



IDEA EVO20-P Dual 10 Passive Bi Amp Line Array System User Guide

[Home](#) » [iDea](#) » IDEA EVO20-P Dual 10 Passive Bi Amp Line Array System User Guide 

Contents

- [1 IDEA EVO20-P Dual 10 Passive Bi Amp Line Array System](#)
- [2 Product Information](#)
- [3 Product Usage Instructions](#)
- [4 FEATURES](#)
- [5 APPLICATIONS](#)
- [6 OVERVIEW](#)
- [7 TECHNICAL DATA](#)
- [8 TECHNICAL DRAWINGS](#)
- [9 WARNINGS & SAFETY GUIDELINES](#)
- [10 WARRANTY](#)
- [11 Documents / Resources](#)
 - [11.1 References](#)
- [12 Related Posts](#)



IDEA EVO20-P Dual 10 Passive Bi Amp Line Array System



Product Information

Specifications

- Product Name: EVO20-P
- Type: Dual-10 Passive Bi-Amp Line-Array system
- Power Handling (RMS): [insert value]
- Nominal Impedance: [insert value]
- SPL (Continuous/Peak): [insert value]
- Frequency Range (-10 dB): [insert value]
- Frequency Range (-3 dB): [insert value]
- Coverage: [insert value]
- Connectors: [insert value]
- Cabinet Construction: [insert value]
- Grille Finish: [insert value]
- Rigging Hardware: [insert value]
- Dimensions (WxHxD): [insert value]
- Weight: [insert value]
- Handles: [insert value]
- Accessories: [insert value]

Product Usage Instructions

QuickStart Guide

The QuickStart Guide provides step-by-step instructions to quickly set up and use the EVO20-P system. Please refer to the included guide for detailed instructions.

Warnings & Safety Guidelines

Before using the EVO20-P system, it is important to read and understand the warnings and safety guidelines provided in the user manual. These guidelines ensure safe and proper usage of the product.

Warranty

The EVO20-P system comes with a warranty. To claim guarantee service or replacement, please follow the instructions stated in the warranty section of the user manual.

Declarations of Conformity

The EVO20-P system complies with relevant industry standards and regulations. Declarations of Conformity can

be found in the user manual for reference.

Technical Drawings

Technical drawings provide detailed visual representations of the EVO20-P system, including dimensions and other specifications.

Please refer to the technical drawings section in the user manual for more information.

FAQ

Q: Can I use the EVO20-P system outdoors?

A: The EVO20-P system is designed for indoor use. Using it outdoors may affect its performance and durability.

Q: Can I connect multiple EVO20-P systems together?

A: Yes, multiple EVO20-P systems can be connected together for larger sound reinforcement setups. Please refer to the user manual for instructions on how to properly connect and configure multiple systems.

Q: What is the recommended power amplifier for the EVO20-P system?

A: The recommended power amplifier for the EVO20-P system is [insert recommended power amplifier model]. Using a different amplifier may affect the performance and sound quality of the system.

Dual-10" Passive Bi-Amp Line-Array system

FEATURES

- Premium European High Efficiency custom IDEA Transducers
- Proprietary IDEA High-Q 8-slot line-array waveguide with directivity control flanges
- 10 Positions Integrated Precision rigging for stacked and flown configurations
- 2 integrated handles
- Rugged and durable 15 mm Birch Plywood construction and finish
- 1.5 mm Aquaforce coated steel grille with internal protective foam
- Durable Aquaforce paint, available in standard textured black or white, optional RAL colors (on demand)
- Dedicated transport /storage/rigging accessories and Flying frame

APPLICATIONS

- High SPL A/V portable sound reinforcement
- FOH for medium size performance venues and clubs
- Main system for Regional Touring and Rental Companies
- Down-Fill or ancillary system for larger PA/ Line Array systems

OVERVIEW

EVO20-P professional 2-way active dual 10" Line Array system delivers excellent sonic performance and reliability in a convenient and cost-effective package that meets all audio industry professional standards, featuring high quality European transducers and electronic components, European safety regulations and certifications, superior construction and finish and maximum ease of configuration, set-up and operation.

Conceived as main system in portable professional sound reinforcement or touring applications, EVO20-P can also be the ideal choice for High SPL installations for Club sound, sport arenas or performance venues.

Full compatibility with EVO20 systems is guaranteed and a dedicated Upgrade Kit is also available, allowing

current EVO20 users to benefit of all EVO20-P enhancements with a quick and simple upgrade operation.

TECHNICAL DATA

Enclosure design	10° Trapezoidal
LF Transducers	2 × 10" High performance woofers
HF Transducers	1 x compresion driver, 1.4" horn throat diameter, 75 mm (3 in) voice coil
Power Handling (RMS)	LF: 400 W HF: 70 W
Nominal Impedance	LF: 8 Ohm HF: 16 Ohm
SPL (Continuous/Peak)	127/133 dB SPL
Frequency Range (-10 dB)	66 – 20000 Hz
Frequency Range (-3 dB)	88 – 17000 Hz
Aiming/Prediction Software	EASE FOCUS
Coverage	90° Horizontal
Connectors +/-1 +/-2	2 x Neutrik speakON® NL-4 in parallel LF HF
Cabinet Construction	15 mm Birch Plywood
Grille	1.5 mm perforated weatherised steel with protective foam
Finish	Durable IDEA proprietary Aquaforce High Resistance paint coating process
Rigging Hardware	High-resistance, coated steel integrated 4-point rigging hardware 10 angulation points (0°-10° internal splay angles in 1° steps)
Dimensions (WxHxD)	626 x 278 x 570 mm (24.6 x 10.9 x 22.4 in)
Weight	35.3 kg (77.8 lb)
Handles	2 integrated handles
Accessories	Rigging frame (RF-EVO20) Transport cart (CRT EVO20)

TECHNICAL DRAWINGS

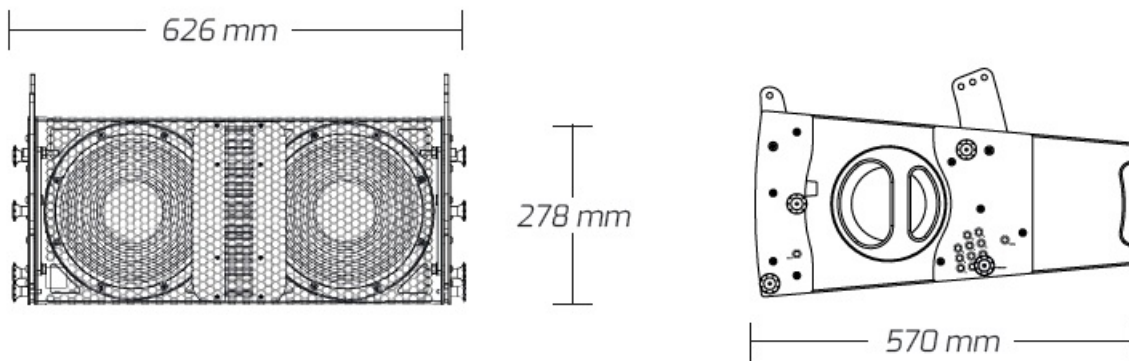

WARNINGS & SAFETY GUIDELINES

- Read this document thoroughly, follow all safety warnings and keep it for future reference.
- The exclamation mark inside a triangle indicates that whatever repairing and component replacement operations must be done by qualified and authorized personnel.
- No user serviceable parts inside.
- Only use accessories tested and approved by IDEA and supplied by the manufacturer or an authorized dealer.
- Installations, rigging and suspension operations must be done by qualified personnel.
- Only use accessories specified by IDEA, complying with maximum loads specifications and following local safety regulations.
- Read the specifications and connection instructions before proceeding to connect the system and use only cabling supplied or re-commended by IDEA. Connection of the system should be done by qualified personnel.
- Professional sound reinforcement systems can deliver high SPL levels that may result in hearing damage. Do not stand close to the system while in use.
- Loudspeaker produce magnetic field even while they are not in use or even when disconnected. Do not place or expose loudspeakers to any device that is sensitive to magnetic fields such as television monitors or data storage magnetic material.
- Disconnect the equipment during lightning storms and when it is not to be used for a long time.
- Do not expose this device to rain or moisture.
- Do not place any objects containing liquids, such as bottles or glasses, on the top of the unit. Do not splash liquids on the unit.
- Clean with a wet cloth. Do not use solvent-based cleaners.
- Regularly check the loudspeaker housings and accessories for visible signs of wear and tear, and replace them when necessary.
- Refer all servicing to qualified service personnel.
- This symbol on the product indicates that this product should not be treated as household waste. Follow local regulation for recycling of electronic devices.
- IDEA declines any responsibility from misuse that may result in malfunction or damage of the equipment.

WARRANTY

- All IDEA products are guaranteed against any manufacturing defect for a period of 5 years from date of purchase for acoustical parts and 2 years from date of purchase for electronic devices.
- The guarantee excludes damage from incorrect use of the product.
- Any guarantee repair, replacement and servicing must be exclusively done by the factory or any of authorized

service centres.

- Do not open or intend to repair the product; otherwise servicing and replacement will not be applicable for guarantee repair.
- Return the damaged unit, at shipper's risk and freight prepaid, to the nearest service centre with a copy of the purchase invoice in order to claim guarantee service or replacement.

DECLARATIONS OF CONFORMITY

- I MAS D Electroacústica SL
- Pol. A Trabe 19-20 15350 CEDEIRA (Galicia – Spain)
- Declares that: EVO20-P
- Complies with the following EU Directives:
- RoHS (2002/95/CE) Restriction of Hazardous Substances
- LVD (2006/95/CE) Low Voltage Directive
- EMC (2004/108/CE) Electro-Magnetic Compatibility
- WEEE (2002/96/CE) Waste of Electric and Electronic Equipment
- EN 60065: 2002 Audio, video and similar electronic apparatus. Safety requirements. EN 55103-1: 1996 Electromagnetic compatibility: Emission
- EN 55103-2: 1996 Electromagnetic compatibility: Immunity

www.ideaproaudio.com

IDEA is always in pursuit of better performance, greater reliability and design features.

Technical specifications and minor finish details may vary without notice in order to improve our products.

©2023 – I MAS D Electroacústica SL

Pol. A Trabe 19-20 15350 Cedeira (Galicia – Spain)

Documents / Resources

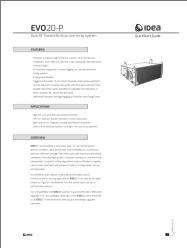
	<p>IDEA EVO20-P Dual 10 Passive Bi Amp Line Array System [pdf] User Guide</p> <p>EVO20-P Dual 10 Passive Bi Amp Line Array system, EVO20-P, Dual 10 Passive Bi Amp Line Array system, Passive Bi Amp Line Array system, Amp Line Array system, Line Array system, Array system, system</p>
---	--

References

-  [IDEA Pro Audio](#)
- [User Manual](#)