

idea display Q32P 4K Monitor 32-inch IPS UHD Computer Gaming Monitor Instruction Manual

[Home](#) » [idea display](#) » idea display Q32P 4K Monitor 32-inch IPS UHD Computer Gaming Monitor Instruction Manual 

idea display

Contents

- [1 idea display Q32P 4K Monitor 32-inch IPS UHD Computer Gaming Monitor Instruction Manual](#)
- [2 GENERAL INFORMATION](#)
- [3 Setup Guide](#)
- [4 Accessories](#)
- [5 Technical Drawing](#)
- [6 Monitor Inputs](#)
- [7 Control Panel](#)
- [8 Initial Setup](#)
- [9 Menu Options](#)
- [10 Technical Specifications](#)
- [11 Documents / Resources](#)
- [12 Related Posts](#)

idea display Q32P 4K Monitor 32-inch IPS UHD Computer Gaming Monitor Instruction Manual

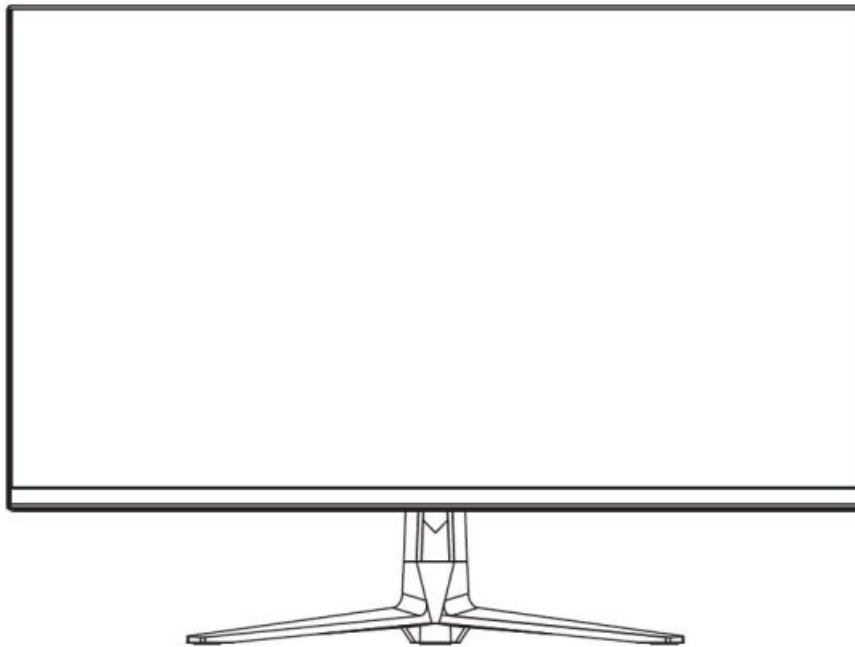

Please read this manual thoroughly before use, and keep it handy for future reference

GENERAL INFORMATION

Dear Customer,

Thank you for having purchased this product. This document describes how to install and use the LCD colour monitor. Read this manual which contains information for correct, safe use carefully. Keep this manual at hand so that you can refer to it when needed.

PRODUCT DESCRIPTION AND TYPE OF USE

The LCD color monitor presents a very rugged structure. It is designed for continuous operation and can be used in closed circuit TV systems without risks of excessive fatigue. The Flat Panel Display has an active matrix, thin-film transistor (TFT), liquid crystal display (LCD).

GENERAL FEATURES

- Display area
- Wall mounting with not included bracket
- One composite one DP, one HDMI, one USB-C, one USB-B, two USB-A
- Wide inclination to allow viewing either from a seated position or standing up and when moving from one position to the other Multilingual OSD menu for easy setting and optimization of the display

OPENING THE BOX

Check that the packing and the contents are not visibly damaged. Contact the retailer immediately if parts are either missing or damaged. Do not attempt to use the device in this case. Send the product back in its original packing if it is damaged.

CONTENTS OF THE BOX

- LCD monitor
- Power Adaptor

- Power cable
- HDMI cable
- USB-C cable
- Audio cable(Optional)
- Remote Control
- User's manual

Important Note: Accessories may be changed without prior notice.

WARNINGS

POWER

- Only use the power unit provided to power the device. Check mains rating before plugging the power unit in.
- Do not pull the cable to unplug the device.

SAFETY PRECAUTIONS

- Keep the device away from rain and humidity to prevent risk of fire and electrocution. Do not introduce material (solid or liquid) inside. If this should accidentally occur, disconnect the device from the mains and have it inspected by qualified personnel.
- Never open the device. In all cases, contact the qualified personnel or authorized service center for repairs.
- Keep the device away from chEren, to prevent accidental damage.
- Do not touch the device with wet hands to prevent electrical shock or mechanical damage.
- Do not use the device if it should fall or the external casing is damaged. Risk of electrocution if the device is used in such conditions. Contact the retailer or authorized installer.
- It is advisable to disconnect the power wire if the monitor is not used for a certain time.

INSTALLATION PRECAUTIONS

- To prevent overheating the device, arrange it in a position allowing the flow of air through the slots in the casing. Ensure at least 5 cm of free space when installing inside a rack. For the same reason, do not install sources of heat, such as radiators or hot air ducts. Keep away from direct sunlight. Do not install in areas subject to excessive dust, mechanical vibrations or shocks.
- Do not arrange this device on an unstable surface, such as a tottering or slanted table. The device could fall causing injury or mechanical failures.
- Do not install the device in a place where it could be exposed to humidity or water. Do not direct a jet of water onto the device: risk of fire, electrocution or mechanical failure.
- Stop using the device if water or other material should penetrate inside: risk of fire and electrocution. Contact the retailer or authorized installer.
- Slots and openings in the cabinet are provided for ventilation. These openings must not be blocked or covered.
- Do not place heavy or heat generating objects on top of the device: this could damage the casing and/or increase internal temperature causing faults.
- Do not cover the device with a cloth while it is running to prevent deforming the external casing and

overheating the internal parts: risk of fire, electrocution and mechanical failure

- Keep magnets and magnetized objects away from the device to prevent faults.
- Do not use the device in presence of smoke, vapor, humidity, dust or intense vibrations.
- Wait for a while before operating a device immediately after transporting it from a cold place to a warm place and vice versa. Wait on average for three hours: this will allow the device to adapt to the new ambient (temperature, humidity, etc.).
- The monitor is provided with a plastic base and rubber feet. It can be positioned on a horizontal surface, such as a desk or a table. Make sure that the device is fastened firmly and that it is not resting on unstable supports or surfaces. Dropping could cause severe injury and damage the device.
- Remember to adjust the brightness and contrast to obtain a perfect image.
- The monitor can also be installed on the wall by means of a bracket (not provided).

CLEANING THE DEVICE

- Rub delicately with a dry cloth to remove dust and dirt.
- Dip the cloth in neutral detergent if dirt cannot be eliminated with a dry cloth alone.
- Do not use volatile liquids (such as petrol, alcohol, solvents, etc.) or chemically treated clothes to clean the device to prevent deformation, deterioration or scratches to the paint finish.

PRIVACY AND COPYRIGHT

The LED monitor is a device for Gaming. Recording of images is subject to the laws in force in your country. Recording of images protected by copyright is forbidden.

Product users shall be responsible for checking and respecting all local rules and regulations concerning monitoring and recording video signals. The manufacturing SHALL NOT BE LIABLE for use of this product not in compliance with the laws in force.

Setup Guide

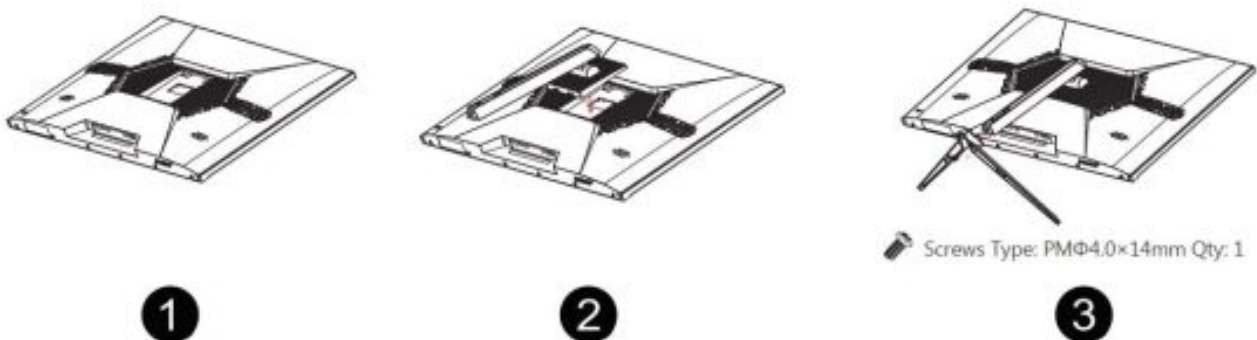

Accessories

PACKAGE INCLUDES

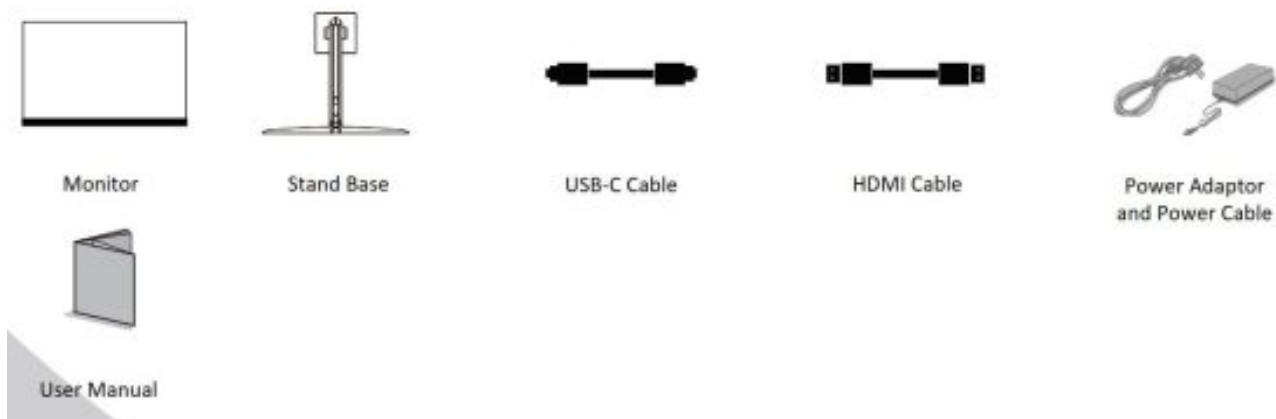

Technical Drawing

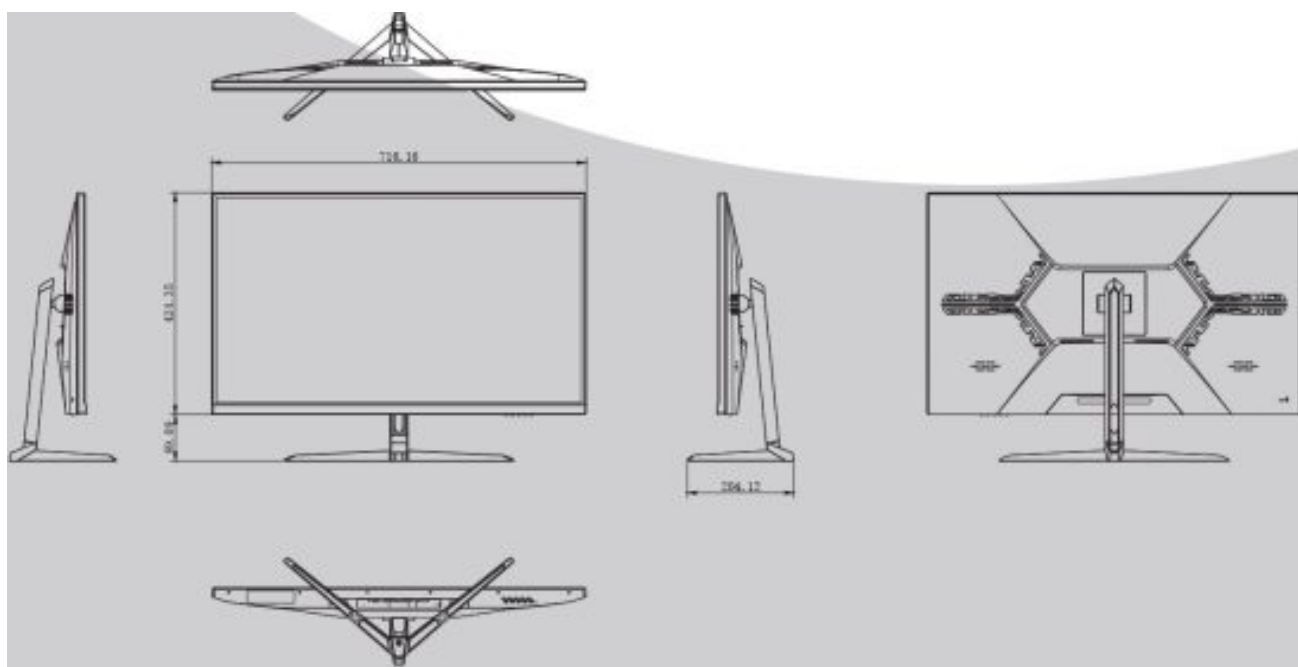

Monitor Inputs

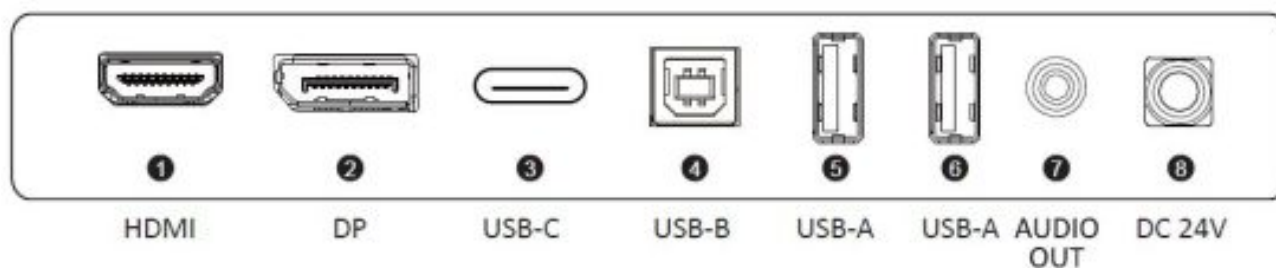

Control Panel

The color and shape of parts may differ from what is shown. Specificaons are subject to change without notice to improve quality.

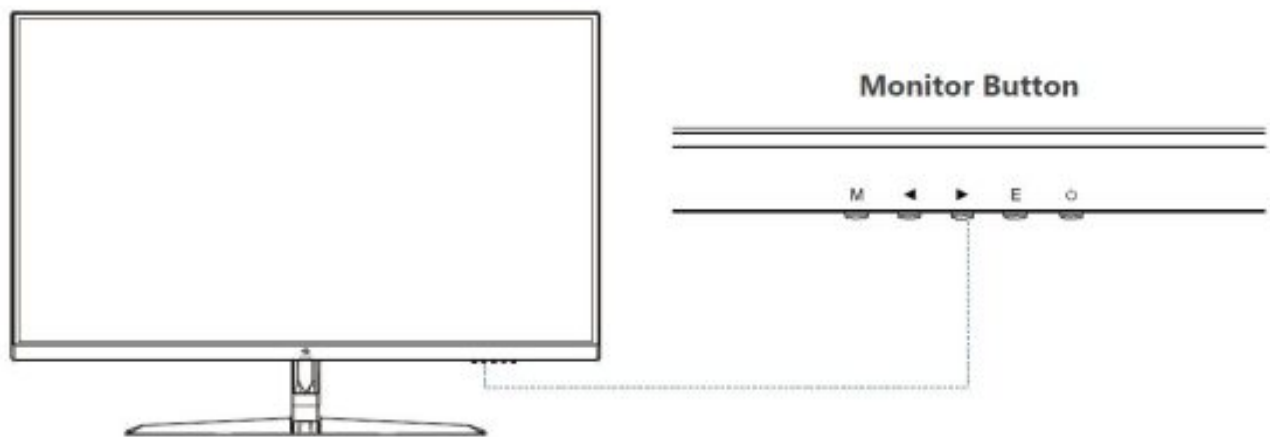

Monitor Button	Action
M	Open the Main OSD Menu and Select submenu
◀	Go Up on the Main OSD Menu Increase the value of a selected item
▶	Go Down on the Main OSD Menu Decrease the value of a selected item
E	Select signal source or Exit OSD
⏻	Turn the monitor ON or OFF

Initial Setup

Connect the monitor to a power outlet.

1. Press the POWER button on the monitor or to turn it on (The indicator will be blue)
2. Connect the relevant cable to the corresponding input on the monitor. The source will be automatically detected.
3. To change between inputs, press the " E" button to enter the source menu. Use the ◀ and ▶ buttons to choose the input source between USB C, DP and HDMI.



Menu Options

The menu for the monitor can be accessed by pressing the “M” button on the control panel. This menu is separated into the following sub menus: Picture Settings, Image Settings, Color Temperature, OSD Settings, Reset, and Miscellaneous options, details of each menu can be found in the following section.

Note:

Some settings may not be adjustable in which case they will be grayed out. This could be due to the input source or other options chosen within the menus.

OSD Menu

A. BRIGHTNESS

BRIGHTNESS: Adjust the display brightness value from 0 to 100.

CONTRAST: Adjust the contrast value from 0 to 100.

ECO: Energy saving mode STANDARD, TEXT, MOVIE, GAME, FPS, and RTS.

DCR: Set the dynamic contrast ratio feature to ON and OFF.

HDR MODE: Allow HDR mode to be turned OFF, AUTO, 2084.



B.IMAGE

ASPECT: Allows selection of video forma WIDE, 4:3.

FLICKER FREE: Set the flicker free feature to ON and OFF.



C.COLOR TEMP

COLOR TEMP: Adjust color temperature to Normal, Warm, Cool, User.

RED: Allows adjustment of the red element of the image.

GREEN: Allows adjustment of the green element of the image.

BLUE: Allows adjustment of the blue element of the image.

LOW BLUE LIGHT: Allows adjustment of the low blue effect of the display, value : 0-25-50-75-100.



D.OSD SETTING

LANGUAGE: Allows selection of desired language: ENGLISH, FRENCH, TURKISH, ITALIAN, SPANISH, PORTUGUESE, CHINESE, DUTCH, JAPANESE, GERMAN, POLISH, AND KOREAN.

OSD H. POS: Allows adjustment of the horizontal position of the OSD.

OSD V. POS: Allows adjustment of the vertical position of the OSD.

OSD TIMER: Allows adjustment of the duration of the OSD, value "5-60".

TRANSPARENCY: Allows adjustment of the transparency of the OSD, value "0-100".

LED EFFECT: Allows the led effect to be turned ON and OFF.

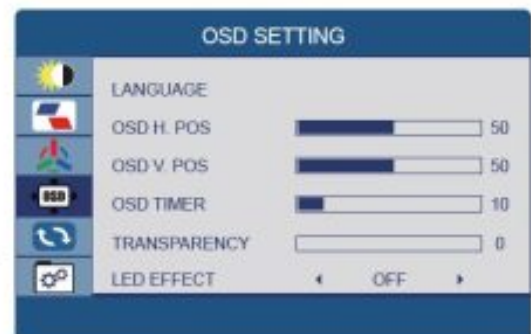

E.RESET

RESET: Returns the monitor to its factory default settings.

USB WAKE UP: Allows the usb wake up to be turned ON and OFF.



F.MISC

SIGNAL SOURCE: Allows user to choose the signal source of the display "HDMI, DP and USB C".

MUTE: Allows Mute to be turned ON and OFF.

VOLUME: Allows adjustment of the volume of the monitor from "0-100".

FREE SYNC: Allows FreeSync to be turned ON and OFF.

OD: Allows OD to be turned ON and OFF.



Technical Specifications

Panel	Model	Q32P
	Resolution	3840x2160
	Refresh	60Hz
	Brightness (MAX)	350cd/m ²
	Contrast Ratio	1000:1
	Response Time (Typical)	OD 4ms
	Aspect Ratio	16:9
	Viewing Angle	178°(H)/178°(V)
	Display Color	1.07B , 100% sRGB
	USB In	2.0x1
	HDMI In	2.0x1
	DP In	1.2x1

In/Out	USB-C	3.1x1
	USB-B	3.0x1
	Audio	x1
	Speaker	2x3W
	Color	Black
ETC	VESA Mount	100x100mm
	Power Consumption	Typical 100W
	Power Source	DC 24V 5A
	USB-C Cable	x1
	HDMI Cable	x1
	Operating Temperature	0~50°C
	Remote Control	x1
	OSD	Eng/Fr/Spanish/Ger/Korean/Japan/Chinese

THANK YOU FOR CHOOSING **idea display**

idea display is a gaming monitor brand that belongs to perfect Display Technology Co.,Ltd which focused on R&D display industry 16 years in China.

We provide high quality yet affordable products that deliver the highest level of performance. Experiencing gaming at its best with idea display .

If you have any questions and comments please do not hesitate to contact us:

E-mail:e-op@perfect-display.com.cn.

REGISTER YOUR PRODUCT

Please register your product online: <https://www.perfectdisplay.com>

idea display encourages you to register your products within thirty(30)days of the original purchases in order to

receive prompt service and support coverage should you need it. idea display may require that you furnish proof of purchase details and / or comply with registration requirements before receiving warranty service.



idea display

www.ideadisplay.store

www.facebook.com/pd.display

www.twitter.com/DisplayPerfect

Read More About This Manual & Download PDF:

Documents / Resources

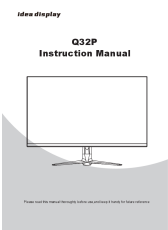
	<p>idea display Q32P 4K Monitor 32-inch IPS UHD Computer Gaming Monitor [pdf] Instruction Manual Q32P, 4K Monitor 32-inch IPS UHD Computer Gaming Monitor, Q32P 4K Monitor 32-inch IPS UHD Computer Gaming Monitor, Computer Gaming Monitor, Gaming Monitor</p>
---	---