



idatalink FTI-CDP1-CH7 LED Programming Error Codes Module Installation Guide

[Home](#) » [idataLink](#) » idatalink FTI-CDP1-CH7 LED Programming Error Codes Module Installation Guide 



BLADE
SERIES

FIRSTECH, LLC.
SUPPORT - 1(888) 820-3690, EXT. 203



Contents

- [1 FTI-CDP1: Vehicle Coverage and Preparation Notes](#)
- [2 FTI-CDP1 – Installation and Configuration Notes](#)
- [3 INSTALL GUIDE](#)
- [4 CARTRIDGE INSTALLATION](#)
- [5 TAKE OVER PROCEDURE – TO THE VEHICLE OWNER](#)
- [6 Documents / Resources](#)
 - [6.1 References](#)

FTI-CDP1: Vehicle Coverage and Preparation Notes

Make	Model	Year	Install	CAN	Lights	IGN	Hood	I/O Changes
DL-CH7					Park / Auto			Green White /Blue
Dodge	Dairage P TS	2013-16	Type 2	CJB	Type A	BCM	BCM	

Firmware: Covered vehicles use either BLADE-AL(DL)-CH7, confirm application, flash module, and update the controllerfirmware before installing.

CAN:

Type 1 vehicles use CAN connections on the harness in OBD-II, the included CAN extension is not necessary for this type of installation.

Lights:

Type A parking lights use the 6-pin connector, make sure the unused 10-pin connector is properly secured for safety.

Ignition:

Common ignition provisions are listed on the BLADE diagram, ignition is also available at the vehicle BCM (C5/E connector, pink/white, pin #27). The hood status wire is available at the vehicle BCM, C1 connector, pin #11 (violet/blue).

FTI-CDP1 – Installation and Configuration Notes

A. CAN Type 1 connection uses harness provision to obtain CAN data from OBD-II connector

B. CAN Type 2 extension cable is not used on covered vehicles, ensure all unused connections are properly insulated and secured for safety.

C. Hood pin connection (if required).

D. Ignition source jumper, NO CONNECTION is required for this type of installation. Ensure ignition without using jumpers to ensure safety

E. Ignition connection varies by vehicle, component locator illustrates common connection to BCM connector C5 (pin #27, pink/white), see notes on coverage page for location details and exceptions



FEATURE COVERAGE

IMMOBILIZER DATA	●
PRIORITY UNLOCK	●
DOOR LOCK	●
DOOR UNLOCK	●
ARM OEM ALARM	●
DISARM OEM ALARM	●
DOOR STATUS	●
RAP SHUTDOWN	●
BRAKE STATUS	●
E-BRAKE STATUS	●
TACH OUTPUT	●
SECURE TAKEOVER	●
PARKING LIGHTS	●

- FT-DAS Required for manual transmission.
- BOTH Red & Red/White MUST be connected with high current application.

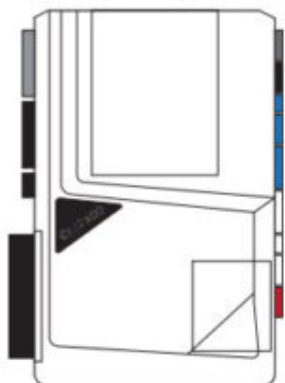
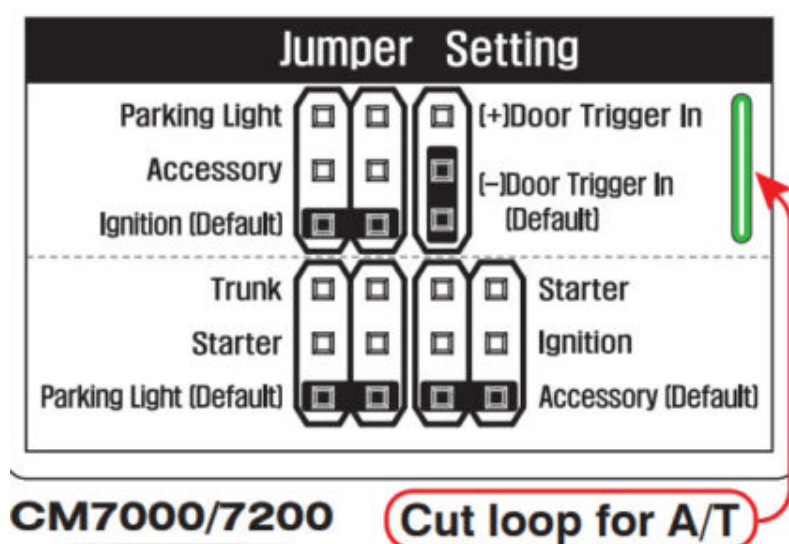

CM-900S/900AS

CM900AS/900S Jumper

START
ACC
IGN1

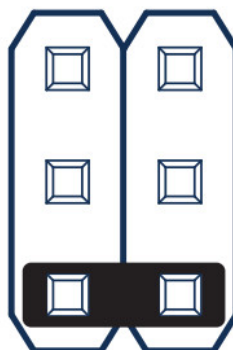

FTI-CDP1 – DL-CH7 – Type 1
2013-16 Dodge Dart PTS

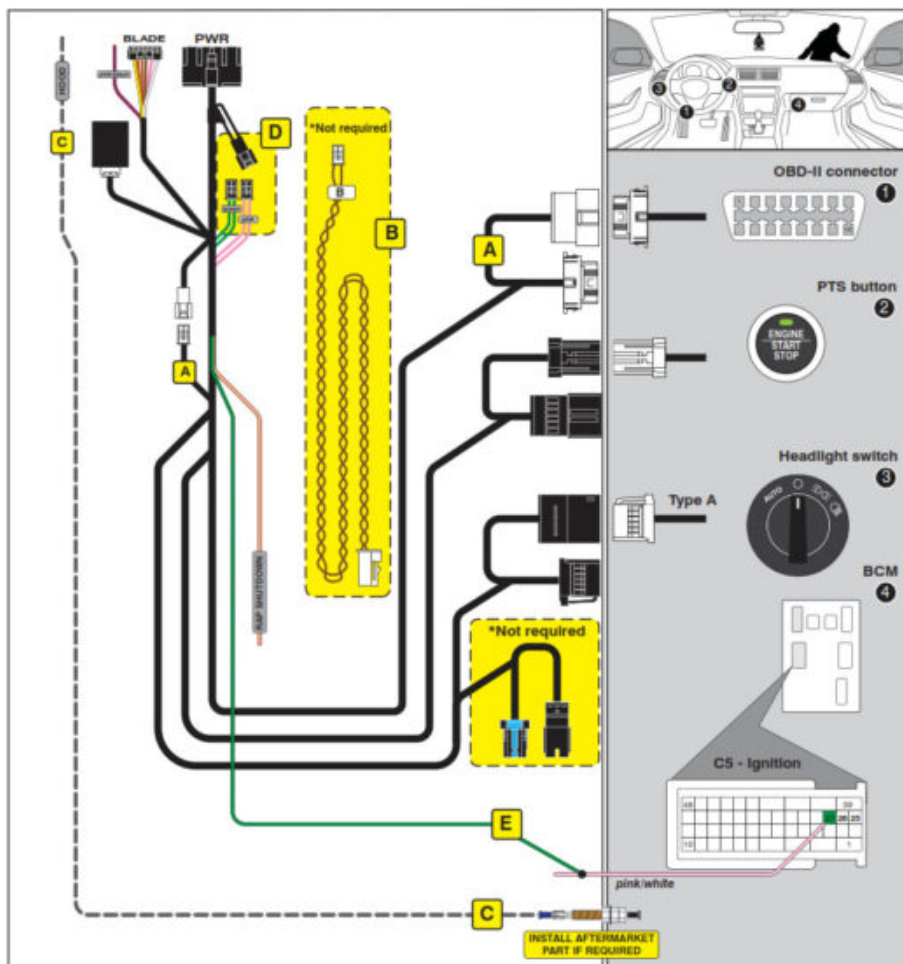

LED Programming Error Codes

Module LED flashes RED during programming

- 1x – CAN error, check CAN wiring and voltages
- 2x – Key code not learned, confirm unlock sent, check CAN
- 3x – No PTS signal, check button connection
- 4x – No immobilizer data, check wiring
- 4x – No immobilizer, confirm only one key in vehicle
- 5x – No ignition, check wiring
- 6x – VIN error, check CAN wiring
- 7x – PTS signal error, check button connection
- 8x – No PTS signal, check button connection

INSTALL GUIDE

ALL IN ONE CHRYSLER/DODGE/JEEP/RAM

Patent No. US 8,856,780 CA 2759622

COM-BLADE-AL(DL)-CH7-EN

Doc. No.: ##72396##

20201117

CARTRIDGE INSTALLATION

1. Slide cartridge into unit. Notice button under LED.

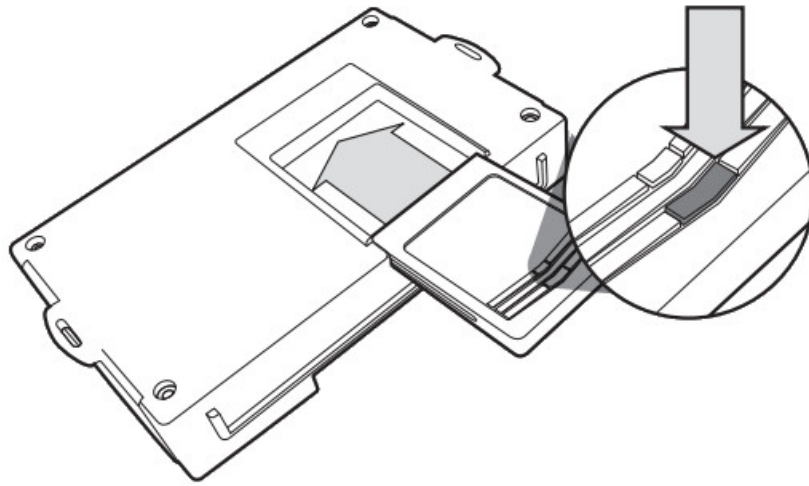

2. Ready for Module Programming Procedure.

MODULE PROGRAMMING PROCEDURE – WITH KLON – 1 OF 2

1. Close driver door

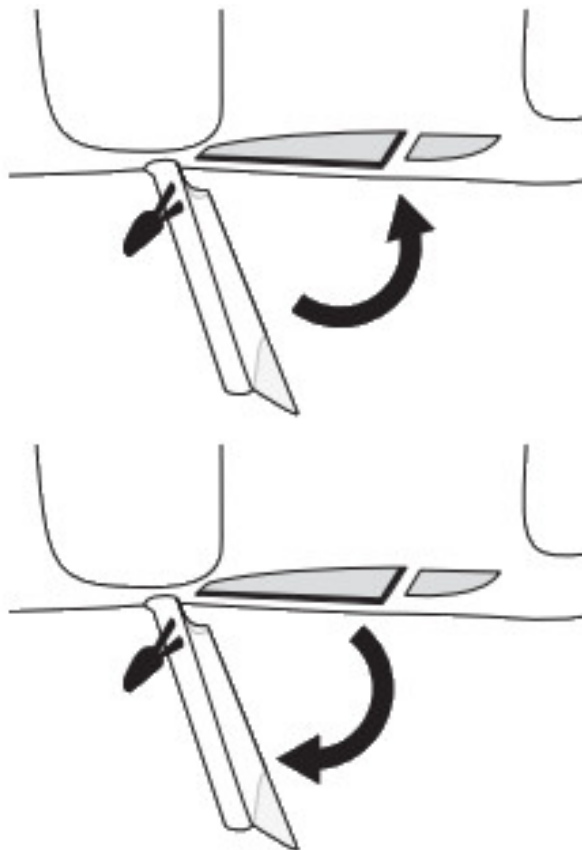

Re-open driver door to wake up data bus

2. Press UNLOCK on keyfob 1.



3. Wait, LED will flash BLUE once [1x].

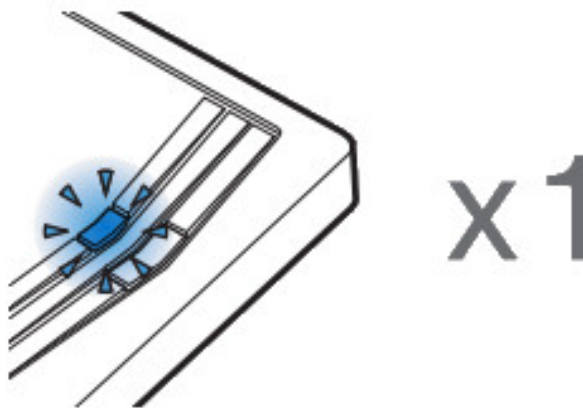

4. Remove valet key from keyfob 1.

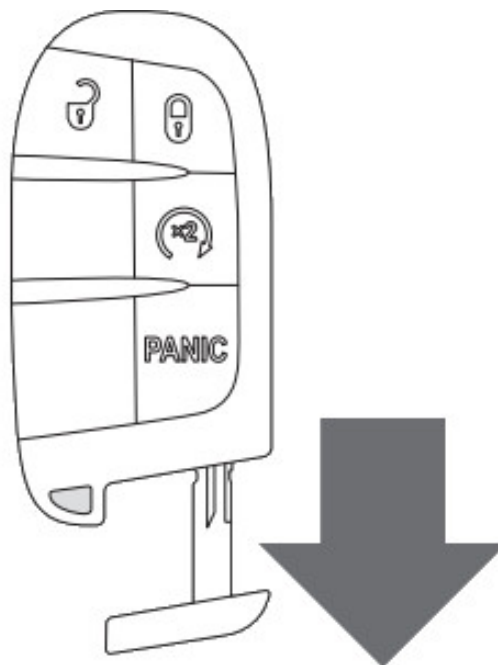

5. Remove batteries from keyfob 1.

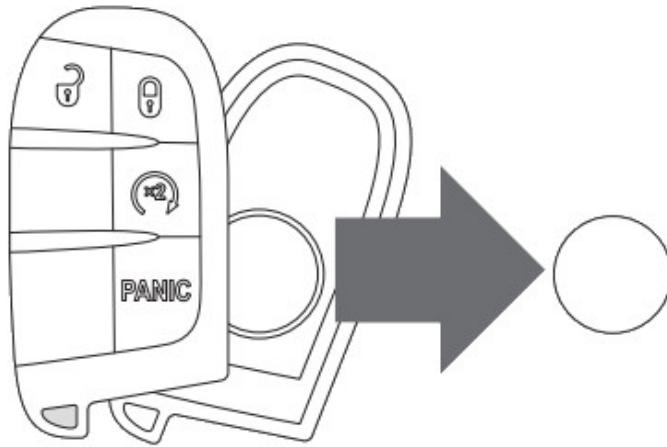

6. Push start button twice [2x] with keyfob 1 to ON position (No battery)

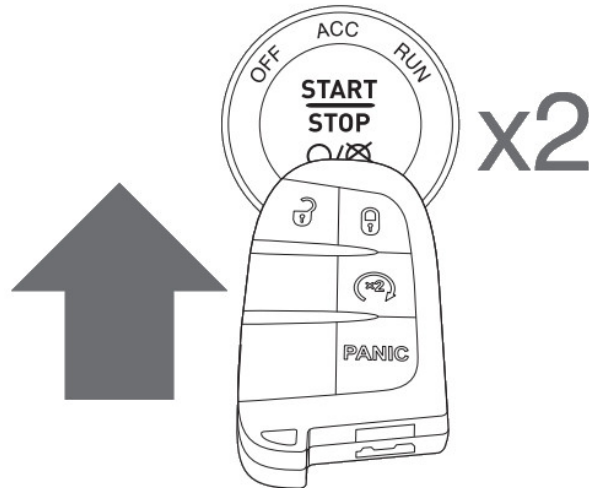

7. Wait, LED will turn solid RED.

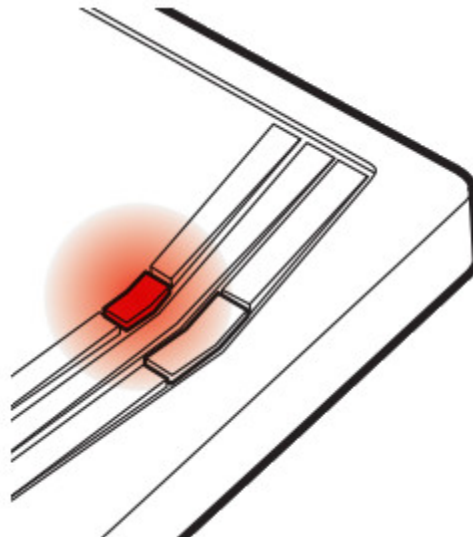

8. Push start button once [1x] to OFF position.

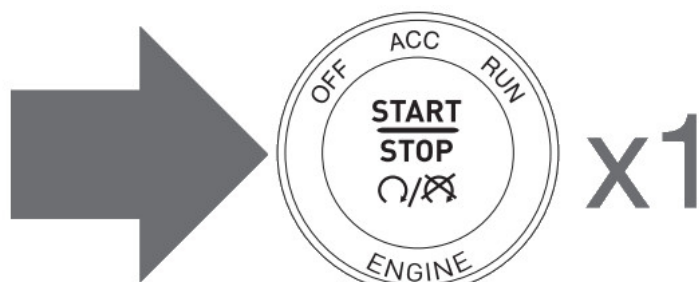

9. Push start button twice [2x] with keyfob 1 to ON position (No battery)

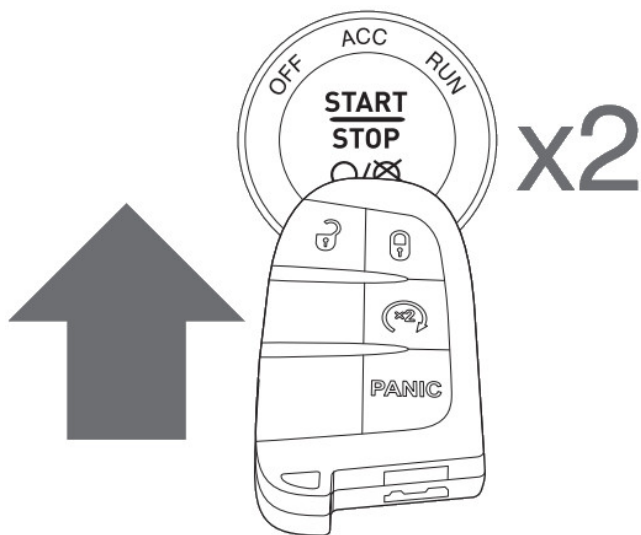

10. Wait, LED flashes BLUE rapidly, proceed to step 11. If LED turns solid RED repeat steps 8 to 10.

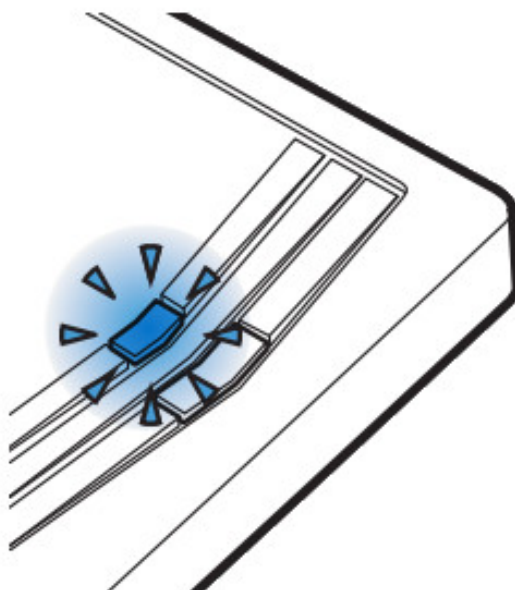

11. Push start button once [1x] to OFF position.

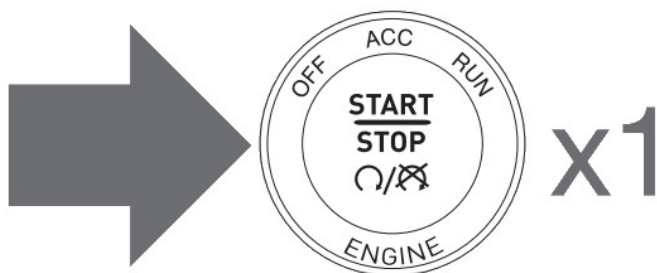

12. Disconnect all connectors from remote starter except the power connector.

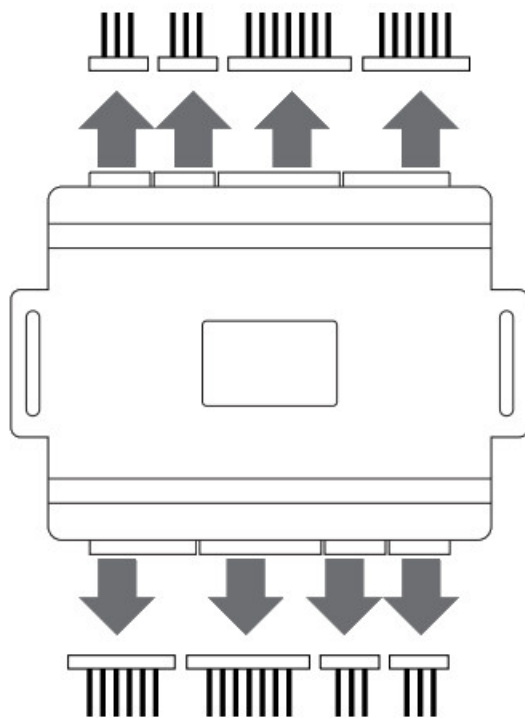

13. Disconnect the power connector.



IMPORTANT: READ NEXT PAGE !

MODULE PROGRAMMING PROCEDURE – WITH KLON – 2 OF 2

14. Remove remote starter from vehicle.

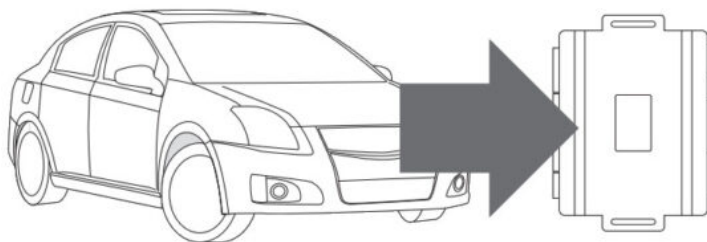

15. Connect remote starter to computer.

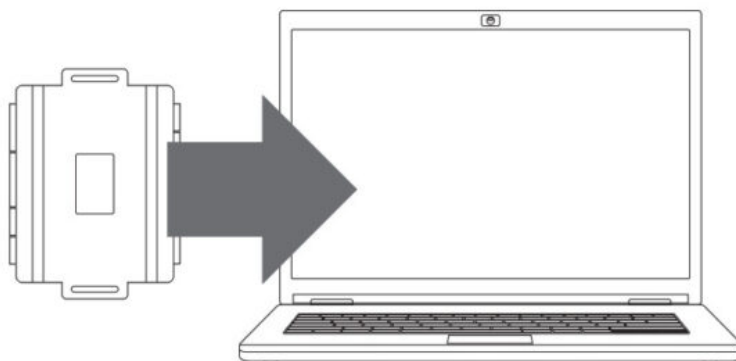

16. Proceed with extended programming.

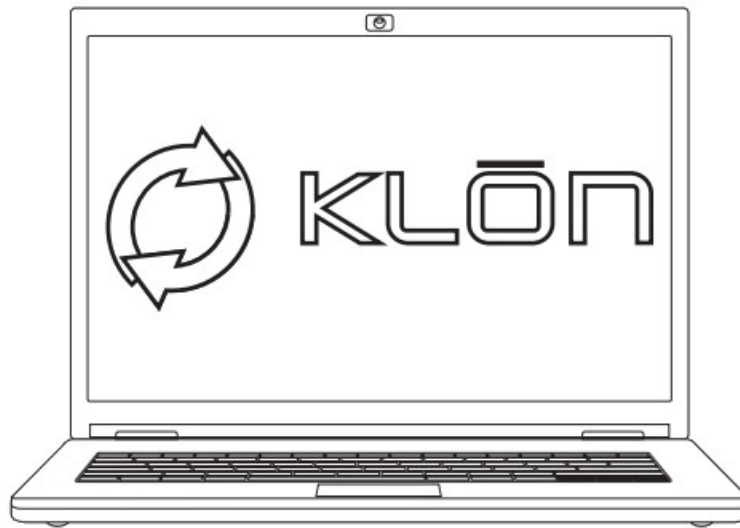

17. Connect remote starter to vehicle.

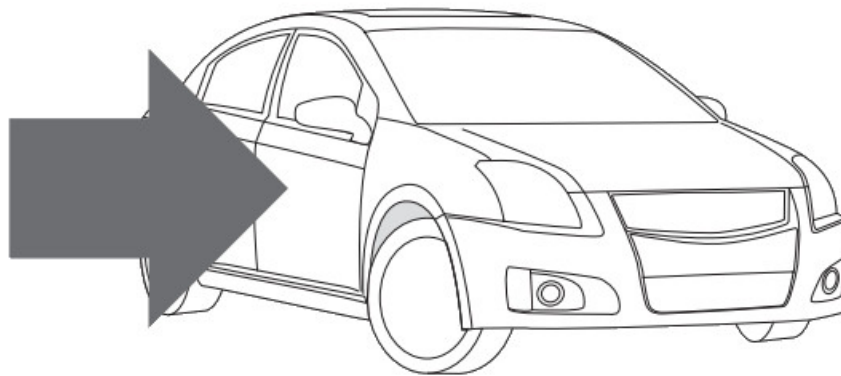

18. Close driver door.

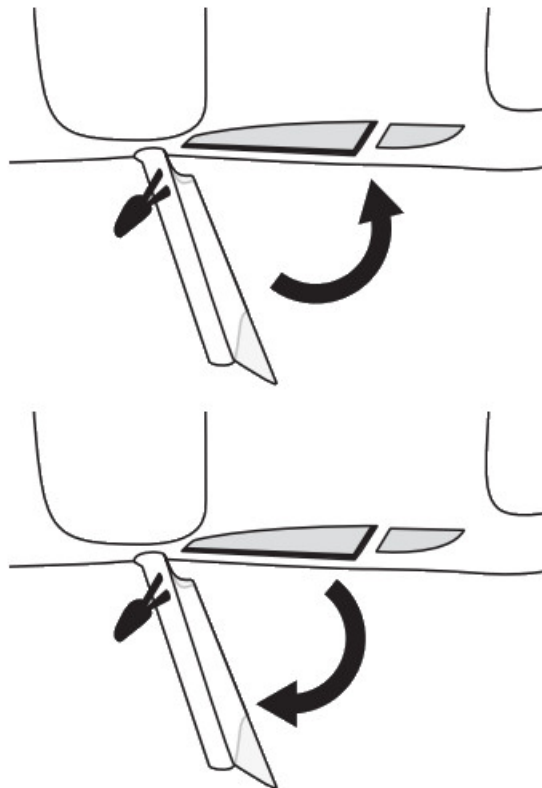

Re-open driver door to wake up data bus.

19. Push start button twice [2x] with keyfob 1 to ON position. (No battery)

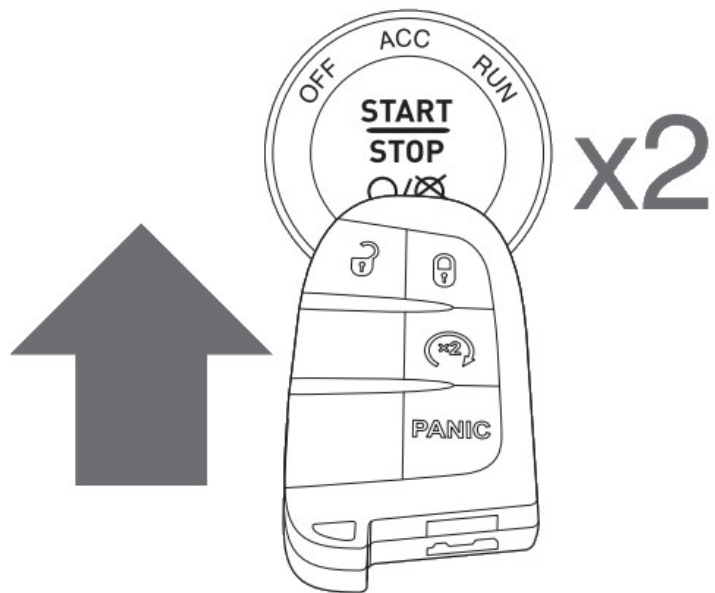

20. Wait, LED will turn solid BLUE for 2 seconds.

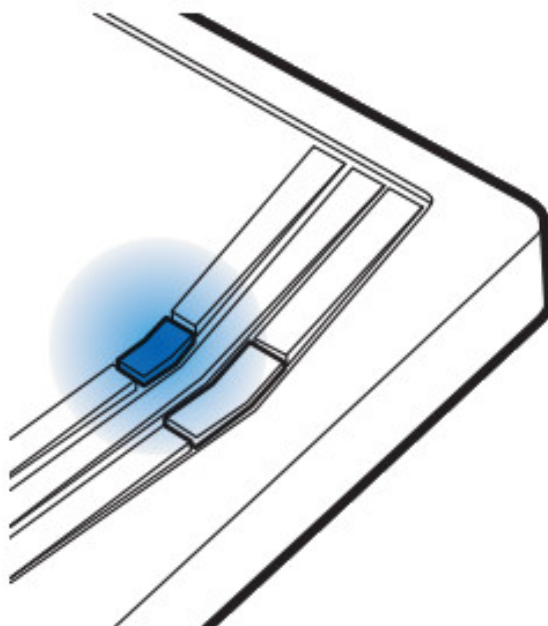

21. Push start button once [1x] to OFF position.

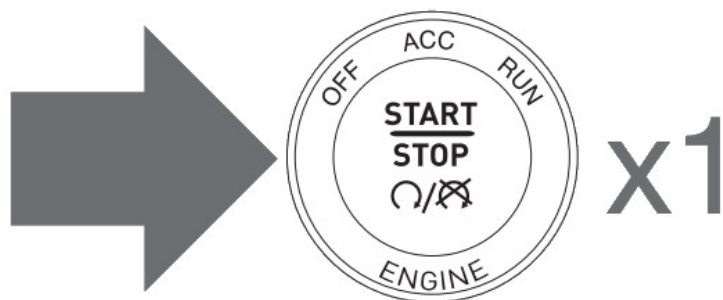

Module Programming

Procedure completed

22. Insert battery in keyfob 1.

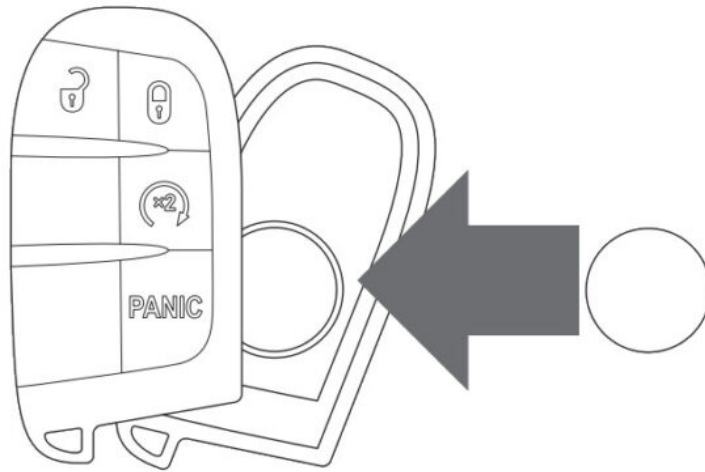

WARNING: READ BEFORE REMOTE STARTING THE VEHICLE

IMPORTANT

1. All OEM keyfobs must be at least 10 feet away from the vehicle. All vehicle doors must be closed and locked prior to remote start sequence. Failure to comply will result in remote starter malfunction.

TAKE OVER PROCEDURE – TO THE VEHICLE OWNER

NOTE

1. All vehicle doors must be closed and locked prior to remote start sequence.



TIME RESTRICTION COMING UP !

1. Press UNLOCK on after-market remote.



2. TIME RESTRICTION

With in 45 SECONDS from previous step.

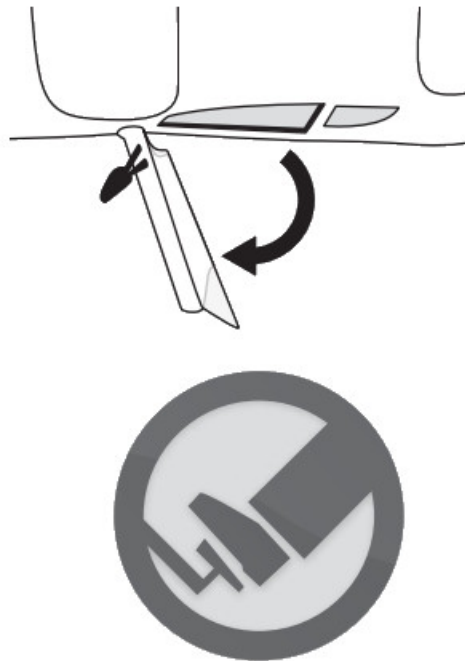

Open vehicle door.

Enter vehicle.

Close vehicle door.

Press and release BRAKE pedal.

3. Take over procedure completed.



Failure to follow procedure within time restriction will result in vehicle engine shutdown.



WWW.IDATALINK.COM

Automotive Data Solutions Inc. © 2020

Documents / Resources

	<p>iDataLink FTI-CDP1-CH7 LED Programming Error Codes Module [pdf] Installation Guide FTI-CDP1-CH7, CM7000-7200, CM900AS-900S, FTI-CDP1-CH7 LED Programming Error Codes Module, FTI-CDP1-CH7, LED Programming Error Codes Module, Programming Error Codes Module, Error Codes Module, Codes Module, Module</p>
	<p>iDataLink FTI-CDP1-CH7 LED Programming Error Codes Module [pdf] Installation Guide FTI-CDP1-CH7 LED Programming Error Codes Module, FTI-CDP1-CH7, LED Programming Error Codes Module, Programming Error Codes Module, Error Codes Module, Codes Module, Module</p>

References

- [iDataLink - Home](#)
- [User Manual](#)

Manuals+. Privacy Policy

This website is an independent publication and is neither affiliated with nor endorsed by any of the trademark owners. The "Bluetooth®" word mark and logos are registered trademarks owned by Bluetooth SIG, Inc. The "Wi-Fi®" word mark and logos are registered trademarks owned by the Wi-Fi Alliance. Any use of these marks on this website does not imply any affiliation with or endorsement.