

ICT BILLET
551216-KN30
Knock Sensor
Relocation
Brackets

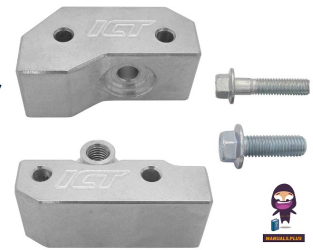

ICT BILLET 551216-KN30 Knock Sensor Relocation Brackets Installation Guide

[Home](#) » [ICT BILLET](#) » ICT BILLET 551216-KN30 Knock Sensor Relocation Brackets Installation Guide 

Contents

- [1 ICT BILLET 551216-KN30 Knock Sensor Relocation Brackets](#)
- [2 Specifications](#)
- [3 Product Information](#)
- [4 Maintenance](#)
- [5 FAQ](#)
- [6 Product Usage Instructions](#)
- [7 CONTACT](#)
- [8 Documents / Resources](#)
 - [8.1 References](#)



ICT BILLET 551216-KN30 Knock Sensor Relocation Brackets

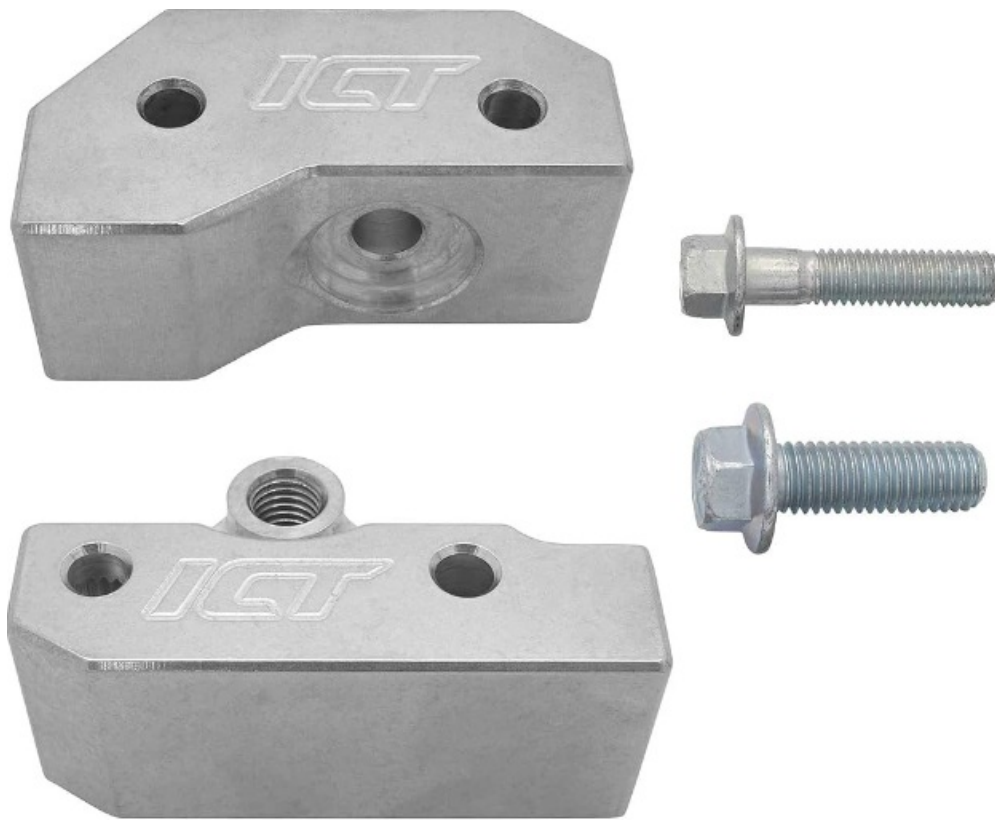

Specifications

- **Part Number:** 551216-KN30 IN
- **Includes:** 2 brackets for knock sensor relocation
- **Compatible with:** Bank 1 (Dark Blue Wire) and Bank 2 (Light Blue Wire)
- **Bracket Material:** Steel
- **Hardware Included:** M8 x 35mm bolts, M10 x 30mm bolts

Product Information

Installation

- Identify the driver side (Bank 1) and passenger side (Bank 2) of your vehicle.
- Locate the knock sensors on each bank.
- Use the provided brackets to relocate the knock sensors as needed.
- Secure the brackets using the included M8 x 35mm and M10 x 30mm bolts.
- Connect the Dark Blue Wire to Bank 1 and the Light Blue Wire to Bank 2.
- You can also use the ICT Billet Knock Sensor Wire Harness Extension (ICT# WEKN030-36) for additional length if required.

Maintenance

- Regularly check the brackets and bolts for tightness to ensure proper sensor positioning.

FAQ

- **Q:** Can I use these brackets on any vehicle?
- **A:** These brackets are specifically designed for LS GEN 3 engines. Ensure compatibility before installation.
- **Q:** Do I need any special tools for installation?
- **A:** Basic hand tools should be sufficient for installing these relocation brackets.

Product Usage Instructions

WARNING: Cancer and Reproductive Harm – www.P65Warnings.ca.gov

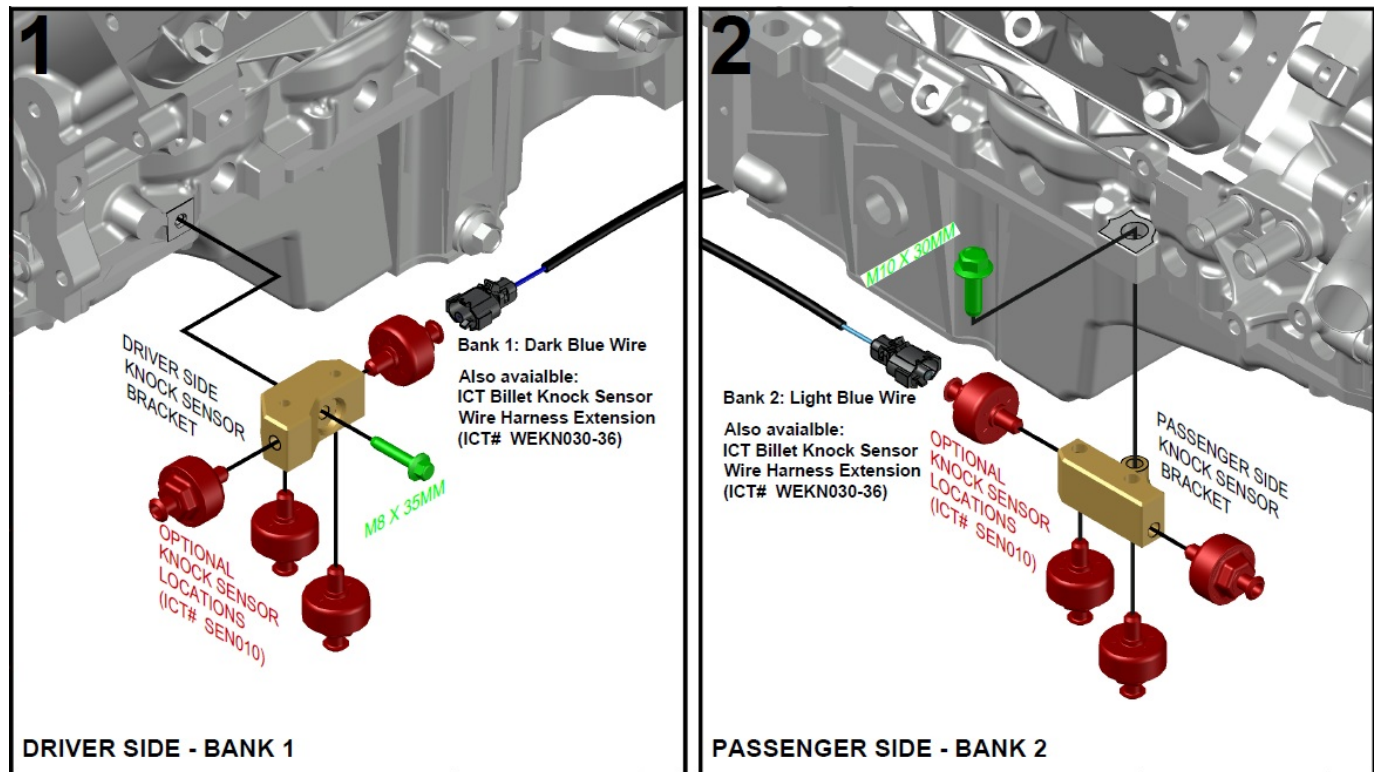

WARNING

- Proposition 65 – This product can expose you to chemicals including lead, which is known to the State of California to cause cancer, birth defects, or other reproductive harm.
- For more information go to www.P65Warnings.ca.gov ALUMINUM – Most of the aluminum alloys used today contain some level of lead, usually less than .1%, Lead is known to the state of California to cause cancer and reproductive harm.
- Most aluminum alloys are physiologically inert in their solid form, and the lead is contained within, however, user-generated dust and/or fumes may pose a hazard if inhaled or ingested.
- Heating beyond a certain temperature may also provide avenues for exposure. STEEL BOLTS – Steel is an iron alloy with several metals including Nickel and Chromium.
- Both Nickel and Chromium are known to the State of California to cause cancer and reproductive harm respectfully. This warning applies to stainless steel as well.

CONTACT

Technical Support

- www.ictbillet.com
- email: sales@ictbillet.com
- Phone: 316-800-695



Made in the USA

- with USA-made materials, spacers, pulleys, & tensioners



- 551216-KN30 LS GEN 3 KNOCK SENSOR RELOCATION BRACKETS



Documents / Resources

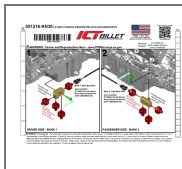

[ICT BILLET 551216-KN30 Knock Sensor Relocation Brackets](#) [pdf] Installation Guide
551216-KN30, 840117201910, 551216-KN30 Knock Sensor Relocation Brackets, 551216-KN30, Knock Sensor Relocation Brackets, Sensor Relocation Brackets, Relocation Brackets, Brackets

References

- [User Manual](#)

[Manuals+](#), [Privacy Policy](#)

This website is an independent publication and is neither affiliated with nor endorsed by any of the trademark owners. The "Bluetooth®" word mark and logos are registered trademarks owned by Bluetooth SIG, Inc. The "Wi-Fi®" word mark and logos are registered trademarks owned by the Wi-Fi Alliance. Any use of these marks on this website does not imply any affiliation with or endorsement.