

## ICOM RS-MS3A Terminal Mode Access Point Mode Application Instructions

[Home](#) » [ICOM](#) » ICOM RS-MS3A Terminal Mode Access Point Mode Application Instructions 



### Contents

- [1 ICOM RS-MS3A Terminal Mode Access Point Mode Application](#)
- [2 SYSTEM REQUIREMENTS](#)
- [3 COMPATIBLE TRANSCEIVERS AND CABLES](#)
- [4 MAIN SCREEN](#)
- [5 Gateway Repeater \(Server IP/Domain\)](#)
- [6 Gateway Type](#)
- [7 Allowed Call sign](#)
- [8 Allowed Call sign List](#)
- [9 Screen Timeout](#)
- [10 Documents / Resources](#)
- [11 Related Posts](#)

**ICOM RS-MS3A Terminal Mode Access Point Mode Application**



## SYSTEM REQUIREMENTS

The following system is required to use the RS-MS3A. (As of October 2020)

- Android™ version 5.0 or later The RS-MS3A has been tested with Android 5.x.x, 6. x.x, 7.x.x, 8.x, 9.0, and 10.0.
- If your device is Android version 4.x.x, you can use RS-MS3A version 1.20, but cannot update RS-MS3A.

USB host function on the Android™ device

- Depending on the software status or the capacity of your device, some functions may not work correctly.
- This application is only set to fit on a vertical screen.
- This instruction manual is based on RS-MS3A

version 1.31 and Android 7.0.

Display indications may differ depending on the Android version or connecting transceiver.

**NOTE:** Before using this application, you must have your call sign registered to the gateway server that has the RS-RP3C installed.

Ask the gateway repeater administrator for details.

## COMPATIBLE TRANSCEIVERS AND CABLES

The following transceivers are compatible with the RS-MS3A. (As of October 2020)

Compatible transceiver	Required item
ID-51A (PLUS2)/ID-51E (PLUS2)	OPC-2350LU data cable  L If your Android device has a USB Type-C port, you need a USB On-The-Go (OTG) adapter to convert the data cable's plug to USB Type-C.
ID-31A PLUS/ID-31E PLUS	
ID-4100A/ID-4100E	
IC-9700	
IC-705*	Purchase the proper USB cable according to your device's USB port.  • For the Micro-B port: OPC-2417 data cable (option)  • For the Type-C port: OPC-2418 data cable (option)
ID-52A/ID-52E*	

Usable only when RS-MS3A version 1.31 or later are installed.

**NOTE:** See “About the DV Gateway function\*” on the Icom website for connection details.

<https://www.icomjapan.com/support/>

When using the IC-9700 or IC-705, see the transceiver's Advanced manual.

When the RS-MS3A is installed, the icon shown to the left is displayed on your Android™ device screen or in the location where you have installed.

Touch the icon to open the RS-MS3A.

## MAIN SCREEN

**1 Start** Touch to start connection to your destination.

**2 Stop** Touch to stop the connection to your destination.

**3 Gateway Repeater (Server IP/Domain)** Enter the RS-RP3C's gateway repeater address.

**4 Terminal/AP Call sign** Enter the gateway call sign.

**5 Gateway Type** Select the gateway type. select “Global” when operating outside of Japan.

**6 UDP Hole Punch** Select whether or not to use the UDP Hole Punch function. This function enables you to communicate with other station who uses the DV Gateway function even if:  
You do not forward port 40000.  
A static or dynamic Global IP address is not assigned to your device.

**7 Allowed Call sign** Select to allow the station of the assigned call sign to transmit through the Internet.

**8 Allowed Call sign List** Sets the call sign of the stations to allow transmissions through the Internet while “Enabled” is selected for 7 “Allowed Call sign.”

**9 Screen Timeout** Enables or disables the Screen Timeout function to save the battery power.

**10 Call sign information field** Displays the information of call signs that are transmitted from the Android™ device or received from the Internet.

### Gateway Repeater (Server IP/Domain)

Enter the RS-RP3C’s gateway repeater address or domain name. LThe address consists of up to 64 characters.

**NOTE:** You must have your call sign registered to the gateway server that has the RS-RP3C installed. Ask the gateway repeater administrator for details.

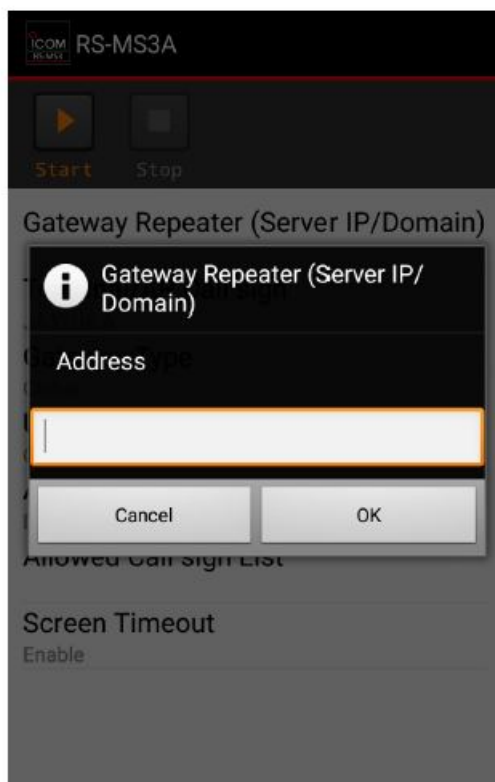

### Terminal/AP Call sign

Enter the Terminal/AP call sign that is registered as the access point on the RS-RP3C’s Personal Information screen. LThe call sign consists of 8 characters.

- Enter My Call sign of the connected transceiver.

- Enter a space for the 7th character.
- Enter a desired ID suffix between A to Z, except for G, I, and S, for the 8th character.

L If the call sign is entered in lowercase letters, the letters are automatically changed to uppercase letters when you touch <OK>.



## Gateway Type

**Select the gateway type.**

L Select "Global" when operating outside of Japan.

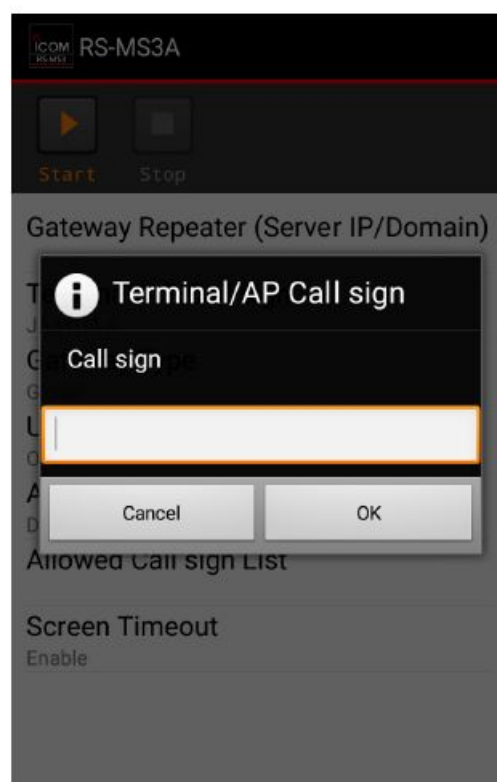

## UDP Hole Punch

Select whether or not to use the UDP Hole Punch function. This function enables you to communicate with other station who uses the Terminal or Access Point mode even if:

- You do not forward port 40000.
- A static or dynamic Global IP address is not assigned to your device.

### Information

- You can receive only a reply.
- You cannot communicate using this function when
- e destination station uses the software that is not compatible with the UDP Hole Punch function.
- When using a device assigned a static or dynamic Global IP address or forwarding port 40000 of a router, select “OFF.”

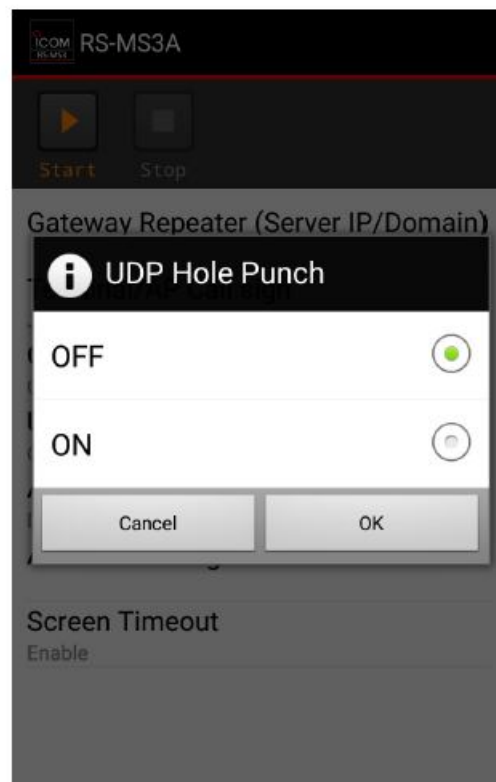

## Allowed Call sign

Select to use the call sign restriction for the Access Point mode. When ‘Enabled’ is selected, this allows the station of the assigned call sign to transmit through the Internet.

- **Disabled:** Allow all call signs to transmit
- **Enabled:** Allow only the call sign displayed under “Allowed Call sign List” to transmit.

When using the Terminal mode, select ‘Disabled.’

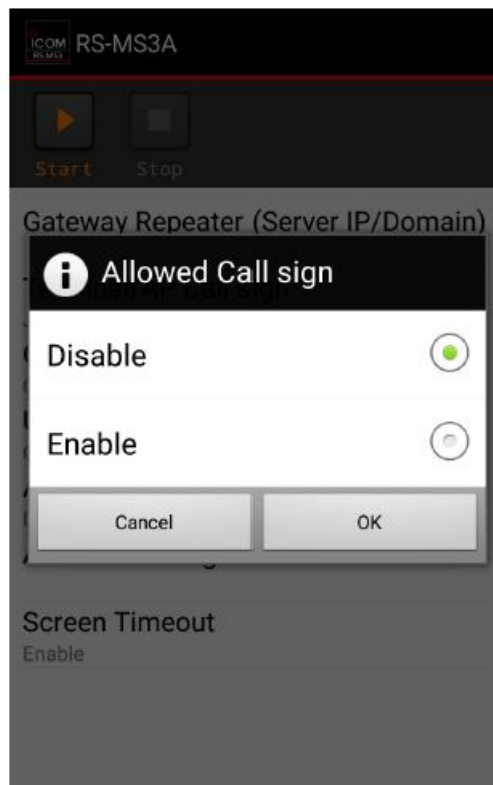

## Allowed Call sign List

Enter the call sign of the stations that are allowed to transmit through the Internet while “Enabled” is selected for “Allowed Call sign.” You can add up to 30 call signs.

### Adding a call sign

1. Touch “Add.”
2. Enter the call sign to allow the call sign to transmit
3. Touch <OK>.



### Deleting a call sign

1. Touch the call sign to delete.
2. Touch <Delete>.

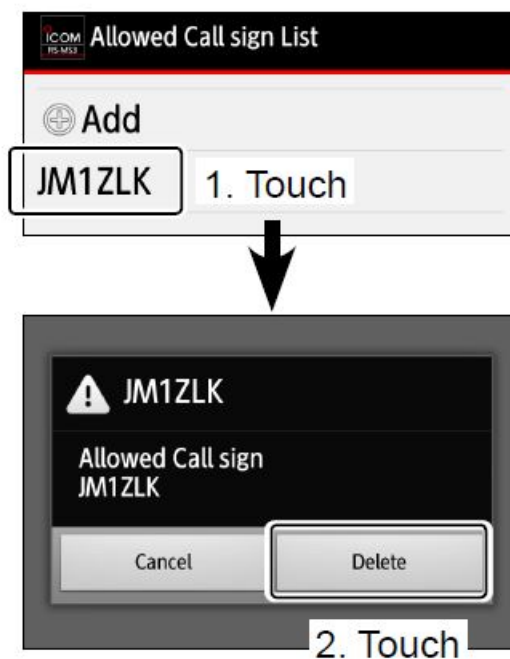

## Screen Timeout

You can enable or disable the Screen Timeout function to save the battery power by turning OFF the screen when no operation is made for a set period of time.

- **Disabled:** Does not turn OFF the screen.
- **Enabled:** Turns OFF the screen when no operation

is made for a set period of time. Set the timeout period in your Android™ device setting. See your Android device's manual for details.

**NOTE:** Depending on the Android™ device, the power supply to the USB terminal may cut off while the screen is OFF or in the battery saving mode. If you are using an Android™ device of this type, select 'Disable.'

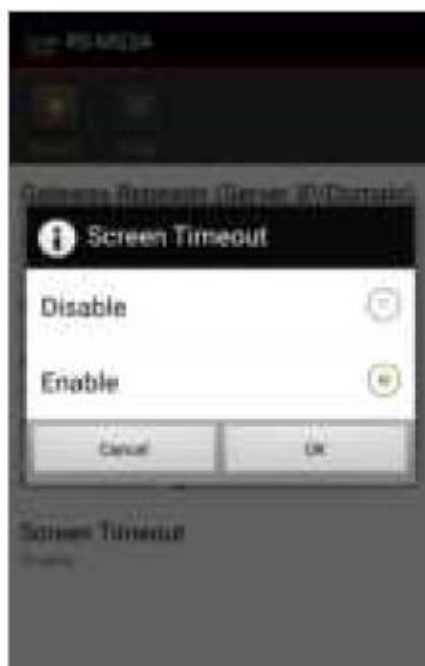



## Call sign information field

Displays the information of call signs that are transmitted from the PC or received from the Internet.

(Example)

(Example)

```
Network -> Transceiver  
(08/17 16:39:07)  
RPT2 : ██████████  
RPT1 : ██████████  
UR   : ██████████  
MY   : ██████████
```

**NOTE:** on disconnecting the data cable: Disconnect the data cable from the Android™ device when not used. This prevents reducing the battery life of your Android™ device.

1-1-32 Kamiminami, Hirano-ku, Osaka 547-0003, Japan Oct. 2020

## Documents / Resources

	<p><a href="#">ICOM RS-MS3A Terminal Mode Access Point Mode Application</a> [pdf] Instructions RS-MS3A, Terminal Mode Access Point Mode Application</p>
---	---