

ickle bubba 4698 Comet 2 in 1 Pushchair



ickle bubba 4698 Comet 2 in 1 Pushchair Instruction Manual

[Home](#) » [Ickle Bubba](#) » ickle bubba 4698 Comet 2 in 1 Pushchair Instruction Manual 

Contents

- 1 ickle bubba 4698 Comet 2 in 1 Pushchair
- 2 Product Information
- 3 Product Usage Instructions
- 4 Frequently Asked Questions
- 5 FEATURES
- 6 COMPONENTS
- 7 SET UP & ASSEMBLY
- 8 Installing the Rear Wheels
- 9 Installing the Front Wheels
- 10 Attaching Footwarmer
- 11 Operating the Seat Recline
- 12 IMPORTANT SAFETY INFORMATION
- 13 CARE AND MAINTENANCE
- 14 WARRANTY INFORMATION
- 15 Documents / Resources
 - 15.1 References



ickle bubba 4698 Comet 2 in 1 Pushchair



Product Information

Specifications

- Product Name: Comet Travel System
- Manufacturer: Ickle Bubba
- Components: Stroller frame, Stroller hood, Locking latch clip, Shopping basket, Brake, Peep hole, Raincover

Product Usage Instructions

Unfolding the Frame

1. Unhook the latch located on the right-hand side of the frame.
2. Lift the handlebar in the direction of the arrow until the frame locks into place.

Installing the Rear Wheels

1. Push the rear wheels onto each side of the axle, brake cluster side first.
2. Fix the smallest part of the locking cap over the end of the axle first, then attach the larger part over the top.
Push the hub cap into place over the top. Repeat for both wheels, ensuring both sides are securely locked in place.
3. Once the wheels are fixed onto the axle, place the axle onto the frame of the chassis. Push it upwards until you hear a 'click' on both sides.
4. To remove the rear wheel axle, push both the metal push pin clips inward and slide downwards until the axle is clear of the chassis.

Installing the Front Wheels

1. Push each wheel onto the front wheel axle until you hear a 'click'. Ensure that the wheels are securely attached to the stroller before use.

Frequently Asked Questions

- Q: How do I unfold the frame of the Comet travel system?
 - A: To unfold the frame, unhook the latch located on the right-hand side of the frame. Lift the handlebar in the direction of the arrow until the frame locks into place.
- Q: How do I install the rear wheels?
 - A: Push the rear wheels onto each side of the axle, brake cluster side first. Fix the locking cap over the end of the axle and push the hub cap into place. Place the axle onto the frame and push it upwards until you hear a 'click' on both sides.
- Q: How do I install the front wheels?
 - A: Push each wheel onto the front wheel axle until you hear a 'click'. Ensure that the wheels are securely attached to the stroller before use.

Dear Parents

Congratulations on the purchase of your Comet travel system! Your child's safety can only be guaranteed if this product is used according to these instructions. Therefore, please take time to read through this instruction manual carefully and keep for future reference.

FEATURES



1. Adjustable handle
2. Stroller Hood

3. Seat Recline
4. Handle adjustment button
5. Seat Unit/ Pram Body Toggle
6. Bumper Bar
7. Bumper Bar Release
8. 5 Point Safety Harness
9. Seat Unit/ Pram Body Removal Button
10. Convertible Seat Unit
11. Locking Latch Clip
12. Shopping Basket
13. Built in Suspension
14. Rear Wheels
15. Front Wheels
16. Brake
17. Apron
18. Peep Hole
19. Car Seat Adaptors
20. Raincover

- Only included when purchased with a car seat.
- Solo se incluye cuando se compra con una silla de auto.

COMPONENTS

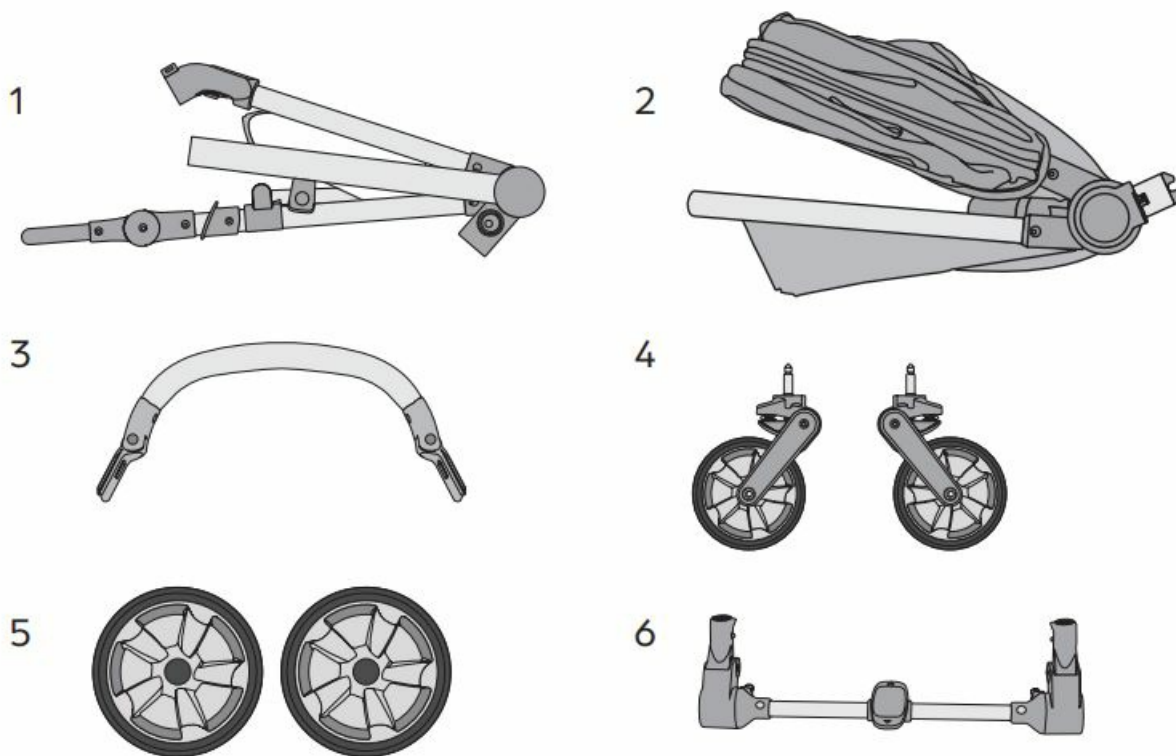

1. Chassis
2. Seat Unit
3. Bumper Bar

4. Front Wheels
5. Rear Wheels
6. Rear Wheel Axle & Break

SET UP & ASSEMBLY

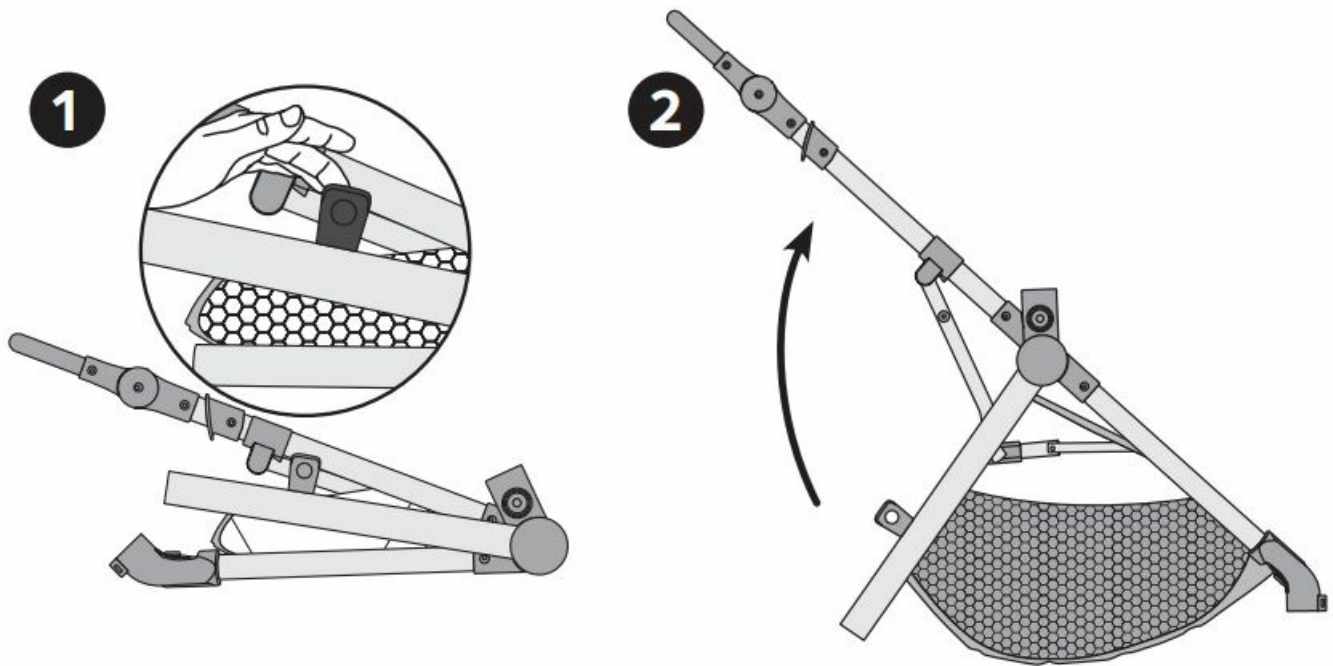

Unfolding the frame

1. Unhook the latch, located on the right hand side of the frame
2. Lift the handlebar in the direction of the arrow until the frame locks into place

Installing the Rear Wheels

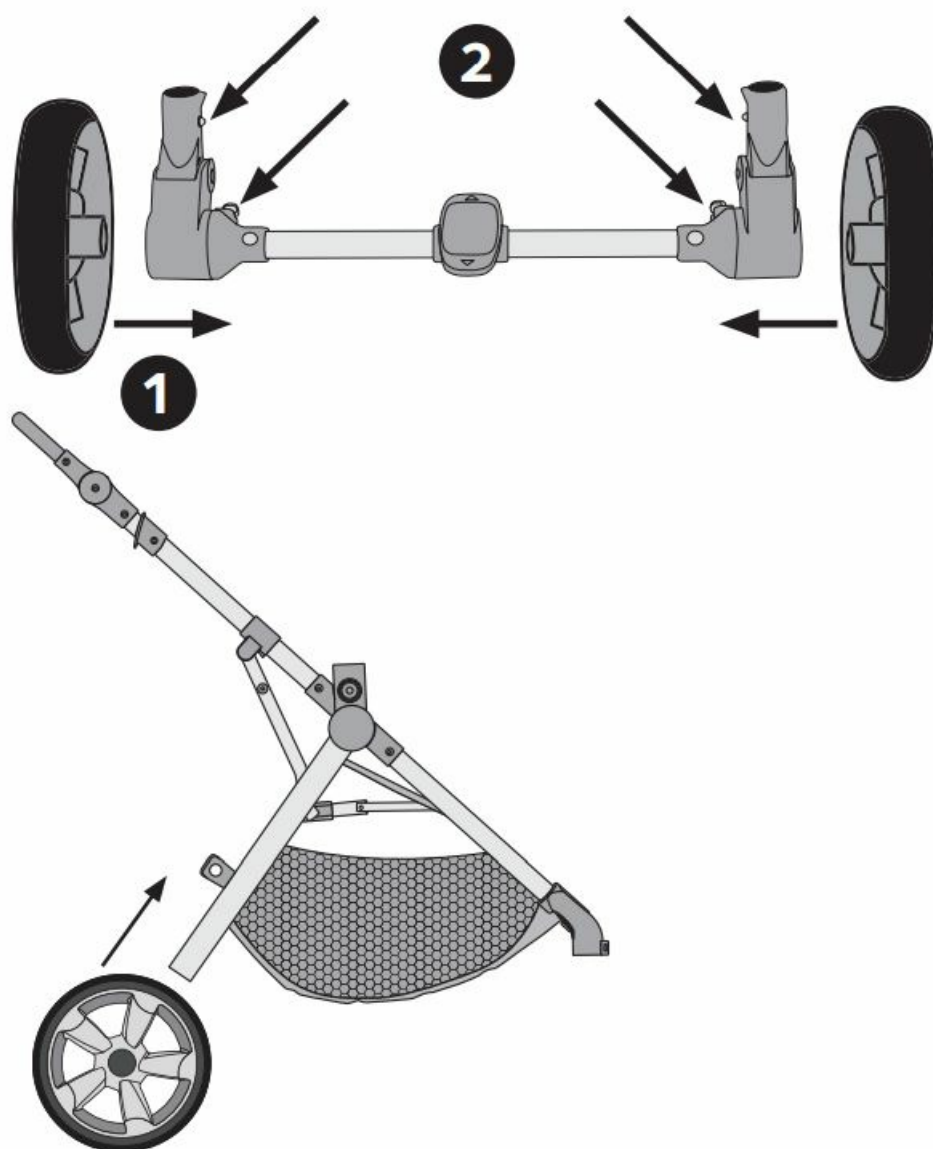

Installing the Rear Wheels

1. Push the rear wheels onto each side of the axle, brake cluster side first .
2. Fix the smallest part of the locking cap over the end of the axle first, then attach the larger part over the top.
Now push the hub cap into place over the top. Repeat for both wheels, ensuring both sides are securely locked in place.
3. Once the wheels are fixed onto the axle, place the axle onto the frame of the chassis. Push it upwards until you hear a 'click' on both sides.
4. To remove the rear wheel axle, push both the metal push pin clips inward, and slide downwards until the axle is clear of the chassis.

Installing the Front Wheels

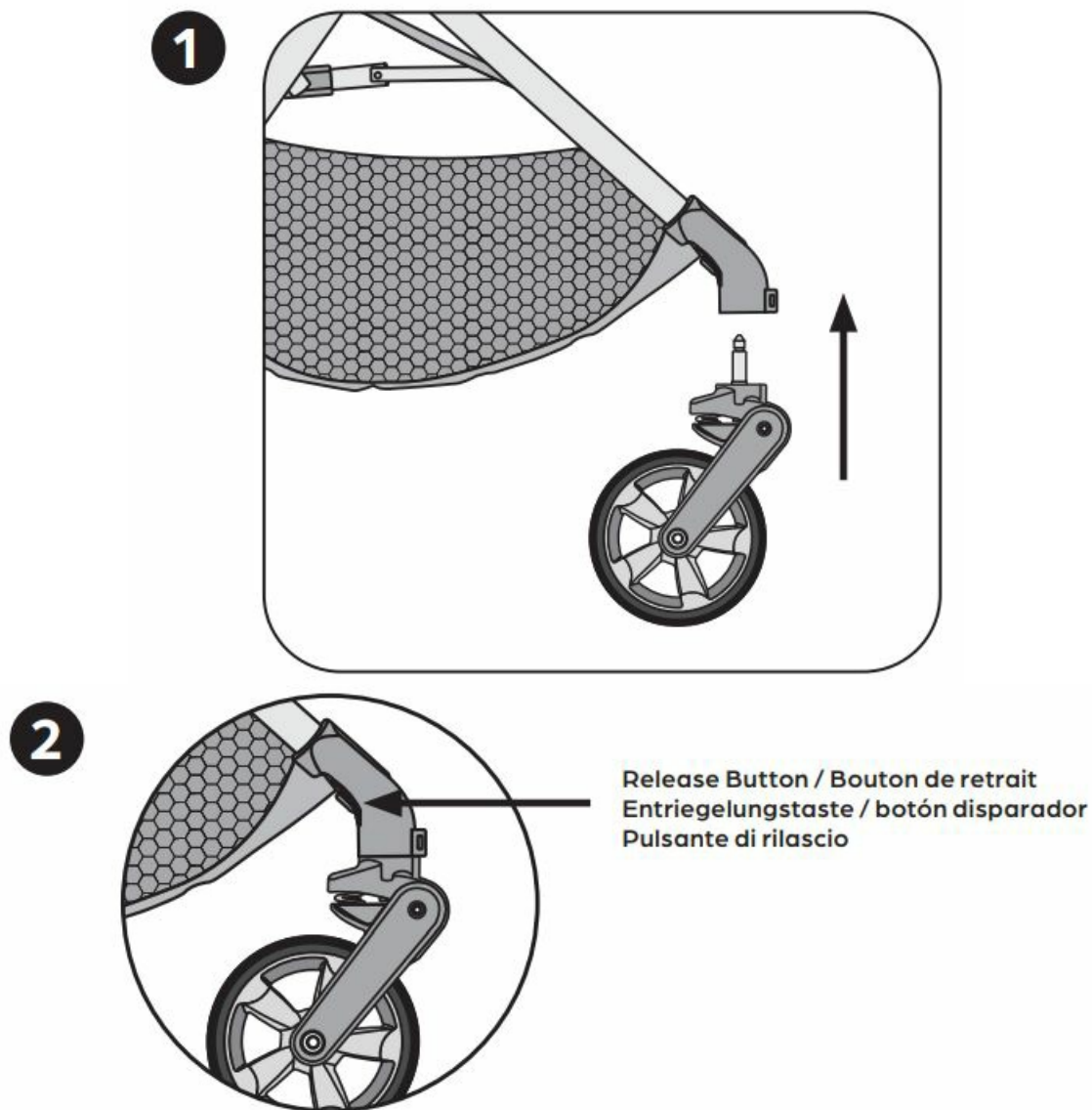

Installing the Front Wheels

1. Push each front wheel onto the front wheel bayonet until you hear a 'click'. Ensure it is securely attached to the stroller before use.
2. To remove the front wheels, locate the release button which can be found at the top of the wheel bayonet, on the inner side. Push the button in firmly and the wheel will disengage

Attaching Seat Unit

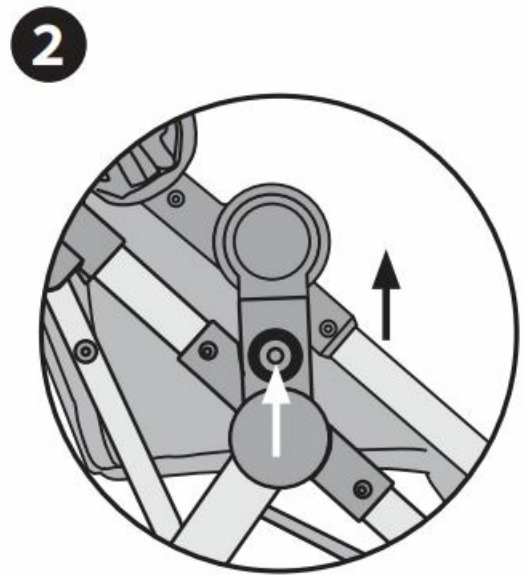

Attaching Seat Unit/ Pram Body to Chassis Frame

1. Align the seat unit adapters with the corresponding holders on the pram frame.
2. Push the seat unit downwards until you hear an audible 'Click'. Ensure that the seat is securely fastened before use.
3. To remove the seat unit, press the release buttons on both sides of the seat frame and lift the seat upwards.

Seat Reversal

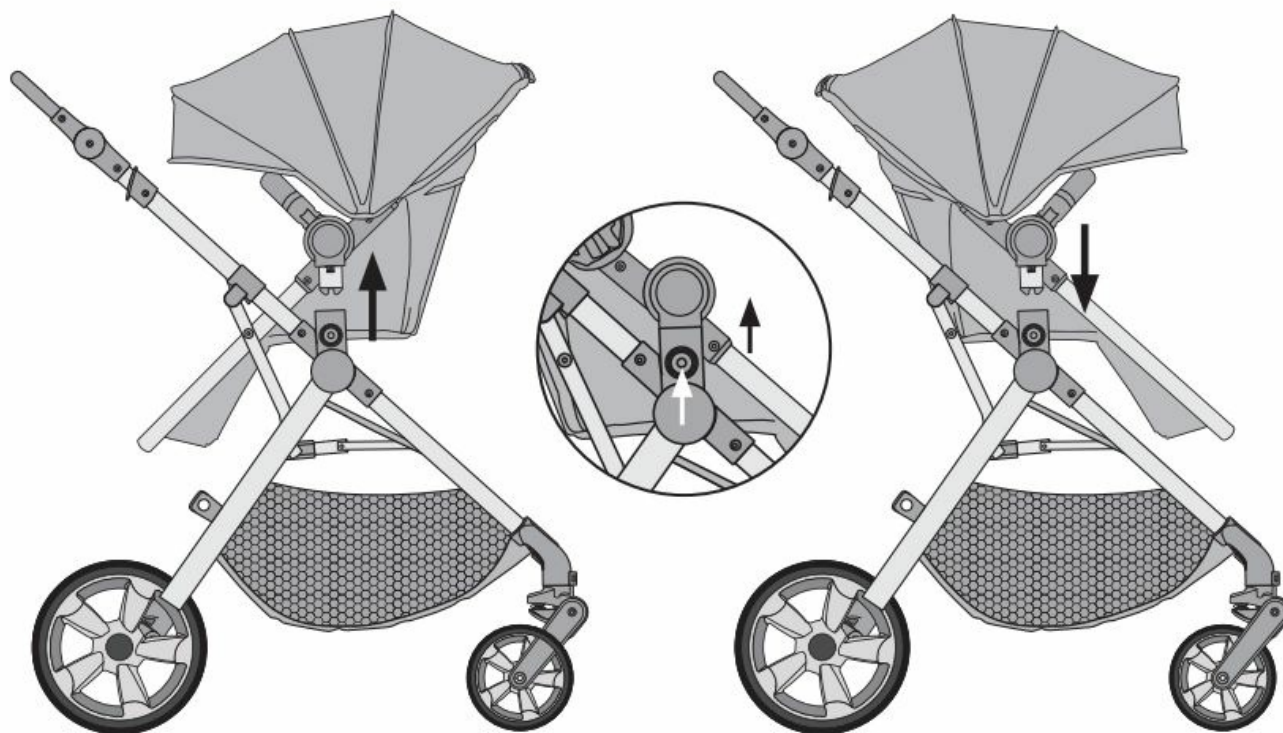

Installing the Pram Hood

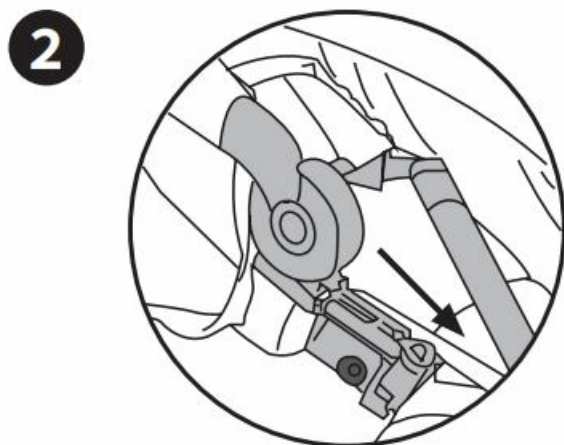
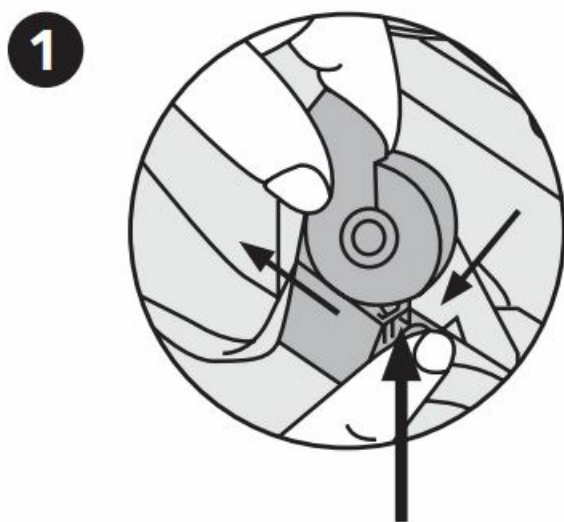

Installing the Pram Hood

1. Insert the metal frame of the hood into the corresponding receptors located on the pram frame.
2. Align the zip located on the back of the hood to the zip located on the seat unit/pram body and fasten.
3. To remove the hood, unfasten the zip, then press both of the hood connector buttons and pull the metal hood frame upwards.

Attaching and Removing the Bumper Bar

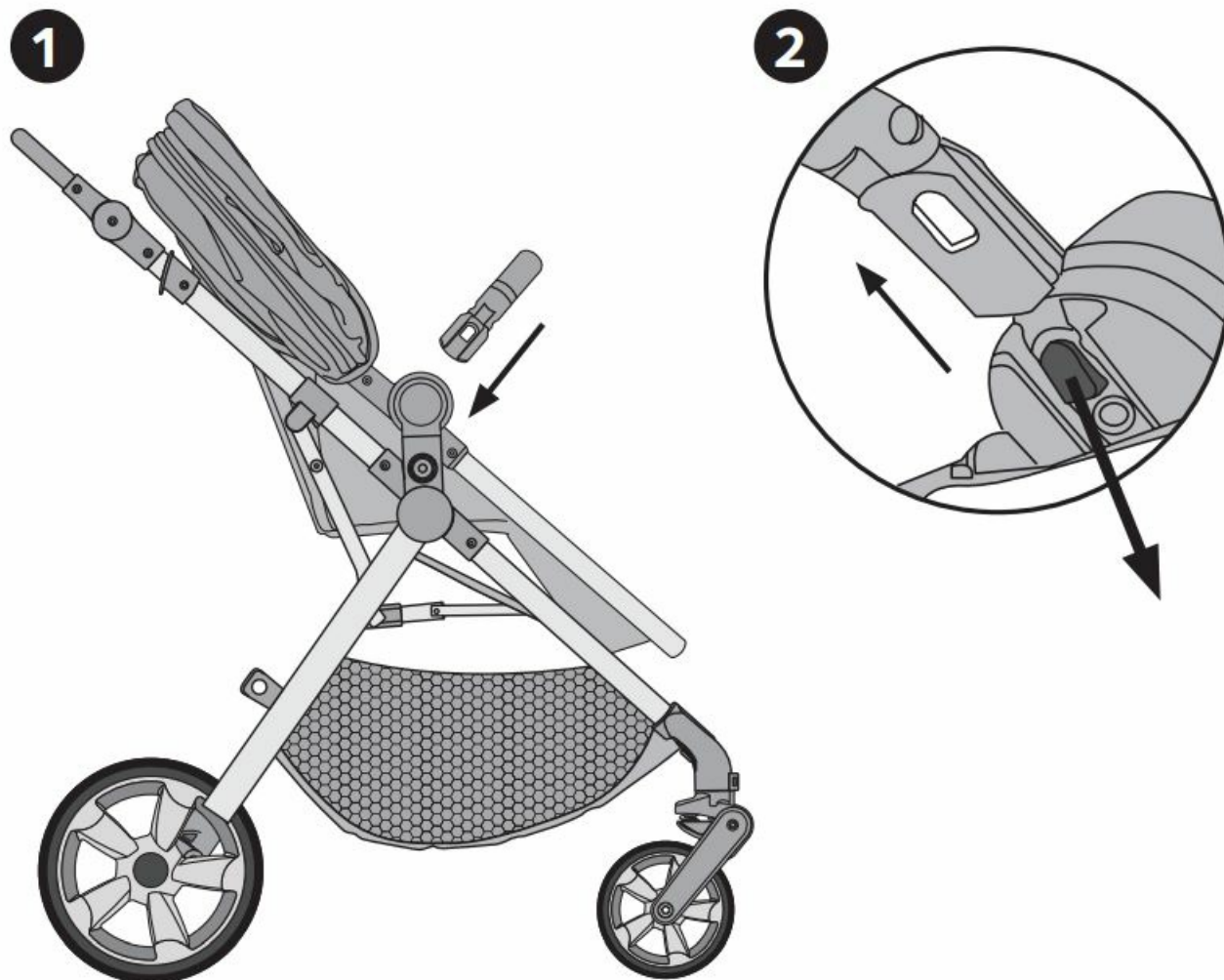

Attaching and Removing the Bumper Bar

1. Align the bumper bar with the fitting on the frame and push inwards until you hear a 'click' on each side and see the safety release buttons are in the raised position.
2. To remove, press each of the safety release buttons (indicated above) and pull the bumper bar outwards.

IMPORTANT: During use, always ensure break is engaged before removing or attaching the bumper bar.

Converting Pram Body to Seat Unit



Converting Pram Body to Seat Unit

1. To convert pram body to seat unit, connect the two clips located at the bottom of the pram body/seat unit.
2. Tighten the toggle located on the top of the pram body/seat unit by holding the strap taught and pushing the toggle upwards. Ensure that all fabrics and buckles are secure before use.
3. To convert seat unit back into pram body, disconnect the two clips located at the bottom of the seat unit and loosen the toggle at the top by squeezing the two side buttons and pulling down. Push the fabric downwards from the inside to ensure the pram body lies flat.

Using the Safety Harness

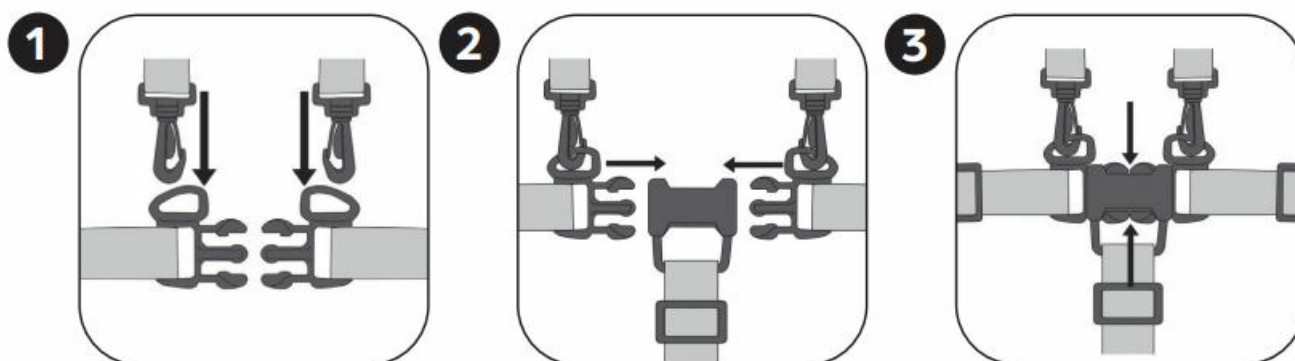

Using the Harness

1. Clip both shoulder strap fastenings into the loops located on the side straps.

2. Push the two side strap clips into the centre clasp until both sides click in securely. Adjust strap lengths as required.
3. To undo the harness, press the buckles in the centre of the harness and pull apart.

Removing the Harness

If you want to remove the harness, place your hand through the Velcro opening at the back of the seat unit/pram body, thread each of the plastic tabs through the openings in the wooden base and pull through the front of the seat fabric. To reinstall, repeat the process in reverse and ensure that each harness belt is secured.

Attaching Footwarmer



Attaching Footwarmer

Align the zip located on the edge of the footwarmer to the zip located on the seat unit/ pram body and fasten. Fold the flap around the bumper bar and fasten into place with the press studs.

Using the Privacy Panel

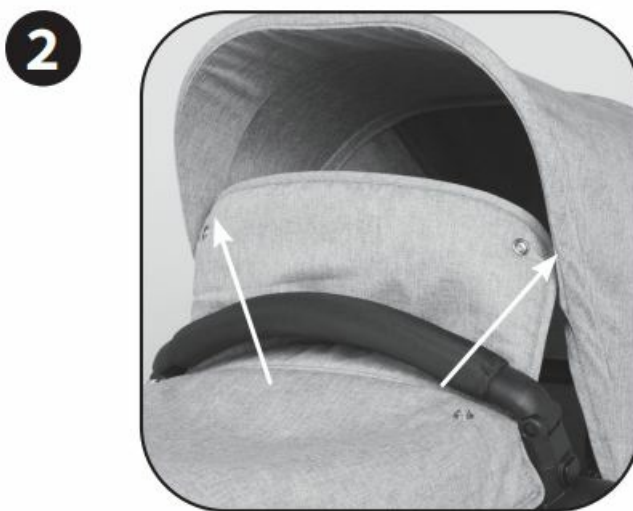

Using the Privacy Panel

1. To use the privacy panel, detach the apron fastenings from around the bumper bar.

2. Reattach the fastenings to the inside of the hood.

Using the Brakes



Using the Brakes

1. To engage the brake, apply a light downward pressure to the brake lever. Ensure that the brakes have been applied correctly and that the stroller will not move.
2. To release the breaks, gently lift up the brake lever.

Using the Front Wheels

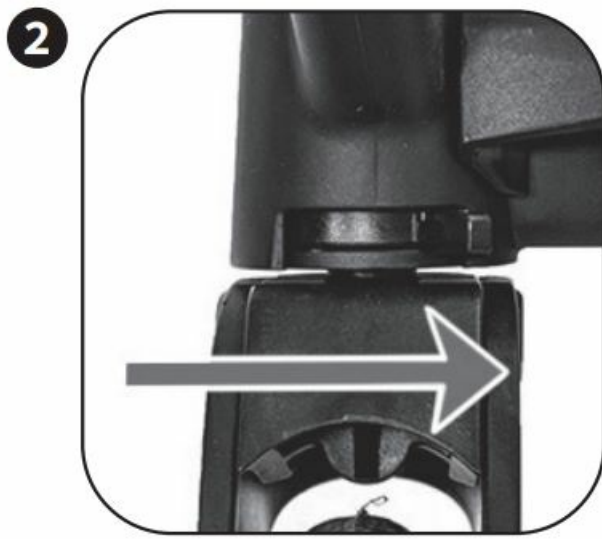

1. Pull the lever located at the rear of the front wheel inwards towards the pram to engage the front wheel lock
2. To release the lock, pull the lever outwards. Note that each wheel will require the lever to be pulled in a different direction – inwards & outwards, and not left or right.

Operating the Seat Recline

1

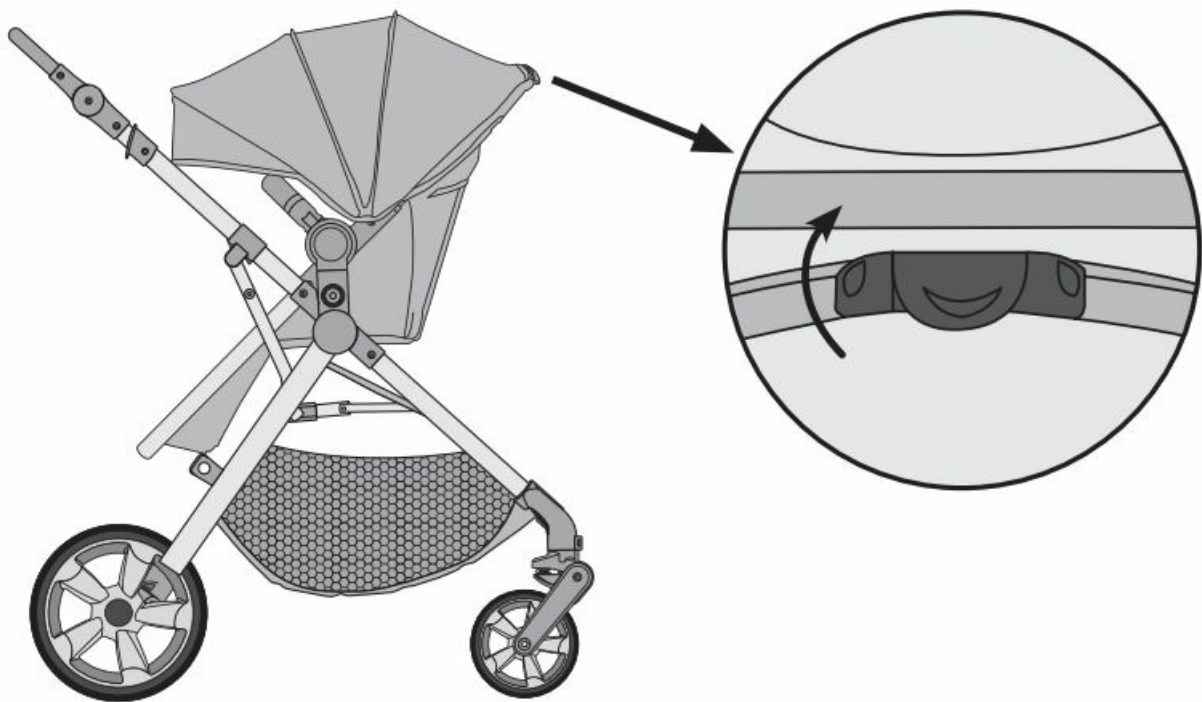

Operating the Seat Recline

1. To recline the seat, lift the handle located at the top of the seat unit.
2. The seat has 3 positions – Fully reclined, mid recline and upright.
3. Please note that the fully upright position should only be used for a child over 6 months old.

NOTE: When using from birth please make sure the pushchair is in the pram mode.

Folding down the Stroller

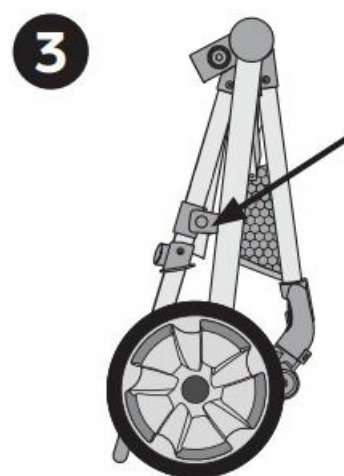
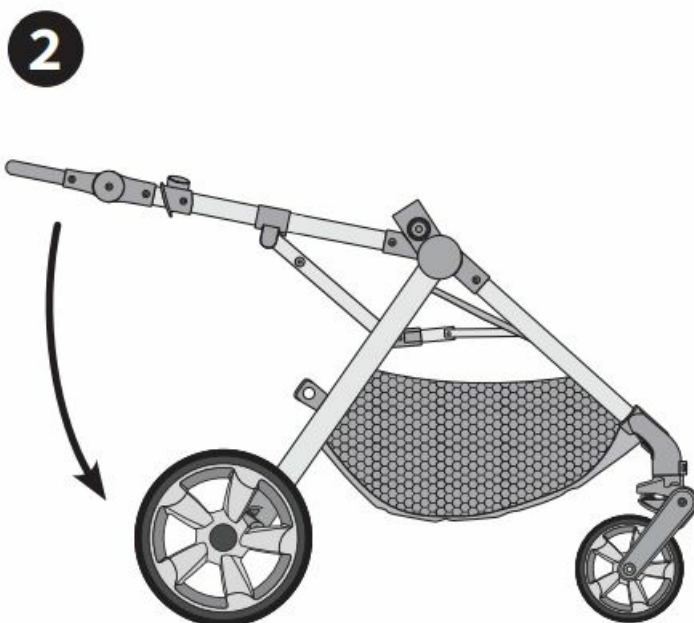
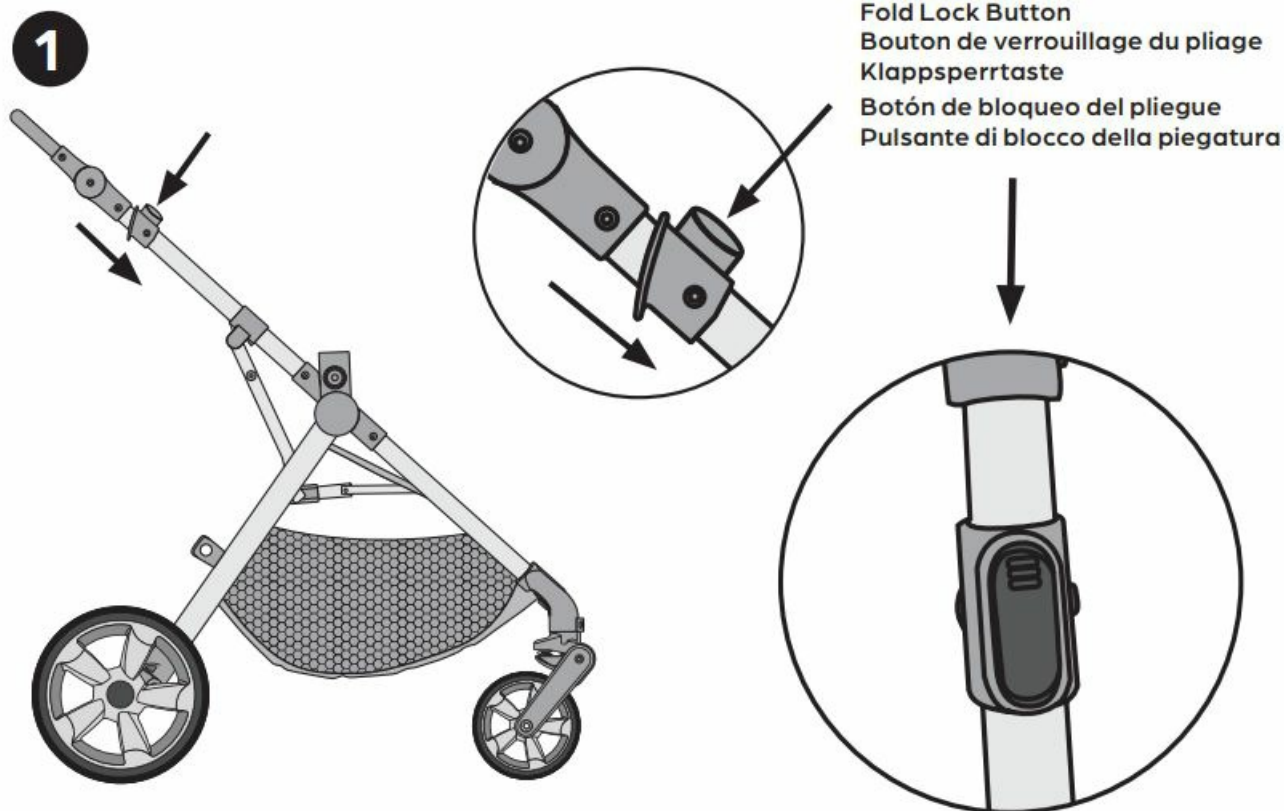

Folding down the Stroller

1. Ensure to remove the pram body/seat unit before folding. Locate the fold levers (on each side of the chassis) and the fold lock button (on the right hand side of the chassis). To fold, press down the fold lock button while pulling the fold levers towards the handle bar.
2. Once the stroller begins to fold, release the folding button and allow to fully fold.
3. Secure the stroller in the folded position by ensuring the latch has fastened.

IMPORTANT SAFETY INFORMATION

IMPORTANT: READ THESE INSTRUCTIONS CAREFULLY BEFORE USE AND KEEP THEM FOR FUTURE

REFERENCE.

Your child's safety may be affected if you do not follow these instructions. Failure to follow these warnings and the instructions could result in serious injury or death. The Comet pushchair in pram mode is suitable for children from birth up to a maximum weight of 9kgs. The Comet seat unit is suitable for children from 6months up to 22kgs or 4 years (whichever comes first).

USING COMET IN PRAM MODE:

WARNINGS

- Never leave the child unattended
- This product is not suitable for running or skating.
- This product is only suitable for a child who cannot sit up unaided, roll over and cannot push itself up on its hands and knees. Maximum weight 9kgs.
- The head of the child in the pram mode should never be lower than the body of the child.
- Do not add an additional mattress to the pram mode.
- This pram mode is not intended to use on its own as a sleeping unit.
- It is manufactured to use with the Comet chassis
- Remove the harness when in pram mode using the instructions in this manual.
- Keep away from fire and other sources of strong heat.

USING COMET IN SEAT MODE:

WARNINGS

- The seat unit is not suitable for children under 6 months.
- Always use the restraint system.
- Use a harness as soon as the child can sit unaided.
- Ensure that all the locking devices are engaged before use and when placing /removing a child.
- Do not let the child play with this product.
- Check the stroller body or seat unit attachment devices are correctly engaged before use.
- To avoid injury ensure that your child is kept away when unfolding and folding this product.
- Always use the crotch strap in combination with the waist belt.
- Do not carry more than one child in this vehicle.
- Do not use if any part of the product is broken, torn or missing.
- Keep away from fire and other sources of strong heat.

WHOLE PRODUCT

WARNINGS

- Ensure your child wears a correctly fitted and adjusted harness at all times.
- Use the parking brake when stationary and when removing or placing the child into the stroller.
- Any additional load attached to the pushchair will affect the stability and safety of the vehicle.
- Do not use a platform with this product as it may render the product unsafe.
- Do not lift the pram body or seat unit using the bumper bar.

- Only use the seat unit, pram body provided with the Comet 2 in 1 Pushchair.
- Do not use replacement parts or accessories other than those approved by Ickle Bubba.
- A basket is provided for the carriage of goods up to a maximum weight of 3kg.
- Store in a safe place away from children.
- To avoid the risk of suffocation, keep all plastic packaging and materials out of reach from children.
- Recommended to be used with the Ickle Bubba Astral or Stratus Car seat. When using a car seat with chassis, please note this does not replace a cot or bed and should your child need to sleep, then it should be placed in a suitable pram body, cot or cot bed.
- Recommended to be used with the Ickle Bubba Astral or Stratus car seat. A basket is provided for the carriage of goods up to a maximum weight of 3kg.
- Store in a safe place away from children.
- To avoid the risk of suffocation, keep all plastic packaging and materials out of reach from children.

THIS BABY STROLLER HAS BEEN APPROVED IN ACCORDANCE TO EN1888-2:2018

CARE AND MAINTENANCE

- Always check the stroller for any wear or damage.
- Storage – Store the stroller in a dry place, do not store in a damp or hot environment. Never leave in sunlight for prolonged periods.
- Chassis – Regularly lubricate all moving parts. Polish metal with a clean dry cloth.
- Wheels – Use a soft brush or cloth.
- Seat Unit/Carry cot outer/Removable Canopy – Sponge clean with warm soapy water. Rinse with clean water to avoid staining. Dry naturally away from direct heat and prolonged sunlight. Do not use strong detergents or bleach.
- Carry cot mattress removable cover/ Apron – Handwash at 30 degrees. Do not tumble dry. Do not iron. Do not use bleach.

Dimensions

- **Open** : L: 91cm H: 109cm D: 60.5cm
- **Closed** : L: 60cm H: 73.5cm D: 60cm

WARRANTY INFORMATION

Please ensure you have registered your product online and keep your proof of purchase for any future claim. If you register within 28 days of receiving the item we will extend your standard warranty to 4 years from the date of purchase at no extra cost. If you have any problem with your Ickle Bubba product when under warranty we offer a 4-step speedy aftercare service within 5 working days. If the item was purchased directly from us, we will pick up the warranty claim directly from you. If the item was purchased through one of our resellers, you will need to contact the reseller to explain the problem. The reseller will then liaise with us on your behalf. We are happy to fulfil our warranty commitments and offer a repair service if needed.

Standard Warranty Terms

- Travel Chassis and seat frames – 2 years

- Wheels – 1 year
- Seat fabrics, carry cot hood, carry cot apron, handle bar cover, bumper bar and accessories – 6 months
- Car seats – 2 years

Please note the warranty applies in the country of purchase only. The warranty applies to the first owner and is non-transferrable.

FREE Extended Warranty Offer

If you register your product with us online within 28 days of receiving the item we are happy to double the warranty period – twice as much peace of mind for FREE!

- This extended warranty does not cover fabrics and wheels, which are covered by the standard warranty only.
- contact@icklebubba.com

Atlantic House, Unit 2, Atlantic Close, Swansea, SA7 9FJ Unit 125, 3 Lombard Street East, Dublin 2, DO2 HC78

- www.icklebubba.com

Documents / Resources

 <p>THE COMET travel system</p> <p>ICKLE BUBBA</p>	<p>ickle bubba 4698 Comet 2 in 1 Pushchair [pdf] Instruction Manual 4698 Comet 2 in 1 Pushchair, 4698, Comet 2 in 1 Pushchair, Pushchair</p>
---------------------------------------------------------------------------------------------------------------------------------------	------------------------------------------------------------------------------------------------------------------------------------------------------------------

References

- [Travel Systems, Pushchairs, Car Seats & Furniture | Ickle Bubba](#)
- [User Manual](#)