



iBUYPOWER Graphics Processing Unit GPU/Graphics Card Installation Guide

[Home](#) » [iBUYPOWER](#) » iBUYPOWER Graphics Processing Unit GPU/Graphics Card Installation Guide 

Contents

- [1 iBUYPOWER Graphics Processing Unit GPU/Graphics Card](#)
- [2 Install your Graphics Processing Unit GPU/Graphics Card\)](#)
- [3 Documents / Resources](#)
- [4 Related Posts](#)



iBUYPOWER Graphics Processing Unit GPU/Graphics Card



Install your Graphics Processing Unit GPU/Graphics Card)

1. Open side panel

Make sure your PC is turned off and not plugged in. Open the side panel.

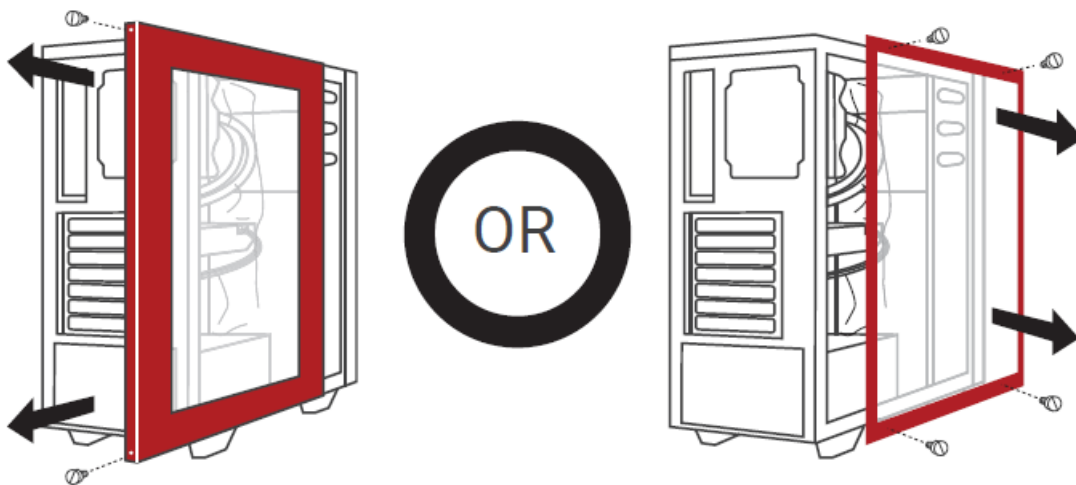

2. Remove screws

Remove the screws on the rear of the case that will be holding the graphics card in place. You may have to remove either the first, second, or third screw on the back, depending on your motherboard.

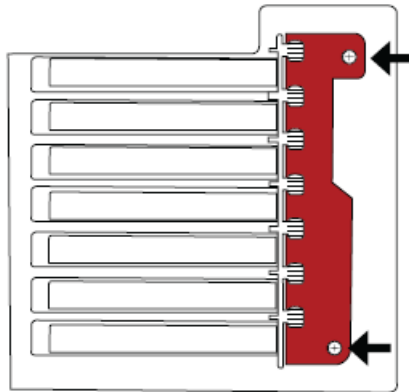
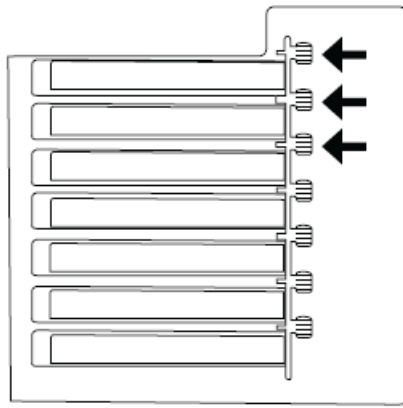

3. Prepare to slot the GPU

Line the graphics card up with the PCI-e slot on the motherboard, as shown in the image below.

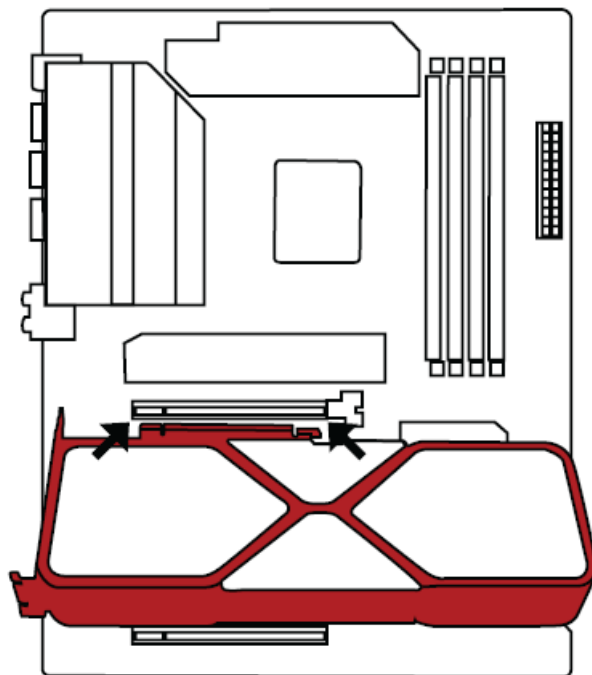

4. Insert the GPU in the PCI-e Slot

Insert the graphics card into the PCI-e slot by pressing firmly until you hear or feel the latch click.

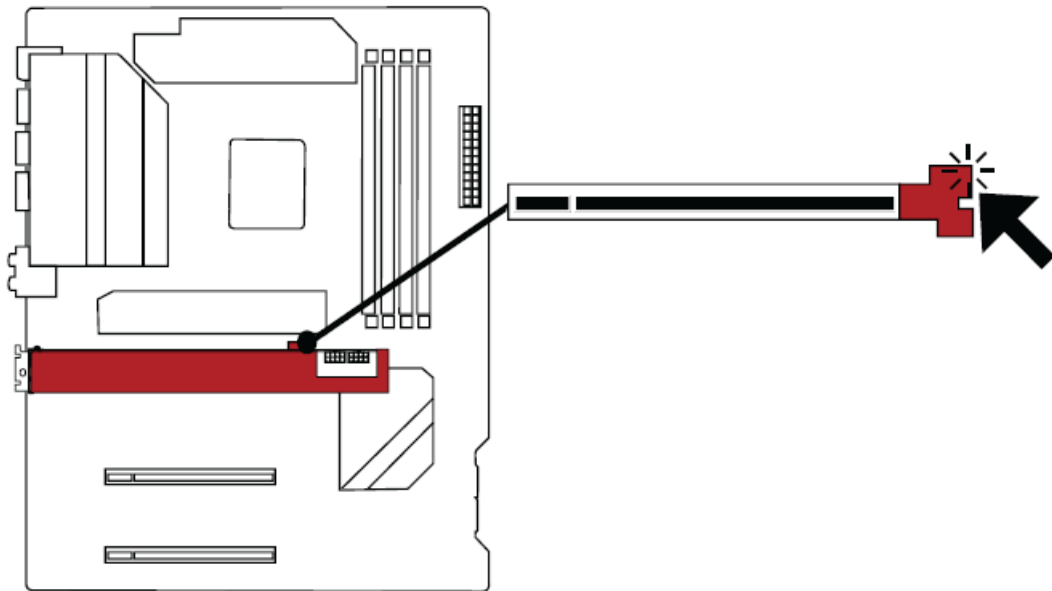

5. Secure the Retention Bracket

Use the screws from earlier to secure the metal retention bracket of the graphics card land PCI screw cover if applicable).

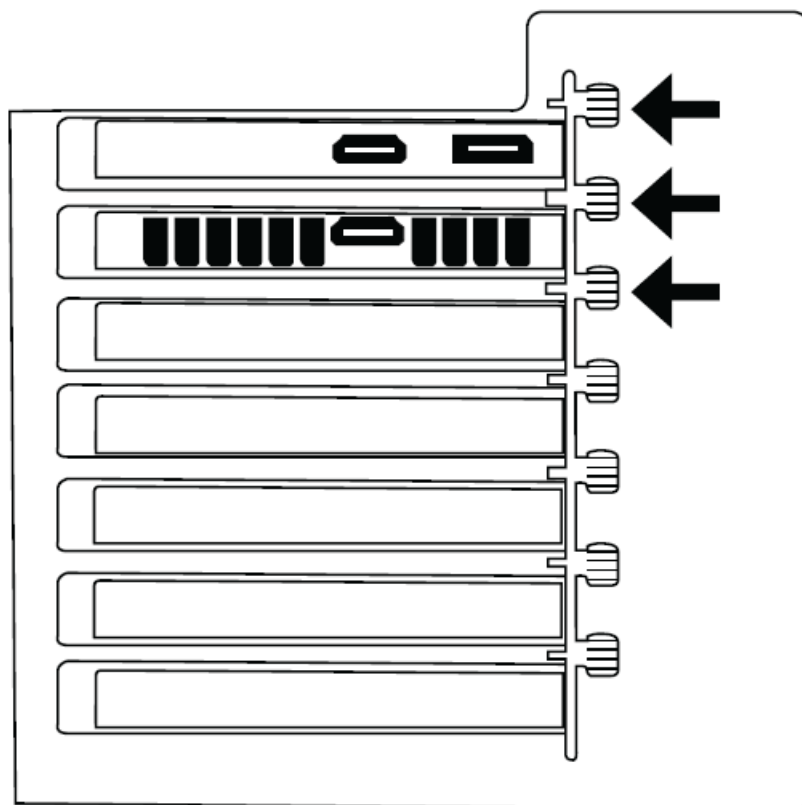

6. Connect cables to graphics card

Locate and connect the power cables). It is possible that the power supply will have extra cables; that is okay as long as ALL the connectors on the graphics card are plugged in.

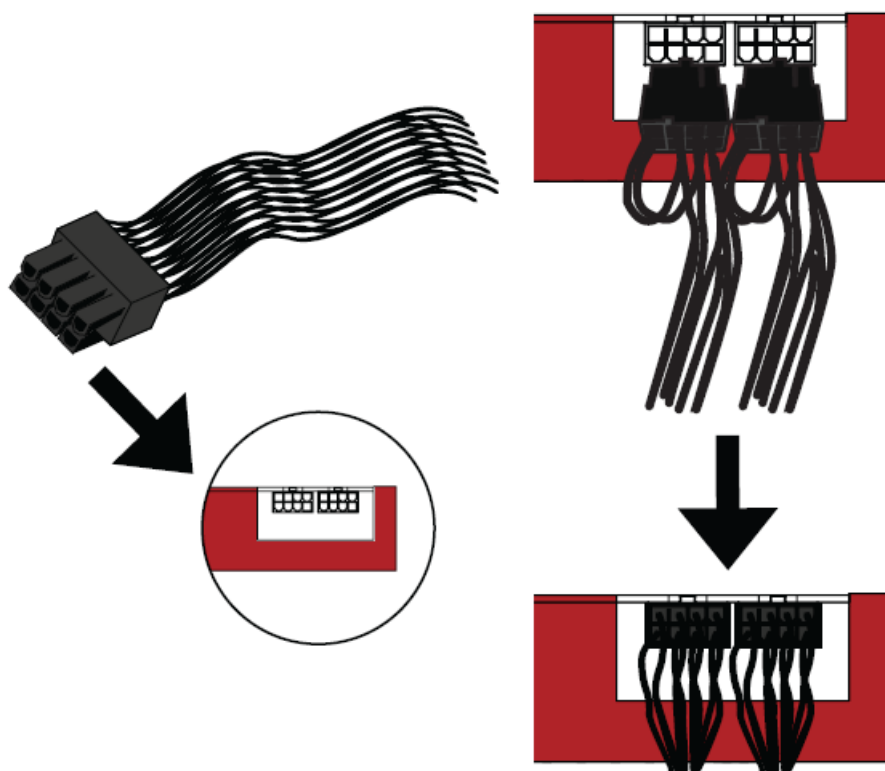

7. Reinstall side panel and continue PC setup

Put the side panel back on, you are finished. You may follow the rest of the main quick start guide to complete setting up your new PC.

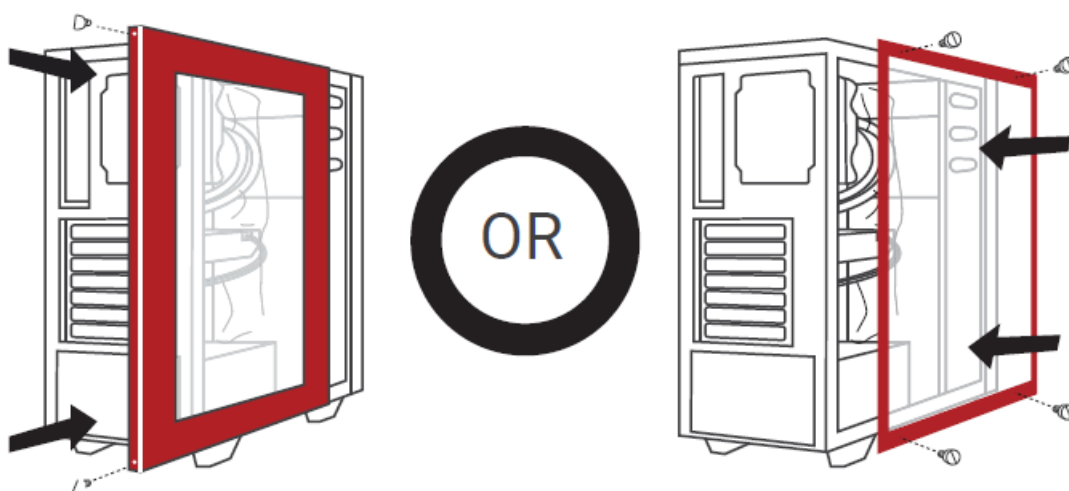

Documents / Resources



How to Install and
Configure iBUYPOWER GPU

1. Check the GPU
Make sure the GPU is compatible with your system.

2. Prepare the GPU
Remove the GPU from its packaging and check the components.

3. Install the GPU
Insert the GPU into the PCIe slot on the motherboard.

4. Connect the GPU
Connect the GPU to the power supply and the monitor.

iBUYPOWER Graphics Processing Unit GPU/Graphics Card [pdf] Installation Guide

Graphics Processing Unit GPU Graphics Card, Graphics Processing Unit, GPU, Graphics Card