

iBoard IB-P177C Black Running Boards Style

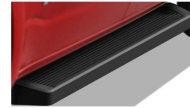

# iBoard IB-P177C Black Running Boards Style Installation Guide

[Home](#) » [iBoard](#) » iBoard IB-P177C Black Running Boards Style Installation Guide 

## Contents

- 1 iBoard IB-P177C Black Running Boards Style
- 2 Hardware Package A (For Bracket Installation)
- 3 Hardware Package B (For Step Bar Installation)
- 4 Documents / Resources
  - 4.1 References
- 5 Related Posts

# iBoard®

## iBoard IB-P177C Black Running Boards Style



### Scan for Installation Video

READ INSTRUCTIONS CAREFULLY BEFORE START ING INSTALLATION. REMOVE CONTENTS FROM BOX AND VERIFY ALL PARTS ARE PRESENT. ASSISTANCE IS RECOMMENDED.



- ROCKER PANEL MOUNT
- DRILLING IS REQUIRED

Fastener Size	Tightening Torque (ft-lbs)	Required
6mm	6-7	X
8mm	16-18	√
10mm	31-32	√
12mm	56-58	X
14mm	92-94	X

#### PART LIST

Driver Side Step Bar

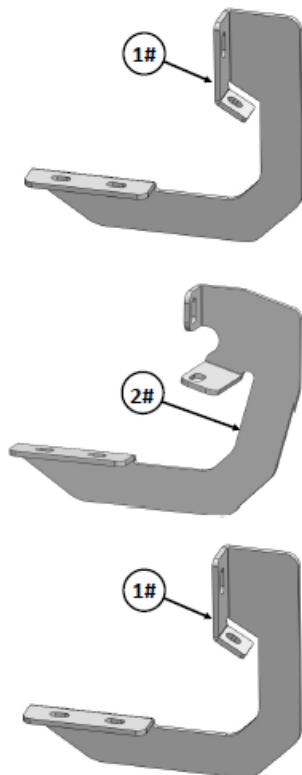
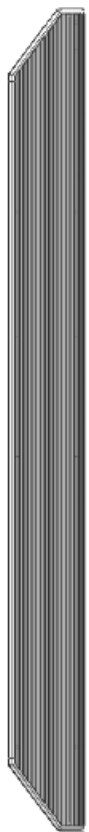

Front



Passenger Side Step Bar

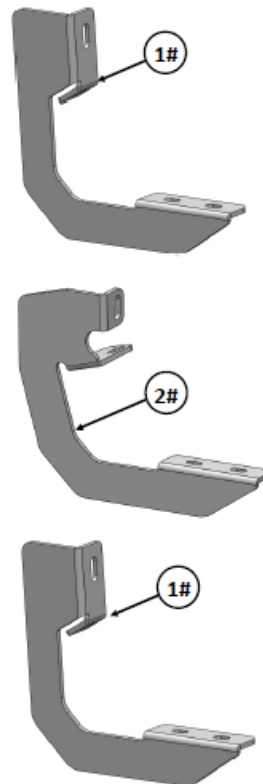

**Hardware Package A (For Bracket Installation)**

Item	QTY	Description	Item	QTY	Description
1#	4	Driver/Passenger Front/Rear Mounting Brackets	5#	12	M8 Lock Washers
2#	2	Driver/Passenger Center Mounting Brackets	6#	6	M8 Hex Nuts
3#	12	M8X1.25-25mm Hex Bolts	7#	6	M8 Clip Nuts
4#	18	M8 Large Flat Washers			



**Hardware Package B (For Step Bar Installation)**

Item	QTY	Description	Item	QTY	Description
1#	12	M8X1.25-35mm Carriage Bolts	3#	12	M8 Nylon Lock Nuts
2#	12	M8 Large Flat Washers	4#	6	Sliders (Packed with Mounting Brackets)



**STEP 1**

Starting on the passenger side of the vehicle. Locate mounting locations as shown, (Fig 1).

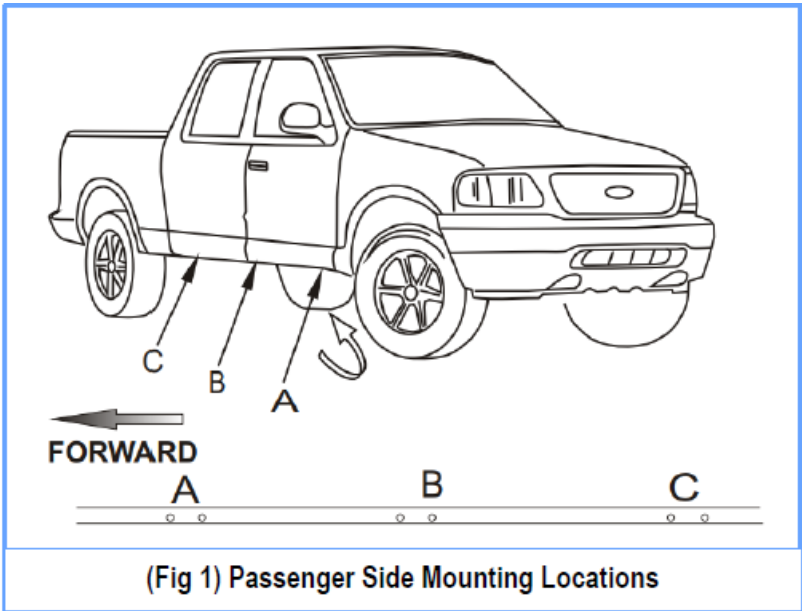

## STEP 2

Starting on the passenger side front of the vehicle. Select (1) M8 Clip Nut, install the M8 Clip Nut as shown, (Fig 2).

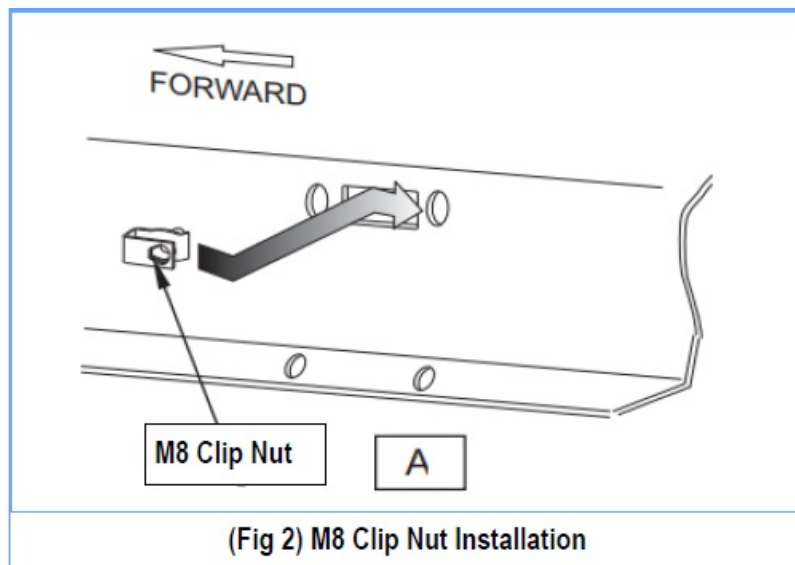

## STEP 3

Attach the Passenger Front Mounting Bracket to the installed M8 Clip Nut with (1) M8X1.25-25mm Hex Bolt, (1) M8 Lock Washer and (1) M8 Large Flat Washer; to rocker panel with (1) M8X1.25-25mm Hex Bolt, (2) M8 Large Flat Washers, (1) M8 Lock Washer and (1) M8 Hex Nut, (Fig 3). Do not fully tighten hardware at this time.

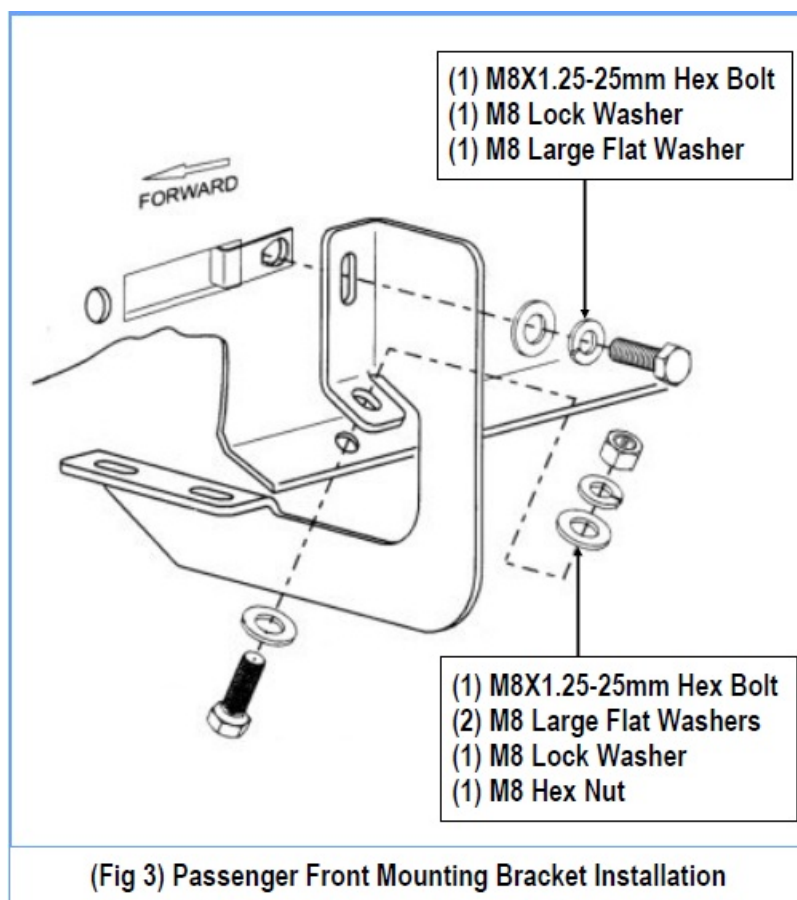

## STEP 4

Move to the passenger side center of the vehicle, repeat Steps 1-2 for Passenger Center Mounting Bracket installation, (Figs 4 -5). Do not fully tighten hardware at this time.

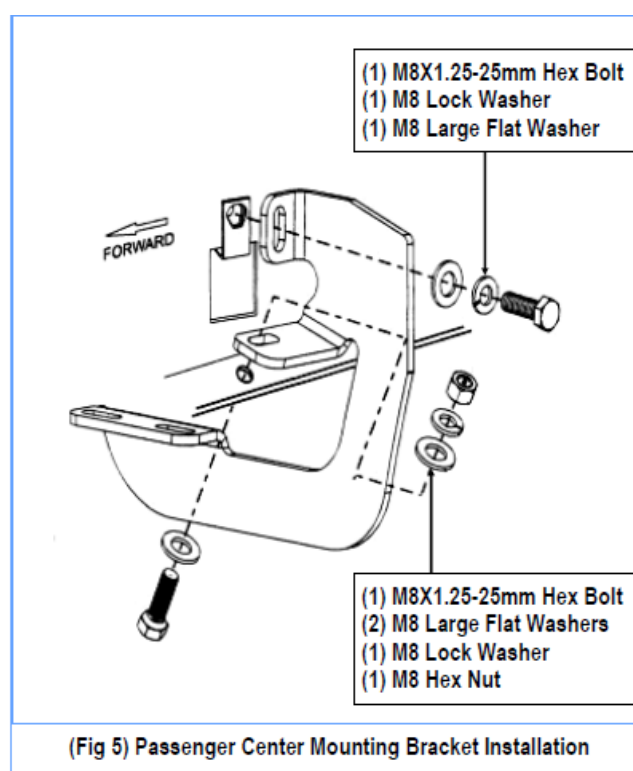
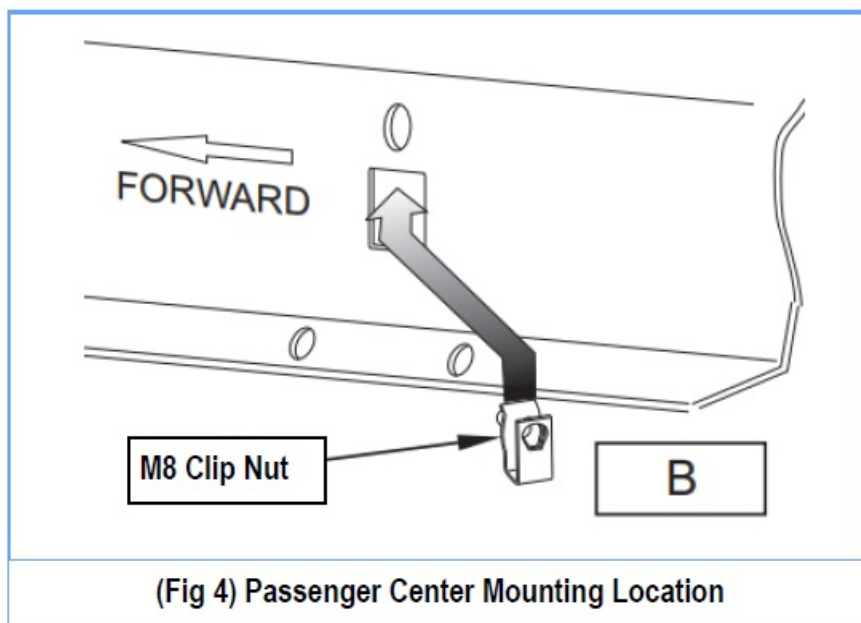

## STEP 5

Move to the passenger side rear of the vehicle, repeat Steps 2-3 to install Passenger Rear Mounting Bracket. (Fig 6)

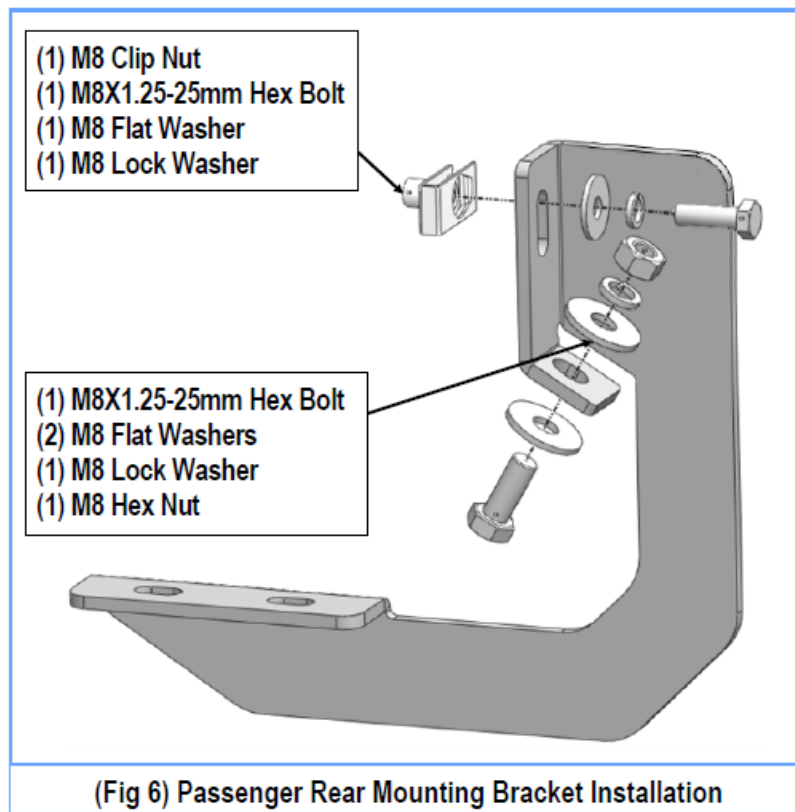

## STEP 6

Once all (3) Passenger side mounting brackets are installed, then proceed to the Step Bar installation. (Figs 7 & 8)

1. Select (1) Slider and (2) M8X1.25-35mm Carriage Bolts;
2. Install (2) M8X1.25-35mm Carriage Bolts in (1) Slider.
3. Slide the Slider (with carriage bolts) to the Step Bar.
4. Repeat to install the other (2) sliders to the step bar.
5. Attach the Step Bar (with the Sliders) onto the installed mounting brackets. Position the Sliders to the installed brackets. Secure the Step Bar to the installed Brackets by using (6) M8 Large Flat Washers and (6) M8 Nylon Lock Nuts and (3) Sliders, (Fig 8). Do not fully tighten hardware at this time.

**Note:** The Sliders are packed with the Mounting Brackets.

Level and adjust the Step Bar and fully tighten all hardware. Repeat Steps 1-6 for the other side Step Bar installation. The installation is completed!!!

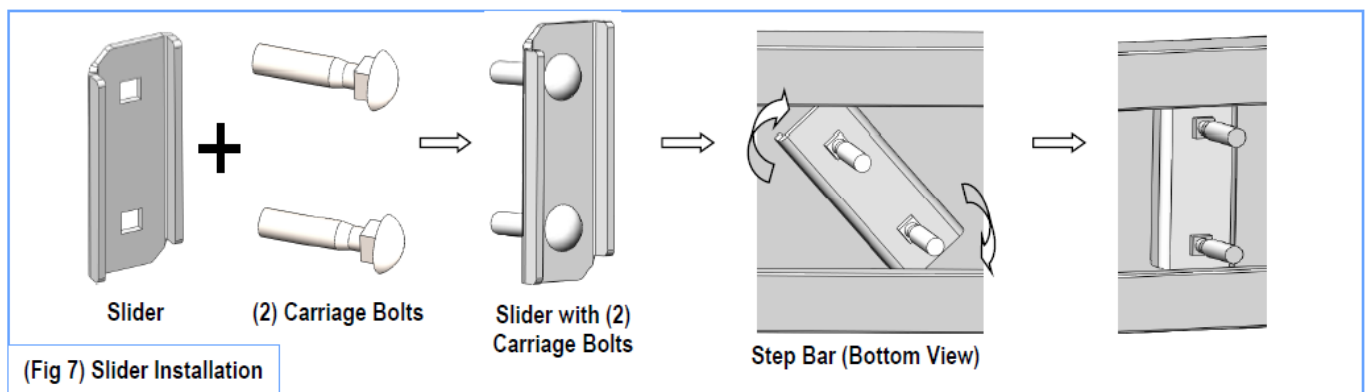

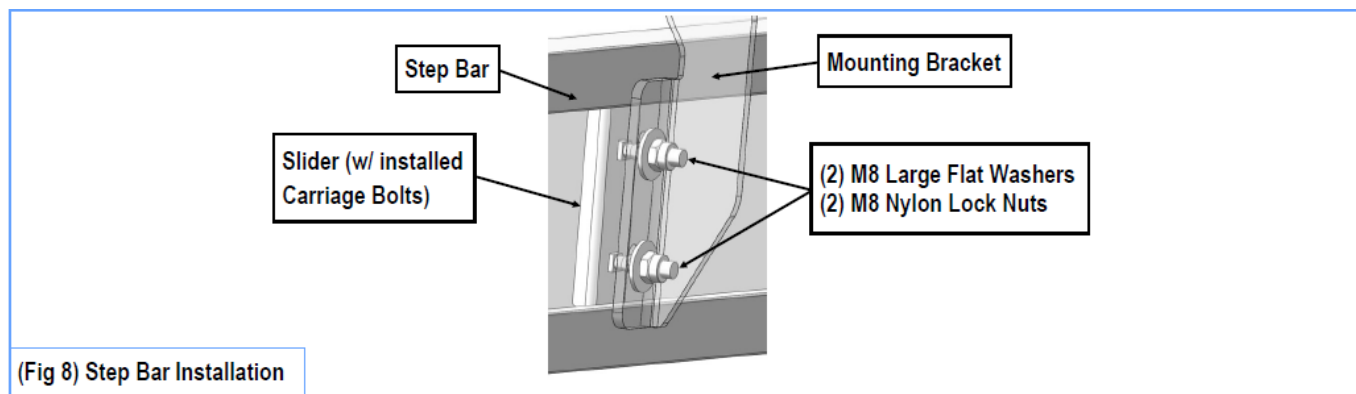

### Attention

Do periodic inspections to the installation to make sure that all hardware is secure and tight. In order to protect your bars/boards, please use mild soap/non-abrasive products for cleaning only.

**Customer Support:** [info@iboardauto.com](mailto:info@iboardauto.com)

## Documents / Resources

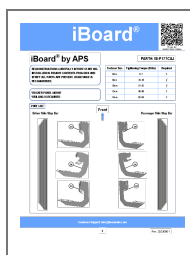

[iBoard IB-P177C Black Running Boards Style \[pdf\] Installation Guide](#)  
IB-P177C, IB-P177J, IB-P177C Black Running Boards Style, IB-P177C, Black Running Boards Style, Running Boards Style, Boards Style

## References

- [User Manual](#)

[Manuals+](#), [Privacy Policy](#)

This website is an independent publication and is neither affiliated with nor endorsed by any of the trademark owners. The "Bluetooth®" word mark and logos are registered trademarks owned by Bluetooth SIG, Inc. The "Wi-Fi®" word mark and logos are registered trademarks owned by the Wi-Fi Alliance. Any use of these marks on this website does not imply any affiliation with or endorsement.