

**iArmor®**  
**IA-W093**  
**Running**  
**Board**



## iArmor IA-W093 Running Board Installation Guide

[Home](#) » [iArmor](#) » iArmor IA-W093 Running Board Installation Guide 

### Contents

- [1 armor IA-W093 Running Board](#)
- [2 Specifications](#)
- [3 Product Usage Instructions:](#)
- [4 PARTS](#)
- [5 INSTALLATION INSTRUCTION](#)
- [6 FAQs](#)
- [7 Documents / Resources](#)
  - [7.1 References](#)

**iArmor®**

**armor IA-W093 Running Board**

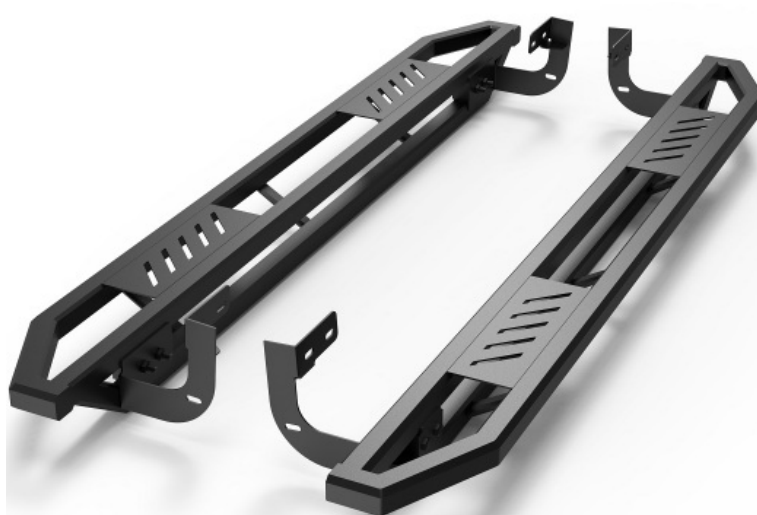

### Specifications

- **Product Name:** IARMOR EDGE
- **Installation Type:** Rocker Panel Mount
- **Drilling/Trimming:** Not Required

**Product Usage Instructions:**

- **Step 1:**  
Start installation from the driver-side front of the vehicle. Assemble the Driver Front Mounting Bracket (DFM) and Driver Front Bar Bracket (DFB) with appropriate hardware. Do not tighten the hardware at this time.
- **Step 2:**  
Select a Backing Plate and put it behind the frame. Attach the Driver Front Mounting Bracket (DFM) on the other side of the frame with the provided hardware. Do not fully tighten the hardware at this time.
- **Step 3:**  
Move to the Driver Side Rear Mounting Location. Assemble the Driver Rear Mounting Bracket (DRM) and Driver Rear Bar Bracket (DRB) with the provided hardware. Do not tighten the hardware at this time.
- **Step 4:**  
Repeat Step 2 to install the Assembled Driver Rear Mounting Bracket. Do not fully tighten the hardware at this time. Place a Backing Plate behind the frame to attach the mounting bracket.
- **BEFORE INSTALLATION**  
REMOVE CONTENTS FROM THE BOX. VERIFY ALL PARTS ARE PRESENT. READ INSTRUCTIONS CAREFULLY BEFORE STARTING INSTALLATION. ASSISTANCE IS RECOMMENDED. THANK YOU FOR CHOOSING OUR PRODUCT!
  - **ROCKER PANEL MOUNT**
  - **DRILLING/TRIMMING NOT REQUIRED**

**Torque Value**

Fastener Size	Tightening Torque (ft-lbs)	Required
6mm	6-7	X
8mm	16-18	X
10mm	31-32	√
12mm	56-58	√
14mm	92-94	X

**PARTS**

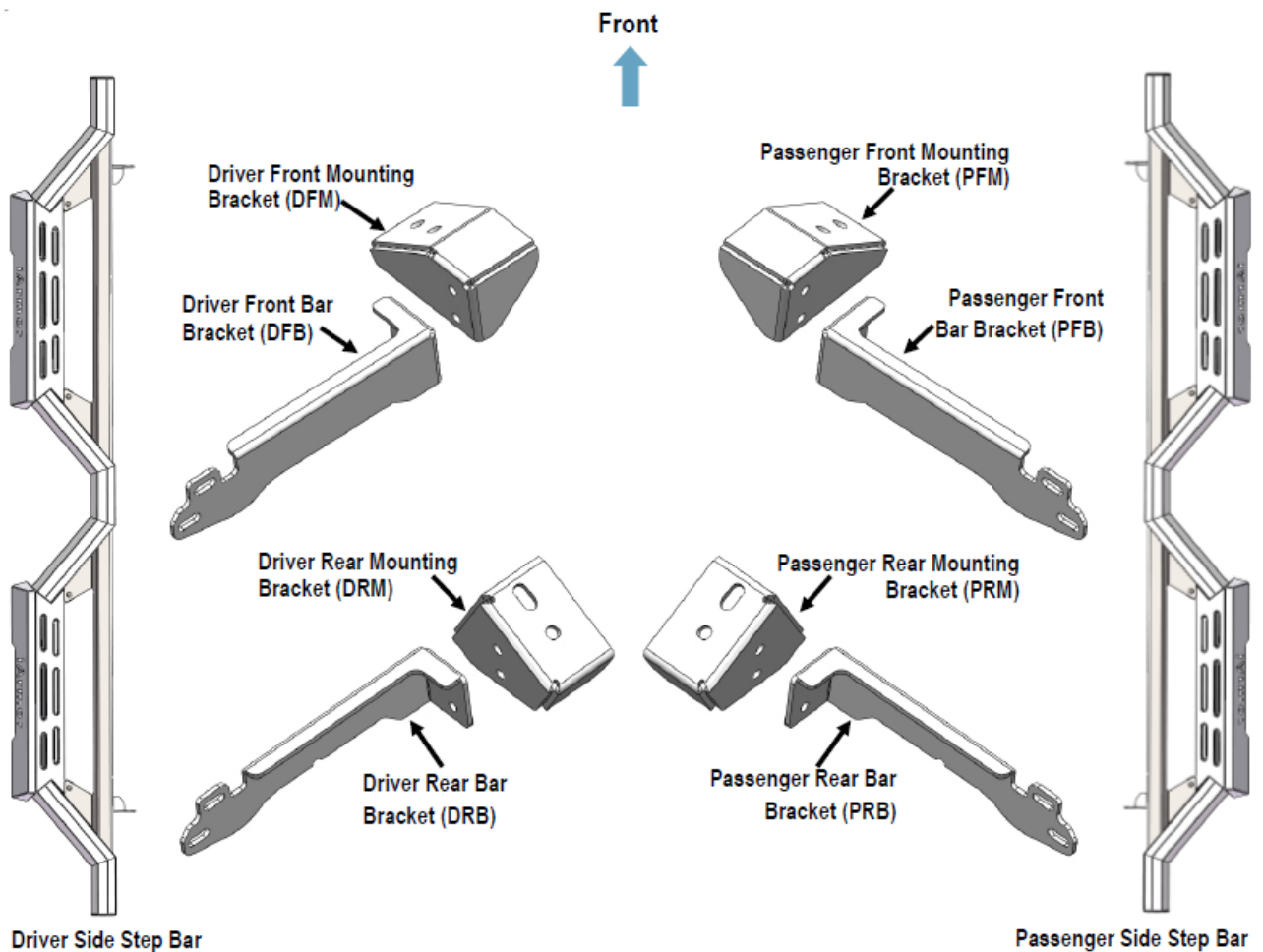

#### Hardware Package (For Brackets & Step Bars Installation)

Item	QTY	Description	Item	QTY	Description
1#	4	Backing Plates	7#	8	M10 Lock Washers
2#	8	M12X1.75-30 Hex Bolts	8#	8	M10 Hex Nuts
3#	8	M12 Large Flat Washers	9#	8	M10X1.5-25 Hex Bolts
4#	8	M12 Lock Washers	10#	16	M10 Flat Washers
5#	8	M10X1.5-30 Hex Bolts	11#	8	M10X1.5 Nylon Lock Nuts
6#	16	M10 Large Flat Washers			



## INSTALLATION INSTRUCTION

The instructions here are for your reference only. We strongly recommend the professional installer for the best result. We are not responsible for any damage caused by the installation.

### STEP 1

Start installation from the driver-side front of the vehicle. As-semble the Driver Front Mounting Bracket (DFM) and Driver Front Bar Bracket (DFB) with (2) M10X1.5-30mm Hex Bolts, (4) M10 Large Flat Washers, (2) M10 Lock Washers and (2) M10 Hex Nuts, (Fig 1). Do not tighten the hardware at this time. (Fig 1) Driver Side Front Brackets Assembly

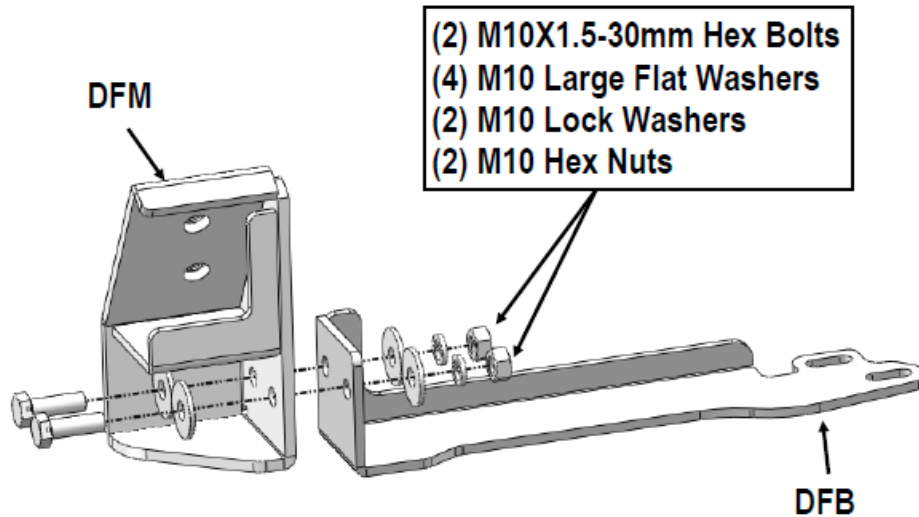

### STEP 2

Select (1) Backing Plate and put it behind the frame, line up the holes, attach (1) Driver Front Mounting Bracket (DFM) on the other side of the frame with (2) M12X1.75-30 Hex Bolts, (2) M12 Lock Washers and (2) M12 Large Flat Washers. Do not fully tighten hardware at this time, (Figs 2&3). (Fig 2) Example of Driver Front Mounting Bracket Installed

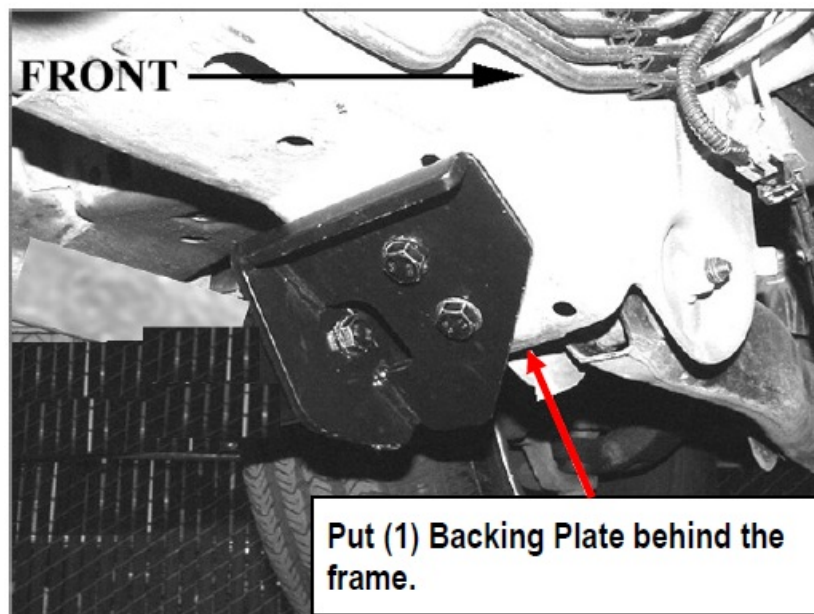

(Fig 3) Assembled Driver Front Mounting Bracket Installation

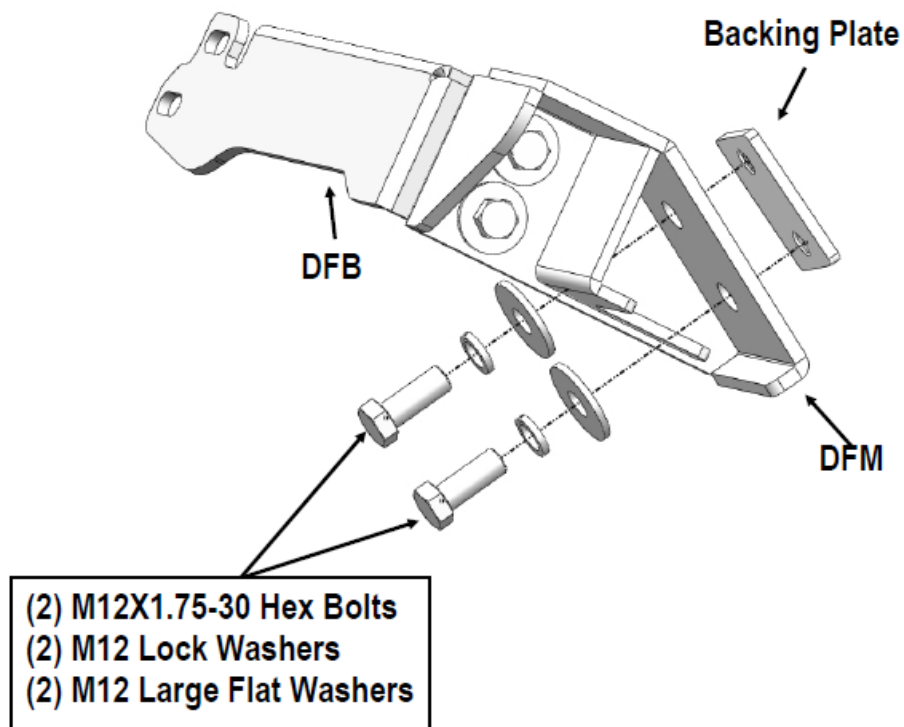

### STEP 3

Move to the Driver Side Rear Mounting Location. Assemble the Driver Rear Mounting Bracket (DRM) and Driver Rear Bar Bracket (DRB) with ((2) M10X1.5-30mm Hex Bolts, (4) M10 Large Flat Washers, (2) M10 Lock Washers and (2) M10 Hex Nuts, (Fig 4). Do not tighten the hardware at this time. Driver Rear Mounting Brackets Assembly.

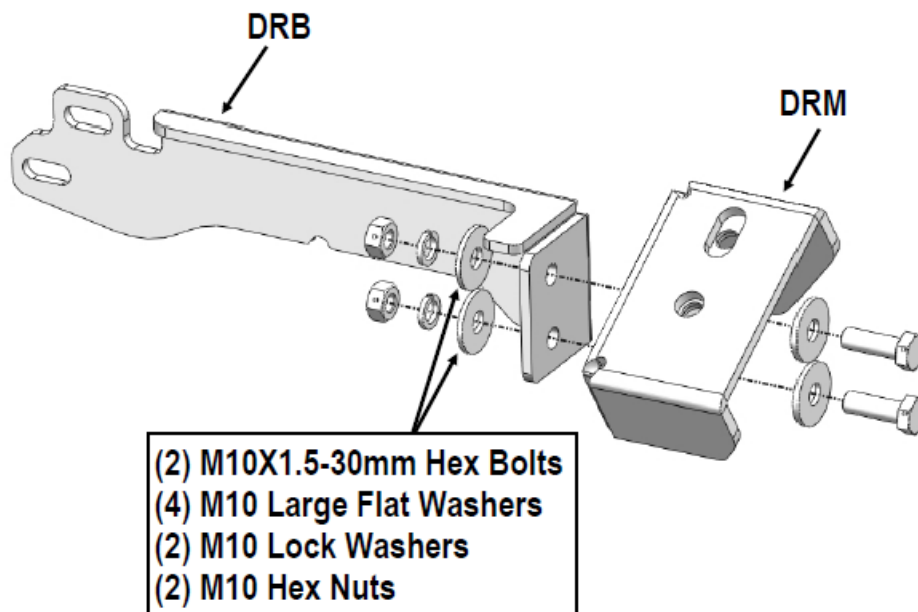

### STEP 4

Repeat Step 2 to install the Assembled Driver Rear Mounting Bracket. Do not fully tighten hardware at this time, (Figs 5-6). (Fig 5) Example of Assembled Driver Rear Mounting Bracket Installed

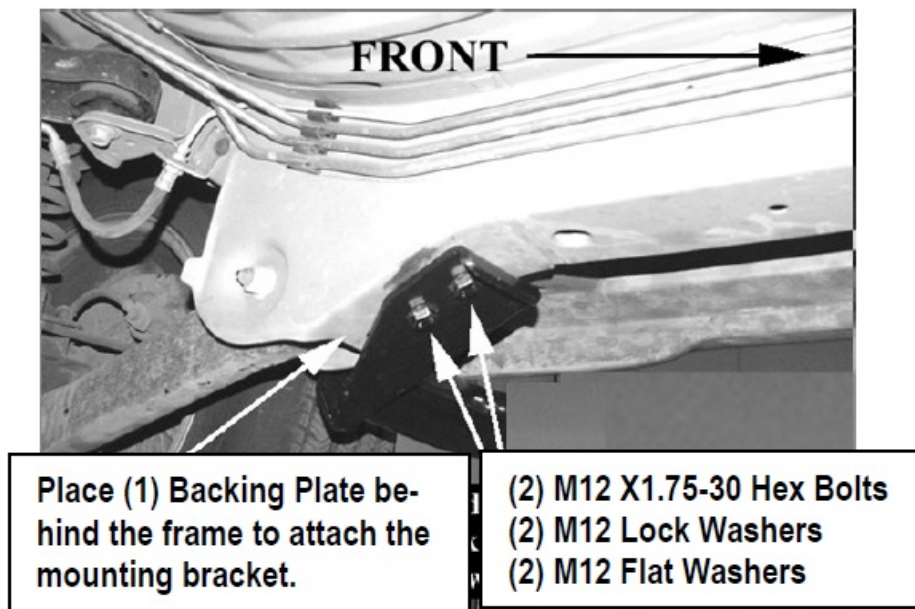

(Fig 6) Driver Rear Mounting Bracket Installation

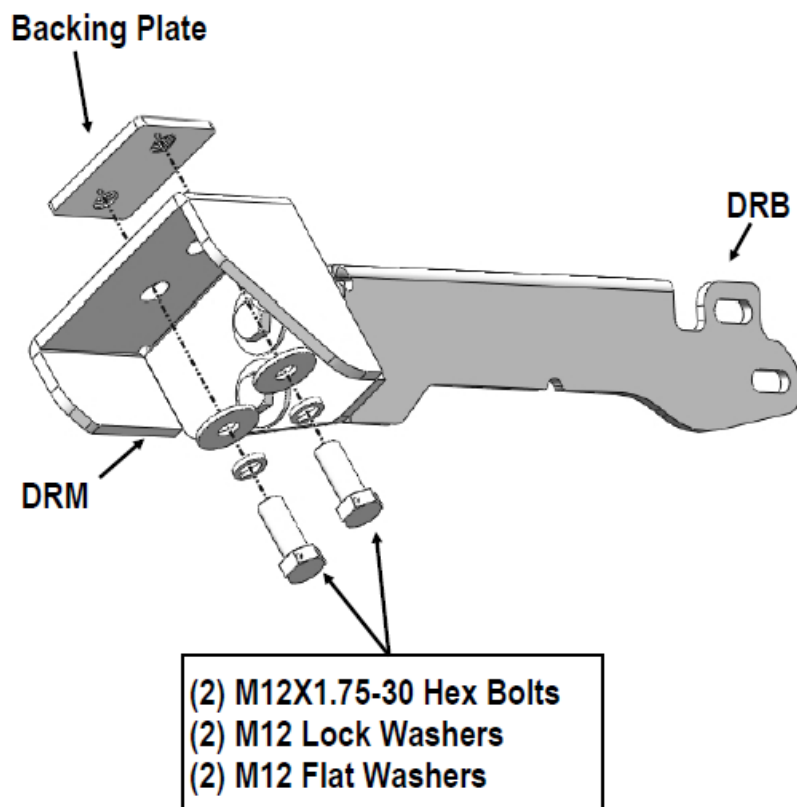

#### STEP 5

Once all (2) Mounting Brackets have been installed, attach the Driver Side Step Bar to the Mounting Brackets with (4) M10X1.5-25 Hex Bolts, (8) M10 Flat Washers, and (4) M10X1.5 Nylon Lock Nuts, (Fig 7). Do not fully tighten the hardware at this time.

#### STEP 6

Properly level and adjust the Step Bar and fully tighten all hardware.

#### STEP 7

Move to the other side of the vehicle. Repeat Steps 1-6 for the other Side Step Bar installation.

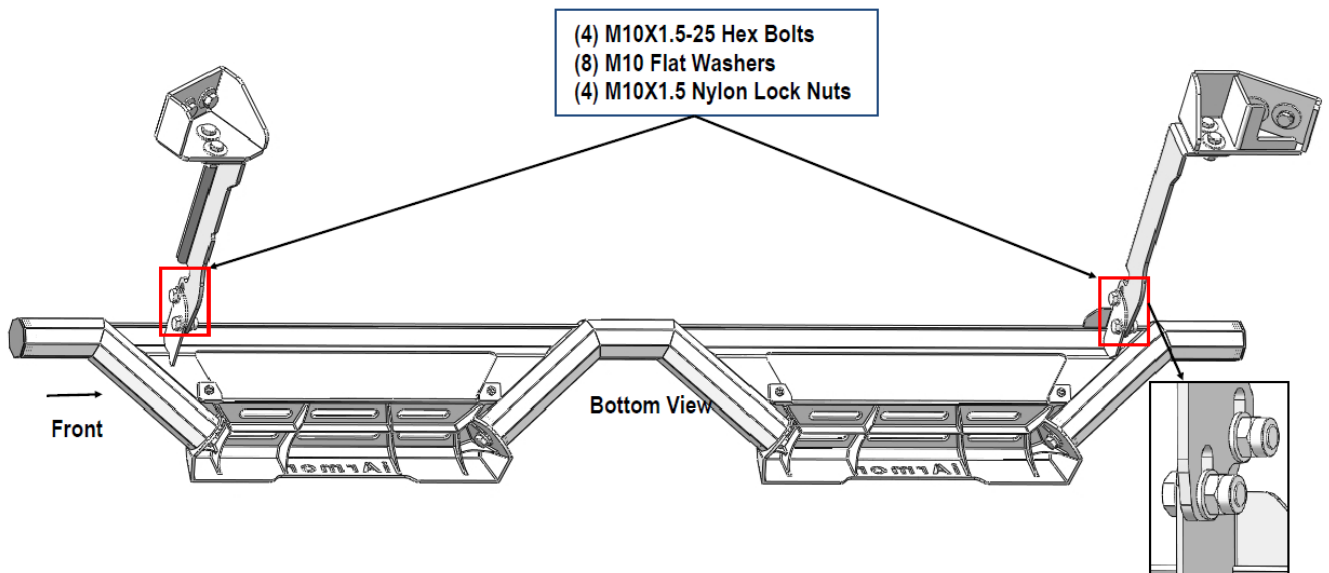

### Attention

- Do periodic inspections to the installation to make sure that all hardware is secure and tight.
- To protect your bars/boards, please use mild soap/non-abrasive products for cleaning only.
- **Customer Support:** [info@iarmorauto.com](mailto:info@iarmorauto.com)

### FAQS

• **Q: Is professional installation recommended?**

A: Yes, we strongly recommend professional installation for the best results. We are not responsible for any damage caused by incorrect installation.

• **Q: What should I do if any parts are missing from the box?**

A: Before starting the installation, verify that all parts listed in the manual are present. If any parts are missing, please contact our customer support at [info@iarmorauto.com](mailto:info@iarmorauto.com)

### Documents / Resources

	<p><a href="#">iArmor IA-W093 Running Board</a> [pdf] Installation Guide IA-W093 Running Board, IA-W093, Running Board, Board</p>
--	---

### References

- [User Manual](#)

[Manuals+](#), [Privacy Policy](#)

This website is an independent publication and is neither affiliated with nor endorsed by any of the trademark owners. The "Bluetooth®" word mark and logos are registered trademarks owned by Bluetooth SIG, Inc. The "Wi-Fi®" word mark and logos are registered trademarks owned by the Wi-Fi Alliance. Any use of these marks on this website does not imply any affiliation with or endorsement.