



## i-box A75 YX76 Portable Party Speaker with Microphone Instruction Manual

[Home](#) » [i-box](#) » i-box A75 YX76 Portable Party Speaker with Microphone Instruction Manual 

### i-box A75 YX76 Portable Party Speaker with Microphone Instruction Manual



Important – Please read these instructions fully before installing or operating your Speaker.  
Keep away from flame sources such as lighted candles.

The unit should not be exposed to direct sunlight, very high or low temperature, moisture, vibrations, strong magnetic fields, high frequencies and dusty environments

Never attempt to insert wires, pins or other such objects into the vents or openings of the unit.





Do not disassemble or modify the speaker, there are no user serviceable parts.

If the speaker is damaged in anyway or malfunctions do not use. Consult a qualified service engineer.

Do not use abrasives, thinner or other solvents to clean the surface of the unit. To clean, wipe with a clean soft cloth and a mild detergent solution.

This product contains a built-in Li-ion battery. It must be used and charged properly to avoid risk of fire or injury. Disconnect from power when charging is complete. Take care to keep the product and its battery cool, especially during charging.

Do not dispose of this product with household waste at the end of its life cycle; take it to a designated collection centre for the recycling of electrical and electronic appliances with batteries. Please check with your Local

Authority for recycling advice.    

## Box Contents

1. i-box Party speaker

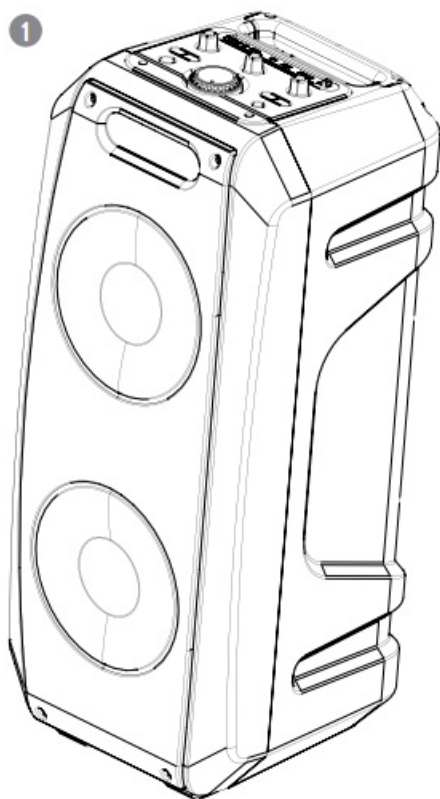

2. AUX cable

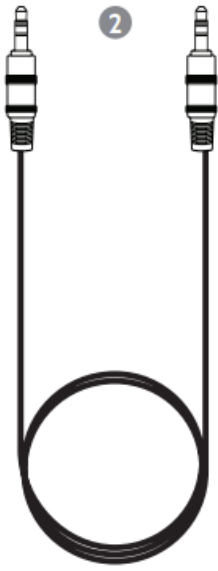

### 3. Wired Microphone

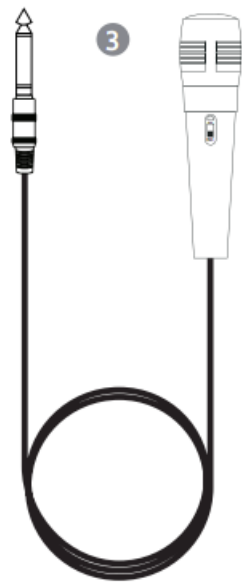

### 4. AC Adaptor



### 5. User Manual



## Getting to know your speaker system

Before you get started please be sure to read through the safety information on pages 4.

### Top Panel

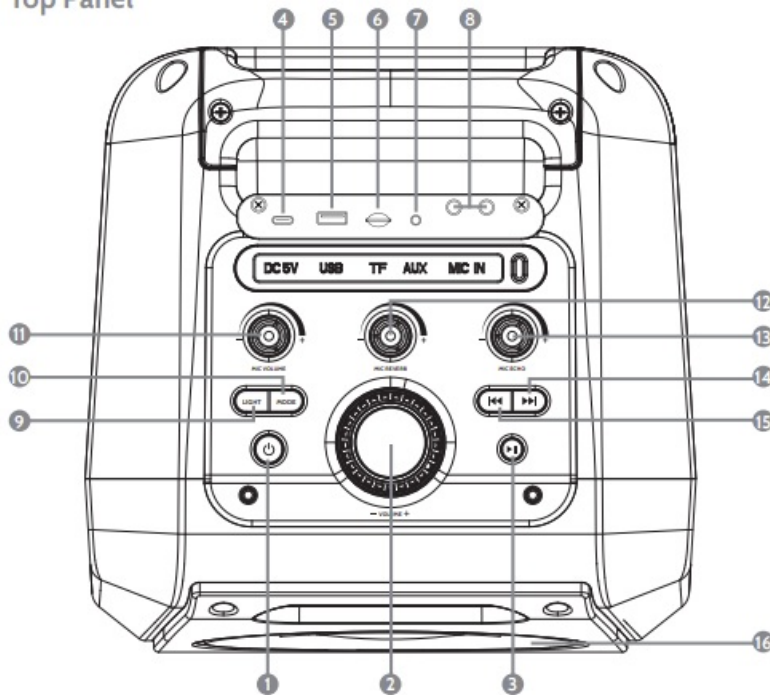

### Controls & Features

1. On/Off Key
2. Volume Dial
3. Play/Pause Key
4. Power Input Socket
5. USB port
6. TF/SD Card Slot
7. AUX In Port
8. Microphone In Socket
9. Light Key
10. Mode Key
11. Microphone Volume Dial
12. Microphone Reverb Dial
13. Microphone Echo Dial
14. Right/Next Key
15. Left/Previous Key

## 16. Speaker

### Powering and Charging your Party Speaker

Your i-box Party speaker has a 7.4W 4400mAh built-in, non user-replaceable, Lithium battery. For best results, the first time you use the Party, let it charge for 4-5 hours until fully charged using the AC adaptor cable supplied.

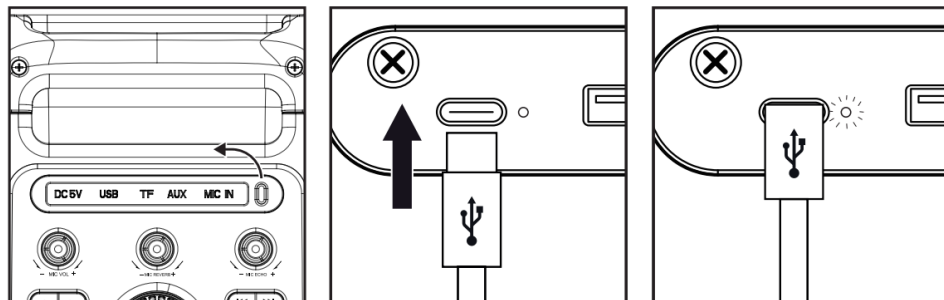

### Standby / ON/OFF

Short press the On/Off key to turn on, long press to turn off.



### Wireless Connection Mode

Press the Mode key (10) to enter into Wireless connection mode. The speaker will emit an audible tone indicating the speaker is in wireless mode and the display will show 'bt'.

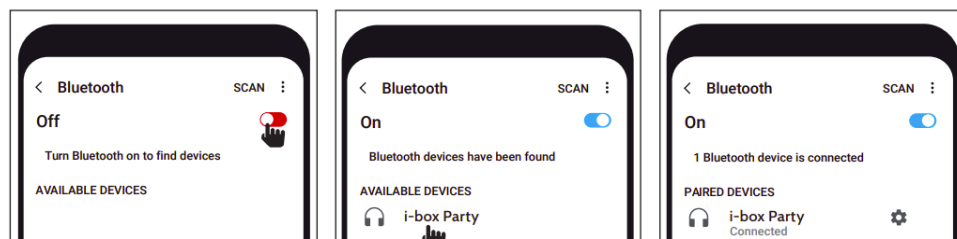
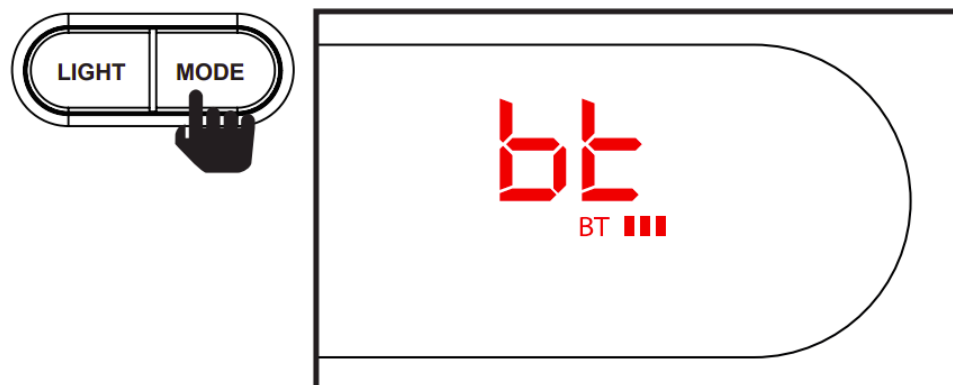

### Help



## Wireless Playback

Rotate the Volume control (13) clockwise to increase volume, rotate anti-clockwise to decrease the volume.

Use the / keys (14/15) to change the song playing or use the connected device. Press the Play / Pause (14) key to play or pause the playing song or use the connected device.



To disconnect the currently connected device press and hold the key. To unpair, you need to select i-box Party in your device's menu and select unpair.

## USB Mode

When a compatible USB stick is inserted into the USB port (5) the speaker will automatically enter into USB playback mode. The speaker will emit a tone indicating the speaker is in USB playback mode and the display will show 'USB'

**Note:** if there is a lot of media on your USB it may take a minute or so to load.

Short press the key to skip forward to the next track.

Short press the key to go back to the previous track.

Short press the Play / Pause (14) key to play or pause the playing song.

The Party speaker will remember that last song you played for your USB stick so you can continue from where

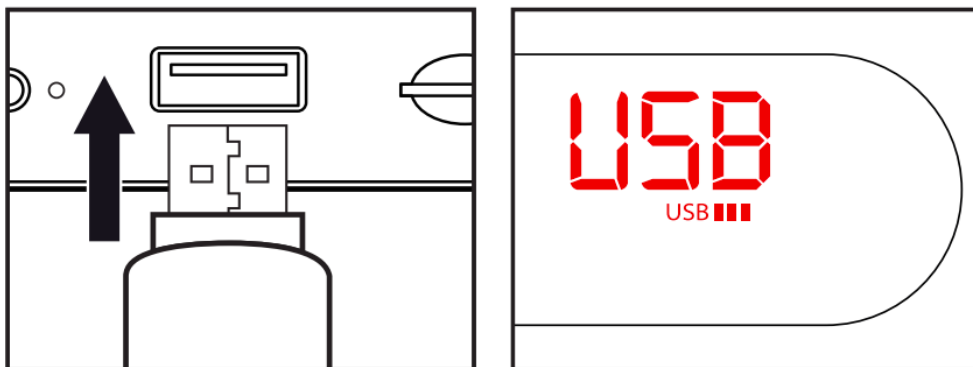

## AUX In Mode

When the 3.5mm audio jack (supplied) is inserted into the AUX In port (7) and the other end is inserted into a compatible A X device the speaker will automatically enter into AUX In mode. The speaker will emit a tone indicating the speaker is in AUX In mode and the display will show 'AUX'

Adjust the volume using a combination of the Party volume control and the source device volume control. For all other playback options use the controls on the source device

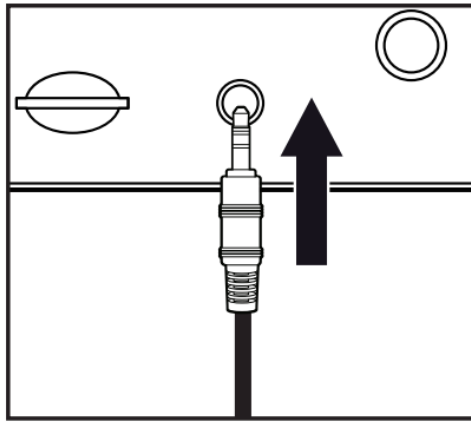
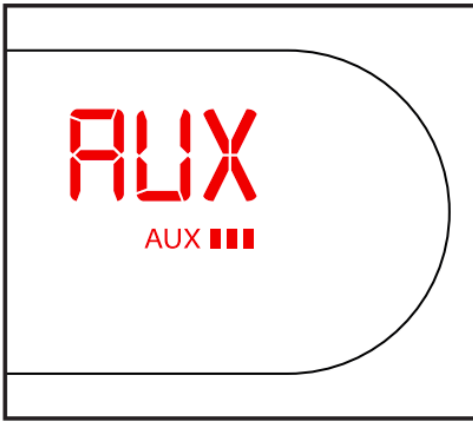

### TF/Micro SD Card Input Mode

The speaker is also compatible with and can play MP3 files loaded onto a TF/Micro SD card

Short press the key to skip forward to the next track.

Short press the key to go back to the previous track.

Short press the Play / Pause (3) key to play or pause the playing song

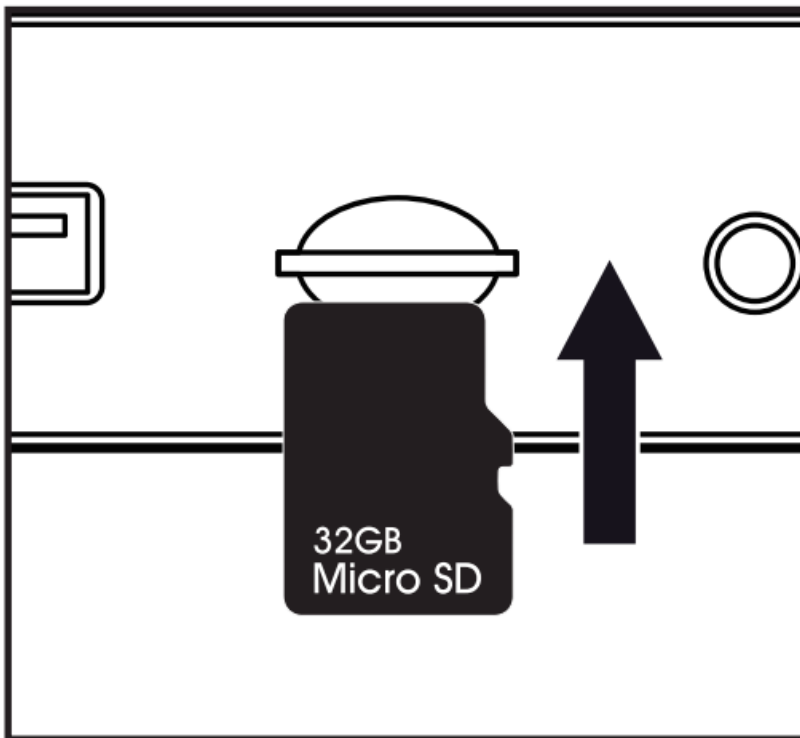

### Microphone Mode

Insert the microphone into one of the two available Microphone In ports (8). Ensure the microphone is switched on.

Rotate clockwise to increase the volume of the microphone, rotate anti-clockwise to reduce the volume of the microphone.

Rotate clockwise to increase the strength of the microphone reverb effect, rotate anti-clockwise to reduce the strength of the reverb effect.

Rotate clockwise to increase the strength of the microphone echo effect, rotate anti-clockwise to reduce the strength of the microphone echo effect.

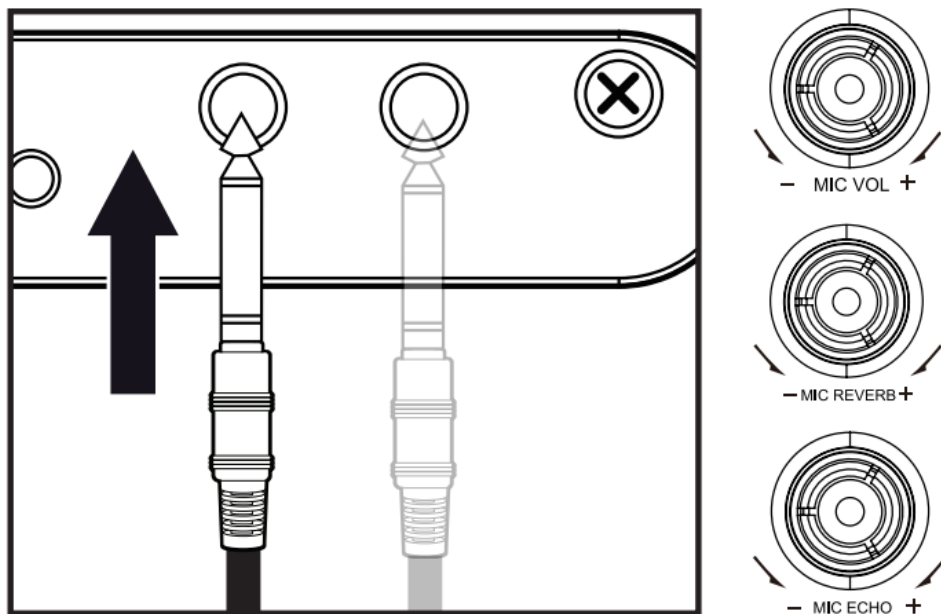

### FM Mode

Press the Mode button to switch to FM radio mode, The speaker will emit an audible tone indicating the speaker is in FM mode and will display the frequency of the radio station



Long press the Play/Pause key (3) to automatically search for a station. After a station has been found, it will automatically play. Short Press the or to tune to the previous or next station

### RGB Light Mode

Long press the Light key (9) to turn the LED woofer speaker lights on and off.

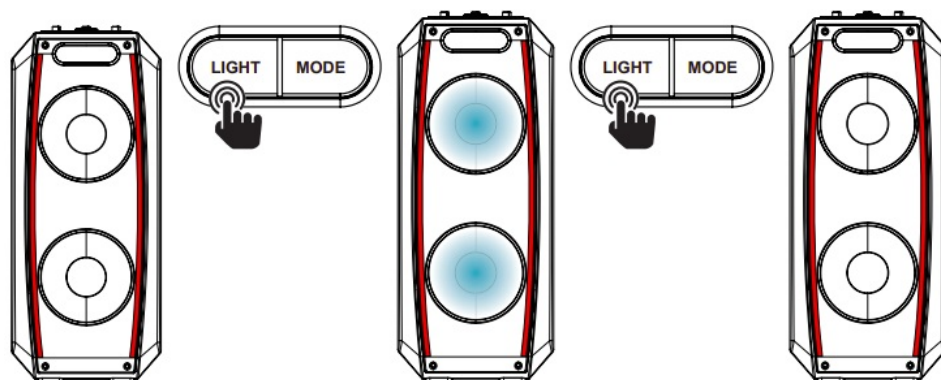

Short press the Light key (9) to change the lighting mode or to switch the LED strip lights on and off. The lighting mode options are slow and fast flashing.



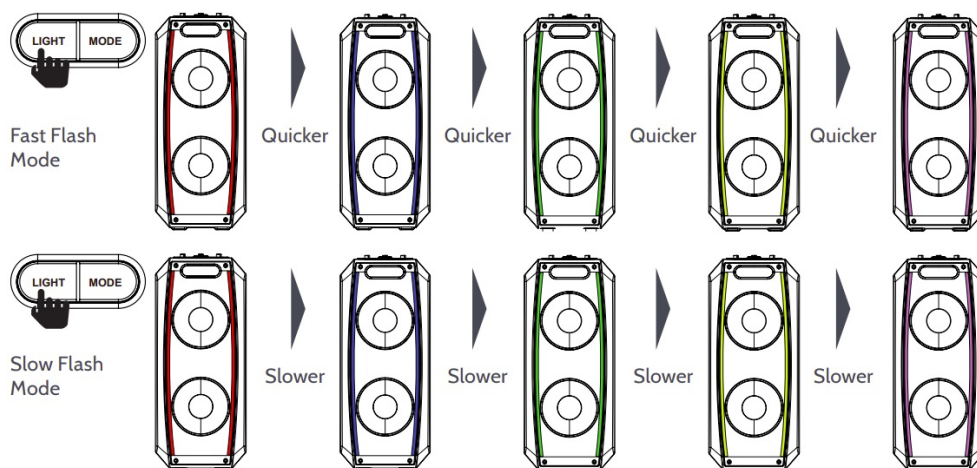

The speed of the LED flashing changes depending on the volume of the music.

Specifications	
Power Input	5V 2A
Audio Output	40W
FM Frequency	87.5MHz-108MHz
Function	BT / USB / AUX / FM / TF-SD card
Battery	7.4V/4400mA rechargeable battery
Playtime	Up to 7 hours at 60% volume

Problem	Solutions
Speaker reception is poor	Move the speaker closer to a window. Check that the speaker is not close to microwaves, fluorescent lights or other equipment which may cause interference
No sound	Check if the volume is turned down. Increase the volume. Check that the speaker is switched on. Try tuning to another speaker station
The speaker does not turn on	The battery has no power and the speaker is not securely connected to the AC adaptor.
No Bluetooth connection	The Bluetooth® function may be deactivated on the compatible device. Activate this, if necessary. Check whether the device to be connected is switched on and is in search mode.
No Microphone audio	Check that the microphone is securely connected to the microphone in port. Check if the microphone volume is turned down. Increase the volume. Check the microphone is turned on at the microphone.
USB input or SD card is not working	Check it is connected properly – reinsert USB drive /SD card is not compatible or formatted properly Audio files are not compatible

### Disclaimer

Updates to Firmware and/or hardware components are made regularly. Therefore some of the instructions specifications and pictures in this documentation may differ slightly from your particular situation. All items described in this guide are for illustration purposes only and may not apply to your particular situation. No legal rights or entitlements may be obtained from the description made in this manual.

## Declaration of conformity

Hereby, Phelix Electronic Ltd. declares that the radio equipment: model i-box Party speaker, with Bluetooth and FM radio, for wireless reception in domestic premises is in compliance with the Radio Equipment Directive 2014/53/EU. The full text of the EU declaration of conformity is available at the following internet address: [www.philex.com/doc](http://www.philex.com/doc)

## Technical support

For further help, advice, information or live chat visit [www.iboxstyle.com](http://www.iboxstyle.com)



Waste electrical and electronic products should not be disposed of with household waste. Please recycle where facilities exist. Check with your Local Authority for recycling advice.



### Contents

- [1 Documents / Resources](#)
  - [1.1 References](#)
- [2 Related Posts](#)

## Documents / Resources



[i-box A75 YX76 Portable Party Speaker with Microphone](#) [pdf] Instruction Manual  
A75 YX76 Portable Party Speaker with Microphone, A75 YX76, Portable Party Speaker with Microphone, Party Speaker with Microphone, Speaker with Microphone, Microphone

## References

- [Declaration of Conformity Documents – Philex Electronic Ltd](#)
- [i-box](#)
- [Declaration of Conformity Documents – Philex Electronic Ltd](#)
- [User Manual](#)

[Manuals+.](#) [Privacy Policy](#)

This website is an independent publication and is neither affiliated with nor endorsed by any of the trademark owners. The "Bluetooth®" word mark and logos are registered trademarks owned by Bluetooth SIG, Inc. The "Wi-Fi®" word mark and logos are registered trademarks owned by the Wi-Fi Alliance. Any use of these marks on this website does not imply any affiliation with or endorsement.