



Hytera PNC360S Push-to-Talk Over Cellular Radio Instructions

[Home](#) » [Hytera](#) » Hytera PNC360S Push-to-Talk Over Cellular Radio Instructions 

Contents

- [1 Hytera PNC360S Push-to-Talk Over Cellular Radio](#)
- [2 Product Overview](#)
- [3 Before Use](#)
- [4 Basic Operations](#)
- [5 PoC Services](#)
- [6 Specifications](#)
- [7 Documents / Resources](#)
 - [7.1 References](#)
- [8 Related Posts](#)



Hytera PNC360S Push-to-Talk Over Cellular Radio



Product Overview

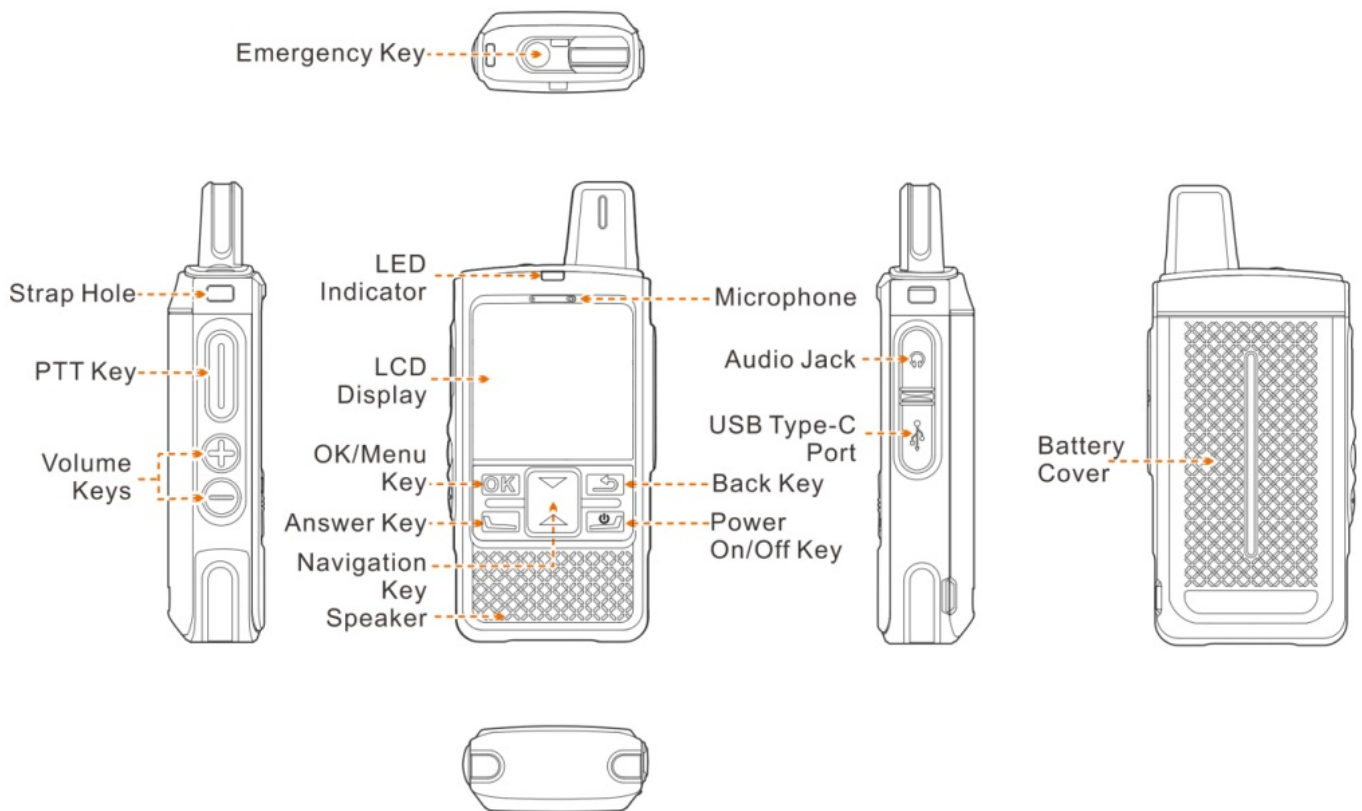

Before Use

Installing the Nano SIM Card

1. Remove the battery cover with a proper tool.
2. Open the SIM card slot cover.
3. Install the SIM card.
4. Put the card slot cover back in place.

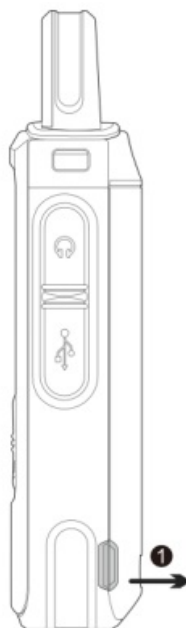

Attaching the Battery

Attach the battery as shown below, and then attach the battery cover back.

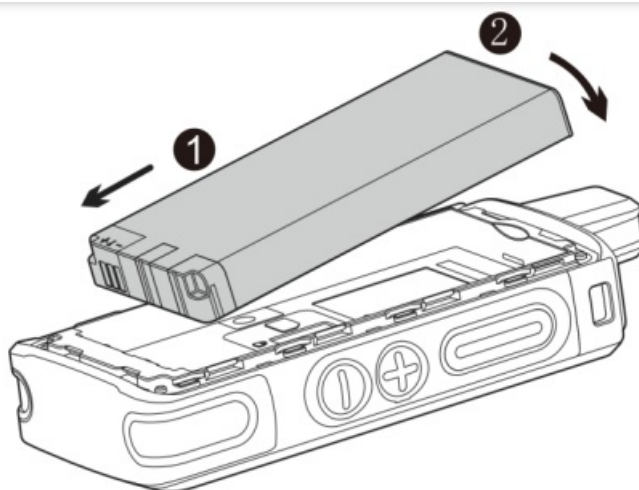

Attaching the Belt Clip

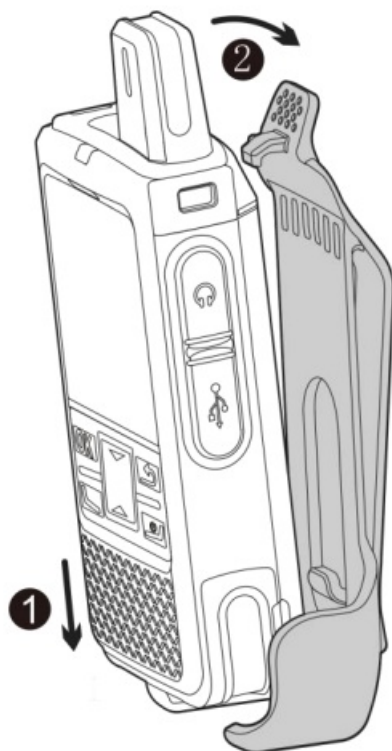

Attaching the Audio Accessory

Open the audio jack cover, and then insert the audio accessory into the jack.

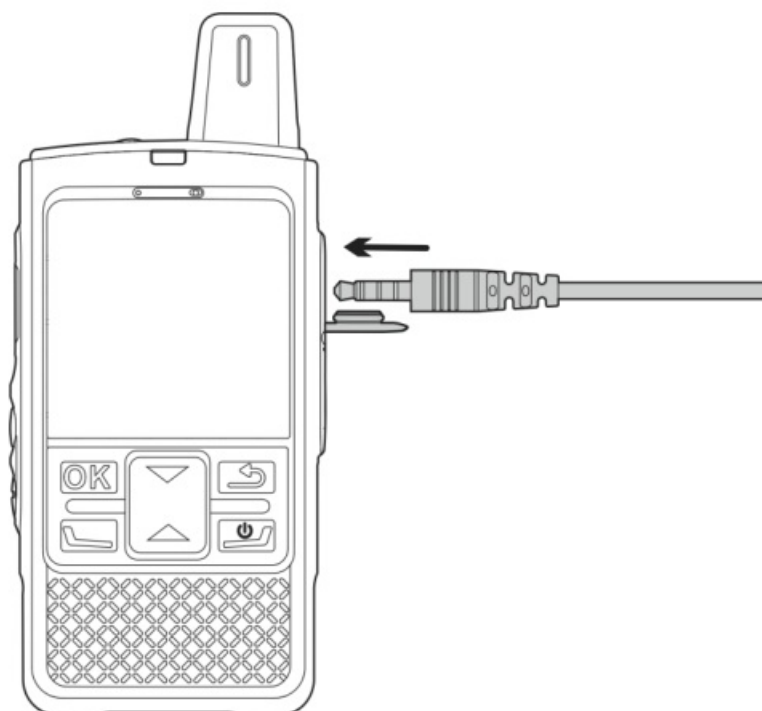

NOTE: To ensure optimum waterproof and dustproof performance, close the audio jack cover after disconnecting the audio accessory.

Charging the Battery

CAUTIONS

- Use the approved charger to charge the battery.
- Read the Safety Information Booklet before charging.
- The remaining lithium-ion battery power is limited to 30% pursuant to the new lithium battery shipment regulation approved by the International Air Transport Association (IATA).

Before initial use, charge the battery.

To charge the battery, connect the product to a power adapter, power bank, or computer with the USB cable. To determine the charging status, check the battery icon shown on the LCD display.

Basic Operations

Turning on/off the Product

- To turn on the product, long press for two seconds.
- To turn off the product, long press for two seconds, and then select Power off.

Adjusting the Volume

To increase the volume, press the Volume + key. To decrease the volume, press the Volume – key.

Locking/Unlocking the Screen

1. To lock the screen, go to Settings > Screen locked to enable the feature. If the product is not operated for a specific duration, the screen will be automatically locked.
2. To unlock the screen, press

Connecting to the Network

To connect to the cellular network, install the Nano SIM card and activate the cellular data service.

Checking the Device Information

To check the information such as model, serial number, and version, go to Settings > About phone.

PoC Services

You can use Push-to-Talk over Cellular (PoC) services such as one-to-one or one-to-many voice call over the public network.

- To initiate a call, do as follows.
 - Select a contact.
 - Press and hold the PTT key, and then speak.
 - Release the PTT key.
- You can receive a call without any operation.

Specifications

Specifications	
Model	PNC360S

Frequency Range	<ul style="list-style-type: none"> I FDD-LTE: B1/B3/B7/B8/B20/B28 I TDD-LTE: B38/B40 I WCDMA: B1/B3/B8 I GSM: 900/1800 I BT: BT4.2 I WIFI: 2.4GHz, 802.11b/g/n20/n40 I GPS: GPS/Galileo/GLONASS/BeiDou
Tx Power	<ul style="list-style-type: none"> I GSM900: 32.5dBm I DCS1800: 29.5dBm I WCDMA B1/B3/B8: 24dBm I FDD-LTE (B1/B3/B7/B8/B20/B28): 24dBm I TDD-LTE (B38/B40): 24dBm I BT: 3dBm I WIFI: 17dBm
Operational Temperature	-20°C to +60°C
Battery Charging Temperature	10°C to +45°C
Software Version	V1.0.01.000.02
Hardware Version	V1.00
Accessories	Adaptor, Belt Clip, Battery
Trademark	
Adapter Model	S010WV0500200
Adapter Input	100-240V~50/60Hz 0.4A
Adapter Output	5.0V/2.0A
Battery Caution	<p>CAUTION</p> <p>Risk of explosion if the battery is replaced by an incorrect type</p>

Specifications	
	<p>disposal of a battery into fire or a hot oven, or mechanically crushing or cutting of a battery, that can result in an explosion;</p> <p>leaving a battery in an extremely high temperature surrounding environment that can result i n an explosion or the leakage of flamma ble liquid or gas;</p> <p>a battery subjected to extremely low air pressure that may result in an explosion or the leaka ge of flammable liquid o gas</p>

Documents / Resources

	<p>Hytera PNC360S Push-to-Talk Over Cellular Radio [pdf] Instructions</p> <p>PNC360S, Push-to-Talk Over Cellular Radio, PNC360S Push-to-Talk Over Cellular Radio</p>
---	--

References

- [!\[\]\(9dc885fa0d6d341860a6e69645e59475_img.jpg\) Hytera Canada - The Leader in Two-Way Radio Communications](#)