



# HYPERX Pulsefire FPS Pro RGB Gaming Mouse Instruction Manual

[Home](#) » [HYPERX](#) » HYPERX Pulsefire FPS Pro RGB Gaming Mouse Instruction Manual

## Contents [ [hide](#) ]

- [1 HYPERX Pulsefire FPS Pro RGB Gaming Mouse](#)
- [2 What's included](#)
- [3 Mouse Overview](#)
- [4 Installation](#)
- [5 Function Keys](#)
- [6 Documents / Resources](#)
  - [6.1 References](#)
- [7 Related Posts](#)



**HYPERX Pulsefire FPS Pro RGB Gaming Mouse**



### What's included

- HyperX Pulsefire FPS Pro™ RGB Gaming Mouse



## Mouse Overview

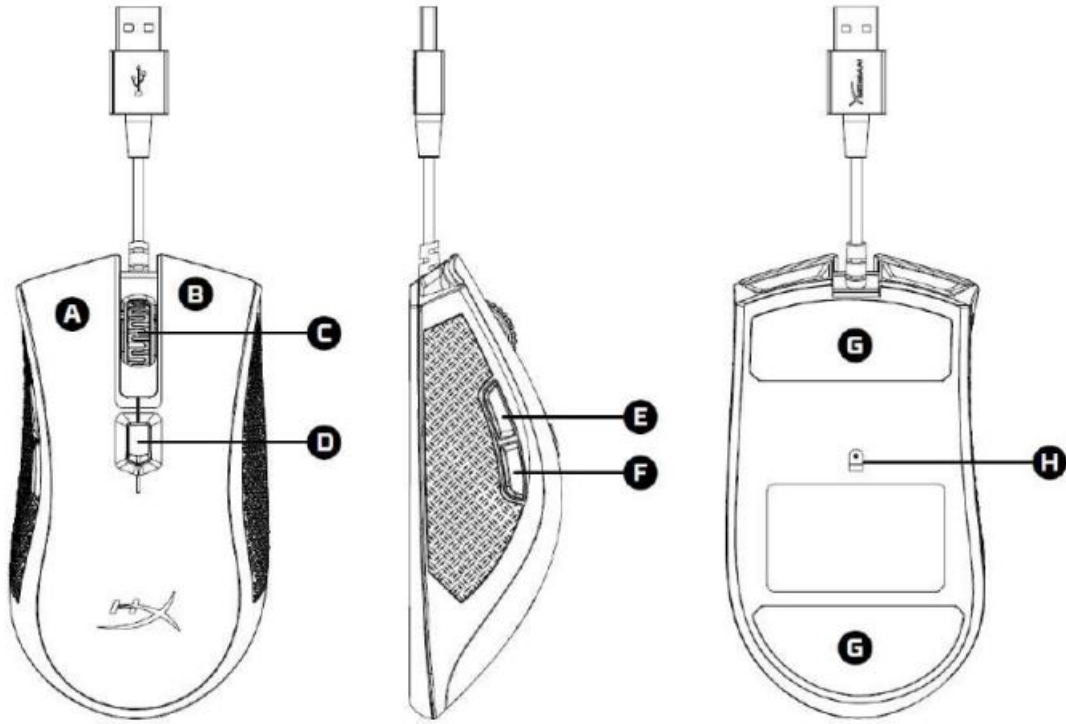

- **A-** Left click button
- **B-** Right click button
- **C-** Mouse wheel
- **D-** DPI button
- **E-** Forward click button
- **F-** Back click button
- **G-** Mouse skates
- **H-** Optical gaming sensor

## Installation

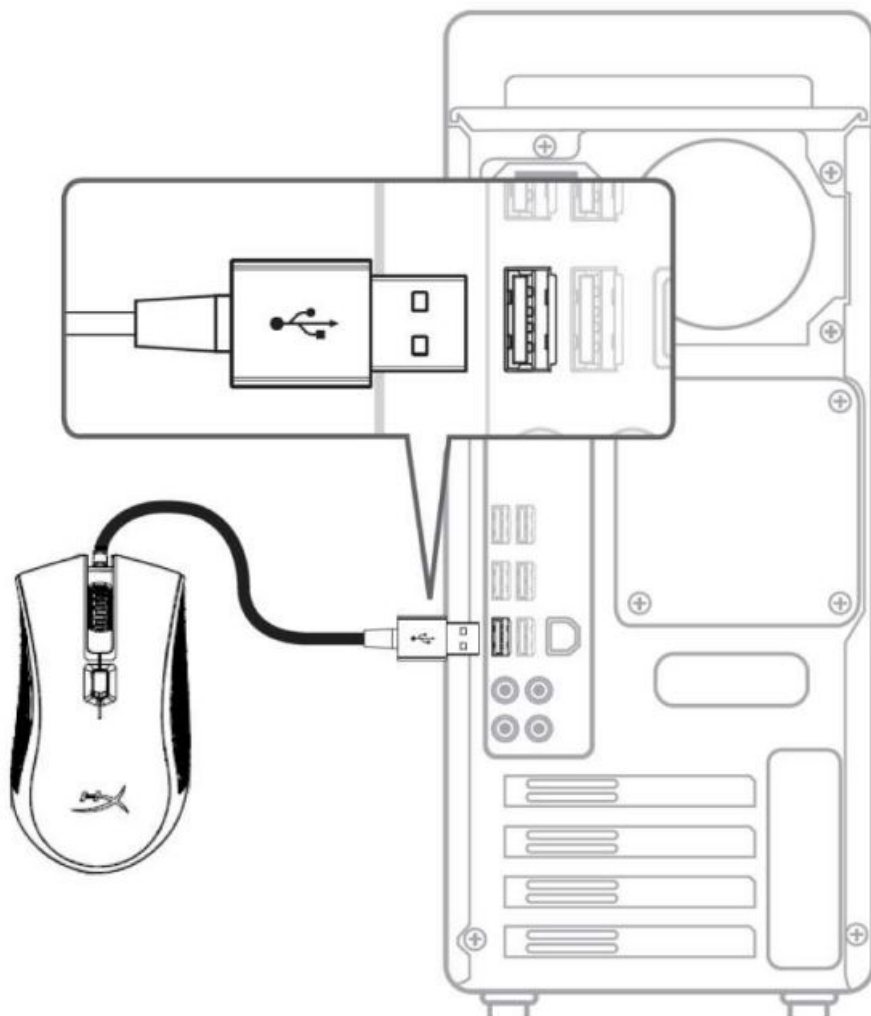

1. Connect the USB connector to the computer.

## Function Keys

| Function Keys                     | Secondary Feature   |
|-----------------------------------|---|
| DPI button                        | Change between DPI presets. Default values are: <ul style="list-style-type: none"> <li>– 800 DPI (blue).</li> <li>– 1600 DPI (yellow).</li> <li>– 3200 DPI (green).</li> </ul>                |
| DPI button + Mouse wheel click    | Switch between the default on board memory profiles: <ul style="list-style-type: none"> <li>– Profile 1: Color cycle</li> <li>– Profile 2: Solid red</li> <li>– Profile 3: LED off</li> </ul> |
| DPI button + Back click button    | Decrease LED brightness. There are 4 brightness levels: off, low, medium and high.  |
| DPI button + Forward click button | Increase LED brightness. There are 4 brightness levels: off, low, medium and high.  |

## HyperX NGenuity Software

To customize lighting, DPI presets and macro settings, download the HyperX NGenuity software here: [hyperxgaming.com/ngenuity](https://hyperxgaming.com/ngenuity).

Refer to the HyperX NGenuity Gaming Software manual for more information on functionalities.

## Mouse factory reset

If you are experiencing any issue with the mouse you can perform a factory reset. You will lose your custom LED profile and DPI presets by doing this.

| Function Keys  | Secondary Feature  |
|--|--|
| DPI button + Mouse wheel click<br><b>for 5 seconds</b> | Factory reset of the mouse and all on board memory settings. |

## Documents / Resources

|  |   |
|--|---|
|  | <p><b><a href="#">HYPERX Pulsefire FPS Pro RGB Gaming Mouse</a></b> [pdf] Instruction Manual</p> <p>Pulsefire FPS Pro RGB Gaming Mouse, FPS Pro RGB Gaming Mouse, Pro RGB Gaming Mouse, RGB Gaming Mouse, Gaming Mouse, Mouse</p> |
|--|---|

References

-  [HyperX | High Quality Gaming Gear](#)
-  [HyperX | High Quality Gaming Gear](#)
-  [HyperX | High Quality Gaming Gear](#)