



HYPERX Pulsefire Core RGB Gaming Mouse Instructions

[Home](#) » [HYPERX](#) » HYPERX Pulsefire Core RGB Gaming Mouse Instructions 



Pulse fire Core RGB Gaming Mouse
Instructions



Contents

- [1 Pulse ire Core RGB Gaming Mouse](#)
- [2 Specifications](#)
- [3 Mouse overview](#)
- [4 Documents / Resources](#)
 - [4.1 References](#)
- [5 Related Posts](#)

Pulse ire Core RGB Gaming Mouse

HyperX Pulse ire Core™ RGB Gaming Mouse

Find the language and latest documentation for your HyperX Pulse ire Core™ RGB Gaming Mouse here. [HyperX Pulse ire Core™ RGB Gaming Mouse Installation Guide](#)

Part numbers: HX-MC004B

The HyperX Pulse ire Core™ delivers the essentials for gamers looking for a solid, comfortable, wired RGB gaming mouse. The Pixart 3327 optical sensor gives players precise, smooth tracking with no hardware acceleration, and has native DPI settings of up to 6200 DPI. The ergonomically designed Pulse ire Core has textured side grips for a comfortable, non-slip grip and its symmetrical shape is suitable for both palm and claw grips. It features high-quality switches with crisp tactile feedback rated for up to 20 million clicks. Customize lighting, DPI settings and macros for 7 programmable buttons with HyperX Ingenuity software and set your mouse up just the way you want it. The large skates on Pulse ire Core help deliver accurate aiming by giving you a smooth, controlled glide as you move the mouse.

What's included: HyperX Pulse ire Core Mouse

Specifications



Mouse:

Ergonomic: Symmetrical

Sensor: Pixar 3327

Resolution: Up to 6,200 DPI

DPI presets*: (4) total 800/1600/2400/3200 DPI

Speed: 220 IPS

Acceleration: 30G

Buttons: 7

Left/right button switches: Omron

Left/right button durability: 20 million clicks

Backlight: RGB (16,777,216 colors)

Light effects: 1 lighting zone – 4 brightness levels

On-board memory: 1 profile

Connection type: USB 2.0

Polling rate: 1000Hz

Cable type: Braided

Dimensions:

Length: 119.30mm

Height: 41.30mm

Width: 63.90mm

Cable length: 1.8m

Weight (without cable): 100g

Weight (with cable): 120g

* Per zone RGB lighting is customizable with HyperX Ingenuity soft

** Tested on HyperX FURY S Pro Gaming Mouse Pad.

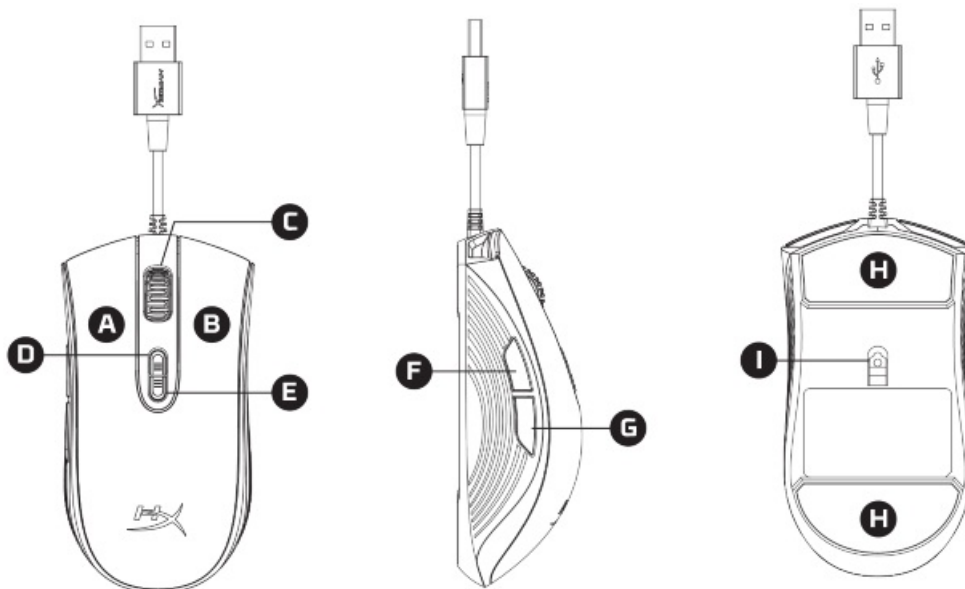
Mouse overview

A. Left-click button

B. Right-click button

C. Mouse wheel

D. DPI increase button

E. Forward-click button

F. Left button

G. Right button

H. Front lighting zone

I. Rear lighting zone

- F. Back-click button
- G. Mouse skates
- H. Optical gaming sensor

Mouse installation:

Connect the USB connector to the computer USB port.

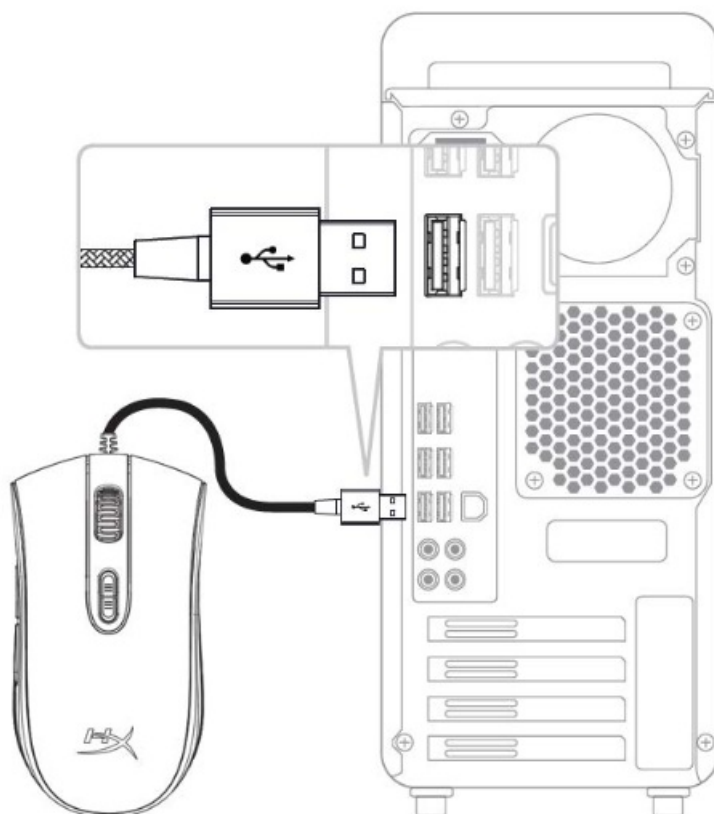

DPI presets:

	Preset 1	Preset 2	Preset 3	Preset 4
DPI value	800 (default)	1600	2400	3200
DPI colour	Red	Green	Blue	Yellow

Mouse functions:

Function keys	Secondary feature
DPI up/down button	Change between DPI presets. Default values are: <ul style="list-style-type: none"> – 800 DPI (red then fade away). – 1600 DPI (green then fade away). – 2400 DPI (blue then fade away). – 3200 DPI (yellow then fade away).
DPI button + B5 button	Decrease LED brightness. There are 4 brightness levels: off, medium and high.
DPI button + B4 button	Increase LED brightness. There are 4 brightness levels: off, medium and high.

Factory reset

DPI button + mouse wheel click for 5 seconds: Factory reset of the mouse and all on-board memory settings.

HyperX NGenuity software:

To customize the lighting and macro settings, download the HyperX Ingenuity software here:



hyperxgaming.com/en/ngenuity

Refer to the HyperX Ingenuity gaming software manual for more information on the functions.





480HX-MC004B.A01
HyperX Pulse ire Core™

Documents / Resources

	<p>HYPERX Pulsefire Core RGB Gaming Mouse [pdf] Instructions</p> <p>Pulsefire Core RGB Gaming Mouse, Core RGB Gaming Mouse, RGB Gaming Mouse, Gaming Mouse, Mouse</p>
	<p>HyperX Pulsefire Core RGB Gaming Mouse [pdf] User Manual</p> <p>Pulsefire Core RGB Gaming Mouse, Pulsefire Core, Pulsefire Core Gaming Mouse, RGB Gami ng Mouse, Gaming Mouse, RGB Mouse, Mouse</p>

References

-  [NGENUITY – HyperX ROW](#)
-  [HyperX | High Quality Gaming Gear](#)
-  [HyperX | High Quality Gaming Gear](#)