



# HYPERX HX426S16IB/32 4G x 64-bit RAM Memory User Guide

[Home](#) » [HYPERX](#) » HYPERX HX426S16IB/32 4G x 64-bit RAM Memory User Guide 

## Contents

- [1 HYPERX HX426S16IB/32 4G x 64-bit RAM Memory](#)
- [2 DESCRIPTION](#)
- [3 PnP JEDEC TIMING PARAMETERS](#)
- [4 SPECIFICATIONS](#)
- [5 FEATURES](#)
- [6 MODULE DIMENSIONS](#)
- [7 Documents / Resources](#)
  - [7.1 References](#)
- [8 Related Posts](#)



## HYPERX HX426S16IB/32 4G x 64-bit RAM Memory



## DESCRIPTION

HyperX HX426S16IB/32 is a 4G x 64-bit (32GB) DDR4-2666 CL16 SDRAM (Synchronous DRAM) 2Rx8, memory module, based on sixteen 2G x 8-bit DDR4 FBGA components. Each module supports Intel® Extreme Memory Profiles (Intel® XMP) 2.0. This module has been tested to run at DDR4-2666 at a low latency timing of 16-18-18 at 1.2V. Additional timing parameters are shown in the PnP Timing Parameters section below. The JEDEC standard electrical and mechanical specifications are as follows:

**Note:** HyperX DDR4 PnP memory will run in most DDR4 systems up to the speed allowed by the manufacturer's system BIOS. PnP cannot increase the system memory speed faster than is allowed by the manufacturer's BIOS.

## **PnP JEDEC TIMING PARAMETERS**

- **JEDEC/PnP:** DDR4-2666 CL16-18-18 @1.2V
- **XMP Profile #1:** DDR4-2666 CL16-18-18 @1.2V

## **SPECIFICATIONS**

- CL(IDD) :16 cycles
- Row Cycle Time (tRCmin) : 45ns(min.)
- Refresh to Active/Refresh : 350ns(min.)  
Command Time (tRFCmin)
- Row Active Time (tRASmin) : 26.25ns(min.)
- UL Rating : 94 V – 0
- Operating Temperature : 0o C to +85o C
- Storage Temperature : -55o C to +100o C

## **FEATURES**

- Power Supply: VDD = 1.2V Typical
- VDDQ = 1.2V Typical
- VPP – 2.5V Typical
- VDDSPD = 2.25V to 3.6V
- On-Die termination (ODT)
- 16 internal banks; 4 groups of 4 banks each
- Bi-Directional Differential Data Strobe
- 8 bit pre-fetch
- Burst Length (BL) switch on-the-fly BL8 or BC4(Burst Chop)
- Height 1.18" (30.00mm)

## **MODULE DIMENSIONS**

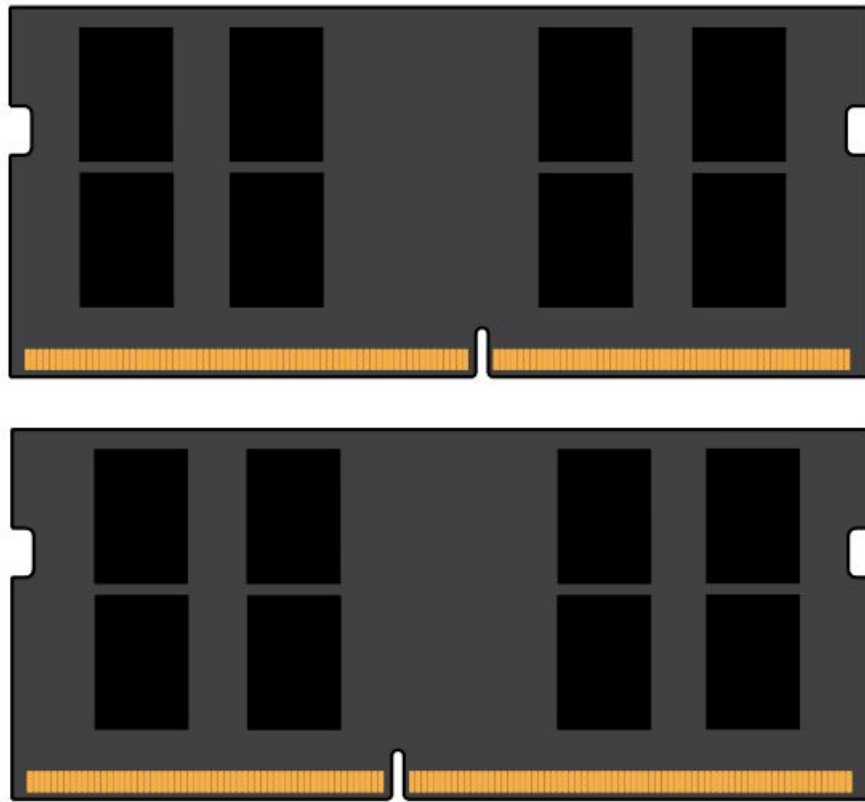

All measurements are in millimeters.

(Tolerances on all dimensions are  $\pm 0.12$  unless otherwise specified)

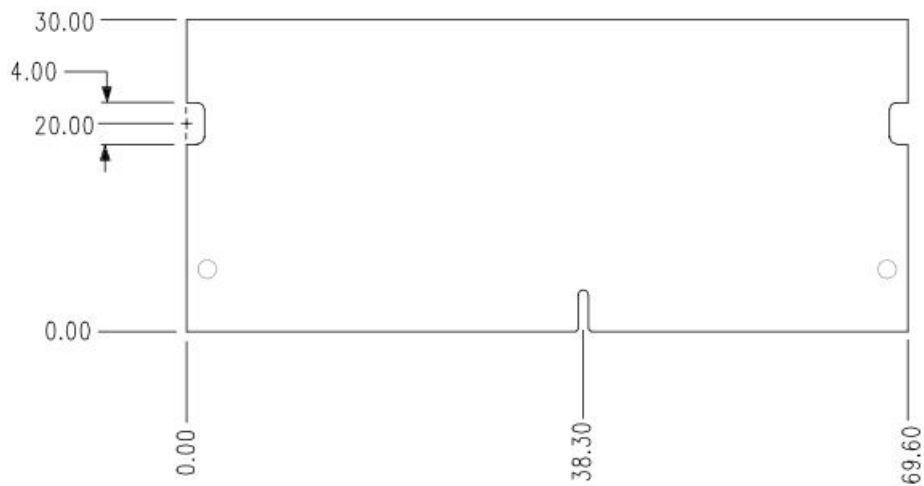

The product images shown are for illustration purposes only and may not be an exact representation of the product. Kingston reserves the right to change any information at anytime without notice.

FOR MORE INFORMATION, GO TO [HYPERXGAMING.COM](https://www.hyperxgaming.com)

All Kingston products are tested to meet our published specifications. Some motherboards or system configurations may not operate at the published HyperX memory speeds and timing settings. Kingston does not recommend that any user attempt to run their computers faster than the published speed. Overclocking or modifying your system timing may result in damage to computer components.

**HyperX is a division of Kingston.**

©2019 Kingston Technology Corporation, 17600 Newhope Street, Fountain Valley, CA 92708 USA.  
All rights reserved. All trademarks and registered trademarks are the property of their respective owners.

[hyperxgaming.com](http://hyperxgaming.com)

**Documents / Resources**



[HYPERX HX426S16IB/32 4G x 64-bit RAM Memory](#) [pdf] User Guide  
HX426S16IB 32 4G x 64-bit RAM Memory, HX426S16IB 32, 4G x 64-bit RAM Memory, RAM Memory

**References**

-  [HyperX | High Quality Gaming Gear](#)