



HyperX HX-MC004B Pulsefire Core RGB Gaming Mouse User Manual

[Home](#) » [HYPERX](#) » HyperX HX-MC004B Pulsefire Core RGB Gaming Mouse User Manual 

HyperX HX-MC004B Pulsefire Core RGB Gaming Mouse



Contents

- [1 Introduction](#)
- [2 What's included](#)
- [3 Specifications](#)
- [4 Mouse overview](#)
- [5 Mouse installation](#)
- [6 DPI presets](#)
- [7 Mouse functions](#)
- [8 HyperX NGenuity software](#)
- [9 Documents / Resources](#)
 - [9.1 References](#)
- [10 Related Posts](#)

Introduction

The HyperX Pulsefire Core™ delivers the essentials for gamers looking for a solid, comfortable, wired RGB gaming mouse. The Pixart 3327 optical sensor gives players precise, smooth tracking with no hardware acceleration, and has native DPI settings of up to 6200 DPI. The ergonomically designed Pulse fire Core has textured side grips for a comfortable, non-slip grip and its symmetrical shape is suitable for both palm and claw grips. It features high-quality switches with crisp tactile feedback rated for up to 20 million clicks. Customise lighting, DPI settings and macros for 7 programmable buttons with HyperX NGenuity software and set your mouse up just the way you want it. The large skates on Pulsefire Core help deliver accurate aiming by giving you a smooth, controlled glide as you move the mouse.

What's included

- HyperX Pulsefire Core Mouse



Specifications

- **Mouse**

Ergonomic: Symmetrical

Sensor: Pixart 3327

Resolution: Up to 6,200 DPI

DPI presets*: (4) total 800/1600/2400/3200 DPI

Speed: 220 IPS

Acceleration: 30G

Buttons: 7

Left/right button switches: Omron

Left/right button durability: 20 million clicks

Backlight: RGB (16,777,216 colours)

Light effects: 1 lighting zone – 4 brightness levels

On-board memory: 1 profile

Connection type: USB 2.0

Polling rate: 1000Hz

Cable type: Braided

- **Dimensions**

Length: 119.30mm

Height: 41.30mm

Width: 63.90mm

Cable length: 1.8m

Weight (without cable): 100g

Weight (with cable): 120g

* Per zone RGB lighting is customisable with HyperX NGenuity software

** Tested on HyperX FURY S Pro Gaming Mouse Pad.

Mouse overview



- A Left-click button
- B Right-click button
- C Mouse wheel
- D DPI increase button
- E DPI decrease button
- F Forward-click button

- G Back-click button
- H Mouse skates
- I Optical gaming sensor

Mouse installation

Connect the USB connector to the computer USB port.

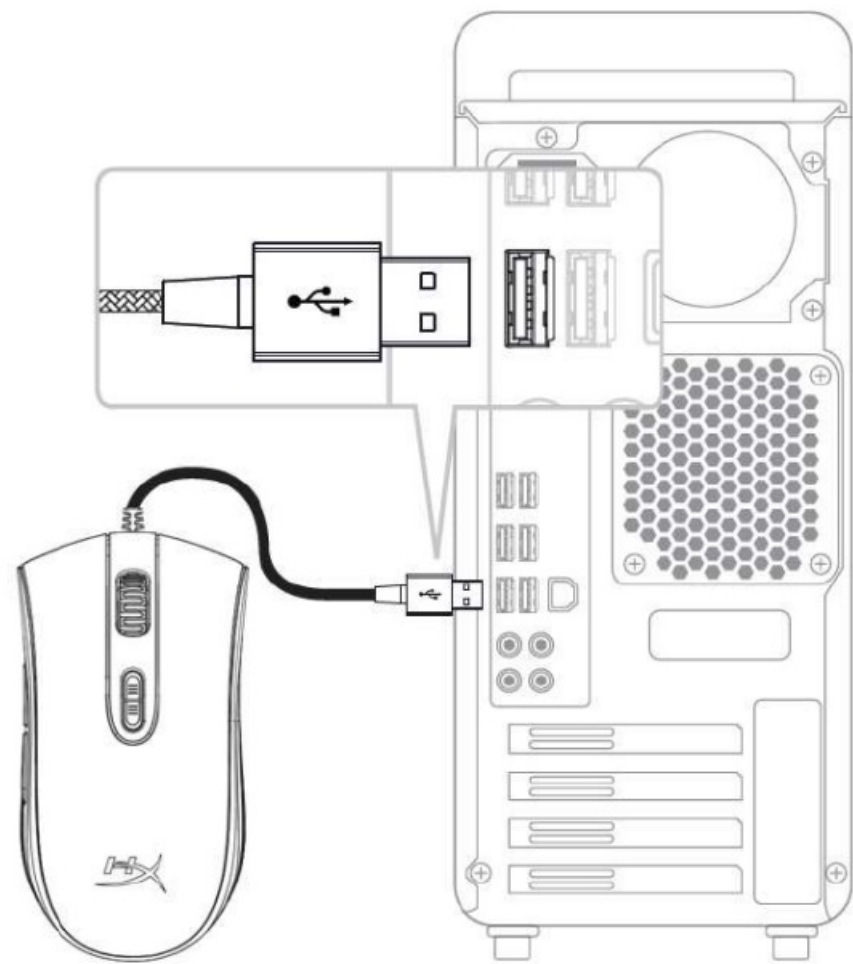

DPI presets

	Preset 1	Preset 2	Preset 3	Preset 4
DPI value	800 (default)	1600	2400	3200
DPI colour	Red	Green	Blue	Yellow

Mouse functions

Function keys	Secondary feature
DPI up/down button	Change between DPI presets. Default values are: <ul style="list-style-type: none"> – 800 DPI (red then fade away). – 1600 DPI (green then fade away). – 2400 DPI (blue then fade away). – 3200 DPI (yellow then fade away).
DPI button + B5 button	Decrease LED brightness. There are 4 brightness levels: off, low, medium and high.
DPI button + B4 button	Increase LED brightness. There are 4 brightness levels: off, low, medium and high.

Factory reset	
DPI button + mouse wheel click for 5 seconds	Factory reset of the mouse and all on-board memory settings.

HyperX NGenuity software



To customise the lighting and macro settings, download the HyperX NGenuity software here:

hyperxgaming.com/en/ngenuity

Refer to the HyperX NGenuity gaming software manual for more information on the functions.

Documents / Resources

	<p>HyperX HX-MC004B Pulsefire Core RGB Gaming Mouse [pdf] User Manual HX-MC004B, HX-MC004B Pulsefire Core RGB Gaming Mouse, Pulsefire Core RGB Gaming Mouse, Core RGB Gaming Mouse, RGB Gaming Mouse, Gaming Mouse, Mouse</p>
--	---

References

- [NGENUITY – HyperX ROW](#)
- [HyperX | High Quality Gaming Gear](#)
- [HyperX | High Quality Gaming Gear](#)