



# **HYPERX Clutch Gladiate Wired Xbox Controller User Guide**

[Home](#) » [HYPERX](#) » **HYPERX Clutch Gladiate Wired Xbox Controller User Guide** 

## **Contents**

- [1 HYPERX Clutch Gladiate Wired Xbox Controller](#)
- [2 Overview](#)
- [3 Setup](#)
- [4 Programmable Buttons](#)
- [5 Trigger Locks](#)
- [6 FCC Compliance and Advisory Statement](#)
- [7 Documents / Resources](#)
  - [7.1 References](#)



**HYPERX Clutch Gladiate Wired Xbox Controller**



## Overview

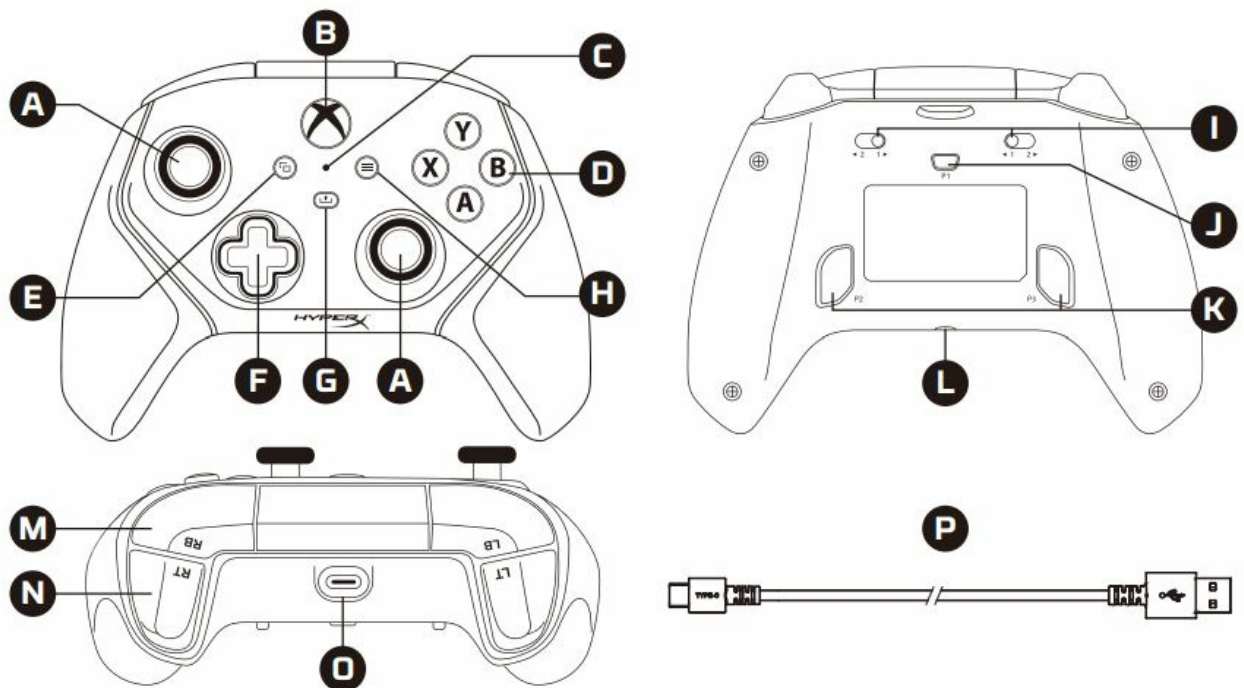

- **A** Analog sticks (L3/R3)
- **B** Xbox button
- **C** Power LED
- **D** ABXY buttons
- **E** View button
- **F** D-Pad
- **G** Share button
- **H** Menu button
- **I** Trigger locks
- **J** P1 button

- **K** P2/P3 buttons
- **L** 3.5mm headset jack
- **M** Bumpers (LB/RB)
- **N** Triggers (LT/RT)
- **O** USB-C port
- **P** USB-C to USB-A Cable

## Setup

Connect the controller with the provided USB cable to your Xbox or PC.

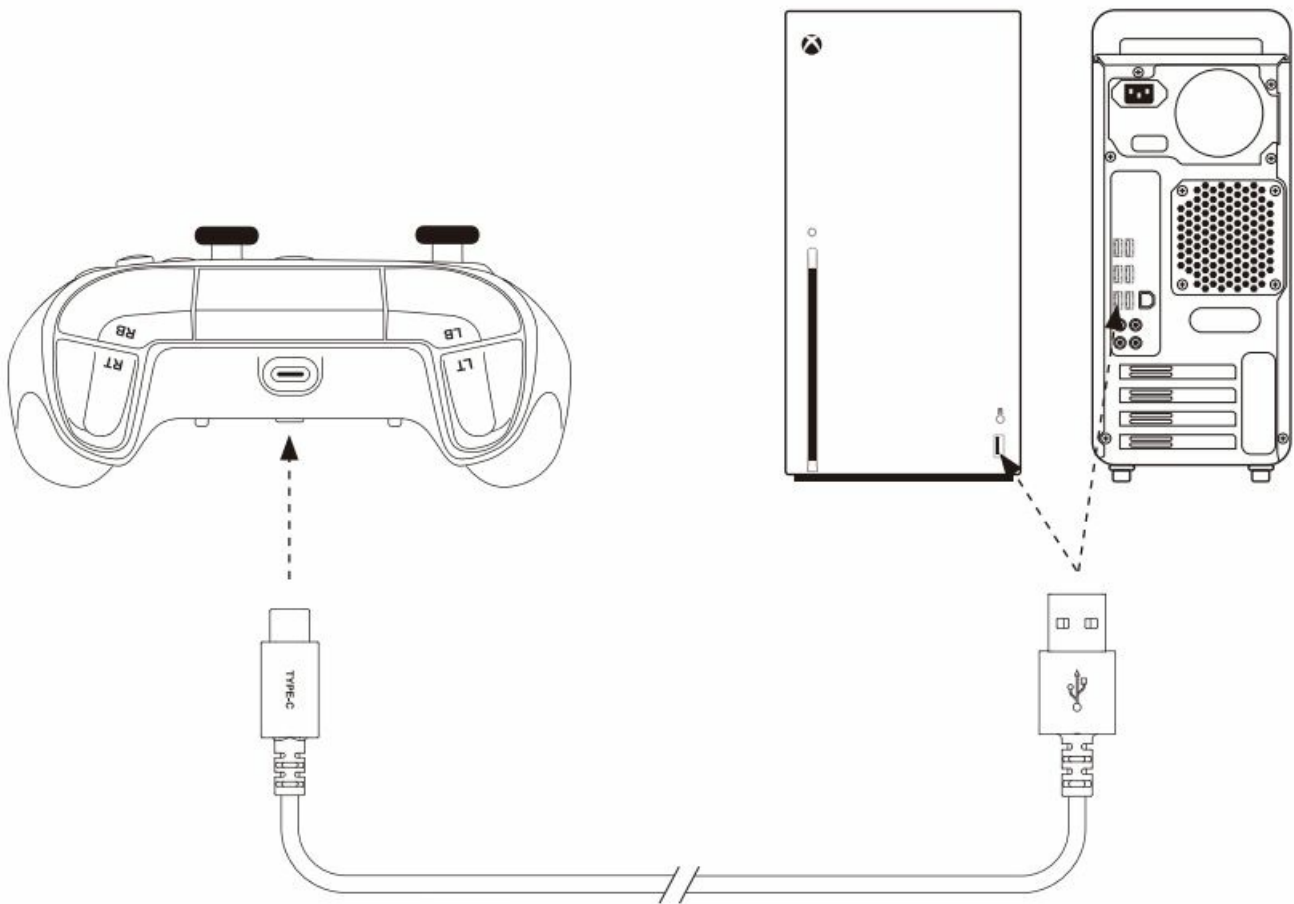

## Programmable Buttons

### Assign/Re-Assign P2 & P3

- Hold P1 and Release when LED is slowly flashing

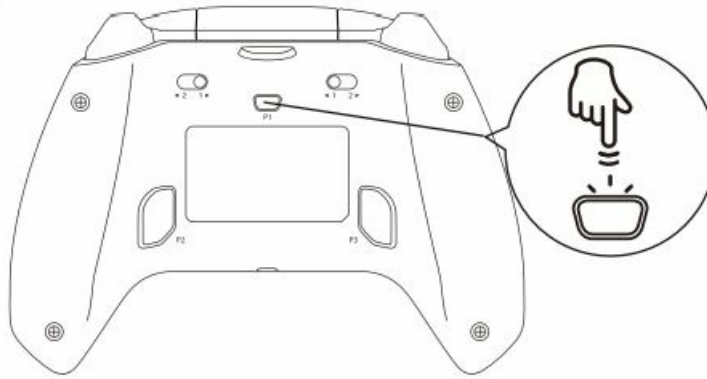

- When LED is flashing slowly, press one of the following buttons to assign.



- When LED is flashing rapidly, press either P2 or P3 to assign your selected button.

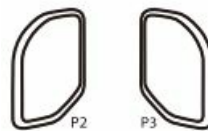

### Clear individually P2 or P3

When LED is flashing slowly, press either P2 or P3 to clear its button mapping.

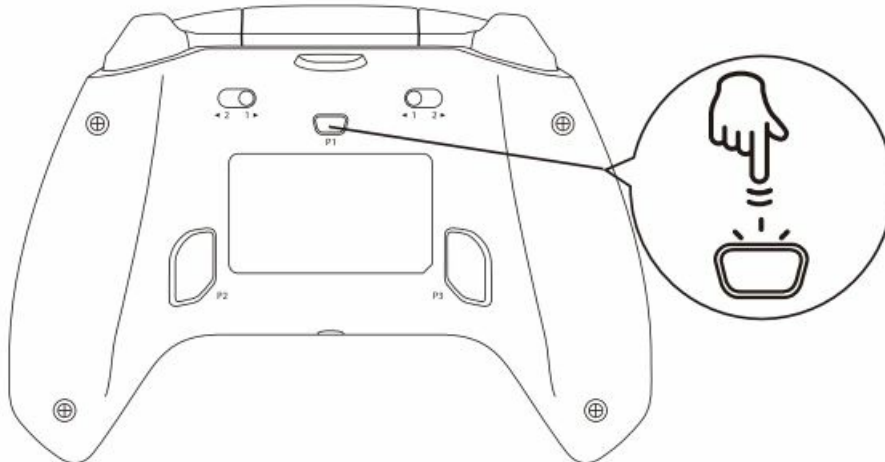

### Trigger Locks

- Move slider to position 1 to unlock full trigger motion.



- Move slider to position 2 to lock and reduce trigger motion.

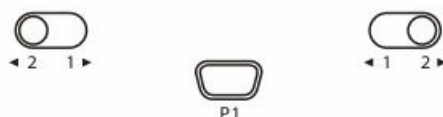

## Questions or Setup Issues?

Contact the HyperX support team or see the user manual at [hyperx.gg/support](https://hyperx.gg/support)

**WARNING:** Permanent hearing damage can occur if a headset is used at high volumes for extended periods of time.

## Simplified Declaration of Conformity

Hereby, HP declares that the radio equipment is in compliance with Directive 2014/53/EU. The full text of the EU Declaration of Conformity is available at the following internet address: [www.hp.eu/certificates](https://www.hp.eu/certificates) (search with Model Name)

**UK only:** Hereby, HP declares that the radio equipment is in compliance with the relevant statutory requirements. The full text of the declaration of conformity is available at the following internet address: [www.hp.eu/certificates](https://www.hp.eu/certificates) (search with Model Name)

## FCC Compliance and Advisory Statement

This device complies with Part 15 of the FCC rules. Operation is subject to the following two conditions: (1) this device may not cause harmful interference, and (2) this device must accept any interference received, including interference that may cause undesired operation. This equipment has been tested and found to comply with the limits for a Class B digital device, according to Part 15 of the FCC rules. These limits are designed to provide reasonable protection against harmful interference in a residential installation. This equipment generates, uses and can radiate radio frequency energy and if not installed and used in accordance with the instructions, may cause harmful interference to radio communications. However, there is no guarantee that interference will not occur in a particular installation. If this equipment does cause harmful interference to radio or television reception, which can be determined by turning the equipment off and on, the user is encouraged to try correct the interference by one or more of the following measures:

1. Reorient the receiving antenna.
2. Increase the separation between the equipment and the receiver.
3. Connect the equipment to an outlet on a circuit different from that to which the receiver is connected.
4. Consult the dealer or an experienced radio/TV technician for help. Any special accessories needed for compliance must be specified in the instruction manual.

**Warning:** A shielded-type power cord is required in order to meet FCC emission limits and also to prevent interference to the nearby radio and television reception. It is essential that only the supplied power cord be used. Use only shielded cables to connect I/O devices to this equipment.

**CAUTION:** Any changes or modifications not expressly approved by the party responsible for compliance could void your authority to operate the equipment.

## India RoHS Statement

This product, as well as its related consumables and spares, complies with the reduction in hazardous substances provisions of the "India E-waste (Management and Handling) Rule 2016." It does not contain lead, mercury, hexavalent chromium, polybrominated biphenyls or polybrominated diphenyl ethers in concentrations exceeding 0.1 weight % and 0.01 weight % for cadmium, except for where allowed pursuant to the exemptions set in Schedule 2 of the Rule.

- Copyright 2022 HyperX and the HyperX logo are registered trademarks or trademarks of HP Inc. in the U.S. and/or other countries. All registered trademarks and trademarks are property of their respective owners.

## Documents / Resources

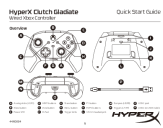
	<p><a href="#">HYPERX Clutch Gladiate Wired Xbox Controller</a> [pdf] User Guide Clutch Gladiate Wired Xbox Controller, Clutch Gladiate, Wired Xbox Controller, Xbox Controller, Controller</p>
---	---

## References

- [Support – HyperX ROW](#)
- [Laptop Computers, Desktops, Printers, Ink & Toner | HP® Official Site](#)
- [Regulations Certificates | HP® United Kingdom](#)

Manuals+.