

HYPERX CEB003L Cloud MIX Buds User Guide

[Home](#) » [HYPERX](#) » **HYPERX CEB003L Cloud MIX Buds User Guide** 

Contents

- [1 HYPERX CEB003L Cloud MIX Buds](#)
- [2 Overview](#)
- [3 Powering on and off the Earbuds](#)
- [4 Pairing the Earbuds](#)
- [5 Connecting the Low Latency USB Adapter](#)
- [6 Using the Touch Controls](#)
- [7 Charging](#)
- [8 Documents / Resources](#)
- [9 Related Posts](#)



HYPERX CEB003L Cloud MIX Buds



Overview

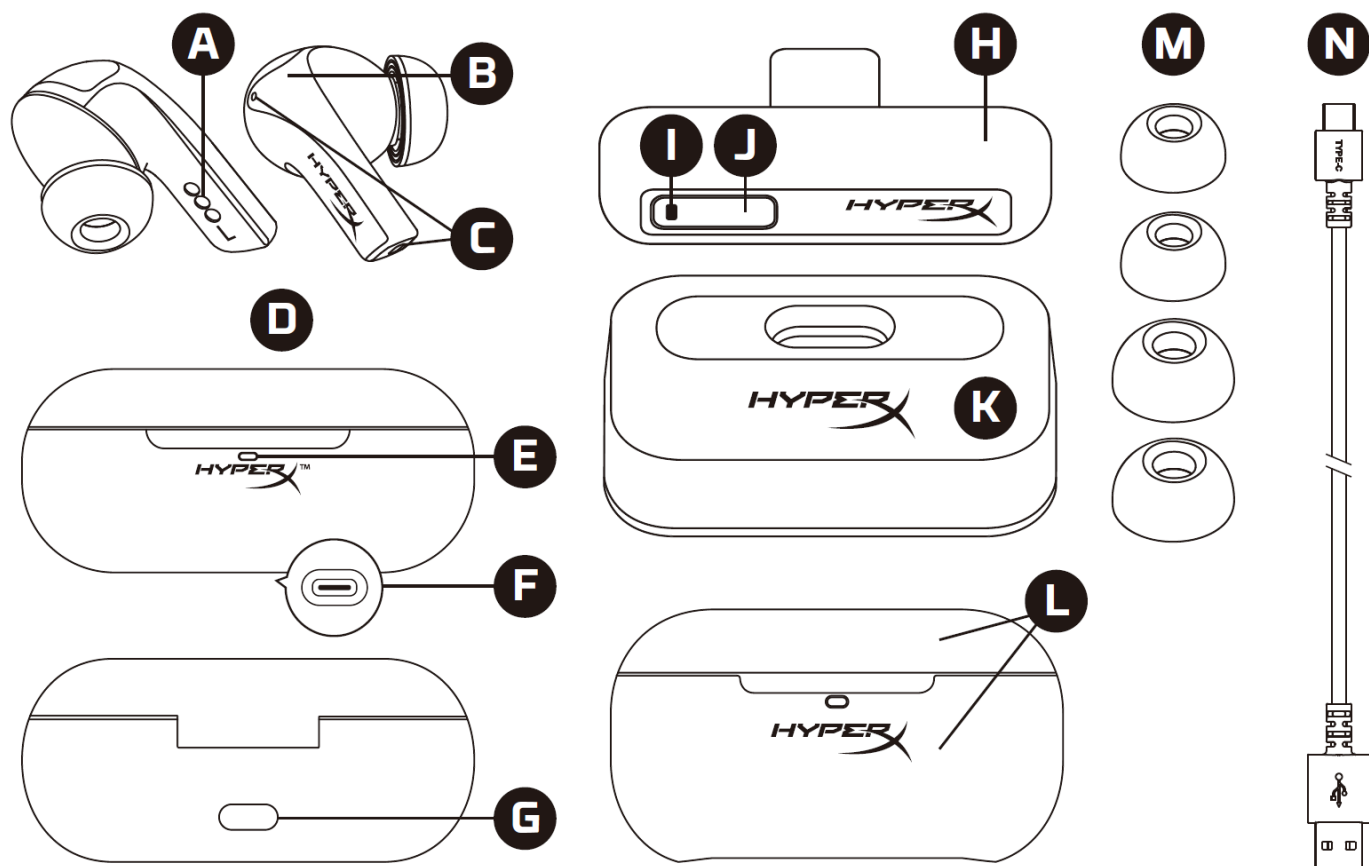

1. A. Charging contacts
2. B. Touch sensor
3. C. Microphones
4. D. Charging case
5. E. Charging case status LED

- 6. F. USB-C port
- 7. G. Charging case button
- 8. H. Low latency USB adapter
- 9. I. USB adapter status LED
- 10. J. USB adapter button
- 11. K. Extension adapter
- 12. L. Silicone case
- 13. M. Ear tips (large, small)
- 14. N. USB-C to USB-A cable

Powering on and off the Earbuds

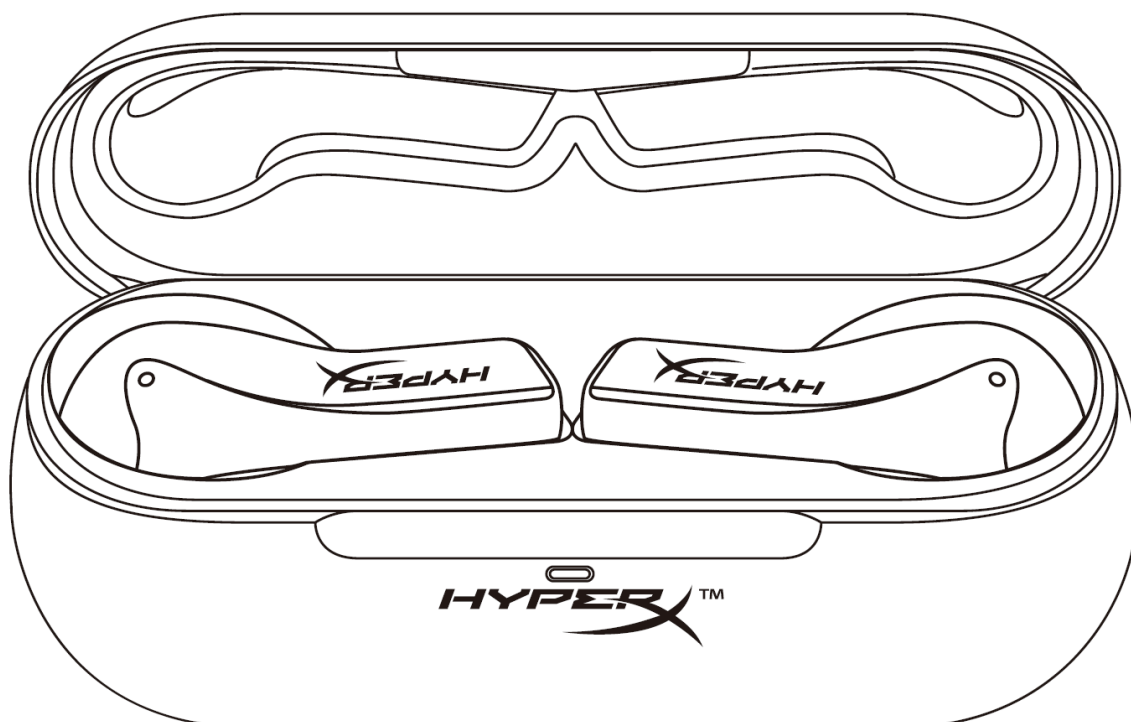

Charging Case Status LED	Earbud Battery Level
Green	51% – 100%
Yellow	16% – 50%
Red	<15%

To power on the earbuds, open the charging case. The charging case status LED will show the battery level of the earbuds.

To power off the earbuds, return them to the charging case and close the lid. The case LED will turn off.

Pairing the Earbuds

1. With the earbuds inserted, open the lid of the charging case.
2. Press and hold the charging case button for 3 seconds. The charging case status LED will begin flashing blue.

On your Bluetooth® enabled device, search for and connect to HyperX Cloud MIX Buds. Once connected, the charging case status LED will turn solid blue and fade off, returning to the battery level indication.

Connecting the Low Latency USB Adapter

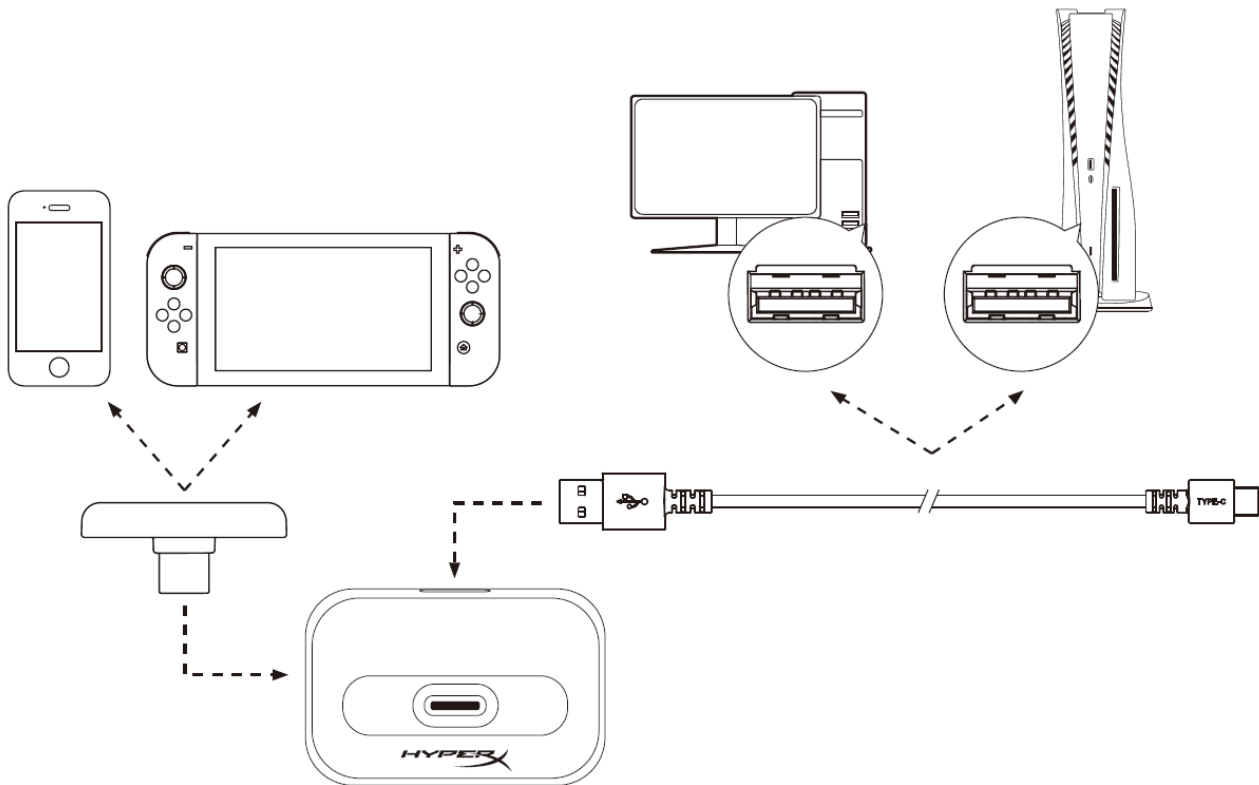

1. Connect the low latency USB adapter to your mobile device, PC, or video game console. The USB adapter status LED will begin flashing white. When not being used with a mobile device, it is recommended that the included extension adapter and USB-C to USB-A cables be used.
2. When the earbuds are powered on, they will automatically connect to the dongle, and the dongle status LED will breathe white.

Using the Touch Controls

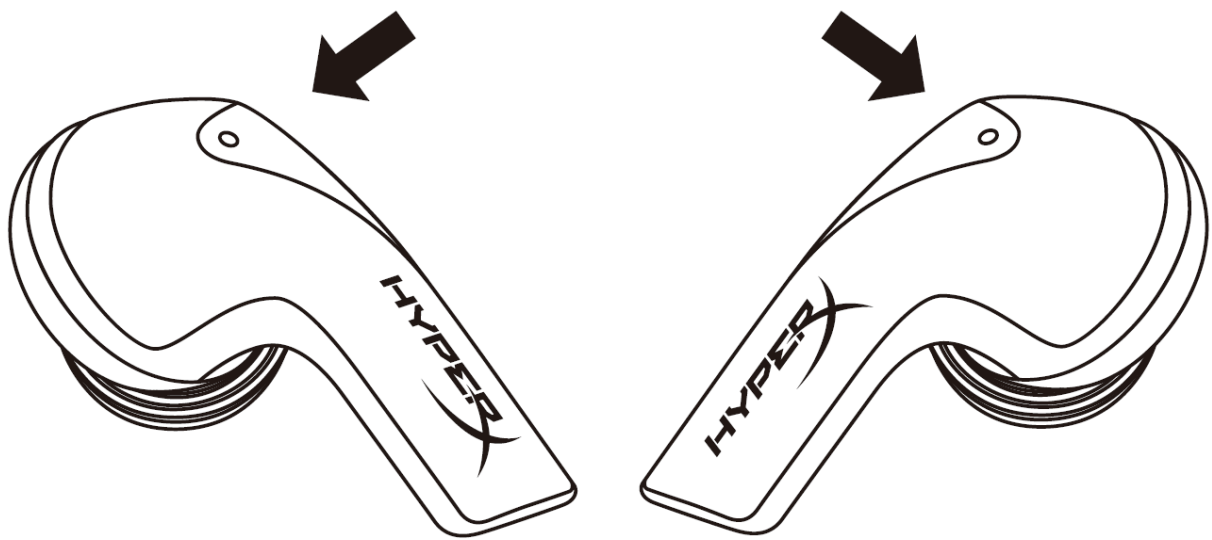

The following media controls are available when using Bluetooth® or the low latency USB adapter:

1 PRESS	2 PRESS	3 PRESS	LONG PRESS
Play / Pause	Skip Track	Previous Track	Mute / Unmute Microphone

The following phone controls are available when using Bluetooth®:

Status	1 Press	2 Press	3 Press	Long Press
Receiving Call	Answer Call	Reject Call	X	X
In Call	X	End Call	X	Mute / Unmute Microphone

Note: Touch control functionality can vary between devices and apps

Muting the Microphones When Using the Low Latency USB Adapter

Press the USB adapter button to mute/unmute the low latency USB adapter's microphone audio. The USB adapter status LED will breathe red when the microphone audio is muted.

Checking the Charging Case Battery Level

Press the charging case button to check the charging case's battery level, indicated by a blink and hold of the case's status LED.

Charging

It is recommended that the charging case and earbuds be fully charged before first use.

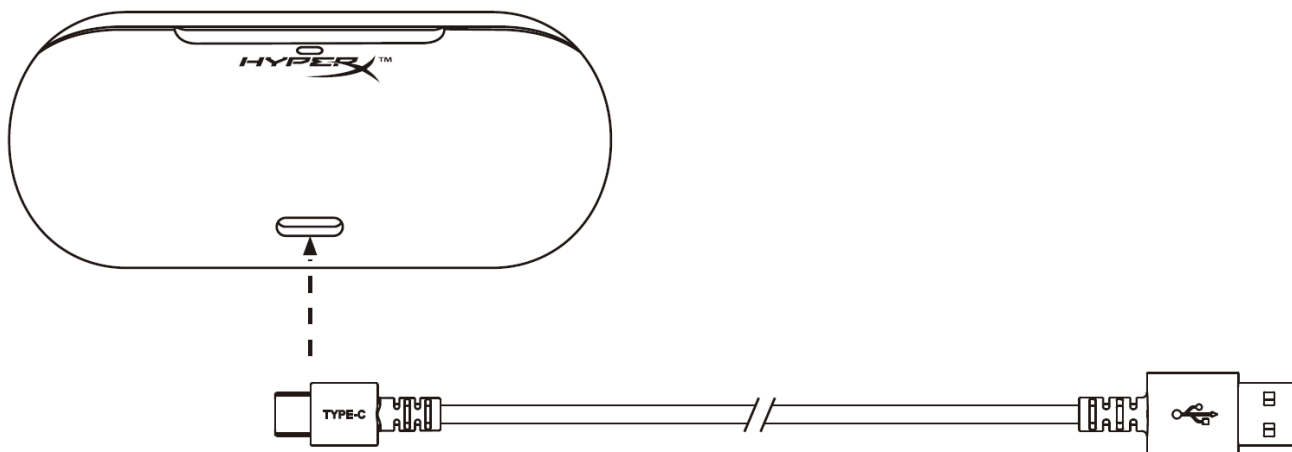

When charging, the charging case status LED will indicate the battery level of the earbuds.
 If neither earbud is in the charging case, the case status LED will indicate the battery level of the charging case.

CHARGING CASE STATUS LED	BATTERY LEVEL
Solid Green	100% (Charging Case = 100%)
Breathing Green	100% (Charging Case < 100%)
Breathing Yellow	16% – 99%
Breathing Red	< 15%

Bluetooth A2DP mode: Up to 33 hours
 Ultra-low latency mode: Up to 21 hours

*Tested at 50% headphone volume, continuous playback. Using A2DP mode earbuds have up to 10 hours of battery life and up to an additional 23 hours using the charging case. Using ultra-low latency mode earbuds have up to 6 hours of battery life and up to an additional 15 hours using the charging case. Actual battery life will vary with use and maximum capacity will naturally decrease with time and usage

HyperX NGENUITY Mobile

To customize sound, controls, and other settings, please download the HyperX NGENUITY Mobile application from iOS App Store or Android Google Play.

Questions or Setup Issues?

Contact the HyperX support team or see the user manual at: hyperxgaming.com/support/headsets

WARNING: Permanent hearing damage can occur if a headset is used at high volumes for extended periods of time.

Documents / Resources



[HYPERX CEB003L Cloud MIX Buds](#) [pdf] User Guide
CEB003L, B94-CEB003L, B94CEB003L, CEB003L Cloud MIX Buds, Cloud MIX Buds

[Manuals+](#).