



HYPERKIN S64 Retron Console Dock User Guide

[Home](#) » [HYPERKIN](#) » HYPERKIN S64 Retron Console Dock User Guide 

HYPERKIN S64 Retron Console Dock



Contents

- [1 Instruction For Use](#)
- [2 Setting up your Retron S64](#)
- [3 Documents / Resources](#)
 - [3.1 References](#)
- [4 Related Posts](#)

Instruction For Use

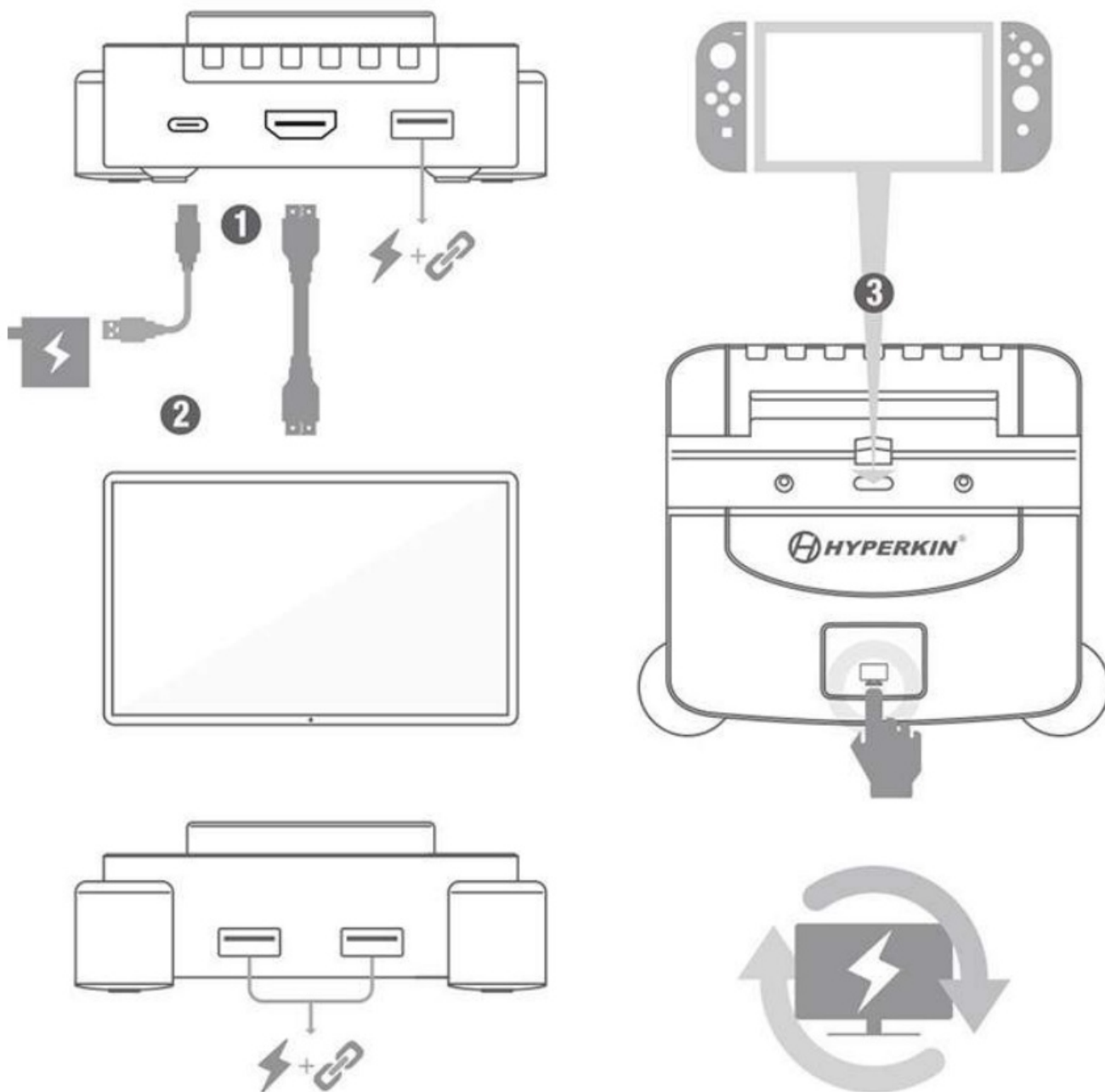

Setting up your RetroN S64

1. Plug in your HD cable (not included) and Type-C power cable (not included) into their designated ports on the back of the RetroN S64.
2. Connect the other end of the HD cable to your HDTV and the USB end of the Type-C power cable into a USB 5V 1A power source (not included).
3. With your console powered on, dock your console (not included) in the console cradle. Press the Toggle Button on the front of the RetroN S64 to switch from Charging Mode to TV Mode. You can also play in Charging Mode using the console's screen.
4. You can also plug in up to 3 accessories compatible with Nintendo Switch (not included) into the 3 USB ports on the console dock. You can also use these ports to charge other devices.
5. Once done playing, press the Toggle Button to switch from TV Mode to Charging Mode and press the Power Button on your console to enter Sleep Mode.

Note: Nintendo Switch Lite does NOT work with TV Mode.

Please visit

www.hyperkin.com/downloads/firmware for firmware updates.

© 2020 Hyperkin Inc. Hyperkin® is a registered trademark of Hyperkin Inc. Nintendo Switch® and Nintendo Switch Light® are registered trademarks of Nintendo® of America Inc. This product is not designed, manufactured, sponsored, approved or licensed by Nintendo® of America Inc. in the United States and in other countries. All rights reserved. Made in China.



Documents / Resources

	<p>HYPERKIN S64 Retron Console Doch [pdf] User Guide</p> <p>S64 Retron Console Doch, S64, Retron Console Doch, Console Doch, Doch</p>
---	---

References

- [User Manual](#)