



Contents [[hide](#)]

- [1 HYPER Qi2 4 In 1 Wireless Charger](#)
- [2 Product Information](#)
- [3 Product Outline](#)
- [4 Applicable Devices](#)
- [5 Instructions](#)
- [6 Specifications](#)
- [7 Standard Accessories](#)
- [8 FCC STATEMENT](#)
- [9 FAQ](#)
- [10 Documents / Resources](#)
 - [10.1 References](#)

HYPER

HYPER Qi2 4 In 1 Wireless Charger

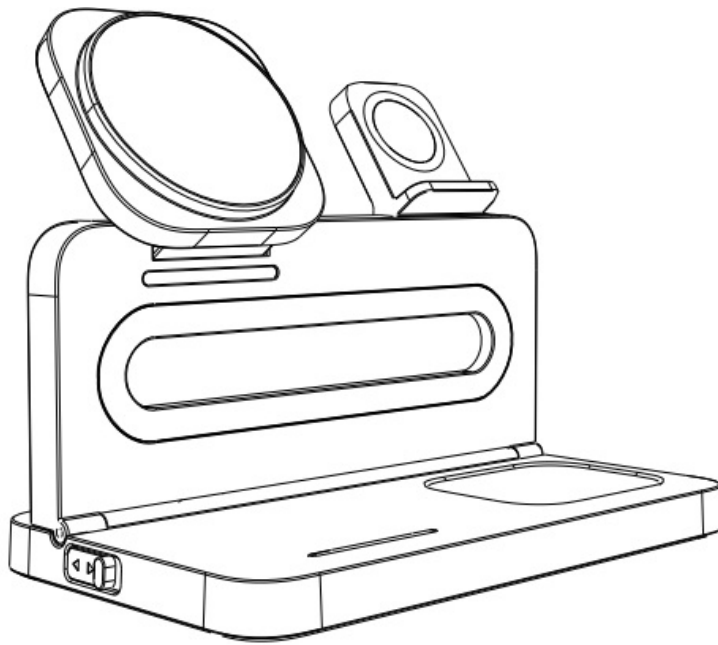

Product Information

Thank you for purchasing our product, the 4-IN-1 Wireless Charger. It features high-end fast wireless charging technology and a luxurious compact design. Compatible with any mobile phone meeting the Qi standard. Ideal for iPhone 12 and above; other phones require a magnetic case for wireless charging, enhancing your charging experience.

Product Usage Instructions

1. Connect the wireless charger to AC power via the provided adapter. The white indicator light will be on, signifying standby mode.
2. For the night light, use the touch switch located between the phone indicator and headset indicator. Single click to turn on/off the light, long press to adjust brightness.

Product Introduction

Thank you for purchasing our product 4-IN-1 Wireless Charger. It uses high-end fast wireless charging chip and has a luxurious and compact design. It is compatible with any mobile phone that meets the QI standard. Perfectly compatible with iPhone 12 and above, other mobile phones with wireless charging function need to be used with a magnetic phone case, effectively saving more time and improving your charging experience.

Product Outline

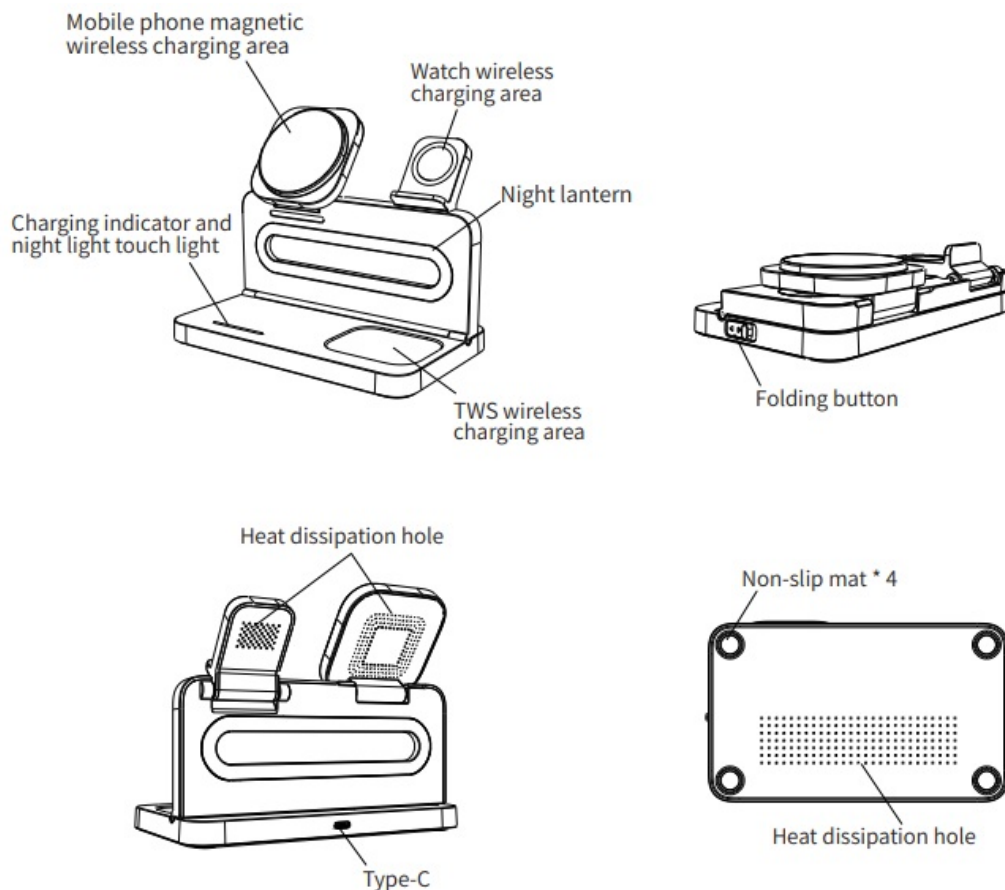

Applicable Devices

1. Devices with a built-in quick charge/normal charge wireless receiver.
2. Devices with an outer-face wireless charging receiver.
3. Devices with a wireless charging receiver in its protection case.

Note: All devices must be Qi standard.

Instructions

1. The wireless charger is connected to the AC power supply through the power adapter. The wireless charger is turned on, and the white light of the indicator is often on, entering the standby mode.
 2. When the mobile phone or TWS is charged, the corresponding indicator lights are blinking in the blue light. After full charging, the indicator light is often on. The indicator light does not change when the watch is charged.
(Frequent flashing of red and blue indicators indicates foreign object detection)
- (Note:** If the watch has no electricity, charging will be slower, it is recommended that the watch is close to 10% please charge, when there is no electricity, charging is

slower, you may need to wait for 1 hour, you need to have patience!)

3. The touch switch of the night light is in the middle of the mobile phone indicator and the headset indicator. Click the switch in a single click, turn on the light, click the switch again, and the lights go out. Long press the switch and the lights gradually brighten or darkens.

Specifications

- **Model:HT-539** FCC ID:2BKMD-HT-539
- **Input:5V 3A,9V 3A**
- **Wireless Charging for Phone:** 15W/10W/7.5W/5W
- **Wireless Charging for Earbuds:** 5W
- **Wireless Charging for Watch:** 2.5W

Standard Accessories

- 1* 4-IN-1 Wireless Charger
- 1* User Manual
- 1* USB Cable

FCC STATEMENT

This device complies with Part 15 of the FCC Rules. Operation is subject to the following two conditions:

1. This device may not cause harmful interference, and
2. This device must accept any interference received, including interference that may cause undesired operation.

Warning: Changes or modifications not expressly approved by the party responsible for compliance could void the user's authority to operate the equipment.

NOTE: This equipment has been tested and found to comply with the limits for a Class B digital device, pursuant to Part 15 of the FCC Rules. These limits are designed to provide reasonable protection against harmful interference in a residential installation. This equipment generates uses and can radiate radio frequency energy and, if not

installed and used in accordance with the instructions, may cause harmful interference to radio communications. However, there is no guarantee that interference will not occur in a particular installation. If this equipment does cause harmful interference to radio or television reception, which can be determined by turning the equipment off and on, the user is encouraged to try to correct the interference by one or more of the following measures:

- Reorient or relocate the receiving antenna.
- Increase the separation between the equipment and receiver.
- Connect the equipment into an outlet on a circuit different from that to which the receiver is connected.
- Consult the dealer or an experienced radio/TV technician for help.

FCC Radiation Exposure Statement:

This equipment complies with FCC radiation exposure limits set forth for an uncontrolled environment. This equipment should be installed and operated with minimum distance 20cm between the radiator & your body.

FAQ

What devices are compatible with the 4-IN-1 Wireless Charger?

The charger is compatible with devices having built-in quick charge/normal charge wireless receivers, outer-face wireless charging receivers, or receivers in their protection cases, all meeting the Qi standard.

How do I know if my phone is wirelessly charging?

When your phone is placed on the charging area, a compatible phone will display a charging icon or notification indicating it's wirelessly charging.

Can I charge multiple devices simultaneously on the charger?

Yes, you can charge multiple devices like a phone, earbuds, and a watch simultaneously on the different charging areas of the 4-IN-1 Wireless Charger.

Documents / Resources



[HYPER Qi2 4 In 1 Wireless Charger \[pdf\]](#) User Manual

Qi2 4 In 1 Wireless Charger, Qi2, 4 In 1 Wireless Charger, Wireless Charger, Charger

References

- [User Manual](#)

📄 4 In 1 Wireless Charger, charger, HYPER, Qi2, Qi2 4 In 1 Wireless Charger, wireless

📁 HYPER charger

Leave a comment

Your email address will not be published. Required fields are marked *

Comment *

Name

Email

Website

☐ Save my name, email, and website in this browser for the next time I comment.

Post Comment

Search:

[Search](#)

[Manuals+](#) | [Upload](#) | [Deep Search](#) | [Privacy Policy](#) | [@manuals.plus](#) | [YouTube](#)

This website is an independent publication and is neither affiliated with nor endorsed by any of the trademark owners. The "Bluetooth®" word mark and logos are registered trademarks owned by Bluetooth SIG, Inc. The "Wi-Fi®" word mark and logos are registered trademarks owned by the Wi-Fi Alliance. Any use of these marks on this website does not imply any affiliation with or endorsement.