



Hyper Mega
Tech Super
Pocket Atari
Edition



Hyper Mega Tech Super Pocket Atari Edition User Guide

[Home](#) » [Hyper Mega Tech](#) » Hyper Mega Tech Super Pocket Atari Edition User Guide 

Contents

- [1 Hyper Mega Tech Super Pocket Atari Edition](#)
- [2 OVERVIEW](#)
- [3 ADDITIONAL INSTRUCTIONS](#)
- [4 POWER ON](#)
- [5 DECLARATION OF CONFORMITY](#)
- [6 ELECTRICAL SAFETY & GUIDANCE](#)
- [7 CONSOLE CARTRIDGES INCLUDING](#)
- [8 12+ ARCADE CARTRIDGES INCLUDING](#)
- [9 Frequently Asked Questions](#)
- [10 Documents / Resources](#)
 - [10.1 References](#)
- [11 Related Posts](#)



Hyper Mega Tech Super Pocket Atari Edition



OVERVIEW

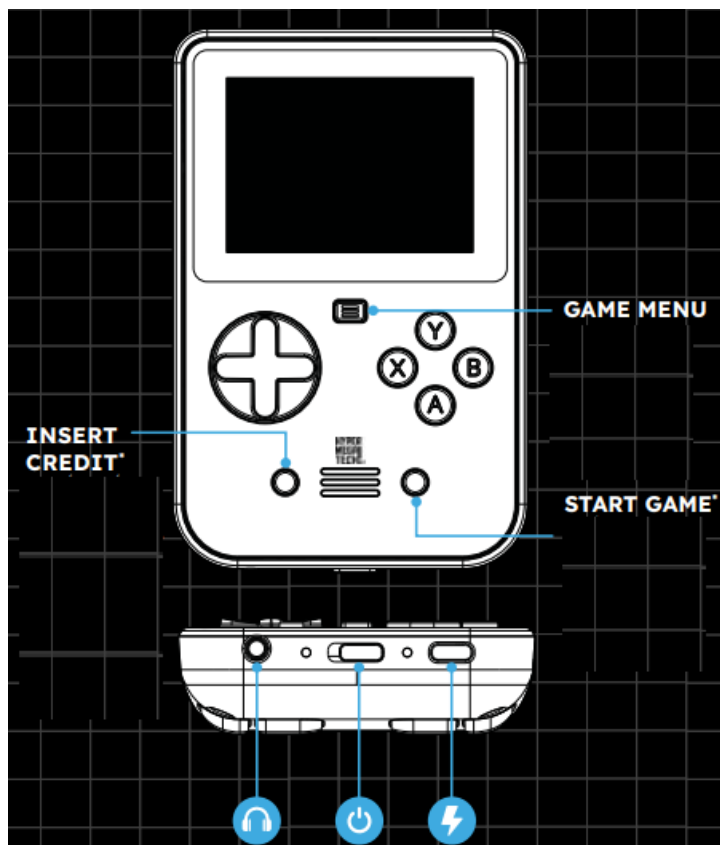

ADDITIONAL INSTRUCTIONS

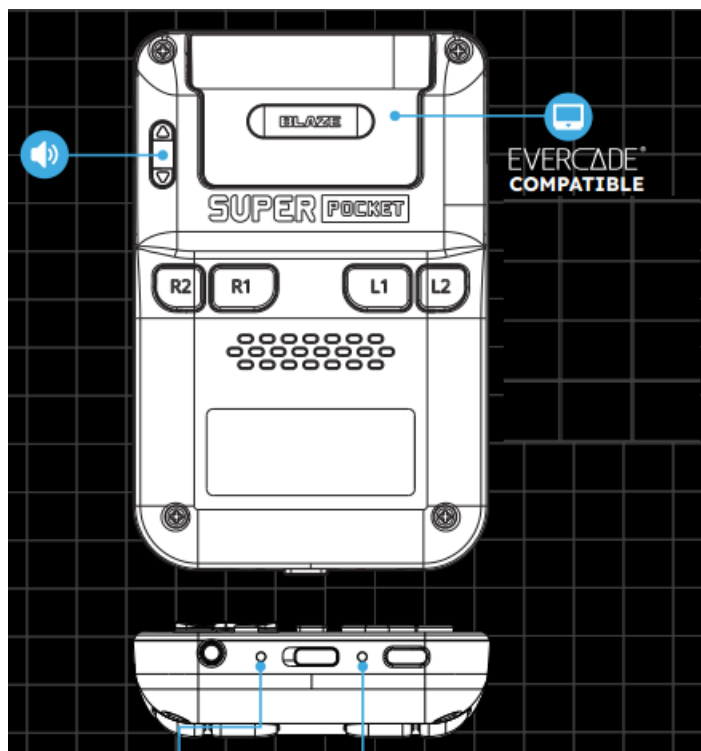

POWER ON

STEADY BLUE LIGHT

- **CHARGING**

STEADY RED LIGHT

- **CHARGED**

STEADY GREEN LIGHT

Arcade games only. Console game controls may vary. See in-game menu for game-specific controls.

DECLARATION OF CONFORMITY

HEREBY, BLAZE ENTERTAINMENT LTD, DECLARES THAT THE RADIO EQUIPMENT TYPE WLAN IS IN COMPLIANCE WITH DIRECTIVE 2014/53/EU. THE FULL TEXT OF THE EU DECLARATION OF CONFORMITY IS AVAILABLE AT THE FOLLOWING INTERNET ADDRESS: HYPERMEGATECH.COM/SUPPORT

ELECTRICAL SAFETY & GUIDANCE

A COMPATIBLE USB AC ADAPTER (NOT INCLUDED) IS REQUIRED TO USE THIS CONSOLE. USE A 5V/1-3A OUTPUT AC ADAPTER WITH A USB PORT.

WARNING!

IF YOU HAVE A HISTORY OF EPILEPSY OR SEIZURES, CONSULT A DOCTOR BEFORE USE. CERTAIN PATTERNS MAY TRIGGER SEIZURES WITH NO PRIOR HISTORY.

CONSOLE CARTRIDGES INCLUDING

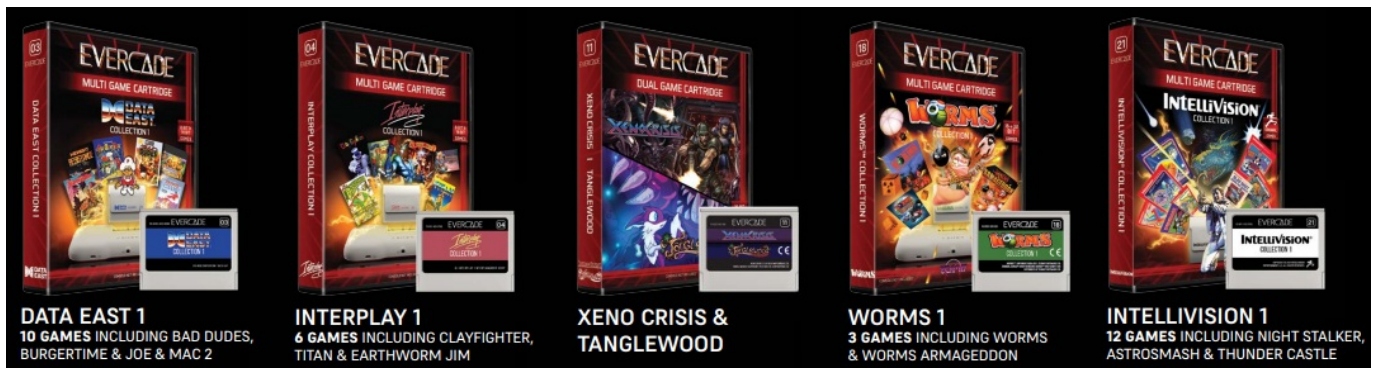

DATA EAST 1

10 GAMES INCLUDING BAD DUDES, BURGERTIME & JOE & MAC 2

INTERPLAY 1

6 GAMES INCLUDING CLAYFIGHTER, TITAN & EARTHWORM JIM
XENO CRISIS & TANGLEWOOD

WORMS 1

3 GAMES INCLUDING WORMS & WORMS ARMAGEDDON



- **THE BITMAP BROTHERS 1**

5 GAMES INCLUDING SPEEDBALL & THE CHAOS ENGINE

- **RENOVATION 1**

12 GAMES INCLUDING VALIS, GAIARES & EL VIENTO

- **DUKE NUKEM 1**

3 GAMES INCLUDING EXCLUSIVE DUKE NUKEM 1+2 REMASTERED

- **INDIE HEROES 3**

13 GAMES INCLUDING DONUT DODO, BIG2SMALL & CHEW CHEW MIMIC

12+ ARCADE CARTRIDGES INCLUDING



- **Gaelco Arcade 1**

6 GAMES INCLUDING ALLIGATOR HUNT, WORLD RALLY & THUNDER HOOP

- **Jaleco Arcade 1**

8 GAMES INCLUDING ROD LAND, SAINT DRAGON & AVENGING SPIRIT

- **Irem Arcade 1**

6 GAMES INCLUDING MOON PATROL, 10-YARD FIGHT & R-TYPE

- **Toaplan Arcade 1**

8 GAMES INCLUDING TIGER-HELI, ALCON & SNOW BROS.

8+ HOME COMPUTER CARTRIDGES INCLUDING...



THEC64 1

14 GAMES INCLUDING SUMMER GAMES, JUMPMAN & LEE

TEAM17 1

10 GAMES INCLUDING ALIEN BREED, BODY BLOWS & KINGPIN

DELPHINE SOFTWARE 1

4 GAMES INCLUDING FUTURE WARS, ANOTHER WORLD & FLASHBACK

HOME COMPUTER HEROES

7 GAMES INCLUDING PLANET X2, FARMING SIMULATOR & TANKS FURRY

VISIT EVERCADE.CO.UK VISIT EVERCADE.CO.UK/CARTRIDGES/CARTRIDGES

©Blaze Entertainment Limited. Copyright and trademarks are exclusive property of their respective owners. All rights reserved.

Frequently Asked Questions

- **How do I know if my console is fully charged?**

A fully charged console will display a steady green light indicator.

- **Where can I find game-specific controls?**

Game-specific controls can be found in the in-game menu. Navigate through the menu options to access control information for each game.

- **What type of power adapter should I use with the console?**

For optimal performance, use a compatible USB AC adapter with a 5V/1-3A output and a USB port.

Documents / Resources

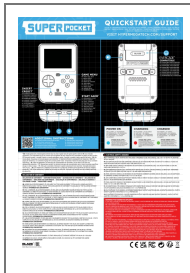

[Hyper Mega Tech Super Pocket Atari Edition](#) [pdf] User Guide
Super Pocket Atari Edition, Pocket Atari Edition, Atari Edition

References

- [User Manual](#)

[Manuals+.](#) [Privacy Policy](#)

This website is an independent publication and is neither affiliated with nor endorsed by any of the trademark owners. The "Bluetooth®" word mark and logos are registered trademarks owned by Bluetooth SIG, Inc. The "Wi-Fi®" word mark and logos are registered trademarks owned by the Wi-Fi Alliance. Any use of these marks on this website does not imply any affiliation with or endorsement.