



HYDRO X SERIES RGB CPU Water Block XC7 RGB Installation Guide

[Home](#) » [HYDRO X SERIES](#) » HYDRO X SERIES RGB CPU Water Block XC7 RGB Installation Guide 

Contents

1 RGB CPU Water Block XC7 RGB

1.1 IMPORTANT NOTICE

1.2 PACKAGE CONTENTS

1.3 PREREQUISITES (NOT INCLUDED)

1.4 INTEL INTEL

1.5 INSTALLING AMD AM4 MOUNTING BRACKET

1.6 AMD AM4 INSTALLATION GUIDE

1.7 OPTIONAL BRACKET ORIENTATION

1.8 FITTING AND TUBING INSTALLATION

1.9 CONNECTING AND USING THE INTEGRATED DIGITAL RGB ILLUMINATION

1.10 CONNECTING THE WATER BLOCK RGB LIGHTING TO THE MOTHERBOARD

1.11 FREQUENTLY ASKED QUESTIONS FOIRE AUX QUESTIONS

2 Documents / Resources

2.1 References

3 Related Posts

RGB CPU Water Block XC7 RGB



XC7 RGB SOCKET 1200 / AM4

WEB: corsair.com PHONE: (888) 222-4346 SUPPORT: support.corsair.com

BLOG: corsair.com/blog FORUM: forum.corsair.com YOUTUBE: youtube.com/corsairhowto

© 2018 – 2020 CORSAIR MEMORY, Inc. All rights reserved. CORSAIR and the

sails logo are registered trademarks in the United States and/or other countries. All other trademarks are the property of their respective owners. Product may vary slightly from those pictured. 49-002088 AA

XC7 RGB
SOCKET 1200 / AM4
RGB CPU Water Block

IMPORTANT NOTICE

- AVIS IMPORTANT

This Quick Start Guide is a general installation guide and does not cover specifics of various motherboard makes and models.

CORSAIR recommends you thoroughly leak-test your custom cooling system for at least 24 hours to ensure that the system is securely sealed and operating reliably. CORSAIR warranty does not cover any hardware damage resulting from poorly executed, improper and otherwise hasty assembly of your custom water-cooling system. Disassembly of CORSAIR HYDRO X products is highly discouraged due to complex design of components. Such action may result in irreparable mechanical, electrical or chemical damage that may void the warranty. For an exact and up-to-date product compatibility list, please refer to CORSAIR website.

PACKAGE CONTENTS

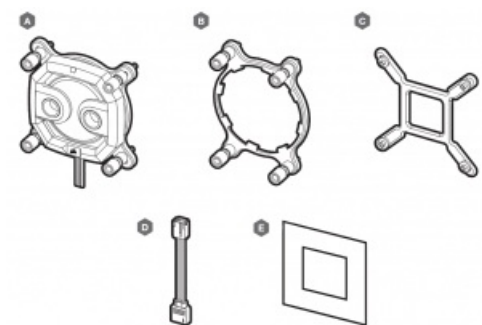

A — x1 XC7 RGB WATER BLOCK WITH INTEL LGA 1200 MOUNTING BRACKET

B — x1 AMD AM4 MOUNTING BRACKET

C — x1 INTEL LGA-1200 CPU BACKPLATE

D — x1 RGB ADAPTER CABLE E — x1 AM4 BACKPLATE ADHESIVE

PREREQUISITES (NOT INCLUDED)

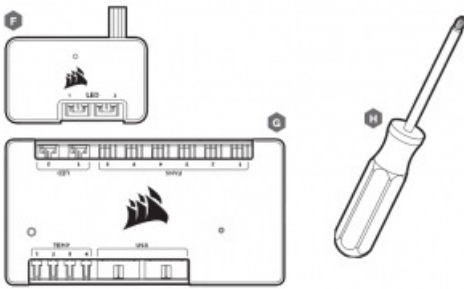

F — CORSAIR LIGHTING NODE PRO

G — CORSAIR iCUE COMMANDER PRO

H — PHILLIPS HEAD SCREWDRIVER (ONLY FOR AM4 SOCKET)

Note: CORSAIR iCUE Commander PRO or CORSAIR Lighting Node PRO are required for driving and controlling the RGB LED illumination.

INTEL INTEL

The XC7 RGB may be installed in any direction, there is no performance penalty for installing the product rotated by 90° or 180°.

- Remove protective film from the self-adhesive side on (C) INTEL LGA-1200 CPU BACKPLATE.
- Place the backplate with the self-adhesive side behind the motherboard. Align the holes as in the diagram below.
- Remove the TIM protective cover from the underside of the water block. Avoid touching the thermal interface material.
- Place the XC7 RGB with pre-installed LGA-1200 MOUNTING BRACKET onto the motherboard (Figure 1).
- Secure the XC7 RGB onto the motherboard by tightening the screws by hand until you reach the end of the thread. Tighten the screws evenly, preferably in a cross-pattern (Figure 2).

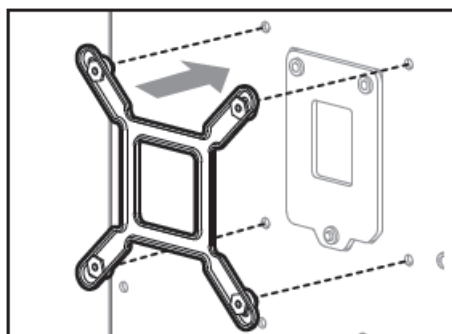
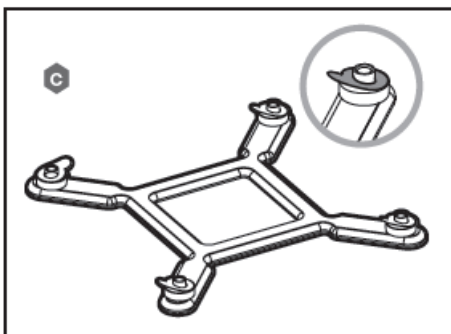

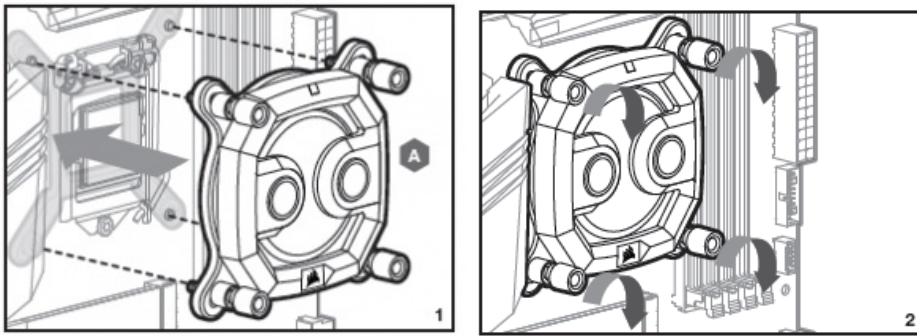

INSTALLING AMD AM4 MOUNTING BRACKET

In order to use the XC7 RGB on the AMD AM4 platform it is necessary to replace the Intel LGA-1200 bracket with the AMD AM4 bracket supplied in the package.

- Pull the bracket upwards towards the cover.
- Rotate it slightly clockwise until it stops (1/16 of a full turn).
- Separate the water block from the bracket by pulling the bracket downwards past the water block cold plate.
- Now install the AM4 bracket in reverse order and preferred orientation. Align the AM4 bracket tabs with the cut-outs and press it upwards.
- Rotate it counter-clockwise until it stops (1/16 of a full turn). · Press it down in the slot. You will feel the bracket locking in the slot.

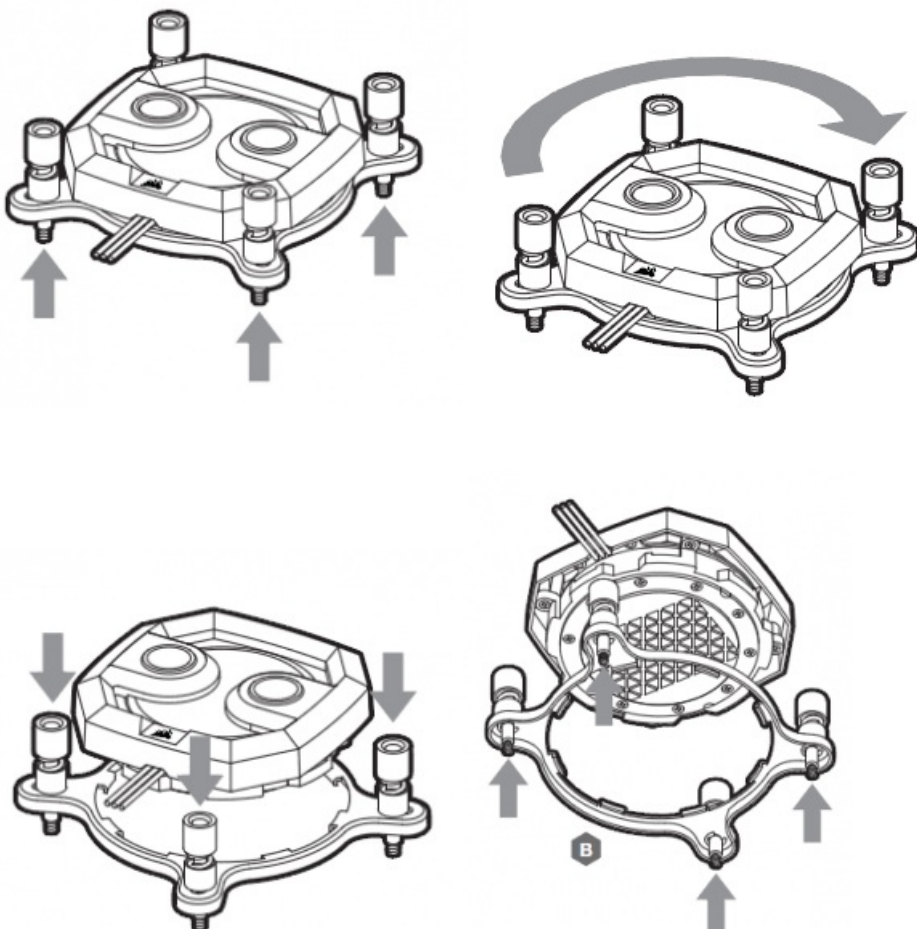

- The XC7 RGB may be installed in any direction, there is no performance penalty for installing the product rotated by 90° or 180°. Remove the original heat sink latching mechanism from your AM4 motherboard by unscrewing four Phillips-head screws holding the assembly together and leave the original backplate as is!
- OPTIONAL: If the original backplate does not stick to the motherboard (i.e. has no adhesive side), please use the included dual-sided tape to secure the original backplate to the motherboard as shown in Figure 1. E
- Place the XC7 RGB with the pre-installed original AM4 backplate onto the motherboard.
- Secure the XC7 RGB onto the motherboard by tightening the screws by hand until you reach the end of the thread. Tighten the screws evenly, preferably in a cross-pattern.

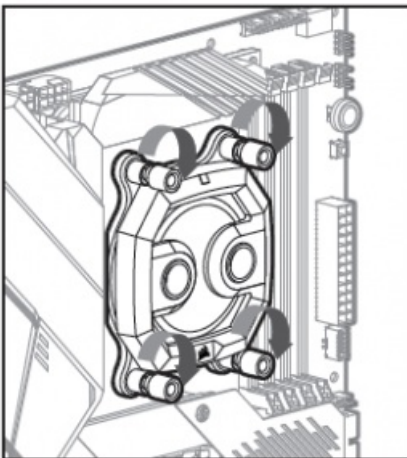
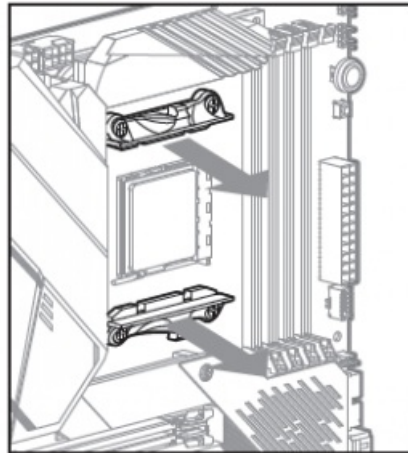
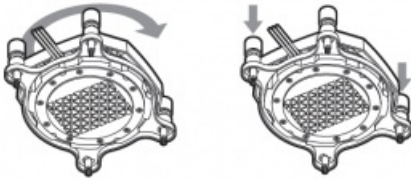

OPTIONAL BRACKET ORIENTATION

Be advised that for mechanical and aesthetic reasons you may install the XC7 RGB rotated by 45° (in any direction) as shown below.

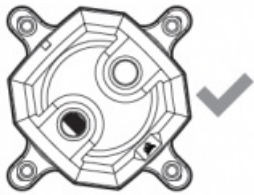
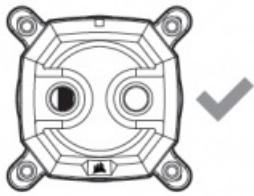

FITTING AND TUBING INSTALLATION

- Install the two (2) appropriate CORSAIR XF G1/4" BSPP threaded-type fittings (not included) into the water block ports and tighten them by hand. Note the prescribed INLET and OUTLET as shown on the image below. Note that INLET is always located on the tip of the triangle-shaped inlet channel.
- Install the appropriate tubing for your CORSAIR XF fitting type and secure it by locking the ring to finalize installation of the water block to the water-cooling loop. Use the appropriate securing method and tubing when using fittings other than compression fittings. Do not forget to leak test the system.

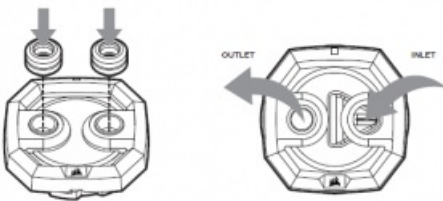

CONNECTING AND USING THE INTEGRATED DIGITAL RGB ILLUMINATION

A CORSAIR iCUE Commander PRO or Lighting Node PRO (either one) is required in order to use the integrated RGB illumination on the XC7 RGB Water Block. CORSAIR iCUE software is used to program the visual effects. The XC7 RGB Water Block can be connected to the appropriate CORSAIR controller either directly or “daisy”-chained with other CORSAIR HYDRO X product(s) with addressable RGB lighting.

Please note that due to the absence of a daisy chain connector, the XC7 RGB should be the last link in the chain!

- Install the appropriate tubing for your CORSAIR XF fitting type and secure it by locking the ring to finalize installation of the water block to the water-cooling loop. Use the appropriate securing method and tubing when using fittings other than compression fittings. Do not forget to leak test the system.
- Identify the correct RGB connector on the water block.
- Insert the RGB connector in a CORSAIR iCUE Commander PRO port or Lighting Node PRO port.
- Download and install CORSAIR iCUE software suite from the following website: www.corsair.com/icue. Configure visual and lighting effects by following the manual for iCUE software.

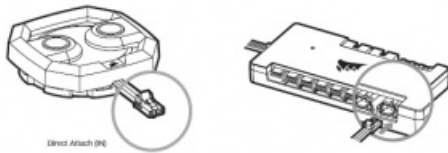

CONNECTING THE WATER BLOCK RGB LIGHTING TO THE MOTHERBOARD

- Connect the XC7 RGB male connector into the RGB ADAPTER CABLE female connector.
- Connect the RGB ADAPTER CABLE female connector into the Digital RGB header on the motherboard. Make sure the arrow on the RGB ADAPTER CABLE is plugged into +5V on the motherboard.

By using the motherboard adapter it is not possible to control the RGB illumination with iCUE software.

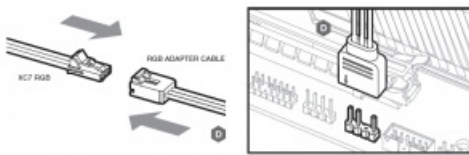

FREQUENTLY ASKED QUESTIONS FOIRE AUX QUESTIONS

1. Is this XC7 RGB Water Block compatible with my motherboard? The product supports most of the LGA-1200 and AM4 motherboards on the market with a few exceptions which are mostly Mini-ITX form factor motherboards. Please consult corsair.com for an up-to-date list of unsupported models prior to installation!
2. Is this XC7 RGB Water Block compatible with older Intel® platforms? Yes, this XC7 RGB is physically compatible with older Intel® socket types, such as LGA-1150, -1151, -1155 and -1156.
3. Can I use XC7 RGB Water Block as a standalone part? No, this is a water-cooling cold plate for your CPU which requires a complete custom water-cooling system, including a standalone pump and a radiator. For more information, please visit corsair.com.
4. Can I use the XC7 RGB Water Block with aluminium water-cooling equipment? No, you cannot! The cold plate is made from nickel-plated copper and should not be mixed with aluminium.
5. Is the flow direction important? Yes, it is. XC7 RGB Water Block works best with coolant entering via the labelled INLET port. However, the product will operate with reversed flow direction, albeit with reduced performance.
6. Can I reuse the pre-applied thermal paste on XC7 RGB Water Block for re-installation? Re-installation of the XC7 RGB Water Block will require you clean off the pre-applied thermal paste and apply a new layer of thermal paste.
7. Can I connect the RGB header directly to my motherboard? Yes you can using the included RGB ADAPTER CABLE. See page 19 – CONNECTING THE WATER BLOCK RGB LIGHTING TO THE MOTHERBOARD.
8. How many RGB devices can I daisy-chain to a single channel on a CORSAIR controller? CORSAIR recommends you connect no more than three (3) Hydro X Series RGB devices of any type connected in a series on a single channel. However, you can connect one (1) XC7/XC9 water block, two (2) XG7 RGB water blocks and one (1) XD5 RGB pump unit for a total of four (4) devices. Please note that due to the absence of a daisy chain connector, the XC7 RGB should be the last link in the chain. Do not mix CORSAIR fans or RGB LED strips and CORSAIR HYDRO X products on the same channel on the controller. Use a dedicated channel

for other components.

This device complies with Part 15 of the FCC Rules. Operation is subject to the following two conditions: (1) This device may not cause harmful interference, and (2) this device must accept any interference received, including interference that may cause undesired operation.

This equipment has been tested and found to comply with the limits for a Class B digital device, pursuant to Part 15 of the FCC Rules. These limits are designed to provide reasonable protection against harmful interference in a residential installation. This equipment generates, uses and can radiate radio frequency energy and, if not installed and used in accordance with the instructions, may cause harmful interference to radio communications. However, there is no guarantee that interference will not occur in a particular installation. If this equipment does cause harmful interference to radio or television reception, which can be determined by turning the equipment off and on, the user is encouraged to try to correct the interference by one of the following measures:

- Reorient or relocate the receiving antenna.
- Increase the separation between the equipment and receiver.
- Connect the equipment into an outlet on a circuit different from that to which the receiver is connected.
- Consult the dealer or an experienced radio/TV technician for help.

FCC Caution: Any changes or modifications not expressly approved by the party responsible for compliance could void the user's authority to operate this equipment.

This Class B digital apparatus meets all requirements of the Canadian Interference-Causing Equipment Regulations. CAN ICES-3(B)/NMB-3(B)

Documents / Resources

	HYDRO X SERIES RGB CPU Water Block XC7 RGB [pdf] Installation Guide RGB CPU Water Block XC7 RGB, SOCKET 1200 AM4
---	---

References

- [PC Components | Gaming Gear | CORSAIR](#)
- [PC Components | Gaming Gear | CORSAIR](#)
- [Corsair Blog - Corsair Community](#)
- [Corsair](#)
- [Home - Corsair Community](#)
- [iCUE Software | Drivers | Software | CORSAIR](#)