



hyco Flow Through Valve Kit with Inlet Group for Powerflow Installation Guide

[Home](#) » [hyco](#) » hyco Flow Through Valve Kit with Inlet Group for Powerflow Installation Guide 

Contents

- [1 hyco Flow Through Valve Kit with Inlet Group for Powerflow](#)
- [2 Installation Instruction](#)
- [3 Documents / Resources](#)
- [4 Related Posts](#)



hyco Flow Through Valve Kit with Inlet Group for Powerflow



Installation Instruction

Assemble the vessel, t – piece and flow through valve as shown in figure 1.

Screw the flow through valve as far into the t – piece as it will go and then turn back if necessary to achieve the orientation shown.

PTFE tape or similar will be required to seal on the threads of both the vessel and the flow through valve.

Orientation is important, the flow through valve water diverter paddle should be at a 90° angle to the tube as shown in figure 2.

For full installation including inlet group see figure 3.

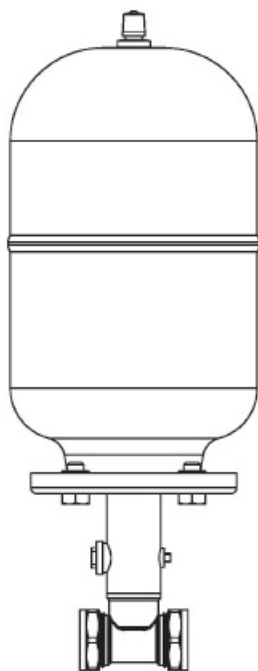

figure 1

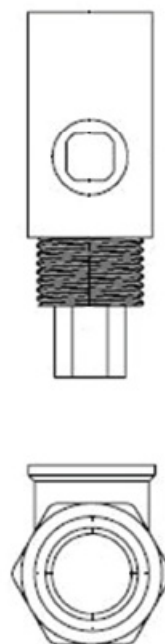

figure 2

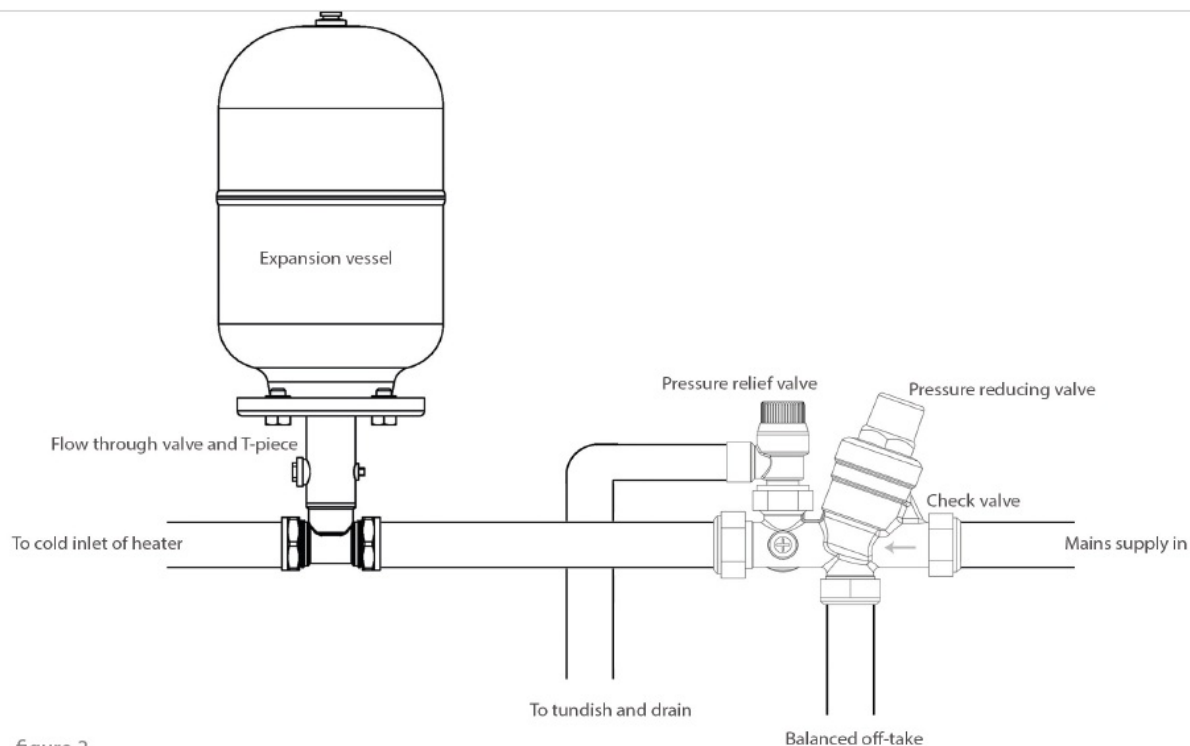

figure 3



Documents / Resources

<p>Product Installation Guide Flow Through Valve Kit with Inlet Group for Powerflow</p> <p>hyco</p>	<p>hyco Flow Through Valve Kit with Inlet Group for Powerflow [pdf] Installation Guide Flow Through Valve Kit with Inlet Group for Powerflow, Flow Through Valve Kit, Inlet Group for Powerflow, Through Valve Kit, Valve Kit</p>
---	---