

**HUTT**  
**W8**

# Window Cleaning Robot



## HUTT W8 Window Cleaning Robot User Guide

[Home](#) » [HUTT](#) » HUTT W8 Window Cleaning Robot User Guide 

### Contents

- [1 HUTT W8 Window Cleaning Robot](#)
- [2 Specifications](#)
- [3 INSTALLATION INSTRUCTIONS](#)
- [4 PRODUCT USING INSTRUCTIONS](#)
- [5 After-sales Service](#)
- [6 FAQs](#)
- [7 Documents / Resources](#)
  - [7.1 References](#)



**HUTT W8 Window Cleaning Robot**



## Specifications

- **Product:** HUTT W8 Window Cleaning Robot
- **Components:** Main Unit, Cleaning pad, Remote control, Water bottle, Safety rope, Power adapter, Plug, User manual

## INSTALLATION INSTRUCTIONS

### 1. ATTACH THE CLEANING PAD

- Attach a clean pad to the device. Make sure it is smooth and tight.

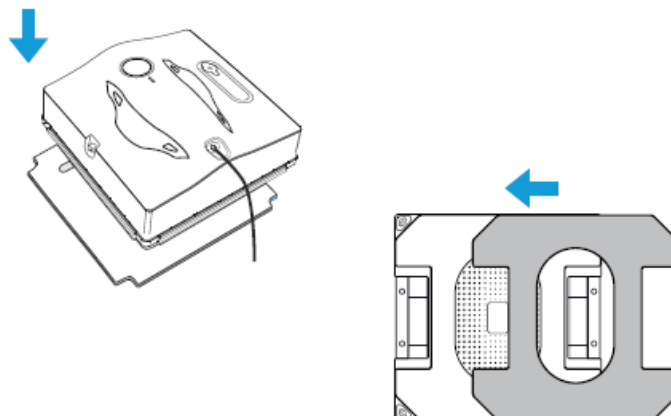

### 2. FILL IN CLEANING AGENT

- Open the pot of the water tank, fill in an appropriate amount of pure water or special glass cleaner. If necessary, use the enclosed filling aid. Close the water tank tightly again.

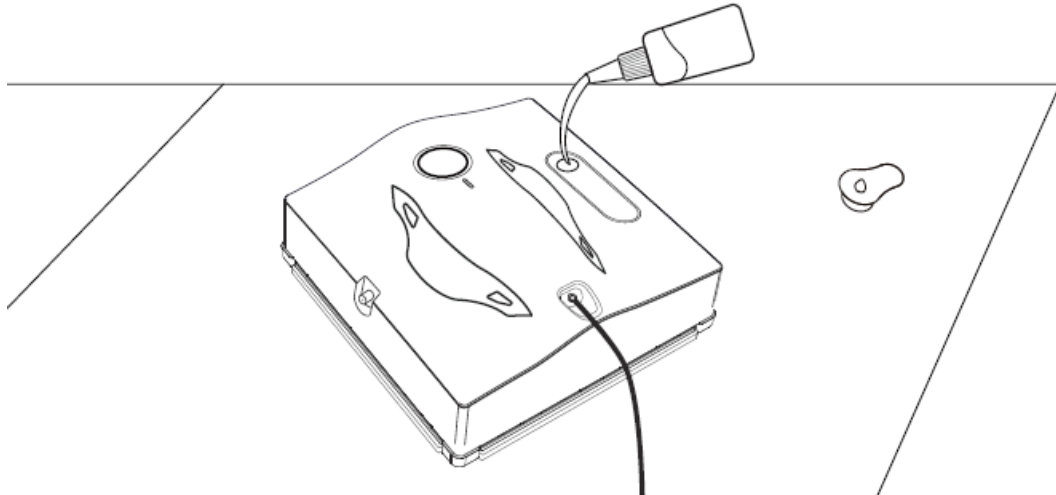

### 3. CONNECT TO THE POWER

- Connect the adapter and the power plug as shown in the sequence below. Finally, insert the plug into the power socket.
- **Caution!** Improper connection can cause damage to the device.

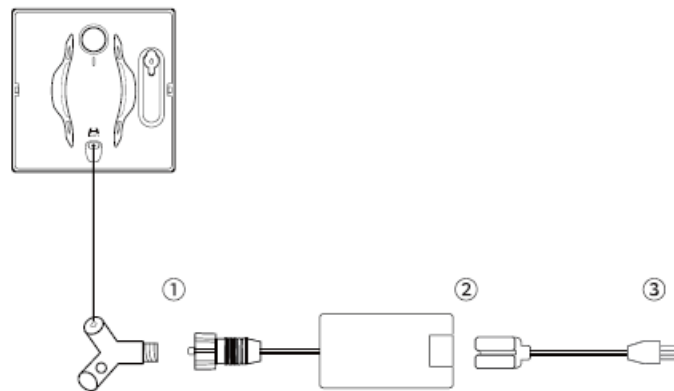

### 4. ATTACH THE SAFETY ROPE

- The safety rope is intended for use at high-rise windows. Check the rope for damage before use. Then attach it to a solid object.

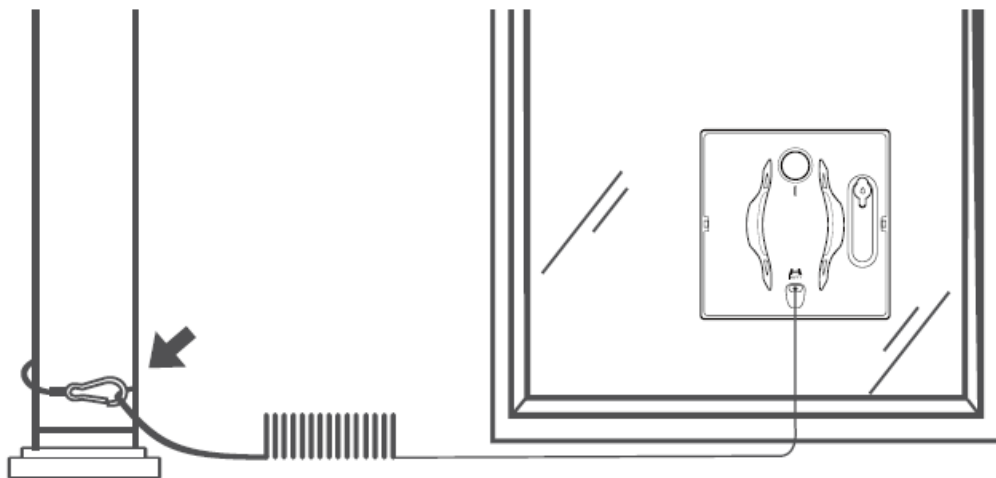

### 5. START CLEANING

- To start the cleaning process, place the device in the center of the window.
- Press and hold the power button for 3 seconds to turn on the device. Check that the device is securely attached to the glass.
- Briefly press the power button again to start the cleaning process.

- Press and hold the power button for more than 1 second

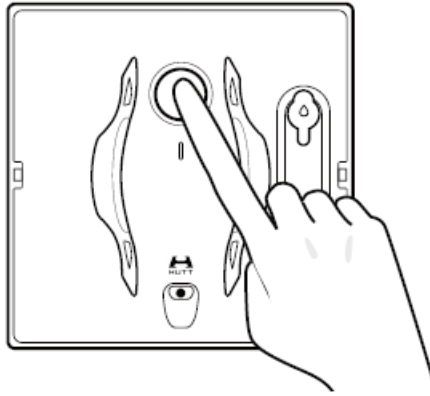

- When the cleaning process is finished, the device returns to the starting point by itself.
- Grasp the device and press the power button for 3 seconds until the device turns off.
- Remove the unit from the glass, check the degree of soiling of the pad and wheels, and clean them if necessary before further use. Top up with water if necessary.

## 6. NOTE & CAUTION

- **Note:** For heavily soiled windows, it is recommended to spray some window cleaner on the window before use. Replace the cleaning pad in time once it gets dirty, and run the device the second pass with the water spray off to remove streaks, if any.
- **Caution!** Do not leave the device on the window longer than necessary to avoid damage. Be sure to hold the device tightly when you turn it off to avoid accidental dropping.

## PRODUCT USING INSTRUCTIONS

### • Applicable Scenes

- Works on vertical smooth surfaces such as rectangular/ square windows, shower glass or marble walls. Works on minimum window size 16in x 24in with a cord length of 19ft, best working length 16ft. Extension cord is available by contacting a customer specialist.

### • Scenes Not Applicable

- Not applicable to arched, triangular, and other irregular windows;
- Not applicable to horizontal surfaces such as floor, kitchen islands, desks etc.

### • Choices of Cleaners

- Pure water, plain water, diluted white vinegar, diluted glass cleaner are recommended.
- Use with Caution, It May Cause An Accidental Fall
- Be cautious to use on windows with a thin frame lower than 6mm
- Be cautious to use on windows with a sloping frame
- Be cautious to use on glue-edged windows
- Be cautious to use on tinted / textured windows

### • To Avoid Accidental Droppings

1. Avoid using the robot on non-applicable surfaces mentioned above.
2. Fix the safety rope well when using the robot on high-rise windows.
3. When working on exterior windows, place warning sign under the operating surface.
4. If you are not sure whether the robot is applicable to your windows, place protective pads underneath is necessary.

### • To Avoid Skidding On The Glass

1. Replace the dirty pads in time
2. Clean the crawling wheels in need
3. Avoid over wetting the windows manually

- **Maintenance**

1. After each use, empty the water tank before storage.
2. After each use, wash the dirty pads, keep them flat and let dry.
3. After each use, clean the crawling wheels with a wet wipe manually.
4. Charge the robot every other month if not use for a long time.

## **After-sales Service**

If you have any questions regarding using your W8, please contact our support team, our friendly customer specialist will be more than happy to assist you.

[support@huttwisdom.com](mailto:support@huttwisdom.com)

### **1. Product Warranty**

- 30 days free return & replacement
- 12 months warranty and free after-sales service
- Contact us if you need an extended warranty period

### **2. Return & Replacement**

- Contact us for easy return and replacement services. We will have you covered even if your purchase exceeds the warranty period.

### **3. New product trial**

- If you wish to be a HUTT brand product trial officer, you may contact us for the latest new product trial plan.
- Thank you for choosing HUTT products!
- [www.huttwisdom.com](http://www.huttwisdom.com)
- Beijing · China

## **FAQs**

- **Q: Can I replace the non-replaceable batteries in the appliance?**
  - **A:** No, the appliance contains non-replaceable batteries. Only use the detachable supply unit provided for recharging.
- **Q: How do I switch between dry-wiping and wet-wiping modes?**
  - **A:** For dry-wiping, use the dry cleaning pad, and for wet-wiping, start the machine with a wet cleaning pad installed.
- **Q: What should I do after completing the cleaning process?**
  - **A:** Drain water from the water tank and replace the used cleaning pad with a clean one or leave the machine without a cleaning pad.

## **Documents / Resources**

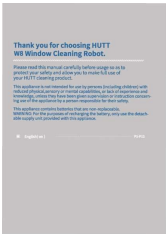

[HUTT W8 Window Cleaning Robot](#) [pdf] User Guide  
W8, W8 Window Cleaning Robot, W8, Window Cleaning Robot, Cleaning Robot

References

- [User Manual](#)

[Manuals+](#), [Privacy Policy](#)

This website is an independent publication and is neither affiliated with nor endorsed by any of the trademark owners. The "Bluetooth®" word mark and logos are registered trademarks owned by Bluetooth SIG, Inc. The "Wi-Fi®" word mark and logos are registered trademarks owned by the Wi-Fi Alliance. Any use of these marks on this website does not imply any affiliation with or endorsement.