

# HUIYEETEX DD2702H Programming Multi Channel Remote Control



## HUIYEETEX DD2702H Programming Multi Channel Remote Control Instruction Manual

[Home](#) » [HUIYEETEX](#) » HUIYEETEX DD2702H Programming Multi Channel Remote Control Instruction Manual 

### Contents

- [1 HUIYEETEX DD2702H Programming Multi Channel Remote Control](#)
- [2 FAQ](#)
- [3 Tool Required](#)
- [4 Image Of The Multi-channel Remote](#)
- [5 Technical Specification](#)
- [6 Set Number Of Channels](#)
- [7 Switch Between One-way & Two-way Mode](#)
- [8 FCC](#)
- [9 Documents / Resources](#)
  - [9.1 References](#)
- [10 Related Posts](#)

# HUIYEETEX

HUIYEETEX DD2702H Programming Multi Channel Remote Control



## FAQ

### **Q: What should I do if the remote control stops working?**

A: Check the battery voltage; if it's less than 2.6V, replace the battery. Also, ensure the battery compartment is securely closed.

### **Q: How can I maximize the battery life?**

A: Remove batteries from equipment not used for an extended period and always secure the battery compartment properly.

### **Q: What should I do in case of RF exposure?**

A: This equipment complies with FCC limits for radiation exposure. Do not co-locate or operate it with other antennas or transmitters.

### **Q: How can I dispose of used batteries?**

A: Remove and recycle used batteries according to local regulations. Do not dispose of them in household trash or incinerate.

## Tool Required

A slim card pin or mini screwdriver or a fine needle

## Image Of The Multi-channel Remote

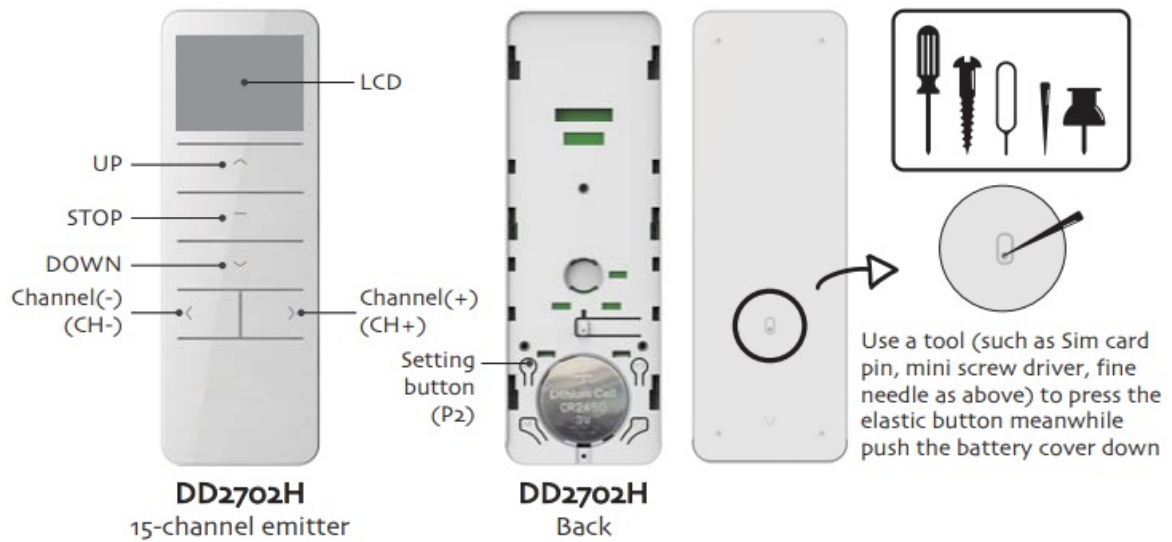

## Technical Specification

- Battery: 3V DC (CR2450)
- Radiofrequency: 433.92MHz
- Battery life: >2 years
- Working temperature: -10 C~50 C
- Radio range: 200 meters outdoor, 35 meters indoor

## **INGESTION HAZARD: This product contains a button cell or coin battery.**

1. Remove and immediately recycle or dispose of used batteries according to local regulations and keep away from children.  
Do NOT dispose of batteries in household trash or incinerate.
2. Even used batteries may cause severe injury or death.
3. Call a local poison control center for treatment information.
4. Non-rechargeable batteries are not to be recharged.
5. Do not force discharge, recharge, disassemble, heat above (40°C) or incinerate. Doing so may result in injury due to venting, leakage or explosion resulting in chemical burns.
6. Ensure the batteries are installed correctly according to polarity (+ and -).
7. Do not mix old and new batteries, different brands or types of batteries, such as alkaline, carbon-zinc, or rechargeable batteries.
8. Remove and immediately recycle or dispose of batteries from equipment not used for an extended period of time according to local regulations.
9. Always completely secure the battery compartment. If the battery compartment does not close securely, stop using the product, remove the batteries, and keep them away from children.
10. Emitter couldn't expose to moisture or be struck heavily, or else the emitter life will be affected.
11. If the emitter is not so sensitive or the radio range becomes shorter, pls check whether to change the battery.
12. If the voltage is less than 2.6V, there will be a low voltage indication.
13. Under uni-directional mode, if you press any button more than 20S, while under bi-directional mode, you press any button 5S, the emitter will stop sending radio signals.

## Set Number Of Channels

Follow below steps to set number of channels.

1. Press and hold CH+&CH- at the same time until “C” (for “change”) is displayed
2. Press CH+ or CH- to select the max. number of channels (from 1 to 15)
3. Press STOP, “OK” (for “ok”) is displayed to confirm the setting is completed



## Switch Between One-way & Two-way Mode

The remote is by default in two-way mode, to switch between one-way or two-way mode, please see below steps:

1. Remove battery
2. Press & hold P2 while putting the battery back in

Tips: for step 2, try to hold the remote with screen facing you, if “1” is displayed, one-way mode is activated, if “2” is displayed, two way mode is activated.



## FCC

### RF exposure statement

This equipment complies with the FCC radiation exposure limits set forth for an uncontrolled environment. This transmitter must not be co-located or operating in conjunction with any other antenna or transmitter.

### FCC Warning

This device complies with Part 15 of the FCC Rules. Operation is subject to the following two conditions:

1. This device may not cause harmful interference, and
2. this device must accept any interference received, including interference that may cause undesired operation.

**Note:** This equipment has been tested and found to comply with the limits for a Class B digital device, pursuant to part 15 of the FCC Rules. These limits are designed to provide reasonable protection against harmful interference in a residential installation. This equipment generates, uses and can radiate radio frequency energy and, if not

installed and used in accordance with the instructions, may cause harmful interference to radio communications. However, there is no guarantee that interference will not occur in a particular installation. If this equipment does cause harmful interference to radio or television reception, which can be determined by turning the equipment off and on, the user is encouraged to try to correct the interference by one or more of the following measures:

- Reorient or relocate the receiving antenna.
- Increase the separation between the equipment and receiver.
- Connect the equipment into an outlet on a circuit different from that to which the receiver is connected.
- Consult the dealer or an experienced radio/TV technician for help.

**NOTE 2:** Any changes or modifications to this unit not expressly approved by the party responsible for compliance could void the user's authority to operate the equipment.

## Documents / Resources

	<p><a href="#">HUIYEETEX DD2702H Programming Multi Channel Remote Control</a> [pdf] Instruction Manual 2BMF4DD2702H, DD2702H Programming Multi Channel Remote Control, DD2702H, Programming Multi Channel Remote Control, Multi Channel Remote Control, Remote Control, Control</p>
---	---

## References

- [User Manual](#)

[Manuals+](#), [Privacy Policy](#)

This website is an independent publication and is neither affiliated with nor endorsed by any of the trademark owners. The "Bluetooth®" word mark and logos are registered trademarks owned by Bluetooth SIG, Inc. The "Wi-Fi®" word mark and logos are registered trademarks owned by the Wi-Fi Alliance. Any use of these marks on this website does not imply any affiliation with or endorsement.