



# HUEDALW-2812WI Multi Zone LED Color Controller Installation Guide

[Home](#) » [HUEDA](#) » HUEDALW-2812WI Multi Zone LED Color Controller Installation Guide 

## Contents

- 1 HUEDALW-2812WI Multi Zone LED Color Controller
- 2 Product Information
- 3 Product Usage Instructions
- 4 SAFETY & WARNINGS
- 5 INCLUDED ITEMS IN BOX
- 6 REMOTE OPERATION
- 7 OPERATION OVERVIEW
- 8 INSTALLATION OVERVIEW
- 9 SETTING THE DMX ADDRESS
- 10 WIRING CONNECTIONS
- 11 MOUNTING
- 12 PINOUT CONNECTION GUIDE
- 13 DYNAMIC MODE CHART
- 14 TROUBLESHOOTING
- 15 SCAN QR CODE TO DOWNLOAD HUEDA™ APPLICATION
- 16 FEDERAL COMMUNICATIONS COMMISSION (FCC) STATEMENT
- 17 SYSTEM WIRING DIAGRAM
- 18 HUEDA™ APP WIFI CONNECTIVITY INSTRUCTIONS
- 19 Documents / Resources
  - 19.1 References

# HUEDA

**HUEDALW-2812WI Multi Zone LED Color Controller**



## Product Information

The HUEDATM Multizone LED Controller is a versatile device used for controlling LED lights. It is designed to work with a regulated constant voltage Class 2 power supply (12-24V DC Max) and is covered by a limited manufacturer warranty of 3 years. This controller should not be used with a dimmable or magnetic dimmable power source(driver). It is important to follow all safety guidelines and installation instructions provided.

## Safety & Warnings

- Only use a regulated constant voltage Class 2 power supply (12-24V DC Max) to power the controller.
- Failure to use the recommended power supply may cause fire or serious injury and will void the limited warranty.
- Ensure proper wire installation to prevent overheating and fire.
- Consult a qualified electrician for low voltage wiring.
- Install the controller only in the provided junction box.
- Do not install the controller with conductors of electric light or power.

## Included Items in Box

- 1 x HUEDATM Multizone LED Controller
- 1 x CAT5 Wire
- 1 x Instruction Manual

## Product Usage Instructions

### Operation Overview

The HUEDATM Multizone LED Controller offers various controls for RGBW lighting:

- RGBW Control: Press to turn ON/OFF Red, Green, Blue, and White color. Long press to adjust the brightness of individual colors.
- Power: Press to turn ON/OFF the device.
- H U E D A T M Color Wheel: Scroll through to find specific colors.
- Three Choices of White: Press to cycle through different shades of white.
- Brightness Control: Long press to increase/decrease brightness.
- Zone Control: Press to select/deselect zones 1-3.

- Dynamic Modes: Long press adjusts the speed of dynamic color changing mode.

## Installation Overview

- Install the controller in accordance with the NEC and local regulations.
- Ensure applicable wires are installed between all components, considering voltage drop, amp rating, and type to prevent fire or electric shock.
- Mount the controller using the included DMX controller wall box.
- Use a compatible 120 Volt Shallow Junction Box (Plastic) to wall mount the touch controller.
- Follow the provided instructions to set the DMX address.

## Wiring Connections

**DO NOT** connect the controller directly to 120VAC. Refer to the system diagram for a general system design. The wiring connections are as follows:

- GND: Ground connection
- Vin: Input voltage (12-24V)
- Data +: Positive data connection
- Data -: Negative data connection

Connect the wires from the 12-24V power supply to the DMX decoder or DMX fixture according to the provided instructions.

## Mounting

To mount the HUEDATM Controller:

1. Use a flathead screwdriver to pop off the faceplate of the controller.
2. Install the controller in the provided junction box.

**WARNING:** Never install the HUEDATM Controller with other high voltage junction boxes, as there is a risk of shock hazard. National Electric Code requires electrical conductors to be separated by a barrier within the box or in a separate box. Install only in the provided junction box.

BEFORE YOU BEGIN, READ ALL WARNINGS AND INSTALLATION INSTRUCTIONS.

## SAFETY & WARNINGS

- Securely mount the Hueda™ Controller
- This product is intended to be installed and serviced by a qualified licensed electrician. Install in accordance with the National Electric Code, and local regulations. Only power with a regulated (listed) constant voltage Class 2 power supply (12-24V DC Max). Failure to use a Class 2 power supply may cause fire or serious injury and will void the limited warranty. Never
- Est pride wits instale le we dier, ideal len contros in been. ven driver, fixture and any controls in between. When choosing wire, factor in voltage drop amperage rating and type (in-wall rated, Plenum rated, wet location rated,

etc.). Inadequate wire installation could overheat wires and cause fire.

- This product is rated for indoor installation and only for dry locations. Do not install in washrooms or areas near water (or the possibility of in the future).
- Do not modify this product beyond the instructions in this guide or the limited warranty will be voided.
- Wiring diagrams in this installation guide for basic installations. Please carefully review your installation before proceeding with a qualified electrician familiar with low voltage wiring.
- Never install the HUEDA™ Controller in with other high voltage Junction Box as there is a risk of shock hazard! National Electric Code requires electrical conductors to be separated by a barrier within the box or in a separate box!. Install only in the provided Junction box.

## **IMPORTANT NOTE**

- Install Hueda DMX controller in a separate box rated for Low voltage use. NEC codes requires conductors shall not be placed in any raceway, compartment, outlet box, junction box, or similar fitting with conductors of electric light or power.

## **WIRE ENDS:**

WIRE 6-8MM (0.25-0.30")

Exposed wire should not be more than 6- 8 mm long & solder tip (tinned). Do not allow Wires to cross and insure all exposed wire is fully inserted into the screw terminals. Hand tighten screw terminals. Use 24 to 18 AWG gauge wire for output terminals.

## **INCLUDED ITEMS IN BOX**

- CAT5 Wire
- Instructions

## **REMOTE OPERATION**

- The DMX controller can also be controlled remotely via wi-fi with a compatible(iOS versions > 8.0) iOS tablet or mobile device using our application "HUEDA".
- Please see our HUEDA™ web page for application instructions.



## OPERATION OVERVIEW

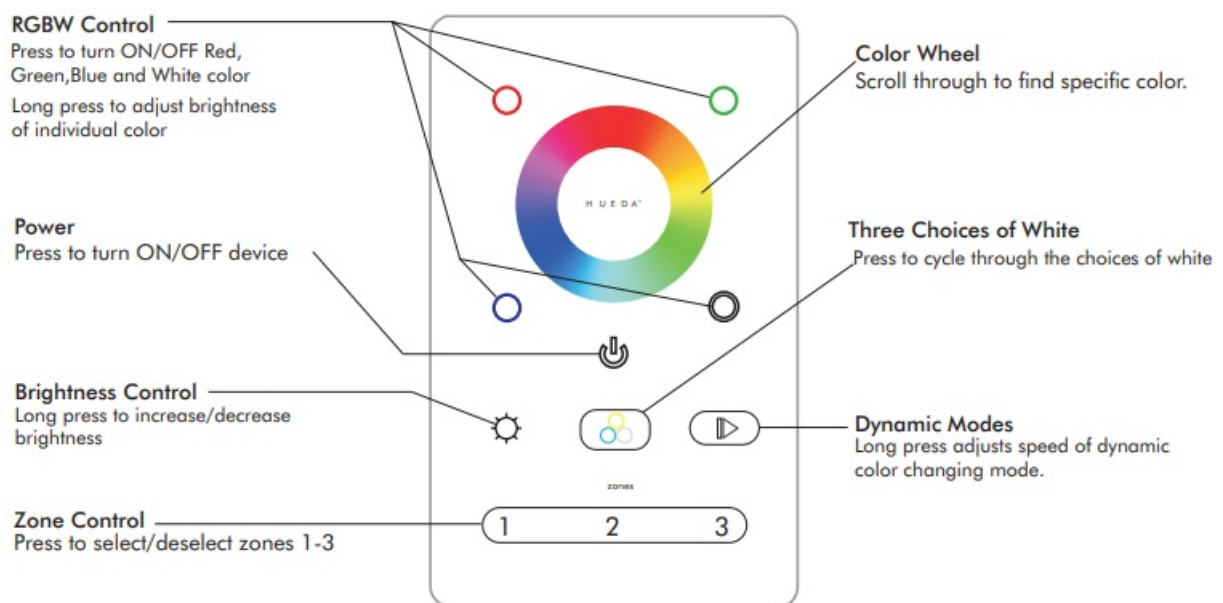

## INSTALLATION OVERVIEW

Install in accordance with the NEC and local regulations.

- Turn power OFF at main circuit breaker and verify the power is off.
- Determine an accessible locit for a comprible low volege driver to be installed between the main breaker and DMX controller. Determ a location to install additional accessories such as DMX decoders, fixtures etc. Ensure applicable wire is installed between all components.
- When choosing wire, factor in voltage drop, amp rating and type to prevent fire or electric shock.
- Remove the existing wall plate and switch. Pull switch from identify wires and disconnect from switch.
- Remove existing switch box from wall and install the included DMX controller switch box. Additional tools may be required to fit DMX controller switch box in the wall.
- Make wiring connections. See 'Wiring Connections' and 'Mounting Diagram' for additional information.

- Replace wiring back into switch box. Mount and align DMX decoders/fixtures. See 'Setting the DMX Address'.

## SETTING THE DMX ADDRESS

Please refer DMX Receiver instructions for setting the DMX address

## WIRING CONNECTIONS

DO NOT connect directly to 120VAC.

See 'System Diagram for a general system design.

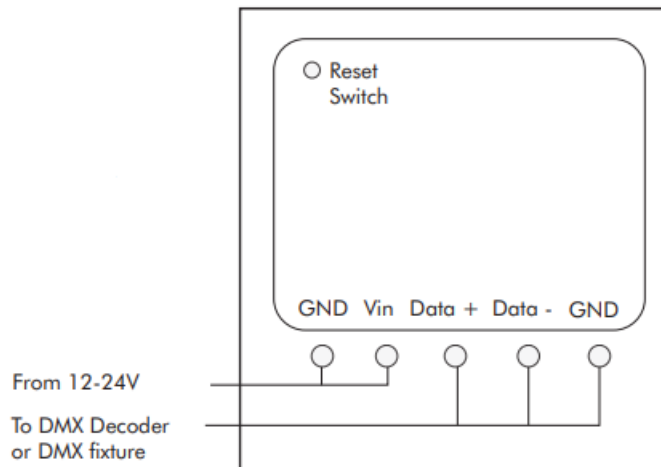

## MOUNTING

Install with the included DMX controller wall box.

Install with the included DMX controller wall box.

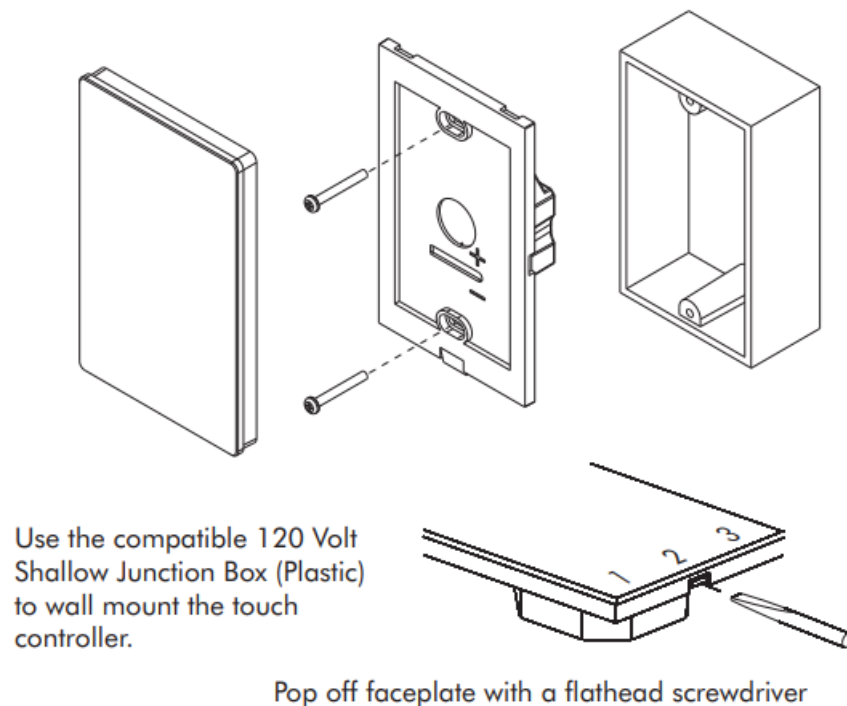

## WARNING

Never install the HUEDA\*™ Controller in with other high voltage Junction Box as there is a risk of shock hazzard! National Electric Code requires electrical conductors to be separated by a barrier within the box or in a separate

box!. Install only in the provided Junction box

PINOUT CONNECTION GUIDE

The following diagrams/tables indicate the appropriate connections for patching your own CAT5/RJ45, and XLR-3 splice cables. These diagrams are for general reference and may slightly differ between different cable manufacturers.

RJ45 568B Connection Pinout

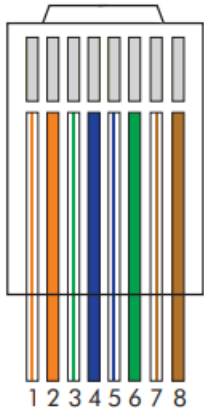

RJ45 568B Pinout Table

Pin No.	Wire Color	Function
1	White/Orange	Data +
2	Orange	Data -
3	White/Green	None
4	Blue	None
5	White/Blue	None
6	Green	None
7	White/Brown	May be used as 2nd ground
8	Brown	Ground

XLR-3 Connection Pinout

Female



Male



XLR-3 Pinout Table

Pin No.	Function
1	Ground
2	Data -
3	Data +

DYNAMIC MODE CHART



The Dynamic Mode tool plays factory-programmed scenes. Choose up to 10 different scenes. Short press switches/pauses the mode. Long press adjusts speed of the dynamic mode

Mode	Description
1	Full Color Fade #1
2	Reverse Rainbow Fade
3	Random Full Color Fade
4	7 Color Jump
5	RGB Fade In / Fade Out
6	RGB Fade In to Off
7	RGB On to Fade Out
8	RGB Jump
9	Full Color Fade #2
10	Pastel Color Fade In / Fade Out

TROUBLESHOOTING

For thorough troubleshooting of LED strip light and fixtures, see LED fixture installation guides.

LED fixtures not responding to touch

- Ensure the blue indicator light is on by pressing ‘Power Button’.
- Ensure the appropriate zone number was pressed prior to controlling the DMX decoder/fixture. For example, if you know the fixture is addressed to zone 1, press 1 prior to controlling.
- Ensure the individual zone has not been turned off. Pressing zones 1-3 will turn the specific zone ON/OFF. Additionally, long pressing R, G, B, W will increase/decrease individual brightness and tapping will turn R, G, B, W ON/OFF.
- Ensure the DMX decoder/fixture is addressed properly. For example, address ‘001’ will respond to zone 1 of the controller.
- See ‘Setting the DMX Address’ on page-2 for additional addressing information.

## LED fixture responding incorrectly

- Ensure all wiring connections are correct. Reversing the Data + and Data – will cause lights to flicker and not respond to controller.
- Power connections of all components (drivers, DMX decoders/fixtures, DMX controller).
- DMX Data connections -see 'Pinout Connection Guide' and 'System Diagram' for Rj45 hard-wiring connections.
- DMX decoder PWM output connections -see 'System Wiring Diagram for CH 1-4 connections

## SCAN QR CODE TO DOWNLOAD HUEDA™ APPLICATION

Download  
HUEDA App  
From  
IOS App Store



## FEDERAL COMMUNICATIONS COMMISSION (FCC) STATEMENT

- This device complies with part 15 of the FCC rules. Operation is subject to the following two conditions:
- This device may not cause harmful interference.
- This device must accept any interference received, including interference that may cause undesired operation.
- **Note:** The manufacturer is not responsible for any radio or tv interference caused by unauthorized modifications to this equipment. Such modifications will void the user's authority to operate the equipment and warranty.

## SYSTEM WIRING DIAGRAM

The following wiring diagram is as an example system connectivity. CAT5 (RJ45 connections) cables are the most effective solution for transmitting DMX-512 signals. XLR-3 cables may also be installed but require an additional adapter for connecting to DMX decoders. With DMX decoders it is possible to transmit signal wireless with use of LC-512X wireless sticks. Always review each component's installation guide for detailed and up-to-date wiring instructions. Install in accordance with NEC and local regulations.

## LT-995 DMX Decoder



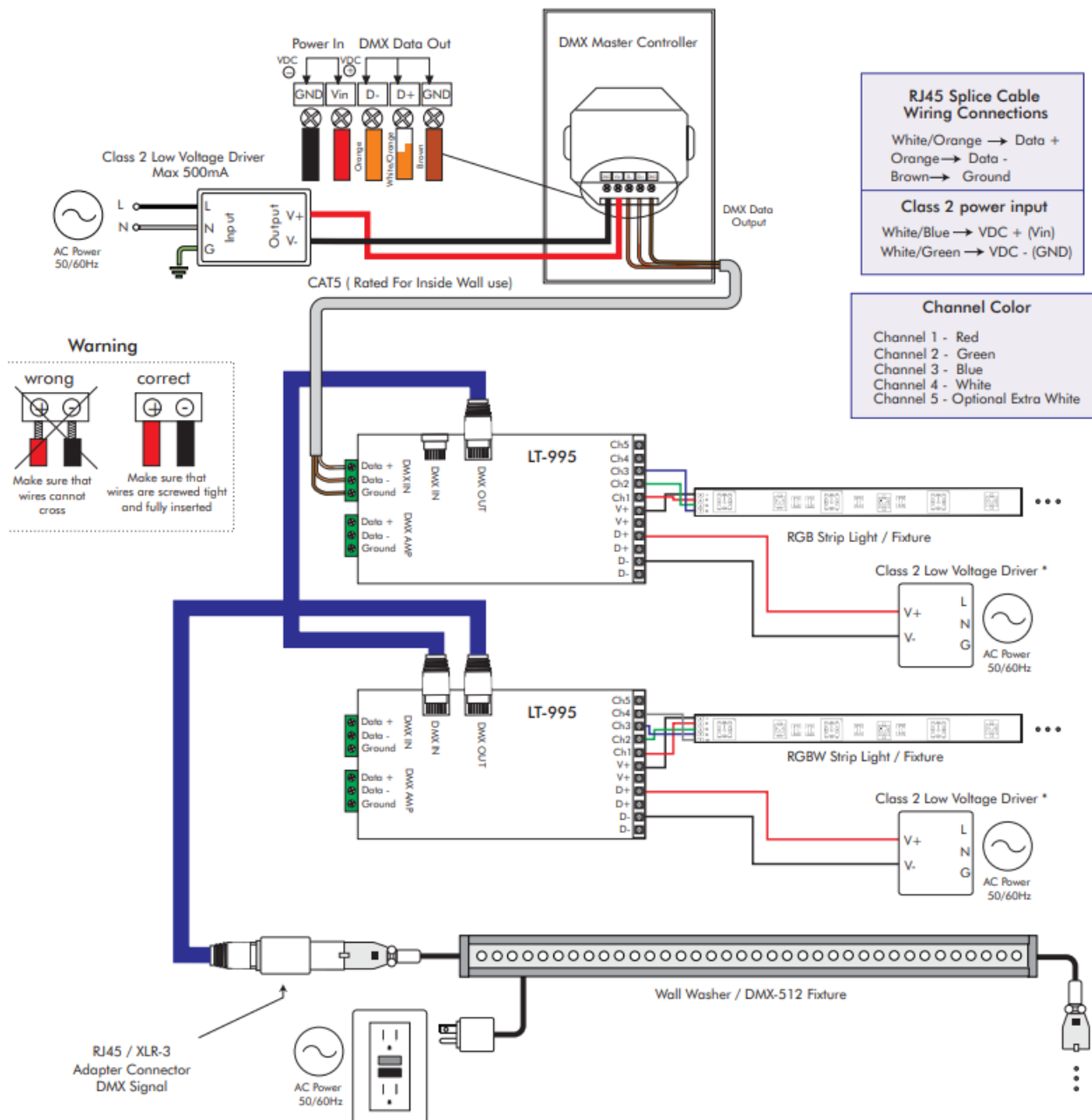

## HUEDA™ APP WIFI CONNECTIVITY INSTRUCTIONS

### • Step 1 :

Turn on the HUEDA™ Master Controller. Blue light on middle of the color circle indicates that HUEDA controller is turned on.

### • Step 2 :

Win nevil, Entice go paiwid 01 29s allable wifi networks look for Easy lighting or Hueda. Select the Easy lighting or Hueda as the

### • Step 3 :

steps to make sure that app is connected to Mater Controller wifi.



#### • Step 4 :

To connect to Home Wifi network while changing color with HUEDA\*\* app, go to settings tab on HUEDA\*\*. Select the Master Controller MAC address. It will bring to you network settings page. From the available settings select the Connect to Home Network and follow the instructions to connect to Home wifi network.

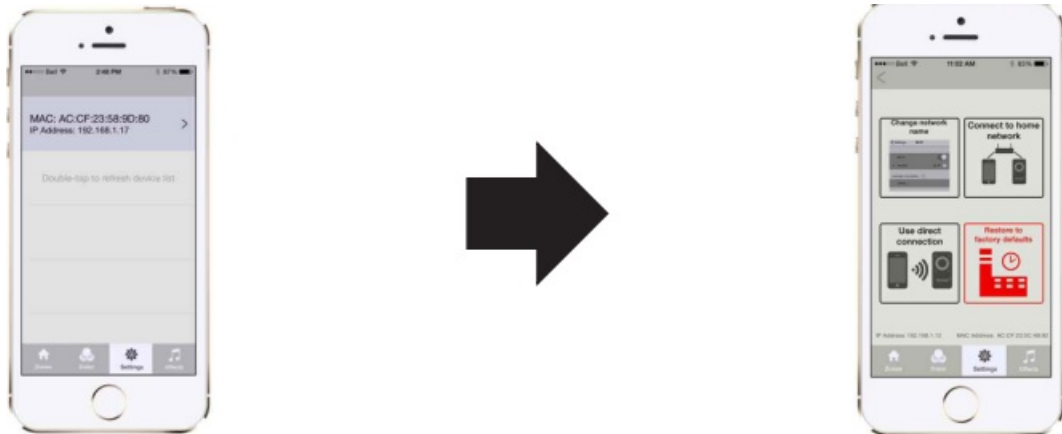



LED World Inc. | #130 10615 48 ST SE | CALGARY, AB T2C 2B7 | CANADA | Version 4.2 10/11/23  
 Copyright © 2023 LED WORLD INC™. All Rights Reserved. We are not responsible for errors or omissions.  
 Product and specifications subject to change without notice. Registered trademarks are owned by their respective registers, or licensee(s)

## Documents / Resources

	<p><a href="#">HUEDA HUEDALW-2812WI Multi Zone LED Color Controller</a> [pdf] Installation Guide          HUEDALW-2812WI Multi Zone LED Color Controller, HUEDALW-2812WI, Multi Zone LED Color Controller, Zone LED Color Controller, LED Color Controller, Color Controller</p>
--	--

## References

-  [LED World Canada](#)
-  [LED World USA](#)
- [User Manual](#)

Manuals+.