



# HUAWEI WS7100 V2 WiFi 6 Plus Smart WiFi Router User Guide

[Home](#) » [Huawei](#) » HUAWEI WS7100 V2 WiFi 6 Plus Smart WiFi Router User Guide 

## Contents

- [1 HUAWEI WS7100 V2 WiFi 6 Plus Smart WiFi Router](#)
- [2 Product Information](#)
- [3 Product Usage Instructions](#)
- [4 WIRING](#)
- [5 CONNECTION](#)
- [6 Getting Started](#)
- [7 Safety Information](#)
- [8 Documents / Resources](#)
  - [8.1 References](#)



**HUAWEI WS7100 V2 WiFi 6 Plus Smart WiFi Router**



## Product Information

The WS7100 V2 96727805\_02 is a modem that provides a LAN and WAN/LAN auto-adaptation port with a 1000M speed. It also has a RESET button and supports Wi-Fi with a Wi-Fi name of XXXXXXXX. The device has a green indicator that lights up when connected to the network, a red indicator when not connected, and a flashing indicator when it has detected a pairable device.

## Product Usage Instructions

1. Before using the device, review and download the latest Quick Start Guide from <https://consumer.huawei.com/en/support/>.
2. Connect the power adapter to the router and connect the WAN port or WAN/LAN auto-adaptation port of the router to the LAN port of the optical/broadband modem or a wall-mounted network port using a network cable.
3. Connect your mobile phone or computer to the router's Wi-Fi network (no password required). Check for the Wi-Fi name on the bottom of the router.
4. Open the browser and enter 192.168.3.1 in the address bar.
5. Follow the instructions to set up your router.

## Indicator Information

- **Steady green:** Connected to the network
- **Steady red:** Not connected to the network
- **Flashing:** The router has detected a pairable device

## Disposal and Recycling Information

For disposal and recycling information, please refer to the product manual or visit

## WIRING

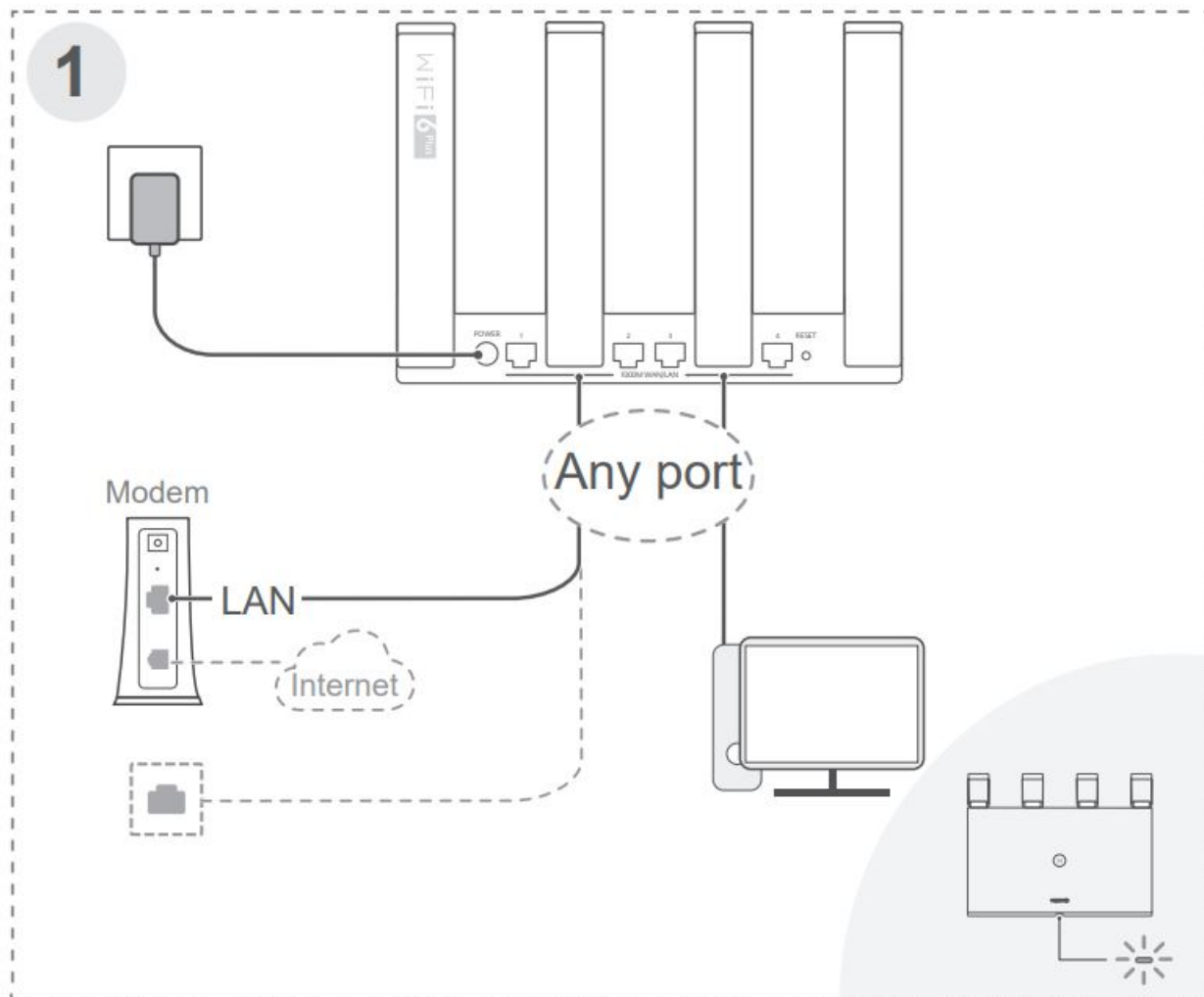

CONNECTION

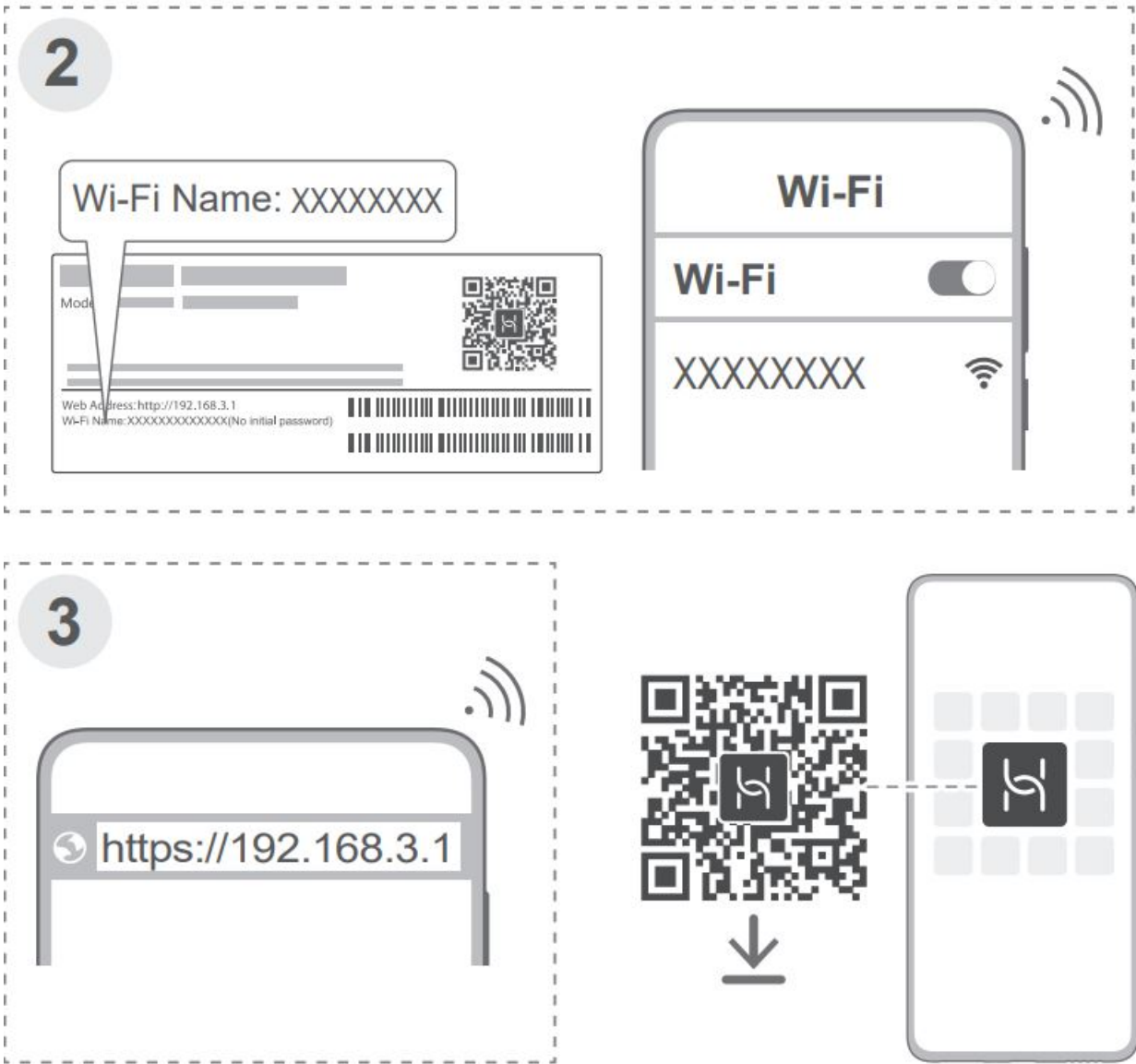

Before using the device, review and download the latest Quick Start Guide at <https://consumer.huawei.com/en/support/>.

Getting Started

1. Connect the power adapter to the router, then connect the WAN port or WAN/LAN auto-adaptation port of the router to the LAN port of the optical/broadband modem or a wall-mounted network port using a network cable.
2. Connect your mobile phone or computer to the router's Wi-Fi network (no password required). Check for the Wi-Fi name on the bottom of the router.
3. Open the browser, then enter 192.168.3.1 in the address bar. Follow the instructions to set up your router.

Steady green	Connected to the network
Steady red	Not connected to the network
Flashing	The router has detected a pairable device

Safety Information

- Please consult your doctor and the device manufacturer to determine if using your device may interfere with the operation of your medical device.
- Avoid using the device in a dusty, damp, or dirty place, or near a magnetic field.
- Ideal temperatures: 0°C to 40°C for operating, -40°C to +70°C for storage.
- Do not touch the device or the power adapter with wet hands. Doing so may lead to short circuits, malfunctions, or electric shocks.
- For pluggable devices, the socket outlet shall be installed near the devices and shall be easily accessible. Use a certified power adapter for the device.
- Ensure that the power adapter meets the requirements of Annex Q of IEC/EN 62368-1 and has been tested and approved according to national or local standards.

## **Disposal and recycling information**

The symbol on the product, battery, literature, or packaging means that the products and batteries should be taken to separate waste collection points designated by local authorities at the end of the lifespan. This will ensure that EEE waste is recycled and treated in a manner that conserves valuable materials and protects human health and the environment. For more information, please contact your local authorities, retailer, or household waste disposal service or visit the website <https://consumer.huawei.com/en/>.

## **RF Exposure Information**

- This device is not portable radio equipment, it is designed to be used at a distance larger than 20 cm between the user and/or bystander and the antenna and/or radiating element of the device.

## **EU Regulatory Conformance**

- Hereby, Huawei Device Co., Ltd. declares that this device WS7100 V2 is in compliance with the following Directive: RED 2014/53/EU, RoHS 2011/65/EU, ErP 2009/125/EC. The full text of the EU Declaration of Conformity, the detailed ErP information, and the most recent information about accessories & software are available at the following internet address: <https://consumer.huawei.com/certification>.

## **Frequency Bands and Power (Egypt)**

- The frequency bands and transmitting power (radiated and/or conducted) nominal limits applicable to this radio equipment are as follows: Wi-Fi 2.4G: 20 dBm, Wi-Fi 5G: 5150-5350 MHz: 23 dBm.

## **Version Update**

- In order to improve the security of the product and provide you with a better user experience, we will push version update information to you on a regular basis when an important update is released.

## **End User License Agreement**

- Please read and agree to the End User License Agreement (HUAWEI EULA) on the product's management page before using the product.



## References

- Manuals+,**