



HUAWEI WiFi WS5200 Dual Band Router User Guide

[Home](#) » [Huawei](#) » HUAWEI WiFi WS5200 Dual Band Router User Guide

Contents [[hide](#)]

- [1 HUAWEI WiFi WS5200 Dual Band Router](#)
- [2 installation](#)
- [3 Getting Started](#)
- [4 Indicator](#)
- [5 Safety Information](#)
- [6 Documents / Resources](#)
- [7 Related Posts](#)



HUAWEI WiFi WS5200 Dual Band Router



installation

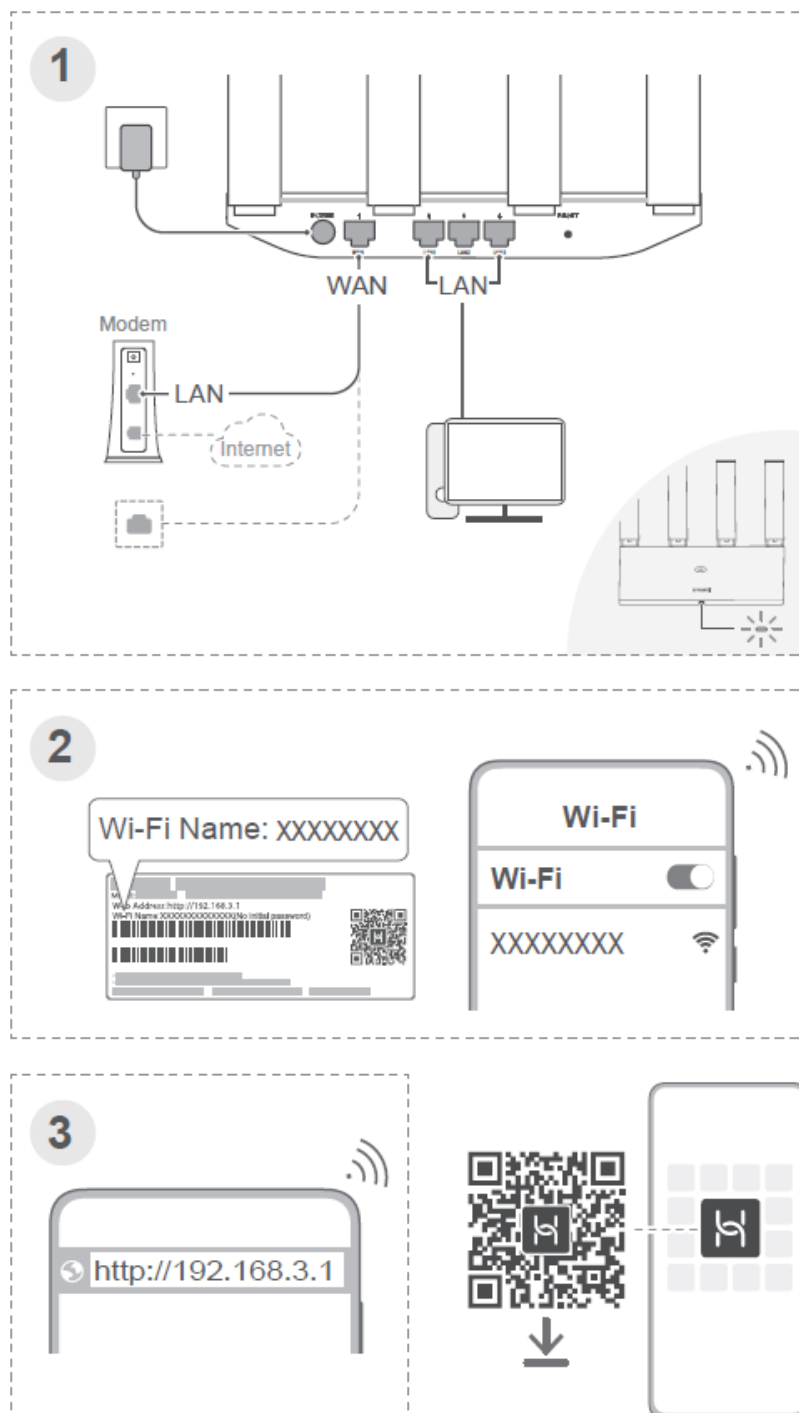

Before using the device, review and download the latest Quick Start Guide at <https://consumer.huawei.com/en/support/>.

Getting Started

1. Connect the power adapter to the router, then connect the WAN port of the router to the LAN port of the optical/broadband modem or a wall-mounted network port using a network cable.
2. Connect your mobile phone or computer to the router's Wi-Fi network (no password required). Check for the Wi-Fi name on the bottom of the router.
3. Open the browser, then enter 192.168.3.1 in the address bar. Follow the instructions to set up your router.
4. [Login/Reset Instructions](#)

Indicator

Steady green	Connected to the network
Steady red	Not connected to the network
Flashing	The router has detected a pairable device

Safety Information

- Please consult your doctor and the device manufacturer to determine if using your device may interfere with the operation of your medical device.
- Avoid using the device in a dusty, damp, or dirty place, or near a magnetic field.
- Ideal temperatures: 0°C to 40°C for operating, -40°C to +70°C for storage.
- When charging, an adapter should be plugged into a socket nearby and easily accessible. Use approved power adapters and chargers.
- Do not touch the device or the charger with wet hands. Doing so may lead to short circuits, malfunctions, or electric shocks.

Disposal and recycling information The symbol on the product, battery, literature, or packaging means that the products and batteries should be taken to separate waste collection points designated by local authorities at the end of the lifespan. This will ensure that EEE waste is recycled and treated in a manner that conserves valuable materials and protects human health and the environment. For more information, please contact your local authorities, retailer, or household waste disposal service or visit the website <https://consumer.huawei.com/en>

RF Exposure Information This device is not portable radio equipment, it is designed to be used at a distance larger than 20 cm between the user and/or bystander and the antenna and/or radiating element of the device.

Version Update In order to improve the security of the product and provide you with a better user experience, we will push version update information to you on a regular basis when an important update is released.

End User License Agreement Please read and agree to the End User License Agreement (HUAWEI EULA) on the product's management page before using the product.

Documents / Resources

	HUAWEI WiFi WS5200 Dual Band Router [pdf] User Guide WiFi WS5200, Dual Band Router
---	---