



HTW SMART PLUS Wi-Fi Control App Owner's Manual

[Home](#) » [HTW](#) » HTW SMART PLUS Wi-Fi Control App Owner's Manual 



HTW-TV-030SMPLUS
HTW-TV-050SMPLUS
HTW-TV-080SMPLUS
HTW-TV-100SMPLUS
SMART PLUS Wi-Fi Control App
Owner's Manua

Contents

- [1 SMART PLUS Wi-Fi Control App](#)
- [2 APP operation instructions](#)
- [3 Documents / Resources](#)
 - [3.1 References](#)

SMART PLUS Wi-Fi Control App



Google Play and the Google Play logo are trademarks of Google LLC.

https://play.google.com/store/apps/details?id=com.tuya.smart&hl=es_419&gl=US



Apple and the Apple Logo are trademarks of Apple Inc.

<https://apps.apple.com/es/app/tuya-smart/id1034649547>

WIFI CONTROL APP SMART PLUS

Please, read carefully this manual before using the product.
Thank you

APP operation instructions

1. Download the “TuYa” APP from the App Store on your mobile phone.
2. Make sure the mobile phone is connected to the wifi at home. When the electric water heater is on, press and hold the “Power” button for 3 seconds.
3. Register and log in.

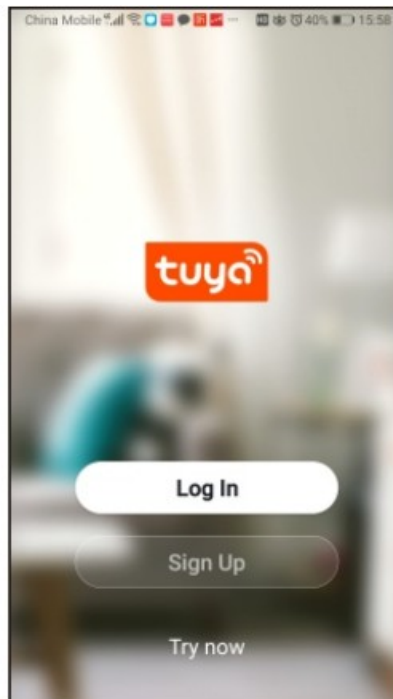

Unregistered users click “Sign up”, and then enter the interface to fill in the corresponding user information;
If it is a registered user, just click “Log in”.

4. Add Device.

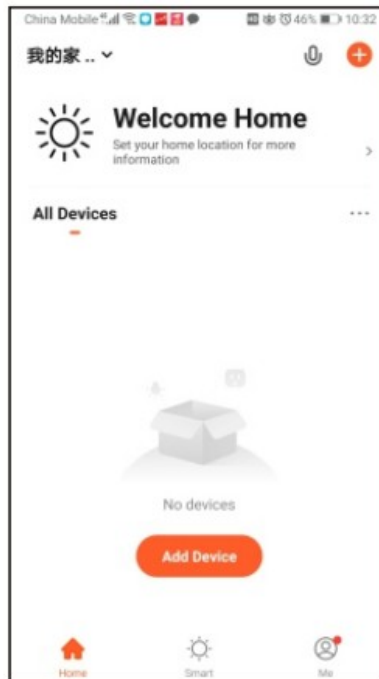

Step 1: Click “Add Device”.

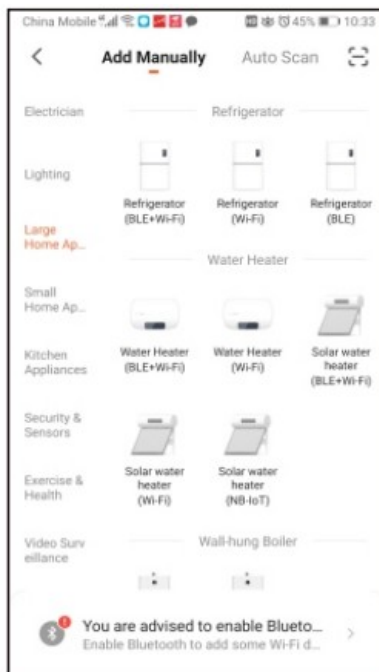

Step 2: Select “Water Heater (Wi-Fi)” in “Large Home Appliances”.

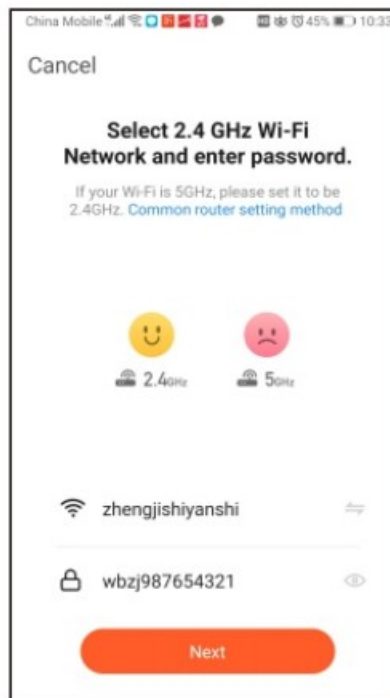

Step 3: Select the Wi-Fi network that the device needs to access, and fill in the corresponding network password, and then click “Next”.

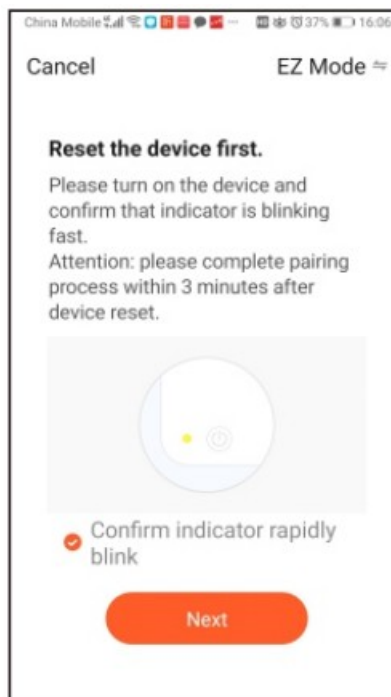

Step 4: Confirm that the “wifi” indicator on the device panel is in the state of blinking, check “Confirm indicator rapidly blink”, and then click “Next”.

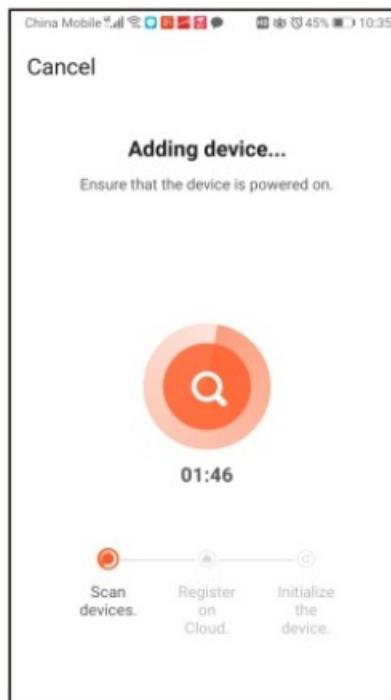

Step 5: Wait for the network connection of the device.



Step 6: Edit the device name, and then click “Done”.

5. Operation Instruction.

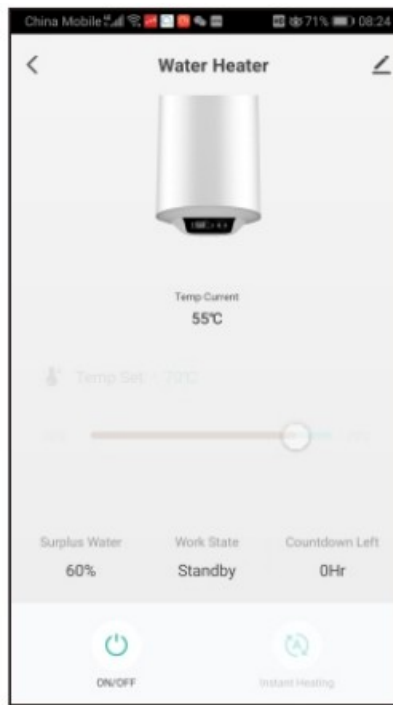

Turn on the device: Click “Power”.

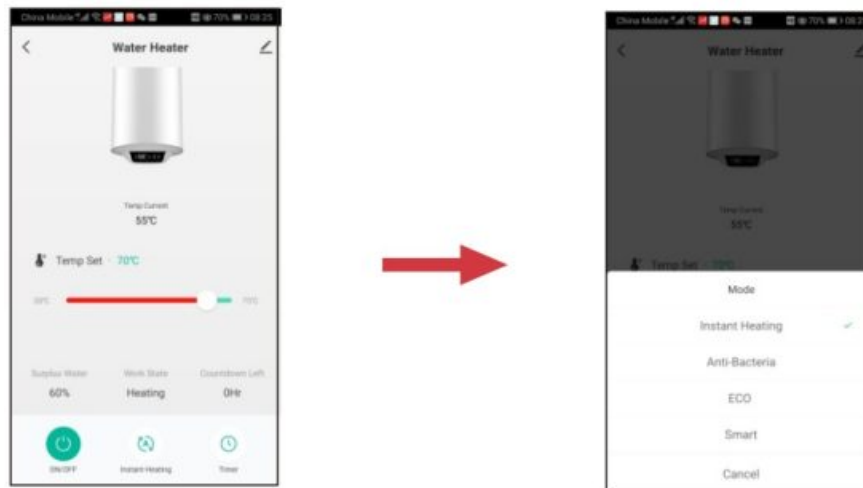

General function selection:

1. Click “” to enter the general function menu;
2. Select the corresponding function according to your needs; “Instant Heating” under this working mode, after heating to the set temperature value, it will transfer to the warming state, and when the current water temperature drops to the value of 8°C lower than the set value [set temperature -8C] will start heating to the set temperature again, and keep the cycle going. -“Anti-Bacteria” under this mode (the temperature is not adjustable), the system will enter the heat preservation state after heating to 80°C, and return to instant heating after 30 minutes of heat preservation.
 -“ECO” This function is the same as the instant heat function, but the set temperature is fixed at 55° C and cannot be adjusted.
 -“Smart” The system would memorize the user’s last week water consumption habits and automatically adjusts the set temperature.

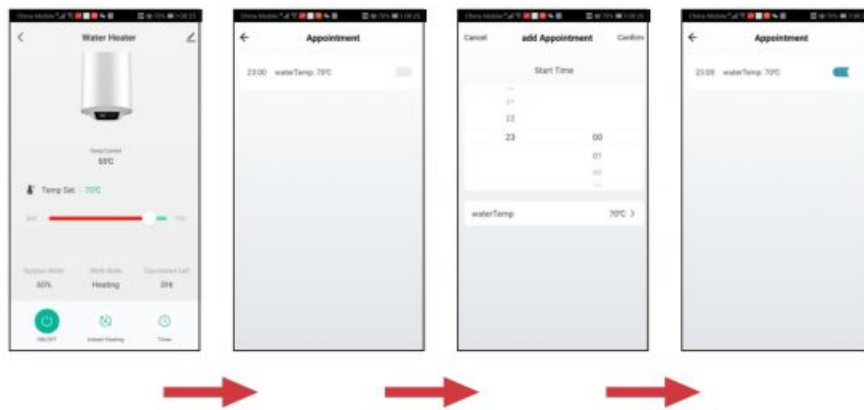

Appointment function setting:

1. Click “Timer” to enter the appointment function;
2. Click the function bar on the interface;
3. Select the required appointment time and water temperature;
4. Slide the start button of the function bar to the right;

Note: The electric water heater can only be bound to one APP account at a time. If you bind another APP account, the original APP account will be automatically unbound.

C/ Industria, 13, Polígono Industrial El Pedregar. 08160 Montmeló. Barcelona (España)
 Tel (0034) 93 390 42 20 – Fax (0034) 93 390 42 05
info@htwspain.com – www.htwspain.com

FRANCE
info@htwfrance.com

PORTUGAL
info@htw.pt

ITALIA
info.it@htwspain.com



IMPORTANT INFORMATION FOR CORRECT DISPOSAL OF THE PRODUCT IN ACCORDANCE WITH EC DIRECTIVE 2002/96/EC.

At the end of its working life, the product must not be disposed of as urban waste. It must be taken to a special local authority differentiated waste collection centre or to a dealer providing this service. Disposing of a household appliance separately avoids possible negative consequences for the environment and health deriving from inappropriate disposal and enables the constituent materials to be recovered to obtain significant savings in energy and resources. As a reminder of the need to dispose of household appliances separately, the product is marked with a crossed-out wheeled dustbin.



Documents / Resources

	<p>HTW SMART PLUS Wi-Fi Control App [pdf] Owner's Manual HTW-TV-030SMPLUS, HTW-TV-050SMPLUS, HTW-TV-080SMPLUS, HTW-TV-100SMPLUS, SMART PLUS Wi-Fi Control App, SMART PLUS, Wi-Fi Control App, Control App, App</p>
--	--

References

- [HTW - Líderes en Climatización y ACS de uso doméstico e industrial](#)
- [User Manual](#)

Manuals+. [Privacy Policy](#)

This website is an independent publication and is neither affiliated with nor endorsed by any of the trademark owners. The "Bluetooth®" word mark and logos are registered trademarks owned by Bluetooth SIG, Inc. The "Wi-Fi®" word mark and logos are registered trademarks owned by the Wi-Fi Alliance. Any use of these marks on this website does not imply any affiliation with or endorsement.