



# HTTE Revolt 3 Small Form Factor ITX Case Instruction Manual

[Home](#) » [HTTE](#) » HTTE Revolt 3 Small Form Factor ITX Case Instruction Manual 



EXPERIENCE P L AY  
R E V O L T  
Premium ITX Case

## Contents

- [1 HYTE Revolt 3 Small Form Factor ITX Case](#)
- [2 Specs & Compatibility](#)
- [3 Assembly Instructions](#)
- [4 Safety and Regulations](#)
- [5 Warranty Length for Parts](#)
- [6 Documents / Resources](#)
  - [6.1 References](#)
- [7 Related Posts](#)

## HYTE Revolt 3 Small Form Factor ITX Case

### Contents

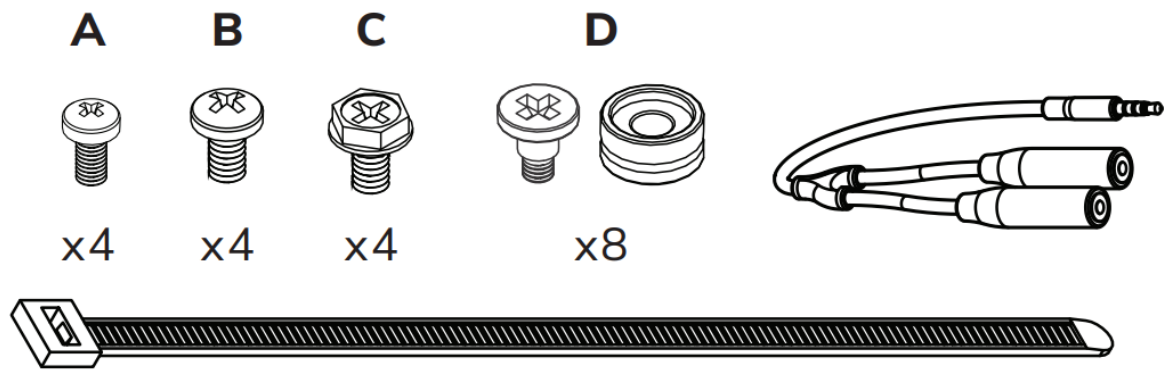

- Revolt 3 Case
- Instructions
- PC Headset Adapter
- Accessory Box
  - (A) 4x Motherboard Screws (M3)
  - (B) 4x HDD Screws (6-32)
  - (C) 4x PSU Screws (6-32)
  - (D) 8x SSD Screws (M3) Zip Ties

## Specs & Compatibility

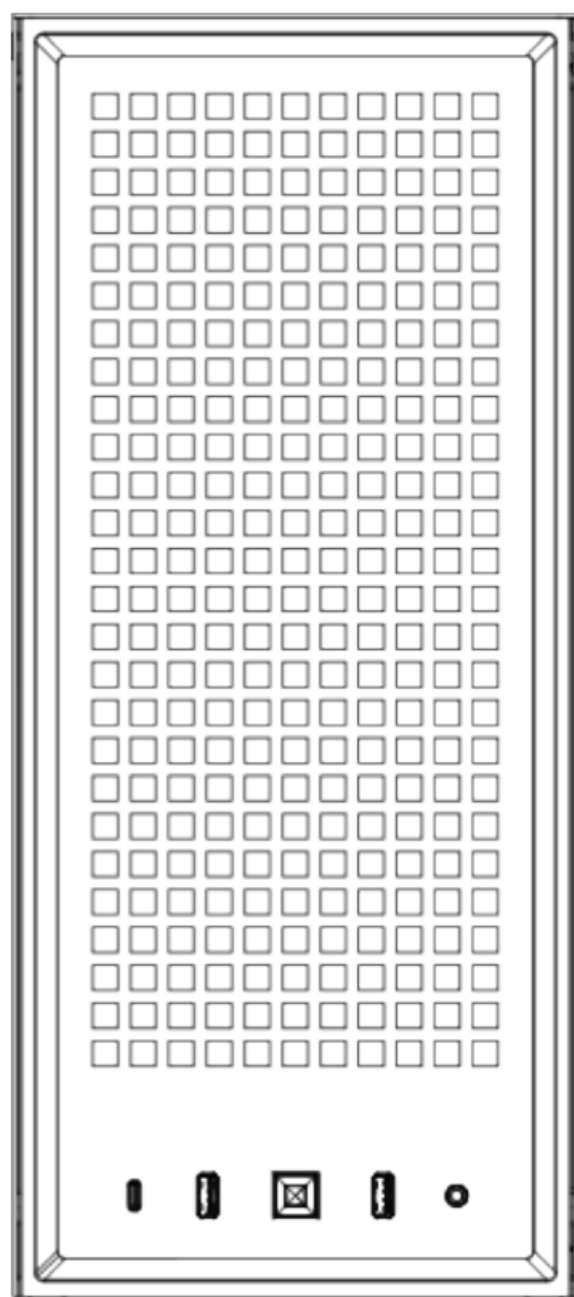

Material	Aluminum. Steel, ABS
Color	Black, White
Dimensions	253 x 178 x 409mm (9.9" D x 7" W x 16.1" H)
Motherboard Size	ITS
Radiator Support	120, 240, 140, 280mm up to 35mm thick
Clearance	Graphics Card: Most cards up to 335 x 140 x 58mm Power Supply: SFX, SFX-L (700w 80 Plus Gold SFX-L Optional) CPU Cooler Height Up to 140mm Handle Weight Limit 301bs. (14kg) * See a list of compatible graphics cards on <a href="https://www.hyte.com">HYTE.com</a>
Expansion Slots	3
Internal 3.5 Bays	1
Internal 2.5 Bays	2
Front Interfaces	USB 3.2 Gen 2 Type-C x1, USB 3.2 Gen 1 Type-A x2. Audio/Mic Combo x1
Dust Filters	Front (metal mesh), Top, Sides, Rear (magnetic)

## Assembly Instructions

Revolt 3 is designed to be easy to build, but it is still a small form factor case which means not every step is obvious. We've included the most important steps in this manual as a quick start guide, but for more detailed instructions, scan the QR code or check out Revolt 3's page on [HYTE.com](https://www.hyte.com).



For more detailed instructions, scan the QR code

1. **Remove Side Panels** – Start by removing the rear panel by pulling from the bottom. The 4 side panels can be removed easily by hand, the top panel is secured by 4 screws.

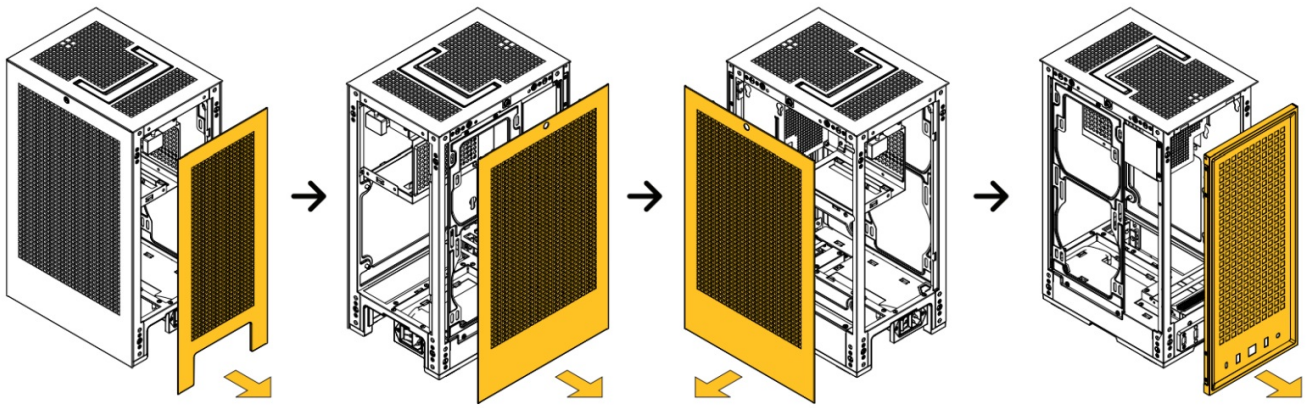

2. **Install Power Supply** – Skip these steps if your Revolt 3 comes with its power supply pre-installed.

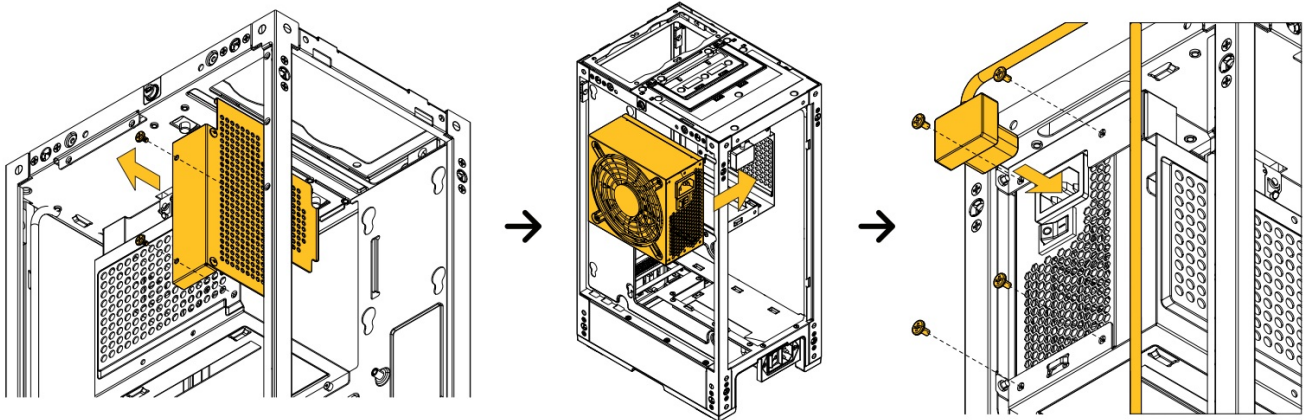

3. **Remove GPU Cable Cover and Open Radiator Door**

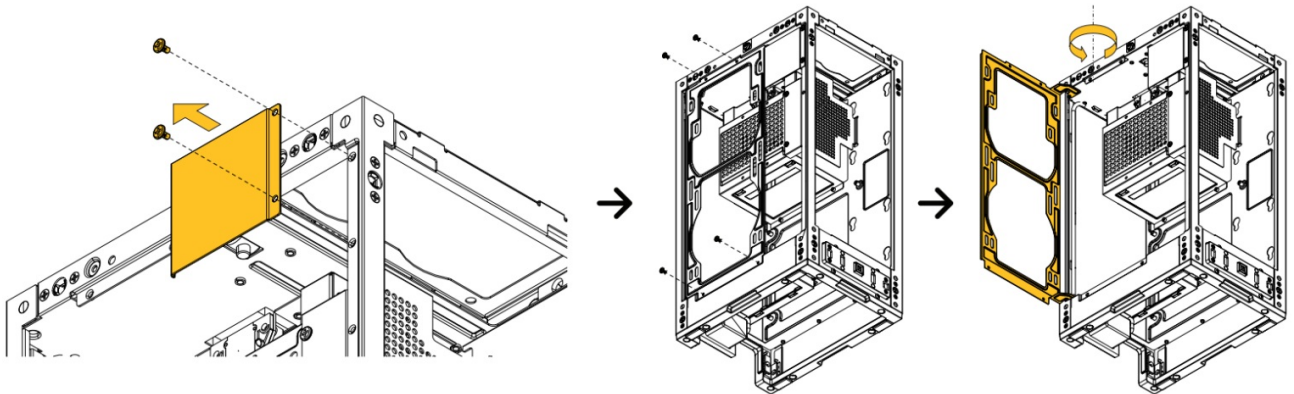

4. **Pre-Assemble and Install Motherboard** – Install CPU, RAM, and M.2 before installing the motherboard into the case.

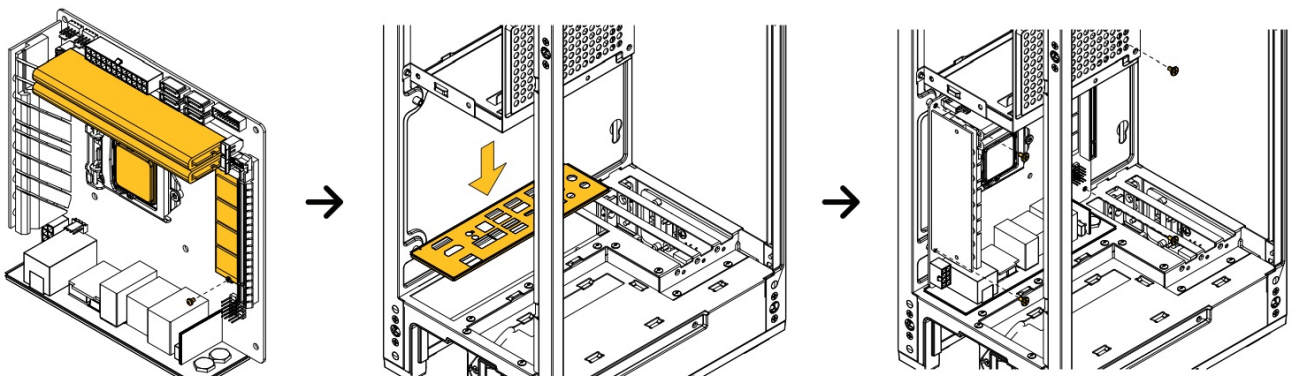

5. **Cable Manage Motherboard** – Complete as much cable management as possible before installing the CPU cooler.



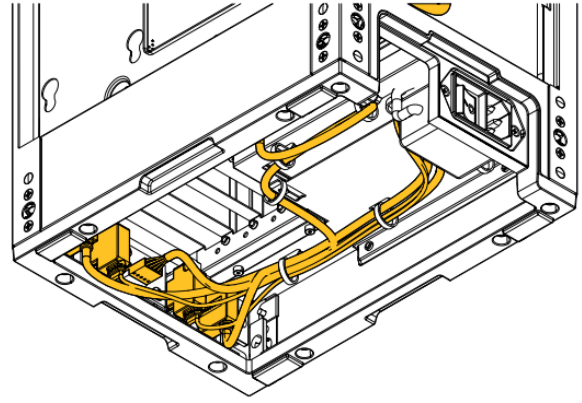
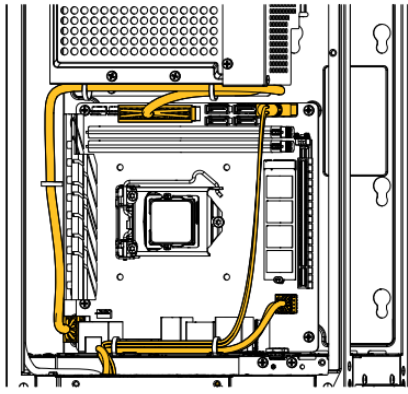

## 6. Install Storage and Cable Manage

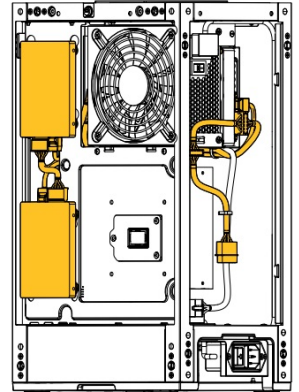
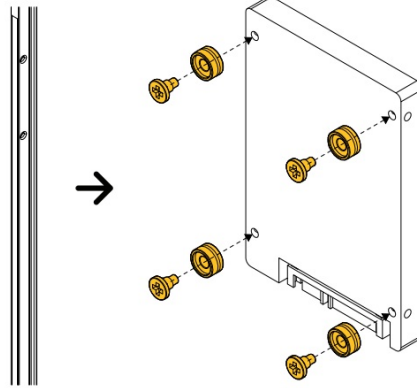
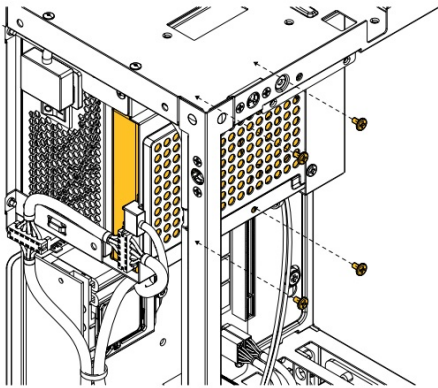

## 7. Install CPU Cooler

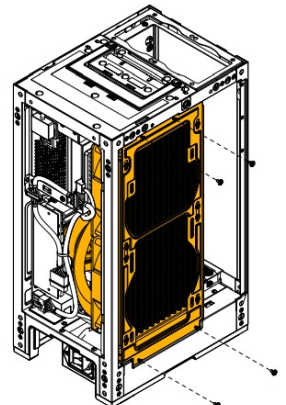
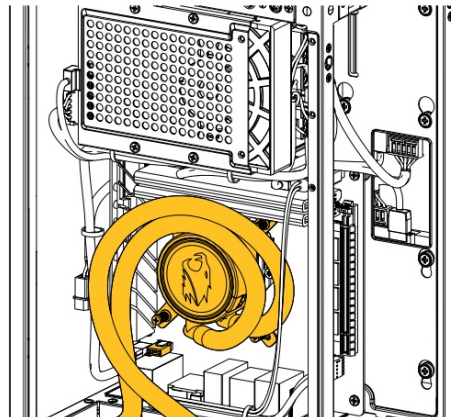
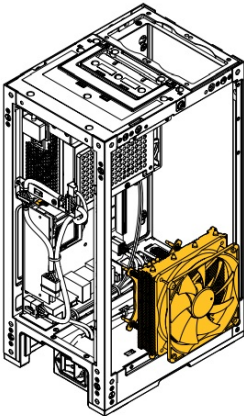

## 8. Install Graphics Card – The top panel can be removed for extra-large graphics cards over 320mm.

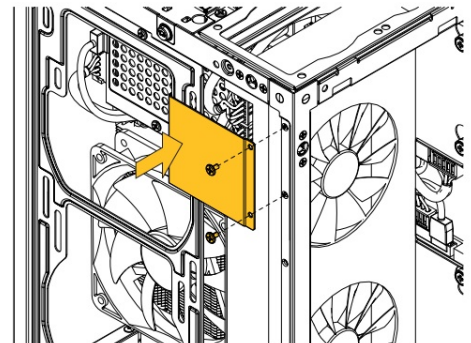
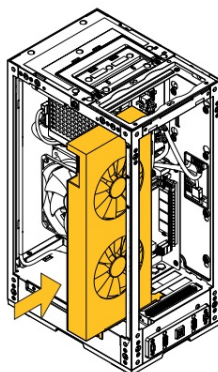
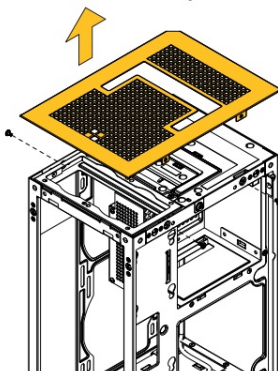

## Safety and Regulations

Compliance applies to models with pre-installed SFXL-A700GD-IBP power supply  
FCC

- CFR Title 47, Part 15, Subpart B. ANSI C63.4-2014.

## **CE**

- EN 55032:2015+A11:2020
- EN 61000-3-2:2014
- EN 61000-3-3:2013+A1:2019
- EN 55035:2017+A11:2020

## **CTUVus**

- UL 62368-1:2014
- CAN/CSA-C22.2 NO. 62368-1-14

## **CB**

- IEC 62368-1:2014

## **TUV**

- EN 62368-a:2014+A11

The devices within the HYTE Revolt 3 case with included power supply comply with Part 15 of the FCC Rules individually. Operation is subject to the following two conditions: (1) This device may not cause harmful interference, and (2) this device must accept any interference received, including interference that may cause undesired operation.

### **Caution: Electrical Shock Hazard!**

1. Install in accordance with all manufacturer instructions and safety warnings. Failure to do so may result in damage to your power supply or system and may cause serious injury or death.
2. High voltages are present in the power supply. Do not open the power supply case or attempt to repair the power supply; there are no user-serviceable components.
3. This product is designed for indoor use only.
4. Do not use the power supply near water, or in high temperature or high humidity environments.
5. Do not install near any heat sources such as radiators, heat registers, stoves, or other apparatus that produce heat.
6. Do not insert any objects into the open ventilation or fan grill area of the power supply.
7. Do not modify the cables and/or connectors included with this power supply.
8. If this power supply uses modular cables, use only manufacturer-supplied cables. Other cables may not be compatible and could cause serious damage to your system and power supply.
9. The 24-pin main power connector has a detachable 4pin connector. This 4-pin connector is not a P4 or ATX 12V connector. Do not force this cable in the P4 or ATX +12V socket on the motherboard.
10. Failure to comply with any manufacturer instructions and/or any of these safety instructions will immediately void all warranties and guarantees.

Warranty Length for Parts

Revolt 3 Computer Case – 3 Years SFXL-A700GD-IBP Power Supply – 10 Years

HYTE Limited Warranty

This product is covered by a limited warranty, please visit HYTE.com to obtain a full copy of the written warranty or contact us using one of the methods below.

[Support@HYTE.com](mailto:Support@HYTE.com)

HYTE by iBUYPOWER

529 N Baldwin Park Blvd., City of Industry, CA 91746, USA

[www.HYTE.com](http://www.HYTE.com)



Documents / Resources

	<a href="#">HTTE Revolt 3 Small Form Factor ITX Case</a> [pdf] Instruction Manual Revolt 3 Small Form Factor ITX Case
--	--

References

- [HYTE.com](http://HYTE.com)
- [HYTE - Gaming PC Cases & Accessories | HYTE](#)
- [HYTE Gaming PC Cases Accessories](#)