



HPRT HN-3358SR Handheld Barcode Scanner Instruction Manual

[Home](#) » [HPRT](#) » HPRT HN-3358SR Handheld Barcode Scanner Instruction Manual 

HPRT HN-3358SR Handheld Barcode Scanner Instruction Manual



Contents

- 1 Appearance
- 2 Power on/off and Restart
- 3 Maintenance
- 4 USB Connection
- 5 Buzzer
- 6 LED Indicator
- 7 Interface Setting
- 8 Bluetooth Connection
- 9 Set Defaults
- 10 Scanning Mode
- 11 Common Problem
- 12 State
- 13 FCC Warning
- 14 Documents / Resources
- 15 Related Posts

Appearance

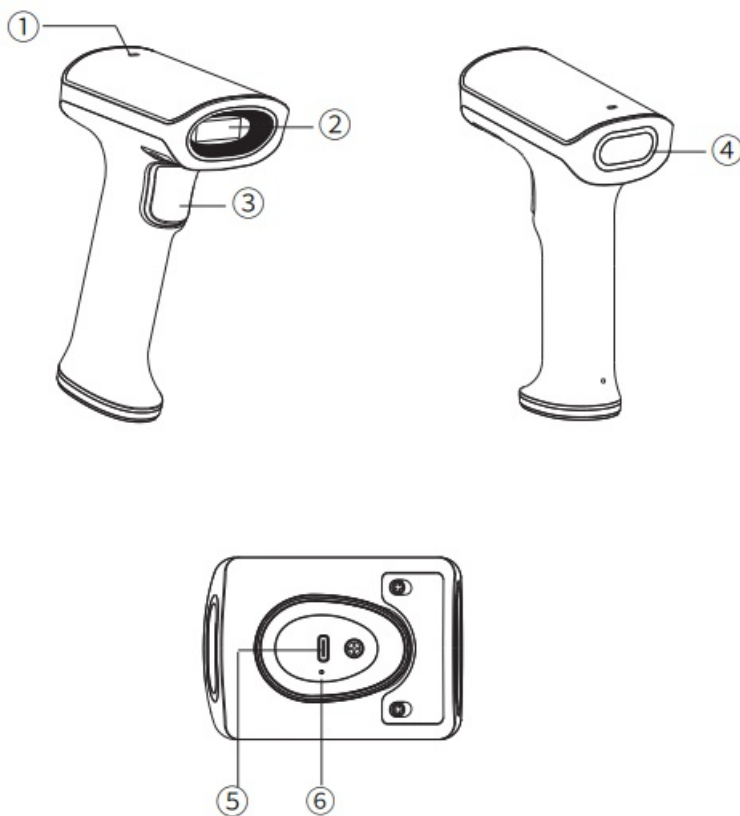

- 1. Sound Hole
- 2. Scan Window
- 3. Scan Button
- 4. Indicator
- 5. Type-C
- 6. Shutdown Hole

Power on/off and Restart

Start up:

1. Automatically start up after connecting USB;
2. When USB is not connected, press the scanning button to start the scanner.

Shut down:

1. Press and hold for 15s to shut down;
2. Shut down automatically after 15 minutes of silence (without any touch).

Restart:

If the scanner crashes or does not response, press the bottom switch with the paper clip. Then press the scanning button to restart.

Maintenance

- The reading window must be kept clean.
- Avoid hard and rough objects to scratch the reading window.
- Remove the stains from window with a brush.
- Please use a soft cloth to clean the window, such as glasses cloth.
- Do not spray any liquid on the window
- Do not use any cleaner other than cleaning water.

USB Connection

1. Connect the device interface (type-C interface) of USB to scanner;
2. Connect the host interface (USB interface) of USB to the host and switch to the keyboard mode.

Buzzer

Status

Power on

Scan Successfully

Beeping times

3 times

1

LED Indicator

Color

- Red light on
- Red light off
- Red light flash
- Green light slow flash

- Green light on
- Alternating slow flashing of red and yellow light
- Yellow light on

Description

- Charging
- Full charge
- Low power prompt
- Bluetooth not connected
- Bluetooth connected
- Charging and Bluetooth not connected
- Charging and Bluetooth connected

Interface Setting

The scanner can communicate with the host by RS-232 serial port or USB port. The user can switch to the corresponding interface by replacing the cable and scanning the corresponding barcode below.

1. USB virtual keyboard



2. USB virtual Serial Port



3. Bluetooth



Bluetooth Connection

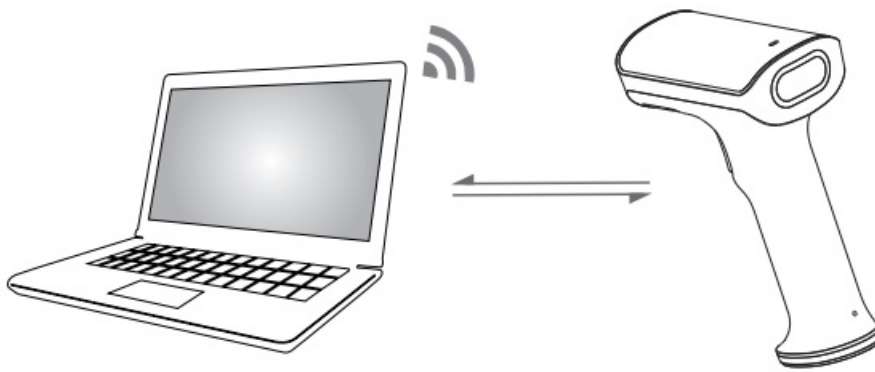

The scanner is shut up by pressing the scanning button, and be connected it to the host devices through Bluetooth. The green light indicates that it is connected and can be used normally.

1. Set shut down/up time



Disable



5min



10min



15min

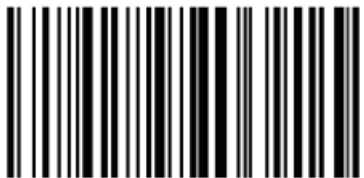

30min



60min

2. Pop up iPhone keyboard by Bluetooth

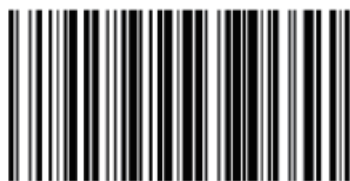

Yes



No

Set Deafults

Scan the barcode to restore all settings to the factory default state.



Note: Please use the “factory reset” function carefully. After recognizing this barcode, the current parameter settings will be lost and replaced with the factory default values.

Scanning Mode

Scan mode settings by scanning the barcode below

1. Manual Mode



2. Sensing Mode



3. continuous Mode



Other

1. Aiming Barcode

ON

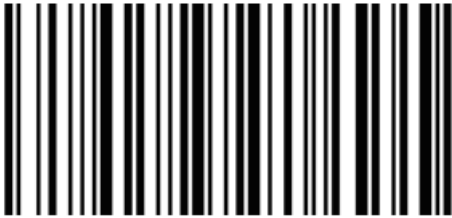

OFF



2. Read Successfully Barcode

ON

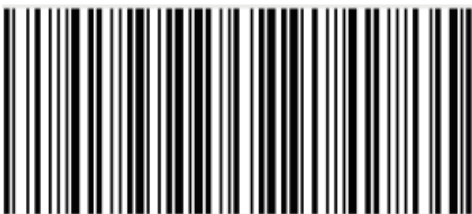

OFF



Common Problem

Q There are some barcodes can not be scan.

A

- a) Firstly, check the barcode type and enable the barcode function; if there is verified, try to close the verification.
- b) Unable to know the barcode type, then set all barcodes allow to be read.

Q The barcode data is incorrect.

A

Check the status of barcode errors (whether all barcodes have errors or specific barcodes have errors)

Q Bar code can be read but not displayed.

A

First, confirm whether the working mode of the scanner is in Bluetooth transmission mode; if it is already in Bluetooth transmission mode, confirm whether the Bluetooth of the scanner is connected to the host terminal.

Q Aiming light and illumination light are not on.

A

- a) Check whether the device is powered on.
- b) Re-plug the data cable.

State

- Our company does not assume any responsibility for losses caused by natural disasters (such as earthquakes,

floods, etc.) that exceed our scope of responsibility.

- In any case, our company does not assume any responsibility for losses caused by using this product, such as loss of profits, loss of reputation, business interruption, loss or change of stored data, and any special, unexpected, associated or intermittent losses caused by the above.
- Our company does not assume the responsibility for the losses caused by due to improper use of hardware or software not specified by the our company .
- Our company does not provide any form of warranty or technical support for the information, data, files, other products, services obtained though the use of this product, and does not assume any responsibility for the use of above description by users.
- Our company are not take any form of guarantee for third-party software used by this product.
- Due to the continuous improvement of the products, the operation and common problems of the models described in the manual are mainly based on actual machines. And it may be changed without notice.

FCC Warning

This device complies with part 15 of the FCC Rules.
Operation is subject to the following two conditions:

1. This device may not cause harmful interference, and
2. this device must accept any interference received, including interference that may cause undesired operation.

NOTE:

This equipment has been tested and found to comply with the limits for a Class B digital device, pursuant to part 15 of the FCC Rules. These limits are designed to provide reasonable protection against harmful interference in a residential installation.

This equipment generates, uses and can radiate radio frequency energy and, if not installed and used in accordance with the instructions, may cause harmful interference to radio communications.

However, there is no guarantee that interference will not occur in a particular installation. If this equipment does cause harmful interference to radio or television reception, which can be determined by turning the equipment off and on, the user is encouraged to try to correct the interference by one or more of the following measures:

- Reorient or relocate the receiving antenna.
- Increase the separation between the equipment and receiver.
- Connect the equipment into an outlet on a circuit different from that to which the receiver is connected.
- Consult the dealer or an experienced radio/ TV technician for help.



Warning:

Changes or modifications to this unit not expressly approved by the part responsible for compliance could void the user's authority to operate the equipment.

FCC Radiation Exposure Statement

The device has been evaluated to meet general RF exposure requirement. The device can be used in portable exposure condition without restriction.

Documents / Resources

	HPRT HN-3358SR Handheld Barcode Scanner [pdf] Instruction Manual HN-3358SR Handheld Barcode Scanner, Handheld Barcode Scanner, Barcode Scanner
	HPRT HN-3358SR Handheld Barcode Scanner [pdf] Instruction Manual HN3358, 2AUTE-HN3358, 2AUTEHN3358, HN-3358SR, Handheld Barcode Scanner, HN-3358 SR Handheld Barcode Scanner
	HPRT HN-3358SR Handheld Barcode Scanner [pdf] Instruction Manual HN3358SR, 2AUTE-HN3358SR, 2AUTEHN3358SR, HN-3358SR Handheld Barcode Scanner, HN-3358SR Handheld Barcode Scanner, Barcode Scanner, Scanner

Manuals+.