

HPRT HDR3D2331 Thermal Receipt Printer



HPRT HDR3D2331 Thermal Receipt Printer User Guide

[Home](#) » [HPRT](#) » HPRT HDR3D2331 Thermal Receipt Printer User Guide 

Contents

- [1 HPRT HDR3D2331 Thermal Receipt Printer](#)
- [2 Product Information](#)
- [3 Product Usage Instructions](#)
- [4 FAQs](#)
- [5 Packing List](#)
- [6 Appearance and Components](#)
- [7 Paper Loading](#)
- [8 CE DECLARATION OF CONFORMITY](#)
- [9 Power Supply](#)
- [10 FCC](#)
- [11 Documents / Resources](#)
 - [11.1 References](#)

HPRT

HPRT HDR3D2331 Thermal Receipt Printer



Product Information

- **Specifications:**

- **Product:** HPRT TP900-i
- **Type:** Direct Thermal Line Printing
- **Manufacturer:** Xiamen Hanin Co., Ltd.
- **Power Supply:** Power Adapter
- **Connectivity:** Ethernet, USB Type-B, USB Type-A, USB Type-C
- **Cash Drawer Interface:** USB Type-C (HOST / PD)

Product Usage Instructions

- **Appearance and Components:**

- **Front & Side View:**
 - Cover Opening Button
 - Control Panel
 - Print Cover
 - Volume Button
 - Feed Button
 - Power Button
- **Back View:**
 - Ethernet Interface
 - Power Interface
 - USB Type-B (Device)
 - USB Type-A (HOST)
 - USB Type-C (HOST)
 - Cash Drawer Interface: USB Type-C (HOST / PD)
- **Opening the Print Cover:**
 - Press the cover opening button to open the print cover.
 - Load the roll paper in the correct direction.
- **Power Supply:**
 - Connect the power adapter to the printer.

- Connect the power adapter to the power cord.
- Plug the other side of the power cord into the socket outlet.
- **Paper Loading:**
 - Pull out some paper and close the printer cover.
 - Tear any extra paper.

FAQs

- **Q: What should I do if the printer is not powering on?**
 - **A:** Make sure the power adapter is properly connected to both the printer and the power source. Check that the power cord is securely plugged in. If the issue persists, contact customer support for assistance.
- **Q: Can I use any type of roll paper with this printer?**
 - **A:** It is recommended to use compatible roll paper for optimal printing results and to prevent damage to the printer. Using non-compatible paper may cause jams or poor print quality.

Packing List



Printer



Power Cord



USB Cable



Power Adapter



Roll Paper



Quick Start Guide

Notes

1. The items in the package are dependent on the actual order.
2. The power adapter and power cord vary by local or region.

Appearance and Components

Front & Side View

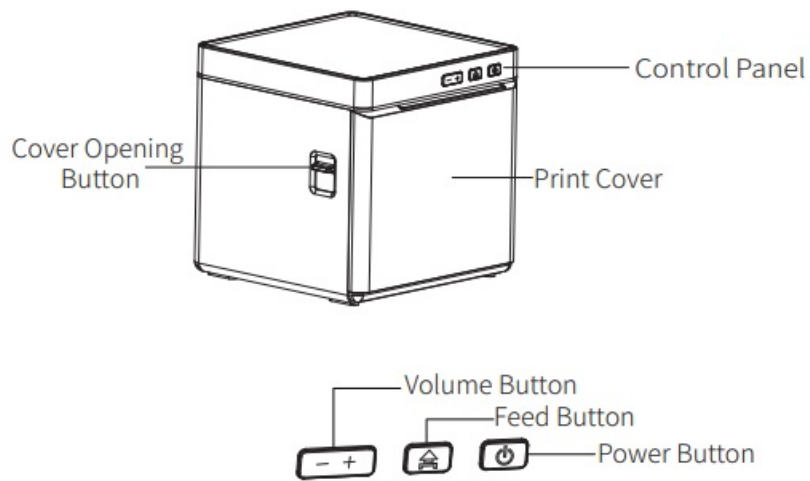

Back View

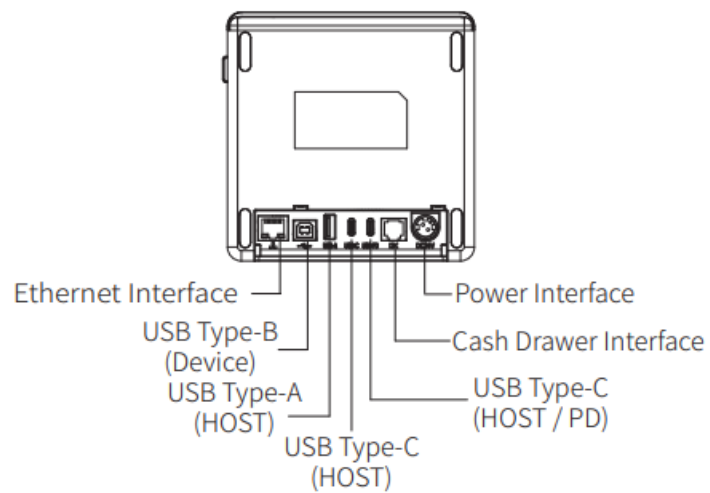

Notes

- USB Type-B (Device) is used to connect to a PC.
- USB Type-A (HOST) is used to connect a driver peripheral, keyboard, display, USB flash drive, etc.
- USB Type-C (HOST) is used to connect a driver peripheral and communicate with tablets.
- USB Type-C (HOST/PD) supports rapid charging

Open the Print Cover

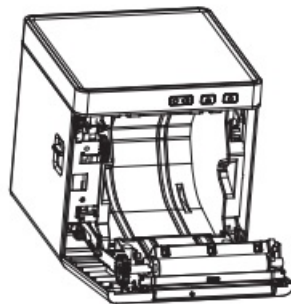

Paper Loading

1. Press the cover opening button to open the print cover.
2. Load the roll paper in the correct direction.

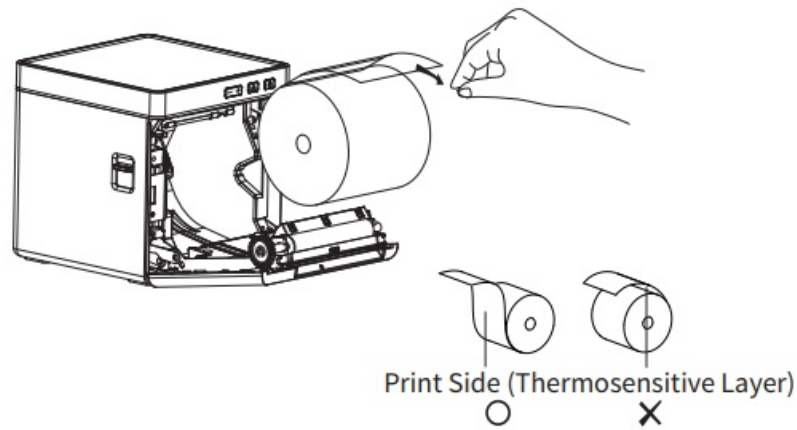

3. Pull out some paper, and close the printer cover.
4. Tear the extra paper.

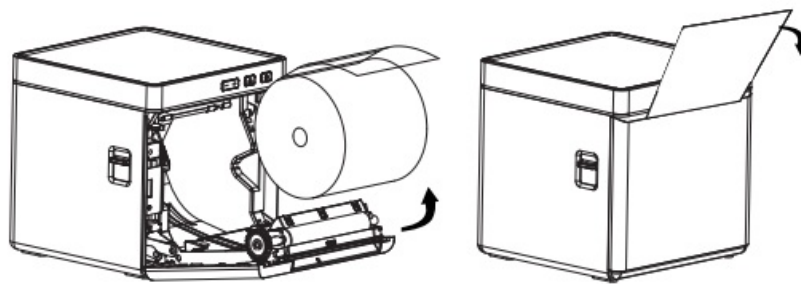

CE DECLARATION OF CONFORMITY

- **The manufacturer certifies that the following designated product:** HPRT TP900-i
- **Type of product:** Direct Thermal Line Printing It conforms with the standards.

Test Standard Information

- **Under the Council Directive:** (LVD) Directive 2014/35/EU relating to electrical equipment designed for use within Low Voltage Directive.
- EN 62368-1:2014+A11:2017
- **Under the Council Directive:** (EMC) Directive 2014/30/EU relating to Electro Magnetic Compatibility.
- EN 55032: 2015+AC:2016
- EN 55035: 2017
- EN 61000-3-2: 2014
- EN 61000-3-3: 2013

We declare herewith that as a result of how the device designated below was designed, the type of construction and the devices which, as a result, have been brought on to the general market comply with the relevant fundamental regulations of the CE Rules for Safety. And we declare herewith the above-mentioned model conforms with Directive 2014/30/EU and 2014/35/EU. In the event of any alteration which has not been approved by us being made to any device as designated above, this statement shall thereby be made invalid. The declaration is the sole responsibility of the manufacturer HPRT.

Power Supply

1. Connect the power adapter to the printer.
2. Connect the power adapter to the power cord.
3. Plug the other side of the power cord into the socket outlet.

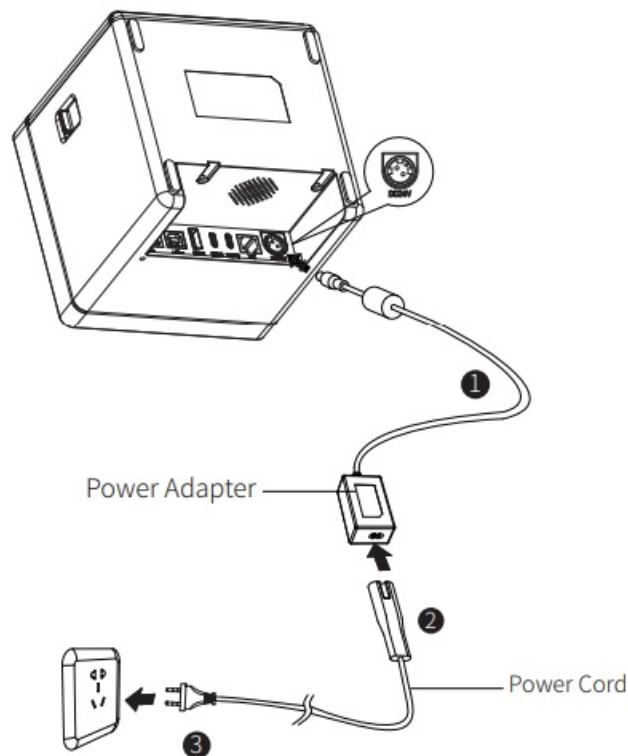

FCC

FCC Warning

This device complies with part 15 of the FCC Rules.

Operation is subject to the following two conditions:

1. this device may not cause harmful interference, and
2. this device must accept any interference received, including interference that may cause undesired operation.

Any changes or modifications not expressly approved by the party responsible for compliance could void the user's authority to operate the equipment.

NOTE: This equipment has been tested and found to comply with the limits for a Class A digital device, under part 15 of the FCC Rules. These limits are designed to provide reasonable protection against harmful interference when the equipment is operated in a commercial environment. This equipment generates, uses, and can radiate radio frequency energy and, if not installed and used per the instruction manual, may cause harmful interference to radio communications. Operation of this equipment in a residential area is likely to cause harmful interference in which case the user will be required to correct the interference at his own expense.

- Reorient or relocate the receiving antenna.
- Increase the separation between the equipment and the receiver.
- Connect the equipment to an outlet on a circuit different from that to which the receiver is connected.
- Consult the dealer or an experienced radio/TV technician for help.

To satisfy FCC RF exposure requirements, a separation distance of 20cm or more should be maintained between the antenna of this device and persons during device operation. To ensure compliance, operations at closer than this distance is not recommended.

Xiamen Hanin Co., Ltd.

- **ADD:** Room 305A, Angye Building, Pioneering Park, Torch High-tec zone, Xiamen, china

Documents / Resources

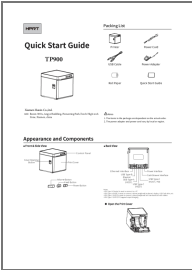
| | |
|---|---|
|  | <p>HPRT HDR3D2331 Thermal Receipt Printer [pdf] User Guide HDR3D2331, HDR3D2331 Thermal Receipt Printer, Thermal Receipt Printer, Receipt Printer, P rinter</p> |
|---|---|

References

- [User Manual](#)

[Manuals+](#), [Privacy Policy](#)

This website is an independent publication and is neither affiliated with nor endorsed by any of the trademark owners. The "Bluetooth®" word mark and logos are registered trademarks owned by Bluetooth SIG, Inc. The "Wi-Fi®" word mark and logos are registered trademarks owned by the Wi-Fi Alliance. Any use of these marks on this website does not imply any affiliation with or endorsement.