



# hp 3800 PostScript MFP Printer Instruction Manual

[Home](#) » [HP](#) » hp 3800 PostScript MFP Printer Instruction Manual 

## Contents

- 1 HP DJ XL 3800 PostScript MFP Printer
  - 1.1 Assembly Instructions
    - 1.1.1 Tools required for the Assembly
    - 1.1.2 Unpack the printer
- 2 Documents / Resources
  - 2.1 References
- 3 Related Posts

## HP DJ XL 3800 PostScript MFP Printer

### Assembly Instructions

Edition 1

© Copyright 2023 HP Development Company, L.P.  
Large Format Division  
Camí de Can Graells 1-21  
08174 · Sant Cugat del Vallès  
Barcelona · Spain

All rights reserved



### **Please read these instructions carefully.**

These assembly instructions explain how to assemble the printer.

Because spare screws are supplied, some screws may remain unused after assembly of the printer.

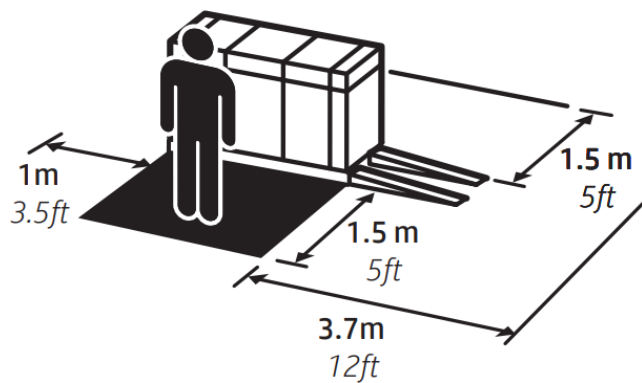

The size of the crate is 1718 mm x 766 mm x 1275 mm. The space required for assembly is 1.5 m (5 feet) at the front and back and 3.7 m (12 feet) at the side.

Warning: Do not use other methods to assemble the printer 



2 people are required to perform certain tasks.



Time required for assembly of the printer is approximately 90 minutes.

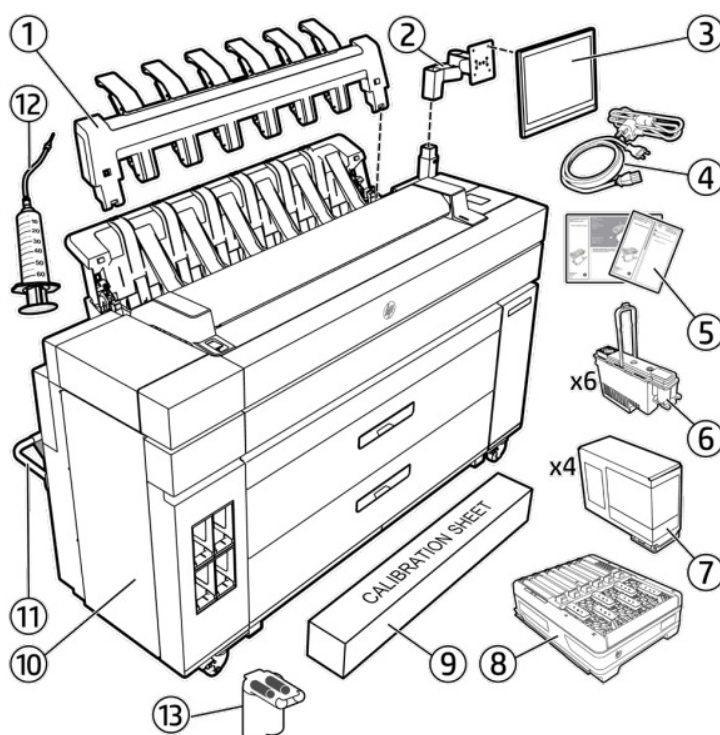

#### Crate contents

1. Stacker
2. Monitor arm
3. Control panel
4. Power cords

5. Documentation
6. Printheads (×6)
7. Ink cartridges (×4)
8. Megacassette (maintenance cartridge)
9. Scanner calibration sheet
10. Printer
11. Basket
12. Syringe
13. Purgers

#### Tools required for the Assembly

#### Required and included in the box

- 1× big screw to assemble the control panel arm
- 1× 8 mm (5/16 inch) Allen key

#### Required but not included in the box

These tools are not included, make sure you have them on the day of installation.

- Electric screwdrivers
- T10, T15, T20, T25 screwdrivers
- Electric nut driver with 7 mm adapter
- Cutter
- Hammer
- LAN cable

#### Unpack the printer



#### Important:

- Make sure to unpack on a flat floor
- Keep packaging and security locks

Note: When unpacking the printer, make sure to leave the area clean and tidy in order to avoid accidents

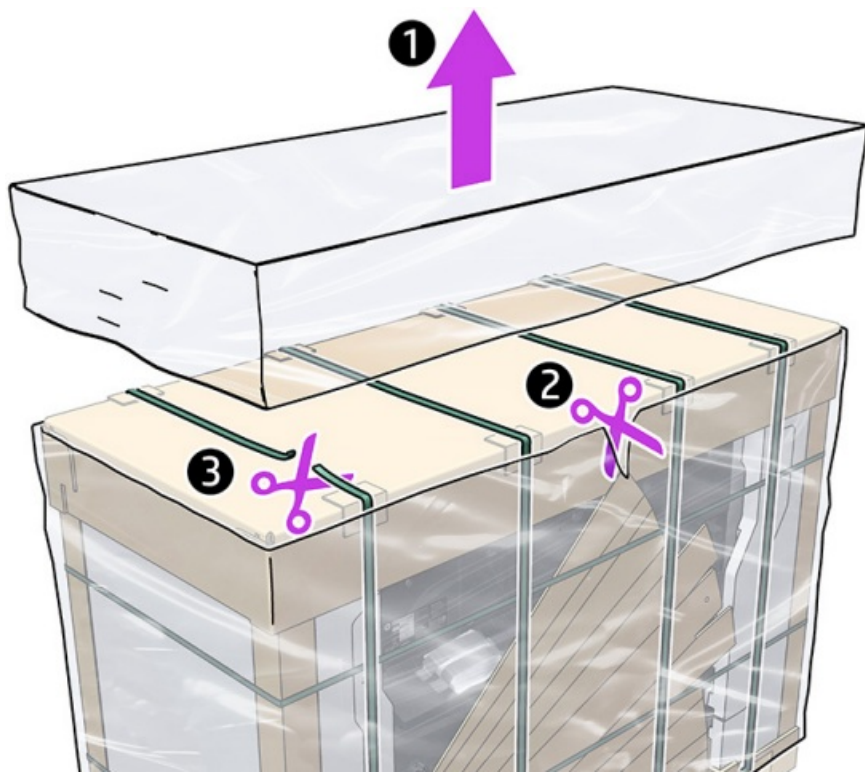

Remove the plastic covers from the top and around the printer (1+2). Cut and remove the vertical plastic-straps (3).

2

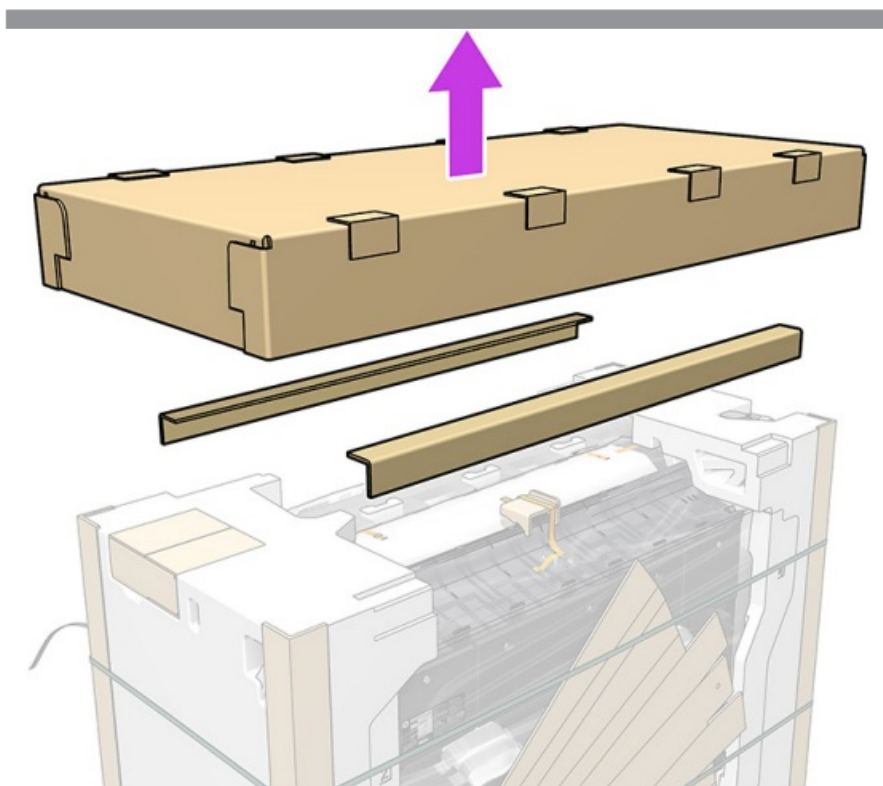

Remove the top carton-cover, then remove the wooden bars from inside of the box.

3

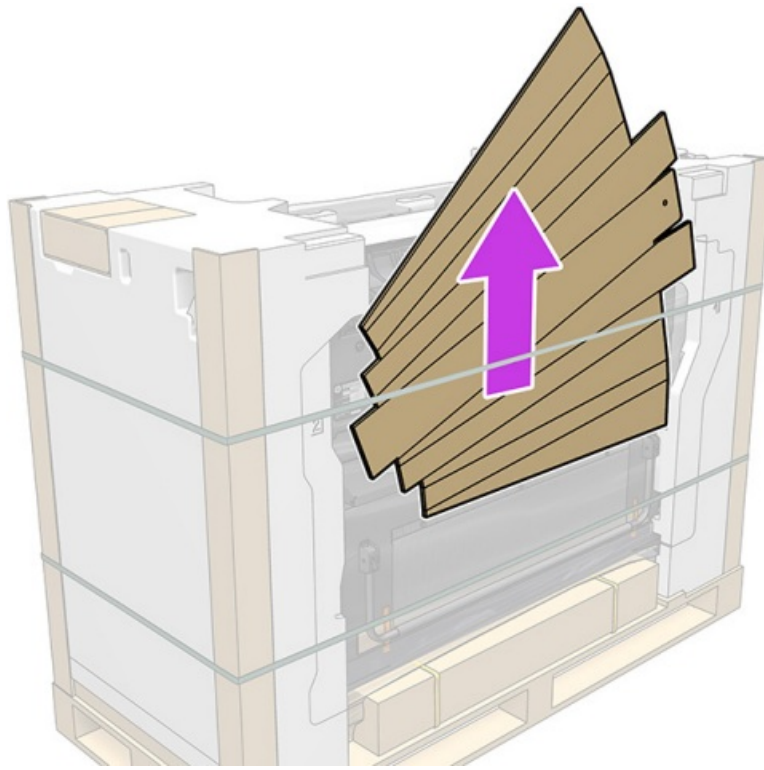

Remove the two unfolded cardboard ramps by lifting them upwards, and place them aside for later use.

4

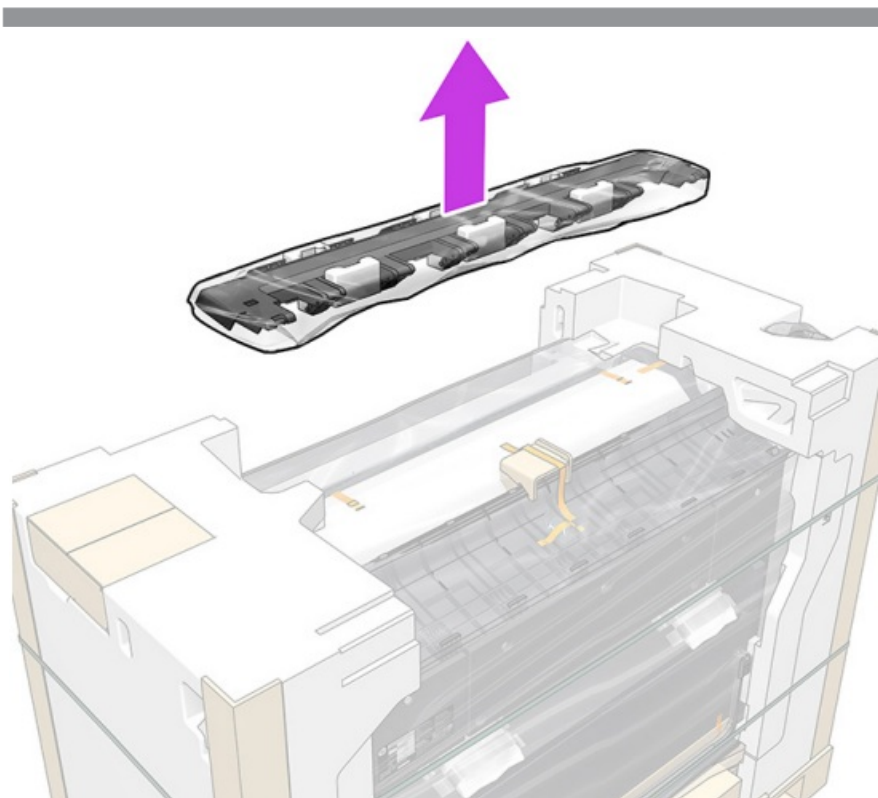

Remove the stacker arms.

5

---

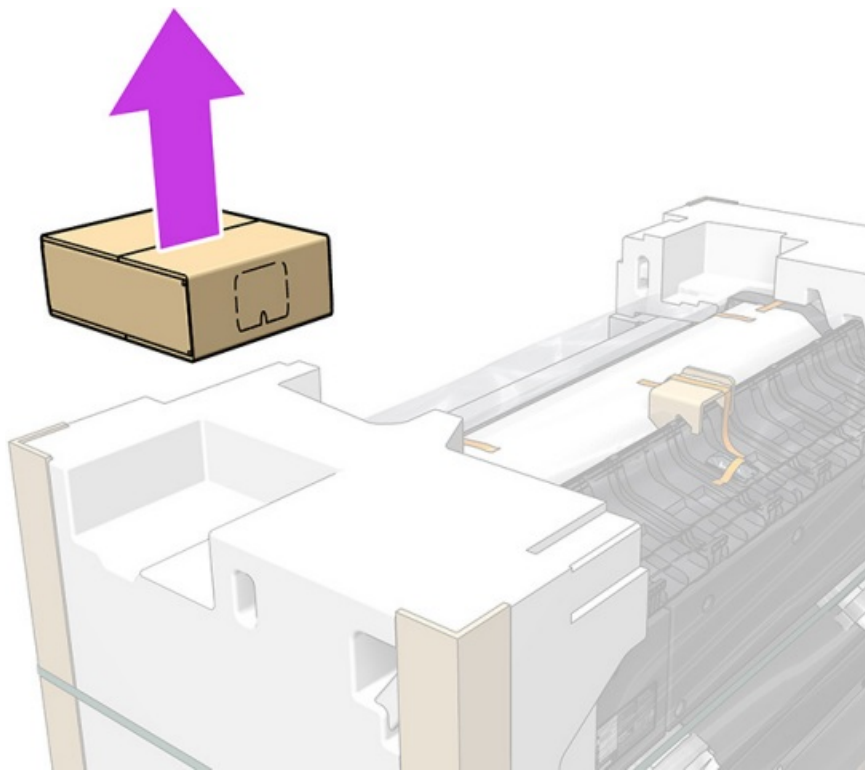

Remove the maintenance-cartridge box.

6

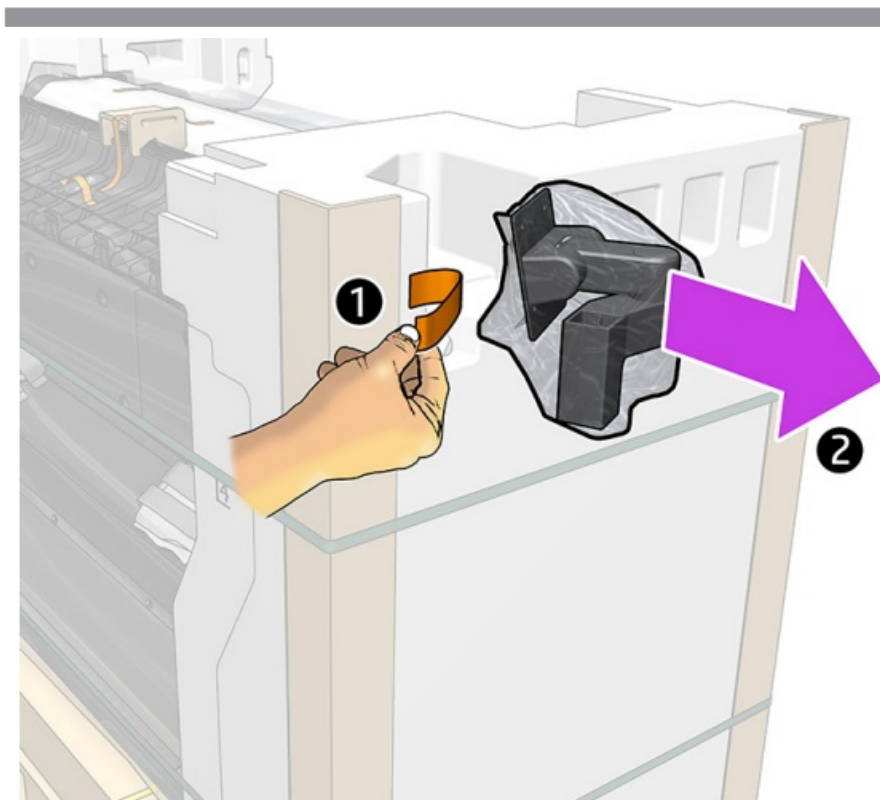

Remove the bag containing the monitor arm and place it aside for use later.

7



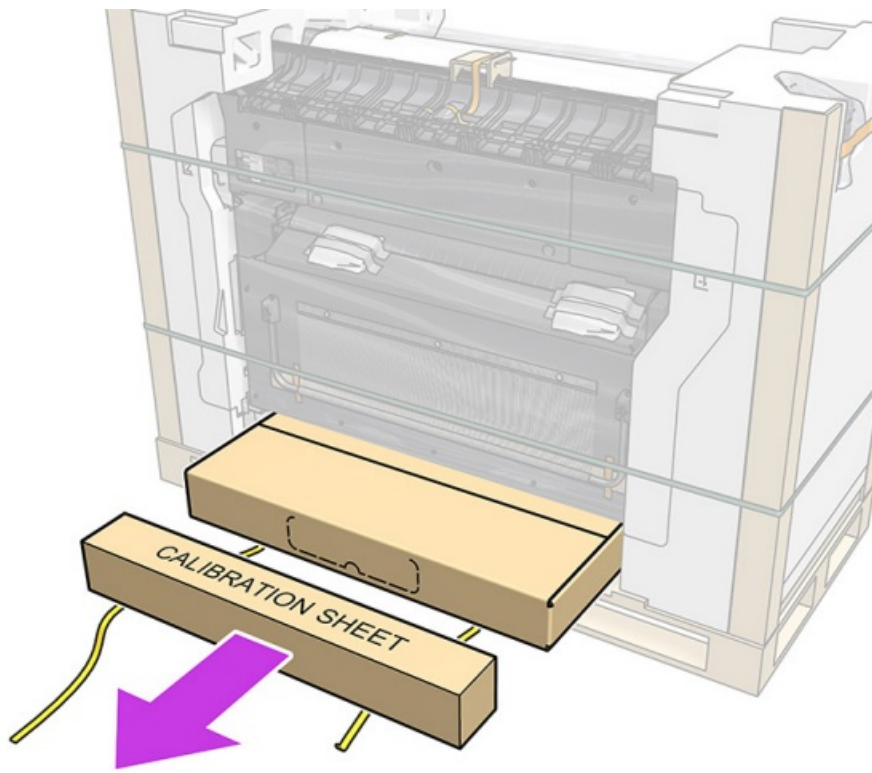

At the back of the unit, cut the yellow straps to free the the two boxes of materials. Remove the boxes.

8

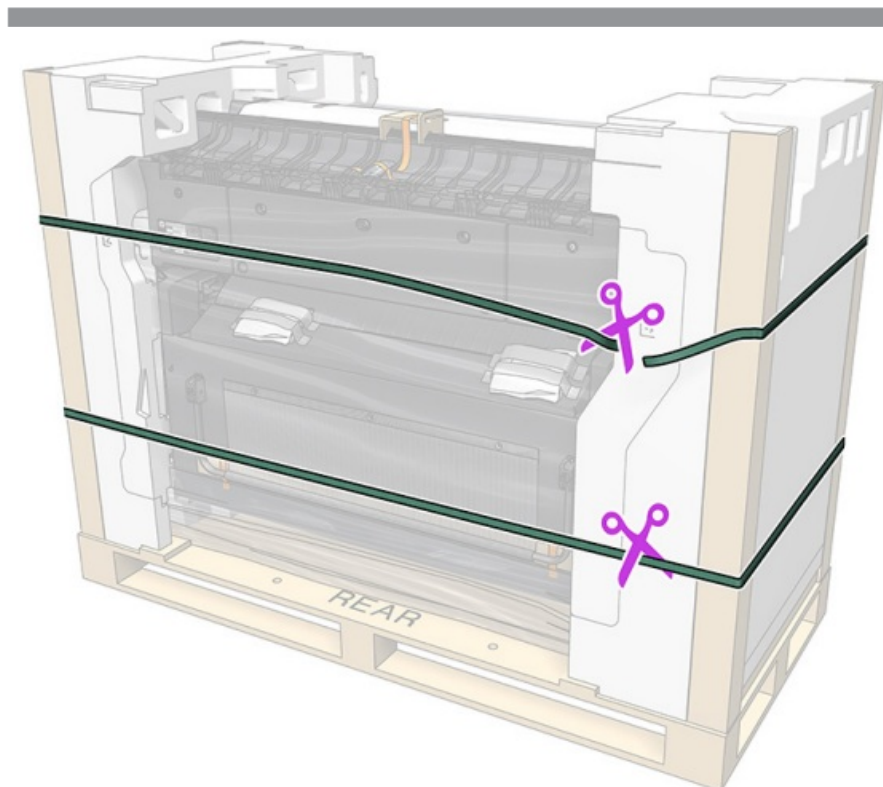

Cut and remove the horizontal plastic-straps.

9

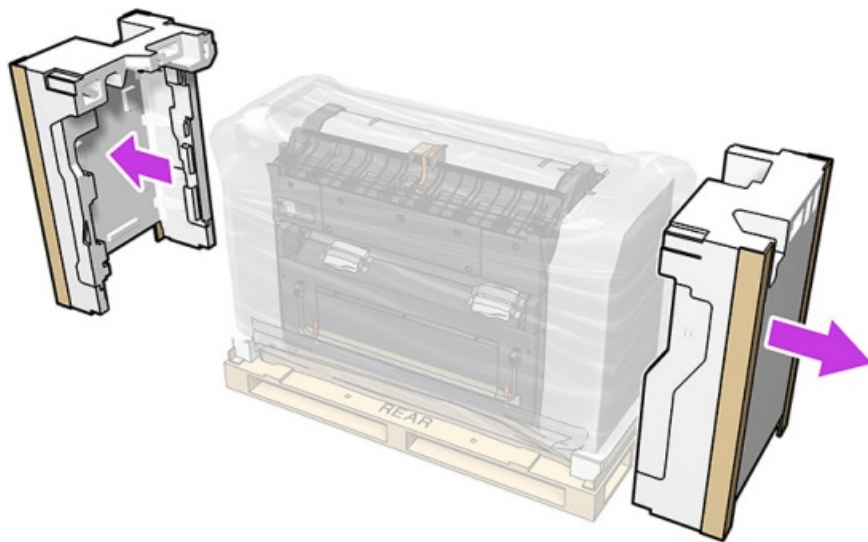

Remove the two endcaps.

Note: Do not remove the pieces that remain below the wheels yet; they will be removed in a later step.

10

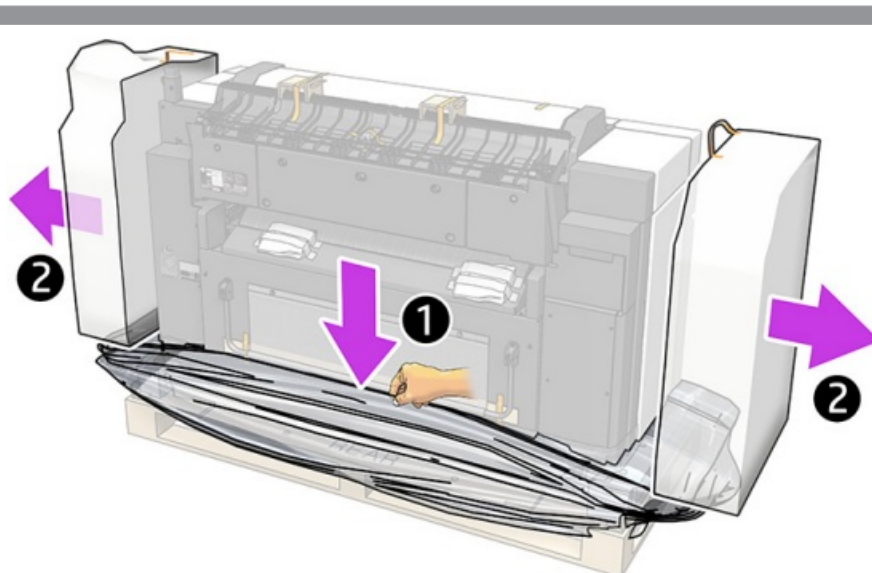

Break the plastic bag (1) and let it to be removed later, Remove the two foam protectors (2).

11



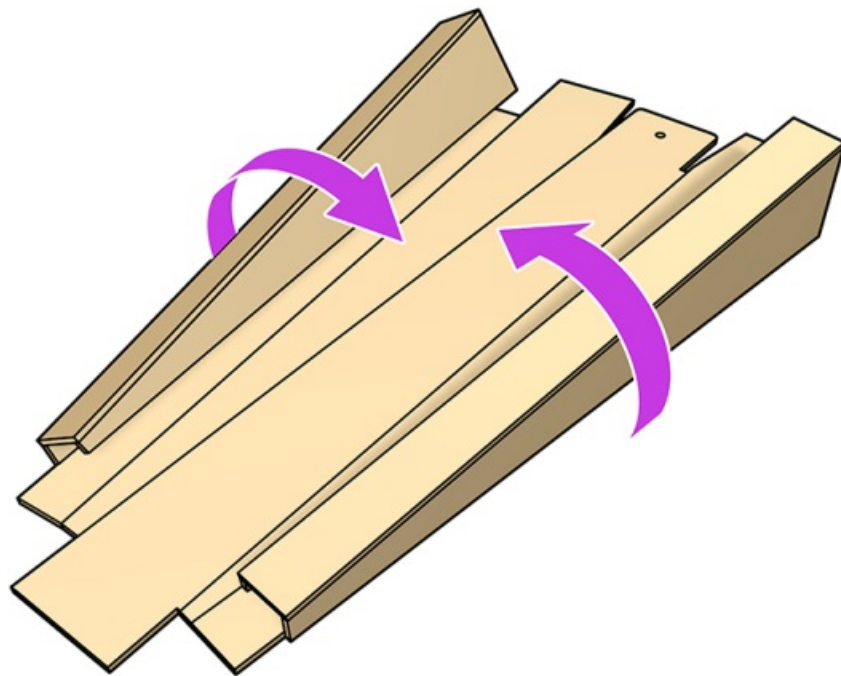

Tear open the plastic bag (1) and allow it to release later, remove the two foam protectors (2).

12

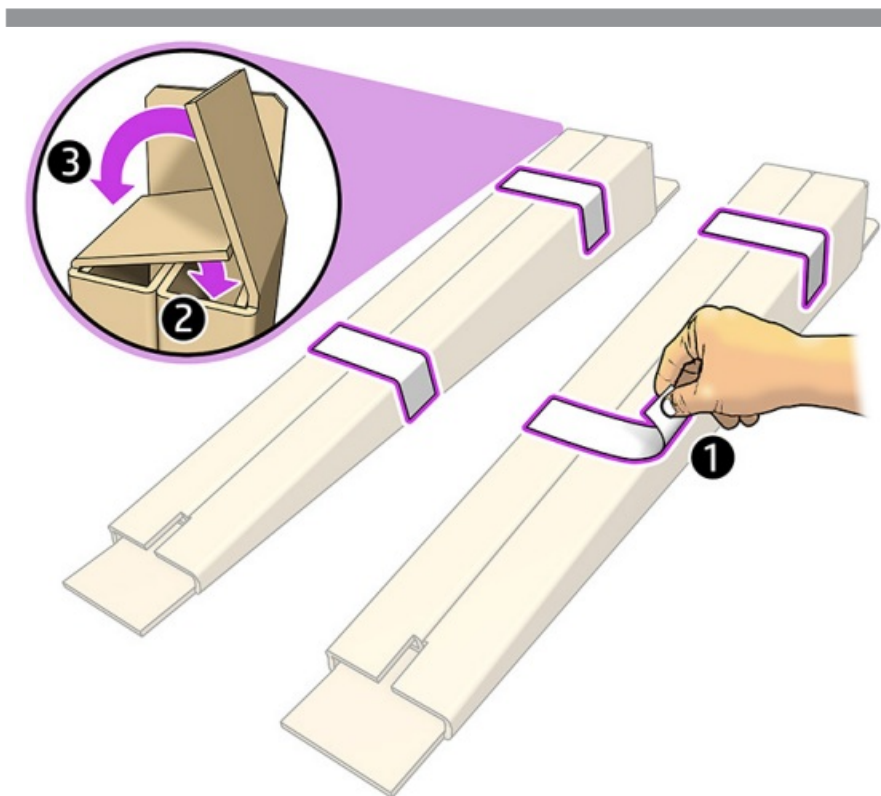

Use the tapes provided in the box to fix each ramp.

Assemble the lifters and remove the printer endcaps.

Caution: Follow the process carefully to prevent structure deformation.



13

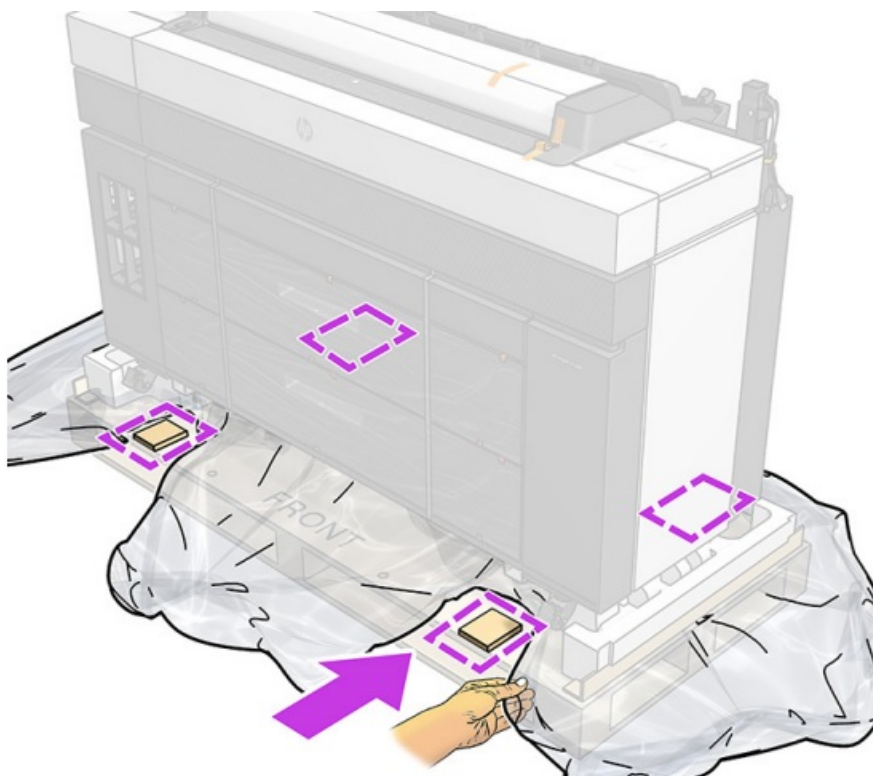

Remove all the plastic bag from beneath the lifters.



14

---

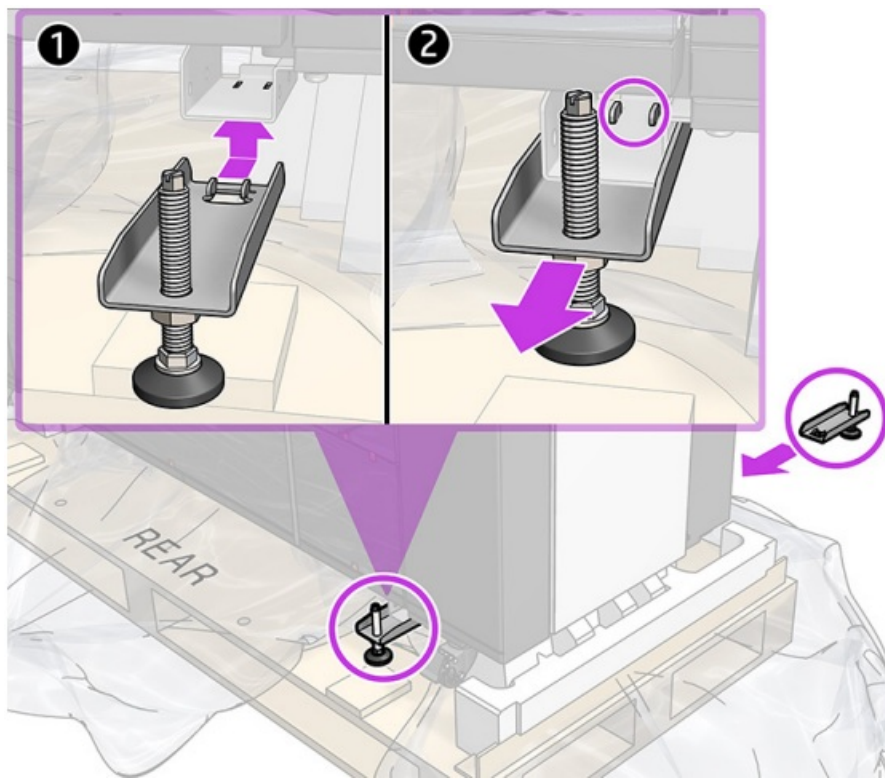

Take the bag with the 2 lifters from the accessories box.

Start on the right side of the printer:

a) Insert and slide the right-hand lifter into the bracket slots.

B) Insert the other lifter onto the back of the right-hand side.

15

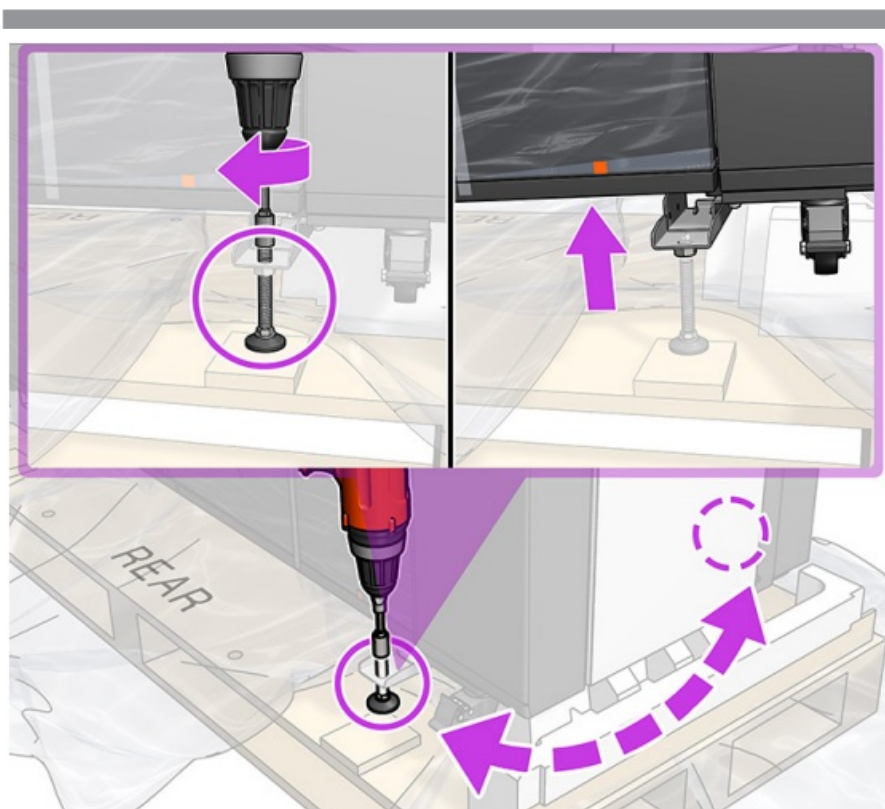

Little by little screw the bolts to elevate the printer until the endcaps are free from the pallet.

Important: Do so by alternating between right and left sides two or three turns at a time to prevent printer structure deformation and tilt issues. HP recommends an electrical nut driver with a 7 mm adapter for this.

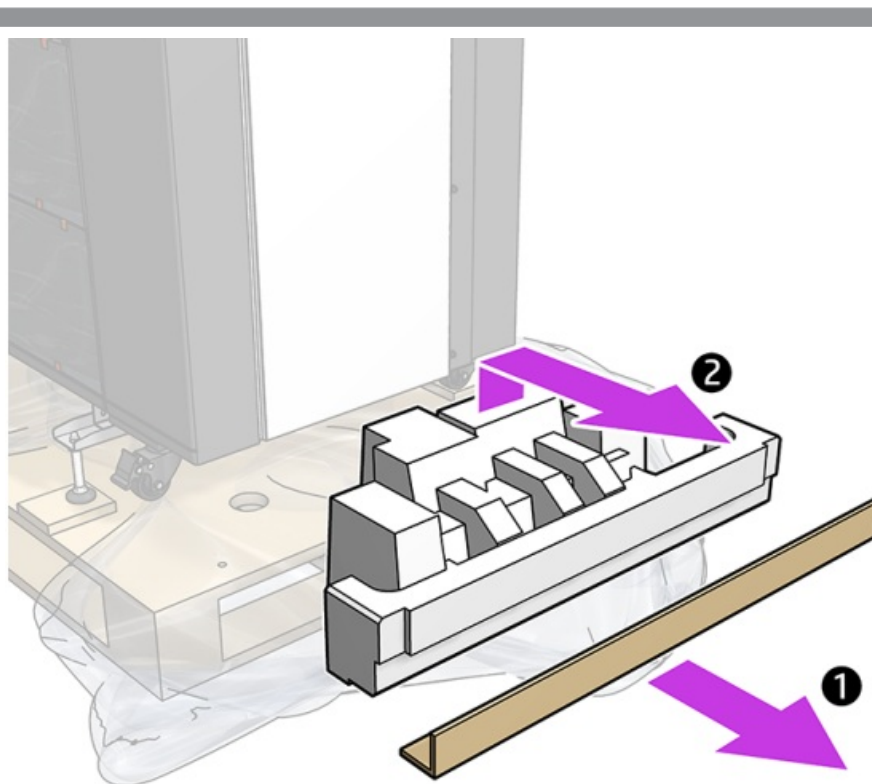

Remove the endcap.

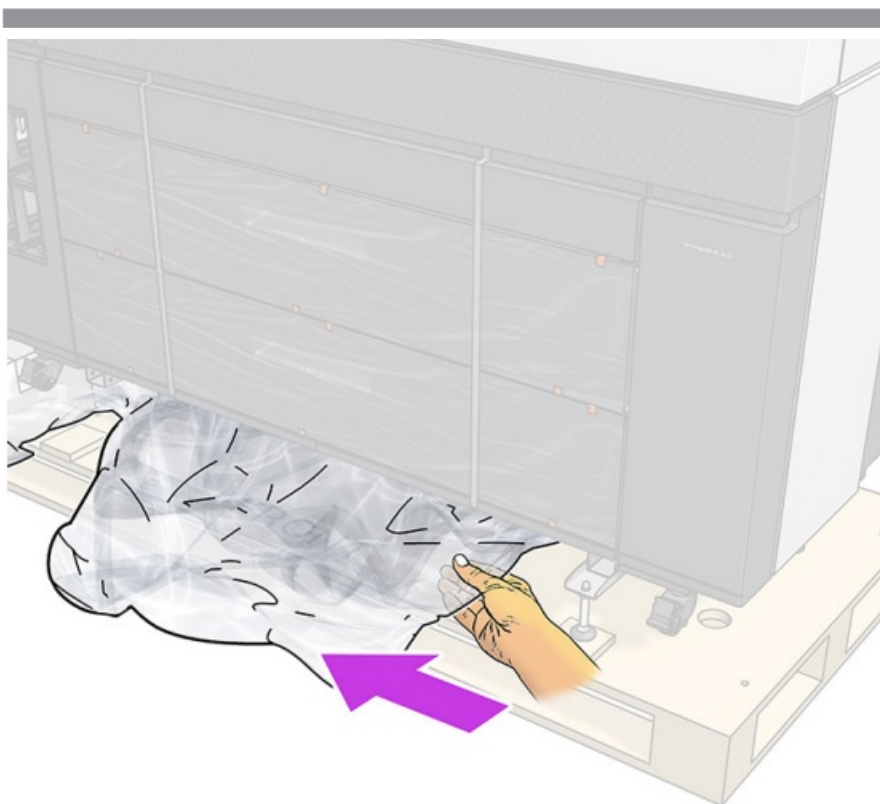

Remove the plastic.  
Important: Do not manipulate it, just pull it out.



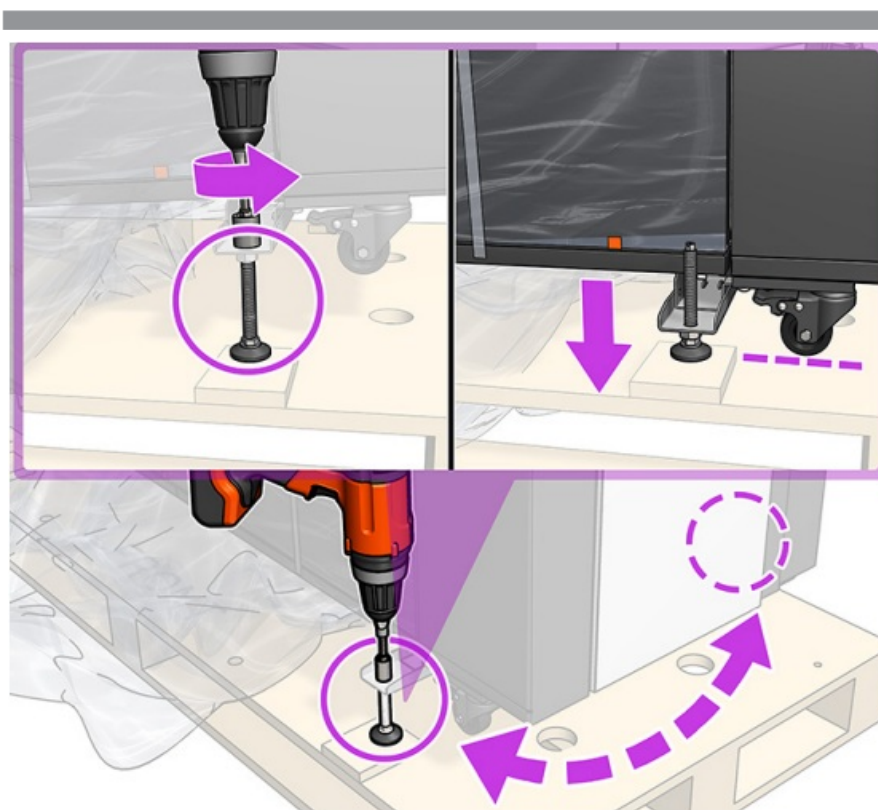

Lower the printer by reversing the step to lift it.

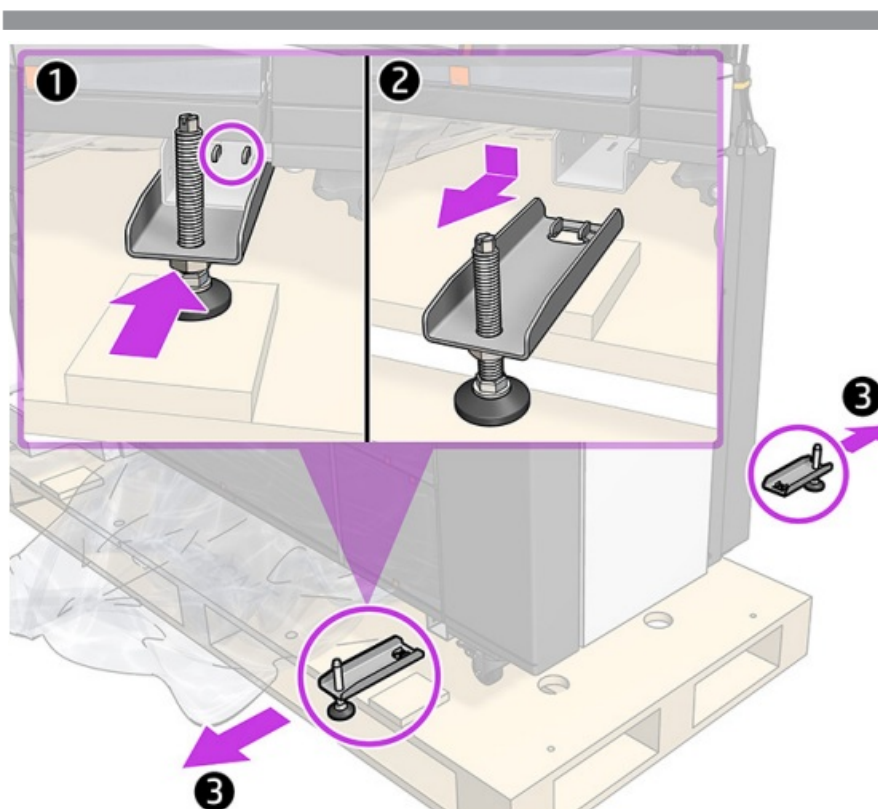

Remove the lifters.

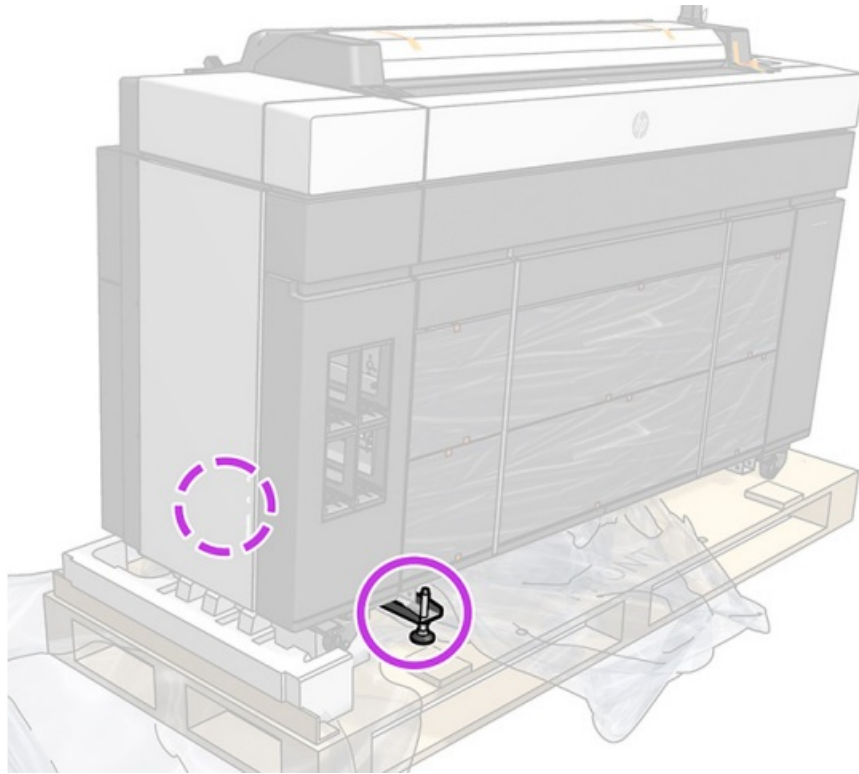

Repeat the same process on the right side of the printer.

Move the printer off the pallet





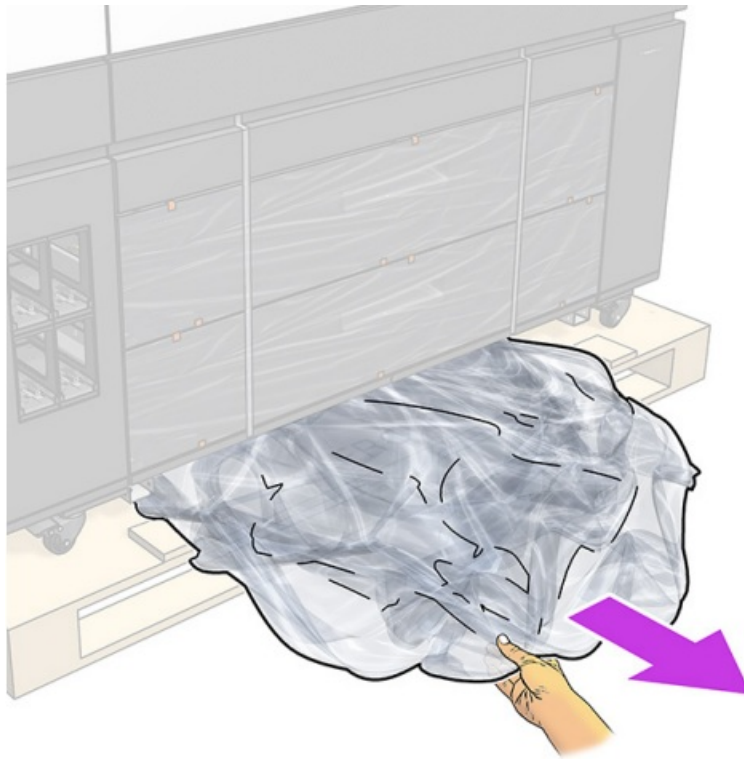

Remove the plastic.

22

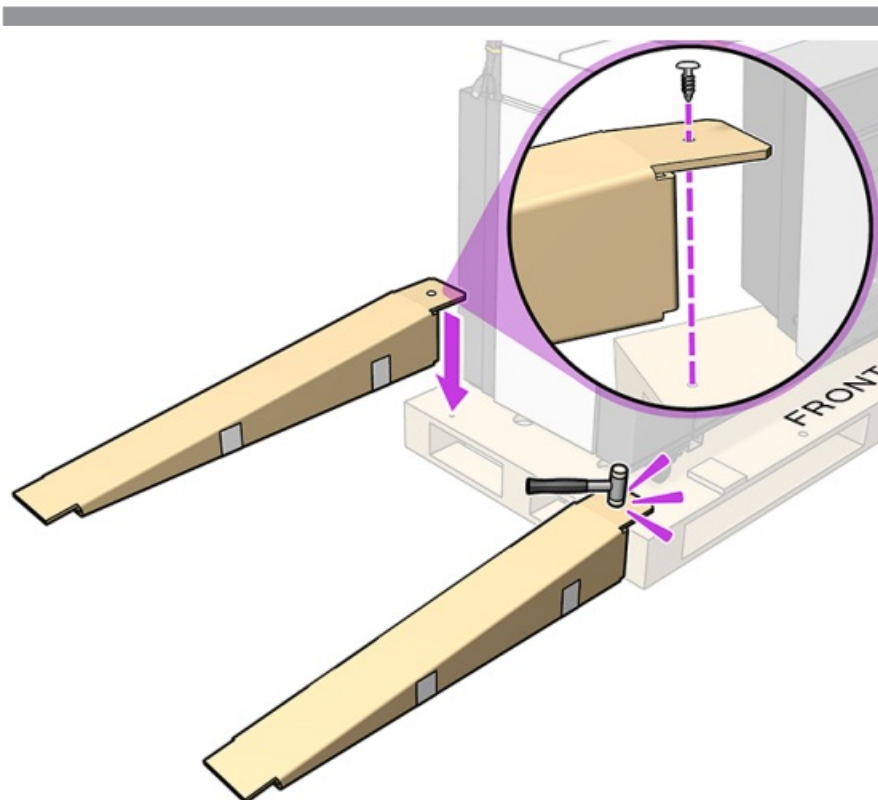

At the left side of the unit, use the white screws—located in the accessory box—to fix the ramps to the pallet.

23

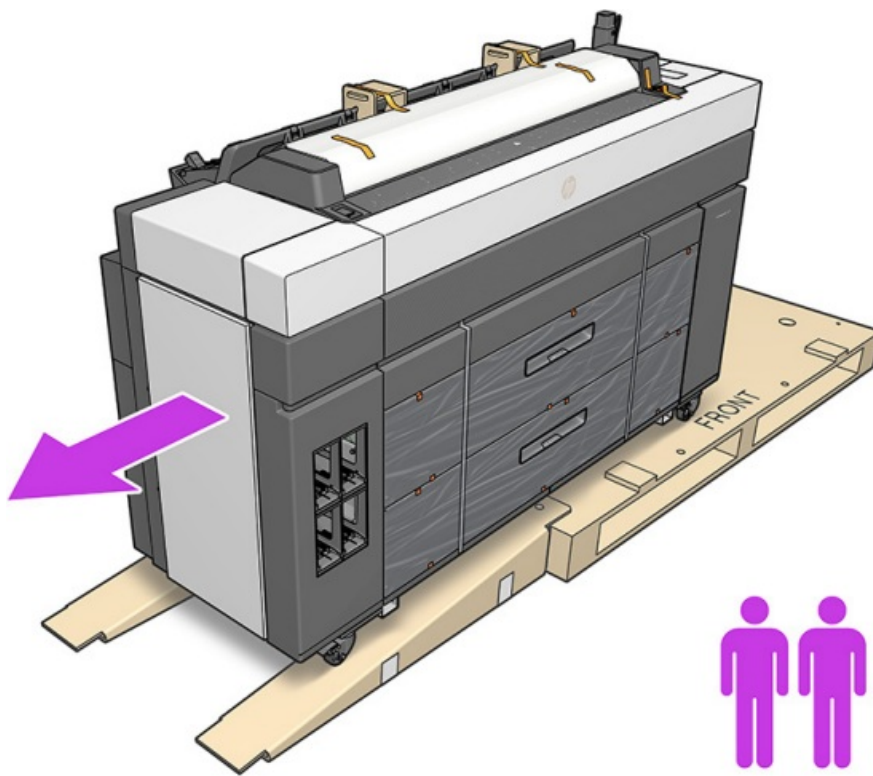

Turn the wheels to align them with the pallet. Using one person at each end, carefully slide the printer down the ramps, try to avoid the screw added in the previous step and align again. Move the printer to its final destination and lock the wheels.

24

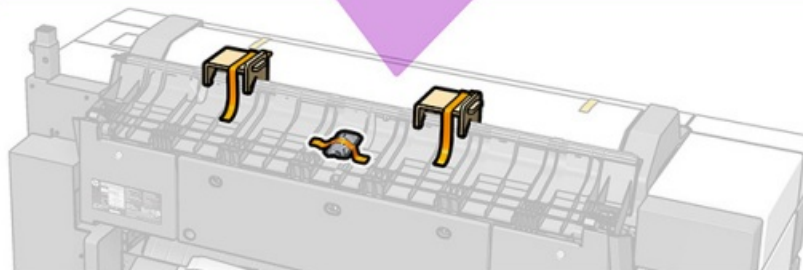
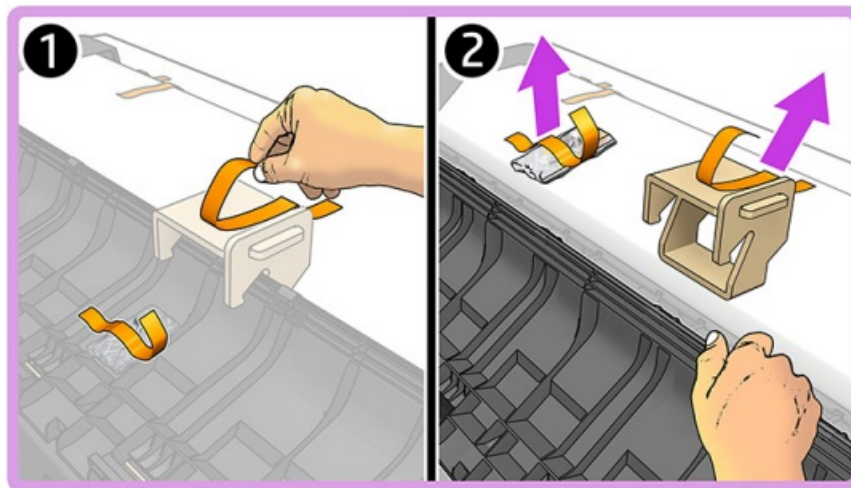

Remove the tray-holder locks and bag of stacker screws. Put the screws to one side for later.

25

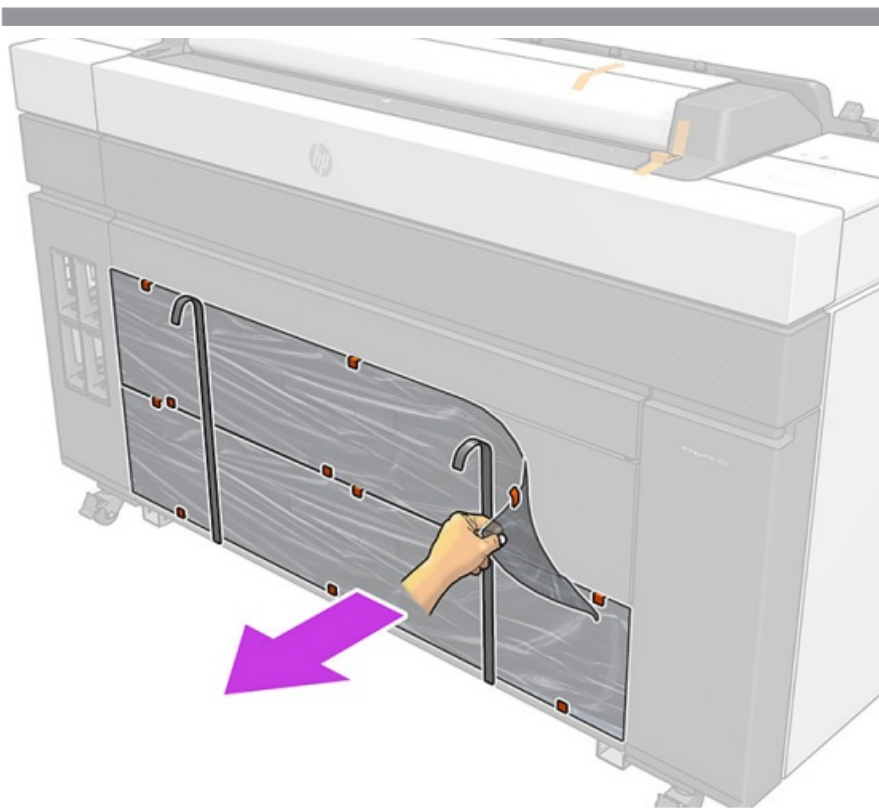

Remove the protective covering from the drawers.



Assemble the control panel

26

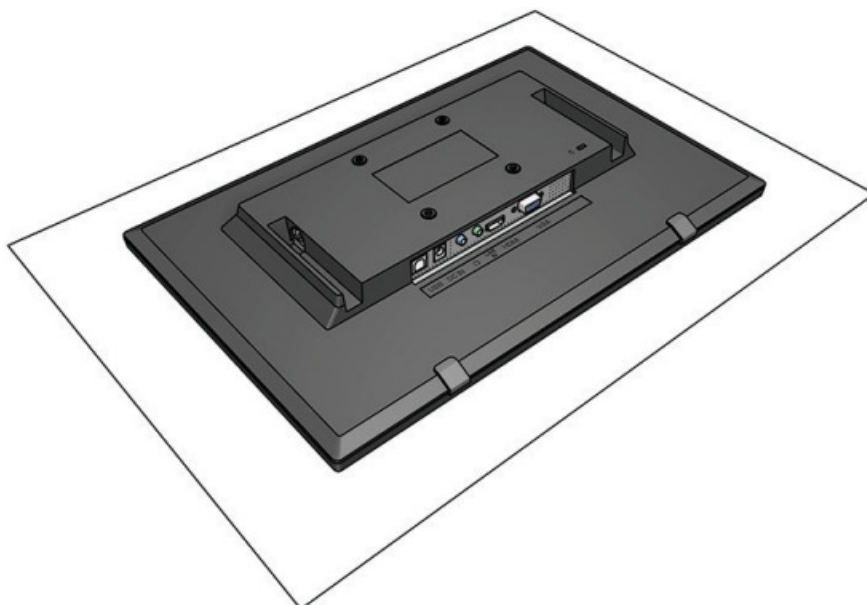

Take the control panel from the box and place it onto a cloth to avoid scratches.



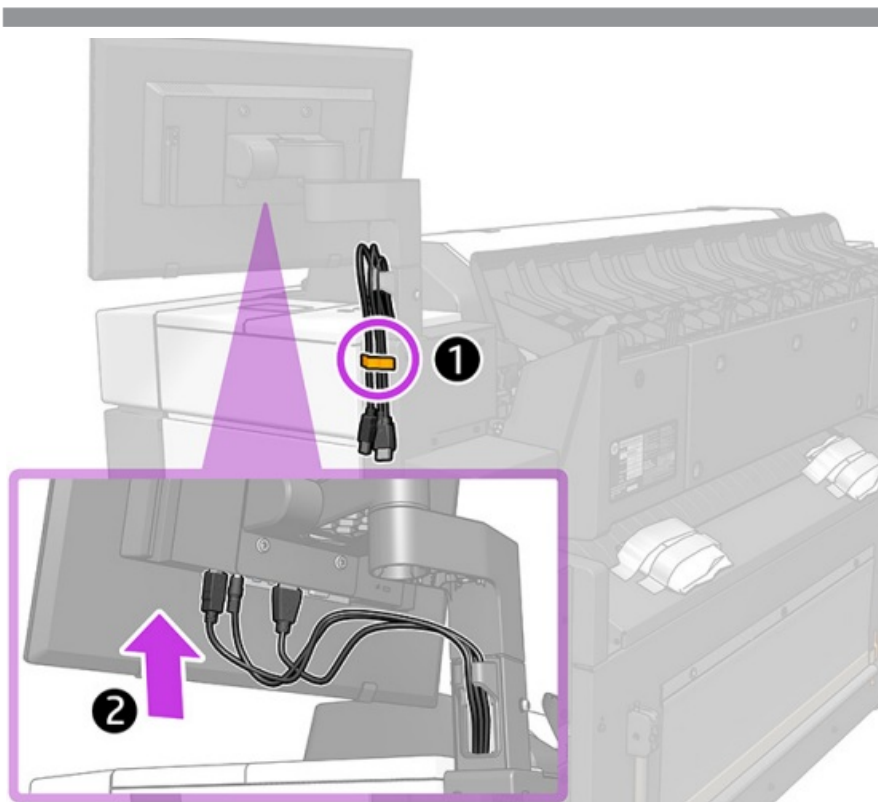

Remove the orange tapes and plastic bags, then route the cables through the control-panel support.

Assemble the stacker

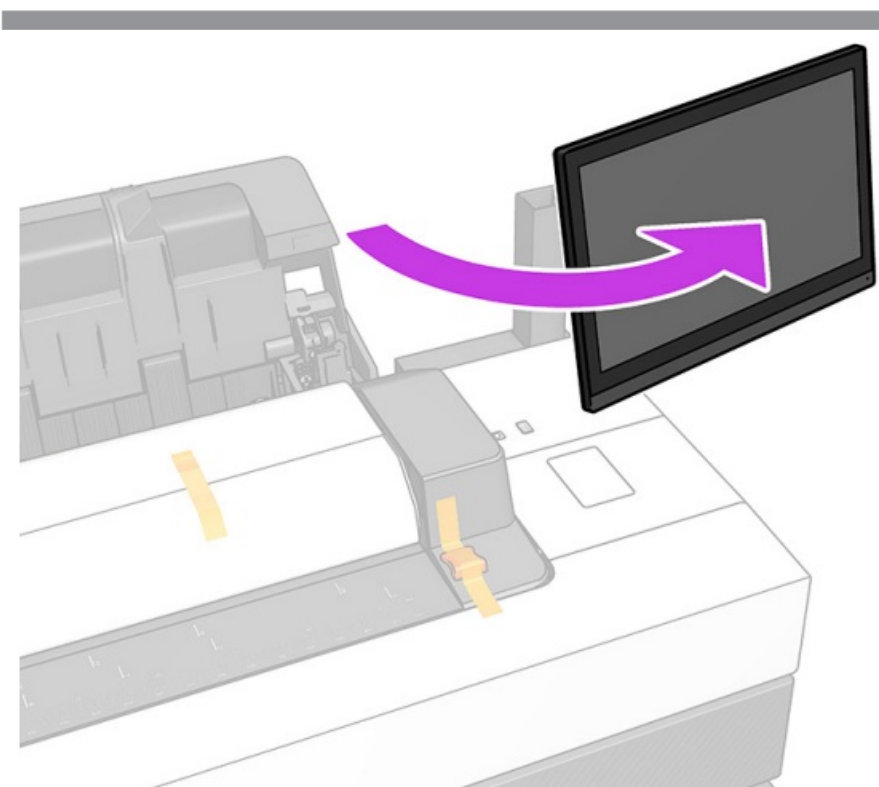

Rotate the control panel out of the way to create space.



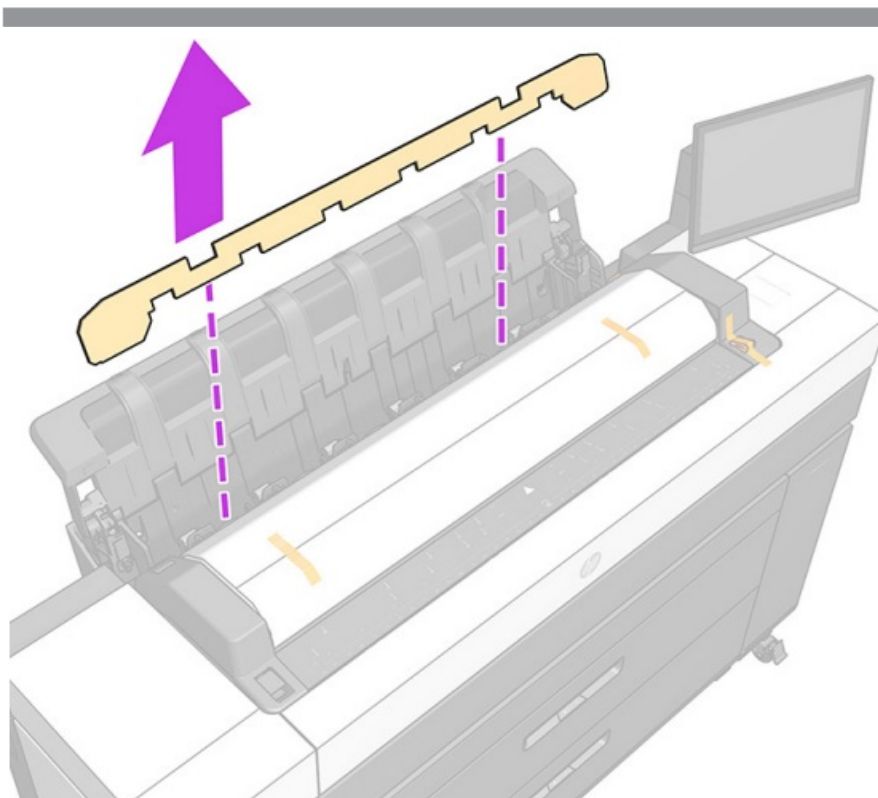

Carefully remove the carton from inside the stacker.  
 Note: Perform this step with caution.

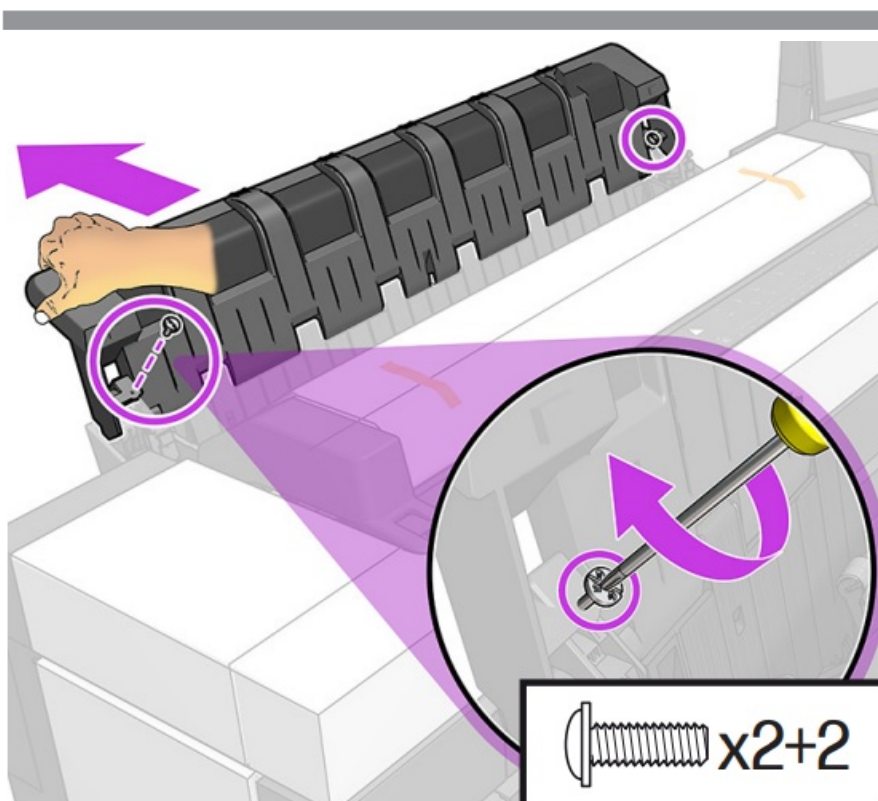

Pull the stacker back and hold it (1), then fix it into position with two T25 screws, one each side (2).  
 Tip: Start at the left side of the stacker.



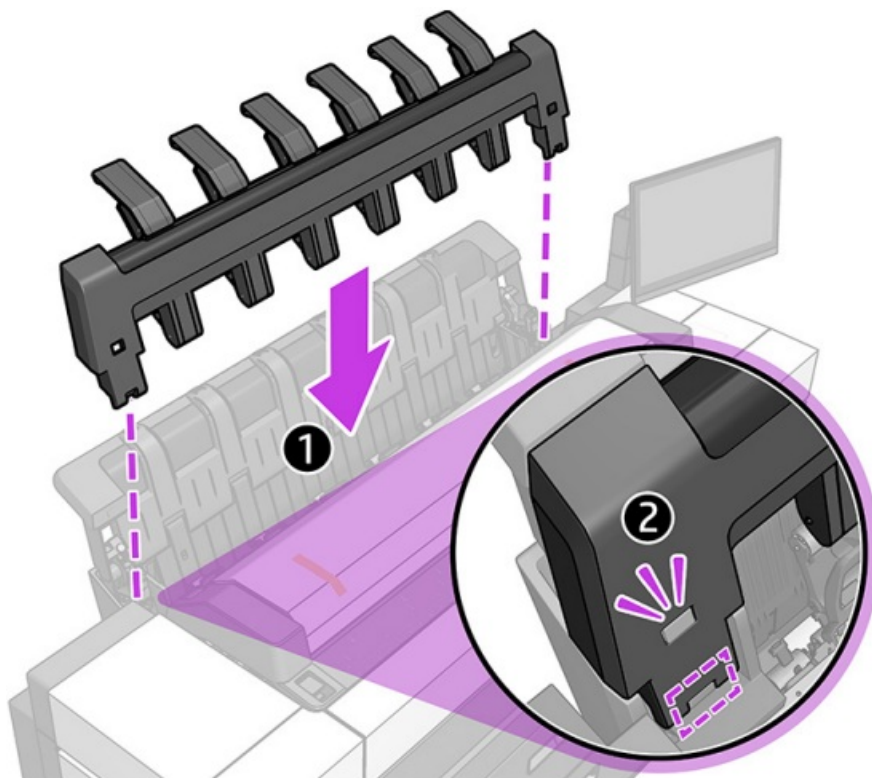

Remove the foam protector and the orange tapes from the stacker arms.  
Insert the stacker arms into the stacker.  
Caution: Do not touch the blue labels during insertion.

Remove the security locks and insert the deflectors.

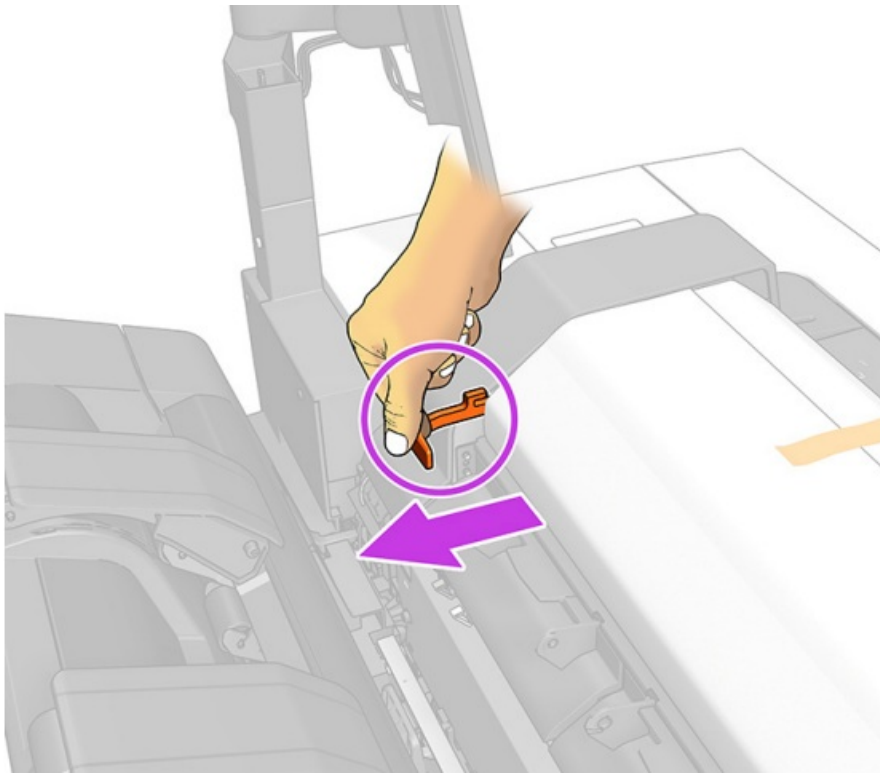

Remove the scanner locking pin by pulling it forward.

35

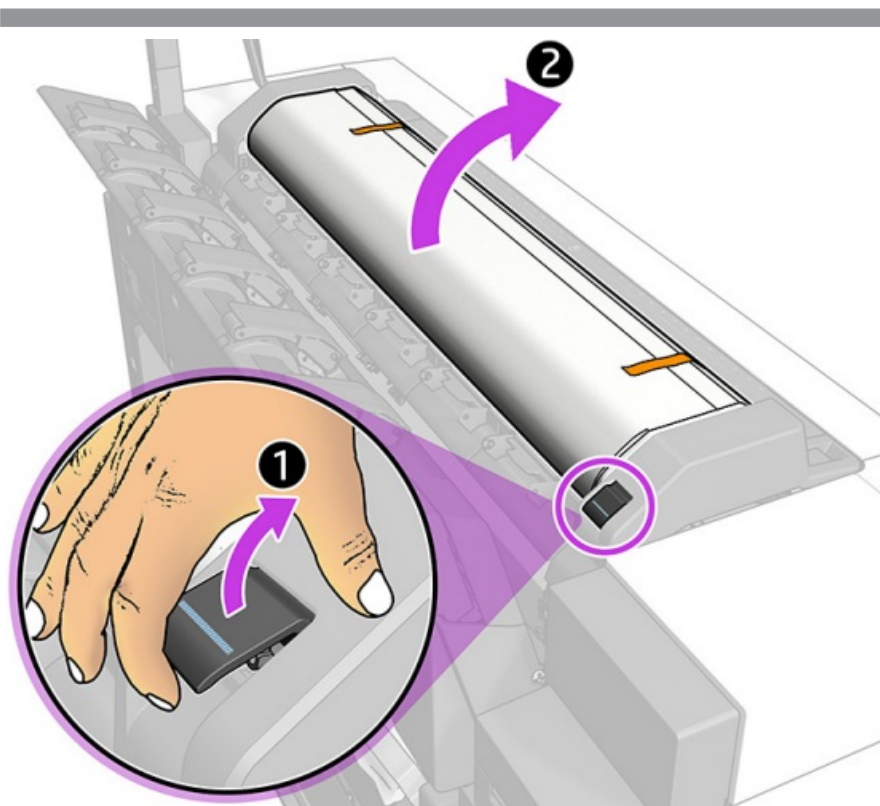

Pull up the latch (1) and open the scanner (2).

36

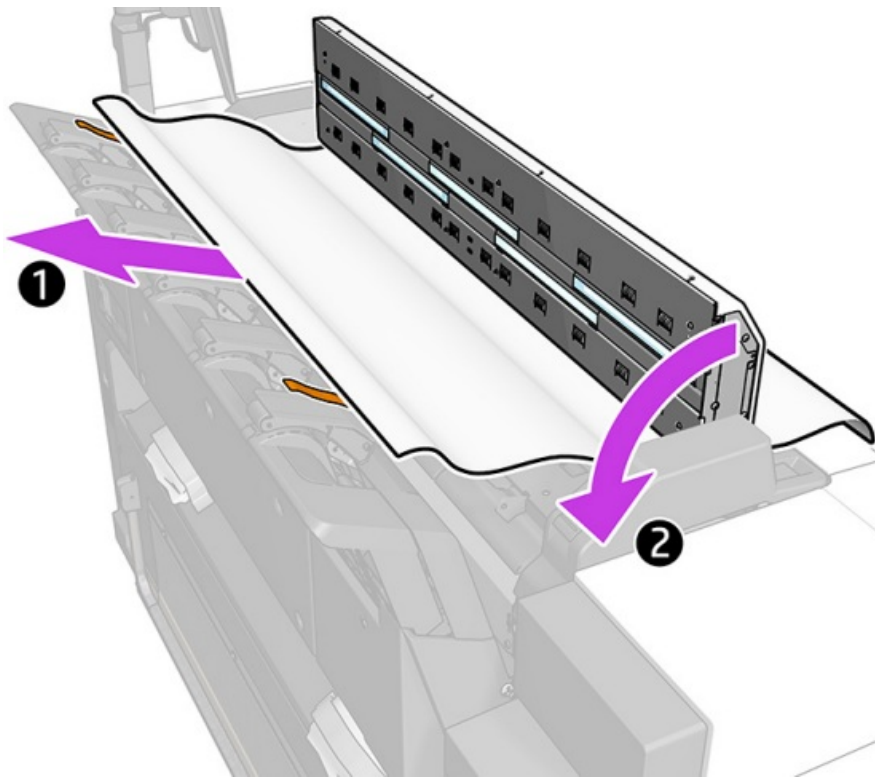

Remove the protective foam (1) and close the scanner (2).

37

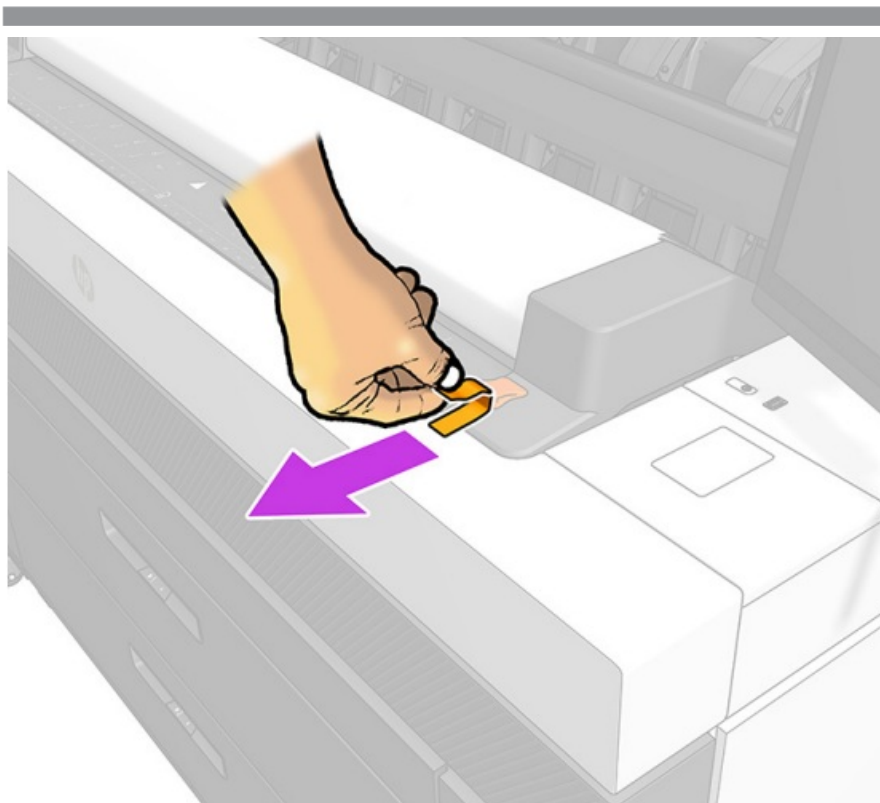

Remove the orange tape from the scanner locking key.

38

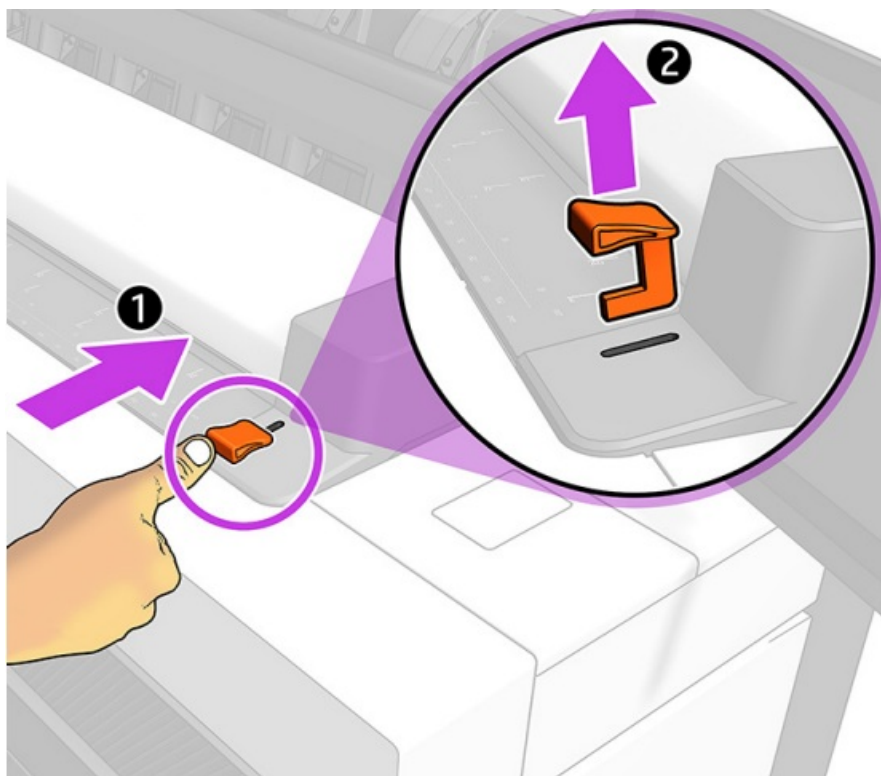

Remove the lifters.

39

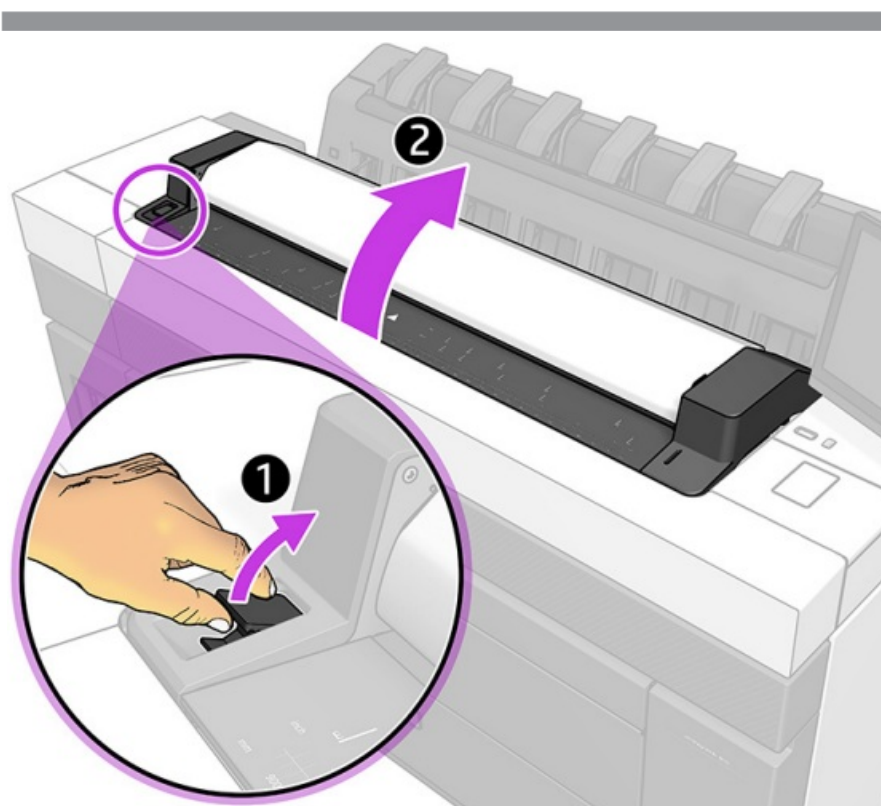

Pull up the latch (1) and open the scanner (2).

40



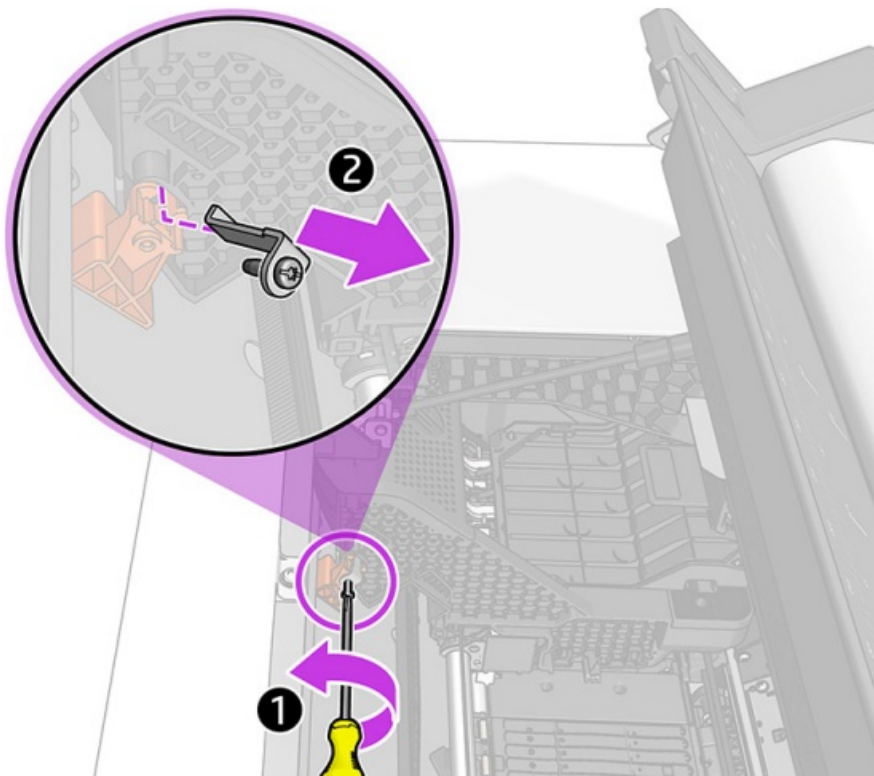

Remove the T15 screw and metal piece from the carriage.

41

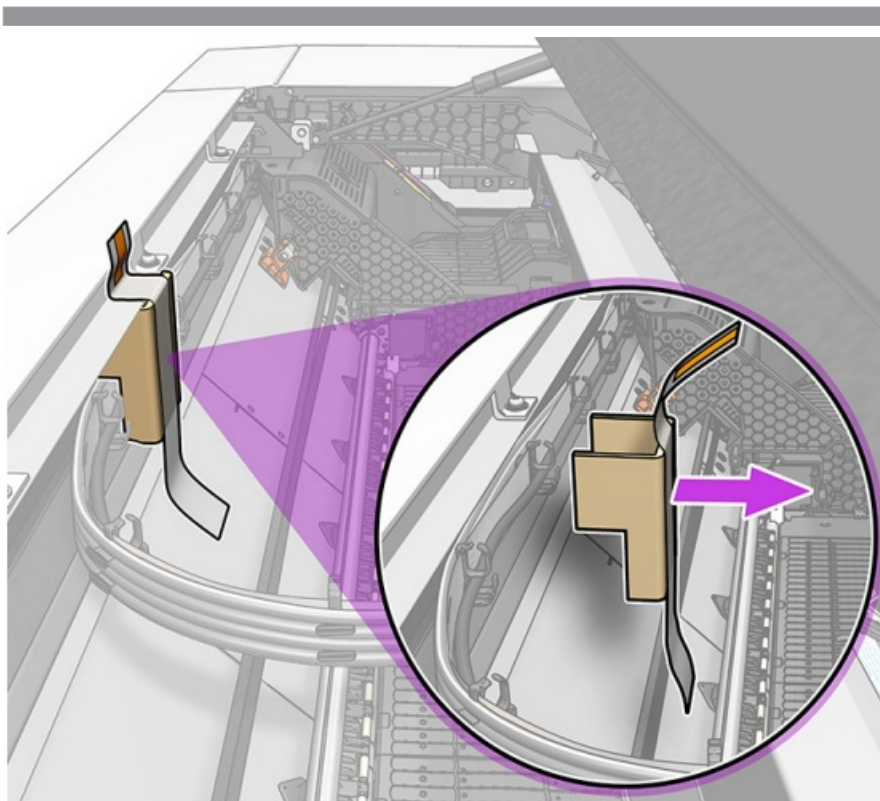

Remove tape and cardboard packaging that holds the SRK in place within the print zone. Pull away from the SRK at 90-degree angle (as pictured).

42

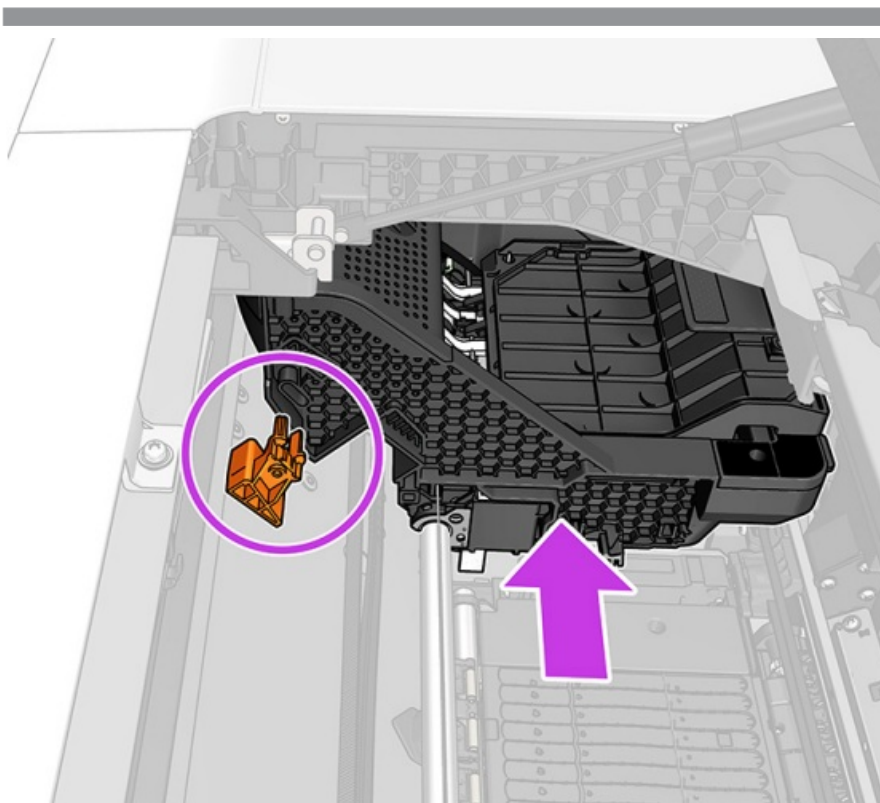

Push the carriage to the left to access the orange carriage-lock.

43

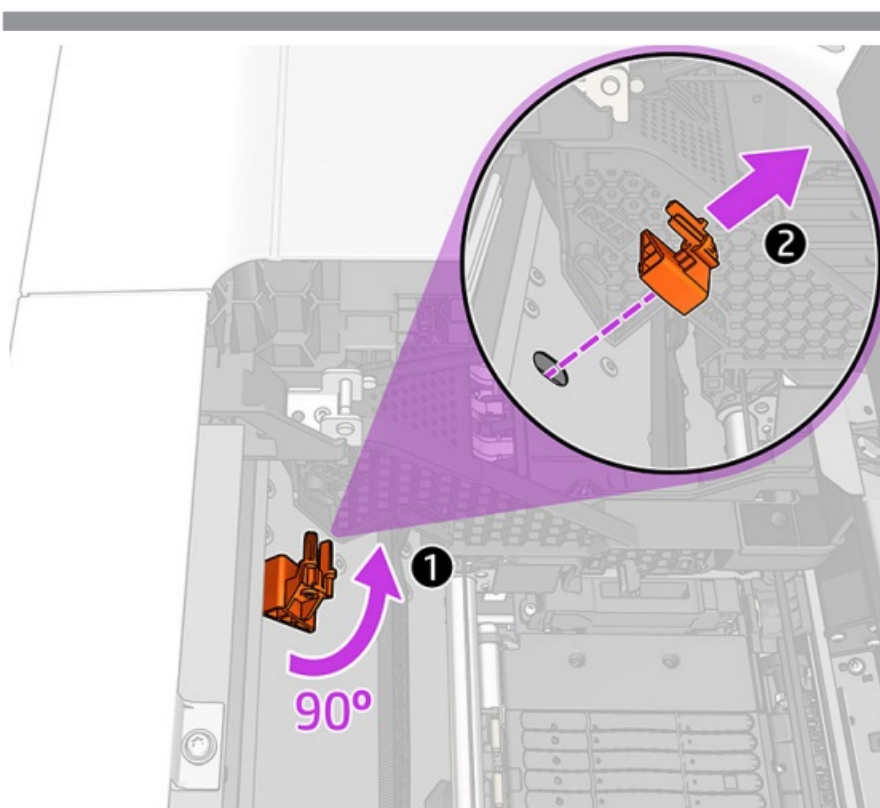

Remove the orange carriage lock by rotating it (1) and pulling it out (2). Close the scanner.

44



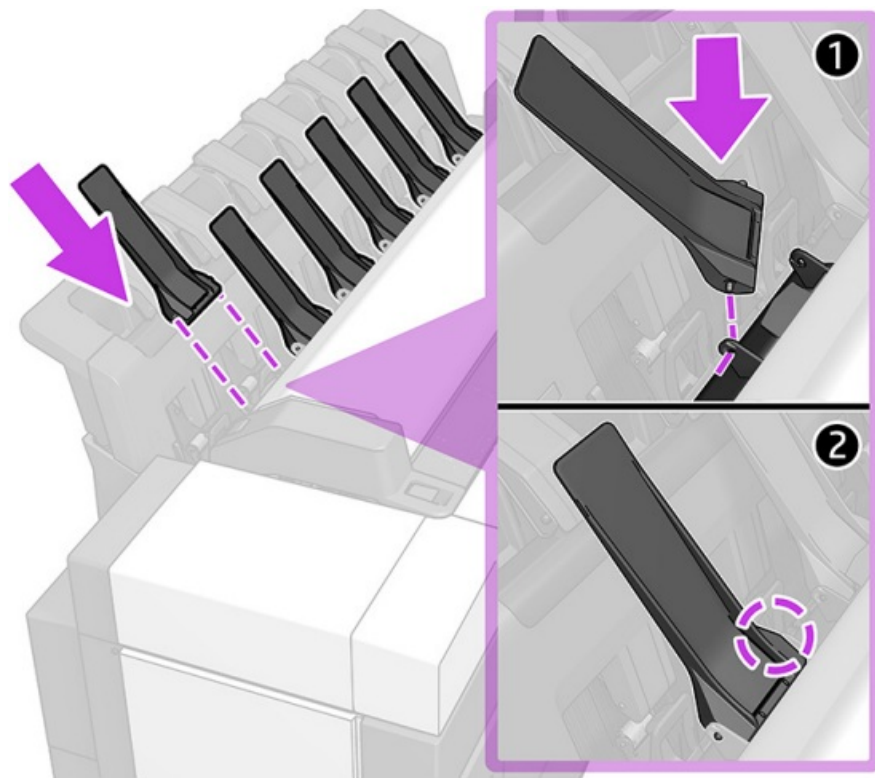

Insert the six deflection guides; first insert one side (1) and then click the other side into place (2).

Remove the packaging and security locks from the drawer.

45

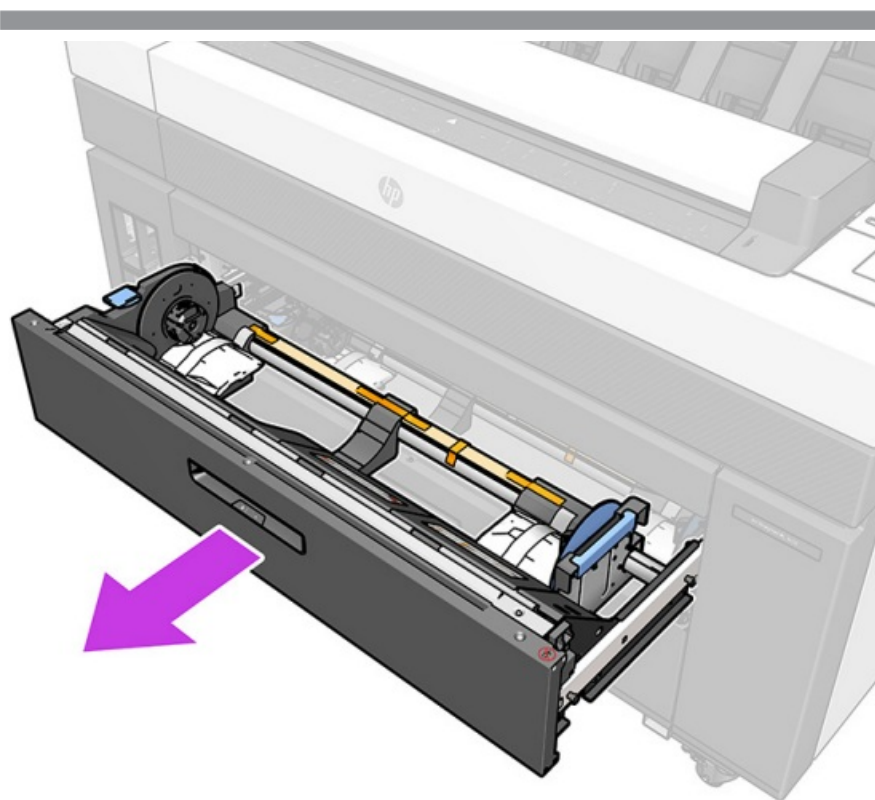

Open the top drawer.

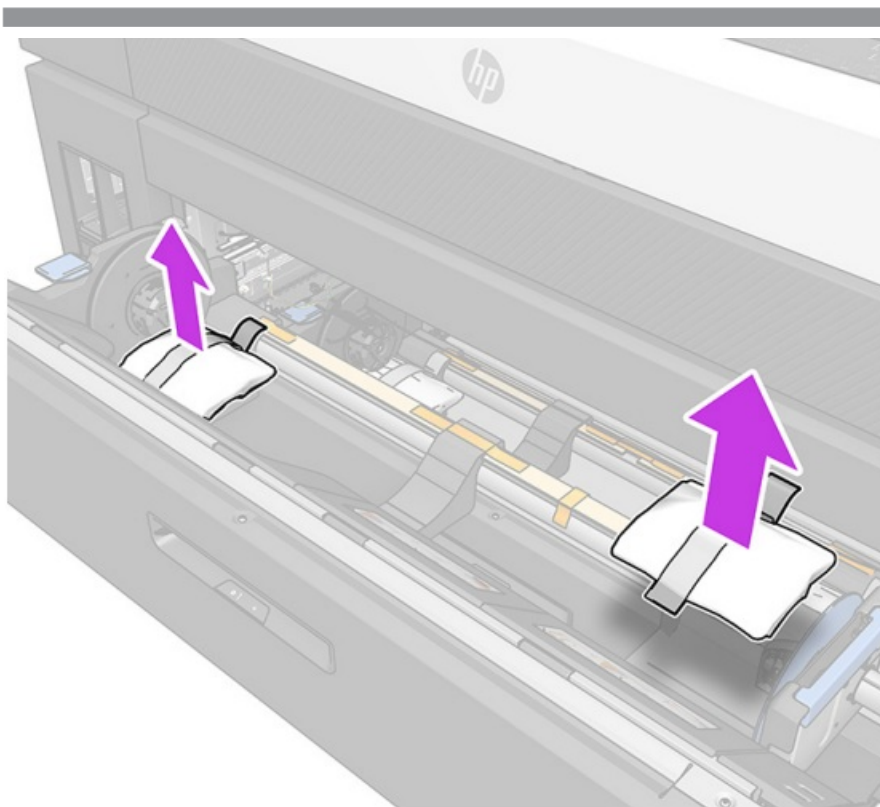

Remove the two desiccant bags.

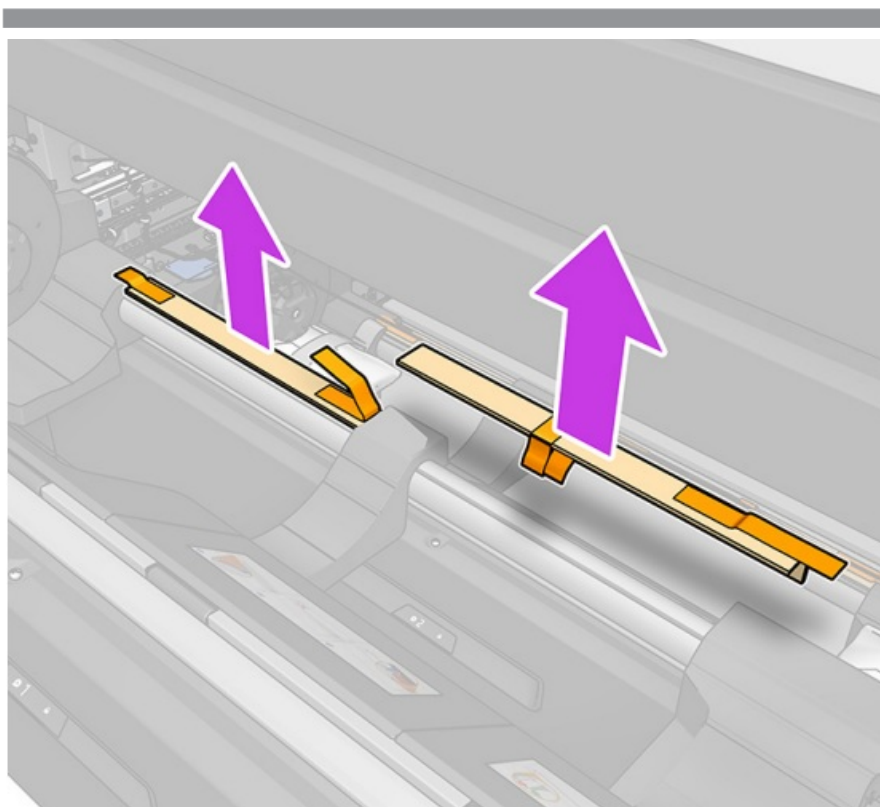

Remove all the orange tapes and the two carton protectors.

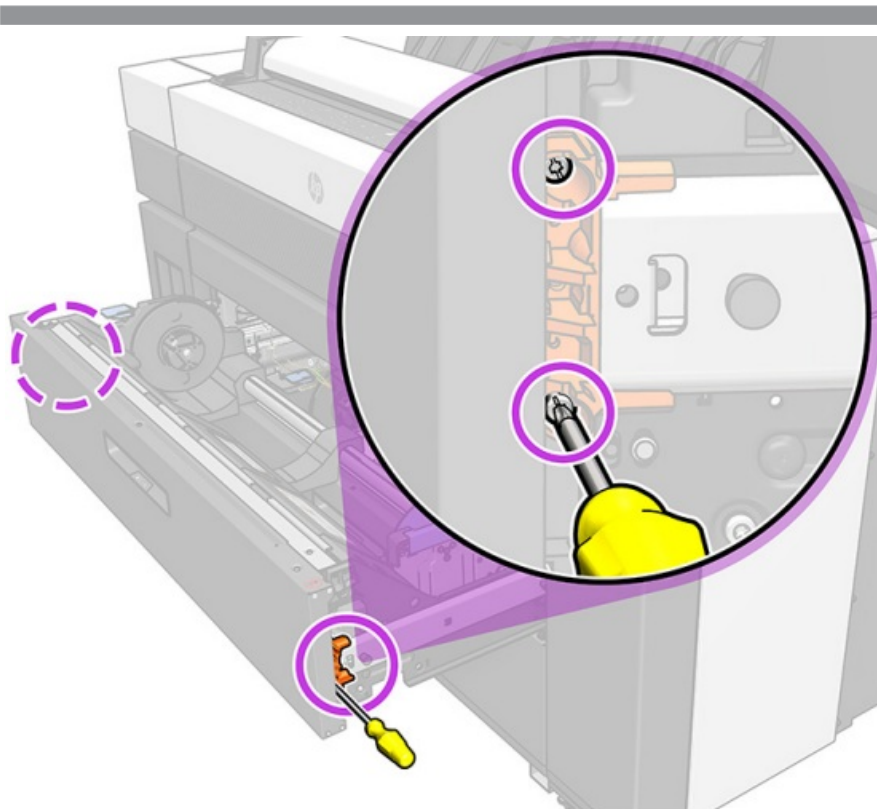

Remove the two T15 screws from each of the orange locks. There is one lock on each side of the drawer.

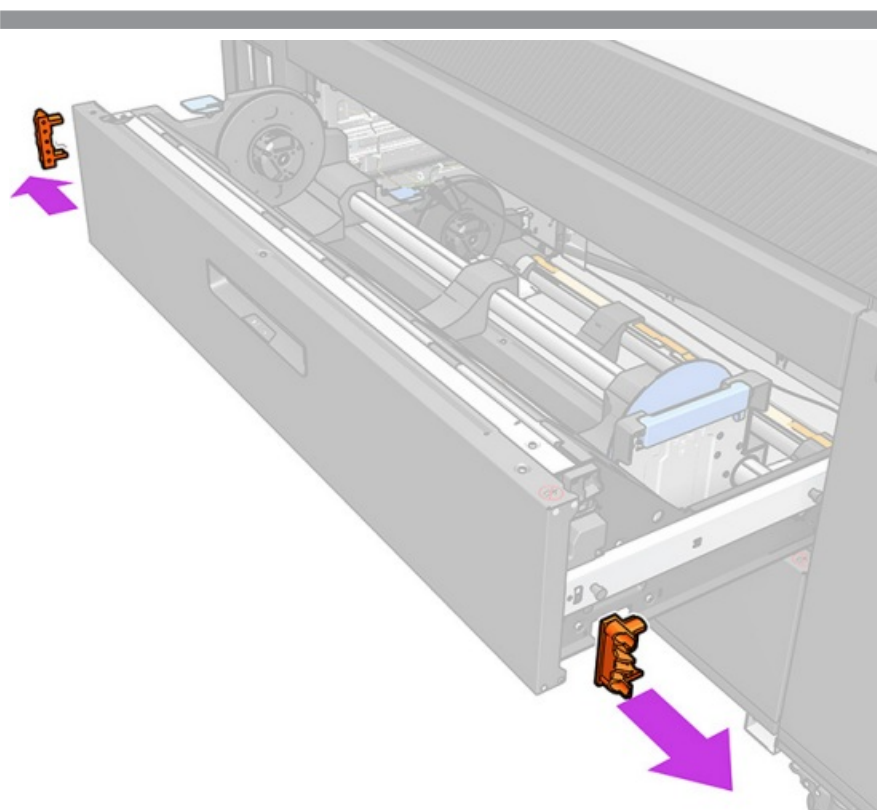

Remove the two orange locks.  
Now follow the same steps for the bottom drawer.

Install the drawer pins

50

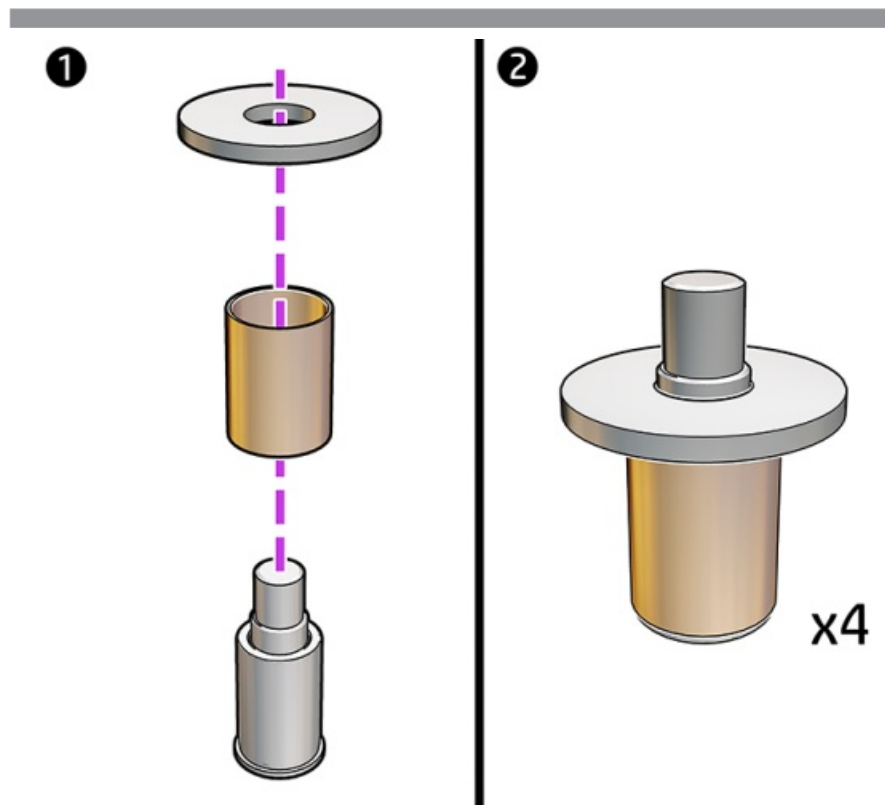

Assemble the four pins by adding a sleeve and washer to each one.

51

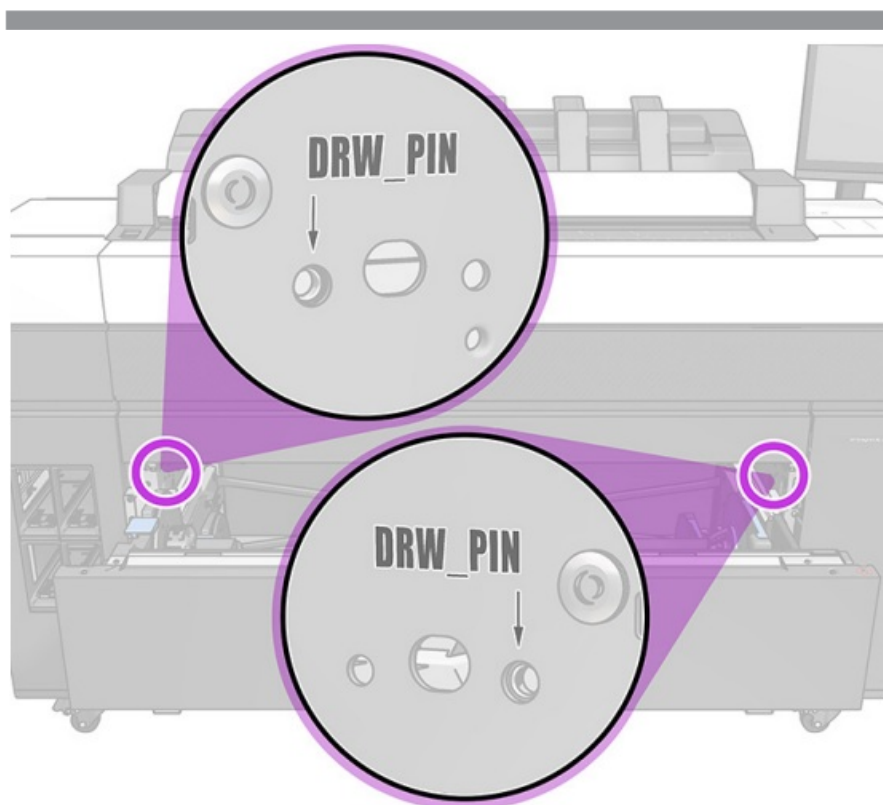

Locate the holes where the pins will be inserted; they are marked with a printed draw-pin and an arrow pointing to the position.

52

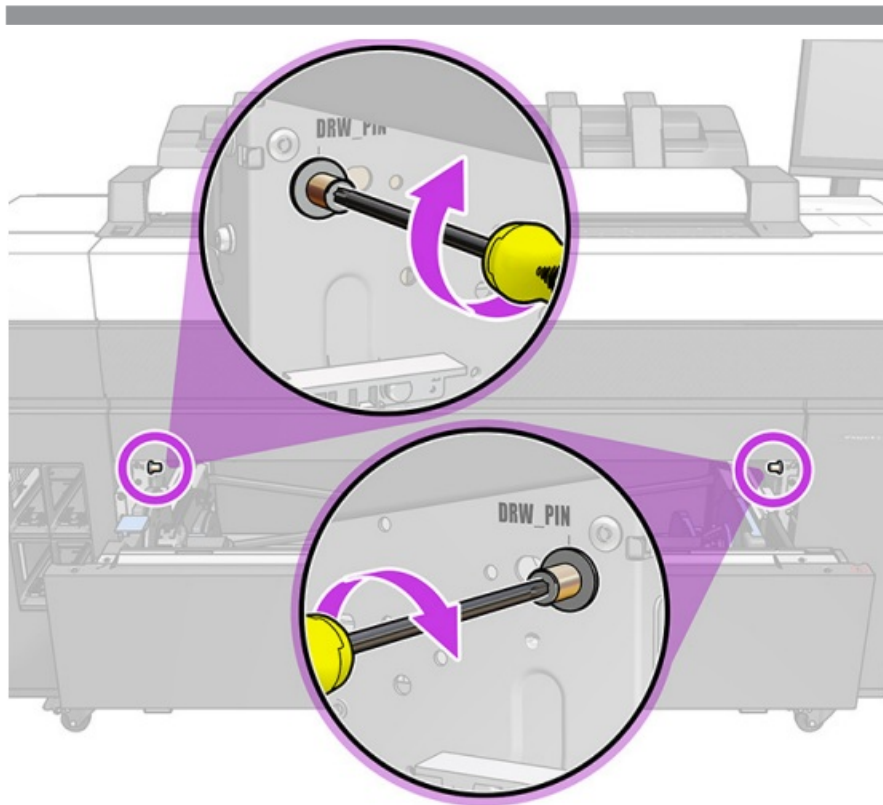

Insert the pins and screw (T25) them firmly into place.  
Now do the same for the bottom drawer, they are located at the same place.

Assemble the basket

53





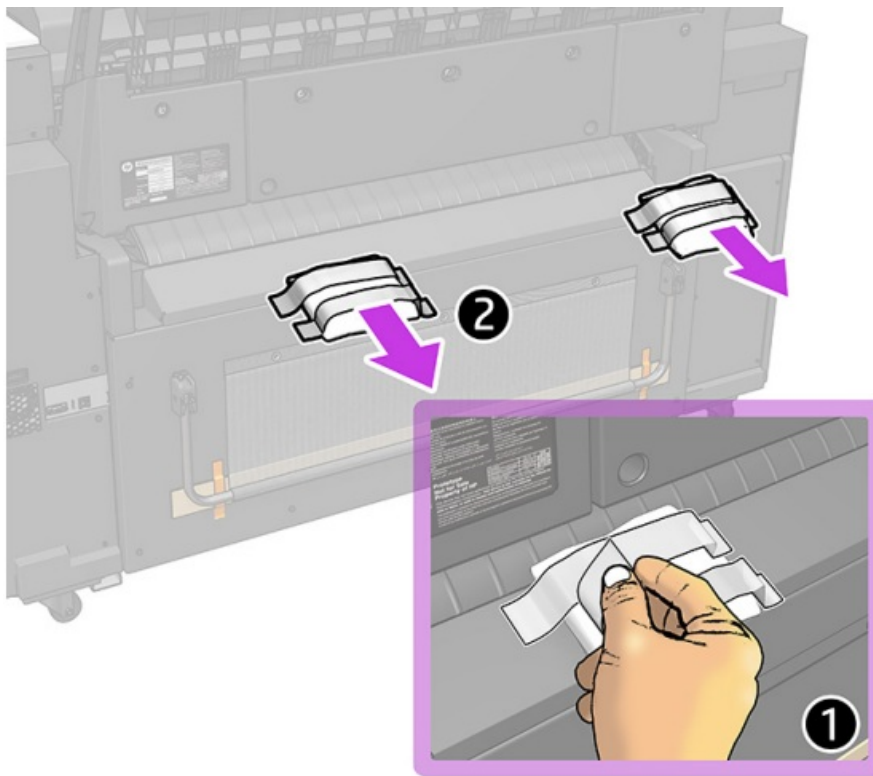

Remove the two bags from the rear of the printer.

Note: The basket comes preinstalled on the unit, and in the folded, lower position.

54

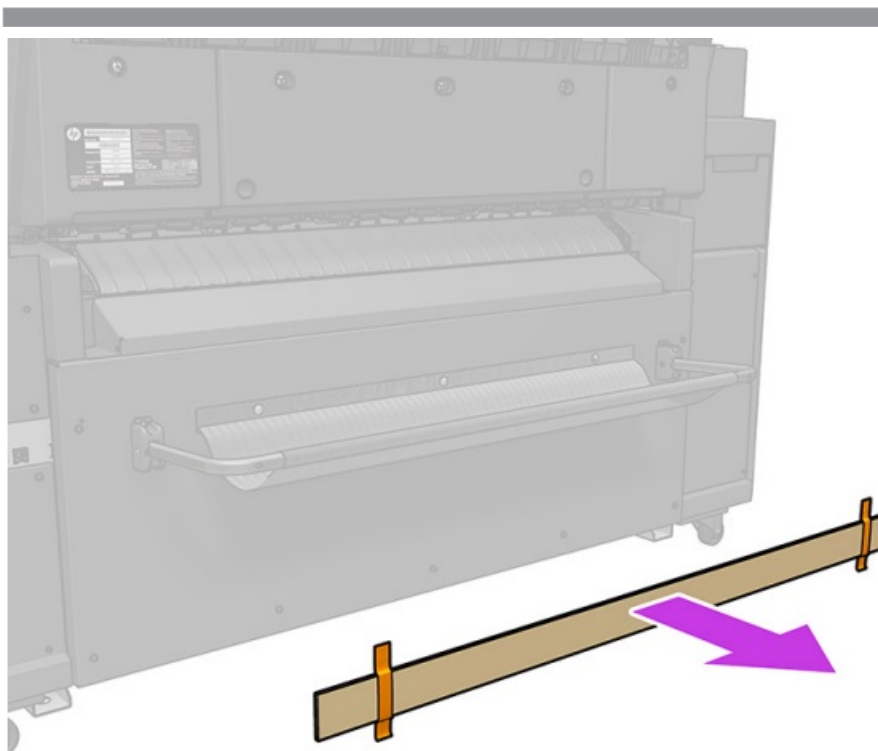

Remove the carton piece and all remaining orange tapes.

Note: The basket prevents the unit being placed against a wall. This is intentional to ensure stable functioning of the stacker.

55



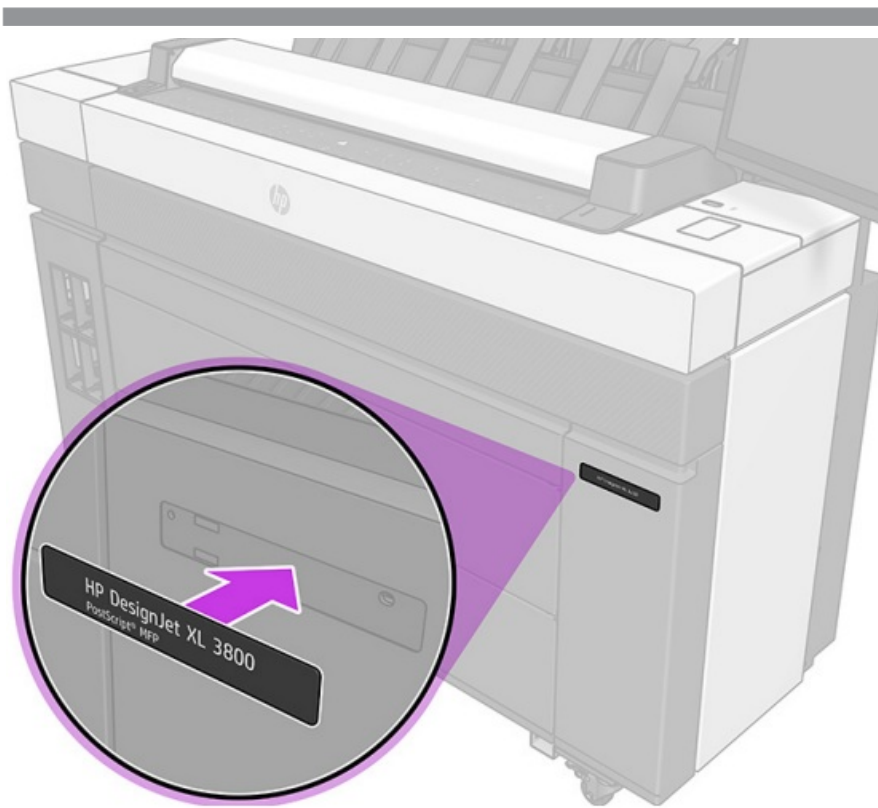

Place the label "HP DesignJet XL 3800 Postscript MFP" at the front of the printer.

Connect the power and LAN cables

56

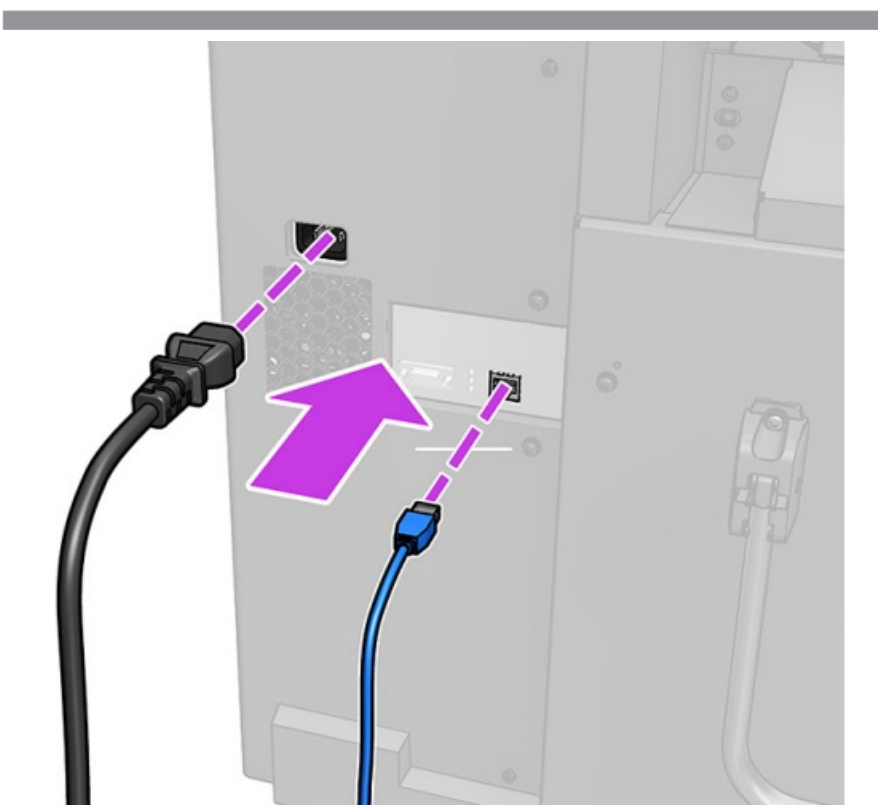

Connect the power cable and the LAN cable to the back of the printer.



Turn on the printer and follow the instruction on the control panel.  
After the printer setup, make sure to do a Scanner Calibration using the calibration sheet provided, to avoid possible IQ defects..

© Copyright 2019-2021 HP Development Company, L.P.

The information contained herein is subject to change without notice. The only warranties for HP products and services are set forth in the express warranty statements accompanying such products and services. Nothing herein should be construed as constituting an additional warranty. HP shall not be liable for technical or editorial errors or omissions contained herein.

---

## Documents / Resources

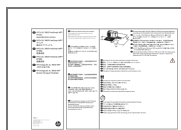

[hp 3800 PostScript MFP Printer](#) [pdf] Instruction Manual  
3800 PostScript MFP Printer, 3800, PostScript MFP Printer, MFP Printer, Printer

## References

- [User Manual](#)

[Manuals+](#), [Privacy Policy](#)

This website is an independent publication and is neither affiliated with nor endorsed by any of the trademark owners. The "Bluetooth®" word mark and logos are registered trademarks owned by Bluetooth SIG, Inc. The "Wi-Fi®" word mark and logos are registered trademarks owned by the Wi-Fi Alliance. Any use of these marks on this website does not imply any affiliation with or endorsement.