

hp 121325 Site Print Robot



hp 121325 Site Print Robot User Guide

[Home](#) » [HP](#) » hp 121325 Site Print Robot User Guide 

Contents

- 1 [hp 121325 Site Print Robot](#)
- 2 [Product Information](#)
- 3 [Product Usage Instructions](#)
- 4 [What's in the box](#)
- 5 [Insert the battery](#)
- 6 [Switch on the control panel](#)
- 7 [Connect to the HP SitePrint Robot's Wi-Fi](#)
- 8 [Assign the robot to your cloud account](#)
- 9 [Introduce user ID](#)
- 10 [Get started](#)
- 11 [Software update](#)
- 12 [Insert the ink cartridge](#)
- 13 [Remove air from the ink system](#)
- 14 [Remote control basics](#)
- 15 [Recommendations](#)
- 16 [Documents / Resources](#)
 - 16.1 [References](#)



hp 121325 Site Print Robot



Product Information

Specifications:

- Prism hole space
- Miniprism bipod
- Battery
- Extraction handle
- HP SitePrint Robot
- Spray bottle for cleaning
- Ink supply slots
- Battery holder
- Charger and joystick cable
- Remote control
- Battery charger transformer
- Battery charger

Product Usage Instructions

Extracting the HP SitePrint Robot from the box:

1. Open the packaging and extract the contents.
2. Hold the HP SitePrint Robot by the blue handle and the rear handle and remove it from the box by gently lifting it upwards while keeping it horizontal.

Inserting the battery:

1. To activate the battery for first use, place it in the charger provided in the suitcase. Make sure the battery is fully charged before inserting it and before executing a layout job.
2. Take the battery holder and the battery and locate the pins on the battery.
3. Push them into the pin holders on the holder and clip the battery into place. Note: Parallel grooves will remain visible during the process.

4. Press the button with your thumb to open the lock and insert the battery holder into the HP SitePrint Robot.
Once in place, release the button.
5. Support the HP SitePrint Robot with the rear handle or wheel and gently push the battery holder to fully lock it into place.

Switching on the HP SitePrint Robot:

1. Make sure that the HP SitePrint Robot is on an even, clear, non-reflective surface. Turn it on and wait for the LEDs to turn white. This can take up to two minutes.
2. Four red LED signs are seen projected in the front and rear of the HP SitePrint Robot.
3. If the LEDs turn orange or red at the end of the process, reboot the

Switching on the control panel:

- Turn on your device.

Connecting to the HP SitePrint Robot's Wi-Fi:

- Use the tablet to scan the QR code from the back of the assembly instructions. You can also find the Wi-Fi name and password on the back of the remote control. The Wi-Fi name corresponds to the HP SitePrint Robot's serial number which is located on the label next to the printhead.

Assigning the robot to your cloud account:

NEED ILLUSTRATION!!!

Sign into HP SitePrint Cloud and assign the robot to your account.

Accessing the control panel:

- Only Google Chrome Browser is supported.
- NEED ILLUSTRATION!!!
- Create a shortcut in your desktop to enable easier access and full screen view.
- Access the control panel user-interface from a Google Chrome Browser by navigating to <http://192.168.10.1>.
- Check that Network provider connectivity type and signal level is displayed in the top bar. If "Starting up" is shown, reboot the unit.
- Use the Full screen setting in Chrome to use the control panel.

Introducing user ID:

NEED ILLUSTRATION!!!

Ensure that you have an active cloud account to complete the process successfully. If you don't have a cloud account, contact your HP SitePrint Specialist or Admin.

Registering the HP SitePrint Robot:

NEED ILLUSTRATION!!!

Register the HP SitePrint Robot.

Getting started:

NEED ILLUSTRATION!!!

Click “Get started” and follow the on-screen instructions.

Software update:

Before using the HP SitePrint Robot for the first time, you must install the latest software update. This can be found in the Support menu tab > Software updates menu. At the end of the update, the Robot will switch off. Turn it on again.

FAQ

Q: What should I do if the LEDs turn orange or red at the end of the HP SitePrint Robot startup process?

A: Reboot the unit.

Q: Which browser is supported for accessing the control panel?

A: Only Google Chrome Browser is supported.

Q: How can I create a shortcut to access the control panel easily?

A: Create a shortcut in your desktop for easier access and full screen view.

© Copyright 2023 HP Development Company, L.P. The information contained herein is subject to change without notice.

What's in the box

1. Prism hole space
2. Miniprism bipod
3. Battery
4. Extraction handle
5. HP SitePrint Robot
6. Spray bottle for cleaning
7. Ink supply slots
8. Battery holder
9. Charger and joystick cable
10. Remote control
11. Battery charger transformer
12. Battery charger

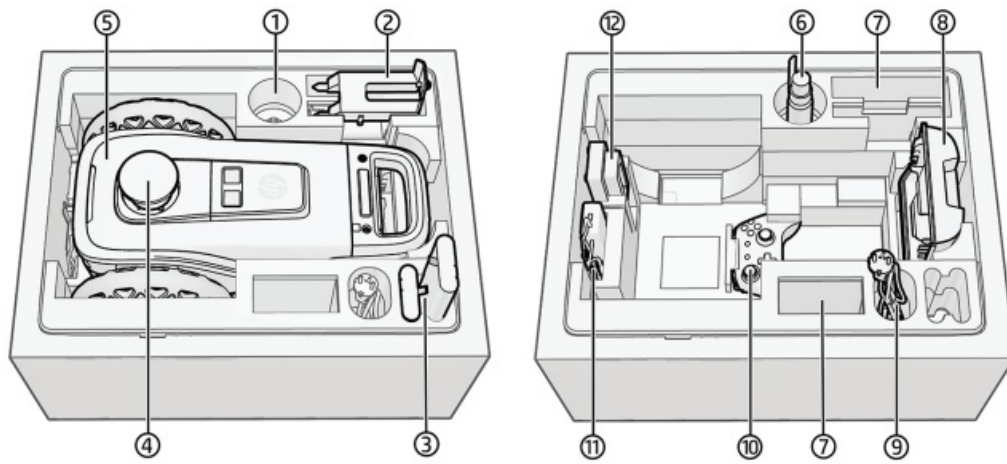

This product contains items classified as Dangerous Goods for Transportation, please refer to the User Guide for transportation guidelines.

Extract the HP SitePrint Robot from the box



- Open the packaging and extract the contents.
- Hold the HP SitePrint Robot by the blue handle and the rear handle and remove it from the box by gently lifting it upwards while keeping it horizontal.

Insert the battery

To activate the battery for first use, place it in the charger provided in the suitcase. Make sure the battery is fully charged before inserting it and before executing a layout job.

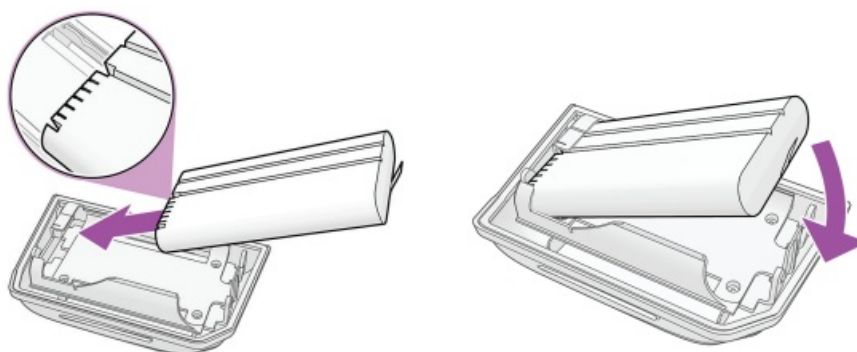

- Take the battery holder and the battery and locate the pins on the battery.
- Push them into the pin holders on the holder and clip the battery into place.

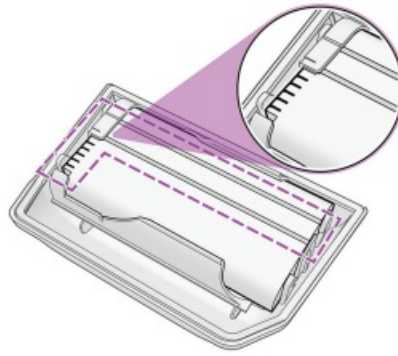

Note: Parallel grooves will remain visible during the process.

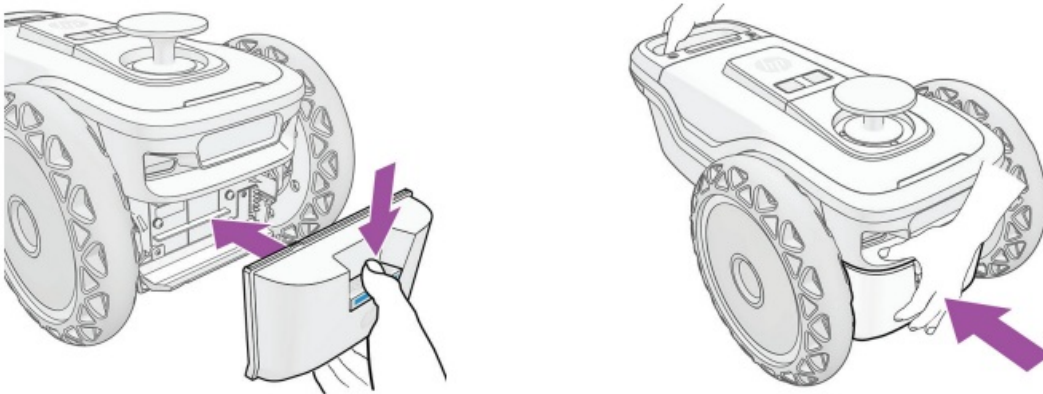

- Press the button with your thumb to open the lock and insert the battery holder into the HP SitePrint Robot. Once in place, release the button.
- Support the HP SitePrint Robot with the rear handle or wheel and gently push the battery holder to fully lock it into place.

Switch on the HP SitePrint Robot

- Make sure that the HP SitePrint Robot is on an even, clear, non-reflective surface. Turn it on and wait for the LEDs to turn white. This can take up to two minutes.
- Four red LED signs are seen projected in the front and rear of the HP SitePrint Robot.
- If the LEDs turn orange or red at the end of the process, reboot the

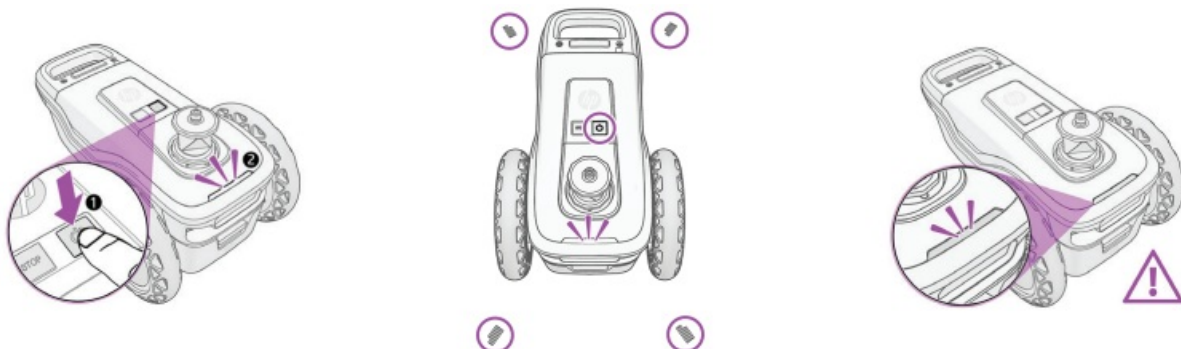

Switch on the control panel



Turn on your device.

Connect to the HP SitePrint Robot's Wi-Fi



Use the tablet to scan the QR code from the back of the assembly instructions. You can also find the Wi-Fi name and password on the back of the remote control. The Wi-Fi name corresponds to the HP SitePrint Robot's serial number which is located on the label next to the printhead.

Assign the robot to your cloud account



Sign into HP SitePrint Cloud and assign the robot to your account.

Access the control panel

Only Google Chrome Browser is supported.

Create a shortcut in your desktop to enable easier access and full screen view.

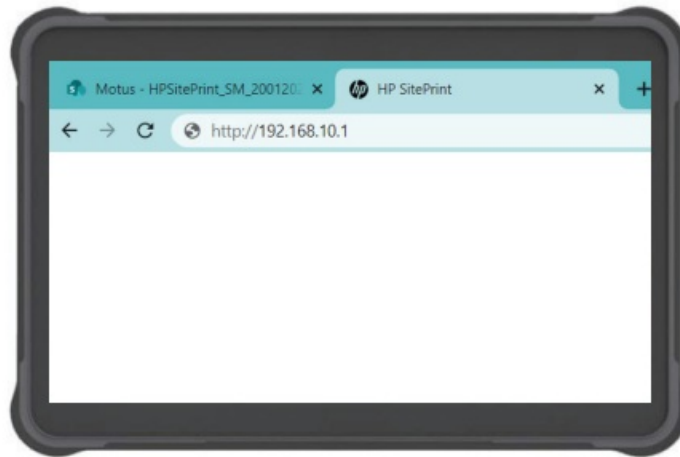

- Access the control panel user-interface from a Google Chrome Browser by navigating to <http://192.168.10.1>.
- Check that Network provider connectivity type and signal level is displayed in the top bar. If “Starting up” is shown, reboot the unit.
- Use the “Full screen” setting in Chrome to use the control panel.

Introduce user ID

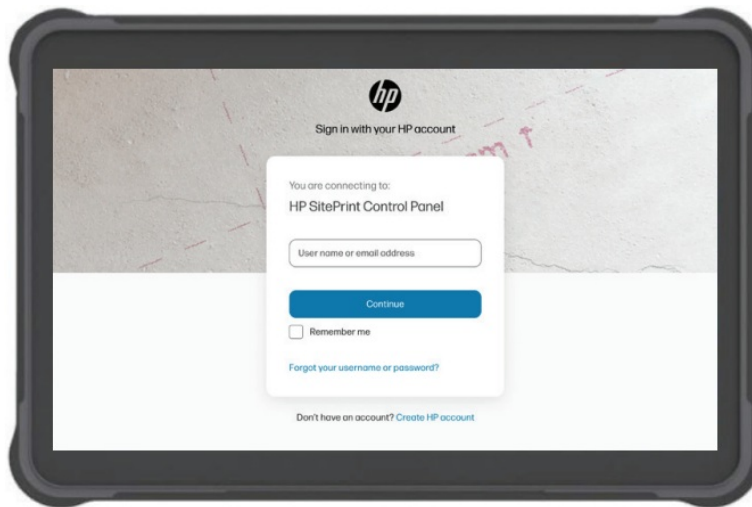

Ensure that you have an active cloud account to complete the process successfully. If you don't have a cloud account, contact your HP SitePrint Specialist or Admin.

Register the HP SitePrint Robot

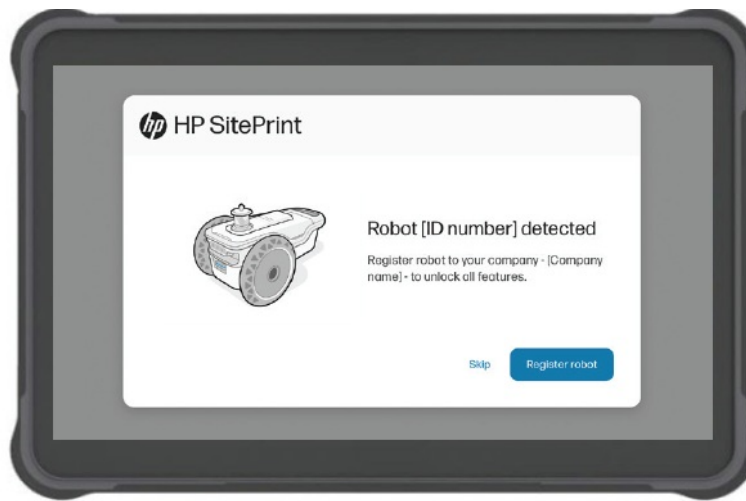

Register the HP SitePrint Robot.

Get started

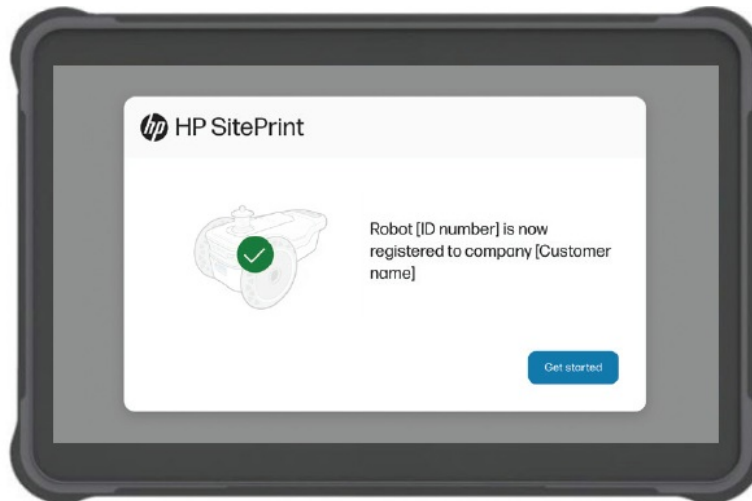

Click Get started and follow the on-screen instructions.

Software update

Before using the HP SitePrint Robot for the first time, you must install the latest software update. This can be found in the Support menu tab > Software updates menu. At the end of the update, the Robot will switch off. Turn it on again.

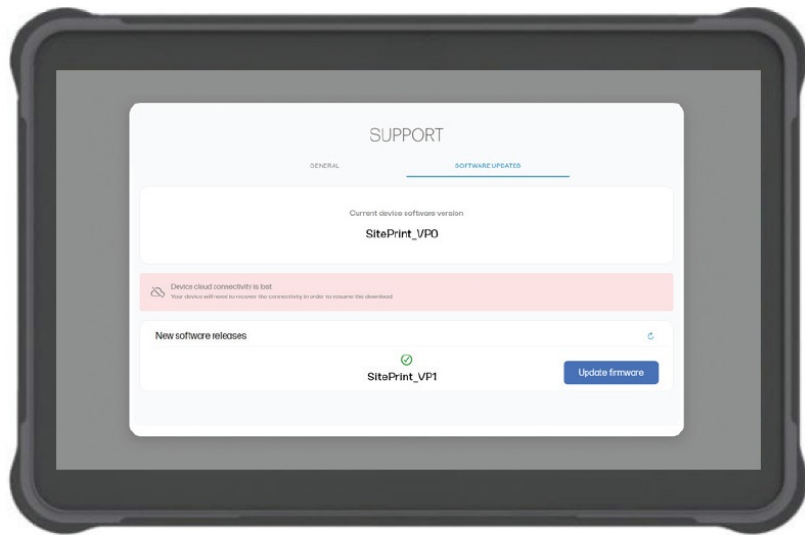

The software update can take up to 40 minutes. 3G+ or 4G connectivity is recommended. Clear the cookies in the browser after every software update.

Insert the ink cartridge

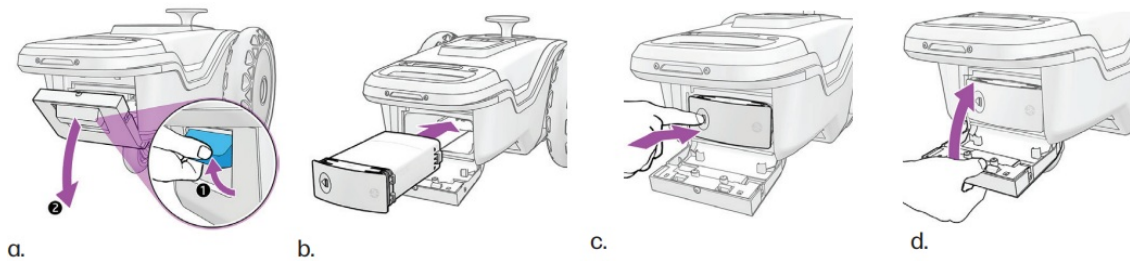

- **a.** With the robot in the horizontal position, or rotated 45°: Open the door.
- **b.** Insert a color cartridge.
- **c.** Push the cartridge to the right to lock it into place.
- **d.** Close the door.

The ink supply replacement workflow will be triggered to purge the ink system. Follow the instructions in the control panel.

Do not rotate the robot more than 45° as the sensors can be damaged if placed vertically.

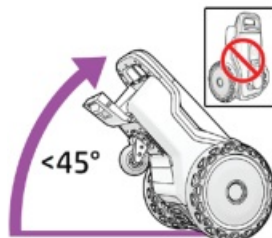

Remove air from the ink system

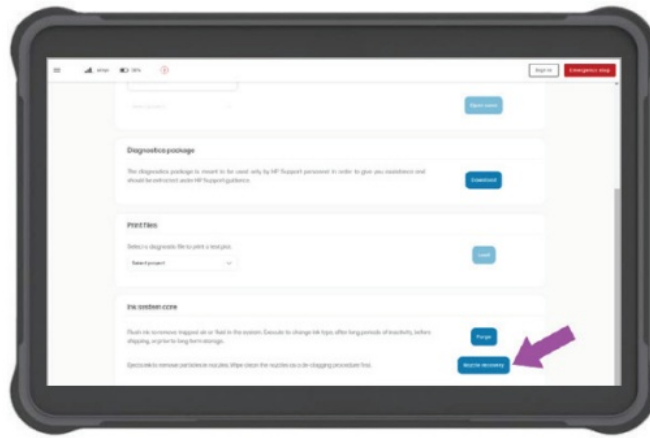

Before printing your first job, go to Support > Ink system care and run 'Nozzle recovery' to remove any air from the ink delivery system. Repeat the process until the ink fires.

Insert the prism

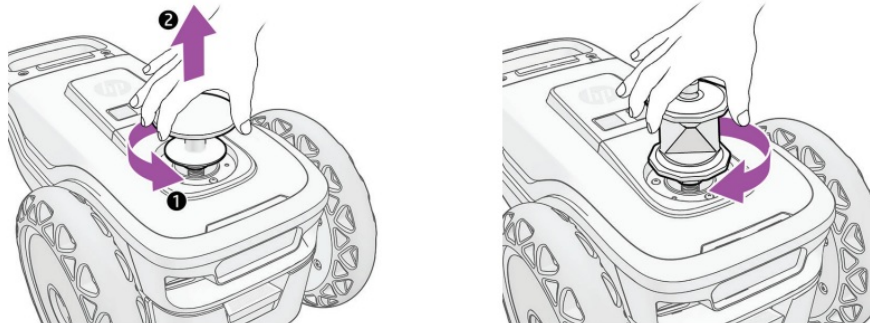

- Remove the extraction handle from of the HP SitePrint Robot.
- Insert and screw in the 360° prism.

Store the handle in the suitcase prism slot.

Remote control basics



1. Press the blue 'X' button to turn ink firing on or off.
2. Press the green 'A' button to enter manual mode.
3. Hold the 'L1' button to move the robot with the joysticks.

4. The left joystick moves the robot forwards and backwards. The right joystick moves the robot left and right.
5. Press the 'Select' button to recover after an emergency stop.

After a software upgrade, the controller must be paired again with the HP SitePrint Robot.

Please follow the remote control pairing instructions included in next slide to pair again the HP SitePrint Robot.

Remote control pairing



The switch must be set to 'Bluetooth' (Right).
To prevent battery drain, switch it back to USB (Left) to turn off the controller before storing it in the suitcase.

HyperX Bluetooth connection:

1. Go to the settings section in the HP SitePrint UI: o Settings → Connectivity → Remote controller → Connect.
2. The switch must be set to Bluetooth in the controller
3. Press and hold the 'Home' button for 6 seconds until the LEDs animate to indicate pairing mode.
4. Click the connect button in the pop-up of the HP SitePrint UI.

Recommendations



- Do not lean on the HP SitePrint Robot when manipulating it as the caster wheels could break.
- Do not place the HP SitePrint Robot vertically as it could fall.
- Note that the fragile areas of the HP SitePrint Robot are: the caster wheel, printhead and frontal sensors. Always handle the with care to protect them.

You are set up and ready to work on your first project!

Documents / Resources

 HP SitePrint Robot Quick Setup	hp 121325 Site Print Robot [pdf] User Guide 121325 Site Print Robot, 121325, Site Print Robot, Print Robot, Robot
--	--

References

- [User Manual](#)

Manuals+, Privacy Policy

This website is an independent publication and is neither affiliated with nor endorsed by any of the trademark owners. The "Bluetooth®" word mark and logos are registered trademarks owned by Bluetooth SIG, Inc. The "Wi-Fi®" word mark and logos are registered trademarks owned by the Wi-Fi Alliance. Any use of these marks on this website does not imply any affiliation with or endorsement.