



# hoymiles DTU-G100 USB Data Transfer Unit Installation Guide

[Home](#) » [hoymiles](#) » hoymiles DTU-G100 USB Data Transfer Unit Installation Guide 



**Contents**

- [1 Interface Layout](#)
- [2 Preparation](#)
- [3 Installation](#)
- [4 Installation Map](#)
- [5 Online Setup](#)
- [6 Warning](#)
- [7 Documents / Resources](#)
- [8 Related Posts](#)

## Interface Layout

Item	Description
A	USB Connector
B	Status Indicator
C	Reset Button
D	SIM Card Slot

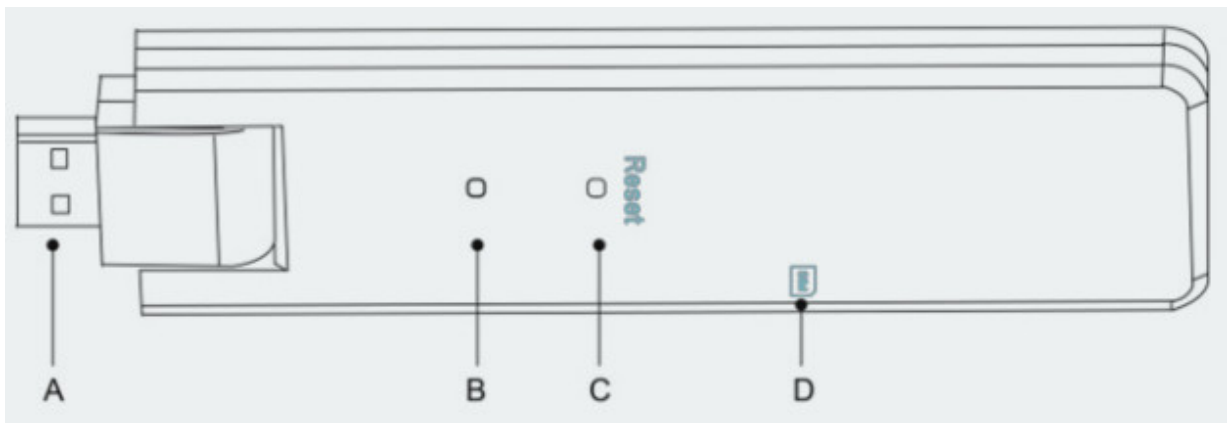

## Preparation

A) Download the Hoymiles Mobile Installer App.



<https://m.hoymiles.com/platform/app?m=1>

B) Check the box for the following items:

- Hoymiles DTU-G100
- Adapter

## Installation

A) Insert the SIM card into the SIM card slot.

B) Power the DTU-G100 3rd Gen.

**Option 1:** Connect the DTU to the adapter and plug it into the wall socket.

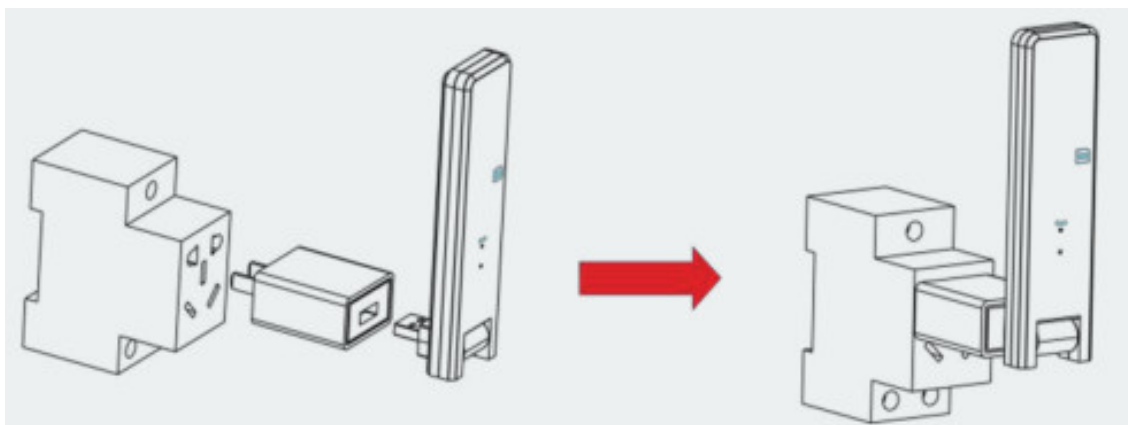

**Option 2:** Connect the DTU to the adapter and plug it into the power strip. Please make sure that it is placed at least 0.5 meters above the ground, and try to install the DTU at a 90 degrees angle perpendicular to the ground.

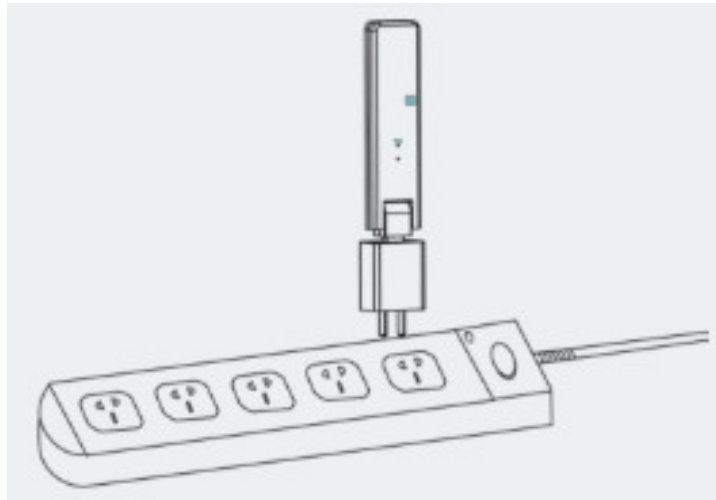

**Note:** Please do not install the DTU directly above metal or concrete to prevent signal interference.

**C) Start Procedure.**

Once the DTU powers on, the red, green and blue lights will flash in sequence for one second each for 30 seconds.

**Installation Map**

**Complete the installation map.**

A) Peel the serial number label (as circled below) from the DTU and place it on the installation map.

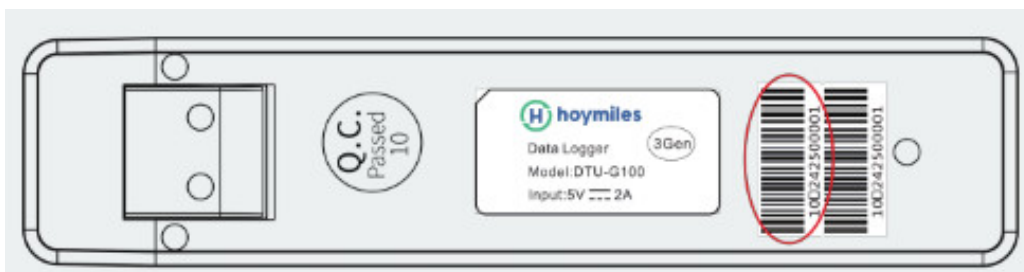

B) Complete the system information of the installation map as shown below.

To sheet \_\_\_\_\_

N S E W (circle one) 	Panel Group: Azimuth: Tilt: Sheet _ of _	Customer Information:	DTU Serial Number:											
	1	2	3	4	5	6	7	8	9	10	11	12	13	14
A														
B														
C														
D														

To sheet \_\_\_\_\_

## Online Setup

Create an online account to complete the DTU installation (refer to “Quick Installation Guide for S-Miles Cloud (Hoymiles Monitoring Platform) Online Registration” for detailed account creation steps).

**Note:** For more setup details regarding the Local Installation Assistant, please acquire the related Operation Guide from Hoymiles Technical Service Center at [service@hoymiles.com](mailto:service@hoymiles.com).

## Warning



### Warning

- Only qualified personnel can install or replace the DTU.
- Do not attempt to repair the DTU, as it contains the parts that are not serviceable to users. If the DTU breaks down, please contact your distributor for maintenance. Opening the DTU without permission will invalidate the warranty.

Product information is subject to change without notice. (Please download reference manuals at [www.hoymiles.com](http://www.hoymiles.com).)



Region: Global AP040261 REV1.2  
© 2020 Hoymiles Power Electronics Inc.  
All rights reserved.

## Documents / Resources



## [hoymiles DTU-G100 USB Data Transfer Unit](#) [pdf] Installation Guide

DTU-G100, USB Data Transfer Unit, Data Transfer Unit, Transfer Unit, DTU-G100