



## **Contents** [ [hide](#) ]

- [1 Hoymiles DTS Series G3 Data Transfer Stick](#)
- [2 Product Usage Instructions](#)
- [3 About This Manual](#)
- [4 Safety Instructions](#)
- [5 Product Introduction](#)
- [6 Technical Specifications](#)
- [7 Installation](#)
- [8 Indicators and Button](#)
- [9 Network Configuration](#)
- [10 Regulatory Compliance Statement](#)
- [11 FCC Radiation Exposure Statement](#)
- [12 Legal Notice](#)
- [13 Warranty](#)
- [14 Contact Us](#)
- [15 Revision History](#)
- [16 FAQs](#)
- [17 Documents / Resources](#)
  - [17.1 References](#)



## **Hoymiles DTS Series G3 Data Transfer Stick**



## Specifications

- Product Name: Hoymiles Data Transfer Stick (DTS)
- Versions: DTS-WiFi-G3, DTS-4G-G3, DTS-WL-G3
- Region: Global V202504
- Compatibility: Hoymiles hybrid energy storage inverters and AC-coupled energy storage inverters

## Product Usage Instructions

### About This Manual

This manual provides essential instructions for the installation and operation of the Hoymiles Data Transfer Stick (DTS). It is crucial to read and understand this manual thoroughly before proceeding with the installation, operation, and maintenance.

### Audience

This manual is intended for qualified personnel who have received proper training or have relevant skills to install and maintain the product under the guidance provided in this document.

### Compatibility

The DTS is designed to work exclusively with Hoymiles hybrid energy storage inverters and AC-coupled energy storage inverters.

## Safety Instructions

## Safety Symbols

- **DANGER:** Indicates potential risks that may lead to death or serious physical injury if not avoided.
- **WARNING:** Highlights potential risks that could result in injury or damage if not heeded.
- **CAUTION:** Indicates precautions that need to be taken to prevent damage to the product or surrounding components.
- **NOTICE:** Provides important information or tips for optimal product usage.

## About This Manual

### Purpose

This manual contains important instructions regarding the installation and operation of the Hoymiles Data Transfer Stick (DTS). Please carefully read this manual before the installation, operation, and maintenance.

### Audience

This document is only for qualified personnel. Only qualified personnel who have been trained or have mastered relevant skills can install and maintain the product under the guidance of this document.

### Validity

The DTS is only compatible with Hoymiles hybrid energy storage inverters and AC-coupled energy storage inverters. This document is valid for the following DTS models:

- DTS-WiFi-G3
- DTS-4G-G3
- DTS-WL-G3

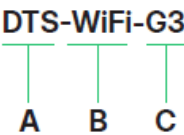





Item	Meaning	Description
A	Product name	DTS: Data Transfer Stick

B	Communication method	<p>WiFi: Connects to the S-Miles Cloud via Wi-Fi</p> <p>4G: Connects to the S-Miles Cloud via 4G and Wi-Fi</p> <p>WL: Connects to the S-Miles Cloud via LAN and Wi-Fi</p>
C	Generation	G3: The third generation

## Safety Instructions





### Safety Symbols

Safety symbols are used in this manual as follows:

Symbol	Description
 <b>DANGER</b>	This symbol indicates potential risks that, if not avoided, may lead to death or serious physical injury.
 <b>WARNING</b>	This symbol indicates potential risks that, if not avoided, may lead to personal injury or device damage.
 <b>CAUTION</b>	This symbol indicates potential risks that, if not avoided, may lead to device malfunctions or financial losses.
<b>NOTICE</b>	This symbol indicates potential risks that, if not avoided, may lead to minor injury or damage to the equipment.
 <b>NOTE</b>	This symbol indicates an important step or tip that leads to the best results but is not safety or damage-related.

### Additional Symbols

The product label contains the following symbols, with their meanings described below:

Icon	Explanation
	<b>CE mark</b> The product complies with the requirements of the applicable EU directives.
	<b>FCC mark</b> The product complies with the FCC standard.
	<b>Observe the documentation</b> Read and understand all documentation supplied with the product.
	<b>Treatment</b> Electrical equipment that has reached the end of life must be collected separately and returned to an approved recycling facility to comply with the European Directive 2002/96/EC on Waste Electrical and Electronic Equipment and its implementation as national law. Return any devices you no longer need to an authorized dealer or an approved collection and recycling facility.

## Safety Instructions

The DTS has been designed and tested in compliance with international safety standards, and thus requires careful installation and operation. Installers must carefully read and strictly follow the safety instructions in this section. Failure to do so may result in:

- Injury or death to the installers or operators
- Damage to the DTS

## DANGER!

Do not attempt to repair the device yourself. If you encounter any device issues or need repair or warranty information, please contact us.

## WARNING!

- Do not use Hoymiles products in a way that is not suggested by the manufacturer. Doing so may cause death or injury to persons or damage to the equipment.
- Read all instructions and warnings in the technical description and on the DTS before installing or using the device.
- Do not use the device in locations where wireless devices are not allowed.
- Keep the device away from water, fire, moisture, and hot environments to prevent

damage.

## CAUTION!

- Do not try to repair the DTS without approval from Hoymiles. If the DTS is damaged, send the DTS back to your installer for repair or replacement. Disassembling the DTS without approval from Hoymiles will invalidate the remaining warranty period.
- Hoymiles confirms that the product described in this guide meets the essential requirements and relevant provisions of the EU directives.

Radio Technology	2.4 G Wi-Fi
Radio Spectrum	Wi-Fi: 2412 to 2484 MHz Bluetooth LE: 2402 to 2480 MHz
Maximum Transmission Power	Wi-Fi: 19.59 dBm Bluetooth LE: 9.72 dBm

## NOTICE

- Electrical installations: Perform all electrical installations according to national and local regulations.
- To ensure optimal reliability and meet warranty conditions, install the DTS according to the instructions in this guide.
- This product is not a network device but can connect to a home router via Wi-Fi, leveraging the router's security functions to counter potential cybersecurity risks like DoS attacks.

## EU Directive Compliance

This product complies with the following EU directives and can be used without restrictions in the European Union:

- Directive 2014/53/EU (RED) and 2009/125/EC: Relating to the provision of electrical

equipment within certain voltage limits on the market (Low Voltage Directive).

- Directive 2011/65/EU and 2015/863/EU (RoHS): Restricting the use of certain hazardous substances in electrical and electronic equipment.

More detailed information can be found at <https://www.hoymiles.com/>.

## **Product Introduction**

### **Overview**

- DTS-G3 is the third-generation data transfer stick of Hoymiles, which is small and easy to install.
- DTS-G3 supports communication methods including Wi-Fi, 4G, and LAN, enabling the inverter to connect to the router or base station and transmit data to the S-Miles Cloud for real-time monitoring and remote control. In addition,
- DTS-G3 supports Bluetooth for short-range communication between the inverter and the App, offering users convenient control of power on/off, power adjustment, mode setting, and configuration parameters viewing via the App.

### **Features**

- Plug and play
- Stable and reliable data transmission
- Supports Bluetooth local configuration
- IP66 protection

### **Applications**

DTS-WiFi-G3

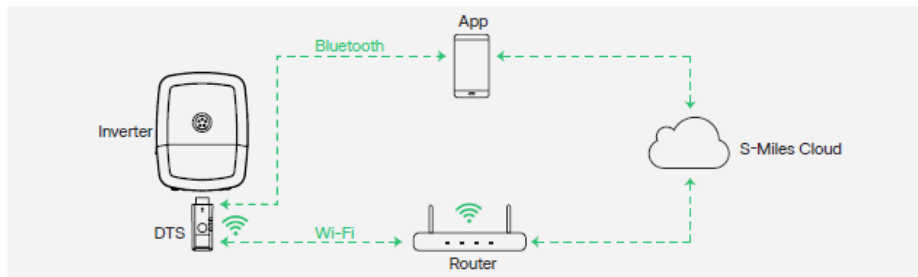

DTS-4G-G3

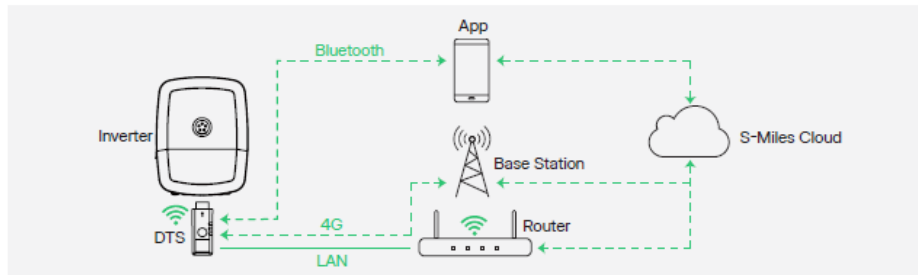

DTS-WL-G3

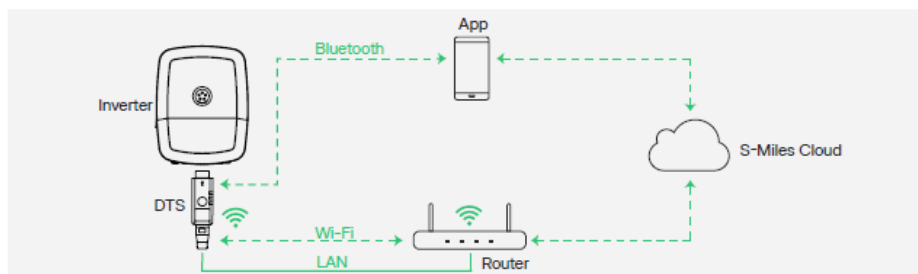

DTS Interface: Connect and communicate with the inverter. Inverter Interface: Connect and communicate with the DTS.

## Dimensions

DTS-WiFi-G3 / DTS-4G-G3

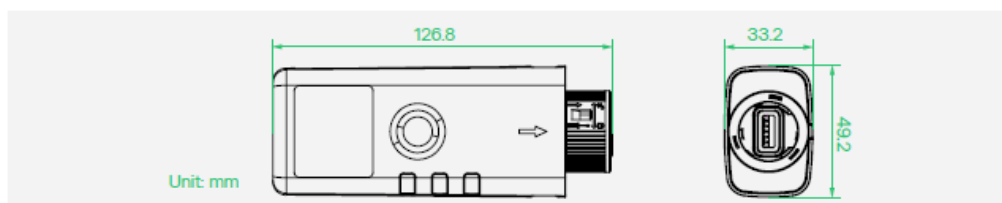

DTS-WL-G3

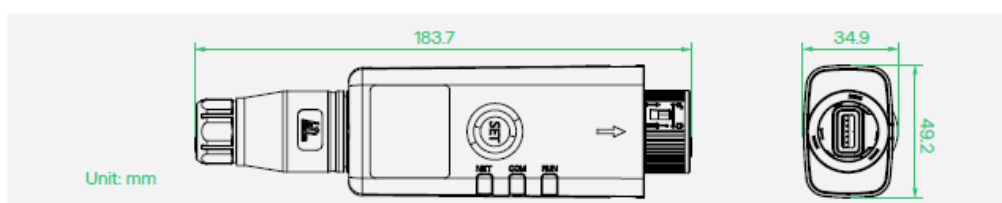

## Technical Specifications

Model	DTS-4G-G3	DTS-WiFi-G3	DTS-WL-G3
-------	-----------	-------------	-----------



Communication			
Max. inverter supported		10	
Data upload cycle (min)		5	
Indicator		LED × 3	
Connection interface		USB	
4G standard	4G: LTE-FDD / LTE-TDD  3G: WCDMA / HSDPA / HSUPA / HSPA+  2G: GSM / GPRS / EDGE	/	/
Wi-Fi standard		IEEE 802.11 b/g/n/ax @2.4 GHz	
LAN standard	/	/	10/100 Mbps adaptive; Max. Length of network cable: 100 m
Bluetooth standard		Bluetooth 5.0	
Configuration method		BLE App	
General			
Operating voltage (V)		5	

Power consumption (W)		$\leq 5$	
Dimensions (mm)	49.2 × 126.8 × 33.2	49.2 × 126.8 × 33.2	49.2 × 183.7 × 34.9
Weight (g)	103	82	105
Protection degree		IP66	
Installation method		Plug and play	
<b>Environment</b>			
Operating temperature range (°C)		-25 to +65	
Relative humidity		0 to 95%, no condensing	
Operating altitude (m)		$\leq 4000$	
<b>Certifications and Standards</b>			
Certificate	FCC; IC	CE; NTC; PTA; RED18031; MIC; NBTC; UkrSEPRO; WPC; PSTI; FCC; IC	

## Installation

### Wi-Fi/4G DTS Installation

- Step 1: Remove the DTS port cover on the bottom of the inverter.
- Step 2: Insert the DTS into the DTS port. Listen for a click as they engage.

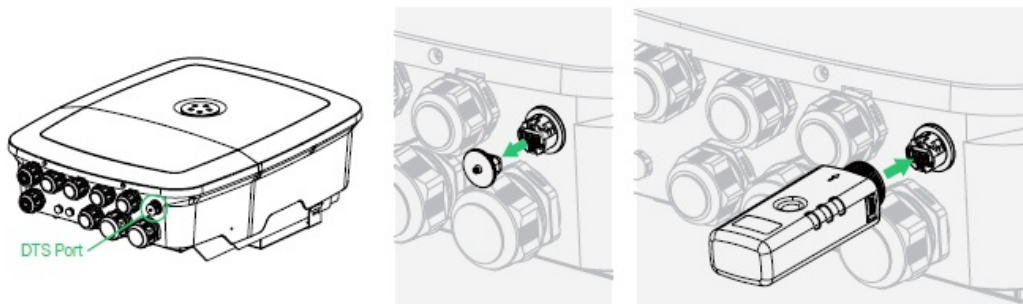

## WLAN DTS Installation

- Step :1: Turn the end of the DTS counterclockwise, and separate the DTS into four parts.
- Step: 2 Plug the LAN cable into the network port he part 1.
- Step 3:Slidee parts 3 and 4 over the cable in sequence, and tighten all parts.

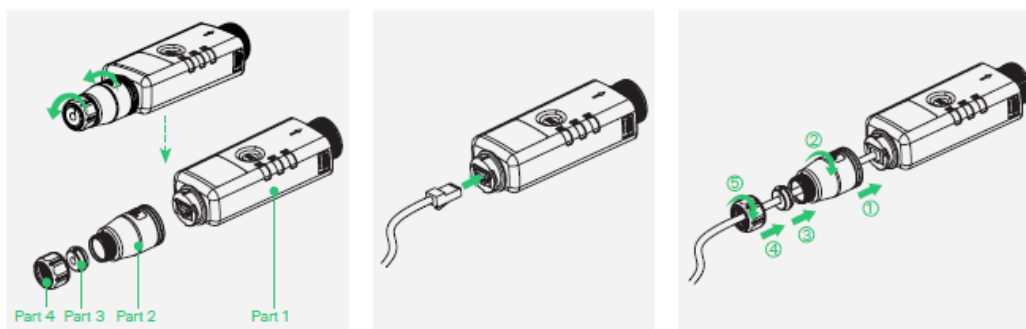

- Step: pp: :p Remove the DTS port cover on the bottom of the inverter.
- Step 5: Insert the DTS into the DTS port. Listen for a click as they engage.

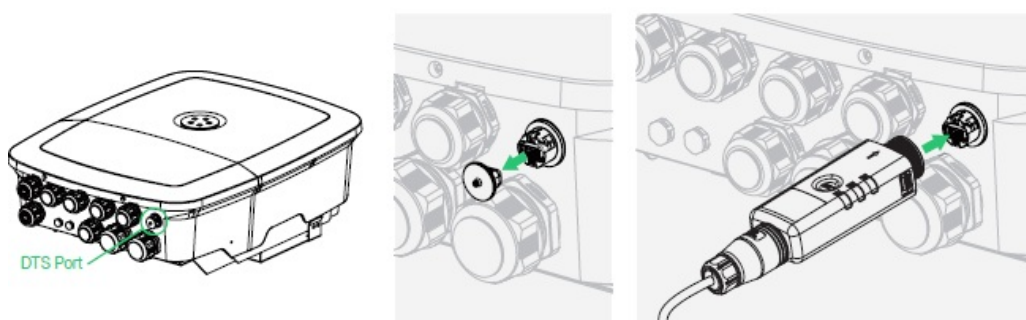

## NOTICE

For both types of devices, if you need to remove the DTS, turn the lock ring counterclockwise and unplug it.

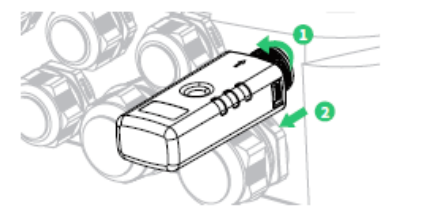

## Indicators and Button

### Indicators Status

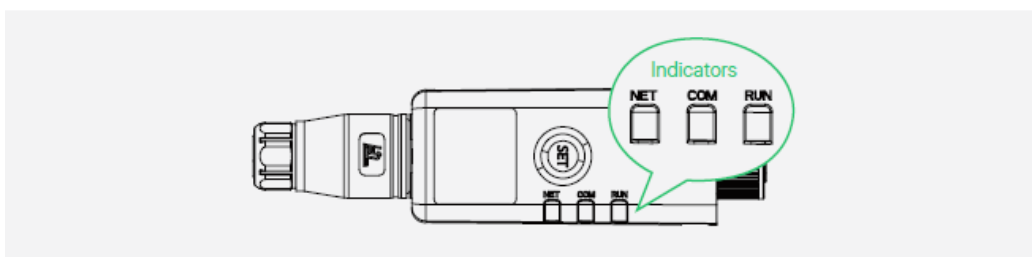

Indicator	Status	Indication
NET	On	The network is connected, and communication with the S-Miles Cloud is normal.
	Off	Network not connected
	Blinking	The network is connected, but communication with the S-Miles Cloud is abnormal.
COM	On	Communication with the inverter is normal.
	Off	Communication with the inverter is abnormal.
RUN	On	Connected to the external power supply
	Off	Not connected to the external power supply
NET & COM	Blinking	Device Upgrading

### Button Instruction

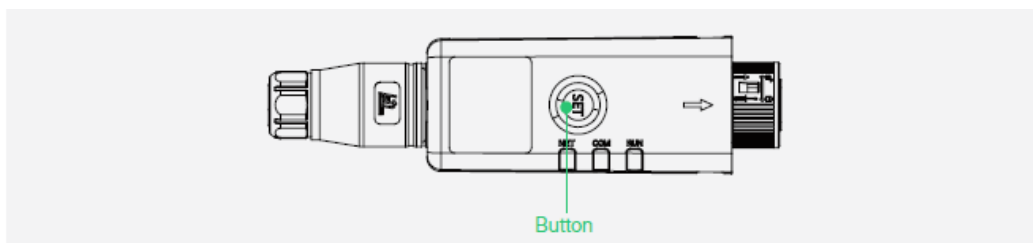

Operation	Function	Indicator Status
Short press twice successively (Each press duration 1s; interval between presses 1s)	Reboot software	All three indicators flash twice simultaneously
Long press for 5s to 10s	Reset password and reboot the software	All three indicators flash three times simultaneously



## Network Configuration

### NOTICE

- The screenshots provided here are for reference only. The actual screens may vary.
- For additional details of App operation, see the S-Miles Installer App Operating Guide.

1. Step 1: Scan the QR code below, or search for “S-Miles Installer” on the App Store (iOS) or Google Play Store (Android) to download the app.



2. Step 2: Open and log in to the app using your credentials.
3. Step 3: Tap O&M  > Network Config  . The app will scan for the Bluetooth of nearby devices. Step 4: On the Via Bluetooth part, tap the DTS to be connected.
4. Step 5 Enter the PIN code (only required for the first connection, by default is 123456),

and tap Confirm.

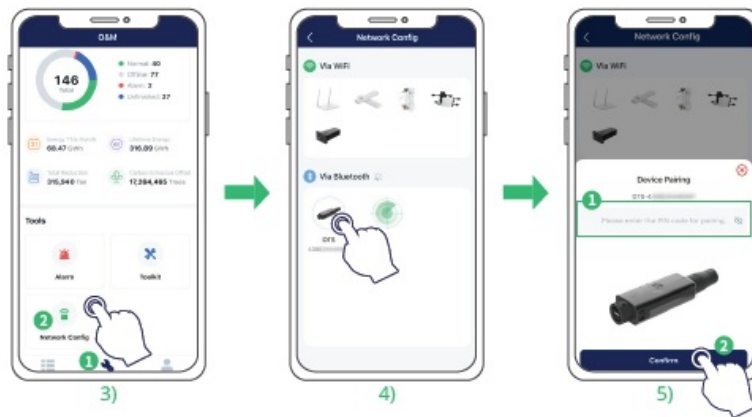

5. Step 6: Connect to the network.

- Ethernet Mode (Only applicable to DTS-WL-G3): DTS and router are connected via LAN cable. Select Ethernet and tap Send to DTU.
- Wi-Fi Mode: Select Wi-Fi. Enter the router's Wi-Fi name and password, and tap Send to DTU.

6. Step 7: When the connection is successful, tap Finish.



## Regulatory Compliance Statement

### FCC Statement

This equipment has been tested and found to comply with the limits for a Class B digital device under part 15 of the FCC Rules. These limits are designed to provide reasonable protection against harmful interference in a residential installation. This equipment generates, uses, and can radiate radio frequency energy and, if not installed and used according to the instructions, may cause harmful interference to radio communications. However, there is no guarantee that interference will not occur in a particular installation.

If this equipment does cause harmful interference to radio or television reception, which can be determined by turning the equipment off and on, the user is encouraged to try to correct the interference by one or more of the following measures:

- Reorient or relocate the receiving antenna.
- Increase the separation between the equipment and receiver.
- Connect the equipment to an outlet on a circuit different from that to which the receiver is connected.
- Consult the dealer or an experienced radio/TV technician for help.

## **FCC Radiation Exposure Statement**

This device complies with FCC radiation exposure limits set forth for an uncontrolled environment, and it also complies with Part 15 of the FCC RF Rules. This equipment must be installed and operated according to the provided instructions, and the antenna(s) used for this transmitter must be installed to provide a separation distance of at least 20 cm from all persons and must not be co-located or operating in conjunction with any other antenna or transmitter. End-users and installers must be provided with antenna instructions and consider removing the no-collocation statement.

This device complies with Part 15 of the FCC Rules. Operation is subject to the following two conditions:

1. This device may not cause harmful interference, and
2. This device must accept any interference received, including interference that may cause undesired operation.

## **Caution!**

Any changes or modifications not expressly approved by the party responsible for compliance could void the user's authority to operate the equipment.

## **Canada Statement**

This device contains licence-exempt transmitter(s)/receiver(s) that comply with Innovation, Science and Economic Development Canada's licence-exempt RSS(s). Operation is subject to the following two conditions:

1. This device may not cause interference.
2. This device must accept any interference, including interference that may cause undesired operation of the device.

The device meets the exemption from the routine evaluation limits of RSS 102 and compliance with RSS-102 RF exposure, users can obtain Canadian information on RF exposure and compliance.

This transmitter must not be co-located or operating in conjunction with any other antenna or transmitter. This equipment should be installed and operated with a minimum distance of 20 centimeters between the radiator and your body.

## Legal Notice

Hoymiles has made every effort to ensure the accuracy and completeness of this manual. However, this manual may be changed and revised due to product enhancements or user feedback.

Hoymiles reserves the right to modify this manual without prior notice at any time. The latest version of this manual can be found by visiting the Hoymiles official website ([www.hoymiles.com](http://www.hoymiles.com)) or scanning the QR Code below.



## Warranty

Follow the installation instructions in this manual to ensure warranty compliance and reliability. The current warranty conditions can be accessed at [www.hoymiles.com](http://www.hoymiles.com).

## Contact Us

If you have technical queries or any questions concerning our products, please contact our support through the Hoymiles service portal:

<b>Germany</b> <a href="mailto:service.de@hoymiles.com">service.de@hoymiles.com</a>	<b>Spain</b> <a href="mailto:service.es@hoymiles.com">service.es@hoymiles.com</a>	<b>France</b> <a href="mailto:service.fr@hoymiles.com">service.fr@hoymiles.com</a>
--	--	---



<b>Italy</b> <a href="mailto:service.it@hoymiles.com">service.it@hoymiles.com</a>	<b>Netherlands</b> <a href="mailto:service.nl@hoymiles.com">service.nl@hoymiles.com</a>		<b>Norway</b> <a href="mailto:service.no@hoymiles.com">service.no@hoymiles.com</a>
<b>Poland</b> <a href="mailto:service.pl@hoymiles.com">service.pl@hoymiles.com</a>	<b>Finland</b> <a href="mailto:service.fi@hoymiles.com">service.fi@hoymiles.com</a>		<b>Austria</b> <a href="mailto:service.at@hoymiles.com">service.at@hoymiles.com</a>
<b>Rest of the EU</b> <a href="mailto:service.eu@hoymiles.com">service.eu@hoymiles.com</a>			
<b>Brazil</b> <a href="mailto:service.br@hoymiles.com">service.br@hoymiles.com</a>	<b>Spanish-speaking countries</b> <a href="mailto:service.mx@hoymiles.com">service.mx@hoymiles.com</a>		
<b>USA</b> <a href="mailto:service.us@hoymiles.com">service.us@hoymiles.com</a>	<b>Canada</b> <a href="mailto:service.ca@hoymiles.com">service.ca@hoymiles.com</a>		
<b>Australia &amp; New Zealand</b> <a href="mailto:service.au@hoymiles.com">service.au@hoymiles.com</a>	<b>Asia &amp; Pacific</b> <a href="mailto:service.asia@hoymiles.com">service.asia@hoymiles.com</a>		
<b>Germany</b> +49 6994322186	<b>France</b> +33 159131589	<b>Netherlands</b> +31 852736388	<b>Poland</b> +48 918821656

<b>Brazil</b>  +55 1148585231	<b>North America</b>  +1 8449964537		
<a href="http://hoymiles.com">hoymiles.com</a>			

## Revision History

V202502	This issue marks the initial official release.
V202504	

© 2025 Hoymiles Power Electronics Inc. All rights reserved.

Hoymiles Customer Support: [hoymiles.com/support/](http://hoymiles.com/support/)

## FAQS

• **Where can I find the latest version of the user manual?**

The latest version of the user manual can be accessed on the official Hoymiles website at [www.hoymiles.com](http://www.hoymiles.com) or by scanning the provided QR Code.

• **How can I contact customer support for technical queries?**

You can reach out to the Hoymiles customer support team via email based on your region or through the provided phone numbers for specific countries.

• **What are the communication methods available for the DTS?**

The DTS is available in three versions: WiFi (connects to S-Miles Cloud via Wi-Fi), 4G (connects via 4G and Wi-Fi), and WL (connects via LAN and Wi-Fi).

## Documents / Resources

	<a href="#">hoymiles DTS Series G3 Data Transfer Stick [pdf]</a> User Manual DTSWLG3, DTS-WiFi-G3, DTS-4G-G3, DTS-WL-G3, DTS Series G3 Data Transfer Stick, DTS Series G3, Data Transfer Stick, Transfer Stick, Stick
---	--

## References

- [Support – Hoymiles](#)
- [Support – Hoymiles](#)
- [User Manual](#)

📁 hoymiles

🔍 Data Transfer Stick, DTS Series G3, DTS Series G3 Data Transfer Stick, DTS-4G-G3, DTS-WiFi-G3, DTS-WL-G3, DTSWLG3, hoymiles, stick, Transfer Stick

—Previous Post

**hoymiles V5 Series Lithium Pytes Battery Instruction Manual**

---

## Leave a comment

Your email address will not be published. Required fields are marked \*

Comment \*

Name

Email

Website

☐ Save my name, email, and website in this browser for the next time I comment.

**Post Comment**

**Search:**

e.g. whirlpool wrf535swhz

Search

[Manuals+](#) | [Upload](#) | [Deep Search](#) | [Privacy Policy](#) | [@manuals.plus](#) | [YouTube](#)

This website is an independent publication and is neither affiliated with nor endorsed by any of the trademark owners. The "Bluetooth®" word mark and logos are registered trademarks owned by Bluetooth SIG, Inc. The "Wi-Fi®" word mark and logos are registered trademarks owned by the Wi-Fi Alliance. Any use of these marks on this website does not imply any affiliation with or endorsement.