



Howdot Smart Table Lamp Instruction Manual

[Home](#) » [Howdot](#) » Howdot Smart Table Lamp Instruction Manual 

HOWDOT

Smart Table Lamp Manual

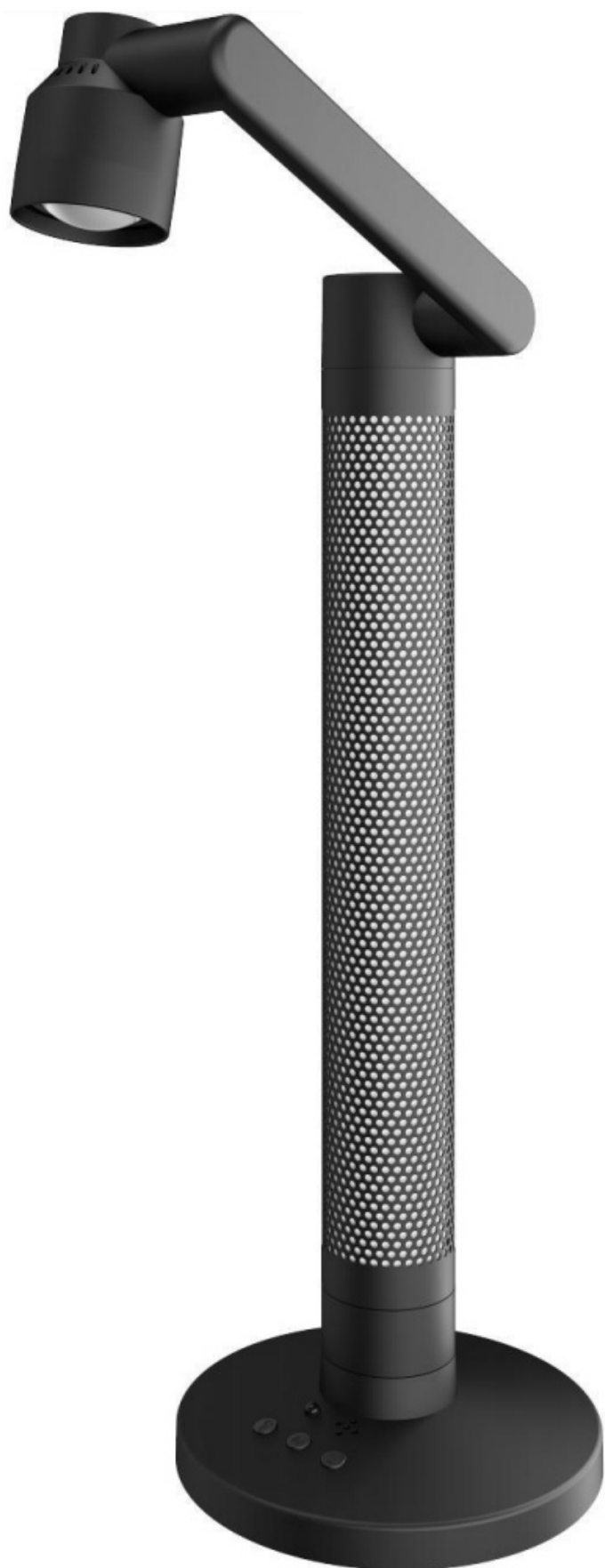

Contents

- 1 Declaration:
- 2 Important Safeguards:
- 3 Button Function:
- 4 Remote Control Function:
- 5 APP CONNECTION GUIDE
- 6 APP PAGE GUIDE
- 7 Product Information:
- 8 Documents / Resources
 - 8.1 References
- 9 Related Posts

Declaration:

Our brand attaches great importance to product quality and customer experience, all our products have been strictly and comprehensively tested before shipment. After receiving the product please avoid the product being squeezed or bumped.

Package Includes:

- 1 x Ambience Table Lamp,
- 1 x Adapter
- 1x IR Remote Control,
- 1 x Instruction Manual

Important Safeguards:

Before using the electrical appliance, the basic precautions should always be followed to avoid safety problems or damage to the lamps caused by incorrect use as below:

1. Read all operating instructions
2. Please DO NOT disassemble the light without permission
3. Please Do NOT stare at the light source closely
4. The sound source is better recognized by maintaining a range of 1M while using the Rhythm Function
5. The product is recommended for indoor use. Prevent foreign objects from entering the body and causing product failure
6. Avoid using in humid or dusty environments
7. Please DO NOT frequently switch ON/OFF the lights for a short period of time. Continuously working for too long will also affect the life of the products
8. Based on the characteristics of semiconductor light source, the working environment temperature is required to be -10~45 degrees

Tips: Be sure to read the manual precautions carefully before using.

We are not responsible for any malfunction or physical damage caused by ignoring the operation manual.

Button Function:

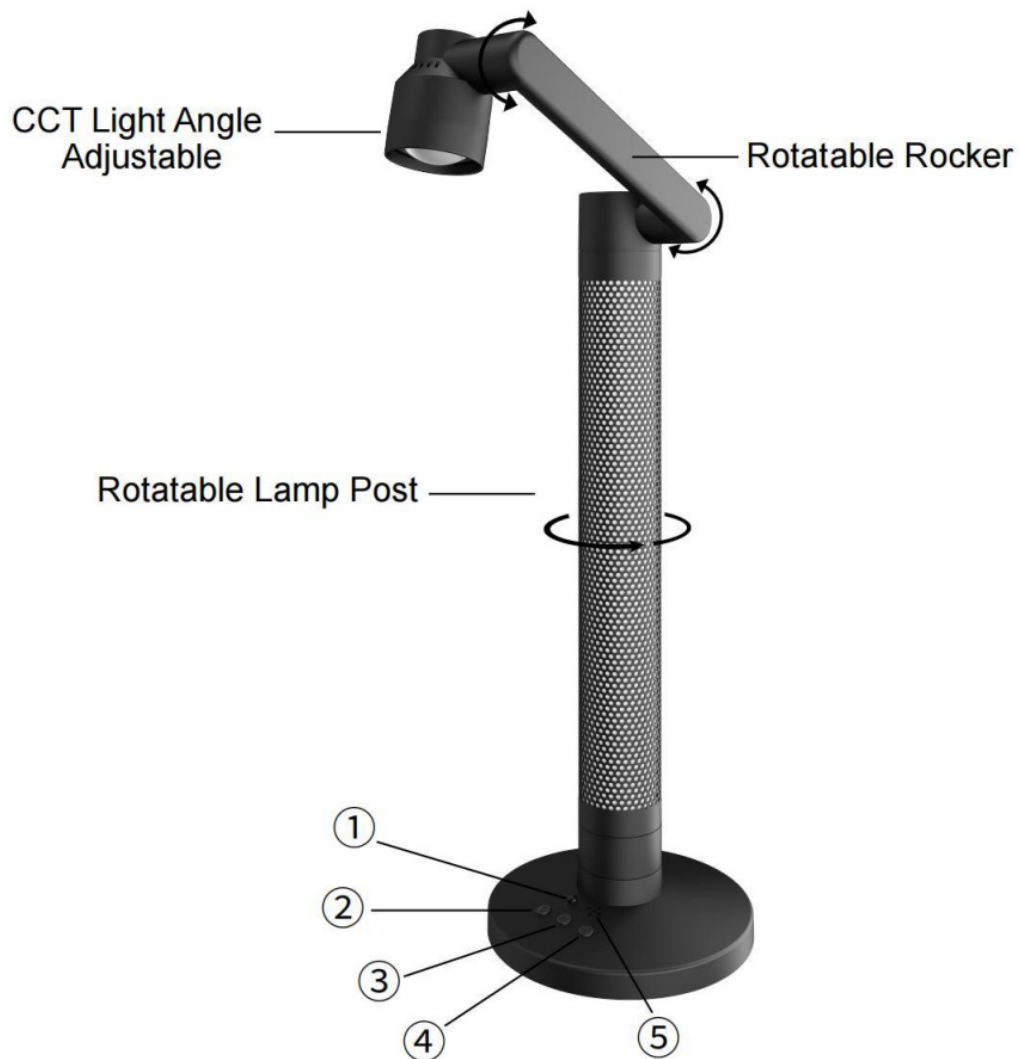

- Sound Receiver: Sound receiving source for Rhythm Mode.
- CCT Light Switch: Click to turn on the light, click again to adjust the light brightness (3 brightness levels adjustable)
Long press 2-3s to turn off the light.
- Ambient Light Control (Lamp Post): Click to switch between 13 modes from 6 Monochrome Lights Mode to 4 Scene Mode to 3-speed Sound Sensitive Mode. Long press to turn off the lamp post light.
- Color Temperature Switching(CCT Light): Click to switch the CCT light between Warm White – Bright White – Natural White. Long press 3s to re-enter the Network Pairing Mode.
- IR Receiver: Receive IR remote control commands.

Remote Control Function:

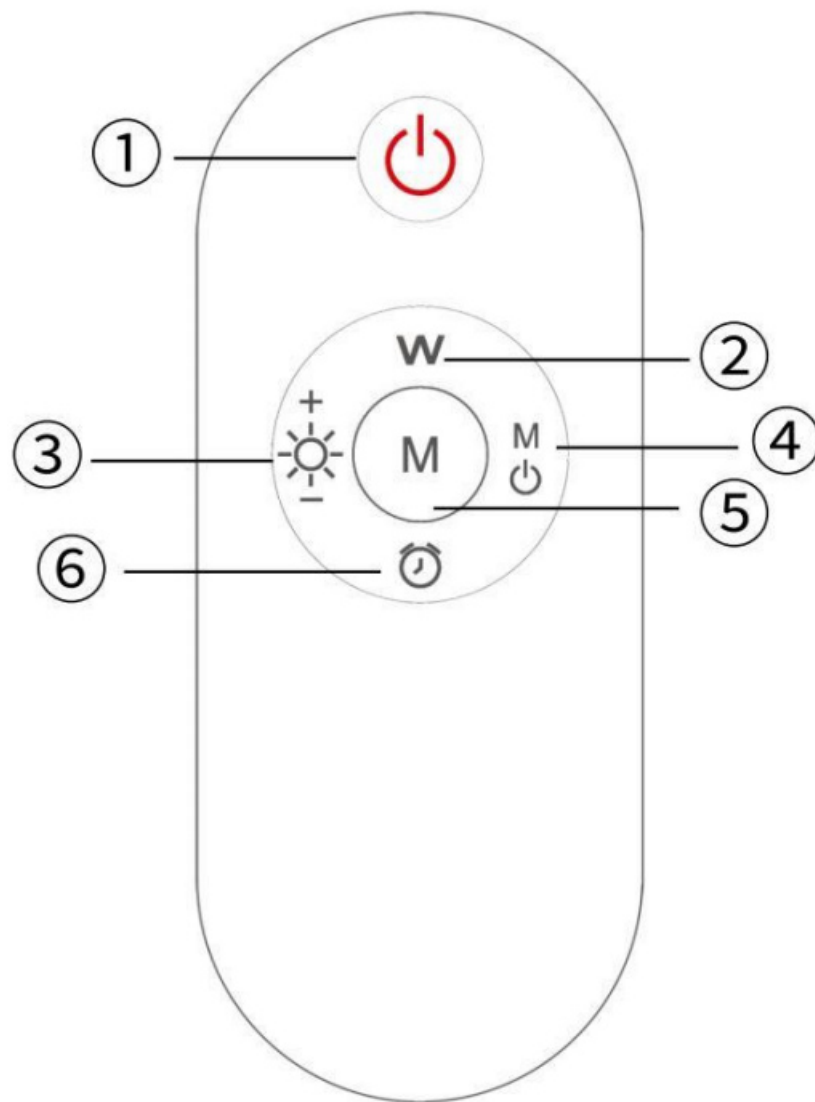

1. Main Switch: Turn On/Turn Off the CCT Light and Ambient Light at the same time.
2. Color Temperature Switching(CCT Light): Click to switch the CCT light between Warm White – Bright White – Natural White.
3. CCT Light Switch: Click to turn on the light, click again to adjust the light brightness (3 brightness levels adjustable)
Long press 2-3s to turn off the light.
4. Ambient Light Switch: Turn On/Off the ambient light (Lamp Post).
5. Ambient Light Control (Lamp Post): Click to switch between 13 modes from 6 Monochrome Lights Mode to 4 Scene Mode to 3-speed Sound Sensitive Mode.
Long press to turn off the lamp post light.
6. Timer Function: Click and the white light of the lamp column flashes once, means successfully set timer for 2 hours.
Click again and the white light flashes once to cancel the timing.

APP CONNECTION GUIDE

Step 1

Scan the QR code or search “Smart Life” directly in the APP store to download the “Smart Life” APP

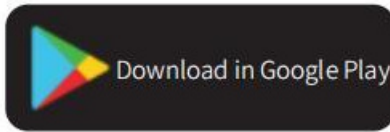
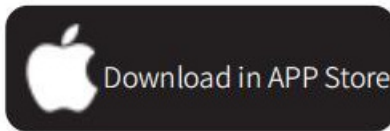

<http://e.tuya.com/smartlife>

Step 2

- ① Open the “Smart Life” APP, Turn on Bluetooth and WiFi.
- ② Enter Network Pairing Mode:

1. After Power ON, when the lamp post appears red light flashing can be automatically connected.
2. The desk lamp is in the OFF state → Long press the Color Temperature button 3-5s → The lamp post appears red light flashing and enter Network Pairing Mode.



Notes:

1. When first time open the app, the pop-up option of whether to allow permissions. Please select “Allow”.
2. If Android phone can't retrieve the Bluetooth, please check to open the location.

Step 3

Device Connection:

- ① Add device
- ② Enter WIFI Password

③ Connect successfully

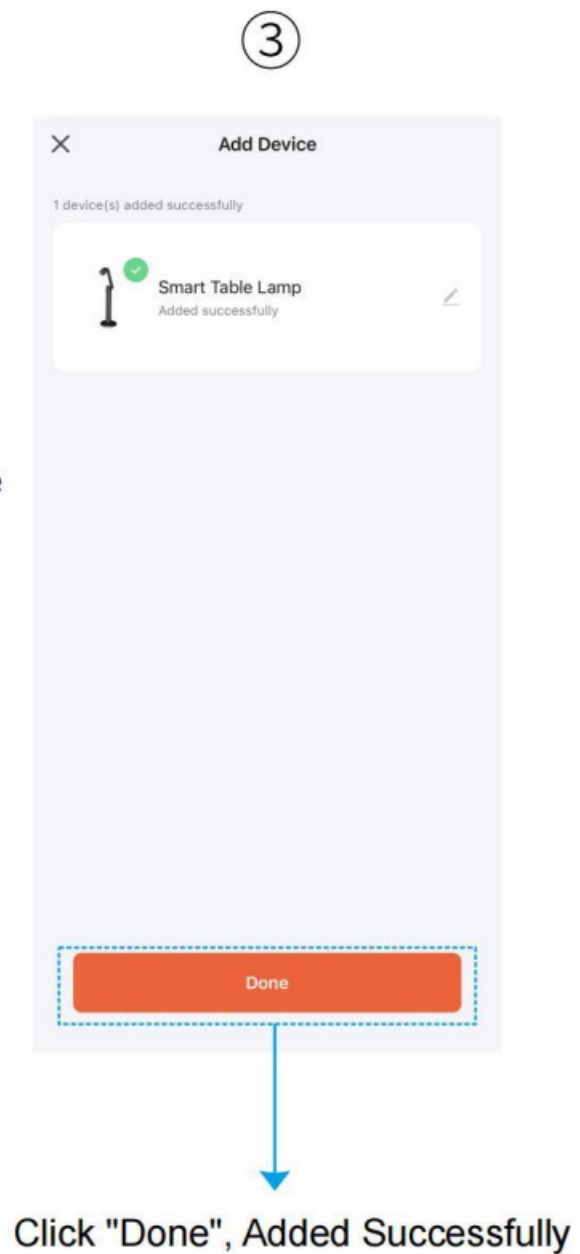
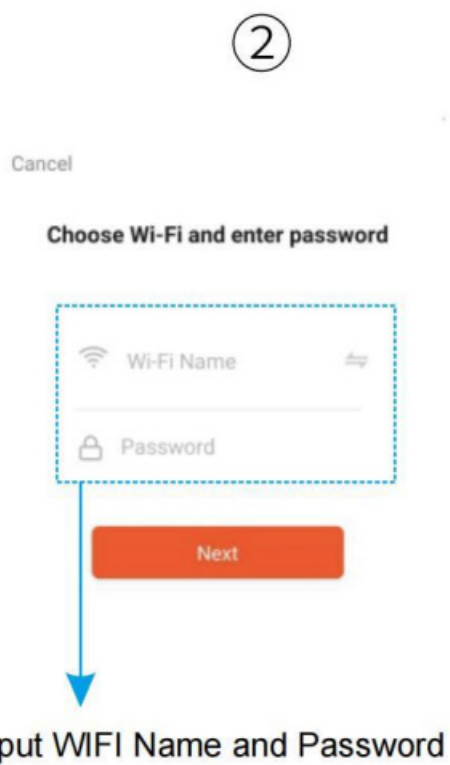
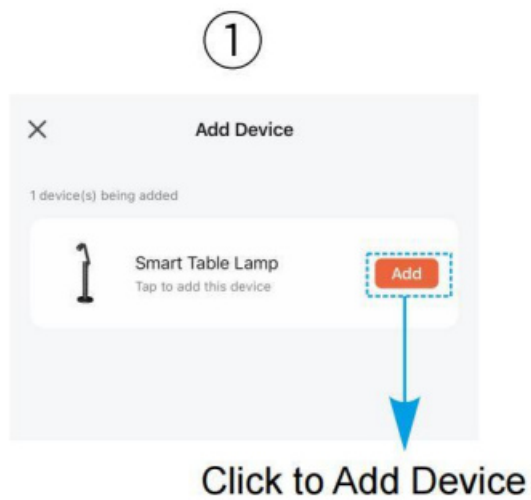

APP PAGE GUIDE

Main Screen

Add Device/Create Scene



Click to enter the Main Interface of Ambience Light

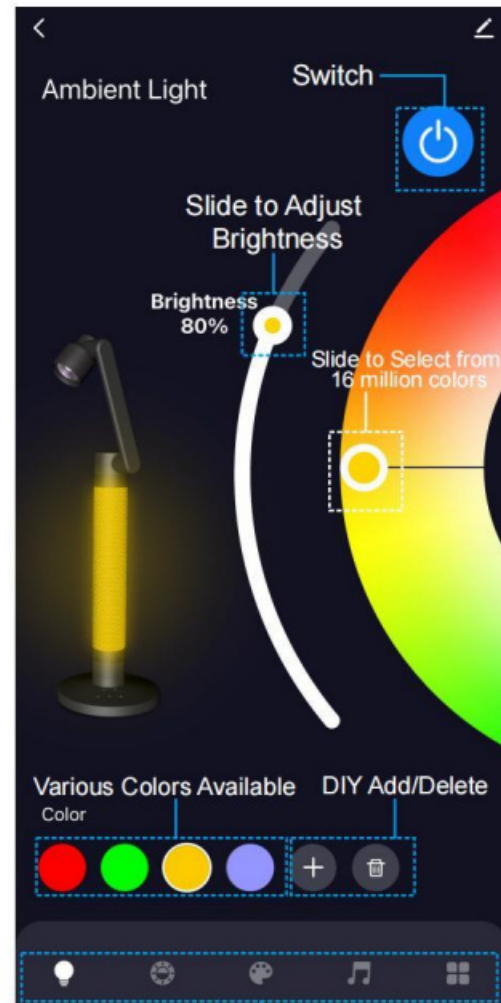

Light Modes/Color Temperature/Scene Modes
Rhythm Mode/More(Schedule & Timer)

CCT Light Function

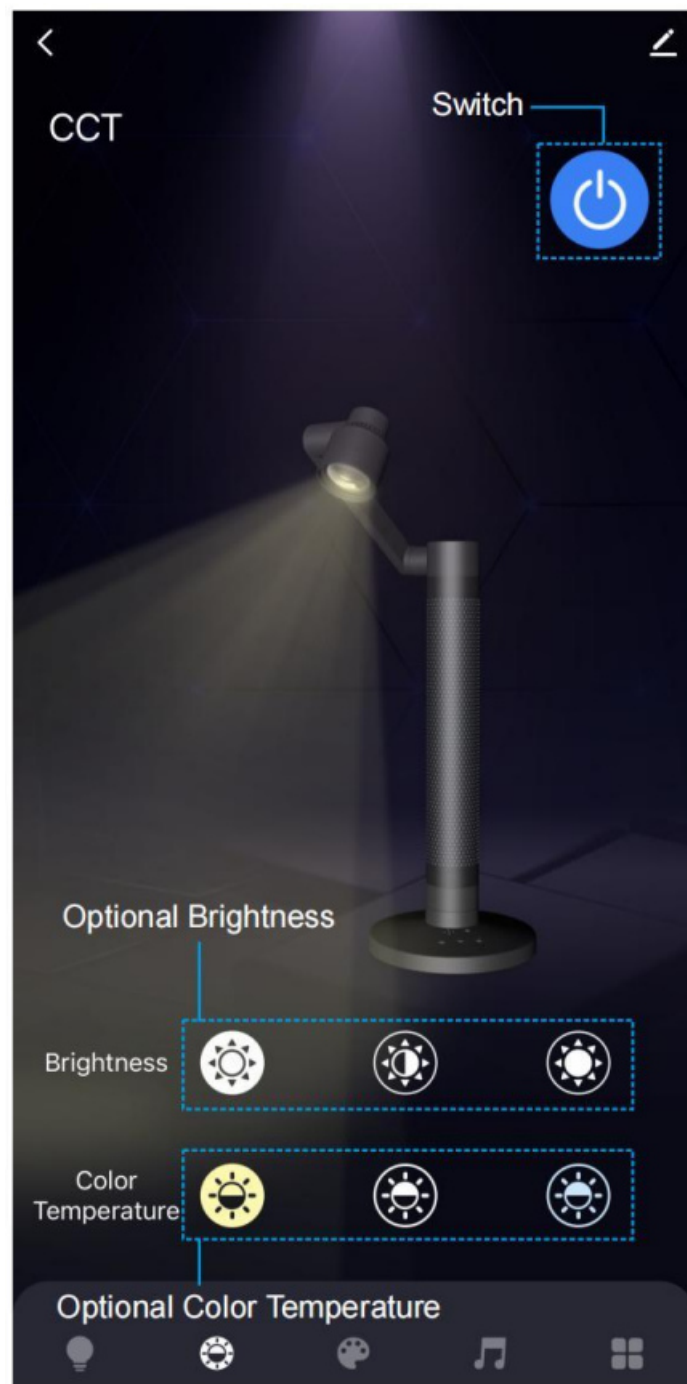

Scene Modes & Rhythm Modes

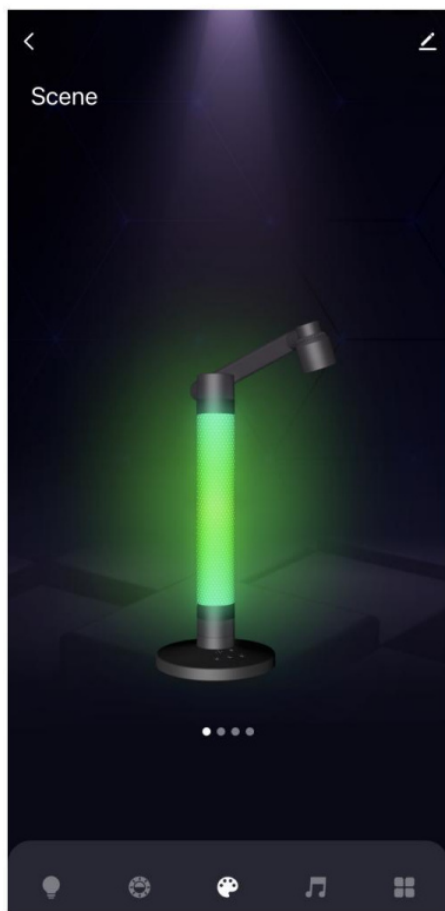

Slide to Switch Between 4 Scene Modes

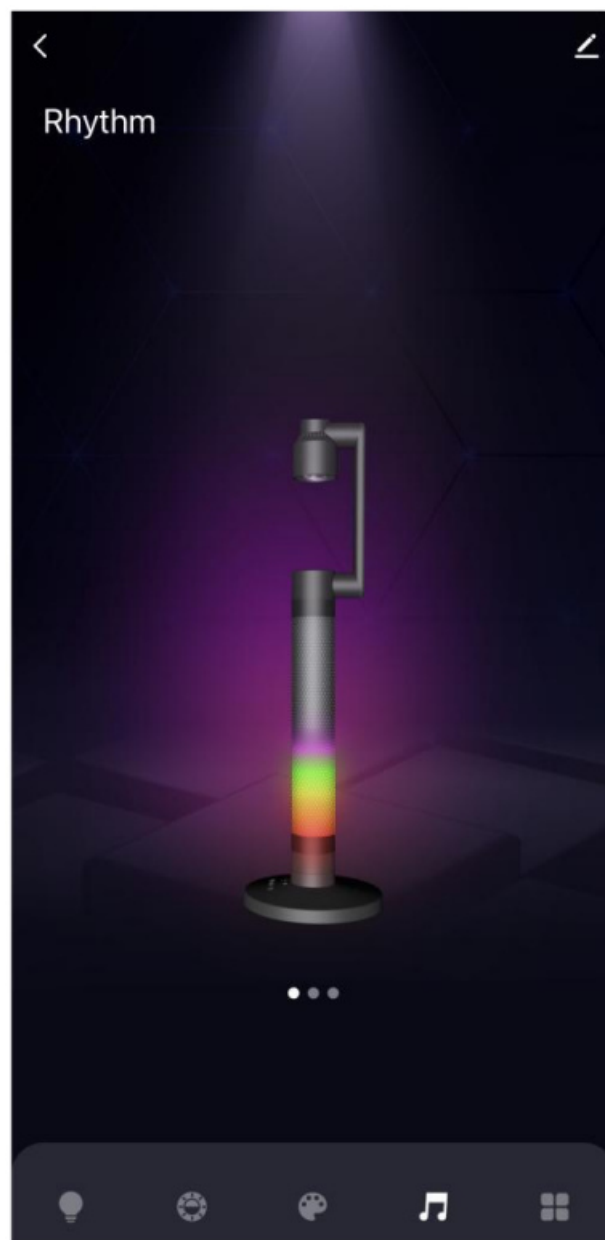

Slide to Switch Between 3 Rhythmic Modes (Sound Sensitivity Adjustment) Built-in Microphone for Sound Reception

Ambience Lamp Timer Function(ON/OFF)

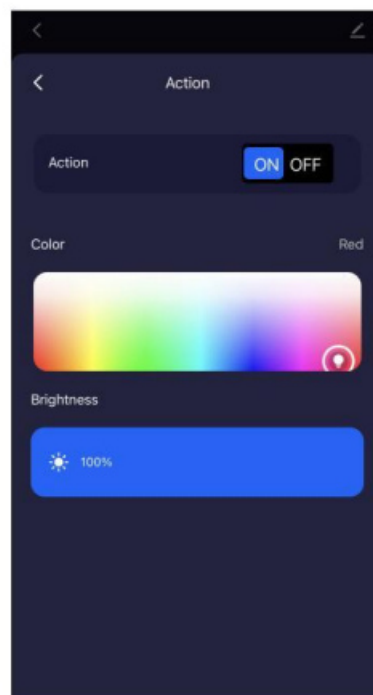
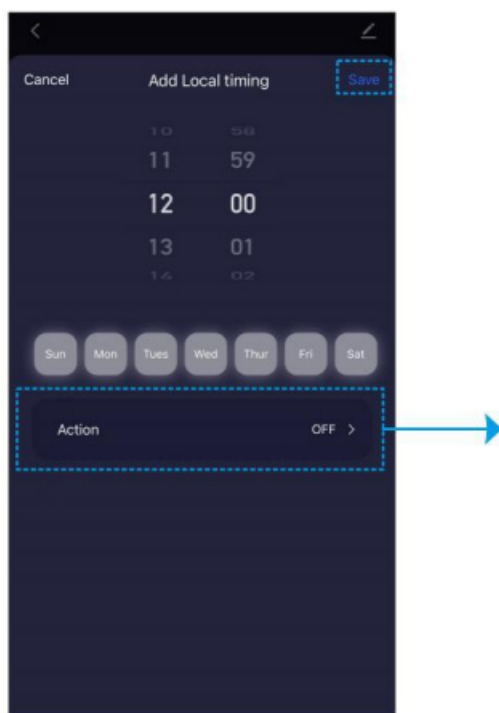
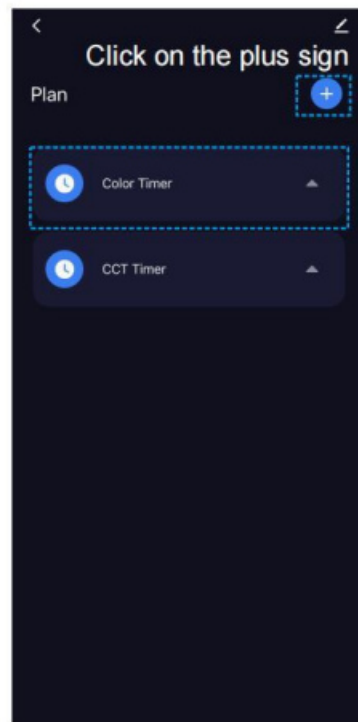
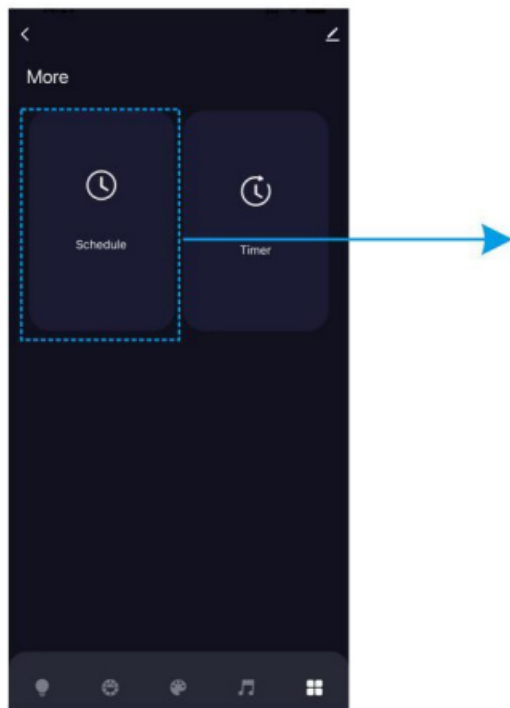

Set Lighting Effects and Brightness

CCT Lamp Timer Function(ON/OFF)

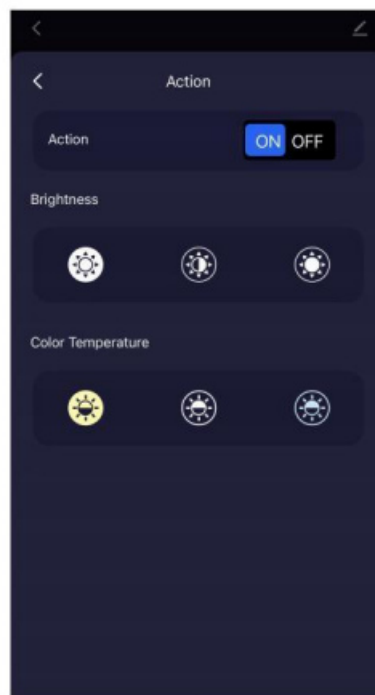
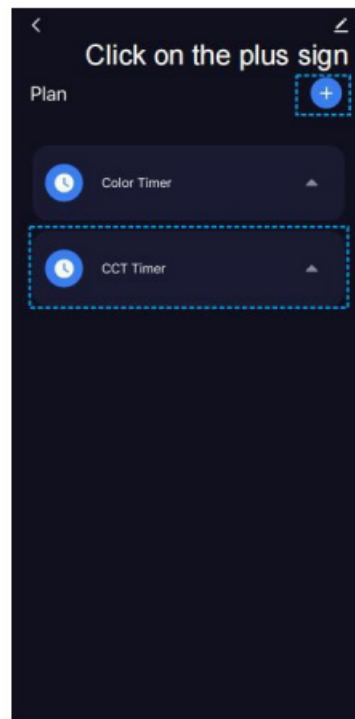
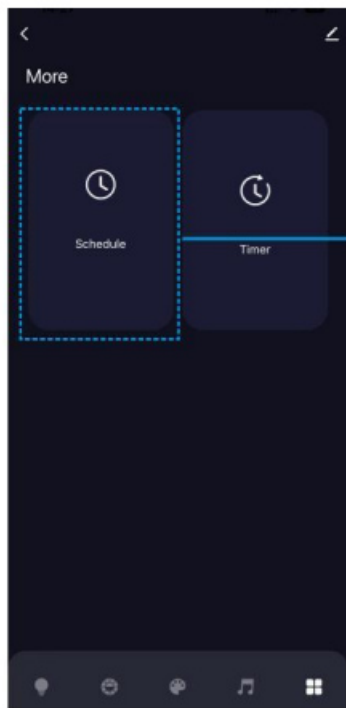

Set Lighting Effects and Brightness

Timed Off Function

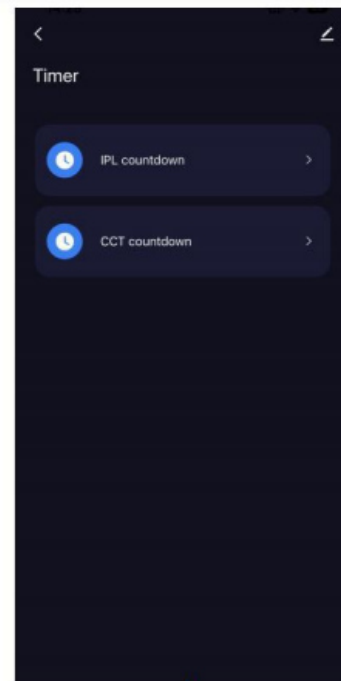
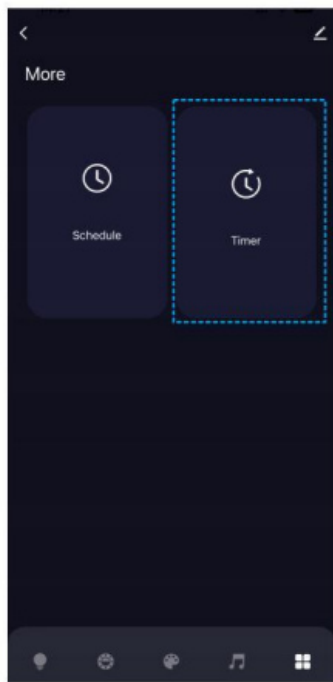

CCT Light Off Countdown Setting

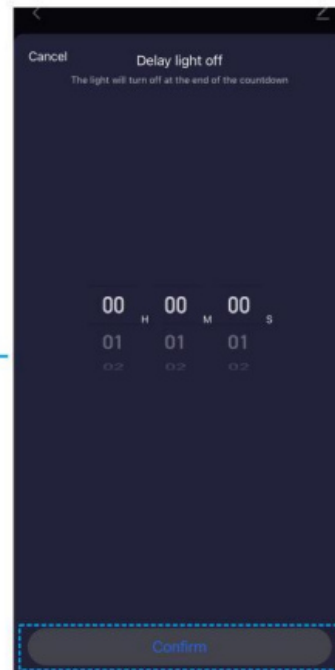

Ambient Light Off Countdown Setting

Create a usage scenario for any device connected to the Smart Life App.
Then you can easily control multiple devices at the same time.

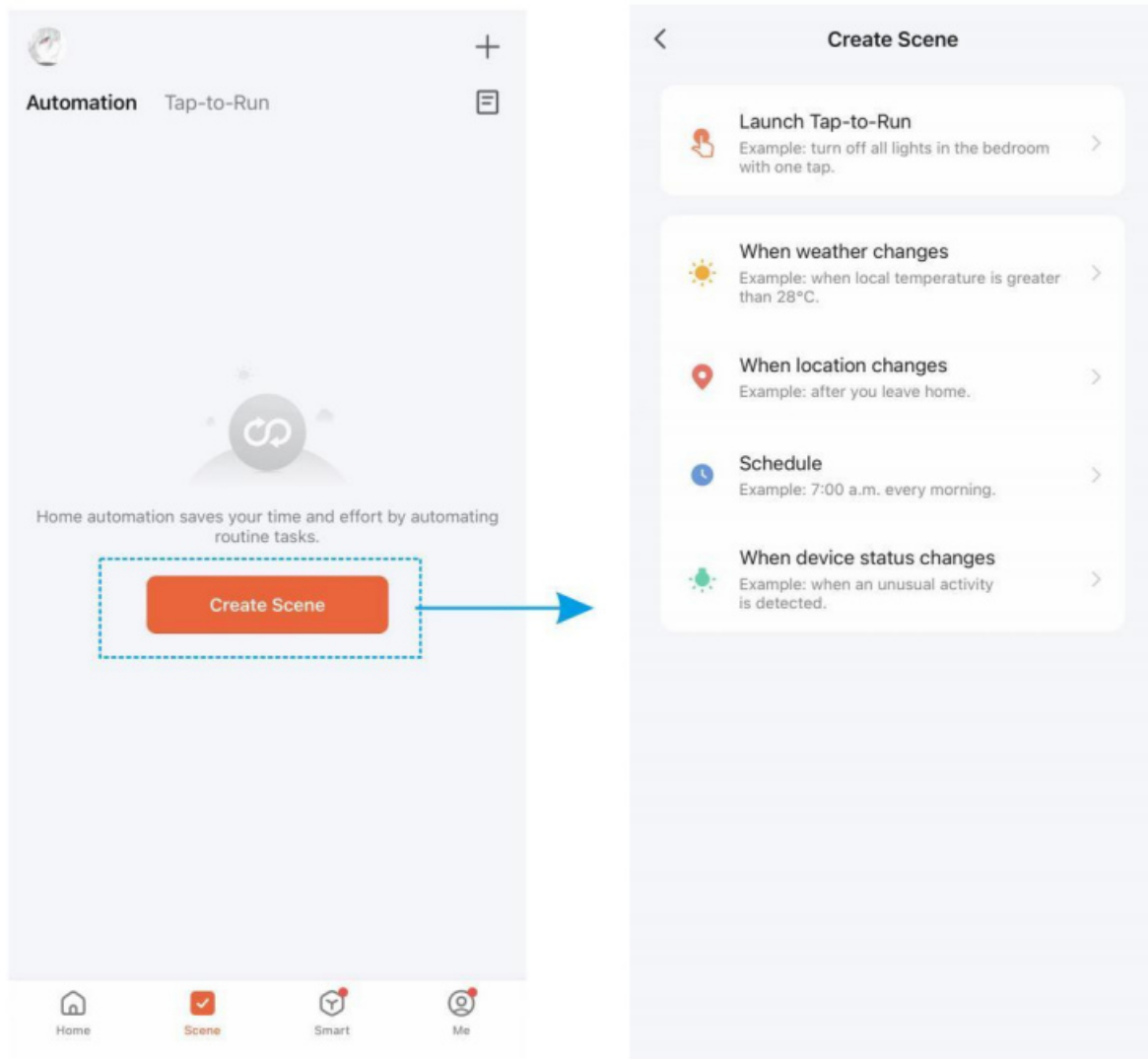

Product Information:

Product Name: Smart Table Lamp
Product Color: Black
Material: ABS + Iron
Product Power: 10W
Power Supply: 5V/2A
Power Supply: USB Cable
Luminous Flux: 600 (lm)
Color Temperature: 2800-6000K
Package Weight: 2.94 pounds
Package Size: 6.10*6.30*14.96 inches
Control Method: IR Remote Control/Push Button/APP
Connection Method: WIFI+BLE
Remote Control Distance: ≤315 inches
APP Control Distance: ≤590 inches

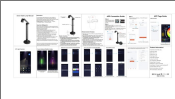

Documents / Resources

	Howdot Smart Table Lamp [pdf] Instruction Manual Smart Table Lamp, Table Lamp, Lamp
---	--

References

- [User Manual](#)