



# HOSOM 8801 Entry Door Handle with Lock and Key Installation Guide

[Home](#) » [HOSOM](#) » HOSOM 8801 Entry Door Handle with Lock and Key Installation Guide 

## Contents

- [1 HOSOM 8801 Entry Door Handle with Lock and Key](#)
- [2 LEVER SET INSTALLATION INSTRUCTIONS AND TEMPLATE](#)
- [3 Door preparations](#)
- [4 Template](#)
- [5 Documents / Resources](#)
  - [5.1 References](#)
- [6 Related Posts](#)

# HOSOM

**HOSOM 8801 Entry Door Handle with Lock and Key**





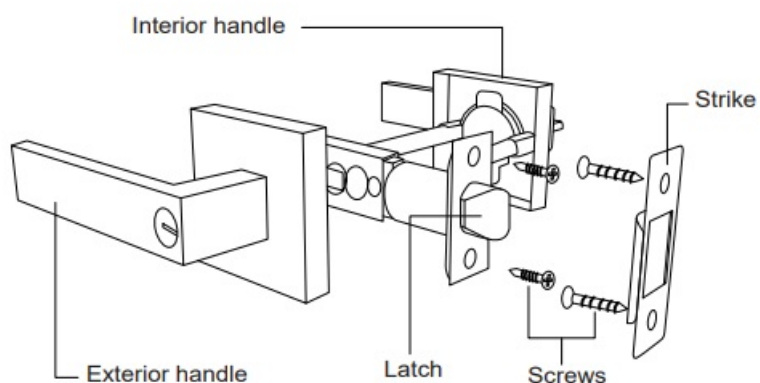

This lever will fit 35mm to 45mm door thickness

## LEVER SET INSTALLATION INSTRUCTIONS AND TEMPLATE

### Detailed components

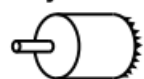

### Tools needed

<b>Power Drill</b> 	<b>Hole saw 24 y 54 mm</b> 
<b>Drill bit 3/32"</b> 	<b>Screwdriver #1 #2</b> 
<b>Chisel</b> 	<b>Pencil</b> 

## Determining door handling

Door handling is determined by standing outside the place/room and looking where the hinges are placed. If they are placed on the right side the door is right and left if the hinges are placed on the left side.

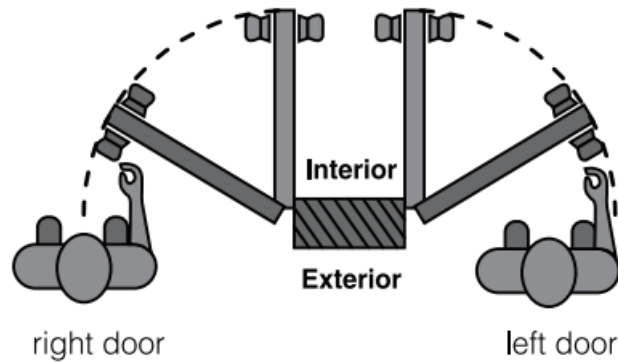

## Door preparations

### 1. HOLE MARKING

Place the template and fold on the door edge, check the distances and centers to drill. Select the distance from the edge of the door. It is recommended to install 90 to 100cm regarding of floor.

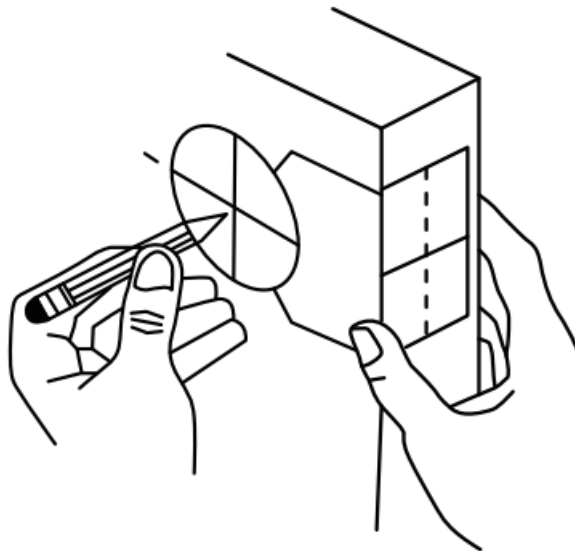

### 2. HOLES

Carefully punch the door with a drill on the previously marked centers, doing first the larger diameter to 54mm (2 1/8") and then the center of the edge of the door

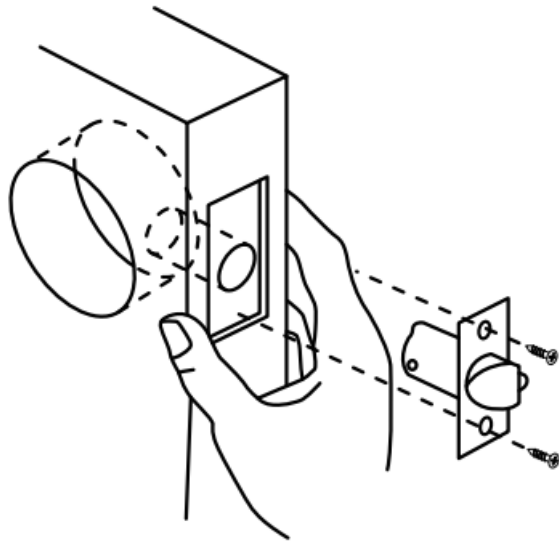

### 3. Latch preparation

Insert the bolt into the hole 24 mm and draw the outline of the front, slot with the chisel all this area to 3 mm depth of where the latch plate will lodge

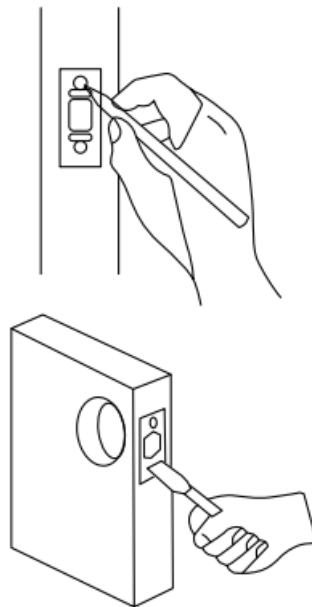

### 4. Setting latch

Adjust the latch to the distance you are going to install, 60 or 70 mm (Backset 2 3/8" or 2 3/4").

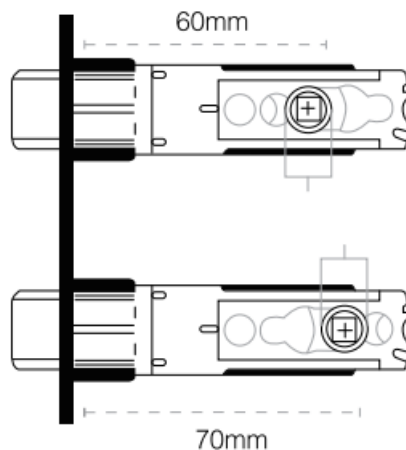

### 5. Latch installation

Insert the latch into the hole in the door edge with its sloping side according to the direction that go to close the door. Screw it on the door edge until the plate flush with the surface.

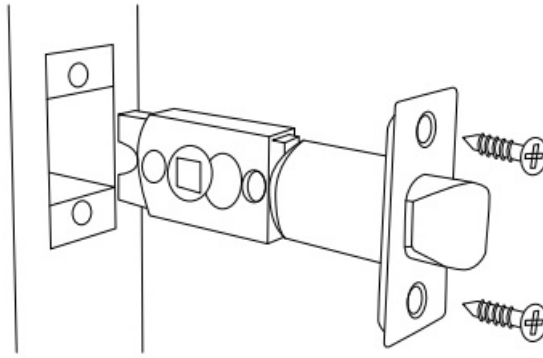

#### 6. Fixing of exterior handle lock

Install the lock of exterior handle by inserting the posts and the square bolt into the holes on the latch mechanism.

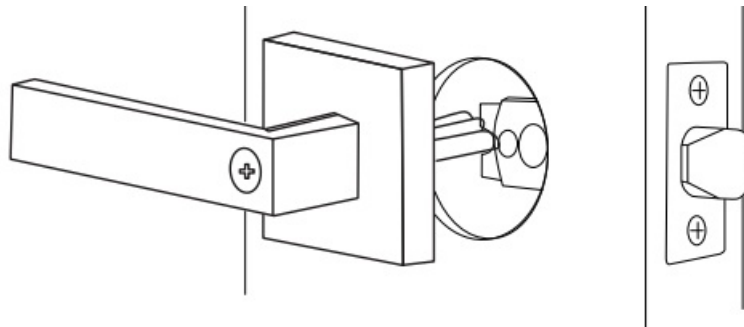

#### 7. Installation of interior handle lock

Install the interior handle lock connecting it to the square bolt of the outer part and positioning the screws from the interior latch toward the posts. Screw and try the operation.

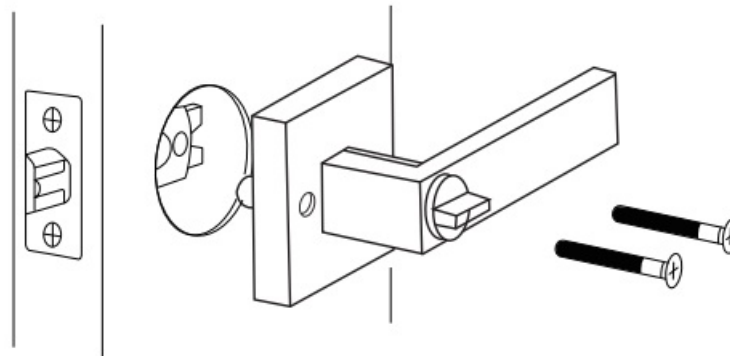

#### 8. Strike installation

Install the strike in the frame of door using the height of the latch to do the needed perforations.

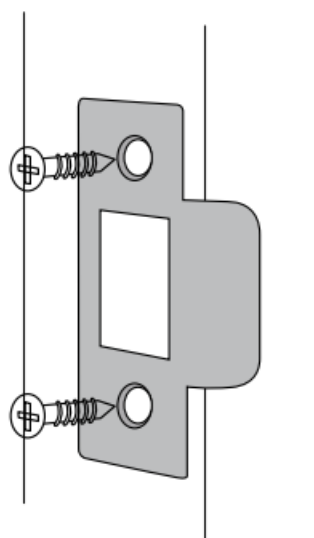

## Template

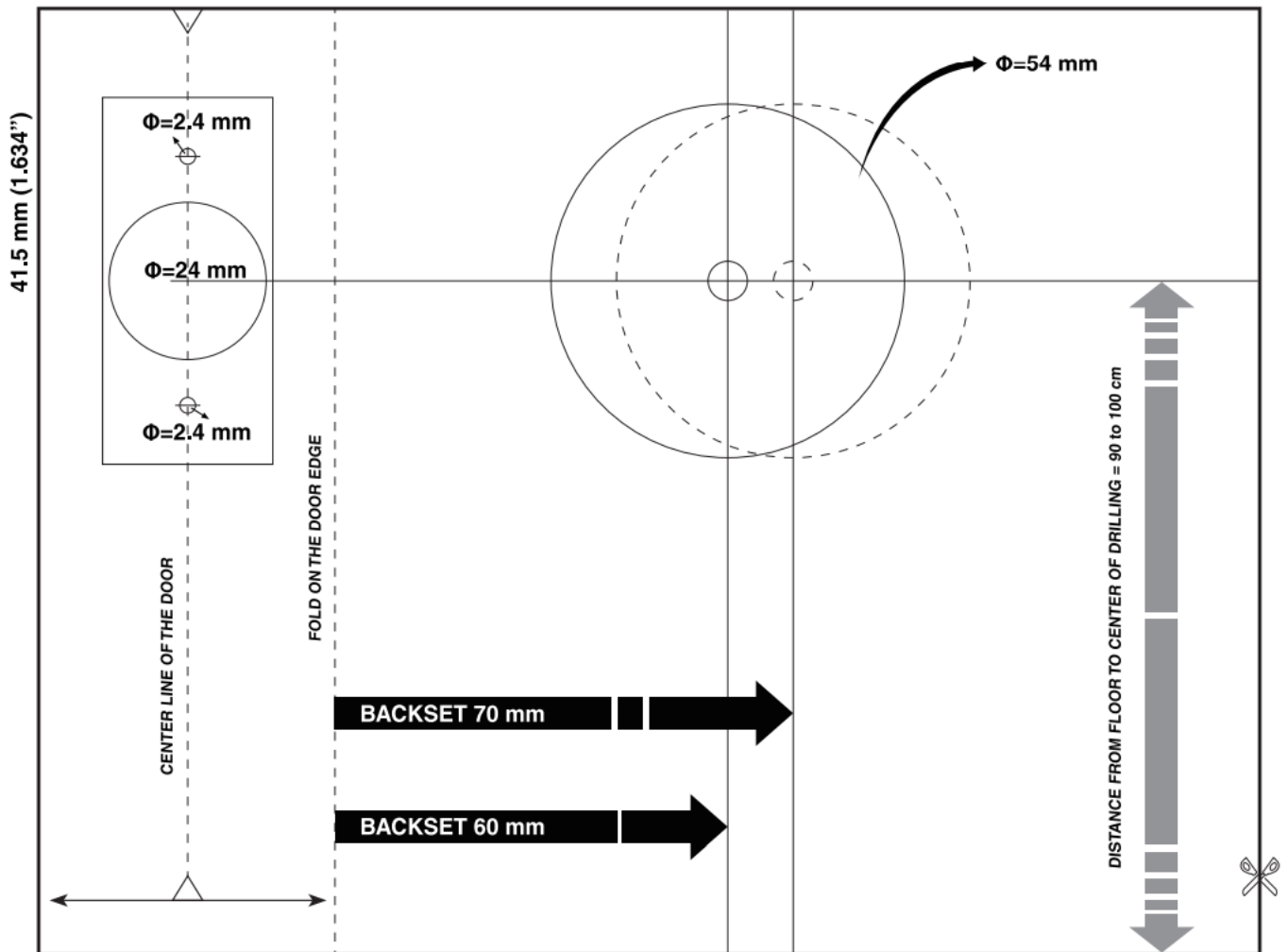

## Documents / Resources

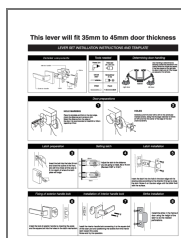

[HOSOM 8801 Entry Door Handle with Lock and Key](#) [pdf] Installation Guide  
8801 Entry Door Handle with Lock and Key, 8801, Entry Door Handle with Lock and Key, Door Handle with Lock and Key, Handle with Lock and Key, Lock and Key, Key

## References

- [User Manual](#)

