



HORNBY HOBBIES HM6010 BLE Model Accessory Controller User Guide

[Home](#) » [HORNBY HOBBIES](#) » HORNBY HOBBIES HM6010 BLE Model Accessory Controller User Guide 



HM6010 BLE Model Accessory Controller User Guide

Contents

- [1 Getting to know the HM6010](#)
- [2 Initial setup](#)
- [3 Basic wiring configurations](#)
- [4 Documents / Resources](#)
 - [4.1 References](#)
- [5 Related Posts](#)

Getting to know the HM6010

Your new Bluetooth circuit controller.

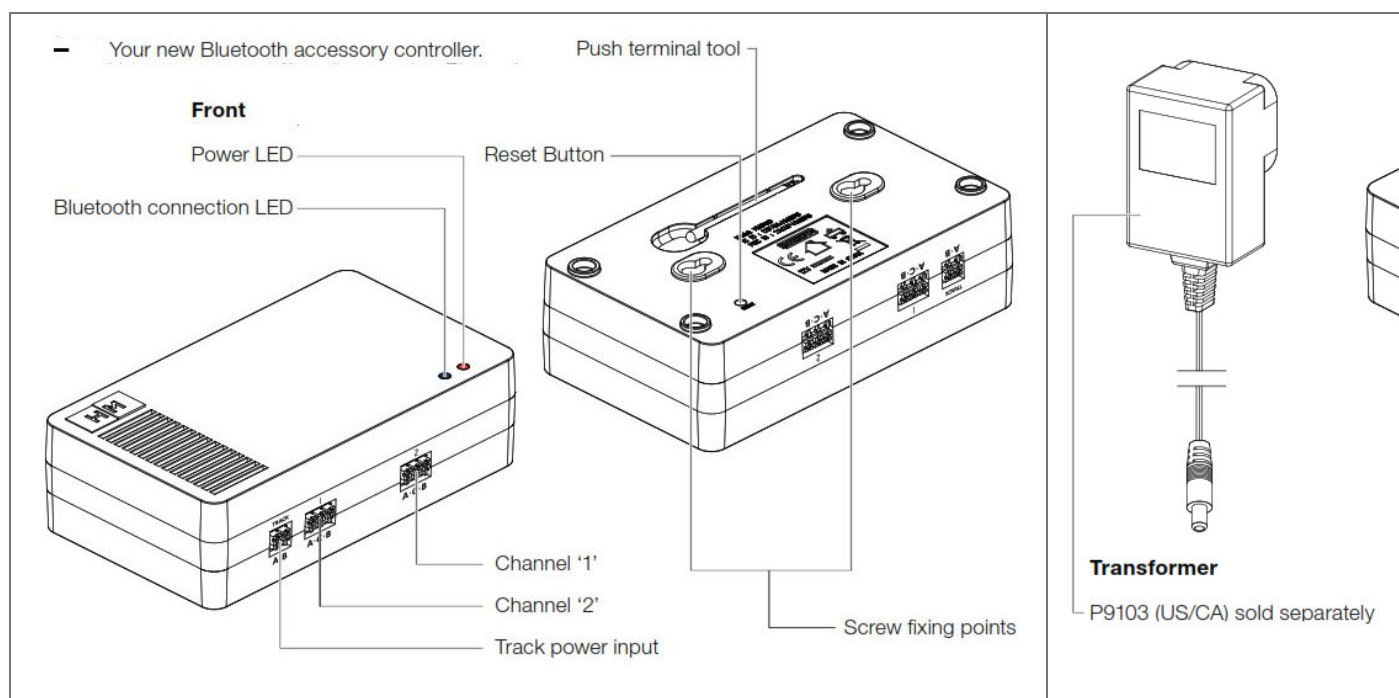

Initial setup

Configuration initiale

1. Firstly, ensure there is no power to the device and the 'Red' and 'Blue' LEDs are off. Next, pick the 'Push terminal tool' out from the underside of the HM6010 (A). Line up the push terminal tool with the white '+' of the terminal (B). Following the diagram in (C), delicately push in the white '+' with the tool and feed the wire into the open slot of the terminal.

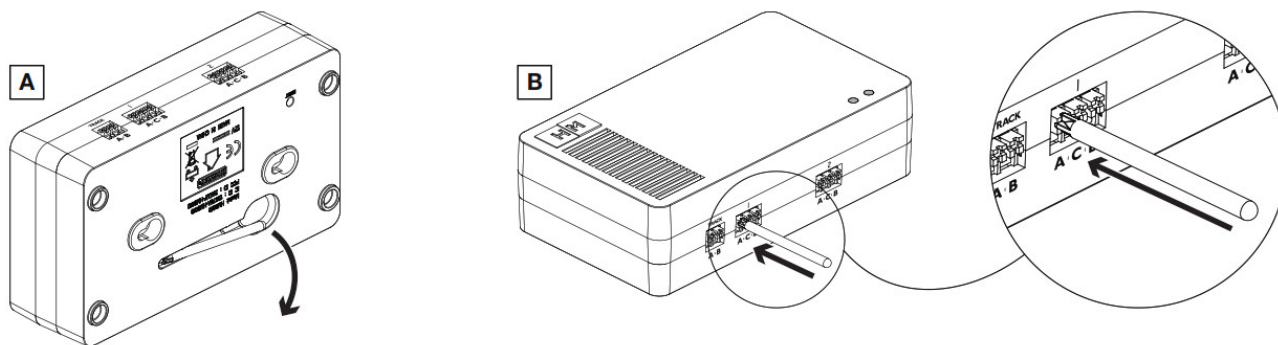

Once the wire is in place, take the pressure off the terminal and remove the push terminal tool.

Lastly, give the wire a very light tug to ensure it is in place. Repeat steps (A) – (C) to connect your given accessories (D).

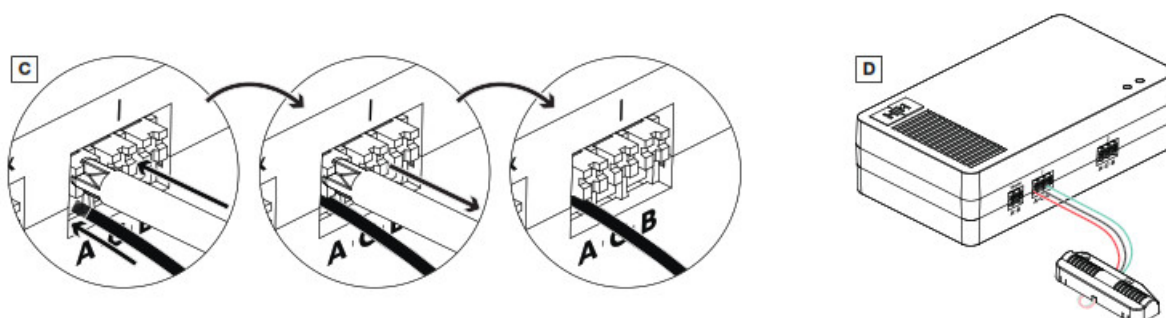

2. Connect your HM6010 to the DC mains or a DCC (digital) circuit.

DC

For DC (analog), connect the transformer jack to the DC port

DCC

For DCC (digital), connect 'A' & 'B' with wiring into an R8241 Digital Power Track

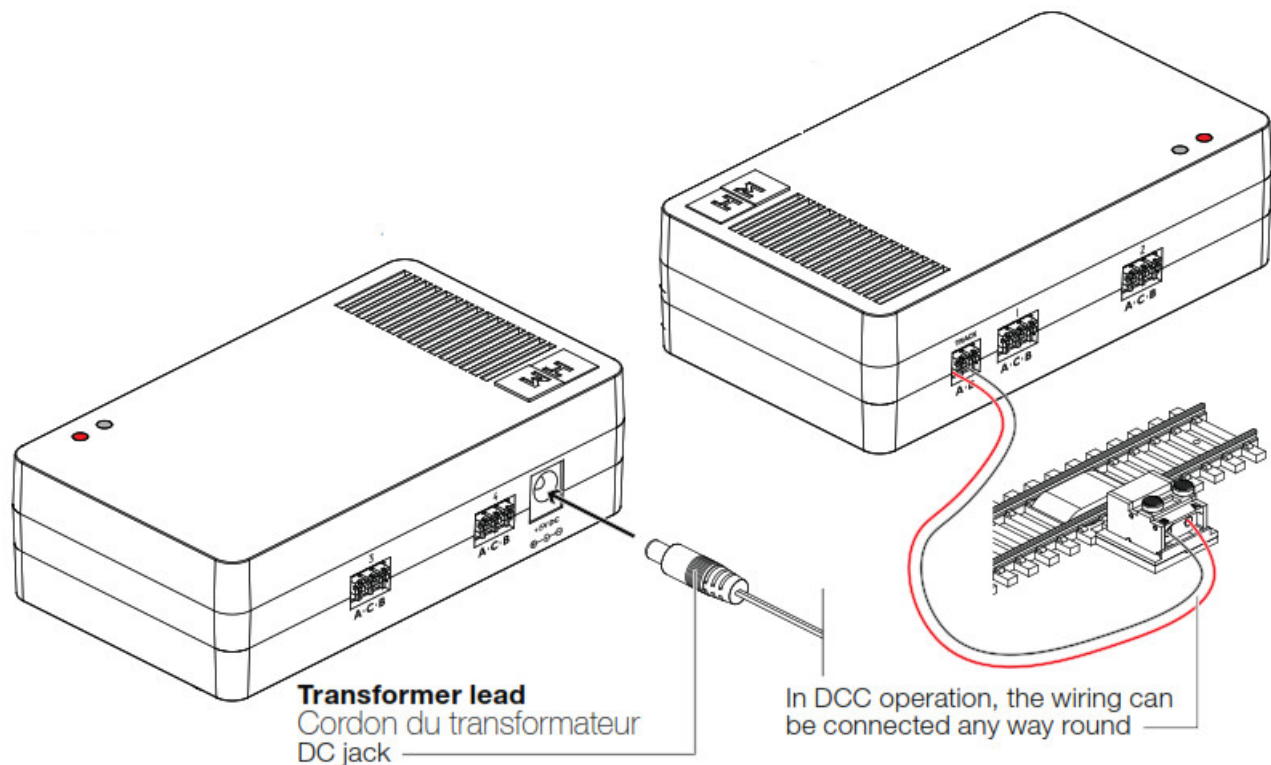

3. Download the HM | DC application.

A. Scan the QR code with a compatible Android or IOS device

B. On the Hornby website, touch on the relevant app store button.

C. Touch on 'GET' or 'Install' next to the HM | DC app icon and follow the on-screen instructions.

D. Open the HM | DC application on your device to get started.

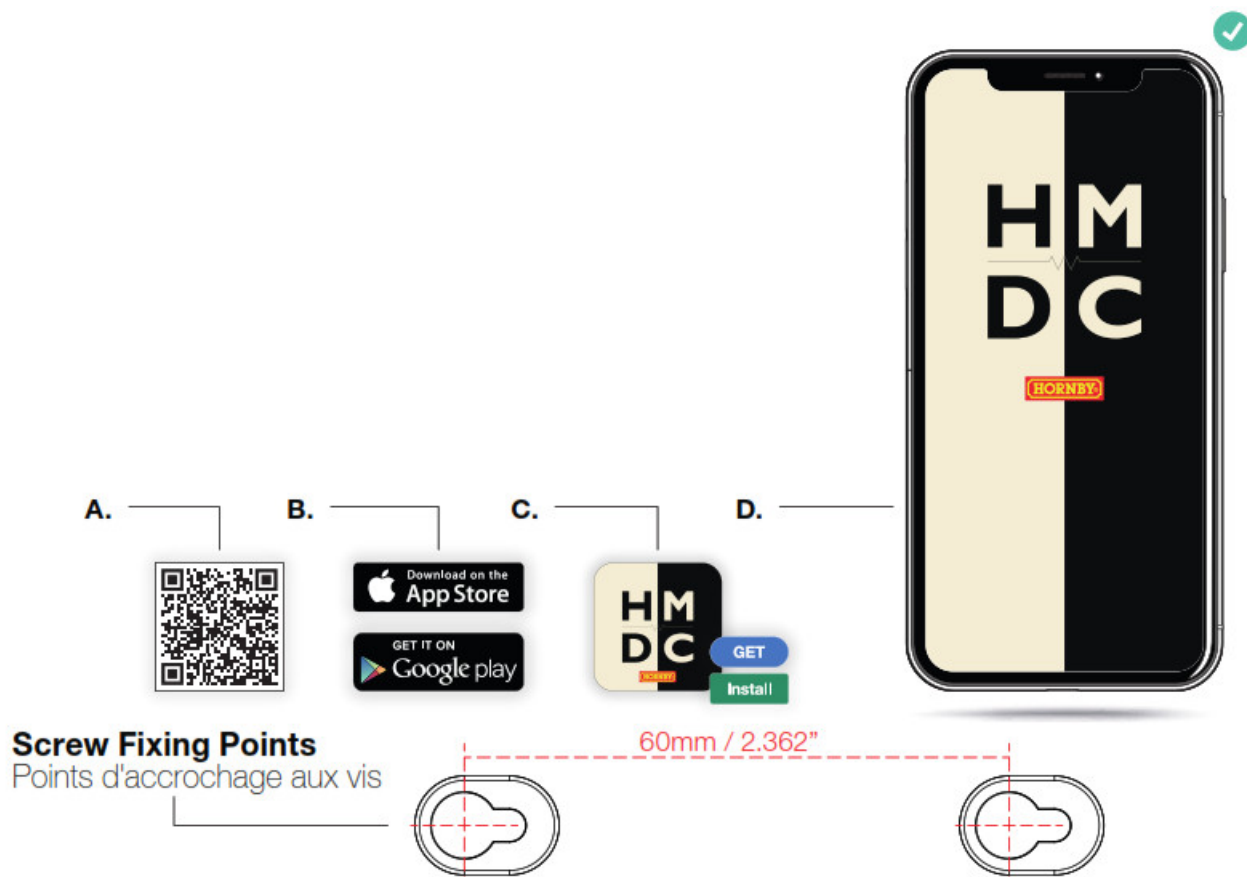

4. Connect your HM6000 to HM | DC.

- A. Ensure your Power LED is solid 'Red', if not refer to Step [2] of 'Initial setup'.
- B. On your compatible device you wish to use, ensure that your Bluetooth is turned on.
- C. Open the application and follow the initial setup process, ensuring you allow HM | DC to access and use Bluetooth on your device.
- D. Once the initial setup is complete, the Bluetooth connection LED should be solid 'Blue'.

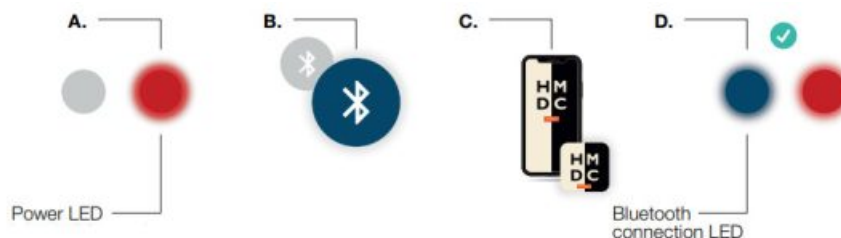

Basic wiring configurations

1. Point motors

Wire in the colored wires from a Hornby point motor (R8243 & R8014) as follows [1]:

'Red' to 'A'(+), 'Black' to 'C'(common) & 'Green' to 'B'(-).

In the HM | DC app device settings, select the 'Point' option for the channel matching the terminal on the HM6010 you have wired your accessory into.

Point motors can be wired into channel/terminal '1', '2', '3' & '4'.

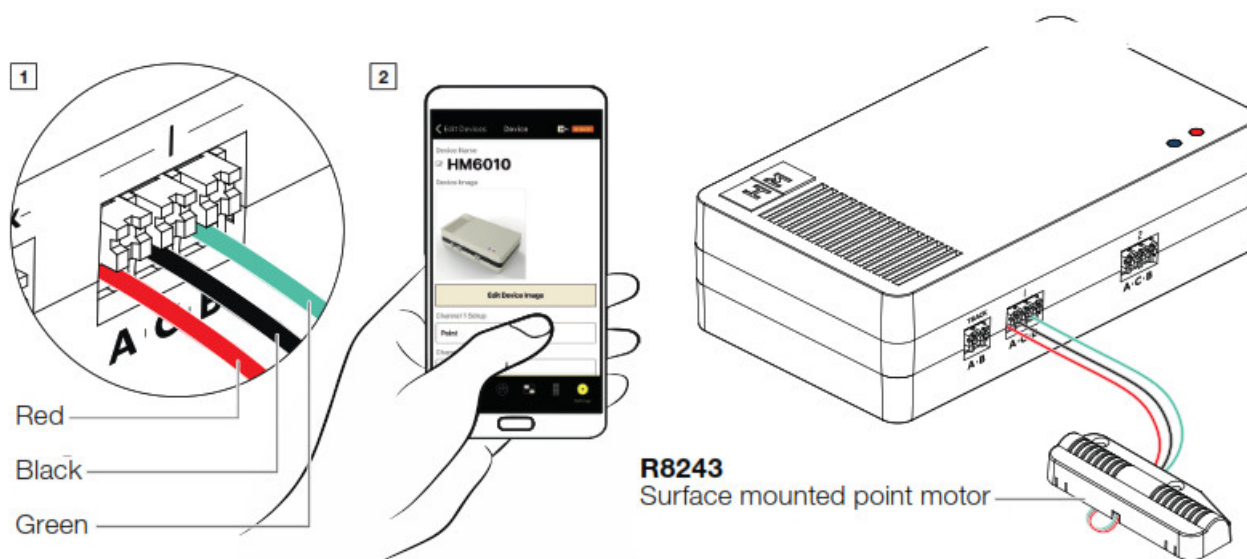

2. Signal Lighting

Wire in the colored wires from a Hornby signal light (R406) as follows [1]:

'Red' to 'A'(+), 'Green' to 'C'(common) & 'Black' to 'B'(-).

In the HM | DC app device settings, select the 'Signal' option for the channel matching the terminal on the HM6010 you have wired your accessory into.

Signal lighting can be wired into channel/terminal '1', '2', '3' & '4'.

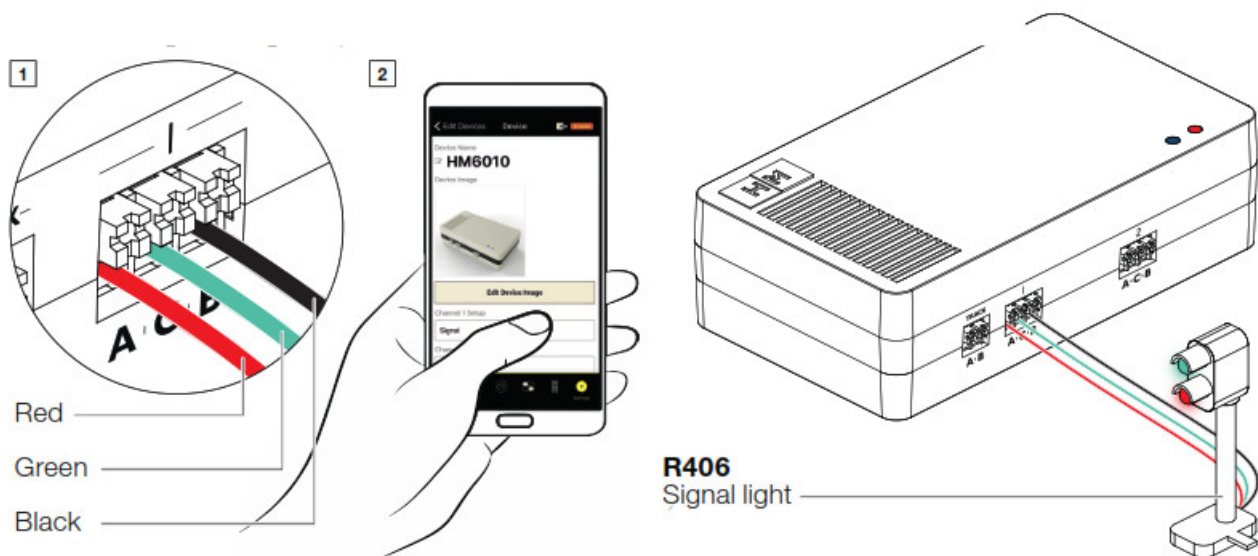

3. Street lighting

Wire in the colored wires from a street light with a simple on/off function as follows [1]: 'Red' to 'A'(+) & 'Black' to 'C'(common).

In the HM | DC app device settings, select the 'Lights' option for the channel matching the terminal on the HM6010 you have wired your accessory into.

Street lighting can be wired into channel/terminal '1', '2', '3' & '4'.

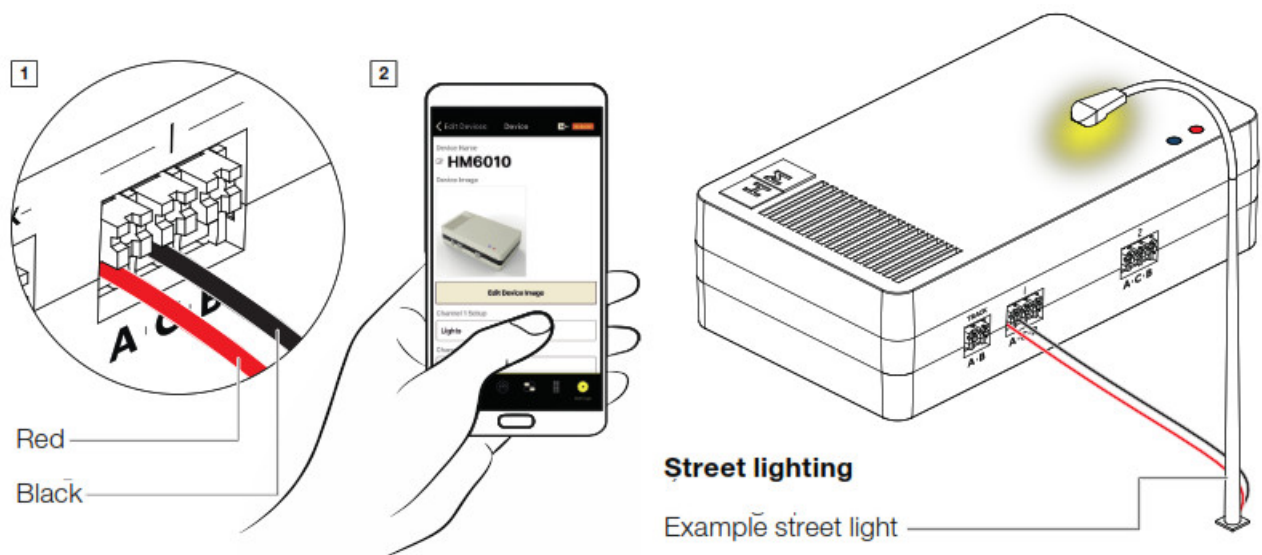

4. Motor-driven accessories

Wire in the colored wires from a motor-driven accessory, for example, a Hornby turntable (R070) as follows [1]: 'Red' to 'A'(+) & 'Black' to 'C'(common).

In the HM | DC app device settings, select the 'Turntable' option on Channel '4' Setup.

Motor-driven accessories can only be wired into channel/terminal '4'.

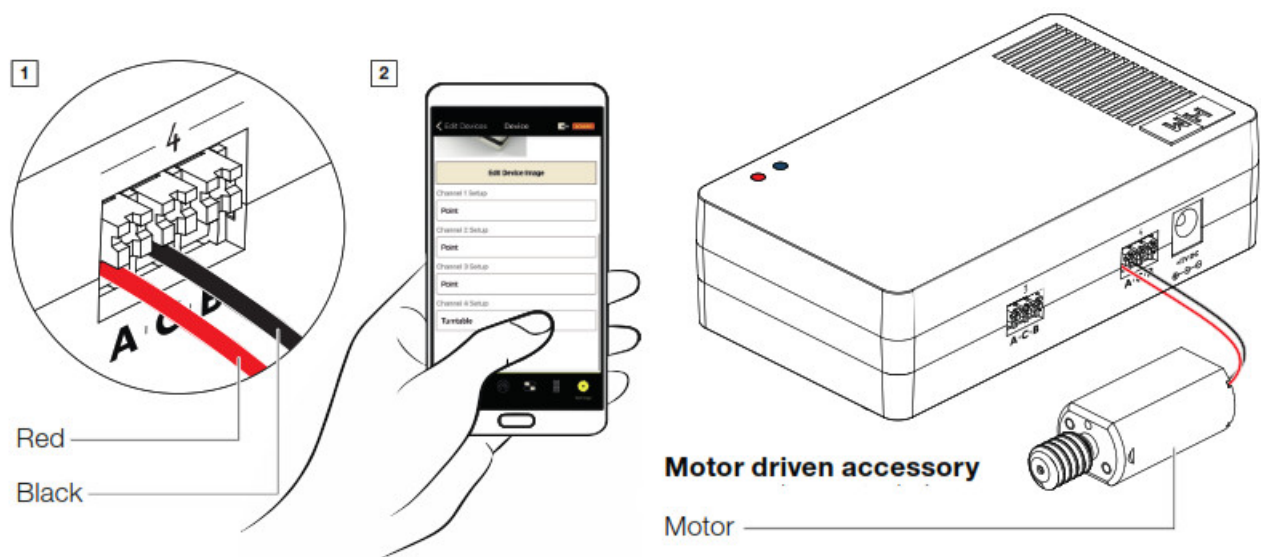

FCC Warning

This device complies with part 15 of the FCC Rules. Operation is subject to the following two conditions: (1) This device may not cause harmful interference, and (2) this device must accept any interference received, including interference that may cause undesired operation. Any changes or modifications not expressly approved by the party responsible for compliance could void the user's authority to operate the equipment.

This equipment has been tested and found to comply with the limits for a Class B digital device, pursuant to part 15 of the FCC Rules. These limits are designed to provide reasonable protection against harmful interference in a residential installation. This equipment generates uses and can radiate radio frequency energy and, if not installed and used in accordance with the instructions, may cause harmful interference to radio communications. However, there is no guarantee that interference will not occur in a particular installation. If this equipment does cause harmful interference to radio or television reception, which can be determined by turning the equipment off and on, the user is encouraged to try to correct the interference by one or more of the following measures:

- Reorient or relocate the receiving antenna.
- Increase the separation between the equipment and receiver.
- Connect the equipment into an outlet on a circuit different from that to which the receiver is connected.
- Consult the dealer or an experienced radio/TV technician for help.

The antenna(s) used for this transmitter must be installed to provide a separation distance of at least 20 cm from all persons and must not be collocated or operating in conjunction with any other antenna or transmitter, end-users must be provided with transmitter operation conditions for satisfying RF exposure compliance.

Canada Warning

This device complies with Industry Canada licence-exempt RSS standard(s).

Operation is subject to the following two conditions: (1) This device may not cause interference, and (2) This device must accept any interference, including interference that may cause undesired operation of the device.

The antenna(s) used for this transmitter must be installed to provide a separation distance of at least 20 cm from all persons and must not be collocated or operating in conjunction with any other antenna or transmitter, End-Users must be provided with transmitter operation conditions for satisfying RF exposure compliance.



www.hornby.com

Manufactured by:





HORNBY HOBBIES LTD

Westwood Industrial Estate,

Margate, Kent, CT9 4JX,
United Kingdom
+ 44(0)1843 233525
customerservices.uk@hornby.com

This instruction sheet or part thereof may not be copied, duplicated, amended, or circulated in any form whatsoever without written permission from Hornby Hobbies Ltd.

© Hornby Hobbies Ltd.

    
HM6000 - Quick Start Guide

Model: HM6000

FCC ID: 2ACUF-HM6000

IC: 12075A-HM6000

Documents / Resources

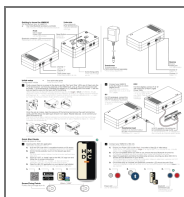

[HORNBY HOBBIES HM6010 BLE Model Accessory Controller](#) [pdf] User Guide
HM6010, 2ACUF-HM6010, 2ACUFHM6010, HM6010 BLE Model Accessory Controller, HM6010, BLE Model Accessory Controller

References

-  [Hornby UK - Model Railways, Train Sets, Locomotives & Accessories](#)