



HORNBACH BCMB03 Garbage Can Box Instruction Manual

[Home](#) » [HORNBACH](#) » **HORNBACH BCMB03 Garbage Can Box Instruction Manual** 

Contents

- [1 HORNBACH BCMB03 Garbage Can Box](#)
- [2 DIMENSION](#)
- [3 Before assembly](#)
- [4 PARTS AND TOOLS](#)
- [5 INSTALLATION](#)
- [6 Documents / Resources](#)
- [7 Related Posts](#)



HORNBACH BCMB03 Garbage Can Box

CITIBIN_ParcelDrop_Parcelbin_package_lockers-web_1600x

DIMENSION

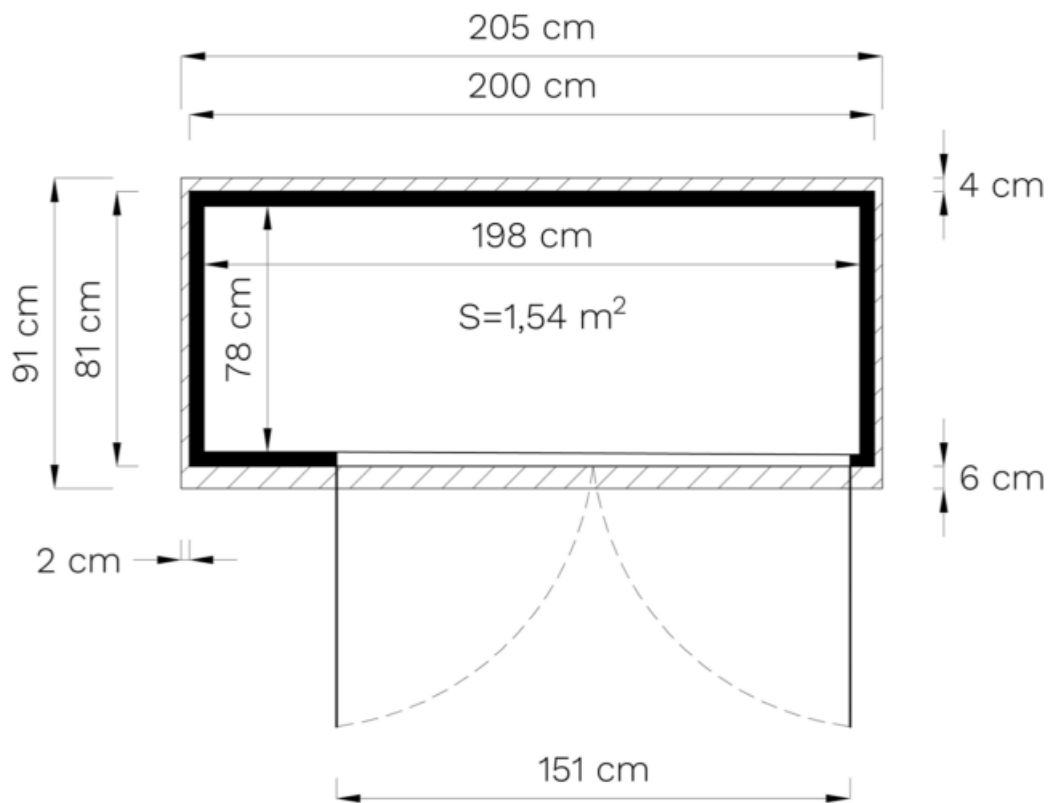

Before assembly

- We recommend that time is taken to read the assembly instructions prior to assembly.
- All assembly steps are shown – also in detailed images.
- The step-by-step instructions must be followed.
- Before assembly, please use the parts list to check that all components are accounted for and in good condition.
- Wood protection is particularly important! The floor elements must be treated from below with a suitable wood preservative before assembly!
- The data sheet, which is available online for most products, offers further important information for assembly.
- The guarantee conditions are also attached.

PARTS AND TOOLS

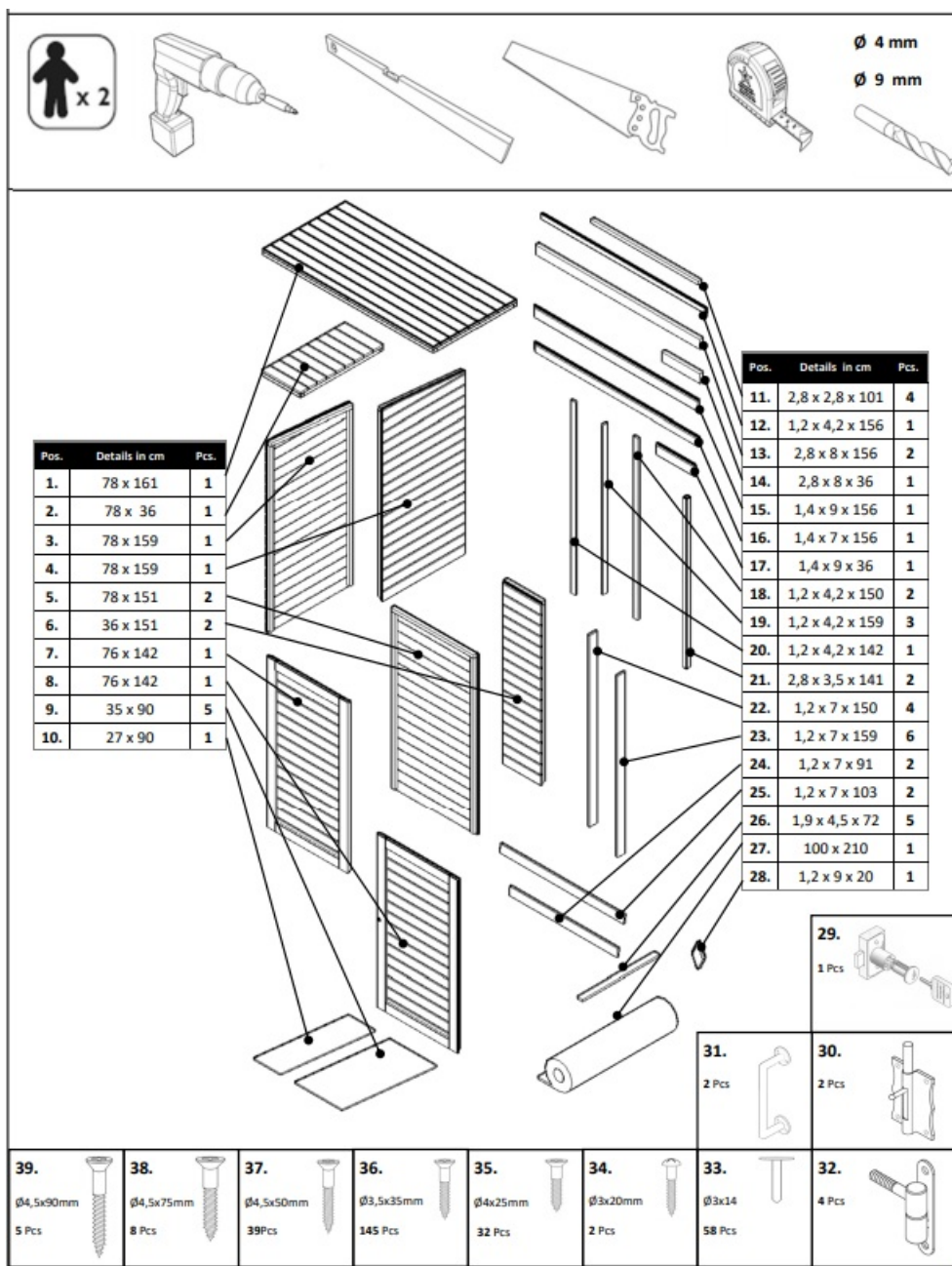

INSTALLATION

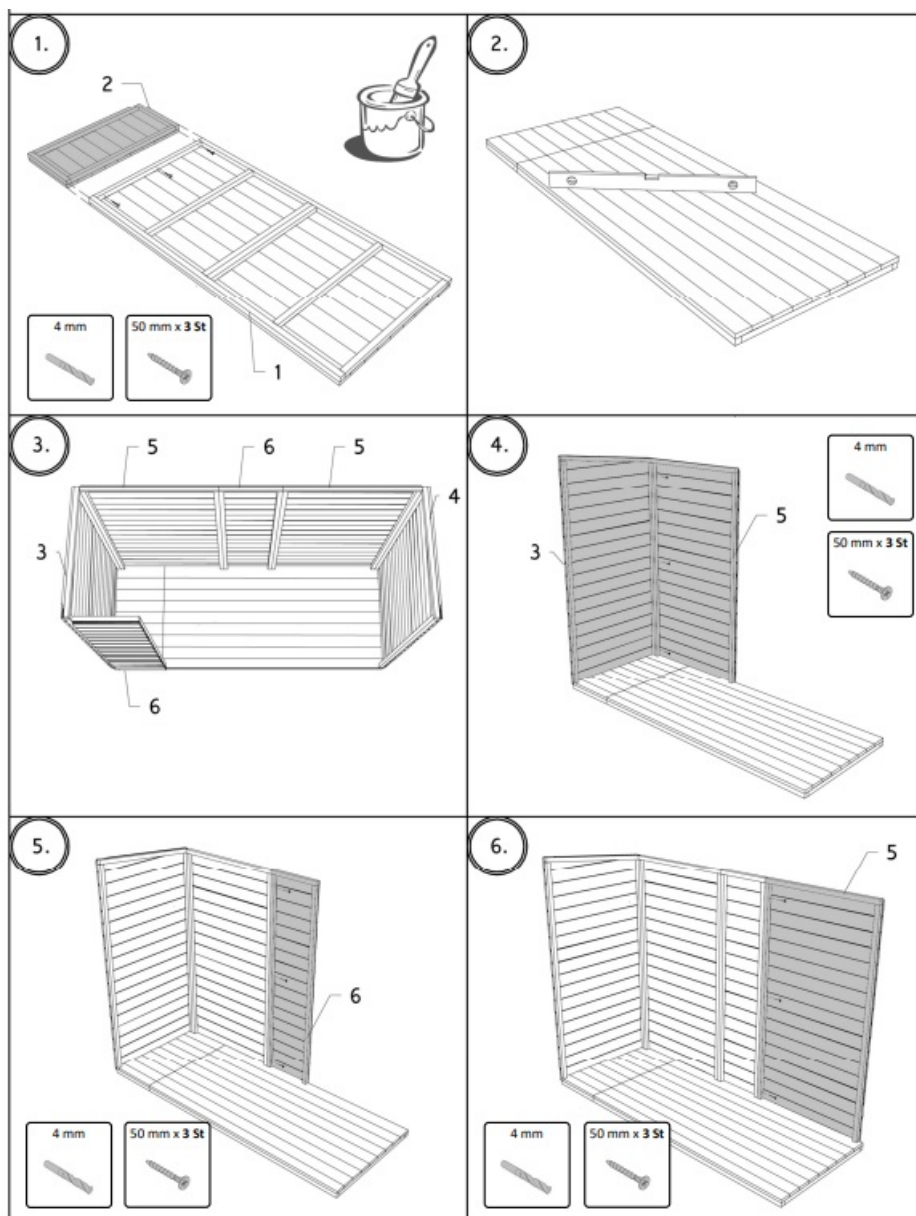

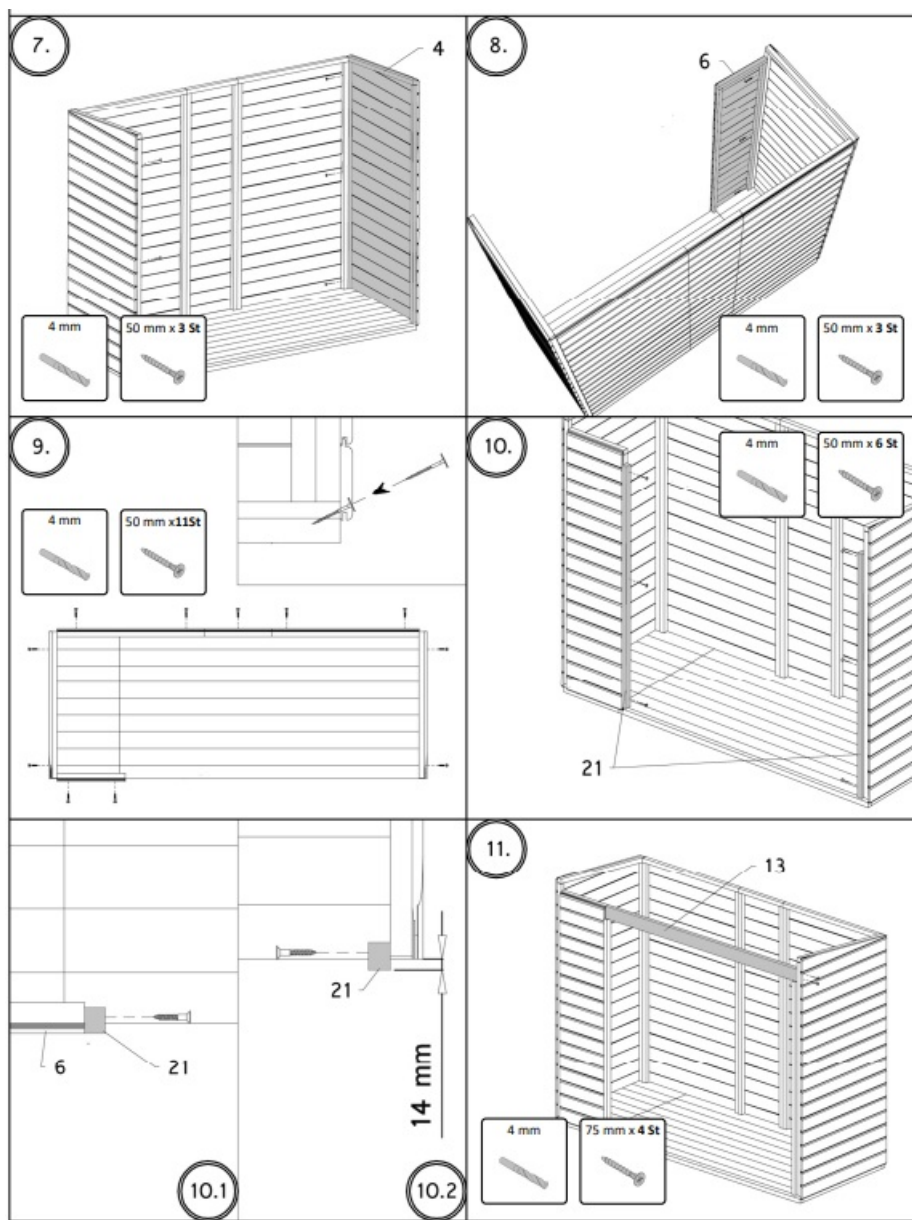

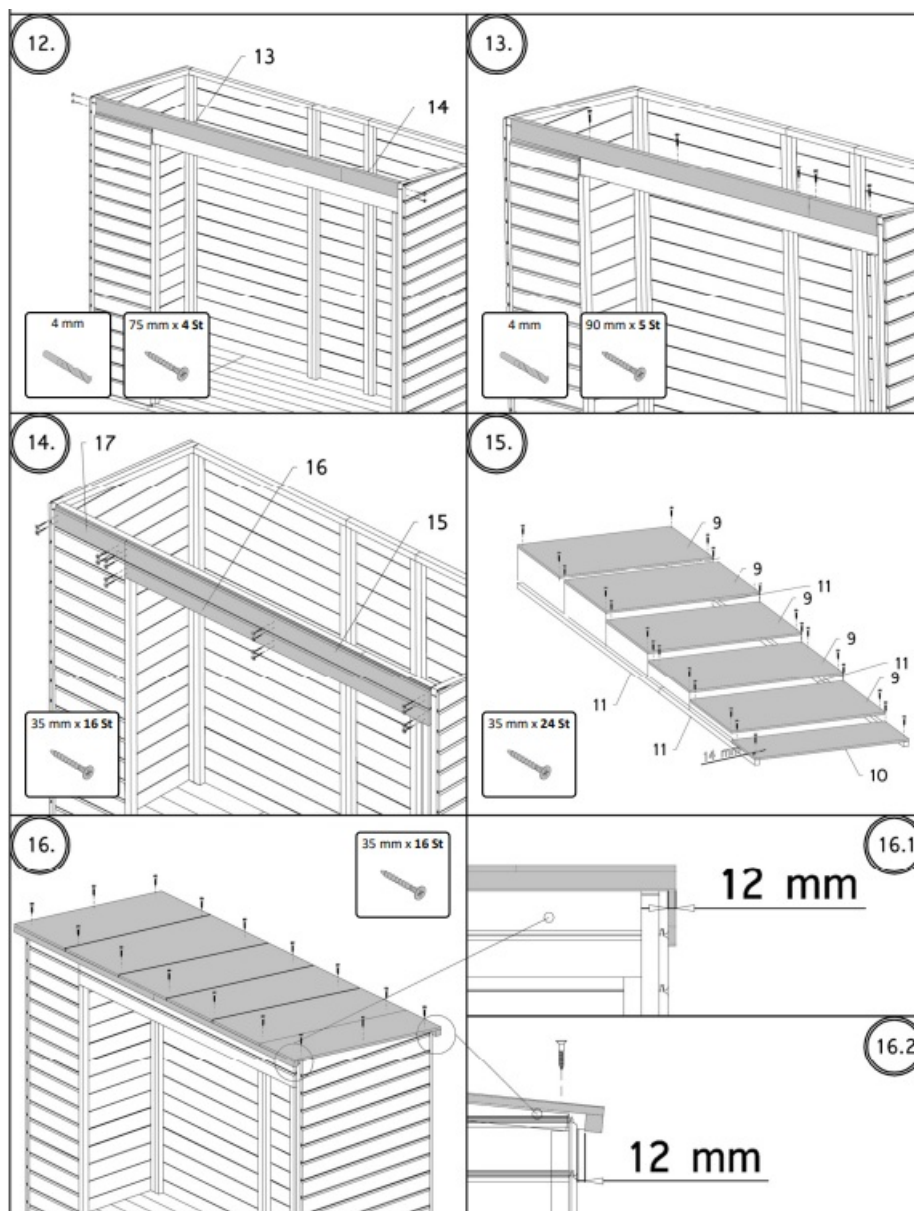

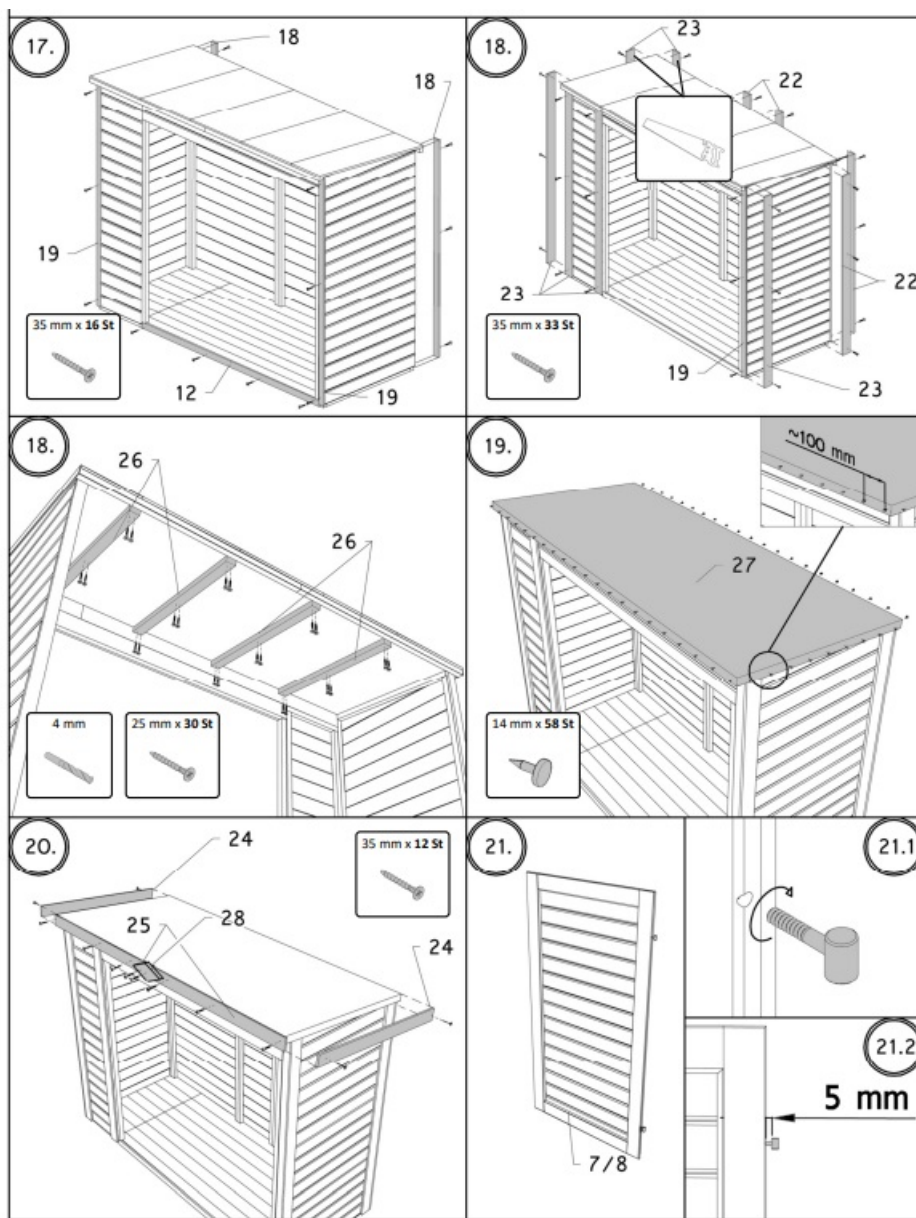

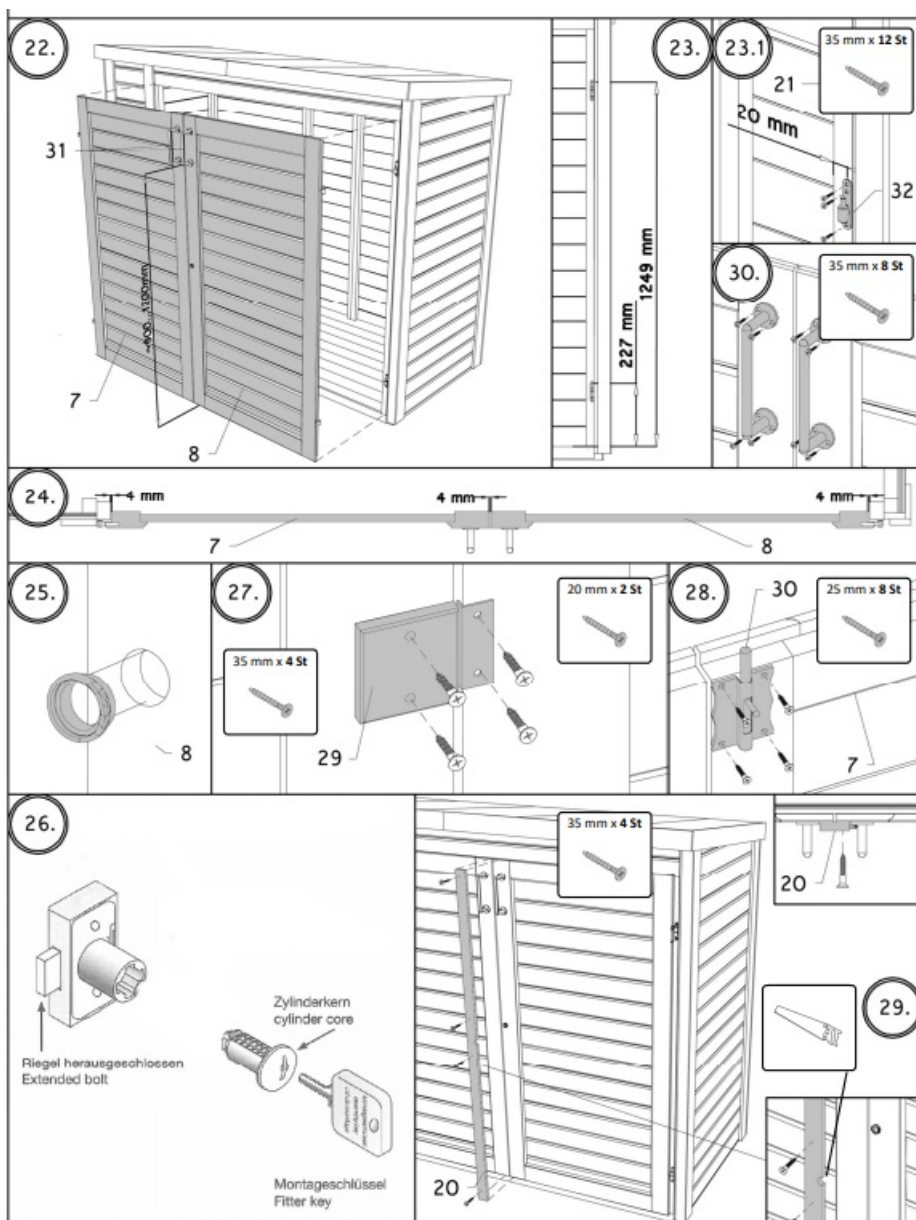

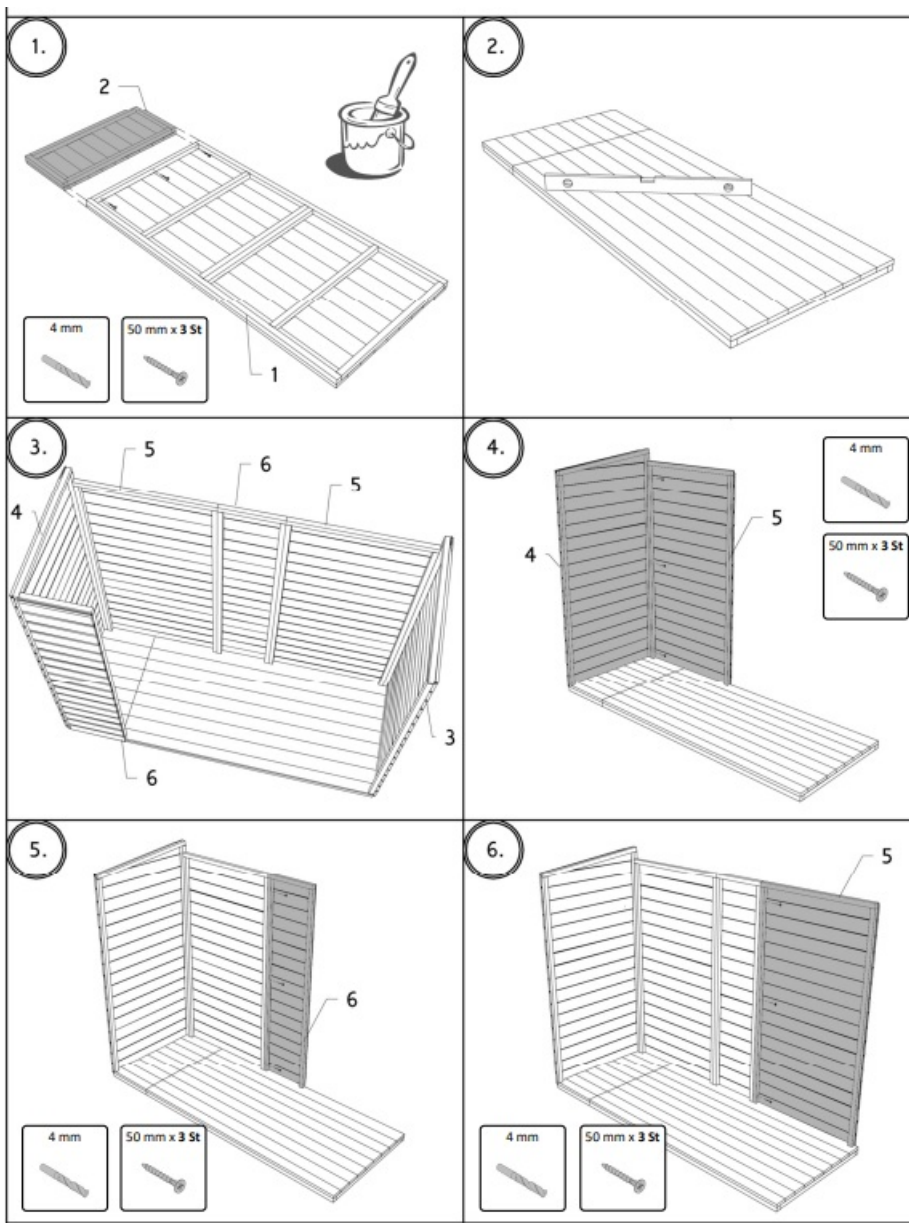

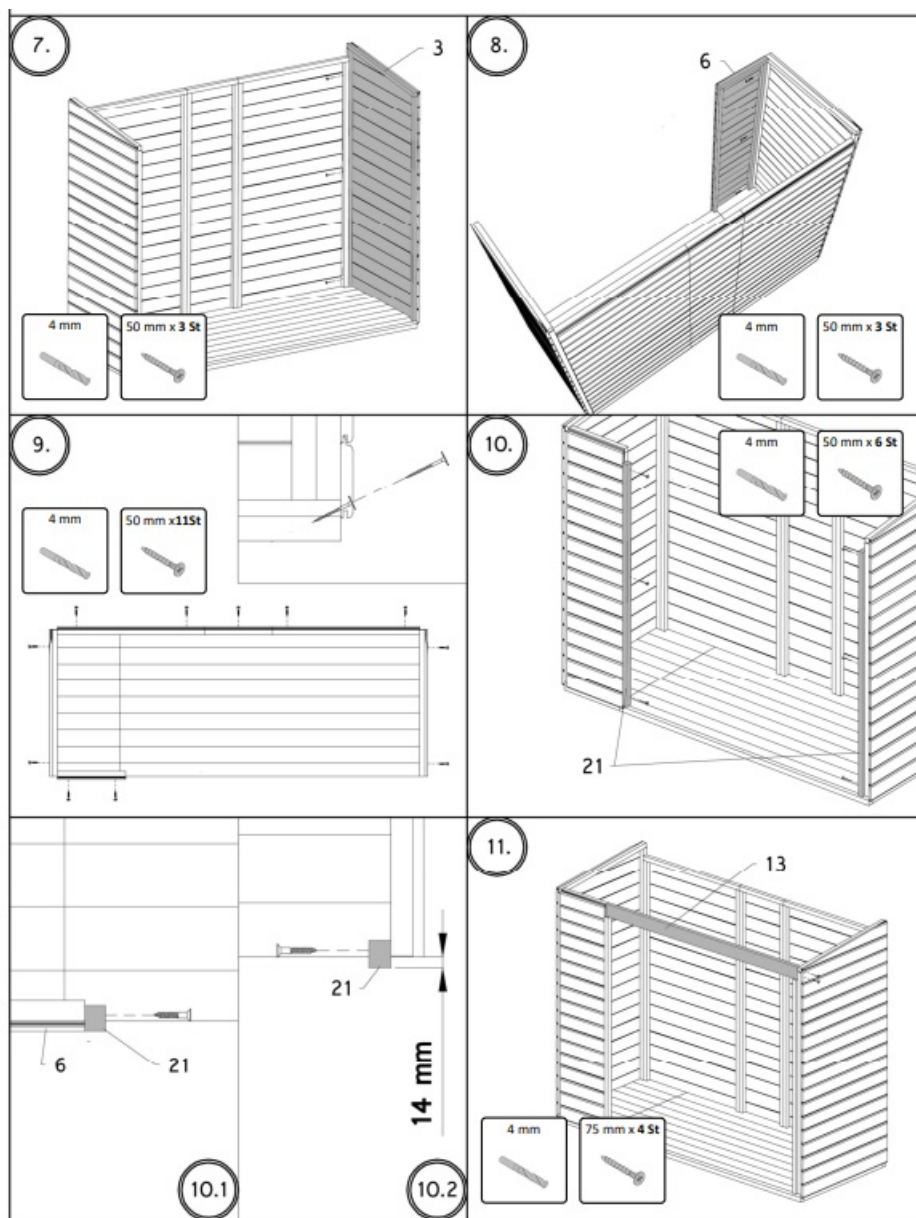

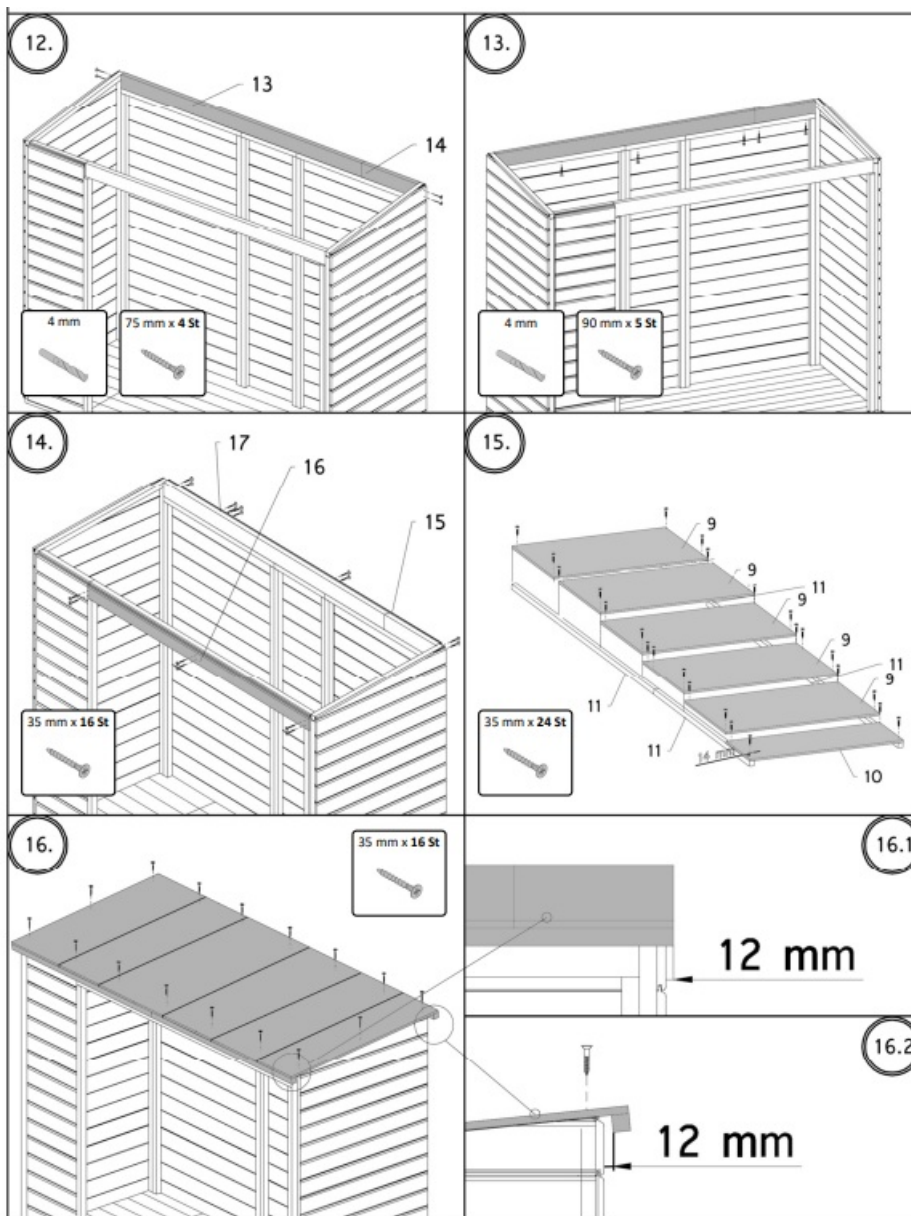

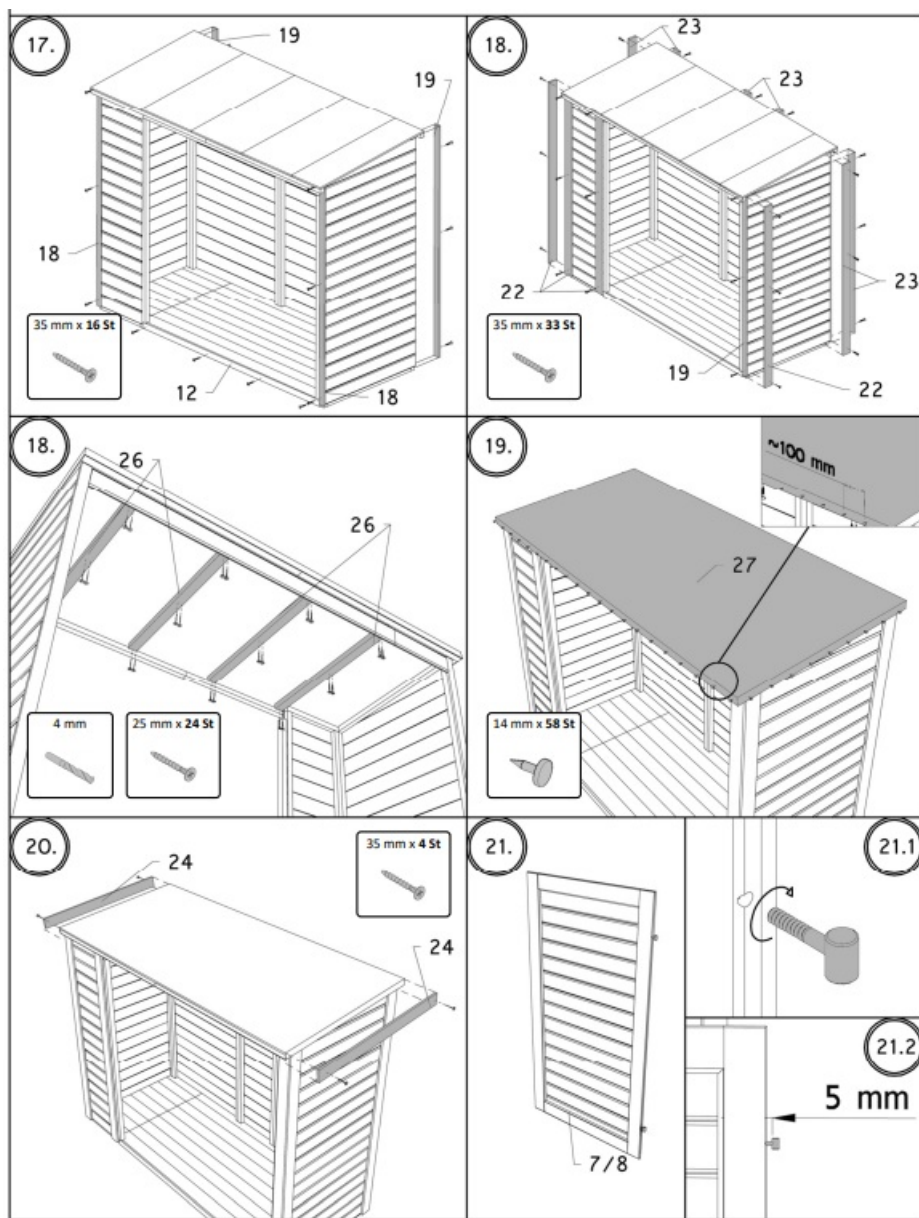

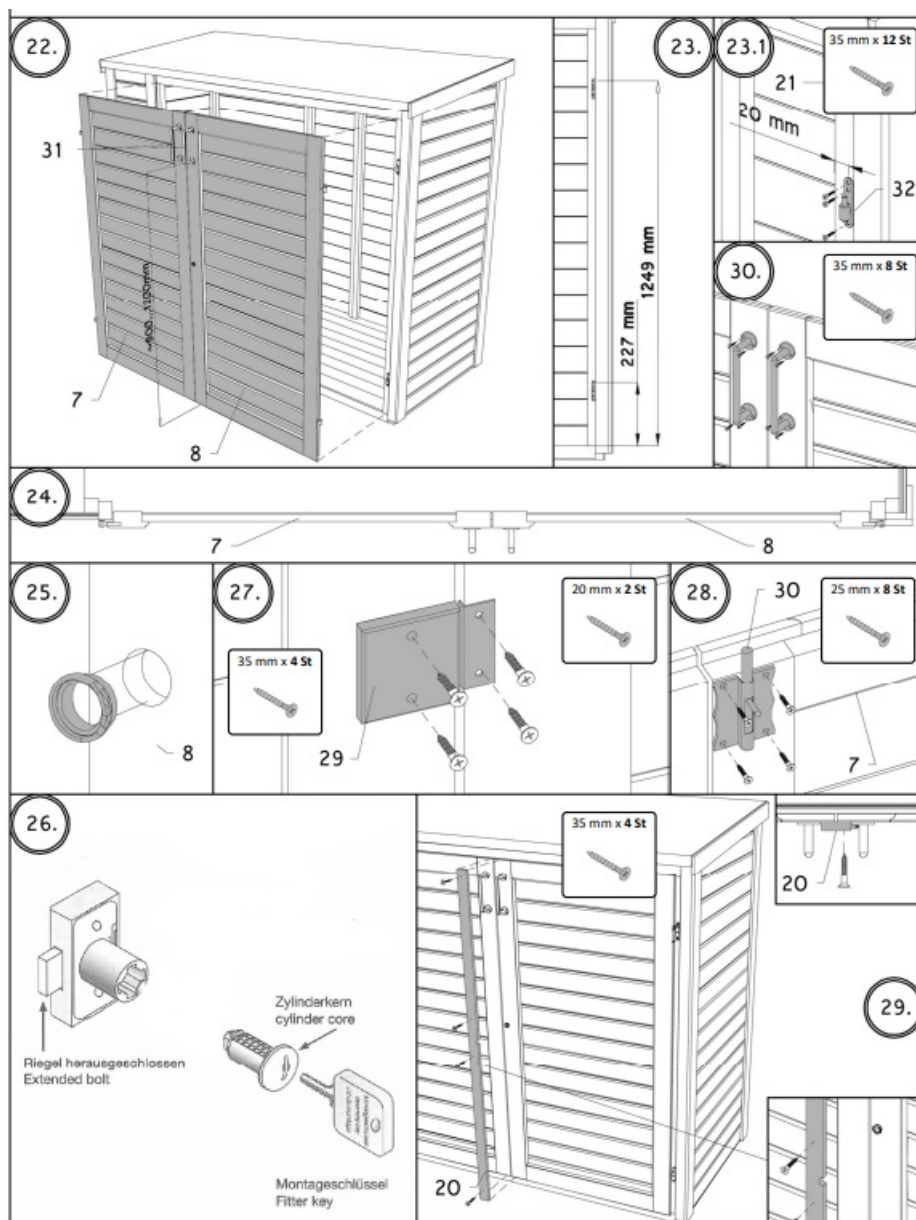



Baltic Connexions Oü Tabivere 49127, Tartumaa, Estonia www.BERTILO.com

Documents / Resources

	<p>HORNBAACH BCMB03 Garbage Can Box [pdf] Instruction Manual BCMB03 Garbage Can Box, BCMB03, Garbage Can Box, Can Box, Box</p>
--	---