

Contents [[hide](#)]

- [1 HORMANN HET-S24-BLE Bluetooth Receiver](#)
- [2 Safety instructions](#)
- [3 Description of the receiver](#)
- [4 Assembly](#)
- [5 Connection](#)
- [6 Initial start-up](#)
- [7 Operation](#)
- [8 Keys](#)
- [9 LED display and button](#)
- [10 Technical data](#)
- [11 EU Declaration of Conformity](#)
- [12 FAQ](#)
- [13 Documents / Resources](#)
 - [13.1 References](#)

HÖRMANN

HORMANN HET-S24-BLE Bluetooth Receiver

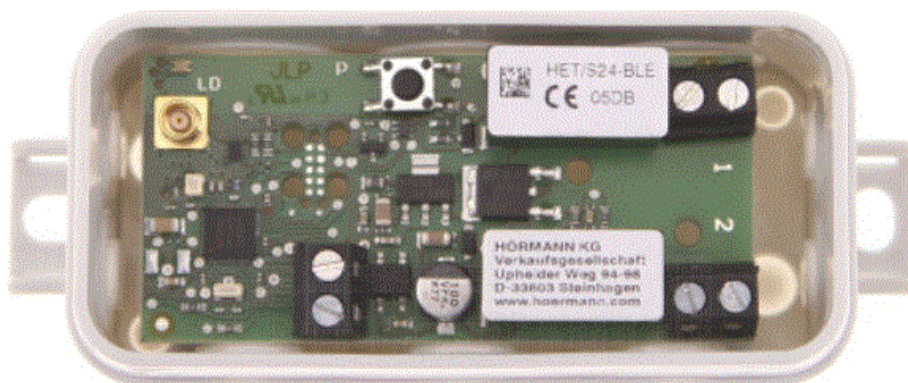

Dissemination as well as duplication of this document and the use and communication of its content are prohibited unless explicitly permitted. Noncompliance will result in damage compensation obligations. All rights reserved in the event of patent, utility model or design model registration. Subject to changes.

- App StoreSM is a brand of Apple Inc.
- GoogleTM Play is a brand of Google Inc.



Dear Customer,

We thank you for choosing a quality product from our company.

About these instructions

- Read through all of the instructions carefully, as they contain important information about the product. Pay attention to and follow the instructions provided, particularly the safety instructions and warnings.
- Further information about handling the Bluetooth receiver can be found on the Internet at www.hoermann.com.
- Please keep these instructions in a safe place and make sure that they are available to all users at all times.

Symbols Used

-  Factory setting
-  **Bluetooth[®]** The Bluetooth[®] word mark and logos are registered trademarks of Bluetooth SIG, Inc. and are used by Hörmann KG Verkaufsgesellschaft under license. Other trademarks and brand names are the property of their respective owners.

Safety instructions

Intended use

- The HET/S 24 BLE Bluetooth receiver is a bidirectional receiver. Door operators, motor locks or electric strikes can be operated via Bluetooth using the associated app on a

smartphone. The receiver has 2 volt-free relay outputs.

- Other types of application are prohibited. The manufacturer is not liable for damage caused by improper use or incorrect operation.

Safety instructions for operating the receiver

CAUTION

Danger of injuries due to unintended door travel

- Unintended door travel may occur while teaching in the radio code.
- Make sure that no persons or objects are in the door system's area of travel when teaching in the radio system.

ATTENTION

External voltage at the connecting terminals and relay outputs

- External voltage on the connecting terminals and relay outputs will destroy the electronics.
- Do not apply any mains voltage (230 / 240 V AC) to the connecting terminals and relay outputs.

ATTENTION

Functional impairment caused by environmental conditions

Non-compliance with these instructions can impair function! Protect the receiver from the following conditions:

- Direct sunlight (permissible ambient temperature: -20°C to $+60^{\circ}\text{C}$)
- Moisture
- Dust

NOTE

- If there is no separate entrance to the garage, then you should enhance or change the

radio system within the garage.

- If you want to start operating, enhance or change the radio system:
 - Perform a function check.
 - Only use original parts.
 - Local conditions may affect the range of the radio system.

Scope of delivery

- Bluetooth receiver HET/S 24 BLE in housing
- Connection cable 7 m, 4-wire
- Key card with QR code
- Operating instructions

Description of the receiver

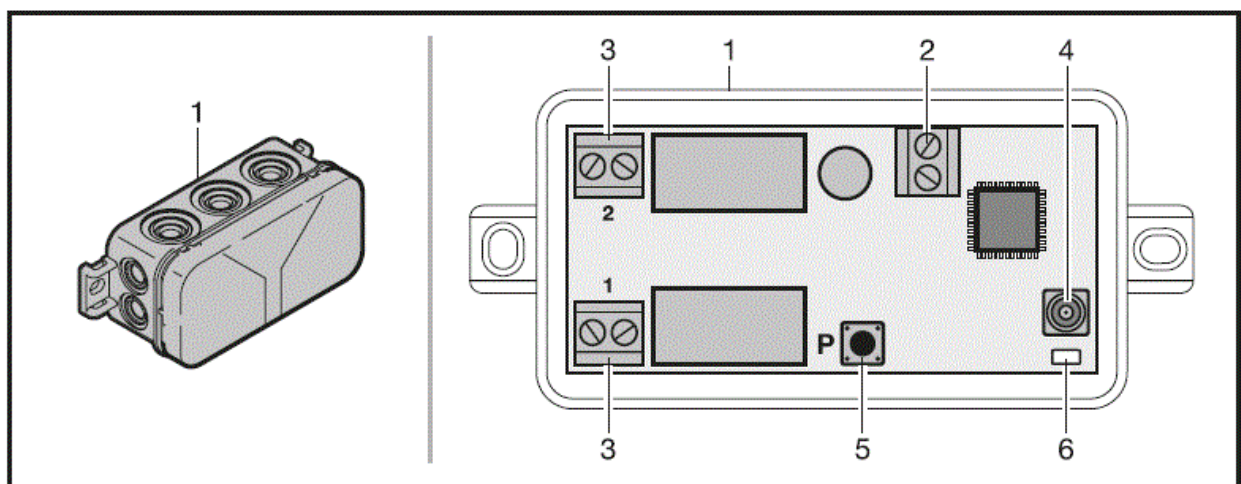

1. Receiver in housing
2. Connecting terminal for 12 V AC / 12 – 24 V DC power supply
3. Connecting terminal for volt-free relay outputs
4. Connection socket for external antenna
5. Programming button P (P button)
6. Double LED – blue / red (BU / RD)

Assembly

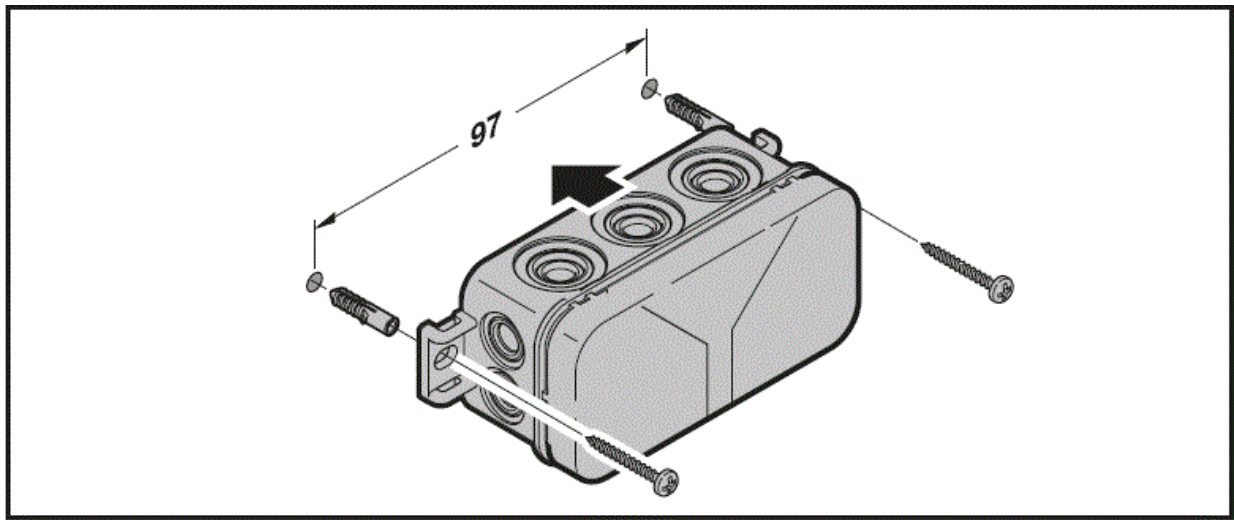

NOTE:

By selecting an appropriate fitting location, the range can be optimised. Determine the best orientation by trial and error.

Connection

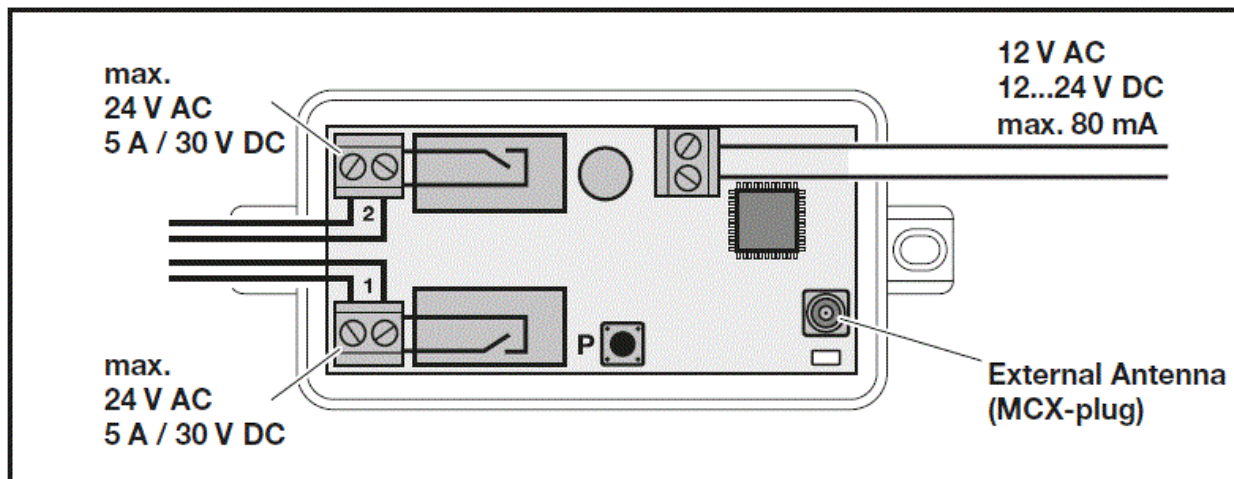

The starting procedure begins when the supply voltage is applied to the connecting terminals. The LED is continuously illuminated blue for at least 2 seconds, until the communication link is completely established. No functions are permitted at this time. The receiver is ready for operation as soon as the LED goes out.

Relay functions

Press and hold	<p>When a transmission impulse is received, the relay is activated for the preset duration and then deactivated. The duration of the transmission pulse is adjustable. The factory setting is 1 second.</p> 
Switching	<p>The relay is activated after the first transmission impulse. On the next one, it is deactivated.</p>



BlueSecur application (app)

- You can operate door operators, motor locks or electric strikes and manage access rights (keys) using your smartphone.
- The BlueSecur app is available free of charge in the App StoreSM or from GoogleTM Play.
- Install the BlueSecur app on your smartphone.

System requirements

Operating system		Software version
Android	Smartphone	from 5
iOS	Smartphone	from 9

App authorisations

In order to use the full functionality of the app, you must allow the following authorizations:

Camera	To scan the QR code.
Bluetooth	For the communication between app and receiver.
Location Android	For the Bluetooth function.

User roles

Admin	The first user who connects with the receiver via the QR code. One other admin can be added.
	Allocates access rights (keys) for users.
	Can delete access rights (keys) for users.
	Can adjust relay settings.
Users	Receive access rights (keys) from the admin.

App functions

You can select the impulse and push notification functions in the app. The factory setting is the impulse function.

Impulse

When the user is within range of the receiver, an impulse command can be triggered using the app, e.g. open or close.

Push notification

- The smartphone must allow push notifications for this function. The app must be active in the background. The push notification is displayed as a pop-up as soon as the user is within the range of the receiver from which a command can be triggered.
- You can activate or deactivate push notifications.

NOTE:

For Android smartphones, you may need to activate push notifications in the settings menu, depending on the software version.

Deleting devices

- If a door operator or motor lock is deleted in the app using the dustbin icon, you can no longer operate the device using the smartphone. However, the device is still saved in the receiver.
- When a device is to be removed from the receiver, perform a reset (see chapter 12).

NOTE

Performing a reset deletes all devices, keys, users and settings.

Backup

To avoid losing data, you can create a backup on the Hörmann server. Saved data can be accessed there at any time. To create a backup, you must first register.

All the following data existing up until this point in time will be saved:

- Devices (door operators, motor locks or electric strikes)
- Purchased sets of keys
- Distributed keys

A backup is necessary for restoring data, if, for example,

- the admin changes the smartphone,
- a reset is to be performed,
- if the smartphone is defective or lost.

A backup is strongly recommended to secure the data.

Initial start-up

The first user that connects with the receiver using the supplied QR code is the admin. This procedure can only be performed once!

1. Make sure that you are in range of the receiver and the receiver is fully connected.
2. Start the app.
3. Select the Teach in field (iOS) or the + symbol (Android).
The camera opens.
4. Scan the QR code on the supplied key card.

The first user is connected with the receiver as the admin.

5. Assign a name to the device.

The receiver is in operation mode.

Keep the key card in a safe place. The key card will be required if you need to set up the receiver again at a later stage.

Operation

- A connection to the receiver is always established exclusively through communication with the app, e.g. for triggering a command, adjusting settings in the app or user management.
- Only one smartphone can be connected to the receiver at a time. A connection takes approx. 1 second. Only after this can the next smartphone connect to the receiver.
- If the receiver detects a valid key, the LED illuminates. A command (open, close, etc.) will be triggered according to the preset relay function.

Relay 1 (channel 1)	LED is illuminated blue once
Relay 2 (channel 2)	LED is illuminated blue twice

Range

Range and performance are highly dependent on the smartphone.

For communication with the receiver, the admin or user must be in range to perform the following actions:

- Trigger a command (open, close, etc.)
- Set up and manage devices
- Delete devices
- Delete user authorisations
- Adjust relay settings
- Import 2nd admin key

Synchronizing

The date and time is synchronised in the receiver with each communication of the admin's smartphone with the receiver.

Power failure and power restoration

- In the case of power failure, the relay outputs open (the relay outputs are de-energized). Taught-in keys, user data and settings are saved in a power failure-proof manner.
- Once the power returns, the relay outputs remain open. This prevents triggering unintended door travel.

Loss of the smartphone

In the event that the smartphone is lost, unauthorised parties could have access to the door. In this event, reset the receiver (see chapter 12). This will delete all keys from the receiver and therefore also the access authorisations.

Keys

Purchasing sets of keys

- In order to distribute keys, the admin must purchase sets of keys using the in-app purchase function. Payment is made according to the App StoreSM or GoogleTM Play policies.
- One-time keys are free of charge.

Distributing keys

- The admin can distribute keys to users via all installed messaging services, e.g. e-mail, Facebook Messenger, iMessage, WhatsApp, etc.
- The admin can only distribute a key once to another admin. The 2nd admin must be in range of the receiver to import this admin key.
- The admin can distribute a maximum of 15 one-time keys simultaneously.

NOTE

The BlueSecur app must be installed on the smartphone to use the key. If users have not installed the app upon receiving a key, they will be directed to download it from the

App StoreSM or GoogleTM Play.

Key type	Validity
Admin key	Always valid
User key	Always valid or just for a defined time period
One-time key	Valid only once and within a maximum of 1 month

The admin has 2 options for defining the time of validity for one-time keys:

1. The one-time key is valid immediately and can be used just once, within 1 month.
2. The one-time key is valid from a defined date and can be used just once, within 1 month.

Safety when distributing keys

When the admin distributes a key to a user, for security reasons, the user must authenticate himself/herself using a PIN generated by the server. The user must enter this PIN before the key can be provided to him/her.

Reset

ATTENTION

- If a reset is performed, all purchased keys are also irretrievably deleted from the receiver. Using the backup function on the Hörmann server is the only way to ensure that all purchased sets of keys continue to be available.
- Create a backup before resetting the device (see chapter 8.6).

The following steps delete all devices, keys, users and settings on the receiver.

1. Switch the activated relay off.
2. Press and hold the P button.
 - The LED slowly flashes in blue for 5 seconds.
 - The LED flashes rapidly in blue for 2 seconds.

3. Release the P button.

All devices, keys, users and settings are deleted. The receiver is now back to its factory setting.

NOTE

If the P button is released prematurely, the reset is aborted. The devices, keys, users and settings are not deleted.

LED display and button

Blue (BU)

State	Function
Illuminated for at least 2 seconds	System start
Illuminated once	A valid key was discovered for channel 1.
Illuminated twice	A valid key was discovered for channel 2.
flashes quickly for 2 seconds	A valid key was discovered during the teach-in procedure.
Flashes slowly for 5 seconds, flashes quickly for 2 seconds	Reset is being performed or is complete.
Off	Operation mode

Red (RD)

State	Function
Illuminated once	An invalid key was discovered.

Off	Operation mode
-----	----------------

Button

P button	Reset
----------	-------

Error / access denied

If access is denied, it could be due to the following reasons:

- The key has expired.
- The receiver is de-energized.
- The receiver was previously de-energized.

If the receiver was previously de-energized, the admin must synchronise his or her smartphone with the receiver again (see chapter 10.2).

The following users may still be denied access before synchronization takes place:

- Users with one-time keys
- Users with a key restricted to a certain time period.

External antenna (optional)

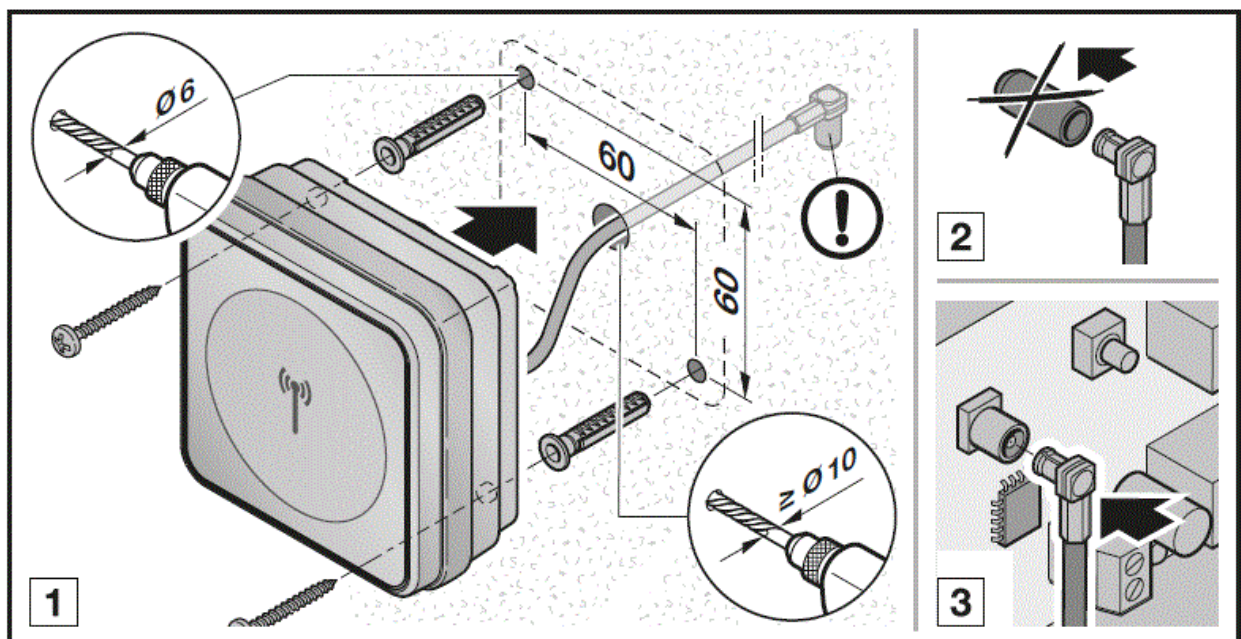

- An external antenna is recommended in the event of a limited range.
- The connection cable is 0.8 m long.
- You must configure an external antenna in the app settings. The factory setting is the internal antenna.



Disposal

Electrical and electronic devices, as well as batteries, must not be disposed of in household rubbish, but must be returned to the appropriate recycling facilities.

Technical data

- **Type Bluetooth receiver** HET/S 24BLE
- **Frequency** 2.45 GHz
- **External power supply** 12 V AC / 12 – 24 V DC
- **Perm. ambient temperature** –20°C to +60°C
- **Protection category** IP 44
- **Relay capacity** max. 24 V AC; 5 A / 30 V DC

EU Declaration of Conformity

Manufacturer Hörmann KG Verkaufsgesellschaft

- Address Upheider Weg 94-98
- 33803 Steinhagen
- Germany

The manufacturer above herewith declares under his sole responsibility that the product
Equipment/system Bluetooth receiver

- Model HET/S24-BLE
- Intended use Actuation of door operators, for example
- Transmission frequency, radiant power 2.45 GHz max. 10 mW (EIRP)
- Conforms to the respective essential requirements of the directives listed below with

intended use, on the basis of its design and type in the version marketed:

- 2014/53/EU (RED) EU Directive for Radio Equipment
- 2011/65/EU (RoHS) Restriction of the use of certain hazardous substances

Applied standards and specifications:

- EN 62368-1:2014 + AC:2015 Product safety (Article 3.1(a) of 2014/53/EU)
- EN62479:2010 Health (Article 3.1(a) of 2014/53/EU)

According to section 4.2 the product automatically complies with this standard, as the radiant power (EIRP), tested according to ETSI

- EN 300328, is lower than the low power exclusion level Pmax of 20 mW.
- EN 50581:2012 Restriction of the use of certain hazardous substances
- ETSI EN 301489-1 V2.2.0 Electromagnetic compatibility
- ETSI EN 301489-3 V2.1.1 (Article 3.1(b) of 2014/53/EU)
- ETSI EN 300328 V2.1.1 Efficient use of the radio spectrum (Article 3.2 of 2014/53/EU)

Any modifications made to the product without approval will invalidate this declaration.

- Steinhagen, 12.06.2018



- Axel Becker
- Management

FAQ

What are the system requirements for the BlueSecur App?

The BlueSecur App is compatible with Android smartphones running OS version 5 and above, as well as iOS smartphones running version 9 and above.

How do I reset the Bluetooth receiver to factory settings?



Refer to the manual for instructions on resetting the Bluetooth receiver to factory settings.

Documents / Resources

	HORMANN HET-S24-BLE Bluetooth Receiver [pdf] Instruction Manual HET-S24-BLE Bluetooth Receiver, HET-S24-BLE, Bluetooth Receiver, Receiver
---	--

References

- [User Manual](#)

 Bluetooth Receiver, HET-S24-BLE, HET-S24-BLE Bluetooth Receiver, HORMANN,  HORMANN Receiver

Leave a comment

Your email address will not be published. Required fields are marked *

Comment *

Name

Email

Website

☐ Save my name, email, and website in this browser for the next time I comment.

Post Comment

Search:

e.g. whirlpool wrf535swhz

Search

[Manuals+](#) | [Upload](#) | [Deep Search](#) | [Privacy Policy](#) | [@manuals.plus](#) | [YouTube](#)

This website is an independent publication and is neither affiliated with nor endorsed by any of the trademark owners. The "Bluetooth®" word mark and logos are registered trademarks owned by Bluetooth SIG, Inc. The "Wi-Fi®" word mark and logos are registered trademarks owned by the Wi-Fi Alliance. Any use of these marks on this website does not imply any affiliation with or endorsement.