

HORMANN 4552998 Wi-Fi Internal Push Button Gateway User Guide

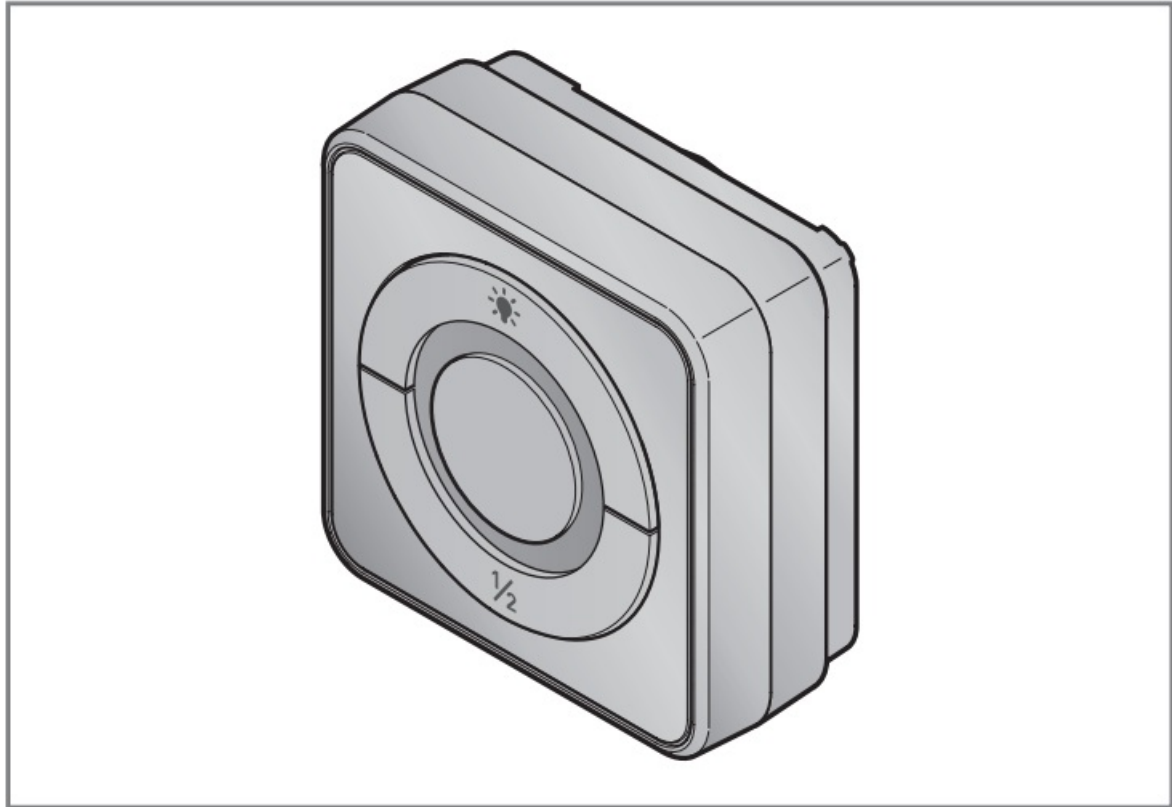

Contents

1	Instructions for fitting and operating
1.1	1 About these instructions
1.2	2 Safety instructions
1.2.1	2.1 Intended use
1.2.2	2.2 Symbols used
1.2.3	2.3 Safety instructions for operation
1.3	3 Scope of delivery
1.4	4 Product overview (see figure [1])
1.5	5 Fitting and Installation (see figure [2])
1.6	6 Home Applikation (App)
1.6.1	6.1 System requirements
1.7	7 Initial start-up
1.7.1	7.1 Home App set up
1.7.2	7.2 Setting up other services
1.8	8 Operation
1.9	9 Reset
1.10	10 Status display
1.10.1	10.1 Definition of flash frequencies
1.11	11 Cleaning
1.12	12 Disposal
1.13	13 Technical data
1.14	14 Legal notices
1.15	15 EU Declaration of Conformity
1.16	16 UK Declaration of Conformity
2	Documents / Resources
2.1	References
3	Related Posts

Instructions for fitting and operating

WiFi internal push button gateway

4553103 B0 / 03-2023

HÖRMANN

1 About these instructions

This instruction is divided into a text section and an illustrated section. It contains important information on the product, and especially safety instructions and warnings.

- Read through the instructions carefully.
- Keep these instructions in a safe place.

NOTICE

- Observe all specifications, standards and safety regulations applicable at the location where the WiFi internal push button gateway is installed.
- Only use the WiFi internal push button gateway in dry rooms.

Dissemination as well as duplication of this document and the use and communication of its content are prohibited unless explicitly permitted. Noncompliance will result in damage compensation obligations. All rights reserved in the event of patent, utility model or design model registration. Subject to changes.

2 Safety instructions

2.1 Intended use

The WiFi internal push button gateway is a button for operators. In conjunction with the Apple HomeKit and/or a voice assistant, it can control door travel.

You will find the compatibility overview at:



www.hoermann-docs.com/229817

2.2 Symbols used



The Works with Apple HomeKit word mark and logos are registered trademarks of Apple Inc. and are used by Hörmann KG Verkaufsgesellschaft under licence. Other trademarks and brand names are the property of their respective owners.



The Wi-Fi-CERTIFIED™ logo is a certification mark of the Wi-Fi Alliance® and is used by Hörmann KG Verkaufsgesellschaft under licence. Other trademarks and brand names are the property of their respective owners.



Google is a brand of Google LLC

Amazon, Alexa and all other corresponding logos are brands of Amazon.com, Inc. or its associated companies.

2.3 Safety instructions for operation

To avoid putting the operational safety of the system at risk, a cyber security analysis of the connected IT components must be performed by the user before initial start-up.



WARNING

Risk of injury during intended or unintended door run

- Make sure that the WiFi internal push button gateway is kept away from children!
- Make sure that the WiFi internal push button gateway is only used by people who have been instructed on how the remote-control system functions.
- Automation or control of an automatic door system without view of the door is permitted if a photocell has been installed on the door in addition to the standard power limit.
- Drive or walk through the door openings only when the door is in the OPEN end-of-travel position!
- Never stand in the door's area of travel.
- Ensure that the remote-controlled operation of devices does not result in danger to persons or objects. Cover these risks with safety equipment.
- Note that accidentally pressing a button on the WiFi internal push button gateway can result in a door run.
- Observe the manufacturer information for the remote-controlled devices.

ATTENTION

External voltage at the connecting terminals

External voltage at the connecting terminals will destroy the electronics.

- Do not apply any mains voltage (230 / 240 V AC) to the connecting terminals.

Functional impairment caused by effects of the environment

High temperatures and water impair the function of the WLAN internal push button gateway. Protect the device from the following factors:

- Direct sunlight
- Moisture
- Dust

3 Scope of delivery

- WiFi internal push button gateway
- Brief instructions
- Fitting accessories
- System cable (1 × 7 m)
- HomeKit code

Optional: HCP adapter

4 Product overview (see figure [1])

- | | |
|---|------------------------------|
| (1) Housing WLAN internal push button gateway | (2) Ring illumination, white |
| (3) Connection socket (BUS) | (4) Seal |
| (5) Reset button | (6) LED, green |

(7) Control buttons

5 Fitting and Installation (see figure [2])

The choice of the fitting location affects the range.

- Prior to fitting, verify that the WLAN signal can reach the selected fitting site in the garage.
- Make sure that your smartphone has at least two bars.
 - Determine the best orientation, by trial and error, if required.

6 Home Applikation (App)

Communication between iPhone, iPad, or iPod touch and the HomeKit-enabled WiFi internal push button gateway is secured by HomeKit technology.

You can control your door operators with the Home app. In addition to controlling your door, the app shows you the door position.

NOTICE

Please note that not every service is available in every country

6.1 System requirements

Access from home

iOS device	Software version
iPhone, iPad or iPod touch	From iOS 11.3

iCloud remote access

iOS device	Software version
HomePod, Apple TV	From tvOS 11.3
iPad	From iOS 11.3

7 Initial start-up

7.1 Home App set up

Before setting up the device, confirm the following:

- The device is connected to the operator, the ring illumination is flashing 6 ×
- The iPhone is connected to the WLAN router

A BUS scan may be required depending on the operator type. Please see the operator or control instructions for information.

7.1.1 Adding devices

1. Open the Home app.
2. Select '**Add device**'.
3. Follow the steps in the user interface.
4. Coupling the Home app with the WLAN may take up to 1 minute.

NOTE

The WiFi internal push button gateway is already connected to a voice assistant.

- Press and hold the reset button for 5 seconds until the ring illumination flashes quickly and then goes out. Release the Reset button. The device is in WAC mode as soon as the LED flashes 6 ×.

7.1.2 Additional applications

You can also actuate the WLAN internal push button gateway while on the go. To do so, you need:

- HomePod from tvOS 11.3
- Apple TV from tvOS 11.3
- iPad from iOS 11.3

7.2 Setting up other services

To set up the voice control via the Google Home app, Google Assistant or the Amazon Alexa app, follow the instructions for the corresponding services.

1. Register at: <https://cd.hoermann.com>
2. Press and hold the reset button for 2 seconds to set up.
3. Wait until the LED flashes 2 ×. The device is now in set up mode.
4. Follow the instructions in the user interface.
5. Activate the Google service / Amazon Skill Hörmann door

- a. The PIN required for the Google service can be found in your Hörmann Cloud user account. This is assigned individually for each Hörmann gateway.

8 Operation

Manual operation is done using the control buttons

Impulse button	Impulse sequence control (open-stop-close-stop-open...)
	Operator light
1/2	Partial opening

9 Reset

There are two different options for resetting the device:

1. Resetting the WLAN connection

- Open the housing.
- Press the Reset button.
- Keep the Reset button pressed until the ring illumination flashes quickly.
- Release the Reset button.
- The WLAN connection is reset.

2. Resetting to the factory setting

- Open the housing.
- Press the Reset button.
- Keep the Reset button pressed until the ring illumination flashes quickly and then goes out.
- The device has now been reset to the factory setting.
- Remove the device from the Home app.

NOTICE

If the Reset button is released prematurely, the device reset is aborted. The WLAN connection is not reset. The device is not reset to the factory setting.

10 Status display

The green LED indicates the status of the WLAN internal push button gateway. The white ring illumination identifies information and errors.

Green (GN)

Display type	Notice
Continuously illuminated	Internal push button is connected to the operator and supplied with power
Not illuminated	Internal push button is not connected to the operator
	Internal push button is not supplied with power <ul style="list-style-type: none"> • Check whether the operator is connected to the mains • Check whether the system cable is defective

White (WH)

Display type	Interval	Note / error
Continuously illuminated	–	Connection established to WLAN router
Flashes slowly with pause	1 ×	Connection established to operator
	2 ×	Set up mode started (Onboarding)
	3 ×	No connection established to WLAN router
	4 ×	Poor WiFi connection
	5 ×	Identifying
	6 ×	WAC-mode
	7 ×	HCP error

10.1 Definition of flash frequencies

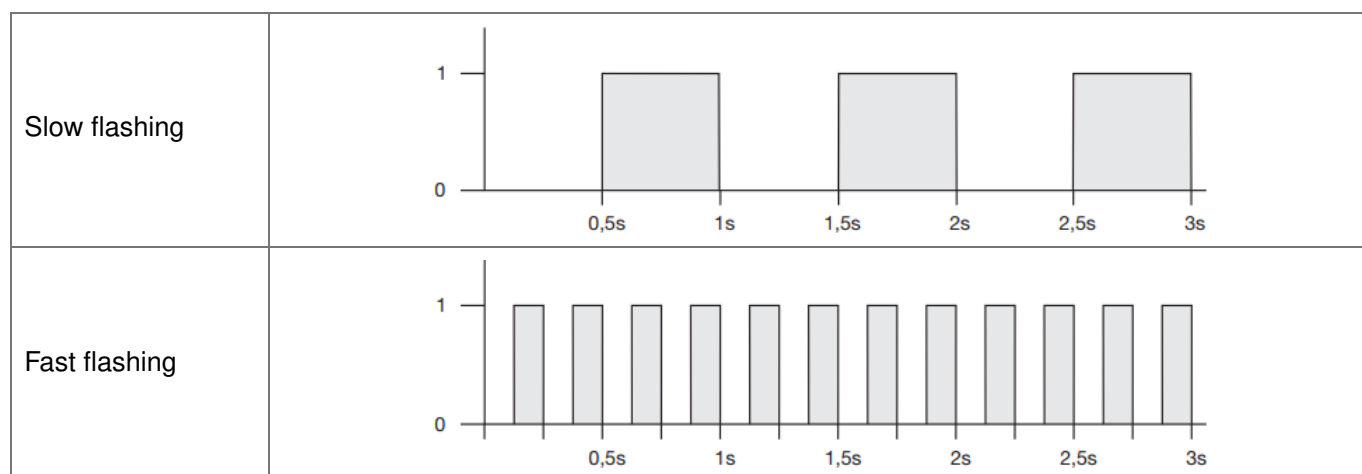

11 Cleaning

ATTENTION
Damage to the WLAN internal push button gateway through improper cleaning <ul style="list-style-type: none"> Clean the internal push button gateway with a clean and soft cloth.

NOTICE

Cleaning the WLAN internal push button gateway with unsuitable cleaning agents can damage the surface.

12 Disposal



Dispose of the packaging sorted by materials



Electrical and electronic devices must be returned to the appropriate recycling facilities.

13 Technical data

WiFi internal push button gateway

Model	IT-WiFi-Gateway
Frequency	2.400...2.483,5 MHz
Transmitting power	Max. 100 mW (EIRP)
Supply voltage	24 V DC
Perm. ambient temperature	– 20°C to + 60°C
Maximum humidity	93%, non-condensing
Protection category	IP 20
System cable	7 m
Dimensions (W × H × D)	80 × 80 × 35,6 mm

14 Legal notices

© 2019 Apple Inc. All rights reserved. Apple, the Apple logo, Apple TV, Apple Watch, iPad, iPad Air, iPad mini, iPhone, iPod, iPod touch, iTunes, Mac, and Siri are trademarks of Apple Inc., registered in the U.S. and other countries. HomeKit, HomePod, Multi-Touch, and tvOS are trademarks of Apple Inc.

Use of the Works with Apple HomeKit badge means that an electronic accessory has been designed to connect specifically to iPod touch, iPhone, or iPad, respectively, and has been certified by the developer to meet Apple performance standards. Apple is not responsible for the operation of this device or its compliance with safety and regulatory standards.

The Wi-Fi CERTIFIED™ Logo is a certification mark of Wi-Fi Alliance®.

Amazon, Alexa and all other corresponding logos are brands of [Amazon.com](https://www.amazon.com), Inc. or its associated companies.

Google is a brand of Google LLC.

15 EU Declaration of Conformity

Manufacturer Hörmann KG Verkaufsgesellschaft
Address Upheider Weg 94-98
33803 Steinhagen
Germany



The manufacturer above herewith declares under his sole responsibility that the product

Device	WiFi internal push button gateway
Model	IT-WiFi-Gateway
Intended use	WiFi internal push button gateway for actuating door operators
Transmitting frequency band	2400...2483.5 MHz
Radiant power	Max. 100 mW (EIRP)

conforms to the respective essential requirements of the directives listed below with intended use, on the basis of its style and type in the version marketed by us:

2014/53/EU (RED)	EU Directive for Radio Equipment
2015/863/EU (RoHS)	Restriction of the use of certain hazardous substances

Applied standards and specifications

EN 62368-1:2014 + AC:2015 + A11:2017	Product safety (Article 3.1(a) of 2014/53/EU)
EN 62311:2008	Health (Article 3.1(a) of 2014/53/EU)
EN 301489-1 V2.2.3	Electromagnetic compatibility (Article 3.1(b) of 2014/53/EU)
EN 301489-17 V3.2.2 (draft)	
EN 300328 V2.2.2	Efficient use of the radio spectrum (Article 3.2 of 2014/53/EU)
EN IEC 63000:2018	Restriction of the use of certain hazardous substances

Any modification made to this device without our express permission and approval shall render this declaration null and void.

Steinhagen, 14.06.2021



Axel Becker
Management

16 UK Declaration of Conformity

Manufacturer Hörmann UK Ltd.
Address Gee Road
Coalville
LE67 4JW
GB-Leicestershire



The manufacturer above herewith declares under his sole responsibility that the product

Device	WiFi internal push button gateway
Model	IT-WiFi-Gateway
Intended use	WiFi internal push button gateway for actuating door operators
Transmitting frequency band	2400...2483.5 MHz
Radiated power	Max. 100 mW (EIRP)

conforms to the respective essential requirements of the UK regulations listed below with intended use, on the basis of its style and type in the version marketed by us:

2017 No. 1206	UK Radio Equipment Regulations 2017
2012 No. 3032	UK Restriction of the use of certain Hazardous Substances 2012

Applied standards and specifications

EN 62368-1:2014 + AC:2015 + A11:2017	Product safety (Article 6.1(a) of 2017 No. 1206)
EN 62311:2008	Health (Article 6.1(a) of 2017 No. 1206)
EN 301489-1 V2.2.3	Electromagnetic compatibility (Article 6.1(b) of 2017 No. 1206)
EN 301489-17 V3.2.2 (draft)	
EN 300328 V2.2.2	Efficient use of the radio spectrum (Article 6.2 of 2017 No. 1206)
EN IEC 63000:2018	Restriction of the use of certain hazardous substances

Any modification made to this device without our express permission and approval shall render this declaration null and void.

Coalville, 14.06.2021



Wolfgang Gorner
Managing Director

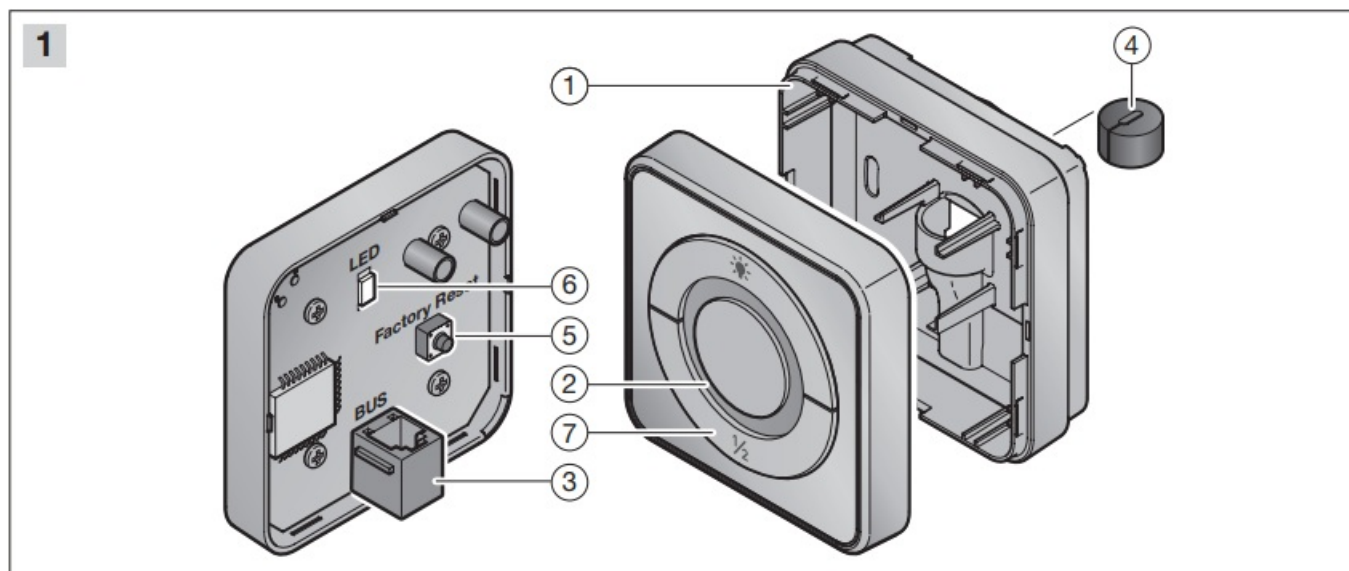

2

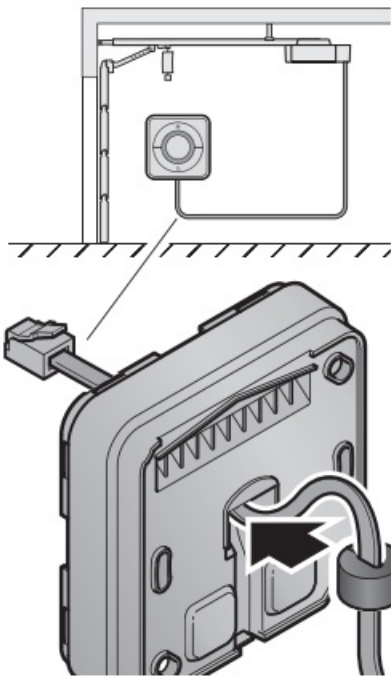

1



TOP

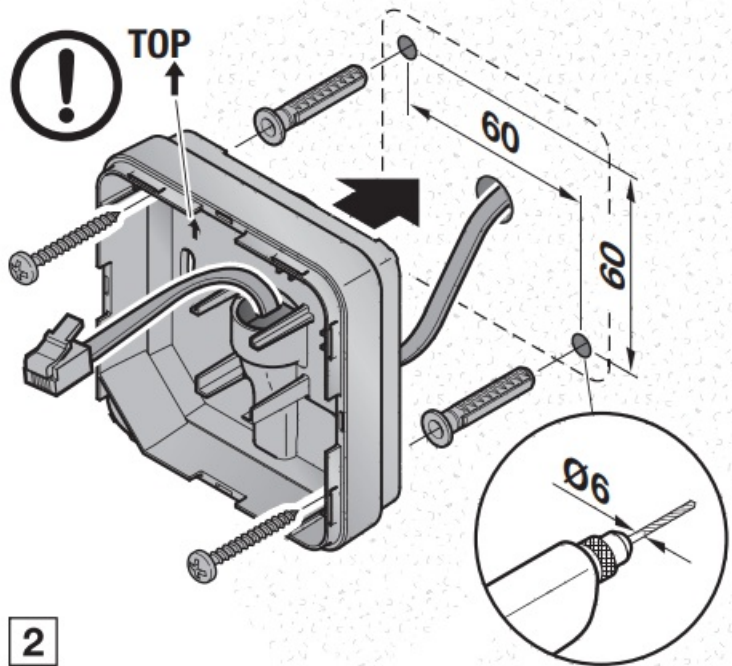

2

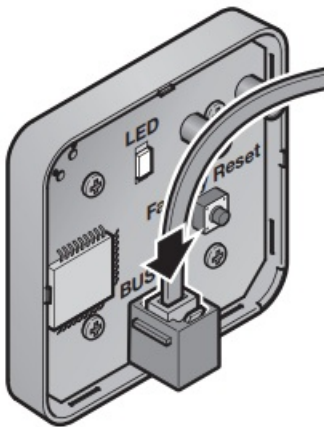

3

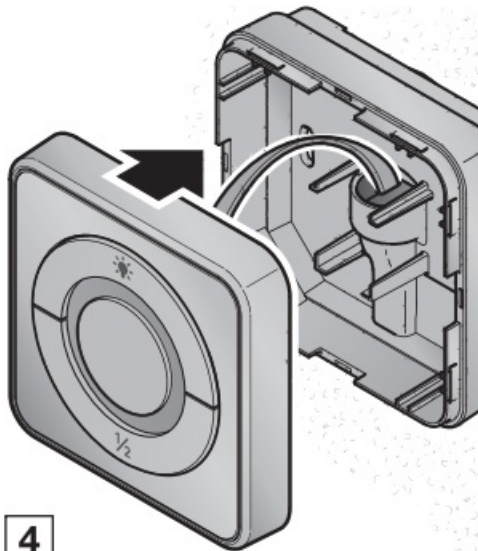

4



5

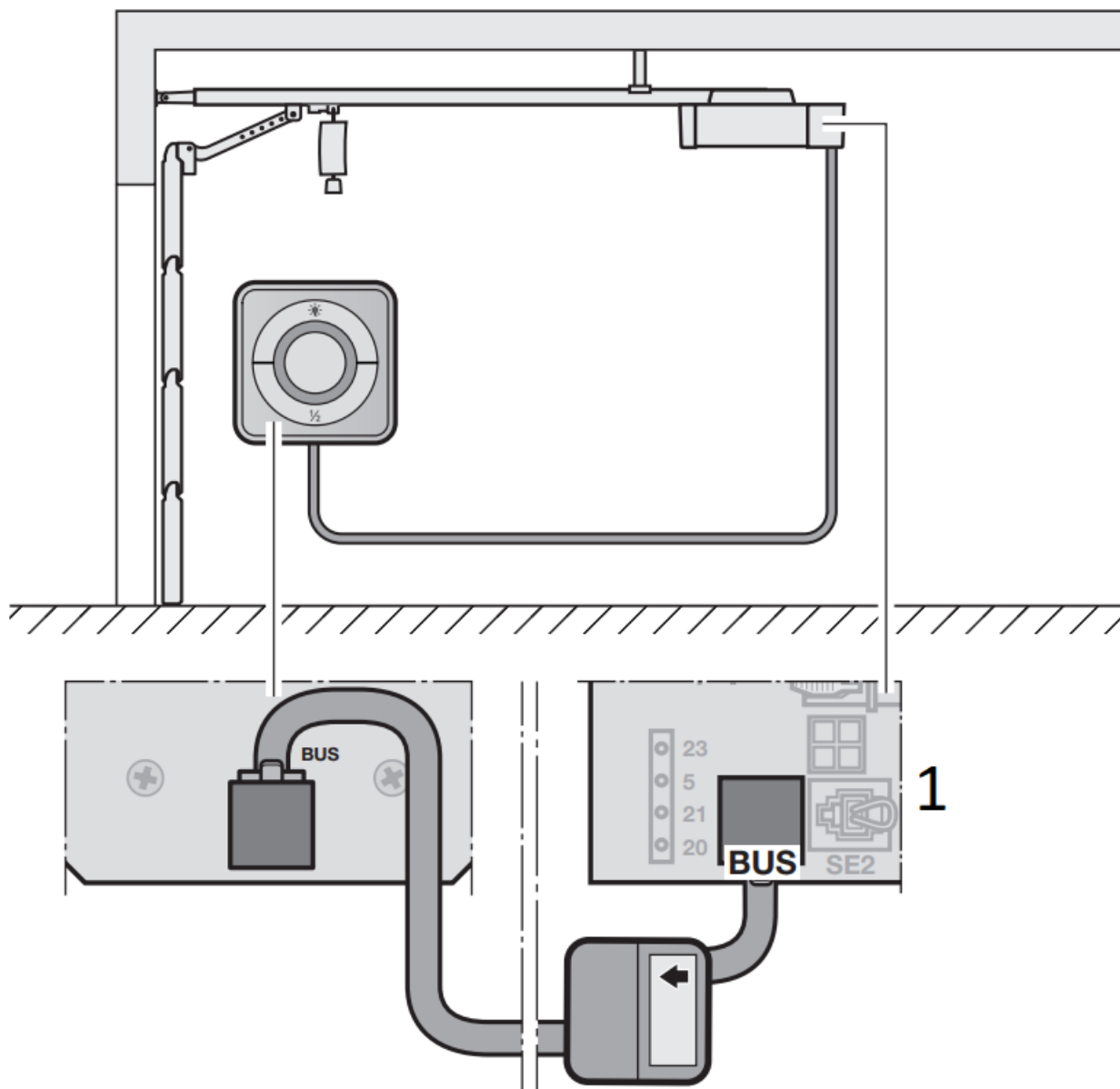

6

1. SupraMatic 4
ProMatic 4

4553103 B0 / 03-2023

HÖRMANN

WLAN – Gateway

Hörmann KG Verkaufsgesellschaft
Upheider Weg 94-98
33803 Steinhagen
Deutschland







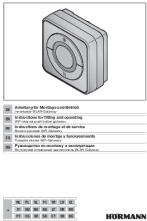





4553103 B0

Documents / Resources



[HORMANN 4552998 Wi-Fi Internal Push Button Gateway](#) [pdf] User Guide
4552998 Wi-Fi Internal Push Button Gateway, 4552998, Wi-Fi Internal Push Button Gateway, In
ternal Push Button Gateway, Push Button Gateway, Button Gateway, Gateway

References

-  [. Spend less. Smile more.](#)
-  [HOE-WM-2c Pantone](#)
-  [hoermann-docs.com/229817](#)
-  [hoermann-docs.com/230803](#)
-  [hoermann-docs.com/231683](#)
-  [hoermann-docs.com/231684](#)
-  [hoermann-docs.com/233627](#)
-  [hoermann-docs.com/240736](#)
-  [Hörmann Voice Assisstant](#)
-  [Tore, Türen, Zargen und Antriebe | Hoermann](#)
- [User Manual](#)