

HORI HPC-044U Force Feedback Truck Control System



HORI HPC-044U Force Feedback Truck Control System Instruction Manual

[Home](#) » [HORI](#) » HORI HPC-044U Force Feedback Truck Control System Instruction Manual 

Contents

- [1 HORI HPC-044U Force Feedback Truck Control System](#)
- [2 Product Information](#)
- [3 Product Usage Instructions](#)
- [4 FAQs](#)
- [5 Quick Start Guide](#)
- [6 Contents](#)
- [7 Compatibility](#)
- [8 Layout and Feature](#)
- [9 Mounting Instructions](#)
- [10 How to Connect](#)
- [11 Download App](#)
- [12 Specifications](#)
- [13 Documents / Resources](#)
 - [13.1 References](#)



HORI HPC-044U Force Feedback Truck Control System



Product Information

- **Specifications**

- **Product Name:** HORI Force Feedback Truck Control System
- **Compatibility:** Windows PC
- **Input Method:** DirectInput
- **System Requirements:** USB-A Port

Product Usage Instructions

- **Mounting Instructions**

- To mount the steering unit, shifter, and foot pedal:
- Place them on a flat, stable surface.
- Refer to the manual for specific mounting instructions for a table or racing wheel stand.

- **Connection Guidelines**

- Connect all cables as follows:
- Modular Cable
- AC Adapter
- Power Cable
- USB Cable to your PC

- **Safety Precautions**

- Read and follow these cautions:
- Avoid placing fingers near foot pedals during gameplay.
- Avoid putting hands or arms close to the rotating base of the steering wheel.

- **Parents/Guardians Note**

- If issues persist, refer to the manual for troubleshooting steps. Do not use the product for purposes other than intended.

FAQs

- **Q: What software is compatible with this product?**
 - **A:** Compatible software information can be found at [this link](#).
- **Q: How can I install the latest driver for this product?**
 - **A:** Download and install the latest dedicated driver from [this link](#).

Please make sure to install the latest dedicated driver to your PC before using this product.
<https://stores.horiusa.com/hpc-044U/app/>.



Quick Start Guide

Please make sure to install the latest dedicated driver to your PC before using this product.
<https://stores.horiusa.com/hpc-044U/app/>.



1. Mount the steering unit, shifter, and foot pedal onto a flat, stable surface.

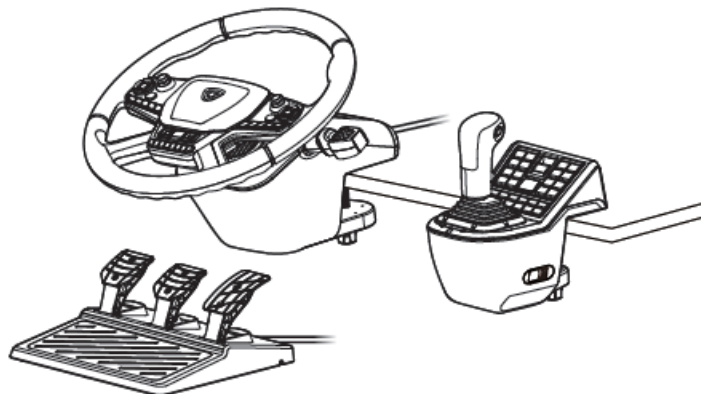

2. Connect all of the cables accordingly.

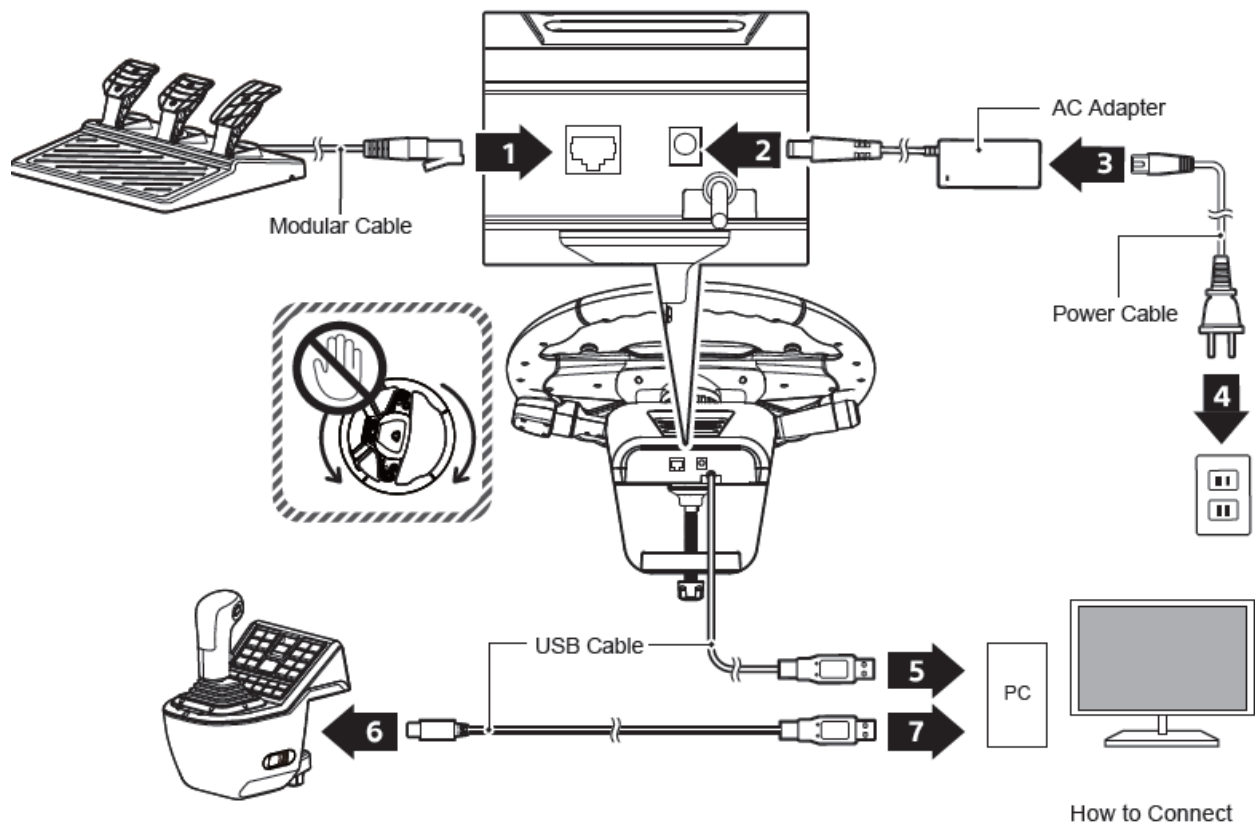

Caution

Please read the following information carefully.

- Only use the included AC adapter and power cable.
- Do not plug the AC adapter and power cable into an outlet with incorrect voltage.
- Do not use the AC adapter or power cable if it is damaged, frayed, or broken.
- Ensure that the AC adapter and power cable are completely plugged into the outlet.
- Unplug the AC adapter and power cable from the outlet when the product is not in use.
- Do not block the air vents of the steering wheel unit.
- Keep the steering wheel at least 4 inches (10 cm) away from the wall.
- Keep the air vents of the steering wheel unit clear of dust.
- Avoid long gameplay and try to take a 10 – 15 minute break every hour.
- If your hands, wrists, feet, or other parts of your body feel tired or sore, stop playing the game and take a break for few hours.
- If symptoms continue, stop gameplay and consult your doctor.
- Keep your fingers away from the foot pedals during gameplay.
- Do not place your hands or arms near the rotating base of the steering wheel during gameplay.

Parents / Guardians: Please read the following information carefully.

- This product contains small parts. Keep away from children under 3 years old.
- Keep this product away from small children or infants. Seek medical attention immediately if any small parts are swallowed.
- Long cord. Strangulation hazard.

- Keep the product away from dusty or humid areas.
- Do not use this product if it has been damaged or modified.
- Do not cover the product with cloth. Doing so may cause overheating.
- Please do not touch with wet hands. This may cause electric shock.
- Do not use this product when there is a risk of a lightning storm to avoid fire, electric shock, or malfunction.
- Do not get this product wet. This may cause an electric shock or malfunction.
- Do not place this product near heat sources or leave it under direct sunlight for an extended period.
Overheating may cause malfunction.
- Do not use this product with a USB hub or extension cable. The product may not function properly.
- Do not insert the USB plug into socket outlets.
- Do not touch the metal parts of the USB plug.
- Do not apply strong impact or weight on the product.
- Do not pull roughly or bend the cable of the product.
- Do not disassemble, modify or attempt to repair this product.
- If the product needs cleaning, use only a soft dry cloth. Do not use any chemical agents like benzene or thinner.
- The packaging must be retained since it contains important information.
- Please retain this instruction manual for your future reference.
- The normal function of the product may be disturbed by strong electromagnetic interference. If so, simply reset the product to resume normal operation by following the instruction manual (How to Connect). In case the function does not resume, please relocate to an area that does not have electromagnetic interference to use the product.
- Do not use this product for anything other than its intended purpose. We are not responsible for any accidents or damages in the event of use other than the intended purpose.

Contents



Steering Unit × 1



Shifter × 1



Foot Pedal × 1



USB Cable
(USB-A to USB-C™) × 1

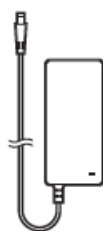

AC Adapter × 1

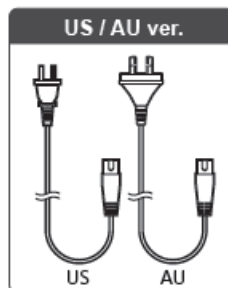

Power Cable (2 types) × 2

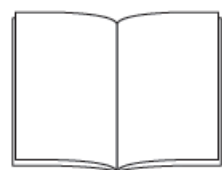
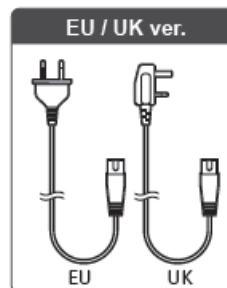

Instruction Manual × 1

Compatibility

PC (DirectInput)

Supported OS	Windows®11 / 10
Input Method	DirectInput*
System Requirements	USB-A Port

Functions as PC controller through DirectInput. This product does not support XInput.

Layout and Feature

Layout and Feature Steering Unit / Foot Pedal

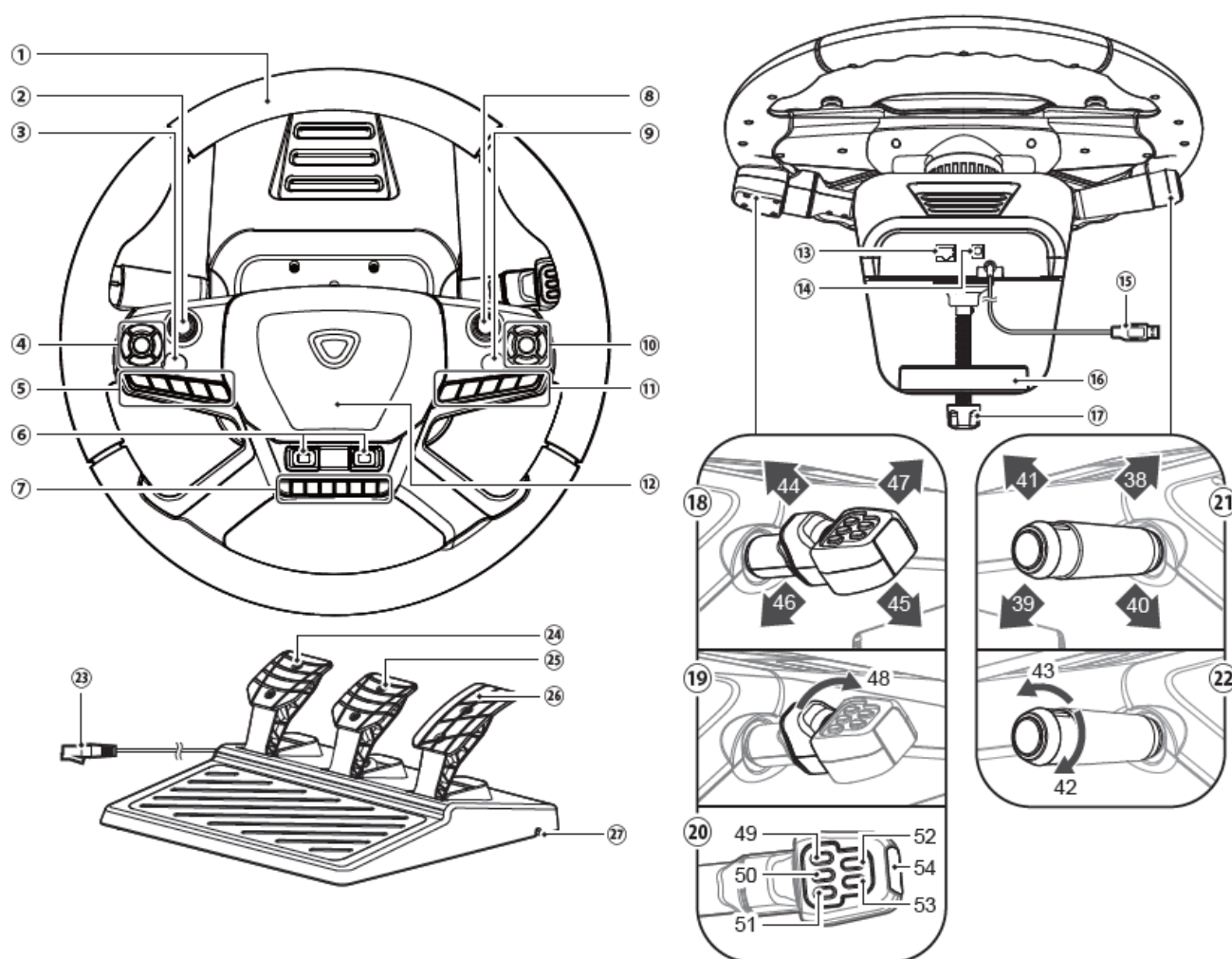

• Steering Unit

1. Steering wheel
2. L Stick (Button 8)
3. Button 10
4. Steering Button B (Directional buttons, Button 6)
5. Steering Button D (Button 12 – 16)
6. Steering Button E (Button 22 – 29)

7. Steering Button F (Button 30 – 37)
8. R Stick (Button 9)
9. Button 11
10. Steering Button A (Button 1 – 5)
11. Steering Button C (Button 17 – 21)
12. Horn Button (Button 7)

Steering Unit (Back View)

13. Foot Pedal Connection
14. AC Adapter Connection
15. USB-A Connector
16. Clamp
17. Screw
18. R Lever (Button 44 – 47)
19. R Lever (Button 48)
20. R Lever Button (Button 49 – 54)
21. L Lever (Button 38 – 41)
22. L Lever (Button 42 – 43)

Foot Pedal

23. Modular Plug
24. Clutch Pedal
25. L Pedal
26. R Pedal
27. Cable Groove

Slide the foot pedal cable through any of the three grooves on the bottom of the foot pedal.

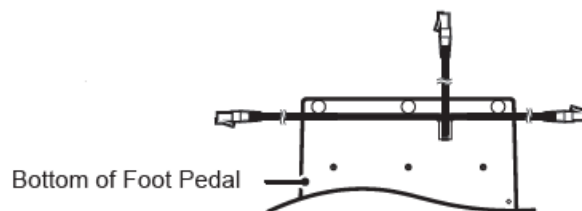

Layout and Feature Shifter

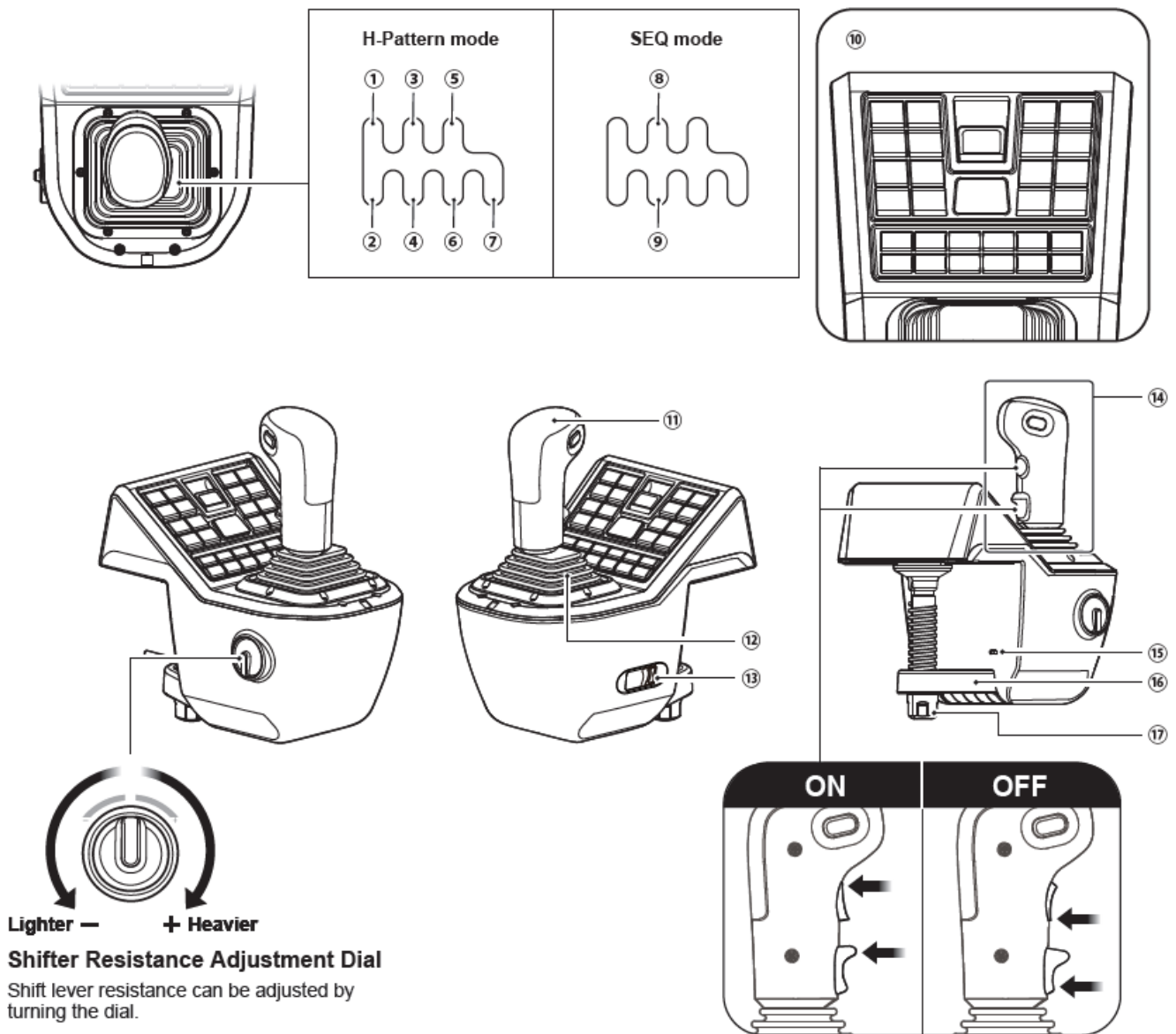

• Shifter

1. 1st Gear (Button 1)
2. 2nd Gear (Button 2)
3. 3rd Gear (Button 3)
4. 4th Gear (Button 4)
5. 5th Gear (Button 5)
6. 6th Gear (Button 6)
7. Reverse Gear (Button 7)
8. Shift Down (Button 8)
9. Shift Up (Button 9)
10. Shifter Buttons (Buttons 10 – 39)

Shifter (Right Side)

11. Shift Knob
12. Shifter Boot
13. Mode Toggle Switch

Shifter (Rear)

14. Shifter Buttons (Buttons 40 – 43)
15. USB-C™ Port
16. Clamp
17. Screw

Mounting Instructions

Mounting Instructions for Steering Unit and Shifter How to mount to a table

Flat, hard surface required (i.e., table)

Steering Unit

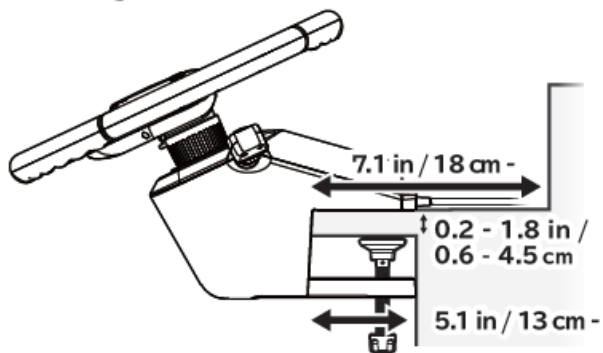

Shifter

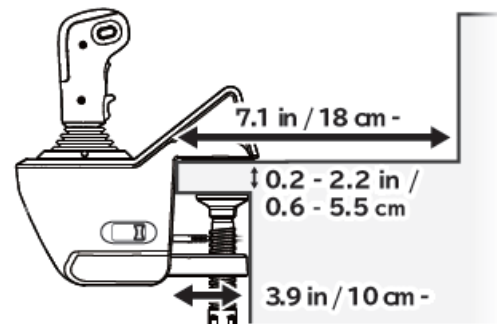

Please read before the setup

- Tighten the clamp into the steering unit base with the screw.
- Carefully detach from furniture to prevent damage to furniture or products.
- Do not attach to any unstable surface as shown in the diagram below.

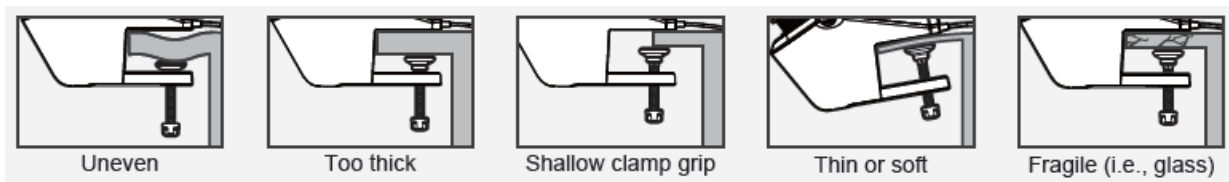

1. Place the clamp around a table or other mounting surface and push the clamp in so the edge of the mounting surface is touching the inside end of the clamp.

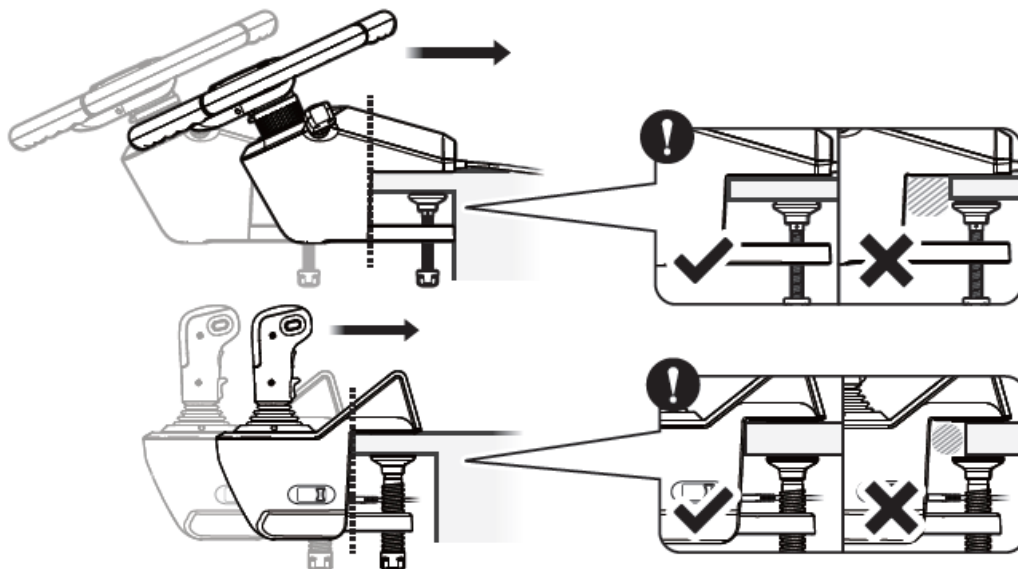

2. Rotate the screw clockwise while supporting the steering unit/shifter and firmly secure it in place.

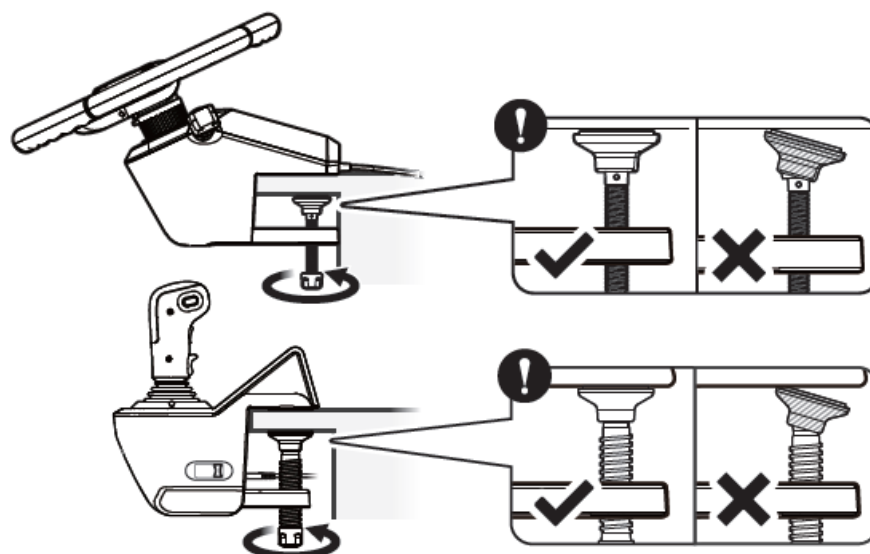

Foot Pedal

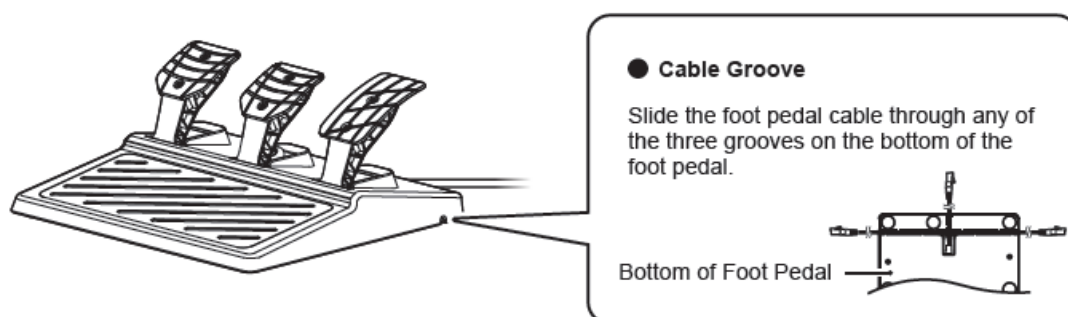

How to mount to a racing wheel stand

- M6 screws, hex key, and racing wheel stand required.
- M6 screws, hex key, and racing wheel stand are not included with this product.

1. Remove the screws before removing the clamp.

- Use a hex key to remove the screw.
- Hex key not included.
- Secure the screws tightly when attaching the clamp.

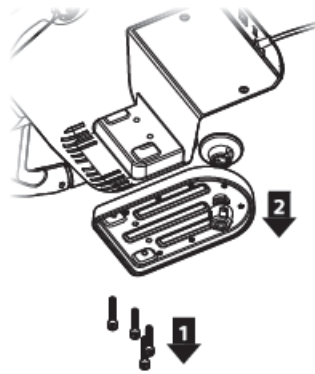

2. Screw the M6 screws into the holes at the bottom of your steering unit/shifter/foot pedal.

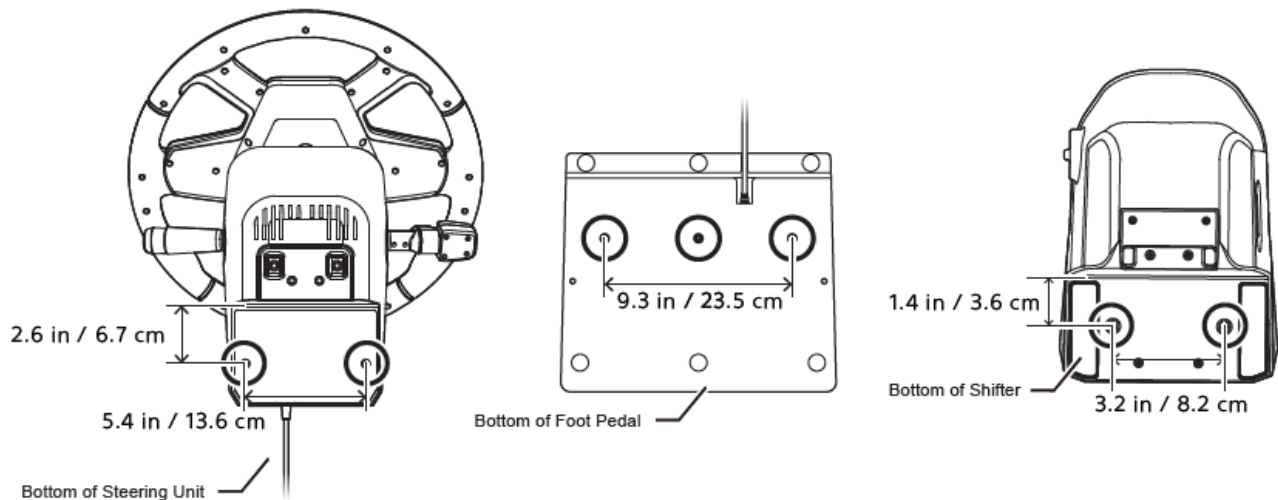

The M6 Screws

- If screws longer than the dimensions listed below are used, they may damage the product.

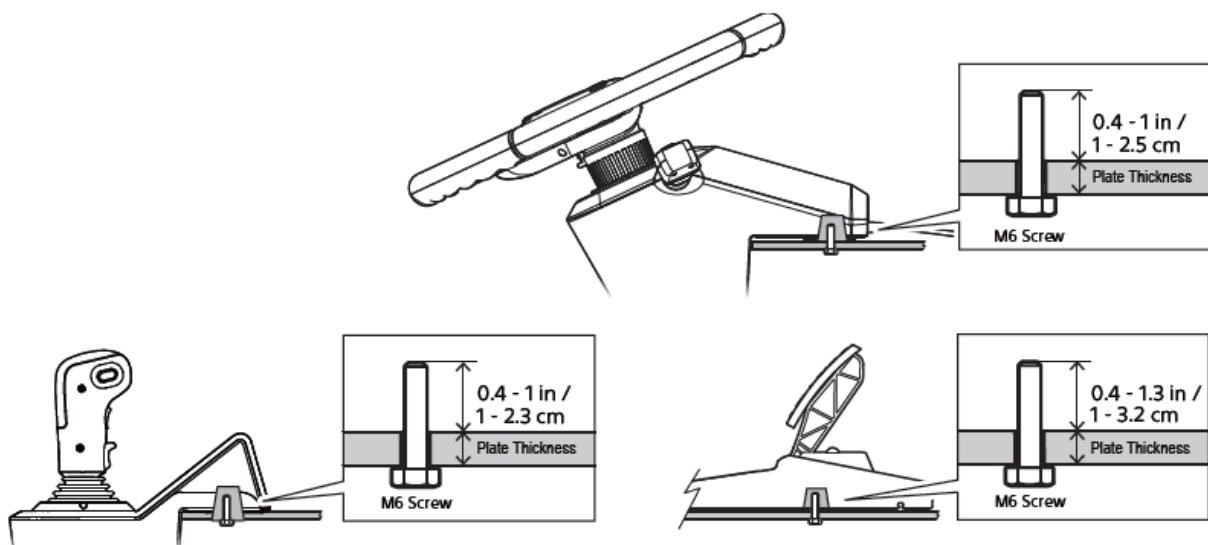

How to Connect

Please read before connecting The steering wheel will rotate when it is connected.

- When connecting the product to the PC / When turning on the PC / When waking the PC from sleep mode
- Analog stick input is disabled during a steering wheel rotation to prevent unintentional operation.
- The analog stick settings can be changed in the companion app.

Mode Toggle

Switch between H-Pattern and Sequential shifting with the Mode Toggle Switch.

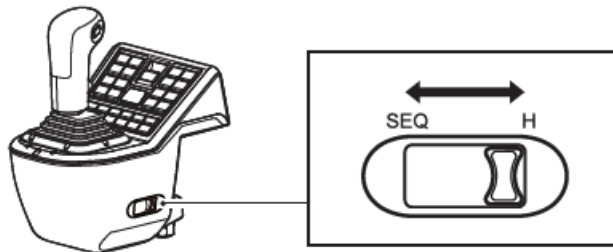

H-Pattern Mode

- H-Pattern for gears 1 through 6 and R (Reverse).

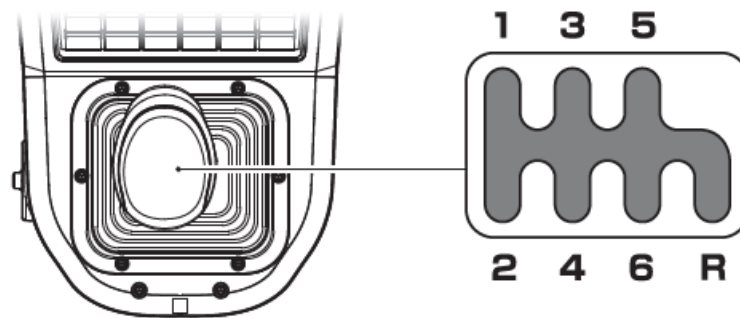

SEQ Mode (Sequential Mode)

- Allows forward and backward sequential shifting.

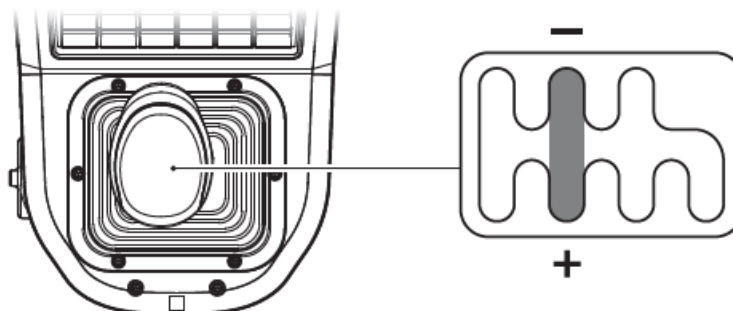

- Make sure the shift lever is in the neutral position when switching to the SEQ mode.

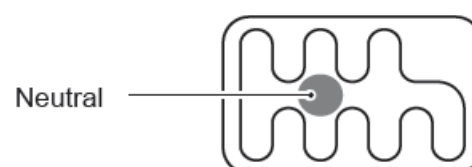

- Customize the racing wheel sensitivity, dead zone and other settings using the companion app.

Download App

<https://stores.horiusa.com/hpc-044U/app/>.

Supported OS	Windows®11 / 10
System Requirements	USB-A Port, Internet Connection



Specifications

Steering Unit

- **External Dimensions** W 15.7 × D 17.7 × H 13.4 in / W 40 × D 45 × H 34 cm
- **Steering Diameter** 15.8 in / 40 cm
- **Degrees of Rotation** 1800°
- **Weight** 7.5 lbs / 3.4 kg
- **Connection Type** USB-A Connector
- **Cable Length** 9.8 ft / 3 m
- **Mountable Surface Thickness** 0.2 – 1.8 in / 0.6 – 4.5 cm

Shifter Unit

- **External Dimensions** W 6.3 × D 9.1 × H 10.6 in / W 16 × D 23 × H 28 cm
- **Weight** 3.1 lbs / 1.4 kg
- **Connection Type** USB-A Connector
- **Cable Length** 6.6 ft / 2 m
- **Mountable Surface Thickness** 0.2 – 2.2 in / 0.6 – 5.5 cm

Foot Pedal

- **External Dimensions** W 13.4 × D 11.8 × H 6.3 in / W 34 × D 30 × H 16 cm
- **Weight** 3.1 lbs / 1.4 kg
- **Connection Type** Modular Connector
- **Cable Length** 5.9 ft / 1.8 m

For more information please visit this website.

- <https://stores.horiusa.com/hpc-044U/>.



Need help with this product? Please visit this website for support.

- <https://stores.horiusa.com/hpc-044U/support/>.



CAUTION: Any changes or modifications not expressly approved by the party responsible for compliance could void the user's authority to operate the equipment.

THE FCC WANTS YOU TO KNOW

This device complies with part 15 of the FCC Rules.

Operation is subject to the following two conditions:

1. This device may not cause harmful interference, and
2. this device must accept any interference received, including interference that may cause undesired operation.

NOTE: This equipment has been tested and found to comply with the limits for a Class B digital device, under part 15 of the FCC Rules. These limits are designed to provide reasonable protection against harmful interference in a residential installation. This equipment generates, uses and can radiate radio frequency energy and, if not installed and used by the instructions, may cause harmful interference to radio communications. However, there is no guarantee that interference will not occur in a particular installation. If this equipment does cause harmful interference to radio or television reception, which can be determined by turning the equipment off and on, the user is encouraged to try to correct the interference by one or more of the following measures:

- Reorient or relocate the receiving antenna.
- Increase the separation between the equipment and the receiver.
- Connect the equipment to an outlet on a circuit different from that to which the receiver is connected.
- Consult the dealer or an experienced radio/TV technician for help.

CAN ICES-003(B) / NMB-003(B)

- This Class B digital apparatus complies with Canadian ICES-003.

Simplified Declaration of Conformity

- Hereby, HORI declares that this product complies with Directive 2014/53/EU.
- The full text of the EU Declaration of Conformity is available at the following internet address:
<https://hori.co.uk/consumer-information/>.



For UK:

- Hereby, HORI declares that this product complies with the relevant statutory requirements.
- The full text of the declaration of conformity is available at the following internet address:

<https://hori.co.uk/consumer-information/>.



PRODUCT DISPOSAL INFORMATION

Where you see this symbol on any of our electrical products or packaging, it indicates that the relevant electrical product or battery should not be disposed of as general household waste in Europe. To ensure the correct waste treatment of the product and battery, please dispose of them by any applicable local laws or requirements for disposal of electrical equipment or batteries. In so doing, you will help to conserve natural resources and improve standards of environmental protection in the treatment and disposal of electrical waste.



HORI warrants to the original purchaser that our product purchased new in its original packaging shall be free of any defects in both material and workmanship for one year from the original date of purchase. If the warranty claim cannot be processed through the original retailer, please contact HORI customer support.

- For customer support in North America and Latin America, please use our customer support form:

<https://stores.horiusa.com/contact-us/>.



- For customer support in Europe, please email info@horiuk.com.

Warranty Information:

- For North America, LATAM, Australia: <https://stores.horiusa.com/policies/>.



- For Europe & Middle East: <https://hori.co.uk/policies/>.



- The actual product may differ from the image.
- The manufacturer reserves the right to change the product design or specifications without notice.
- USB-C is a registered trademark of USB Implementers Forum.
- HORI & HORI logos are registered trademarks of HORI.
- All other trademarks are the property of their respective owners.

Documents / Resources

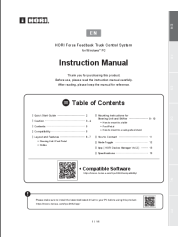
	<p>HORI HPC-044U Force Feedback Truck Control System [pdf] Instruction Manual HPC-044U, HPC-044E, HPC-044U Force Feedback Truck Control System, HPC-044U, Force F eedback Truck Control System, Feedback Truck Control System, Truck Control System, Control System</p>
--	---

References

- [Consumer Information](#)
- [Policies](#)
- [HORI USA](#)
- [Contact Us](#)
- [Truck Control System with Force Feedback for PC \(Windows 11/10\) - HORI USA](#)
- [Truck Control System with Force Feedback for PC \(Windows 11/10\) Firmware Update](#)
- [Policies](#)
- [User Manual](#)

Manuals+, Privacy Policy

This website is an independent publication and is neither affiliated with nor endorsed by any of the trademark owners. The "Bluetooth®" word mark and logos are registered trademarks owned by Bluetooth SIG, Inc. The "Wi-Fi®" word mark and logos are registered trademarks owned by the Wi-Fi Alliance. Any use of these marks on this website does not imply any affiliation with or endorsement.