



Hoover HOUQS 58E Built In Upright Freezer User Manual

[Home](#) » [Hoover](#) » Hoover HOUQS 58E Built In Upright Freezer User Manual 



Upright Freezer User's Manual

HOUQS 58E*
HOUQS 58E*H
HOUQS 58E*K
HOUQS 58E*HK
HOUQS 58E*W
HOUQS 513E*
HOUQS 513E*H
HOUQS 513E*K
HOUQS 513E*HK
HOUQS 513E*W

Contents

- 1 HOUQS 58E Built In Upright Freezer
- 2 Safety
- 3 Intended Use
- 4 Product description
- 5 Control panel
- 6 Use
- 7 Energy saving tips
- 8 Troubleshooting
- 9 Installation
- 10 Technical Data
- 11 Customer Service
- 12 Documents / Resources
 - 12.1 References

HOUQS 58E Built In Upright Freezer

Discover extra content

DOWNLOAD THE hOn App



go.haier-europe.com/download-app/

Thank You

Thank you for purchasing this Product.

Please read these instructions carefully before using this appliance. The instructions contain important information which will help you get the best out of the appliance and ensure safe and proper installation, use and maintenance. Keep this manual in a convenient place so you can always refer to it for the safe and proper use of the appliance. If you sell the appliance, give it away, or leave it behind when you move house, make sure you also pass this manual so that the new owner can become familiar with the appliance and safety warnings.

WARNING: Risk of fire/flammable material. The symbol indicates there is a risk of fire since flammable materials are used. Take care to avoid causing a fire by igniting flammable material.

Legend



General information and tips



Warning- Important Safety information



Environmental information

Disposal



The symbol on the product or on its packaging indicates that this product may not be treated as household waste. Instead it shall be handed over to the applicable collection point for the recycling of electrical and electronic equipment. By ensuring this product is disposed of correctly, you will help prevent potential negative consequences for the environment and human health, which could otherwise be caused by inappropriate waste handling of this product. For more detailed information about recycling of this product, please contact your local

city office. your household waste disposal service or the shop where you purchased the product. Since the flammable insulation blowing gases are used. please contact the professional agent or our after-sale service to dispose of the appliance.



Warning!

Risk of injury of suffocation!

Refrigerants and gases must be disposed of professionally. Ensure that the tubing of the refrigerant circuit is not damaged before being properly disposed of. Disconnect the appliance from the mains supply. Cut off the mains cable and dispose of it. Remove the trays and drawers as well as the door catch and seals to prevent children and pets to get closed in the appliance.

Safety

Before switching on the appliance for the first time, read the following safety hints!:



WARNING!

Before first use

- Make sure there is no transport damage .
- Remove all packaging and keep out of children's reach .
- Wait at least six hours before installing the appliance in order to ensure the refrigerant circuit is fully efficient.
- Handle the appliance always with at least two persons because it is heavy.

Installation

- The appliance should be placed in a well-ventilated place. Ensure a space of at least 10 cm above and around the appliance .
- Never place the appliance in a damp area or location where it might be splashed with water. Clean and dry water splashes and stains with a soft clean cloth .
- Do not install the appliance in direct sunlight or in the near of heat sources(e.g. stoves. heaters) .
- Install and level the appliance in an area suitable for its size and use .
- WARNING: Keep ventilation openings in the appliance or in the in built structure clear of obstruction .
- Make sure that the electrical information on the rating plate agrees with the power supply. If it does not. contact an electrician .
- The appliance is operated by a 220-240 VAC/50 Hz power supply
- Abnormal voltage fluctuation may cause the appliance to fail to start. or damage to the temperature control or compressor. or there may be an abnormal noise when operating. In such case. an automatic regulator shall be mounted .
- Use a separate earthed socket for the power supply which is easily accessible during cleaning. The appliance must be earthed .
- Only for UK: The appliance's power cable is fitted with 3-core (grounding) plug that fits a standard 3-core (grounded) socket. Never cut off or dismount the third pin (grounding). After the appliance is installed. the plug should be accessible .
- Do not use multi-plug adapters and extension cables .
- Ensure that the power cable is not trapped by the freezer. Do not step on the power cable .
- WARNING: Do not damage the refrigerant circuit.



WARNING!

- **WARNING:** Do not locate multiple portable socket outlets or portable power supplies at the rear of the appliance .
- **WARNING:** When positioning the appliance. ensure the supply cord is not trapped or damaged .
- Do not step on the power cable.

Daily use

- This appliance can be used by children aged from 8 years and above and persons with reduced physical, sensory or mental capabilities or lack of experience and knowledge if they have been given supervision or instruction concerning use of the appliance in a safe way and understand the hazards involved .
- Children should be supervised to ensure that they do not play with the appliance .
- If cool gas or other inflammable gas s leaking into the vicinity of the appliance. turn off the valve of the leaking gas. open the doors and windows and do not unplug a plug in the power cable of the freezer or any other appliance .
- Notice that the appliance is set for operation at a specific ambient range between 10 and 38 °C. The appliance may not work properly if it is left for a long period at a temperature above or below the indicated range .
- Do not place unstable articles (heavy objects, containers filled with water) on top of the freezer. to avoid personal injury caused by falling or electric shock caused by contact with water .
- Open and close the doors only with the handles. The gap between the doors and between the doors and the cabinet is very narrow. Do not extend your hands in these areas to avoid pinching your fingers. Open or close the freezer doors only when there are no children standing within the range of door movement.
- Do not store or use inflammable, explosive or corrosive materials in the appliance or in the vicinity .
- Do not store medicines, bacteria or chemical agents in the appliance. This appliance is a household appliance. It is not recommended to store materials that require strict temperatures .
- On refrigerating mode without a 4-star compartment: this refrigerating appliance is not suitable for freezing foodstuffs; on freezing mode with a 4-star compartment: this freezing appliance is not suitable for refrigerating foodstuffs .
- Never store liquids in bottles or cans (besides high percentage spirits)



WARNING!

Daily use

especially carbonated beverages in the freezer. as these will burst during freezing.

- Check the condition of food if a warning in the freezer has taken place.
- Do not set unnecessarily low temperature in the freezer compartment. Minus temperatures may occur at high settings. Attention: Bottles can burst.
- Do not touch frozen goods with wet hands (wear gloves). Especially do not eat ice lollies immediately after removal from the freezer compartment. There is the risk to freeze or the formation of frost blisters. **FIRST aid:** keep immediately under running cold water. Do not pull away!
- Do not touch the inside surface of the freezer storage compartment when in operation, especially with wet hands, as your hands may freeze onto the surface.
- Unplug the appliance in the event of a power interruption or before cleaning. Allow at least 5 minutes before restarting the appliance. as frequent starting may damage the compressor.
- Do not use electrical devices inside the food storage compartments of the appliance, unless they are of the

type recommended by the manufacturer.

- Keep away children under 3 years of age from the appliance unless they are constantly supervised.
- **WARNING:** If you are unsure of the refrigerant type check the rating plate on the unit. It is hazardous for anyone other than an Authorized Service Person to service this appliance.
- Children aged from 3 to 8 years are allowed to load and unload refrigerating appliances. but not allowed to clean and install the refrigerating appliances.
- Cleaning and user maintenance shall not be made by children without supervision.
- The appliance must be positioned so that the plug is accessible.
- Do not pull on the door shelves. The door may be pulled slant. the bottle rack, may be pulled away, or the appliance may topple.
- Never store bottled beer or beverages in the freezer. as these will burst during freezing.
- Do not store explosive substances such as aerosol cans with a flammable propellant in this appliance.
- Disconnect the appliance from the power supply before cleaning.

Maintenance/ cleaning

- Make sure children are supervised if they carry out cleaning and maintenance.
- Disconnect the appliance from the electrical supply before undertaking any routine maintenance. Allow at least 5 minutes before restarting the appliance. as frequent starting may damage the compressor.
- Hold the plug. not the cable. when unplugging the appliance.
- Do not scrape off frost and ice with sharp objects. Do not use sprays. electric heaters like heater. hair dryer. steam cleaners or other sources of heat in order to avoid damage to the plastic parts.
- Do not use mechanical devices or other means to accelerate the defrosting process. other than those recommended by the manufacturer.
- Do not spray or flush the appliance during cleaning.
- Do not use water spray or steam to clean the appliance.
- If the supply cord is damaged. it must be replaced by the manufacturer. its service agent or similarly qualified persons in order to avoid a hazard.
- Do not try to repair. disassemble or modify the appliance by your self. In case of repair please contact our customer service.
- Do not clean the appliance with hard brushes. wire brushes. detergent powder. petrol, amyl acetate. acetone and similar organic solutions. acid or alkaline solutions. Please clean with special freezer detergent to avoid damage.
- Eliminate the dust on the back of the unit at least once in the year to avoid hazard by fire. as well as increased energy consumption.
- Do not clean the cold glass shelves or glass door with hot water. Sudden temperature change may cause the glass to break.
- In case of heating check the condition of frozen goods.
- Before maintenance. deactivate the appliance and disconnect the mains plug from the mains socket.
- Electrical equipment should be serviced only by qualified electrical experts. because improper repairs can cause considerable consequential damages.

Refrigerant gas information



WARNING!

The appliance contains the flammable refrigerant ISOBUTANE (R600a). Make sure the refrigerant circuit is not damaged during transportation or installation. Leaking refrigerant may cause eye injuries or ignite. If a damage has occurred, keep away from open fire sources. thoroughly ventilate the room. do not plug or unplug the power cords of the appliance or any other appliance. Inform the customer service.

In case of eyes get into contact with the refrigerant, rinse immediately it under running water and call immediately the eye specialist.



WARNING: The refrigeration system is under high pressure. Do not tamper with it. Since the flammable refrigerants are used, please. install, handle and service the appliance strictly according to the instruction and contact the professional agent or our after-sales service to dispose of the appliance.



WARNING!

- Taking care to avoid causing a fire by igniting flammable material.
- **WARNING:** When positioning the appliance, ensure the supply cord is not trapped or damaged.
- **WARNING:** Do not locate multiple portable socket-outlets or portable power supplies at the rear of the appliance.
- Do not store explosive substances such as aerosol cans with a flammable propellant in this appliance.
- For flammable refrigerant is used in the freezer, please be careful when installing, handling, serving and recycling the appliance.
- Please contact to the service agent to dispose the appliance because the flammable blowing gas was used.

Intended use

This appliance is intended to be used in household and similar applications such as

- staff kitchen areas in shops, offices and other working environments;
- farm houses and by clients in hotels, motels and other residential type environments;
 - bed and breakfast type environments;
 - catering and similar non-retail applications .
- If the appliance is not used for an extended period of time and you will not use only the fridge off function for the freezer;
 - Take out the food.
 - Unplug the power cord.
 - Clean the appliance as described above.
 - Keep the doors open to prevent the creation of bad odours inside .
- To ensure the safe preservation of foodstuffs. please comply with this instruction for use .
- The details on the most appropriate part in the compartment of the appliance where specific types of food shall be stored, considering the distribution of temperature that can be present in the different compartments of the appliance are in the other part of the manual.
- To avoid contamination of food. please respect the following instructions:
 - Opening the door for long periods can cause a significant increase of the temperature in the compartments of the appliance.
 - Clean regularly surfaces that can come in contact with food and accessible drainage systems.
 - Clean water tanks if they have not been used for 48 h: flush the water system connected to a water supply if water has not been drawn for 5 days.
 - Store raw meat and fish in suitable containers in the freezer, so that it is not in contact with or drip onto other food.

- Two-star frozen-food compartments are suitable for storing pre-frozen food, storing or making ice cream and making ice cubes.
 - One-, two- and three-star compartments are not suitable for the freezing of fresh food.
- If the refrigerating appliance is left empty for long periods switch off defrost clean dry, and leave the door open to prevent mould developing within the appliance.

Intended Use

2.1 Intended Use

“This appliance is intended to be used in household and similar applications such as

- staff kitchen areas in shops, offices and other working environments;
- farm houses and by clients in hotels, motels and other residential type environments;
- bed and breakfast type environments;
- catering and similar non-retail applications.

This appliance is intended for freezing food. It has been designed exclusively for use in dry interior house-holds. It is not intended for commercial or industrial use. On demand this appliance can be used as fresh food compartment.

Changes or modifications to the device are not allowed. Unintended use may cause hazards and loss of warranty claims.

2.2 Accessories

Check the accessories and literature in accordance with this list:

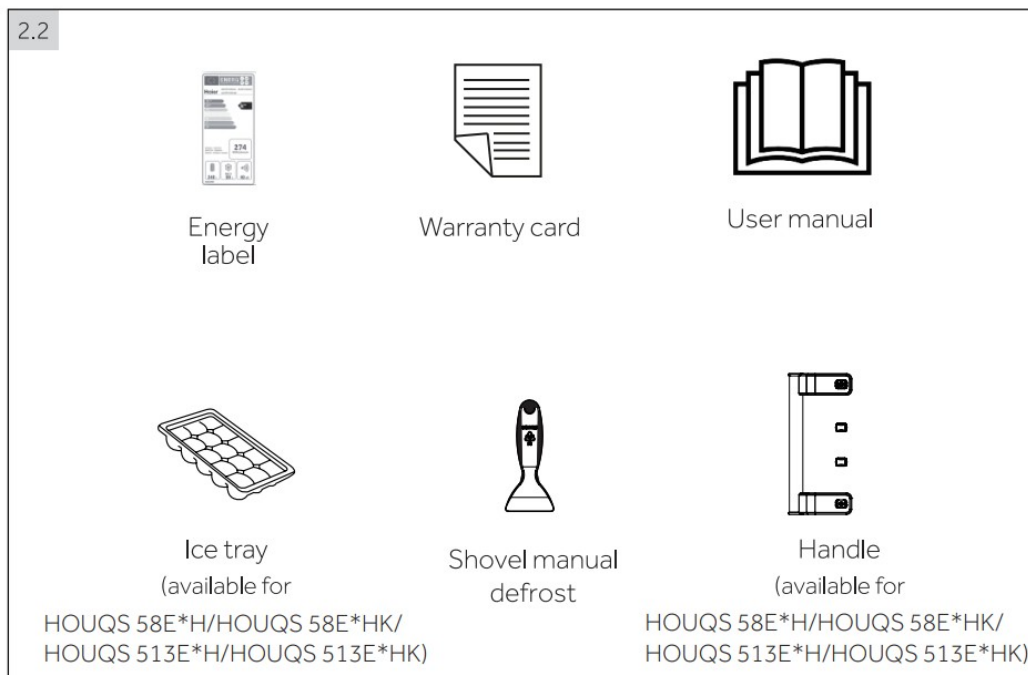

Productdescription



Notice: Differences

Due to technical changes and different models, some of the illustrations in this manual may differ from your model.

Picture of appliance (Fig. 3)

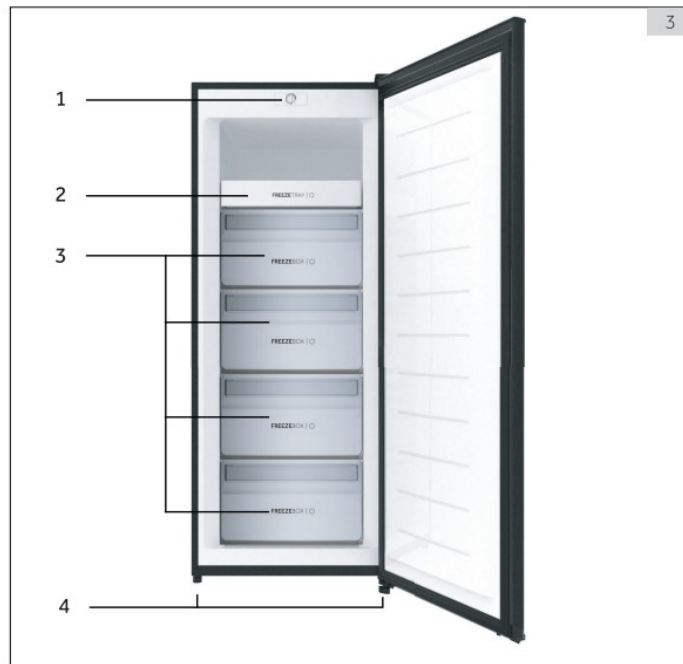

1. Control panel
2. Plastic shelves (available for HOUQS 58E*H/HOUQS 58E*HK/HOUQS 513E*H/ HOUQS 513E*HK)
3. Drawers
4. Adjustable feet

Control panel

Control panel Fig 4

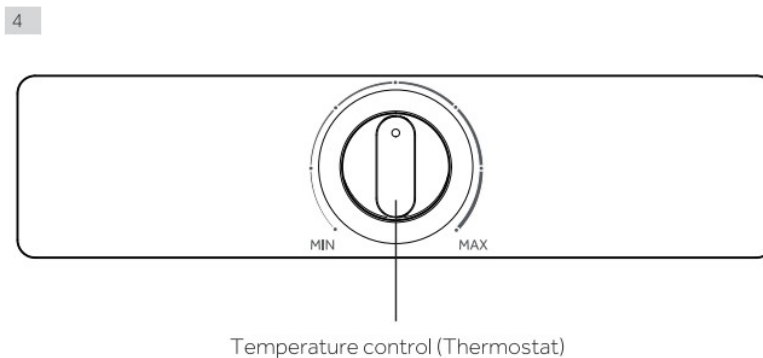

Use

5.1 Before first Use

- Remove all packaging materials, keep them out of childrens reach and dispose them in an environmentally friendly manner.
- Clean the inside and outside of the appliance with water and a mild detergent before putting any food in it.
- After the appliance has been levelled and cleaned, wait for at least 6 hours before connecting it to the power supply, See Section INSTALLATION,
- Precool the compartment for 2 hours at high settings before loading with food. To do So, please set the temperature.

5.2 Temperature setting

Turn thermostat to adjust the temperature between MIN (warmer) and MAX (colder) The storage temperature will be decreased from Min. setting to Max. setting.

Different foods should be placed in different areas according to their properties (Fig. 5).

Fig. 5

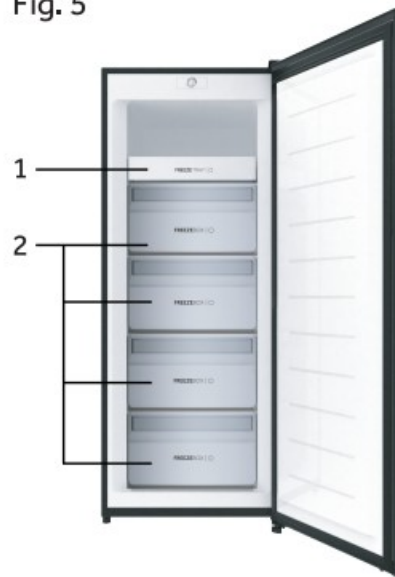

1. Pickled foods, canned food, fruit, vegetables, salad, etc.
2. Eggs, canned food, spices, drinks, meat product, snack foods and bottled foods, etc.

On refrigerating mode without a 4-star compartment: this refrigerating appliance is not suitable for freezing foodstuffs: on freezing mode with a 4-star compartment this freezing appliance is not suitable for refrigerating foodstuffs.

Food can be stored in the freezer at a temperature of at least -18°C for 2 to 12 months, depending on its properties (e.g., meat: 3-12 months, vegetables: 6-12 months).

In order to avoid expiration of storage periods, please note the freezing date, time limit and name of the food on the packaging according to the storage periods of different foods.

Energy saving tips



Energy saving tips

- Make sure the appliance is properly ventilated (see INSTALLATION).
- Do not install the appliance in direct sunlight or in the near of heat sources (e.g. stoves, heaters).
- Avoid unnecessarily low temperature in the appliance. The energy consumption increases the lower the temperature in the appliance is set.
- Allow warm food to cool down before placing it in the appliance.
- Open the appliance door as little and as briefly as possible.
- Make sure the door always closes correctly and unimpaired by food position. Keep door seals clean.
- Defreeze frozen food in a fridge.
- Clean the rear of the appliance regularly. Dust increases energy consumption.
- The most energy-saving configuration requires drawer, food box and shelves to be positioned in the appliance on factory-fresh condition, and food to be placed without blocking the air outlet of the duct.

Care and Cleaning



WARNING!

Disconnect the appliance from the power supply before cleaning.

7.1 General

Clean the appliance when only little or no food is stored.



WARNING!

- Donotclean the appliance with hard brushes, wire brushes, detergent powder, petrol, amyl acetate, acetone and similar organic solutions, acid or alkaline solutions. Please clean with special freezer detergent to avoid damage.
- Donot spray or flush the appliance during cleaning.
- Donot scrape off frost and ice with sharp objects.
- Do not use sprays, electric heaters like heater, hair dryer, steam cleaners or other sources of heat in order to avoid damage to the plastic parts.
- Donotclean the cold glass shelves with hot water. Sudden temperature change may cause the glass to break .
- Donot touch the inside surface of the freezer storage compartment, especially with wet hands, as your hands may freeze onto the surface. In case of heating check the condition of frozen goods.
- Do not try to repair the appliance by yourself. In case of repair please contact our customer service.
- Always keep the door gasket clean.
- Clean the inside and housing of the appliance with a soft cloth or sponge dampened in warm water and neutral detergent (Fig. 7.1).



1. Please scrub the interior and exterior of the refrigerator, including door sealing, door rack, glass shelves, boxes and so on, with a soft towel or sponge dipped in warm water (you may add neutral detergent into the warm water).
2. If there is liquid spilled, remove all the contaminated parts, directly rinse with the flow water, dry and place it back into the fridge.
3. If there is spilled cream (such as the cream, melting ice cream), please remove all the contaminated parts, put into the warm water with about 40 °C for some time, then rinse with the flow water, dry and place it back into the fridge.
4. In case some small part or component gets stucked inside of the fridge (between shelves or drawers), use small soft brush to release it. If you could not reach the part, please contact Hoover service.
Rinse and dry with soft cloth.
Do not clean any of the parts of the appliance in a dishwasher.
Clean the accessory only with warm water and mild neutral detergent.

The user manual includes instructions for the using and operation of multiple models. Please refer to the instructions for the purchased models.

Drawer cleaning steps

1. Remove the front cover of drawer:

Press the bottom of the drawer according to the direction of the arrow, and after releasing the buckle between the drawer cover and the drawer body. And rotating according to the direction of arrow to separate the drawer body from the drawer cover.

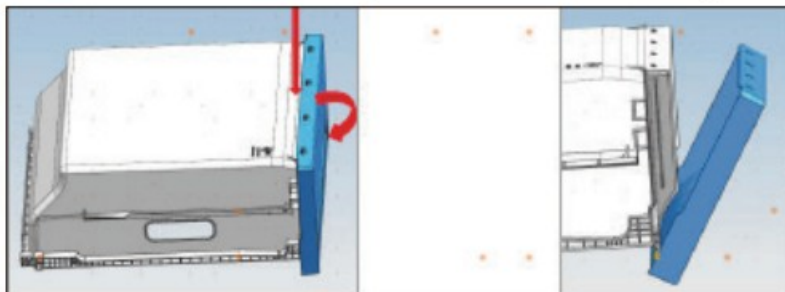

2. Cleaning of drawer body:

Wiping the interior and surface of the drawer with cloth dipping in edible grade alcohol, then washing with clean water.

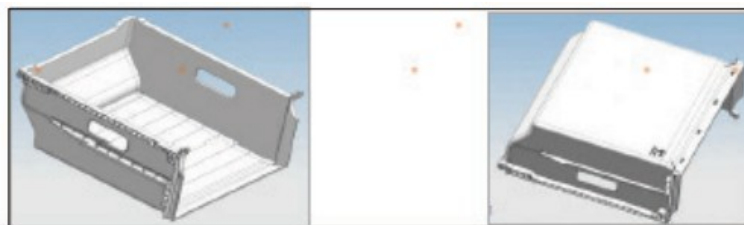

3. Drawer cover cleaning:

Clean the flat surface with a cloth dipping in edible grade alcohol. The part of groove scrub with brush dipping in edible grade alcohol, then washing with clear water.

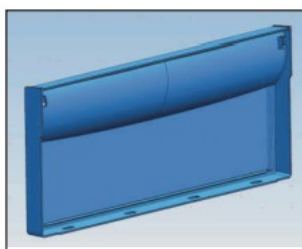

4. Assembly after cleaning:

After inserting the drawer into the hole of the front cover plate, the cover plate rotates around the drawer until the cover plate and the buckle of drawer are installed in place. According to the opposite sequence of disassembly to installation in place.



Door seal cleaning

1. Door seal strip remove

Holding the door seal by hand, pull-out according to the direction of arrow, and then remove the whole door

seal.



2. Door seal cleaning

Dipping with brush in water or edible grade alcohol clear the groove of door seal, and then using cloth dip in clear water or edible grade alcohol to wipe on the surface of door seal. Finally, clean the door seal with clean water and wipe it up with clean cloth.

3. Installation after cleaning

Make sure that there is no residual droplet on the door seal before installing, insert the door seal into the groove of the door lining, and press the door seal lightly from top to bottom by hand until the whole door seal is inserted into the groove.



7.2 Non-use for a longer period

If the appliance is not used for an extended period of time:

- Take out the food.
- Unplug the power cord.
- Clean the appliance as described above.
- Keep the door and freezer drawers open to prevent the creation of bad odours inside.

Remove the door of the appliance (open the door and hold it before removing the screws) to avoid children entering into the appliance and getting locked in.



Notice: Switch off

To ensure the service life of the appliance, only turn it off only if strictly necessary.

7.3 Moving the appliance

1. Remove all food and unplug the appliance.
2. Secure shelves and other moveable parts in the freezer with adhesive tape.
3. Close the door and secure it with tape.
4. Do not tilt the freezer more than 45° to avoid damaging the refrigerating system.

5. Wrap the feet of the freezer to avoid scratching the floor. Never move the freezer forcefully.



WARNING!

- Do not lift the appliance by its handles.
- Never place the appliance horizontally on the ground.

Troubles hooting

Many occurring problems could be solved by yourself without specific expertise. in case of a problem please check all shown possibilities and follow below instructions before you contact an after sales service. See CUSTOMER SERVICE.



WARNING!

- Before maintenance. deactivate the appliance and disconnect the mains plug from the mains socket.
- Electrical equipment should be serviced only by qualified electrical experts. because improper repairs can cause considerable consequential damages.
- A damaged supply should only be replaced by the manufacturer. its service agent or similarly qualified persons in order to avoid a hazard.

The acoustic alarm can be switched off by pressing any button .

8.1 Troubleshooting

Problem	Possible Cause	Possible Solution
The compressor does not work.	<ul style="list-style-type: none"> • Mains plug s not connected in the mai ns socket. 	Connect the mains plug.
The appliance runs frequently or for a too long period of time.	<ul style="list-style-type: none"> • The indoor or outdoor tempera ture is t oo high. The appliance has been off power for a period of time. The door of the appliance is not tightly cl osed. • The door has been opened too frequen tly or for too long. The temperature settings too low. • The door gaskets dirty. worn cracked o r mis-matched. The required air circulation s not guarant eed. The interior s covered in ice. 	<ul style="list-style-type: none"> · In this case. it is normal for the applia nce to run longer. Normally it takes 8 to 12 hours for the a ppliance to cool down completely. · Close the door and ensure the applian ce is ocated on a level ground and there is no food or container jarring the door. · Do not open the door too fre quently. Set the temperature higher un til a satisfactory temperature is obtained. It takes 24 hours for the temp erature to become stable. · Clean the door gasket or re place the m by the customer service. Ensure adequate ventilation. Defrost th e appliance.
The appliance makes abno rmal sounds.	<ul style="list-style-type: none"> • The appliance s not located on level gr ound. The appliance touches an object close t o it. The appliance stands on a wooden floor or near wooden walls. 	<ul style="list-style-type: none"> Level the appliance. Remove objects around the appliance. Wood amplifies the sound. Set the appl iance somewhere else.

Problem	Possible Cause	Possible Solution
The appliance makes a clicking sound	•This is normal. It is caused by the refrigeration unit switching on or off.	•-
A slight sound is to be heard similar to that of flowing water.	•This is normal.	•-
The appliance makes a motor sound	•The refrigeration unit has just turned itself on. This is normal	•-
It is not cold enough inside the appliance.	<ul style="list-style-type: none"> •The temperature is set too high. •Goods that are too warm have been stored. •Too much food has been stored at a time. •The goods are too close to each other. •The door is not tightly closed. •The door has been opened too frequently or for too long. 	<ul style="list-style-type: none"> •Reset the temperature. •Always cool down goods before storing them. •Always store small quantities of food. •Leave a gap between several foods allowing air flowing. •Close the door. •Do not open the door too frequently.
It is too cold inside the appliance.	•The temperature is set too low.	•Reset the temperature.
Moisture accumulates on the surface of the appliance.	•The climate is too warm and too damp.	<ul style="list-style-type: none"> •This is normal in damp climate and will change when the humidity decreases. Wipe dry with a cloth.
Strong ice and frost in the freezer compartment.	<ul style="list-style-type: none"> •The goods were not adequately packaged. •The door is not tightly closed. •The door has been opened too frequently or for too long. •The door gasket is dirty, worn, cracked or mis-matched. •Something on the inside prevents the door from closing properly. 	<ul style="list-style-type: none"> •Always pack the goods well. •Close the door. •Do not open the door too frequently. •Clean the door gasket or re-place them by the customer service. •Reposition the shelves, door racks, or internal containers to allow the door to close.
The cooling system does not work.	<ul style="list-style-type: none"> •Mains plug is not connected to the mains socket. •The power supply is not intact. 	<ul style="list-style-type: none"> •Connect the mains plug. •Check the electrical supply to the room. Call the local electricity company!

Problem	Possible Cause	Possible Solution
The sides of the cabinet and door strip get warm.	• This is normal.	•-
The door is difficult to open.	• Once the appliance runs. it has an internal vacuum.	• Open the door seal gently to let air enter the appliance.
The door can't be closed properly. It always leaves a gap.	• Because of the appliances's low temperature. the door seal can easily get hard and deformed.	• Use a hair dryer or put a hot towel on the spot where the gasket is deformed. When the gasket is soft once again. close the door and compress it tightly.

Minimum guarantee s: 2 years for EU Countries. 3 years for Turkey. 1 year for UK. 1 year for Russia. 3 years for Sweden. 2 years for Serbia. 5 years for Norway. 1 year for Morocco. 6 months for Algeria. Tunisia no legal warranty required.

Thermostats, temperature sensors, printed circuit boards and light sources are available for a minimum period of seven years after placing the last unit of the model on the market.

Door handles, door hinges, trays and baskets for a minimum period of seven years and door gaskets for a minimum period of 10 years after placing the last unit of the model on the market.

8.2 Power Interruption

In the event of a power cut, food should remain safely cold for about 18 hours. Follow these tips during a prolonged power interruption, especially in summer:

- Open the door as few times as possible.
- Do not put additional food into the freezer during a power interruption.
- If prior notice of a power interruption is given and the interruption duration is longer than 15 hours, make some ice and put it in a container in the top of the freezer compartment.
- As temperature in the freezer will rise during a power interruption or other failure, the storage period and edible quality of food will be reduced. Any food that defrosts should be either consumed, or cooked and refrozen (where suitable) soon afterwards in order to prevent health risks.



Notice: Memory function during power interruption

After restoration of power the appliance continues with the settings that were set before the power failure.

Installation

9.1 Unpacking



WARNING!

- The appliance is heavy. Always handle with at least two persons.
- Keep all packaging materials out of children's reach and dispose of them in an environmentally friendly manner.
- Take the appliance out of the packaging.
- Remove all packaging materials.

9.2 Environmental conditions

The room temperature should always be between 10 °C and 38 °C, since it can influence the temperature inside the appliance and its energy consumption. Do not install the appliance near other heat-emitting appliances (ovens, refrigerators) without isolation.

9.3 Space requirements

Required space to open the door (Fig. 9.1):

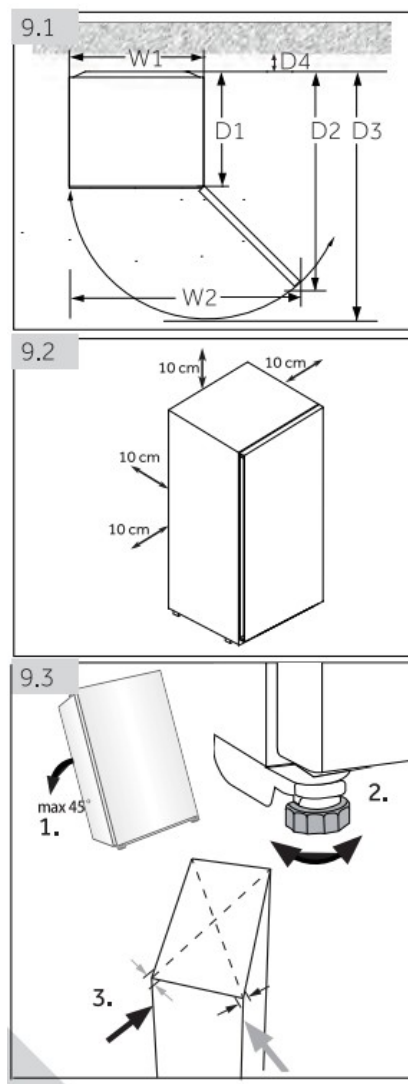

Width in mm		Depth in mm			Distance towall in m	Model identifier
W1	W2	D1	D2	D3	D4	
545	838	480	968	1046	100	HOUQS 58E*/ HOUQS 58E*Q HOUQS 58E*W
545	848	480	968	1046	100	HOUQS 58E* H/ HOUQS 58E*HK
545	838	500	988	1066	100	HOUQS 513E*/ HOUQS 513E*Q HOUQS 513E*W
545	848	500	988	1066	100	HOUQS 513E*H/ HOUQS 513E*HK

FOR a free standing appliance: this refrigerating appliance is not intended to be used as a built-in appliance.

10.4 Ventilaton cross-section

To achieve sufficient ventilation of the appliance for safety reasons, the information of the required ventilation cross sections must be observed (Fig. 9.2).

10.5 Aligning the appliance

The appliance should be placed on a flat and solid surface. If the appliance is placed on a pedestal, strong and fire-resistant materials must be used. Never use the foam packing material as a pedestal.

1. Tilt the appliance slightly backwards (Fig. 9.3).
2. Set the feet to the desired level.
3. The stability can be checked by alternately bumping on the diagonals. The slight swaying should be the same in both directions. Otherwise the frame can warp; possible leaking door seals are the result.
A low tendency to the rear eases the closing of the door.

9.6 Using adjustable feet

If the freezer is unstable, the feet can be adjusted: Rotate the adjustable feet according to the direction of arrow (Fig. 9.4) to turn them up or down:

- Turning the feet clockwise raises the appliance.
- Turning the feet counterclockwise lowers it.

9.7 Waiting time

To the maintenance-free lubrication oil is located in the capsule of the compressor. This oil can get through the closed pipe system during slanting transport. Before connecting the appliance to the power supply you have to wait 6 hours (Fig. 9.5) so that the oil runs back into the capsule.

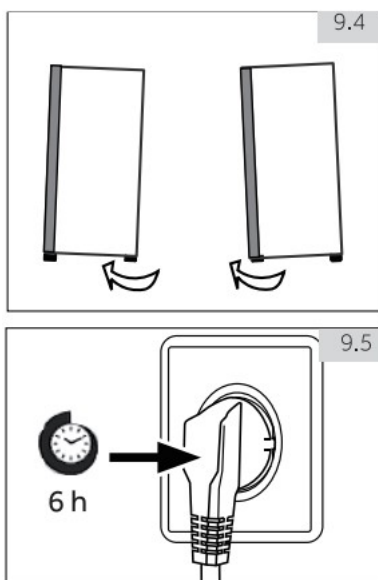

9.8 Electrical connection

Before each connection check if:

- power supply, socket and fusing are appropriate to the rating plate.
- the power socket is earthed and no multi-plug or extension.
- the power plug and socket are strictly according.

Connect the plug to a properly installed household socket.



WARNING!

To avoid risks a damaged power cord must be replaced by the customer service (see warranty card).

9.9 Door Reversibility

Before connecting the appliance to the power supply you should check, whether the door swing must be changed from right (as delivered) to left, if this is required by the installation location and the usability.



WARNING!

- The appliance is heavy. You need two persons to carry out the door reversibility.
- Before any operation, first unplug the appliance from the mains.

- Donot tilt the appliance more than 45 ° to prevent damage of the cooling system.

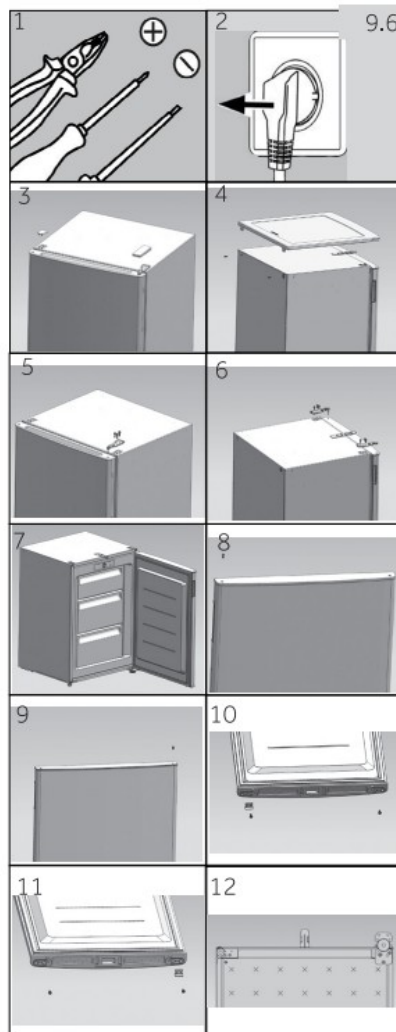

Assembly steps (Fig. 9.6):

1. Provide necessary tool.
2. Unplug the appliance.
3. Remove hinge hole cover and hinge cover(available for HOUQS 513E*/HOUQS 513E*H/HOUQS 513E*K/HOUQS 513E*HK/HOUQS 513E*W).
4. Remove 2 screws in the back and the top cover(avail- able for HOUQS 58E*/HOUQS 58E*H/HOUQS 58E*K/HOUQS 58E*HK/HOUQS 58E*W).
5. Removes 3 screws and hinge (available for HOUQS 513E*/HOUQS 513E*H/HOUQS 513E*K/HOUQS 513E*HK/HOUQS 513E*W).
6. Removes 6 screws and 2 hinge (available for HOUQS 58E*/HOUQS 58E*H/HOUQS 58E*K/HOUQS 58E*HK/HOUQS 58E*W).
7. Open and remove the door.
8. Remove cover inleft side of door.
9. Fix the cover in right side of door.
10. Turn the door upside down, remove 2 screws and door stopper at the bottom of the door.
11. Fix door stopper dismounted last step to the other side and 2 screws.
12. Tilt slightly backwards the cabinet. remove 3 screws, the lower hinge and adjustable feet.

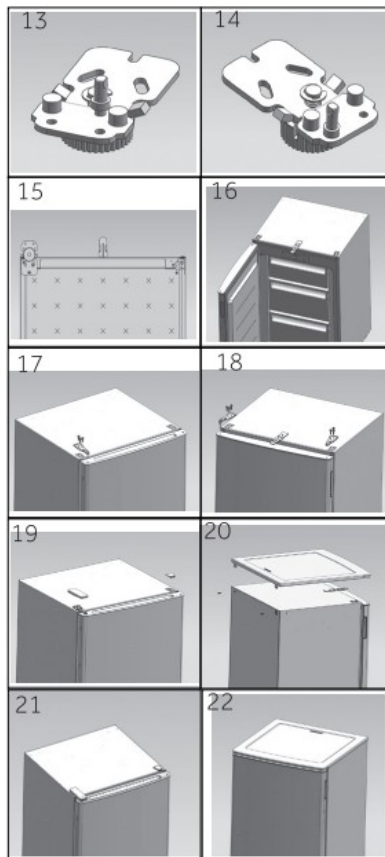

13. Remove hinge axe.
14. Fix hinge axe to the next hole.
15. Fix the hinge to the opposite position of the cabinet with 4 screws and adjustable feet.
16. Mount the door.
17. Fix upper hinge with 3 screws (available for HOUQS 513E*/HOUQS 513E*/H/HOUQS 513E*K/ HOUQS 513E*HK/HOUQS 513E*W).
18. Fix 2 upper hinges with 6 screws (available for HOUQS 58E*/HOUQS 58E*/H/HOUQS 58E*K/ HOUQS 58E*HK/HOUQS 58E*W).
19. Fix hinge hole cover and upper left hinge cover (available for HOUQS 513E*/HOUQS 513E*/H/ HOUQS 513E*K/HOUQS 513E*HK/HOUQS 513E*W).
20. Fix top cover with 2 screws (available for HOUQS 58E*/HOUQS 58E*/H/HOUQS 58E*K/ HOUQS 58E*HK/HOUQS 58E*W).
21. Finished (available for HOUQS 513E*/HOUQS 513E*/H/HOUQS 513E*K/HOUQS 513E*HK/ HOUQS 513E*W).
22. Finished (available for HOUQS 58E*/HOUQS 58E*/H/HOUQS 58E*K/HOUQS 58E*HK/ HOUQS 58E*W)

9.10 Handle Reversibility (available for HOUQS 58E*/H/HOUQS 58E*HK/HOUQS 513E*/H/HOUQS 513E*HK)

Assembly steps (Fig. 9.7):

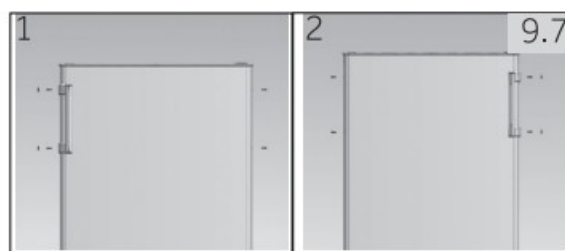

1. Remove 2 handle covers, 2 screws and handle assembly from left side of door. Remove 2 hole plugs from right side of door.
2. Fix handle assembly with 2 screws to right side of door and 2 handle covers. Fix 2 hole plugs to left side of door.
3. Finished.

Technical Data

10.1 Product fiche according to regulation EU No. 2019/2016

Trade mark	HOOVER	
Model identifier	HOUQS 58E*/HOUQS 58E*H/ HOUQS 58E*K/HOUQS 58E*HK/ HOUQS 58E*W	HOUQS 513E*/HOUQS 513E*H/ HOUQS 513E*K/HOUQS 513E*HK/ HOUQS 513E*W
Category of the model	Upright freezer	
Energy efficiency class	E	E
Annual energy consumption (kWh/year)"	164	189
Storage volume cooling (L)	not applicable	
Storage volume freezing (L) ****	85	163
Star rating	*/***	
Temperature of other compartments > 14 °C	not applicable	
Frostfree system	no	
Power cut safe (h)	12	12
Freezing capacity (kg/24h)	4	8.
Climate class (This appliance is intended to be used at an ambient temperature between 10 °C and 38°C.		SN-ST
Airborne acoustical noise emissions (dB(A) re 1pW)	37	38
Construction type	freestanding	

1. based on standard test results for 24 hours. Actual energy consumption will depend on how the appliance is used and where it is located.

Regarding specification details, please consult the rating plate and energy label inside the product.

This appliance is intended to be used at an ambient temperature indicated below:

SN	+ 10°C~+32°C
N	+ 16°C~+32°C
ST	+ 16°C~+38°C
T	+ 16°C~+43°C

10.2 Additional Technical Data

Voltage / Frequency	220-240V ~/ 50Hz
Rated current (A)	0.8
Coolant	R600a
Dimensions (H/W/D in cm) (HOUQS 58E*/HOUQS 58E*H/ HOUQS 58E*K/HOUQS 58E*HK/HOUQS 58E*W)	85/54,5/55
Dimensions (H/W/D in cm) (HOUQS 513E*/HOUQS 513E*H/ HOUQS 513E*K/HOUQS 513E*HK/HOUQS 513E*W)	138/54,5/56,5
Rated power input (HOUQS 58E*/HOUQS 58E*H/HOUQS 58E*K/HOUQS 58E*HK/HOUQS 58E*W)	100W
Rated power input (HOUQS 513E*/HOUQS 513E*H/HOUQS 513E*K/HOUQS 513E*HK/HOUQS 513E*W)	120W

Customer Service

10.3 AFTER-SALE SERVICE

1. Resolving faults by yourself

If you suspect any fault. before contacting the approved after-sales service directly or via your dealer. make sure you have observed all instructions and advice in this user manual.

2. After-sales service

Consult the enclosed warranty card for available after-sales services.

In order to receive immediate help. make sure you have ready the following essential data to identify your appliance:

- Brand of appliance
- Model
- Serial number
- The problem or reason
- Date of purchase
- Purchased from/supplier

To contact the technical assistance. visit our website: <https://corporate.haier-europe.com/en/>

Under the section "website". choose the brand of your product and your country. You will be redirected to the specific website where you can find the telephone number and form to contact the technical assistance.

AVAILABILITY OF SPARE PARTS

Thermostats. temperature sensors. printed circuit boards and light sources are available for a minimum period of seven years after placing the last unit of the model on the market.

Door handles. door hinges. trays and baskets for a minimum period of seven years and door gaskets for a minimum period of 10 years. after placing the last unit of the model on the market.

GUARANTEE

Minimum guarantee is: 2 years for EU Countries. 3 years for Turkey. 1 year for UK. 1 year for Russia. 3 years for Sweden. 2 years for Serbia. 5 years for Norway. 1 year for Morocco. 6 months for Algeria. Tunisia no legal warranty required.

PRECAUTIONS

If your cabinet is to be discarded, you must remove the door and leave the shelves in place. This will reduce the possibility of danger to children. And the flammable foaming needs to be disposed of by professional persons.



Documents / Resources



- ☐ Hoover HOUQS 58E**
- ☐ Hoover HOUQS 58E H*
- ☐ Hoover HOUQS 58E K*
- ☐ Hoover HOUQS 58E HK*
- ☐ Hoover HOUQS 58E W*
- ☐ Hoover HOUQS 513E**
- ☐ Hoover HOUQS 513E H*
- ☐ Hoover HOUQS 513E K*
- ☐ Hoover HOUQS 513E HK*
- ☐ Hoover HOUQS 513E W*
- ☐ Hoover HOUQS 58E Built In Upright Freezer
- ☐ Hoover HOUQS 58E Upright Freezer
- ☐ Hoover HOUQS 58E Freezer

* Colour code

DOWNLOAD THE PDF
Scan QR code



Hoover HOUQS 58E Built In Upright Freezer [pdf] User Manual

HOUQS 58E, HOUQS 58E H, HOUQS 58E K, HOUQS 58E HK, HOUQS 58E W, HOUQS 513E, HOUQS 513E H, HOUQS 513E K, HOUQS 513E HK, HOUQS 513E W, HOUQS 58E Built In Upright Freezer, HOUQS 58E, Built In Upright Freezer, Upright Freezer, Freezer

References

- User Manual

Manuals+, Privacy Policy

This website is an independent publication and is neither affiliated with nor endorsed by any of the trademark owners. The "Bluetooth®" word mark and logos are registered trademarks owned by Bluetooth SIG, Inc. The "Wi-Fi®" word mark and logos are registered trademarks owned by the Wi-Fi Alliance. Any use of these marks on this website does not imply any affiliation with or endorsement.