

Honeywell T827 Series Heat Only Vertical Thermostat



Honeywell T827 Series Heat Only Vertical Thermostat Owner's Manual

[Home](#) » [Honeywell](#) » Honeywell T827 Series Heat Only Vertical Thermostat Owner's Manual 

Contents

- [1 Honeywell T827 Series Heat Only Vertical Thermostat](#)
- [2 Product Information](#)
- [3 Product Usage Instructions](#)
- [4 Pre-installation checklist](#)
- [5 Product application](#)
- [6 Specifications](#)
- [7 Base installation](#)
- [8 Wiring](#)
- [9 Thermostat mounting](#)
- [10 Operation](#)
- [11 5-year limited warranty](#)
- [12 Documents / Resources](#)
 - [12.1 References](#)
- [13 Related Posts](#)

Honeywell

Honeywell T827 Series Heat Only Vertical Thermostat



Product Information

Specifications

- Model: T822/T827 Series Thermostat
- System Types: Heating and Cooling
- Electrical Ratings:
 - W1 Heating: 20-30 Vac
 - W2 (Powerpile): 750 mVdc
 - W2 (DC Powered): 12 Vdc
 - Y3 Cooling: 20-30 Vac
 - Y3 Normally open zone valve: 20-30 Vac
- Running Current: 0.02-1.2 A
- Wire Specifications: Use 18-gauge thermostat wire. Shielded cable is not required.

Product Usage Instructions

Pre-installation Checklist

Before you begin, ensure you have all the necessary components and tools as listed in the package contents. It is recommended to have the thermostat installed by a trained technician to avoid any potential hazards.

Installation Steps

1. Pull wires through the wire hole and position the base on the wall, ensuring it is level.
2. Drill appropriate holes based on the wall material and insert wall anchors.
3. Pull wires through the base, position it over the anchors, and tighten screws securely.

Wiring Instructions

1. Loosen screw terminals, insert bare wires beneath the screws, and securely tighten them.
2. Push any excess wire back into the wall opening.
3. Seal the wall opening with nonflammable insulation to prevent drafts from affecting thermostat operation.

Set Heat Anticipator

For model T822K, adjust the heat anticipator according to your system type as indicated in the provided table.

FAQ

- **Q: What should I do if my thermostat is not functioning properly?**

A: If you encounter any issues with the thermostat's operation, first check the power source and wiring connections. If problems persist, contact a qualified technician for further assistance.

- **Q: Can this thermostat be used in areas with temperatures below freezing?**

A: It is not recommended to use this thermostat in homes where temperatures at or below freezing can occur. This thermostat is suitable for areas like garages where such temperatures may be present.

T822/T827 Series Thermostat

- This manual covers the following models*: T822K,L • T827K
- * Images are for reference only and may not represent the actual thermostat.

Pre-installation checklist

Check package contents:

- Thermostat
- Wall anchors & screws (2 each)

Before you begin, make sure you have:

- No. 2 Phillips & small pocket screwdrivers
- Hammer
- Level (optional)
- Pencil
- Drill and bit (3/16" for drywall, 7/32" for plaster)

Must be installed by a trained, experienced technician

Read these instructions carefully. Failure to follow these instructions can damage the product or cause a hazardous condition.



• **CAUTION: ELECTRICAL HAZARD**

Can cause electrical shock or equipment damage. Disconnect power before beginning installation.



• **CAUTION: EQUIPMENT DAMAGE HAZARD**

Compressor protection is bypassed during testing. To prevent equipment damage, avoid cycling the compressor quickly.



• **CAUTION: MERCURY NOTICE**

If this product is replacing a control that contains mercury in a sealed tube, do not place the old control in the trash. Contact your local waste management authority for instructions regarding recycling and proper disposal.



• **CAUTION: ELECTRONIC WASTE NOTICE**

The product and batteries should not be disposed of with other household waste. Check for the nearest authorized collection centers or authorized recyclers. The correct disposal of end-of-life equipment will help prevent potential negative consequences for the environment and human health.

FCC statement available at: <https://customer.resideo.com/en-US/support/residential/codes-and-standards/FCC15105/Pages/default.aspx>

® U.S. Registered Trademark. Patents pending. Copyright © 2023 Resideo Technologies Inc. All rights reserved.

Product application

This thermostat provides control of:

- 24 Vac heating systems (T822K)
- 750 mV or 12 Vdc heating systems (T827K)
- 24 Vac cooling systems (T822L)

System Types

- Gas or oil
- Warm air, hot water, high-efficiency furnaces, heat pumps, steam, gravity
- Normally closed hot water valves (T822K)
- 2-wire cooling systems (T822L)
- Normally open hot water valves (T822L)

System Settings

Heat, Off (select models only)

Fan Settings

Auto, On (select models only)

Specifications

- **Temperature Control Range**
 - 45° to 95°F (7° to 35°C)
 - 35° to 85°F (2° to 29°C)*
- **Operating Ambient Temperature**
0° to 120°F (-18° to 49°C)
- **Operating Relative Humidity**
5% to 90% (non-condensing)
- **Dimensions (vertical model)**
 - 2.88W x 4.75H x 1.5D (inches)
 - 73W x 121H x 38D (mm)
- **Dimensions (horizontal model)**
 - 4.75W x 2.88H x 1.5D (inches)
 - 121W x 73H x 38D (mm)

Electrical Ratings

Terminal	Voltage (50/60Hz)	Running Current
W¹ Heating	20-30 Vac	0.02-1.2 A
W² (Powerpile)	750 mVdc	100 mAdc
W² (DC Powered)	12 Vdc	0.1 A
Y³ Cooling	20-30 Vac	0.02-1.2 A
Y³ Normally open zone valve	20-30 Vac	0.02-1.2 A
¹ T822K		
² T827K		
³ T822L		

* **CAUTION:** Do not use a product with this temperature control range in a home. Temperatures at or below freezing can occur. A product with this temperature range is for use in areas where temperatures below freezing can occur, such as a garage.

Base installation

1. Pull wires through wire hole. Position base on wall, level and mark hole positions.
2. Drill holes (3/16" holes for drywall, 7/32" holes for plaster), then tap in supplied wall anchors.
3. Pull wires through base, position over anchors, and insert screws. Check level if desired, then tighten screws.

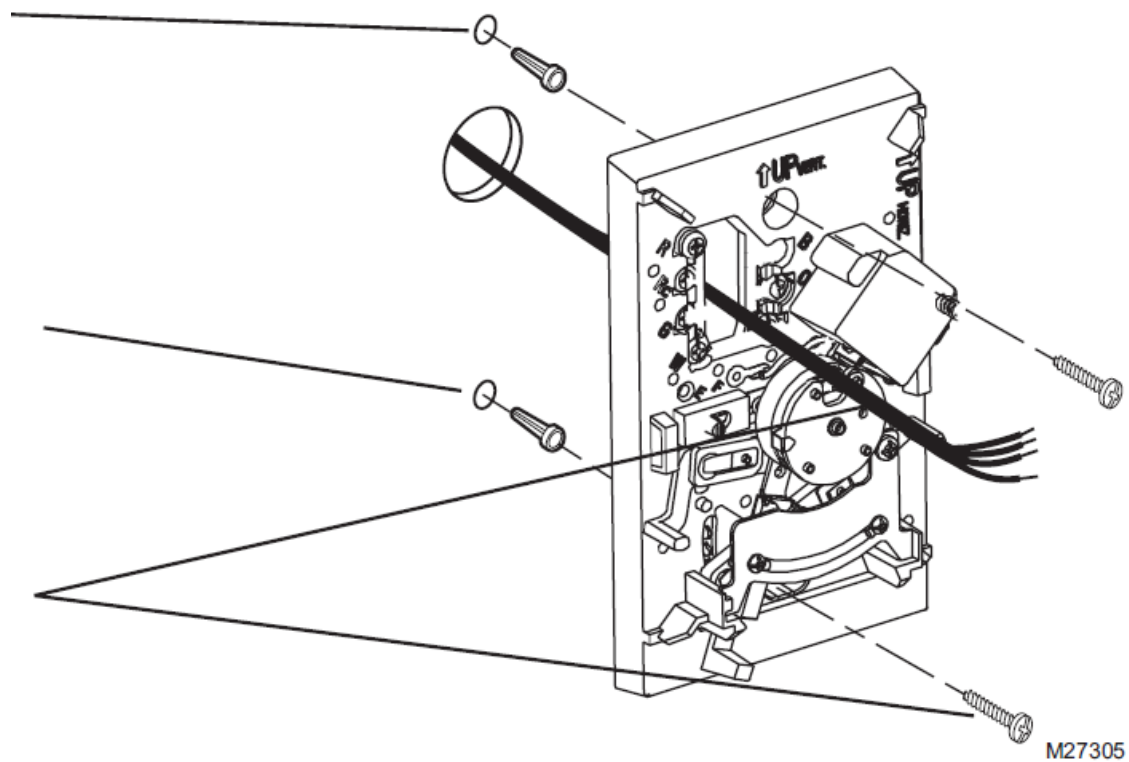

Wiring

1. Loosen screw terminals, insert bare wires beneath screws, then re-tighten screws.
2. Push any excess wire back into the wall opening
3. Plug the wall opening with nonflammable insulation to prevent drafts from affecting thermostat operation.

Terminal Designations

- R R power. Connect to 24 V hot on secondary side of heating/cooling transformer or R on furnace/boiler for 750 mV systems.
- W1 Heat relay.
- Y2 Cool relay, or normally open hot water valve.
- G Fan relay (select models only)
 - 1 T822K and T827K
 - 2 T822L

Wire specifications

Use 18-gauge thermostat wire. Shielded cable is not required.

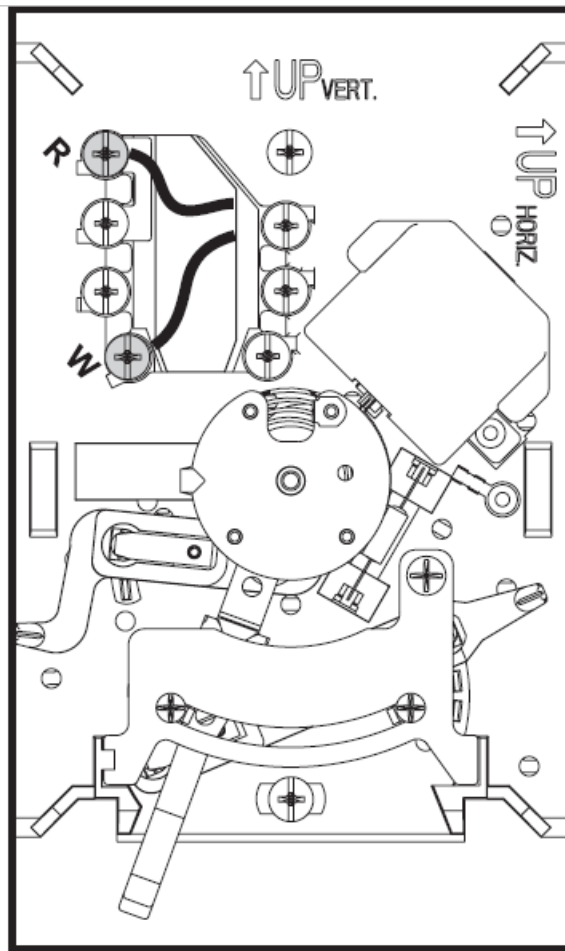

Set heat anticipator (model T822K only)

Move the adjustment arrow to the proper setting for your system (see table below).

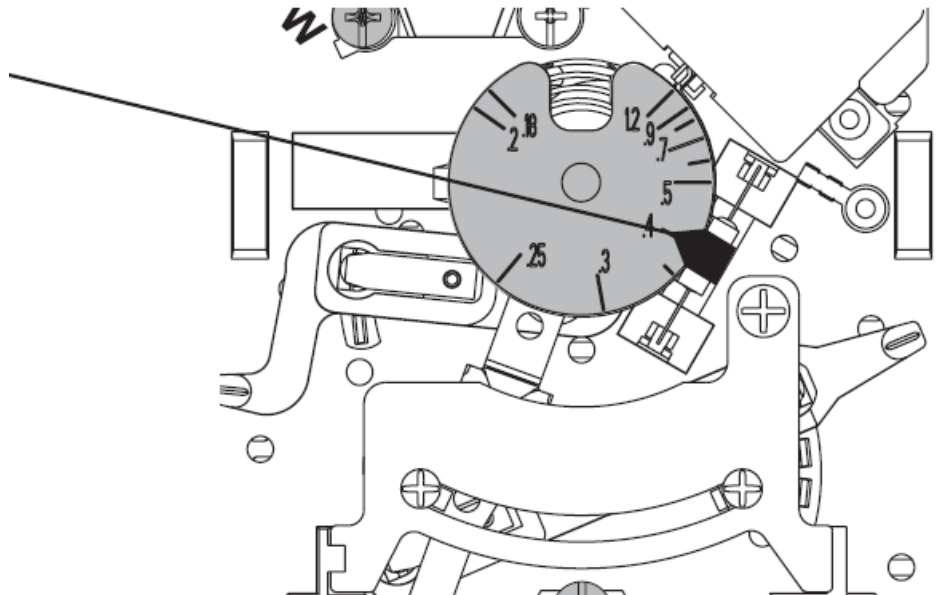

Your system	Setting
Steam	1.2
Hot water heat	0.8
Warm air (high efficiency)	0.8
Warm air (standard)	0.4
Electric heat	0.3

Thermostat mounting

Align the slots on the cover with tabs on the sides of the base, then push gently until the cover snaps into place.

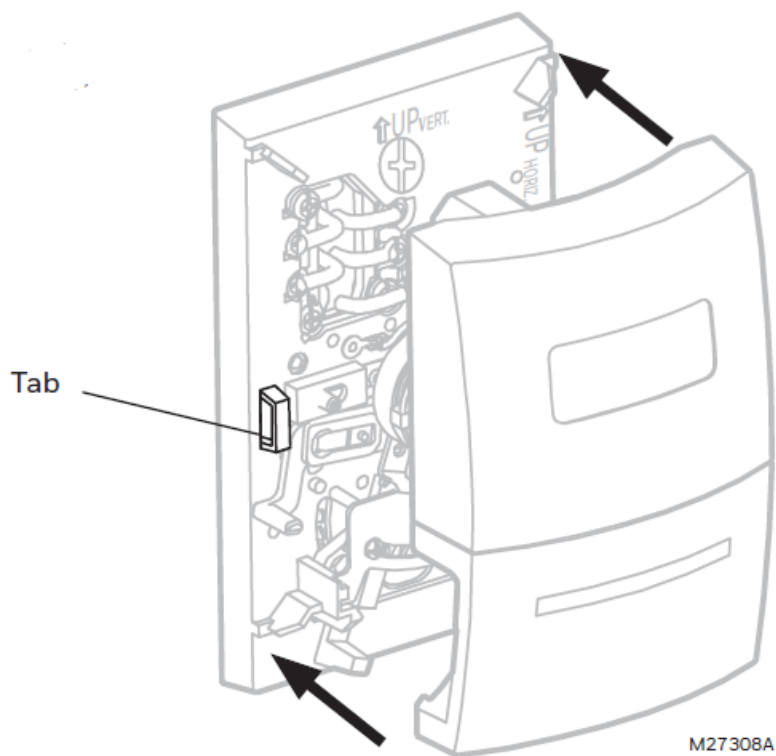

Operation

- **Fan switch (select models)**
 - **On:** Fan runs continuously.
 - **Auto:** Fan runs only when heating or cooling system is on.
- **System switch (select models)**
 - **Heat:** Controls the heating system.
 - **Off:** All systems are off.

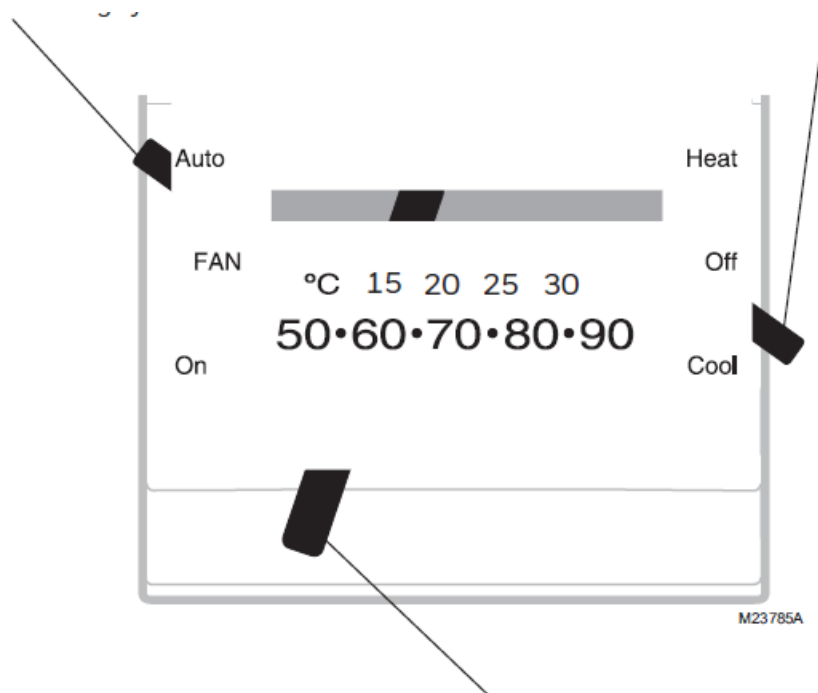

- **Temperature setting**

Adjust to set desired indoor temperature. Note: Temperature scale varies by model.

5-year limited warranty

- Resideo warrants this product to be free from defects in workmanship or materials, under normal use and service, for a period of five (5) years from the date of first purchase by the original purchaser. If at any time during the warranty period the product is determined to be defective due to workmanship or materials, Resideo shall repair or replace it (at Resideo's option).
- If the product is defective,
 - (i) return it, with a bill of sale or other dated proof of purchase, to the place from which you purchased it; or
 - (ii) call Resideo Customer Care at 1-800-468-1502.
- Customer Care will make the determination whether the product should be returned to the following address: Resideo Return Goods, 1985 Douglas Dr. N., Golden Valley, MN 55422, or whether a replacement product can be sent to you.
- This warranty does not cover removal or reinstallation costs. This warranty shall not apply if it is shown by Resideo that the defect was caused by damage which occurred while the product was in the possession of a consumer.
- Resideo's sole responsibility shall be to repair or replace the product within the terms stated above. RESIDEO SHALL NOT BE LIABLE FOR ANY LOSS OR DAMAGE OF ANY KIND, INCLUDING ANY INCIDENTAL OR CONSEQUENTIAL DAMAGES RESULTING, DIRECTLY OR INDIRECTLY, FROM ANY BREACH OF ANY WARRANTY, EXPRESS OR IMPLIED, OR ANY OTHER FAILURE OF THIS PRODUCT.
- Some states do not allow the exclusion or limitation of incidental or consequential damages, so this limitation may not apply to you.
- THIS WARRANTY IS THE ONLY EXPRESS WARRANTY RESIDEO MAKES ON THIS PRODUCT. THE DURATION OF ANY IMPLIED WARRANTIES, INCLUDING THE WARRANTIES OF MERCHANTABILITY AND FITNESS FOR A PARTICULAR PURPOSE, IS HEREBY LIMITED TO THE FIVE YEAR DURATION OF THIS

WARRANTY. Some

- states do not allow limitations on how long an implied warranty lasts, so the above limitation may not apply to you.
- This warranty gives you specific legal rights, and you may have other rights which vary from state to state. If you have any questions concerning this warranty, please write Resideo Customer Care, 1985 Douglas Dr, Golden Valley, MN 55422 or call 1-800-468-1502.

Resideo Inc., 1985 Douglas Drive North Golden Valley, MN 55422

- **Printed in U.S.A.**
- This product is manufactured by Resideo Technologies, Inc., Golden Valley, MN, 1-800-468-1502
- ©2023 Resideo Technologies, Inc. The Honeywell Home trademark is used under license from Honeywell International Inc. All rights reserved. 69-2251EFS—05 S.A. Rev. 03-23

www.resideo.com

Documents / Resources

	<p>Honeywell T827 Series Heat Only Vertical Thermostat [pdf] Owner's Manual T827 Series Heat Only Vertical Thermostat, T827 Series, Heat Only Vertical Thermostat, Vertical Thermostat, Thermostat</p>
---	--

References

- [User Manual](#)

[Manuals+](#), [Privacy Policy](#)

This website is an independent publication and is neither affiliated with nor endorsed by any of the trademark owners. The "Bluetooth®" word mark and logos are registered trademarks owned by Bluetooth SIG, Inc. The "Wi-Fi®" word mark and logos are registered trademarks owned by the Wi-Fi Alliance. Any use of these marks on this website does not imply any affiliation with or endorsement.