



# Honeywell Midas-M Multi Gas Sensor Cartridge User Manual

[Home](#) » [Honeywell](#) » Honeywell Midas-M Multi Gas Sensor Cartridge User Manual 

## Contents

- [1 Honeywell Midas-M Multi Gas Sensor Cartridge](#)
- [2 Introduction](#)
- [3 What's in the Box](#)
- [4 Overview](#)
- [5 Warranty](#)
- [6 Documents / Resources](#)
  - [6.1 References](#)
- [7 Related Posts](#)

# Honeywell

**Honeywell Midas-M Multi Gas Sensor Cartridge**



## Introduction

The Midas-M Sensor Cartridge enables the detection of a wide range of asphyxiant, toxic, flammable, pyrophoric, corrosive, and oxidizer (including Oxygen) gases.

The plug & play Sensor Cartridge is located inside the detector's chassis.

## CAUTION

Failure to observe the following precautions can cause injury to persons or damage to property:

- When the Midas-M Sensor Cartridge reaches the end of its life, it should be disposed of by local regulations.
- Do not use cleaning solvents or abrasives to clean the Sensor Cartridge.
- Do not attempt to modify the product in any way from the manufacturer's design or specification.  
Warranty will be void and malfunction of the gas detector may result.
- Use only genuine spare parts and accessories with Midas-M. Malfunctions may result if non-standard parts are used.
- Installation must be by the recognized standards of the appropriate authority in the country concerned.  
For Europe, see EN60079-14, EN60079- 29-2, and EN61241-14. For installations in North America, the National Electrical Code (NFPA 70) should be strictly observed. All the appropriate local and national regulations should be observed.

**NOTE:** If the customer breaks down the sensor cartridge by disassembling, modifying, careless use (physical and chemical damage), or other unauthorized alteration, the quality is not guaranteed and is excluded from the free replacement.

## What's in the Box

- 1 Sensor Cartridge
- 1 battery module, only when the BiAS sensor is included in the cartridge
- 1 Quick Reference Guide

## Overview

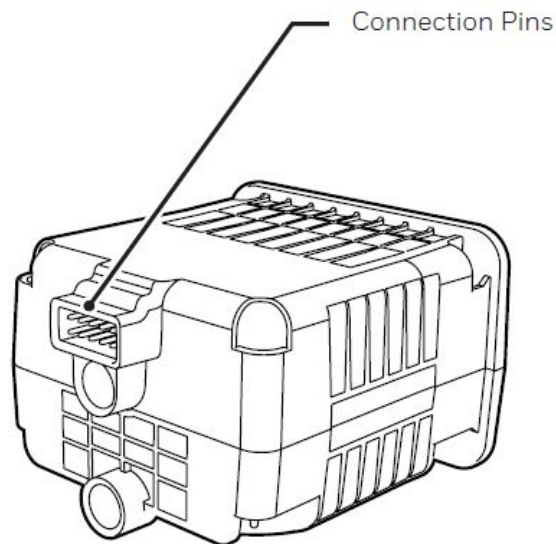

## Mounting the Sensor Cartridge

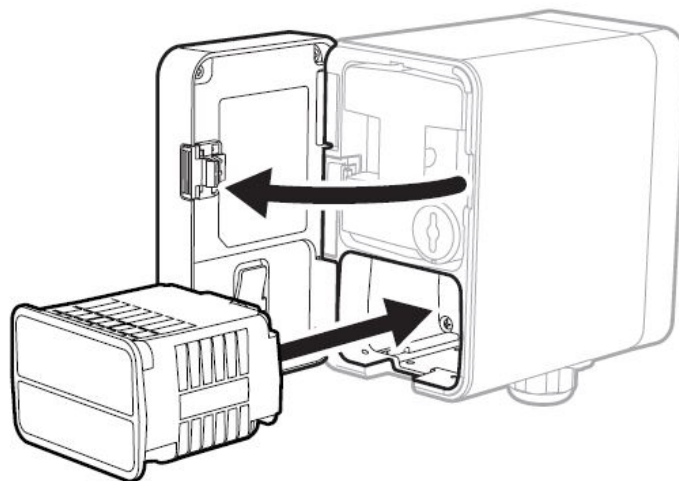

1. Turn the power off
2. Open the door and remove the BiAS battery module and the two plug caps.
3. Align the Sensor cartridge pins with the socket in the sensor cartridge chamber and then push the sensor cartridge gently until fully seated.
4. Close the door.

Press the 'O' button to clear the "Detect New Cartridge " message.

- Confirm that the green LED is flashing, and that the yellow and red LEDs are off.
- Confirm the display shows a concentration of zero (as appropriate).

## Warranty

Midas-M sensor cartridges carry a 12 month (1 year) warranty from switch-on/installation or up to 18 months from the date of shipment from Honeywell Analytics, whichever is less, provided this takes place before the "Activate Before" date on the cartridge. Pro-rata after "Activate Before"/install by date.

The oxygen sensor cartridge is guaranteed to operate satisfactorily for the period described above and will be replaced at no charge within that period only if it will not provide a correct reading after calibration by Authorized Service personnel. Physical or chemical damage, resulting from exposure to improper elements, is not covered.

The combustible (LEL) sensor cartridge is guaranteed to operate satisfactorily for the period described above. If it

will not provide a correct reading after calibration by Authorized

Service personnel, it will be replaced at no charge within that period. This guarantee is void if it has been contaminated by some unusual substance, including but not limited to, water and/or other liquids, oily compounds, corrosives, silicones, lead vapors, extremely high concentrations of combustible gases, and various particulates which may inhibit gas flow to the sensor cartridge element.

The toxic sensor cartridges are guaranteed to operate satisfactorily for the period described above. They will be replaced at no charge within that period only if they will not provide a correct reading after calibration by Authorized Service personnel, and only if the sensor cartridge membranes exhibit no physical or chemical damage resulting from exposure to improper substances.

Note that the Midas-OM sensor cartridge stores an electronic history of each individual sensor cartridge's manufacture, warranty and calibration activity that is accessible by authorized Service personnel.

## **Contact Us**

### **Americas**

Honeywell Analytics  
405 Barclay Boulevard  
Lincolnshire, IL 60069  
Tel: +1 847 955 8200  
Toll free: +1 800 538 0363  
Fax: +1 847 955 8208  
[detectgas@honeywell.com](mailto:detectgas@honeywell.com)

### **Europe, Middle East, and Africa**

Life Safety Distribution  
AG(LSD)  
Javastrasse 2  
8604 Hegnau  
Switzerland  
Tel: +41 (0)44 943 4300  
Fax: +41 (0)44 943 4398  
[gasdetection@honeywell.com](mailto:gasdetection@honeywell.com)

Asia Pacific, India.  
Honeywell Analytics Asia Pacific, Co., Ltd.  
7F SangAm IT Tower,  
434 Worldcup Buk-ro, Mapo-gu,  
Seoul 03922, South Korea  
Tel: +82 (02) 6909 0300  
Fax: +82 (02) 2025 0388  
India Tel: +91 124 4752 700  
[Analytics.ap@honeywell.com](mailto:Analytics.ap@honeywell.com)

### **Mainland China**

Honeywell Industrial Safety Gas Detectors  
Building#L, 555 Huanke Road Zhang Jiang  
Hi-Tech Park Pudong New Area Shanghai  
201203, China  
Tel: 021-80386800  
Fax: 021-60246070  
[gaschina@honeywell.com](mailto:gaschina@honeywell.com)

### **Taiwan**

Honeywell Taiwan Ltd  
6F-2, No.8, ZiQiang S. Road, Jubei City,

30264 Taiwan  
Tel:+886-3-5169284  
Fax: +886-3-5169339  
[analytics.tw@honeywell.com](mailto:analytics.tw@honeywell.com)

Manuals and other information about this product are available at:  
[www.honeywellanalytics.com/en/products/Midas-M](http://www.honeywellanalytics.com/en/products/Midas-M)

## Documents / Resources

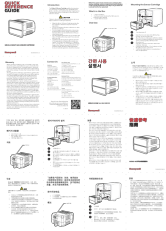
	<p><a href="#">Honeywell Midas-M Multi Gas Sensor Cartridge</a> [pdf] User Manual Midas-M, Multi Gas Sensor Cartridge, Midas-M Multi Gas Sensor Cartridge, Gas Sensor Cartridge, Sensor Cartridge, Cartridge</p>
---	--

## References

- [H Gas Leak & Flame Detection | Honeywell](#)

[Manuals+](#)