



Honeywell CSHUB3WHI Transform Any Outlet Into Connected Power Control User Guide

[Home](#) » [Honeywell](#) » Honeywell CSHUB3WHI Transform Any Outlet Into Connected Power Control User Guide

Contents

- 1 [Honeywell CSHUB3WHI Transform Any Outlet Into Connected Power Control](#)
- 2 [About](#)
- 3 [Safety Instruction](#)
- 4 [Know Your Device](#)
- 5 [Installation Guide](#)
- 6 [Installation](#)
- 7 [Connect the Outlet to the Hub](#)
- 8 [Cleaning the Device](#)
- 9 [Key parameters](#)
- 10 [Specifications:](#)
- 11 [FCC Radiation Exposure Statement](#)
- 12 [ISED RSS WARNING](#)
- 13 [FAQ](#)
 - 13.1 [Q: What should I do if the indicator lights are not functioning as described?](#)
 - 13.2 [Q: Can this device be used in a ceiling installation?](#)
- 14 [Documents / Resources](#)
 - 14.1 [References](#)
- 15 [Related Posts](#)

Honeywell CSHUB3WHI Transform Any Outlet Into Connected Power Control



USER GUIDE

MODEL: CSHUB3WHI

About

The Honeywell Connected Power Hub works in conjunction with Honeywell Connected Power Outlets. A Hub will support up to 50 Outlets and up to 50 Hubs will link into a Building Management System (BMS).

The communication between the Hubs and Outlets is via RF Mesh. The Hubs are wired into the BMS network. The Hub complies with UL / cUL62368-1, UL cUL 2043 (plenum) & FCC , IC. This device complies with Part 15 of the FCC Rules.

Operation is subject to the following two conditions: (1) this device may not cause harmful interference, and (2) this device must accept any interference received, including interference that may cause undesired operation.

Safety Instruction

- Ensure that each wire is connected to the appropriate terminal, as shown in the back cover diagram.
- Each terminal accepts rigid (solid) or stranded cable up to 14 AWG conductors.
- Product and packaging should be disposed and / or recycled where appropriate at the end of their life.
- Only an authorized person should open the device enclosure.

Know Your Device

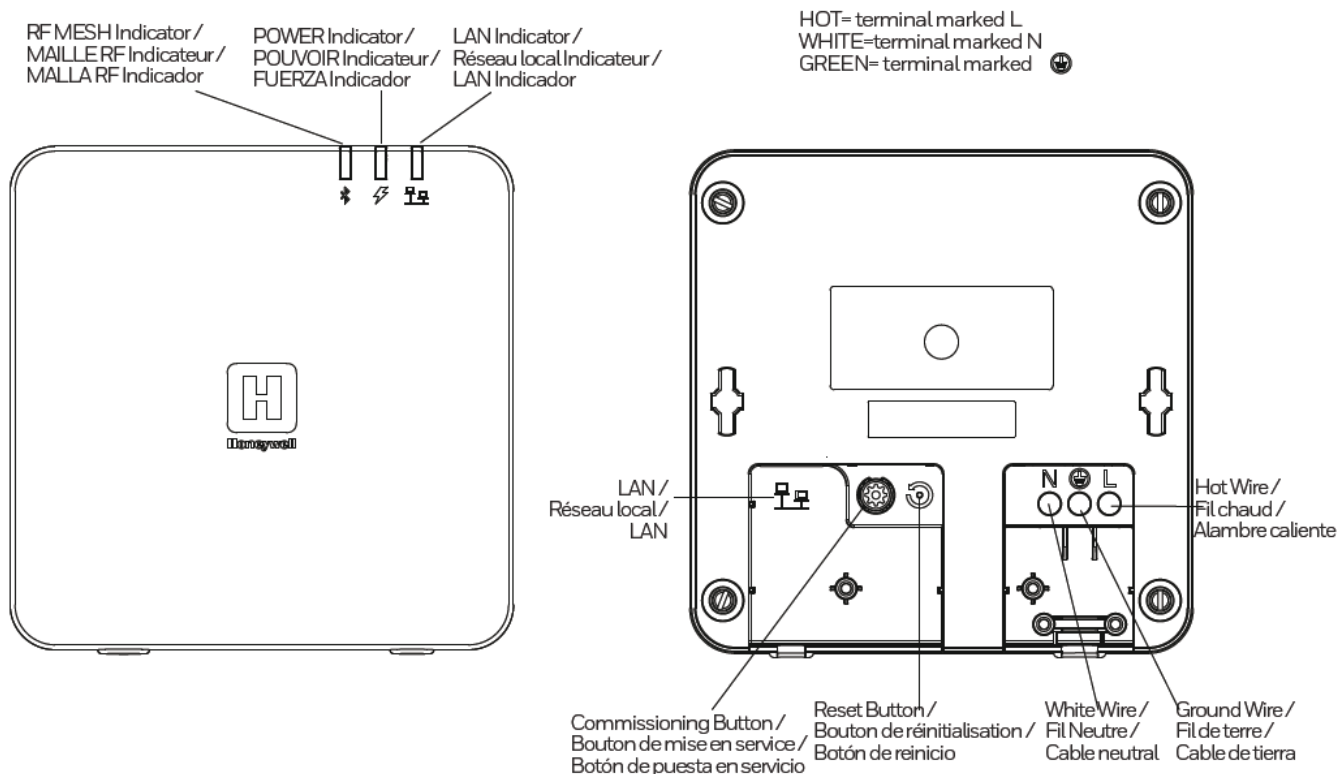

Indicator	Indicator Status	Description
RF MESH Indicator	Green Flash	Bluetooth network normal
	Yellow Flash	All outlets under the hub leave
POWER Indicator	Green	Power on
	Green Flash	Commissioning mode
LAN Indicator	Green Flash	LAN normal
	Yellow Flash	Network lost

Installation Guide

- This product has backed-out terminals ready to receive the cables.
- This product is a Class II device and requires mains power. There are three terminals supplied on the product – Hot, White & Ground. The Ground terminal is not required to be connected.
- Allow adequate slack for cable ends to reach the terminals.
- The conductors should now be connected to the respective terminals as described. Take care to select the cable with the appropriate sleeve colour for each terminal. Ensure all cables are tightly clamped.
- LAN Port used for RJ45 connection to BMS.
- When install the product, make sure the wires don't be blocked.

Installation

NOTE With a standard junction box, wall or ceiling installation is applicable for the installation. The following installation takes wall mounting as an example.

2 screws in box for installation, recommended screw sizes:
P+ UNC 6-32 X 25 (X2).

1. Dettach the installation Bracket by screw driver from the slots on the left and right side of deivce.

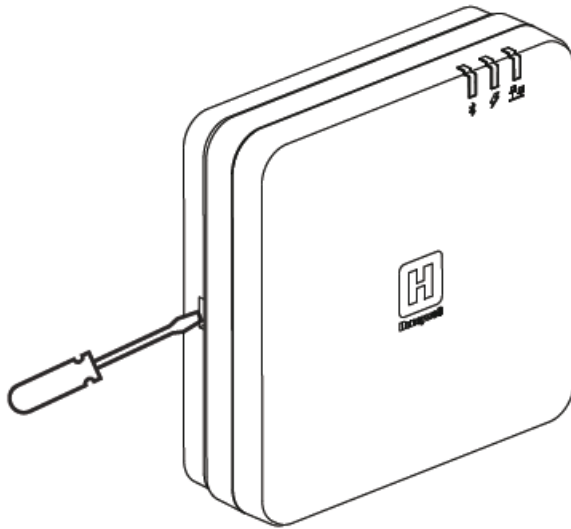

2. Dettach the RJ45 Cover and Terminal Cover by screw driver

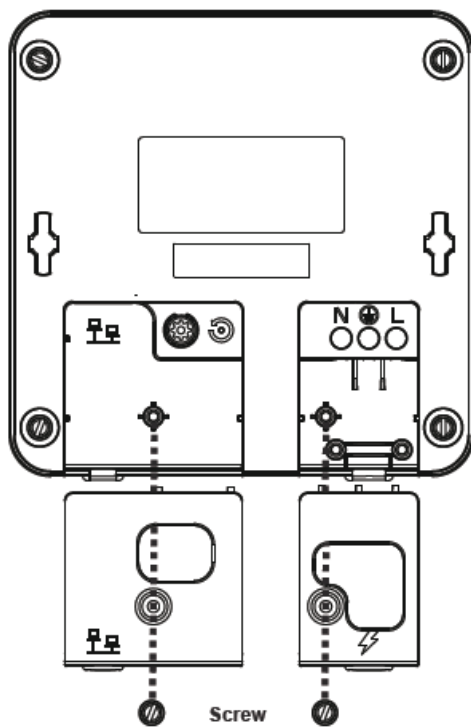

3. Connect the terminal wires and RJ45 cable.

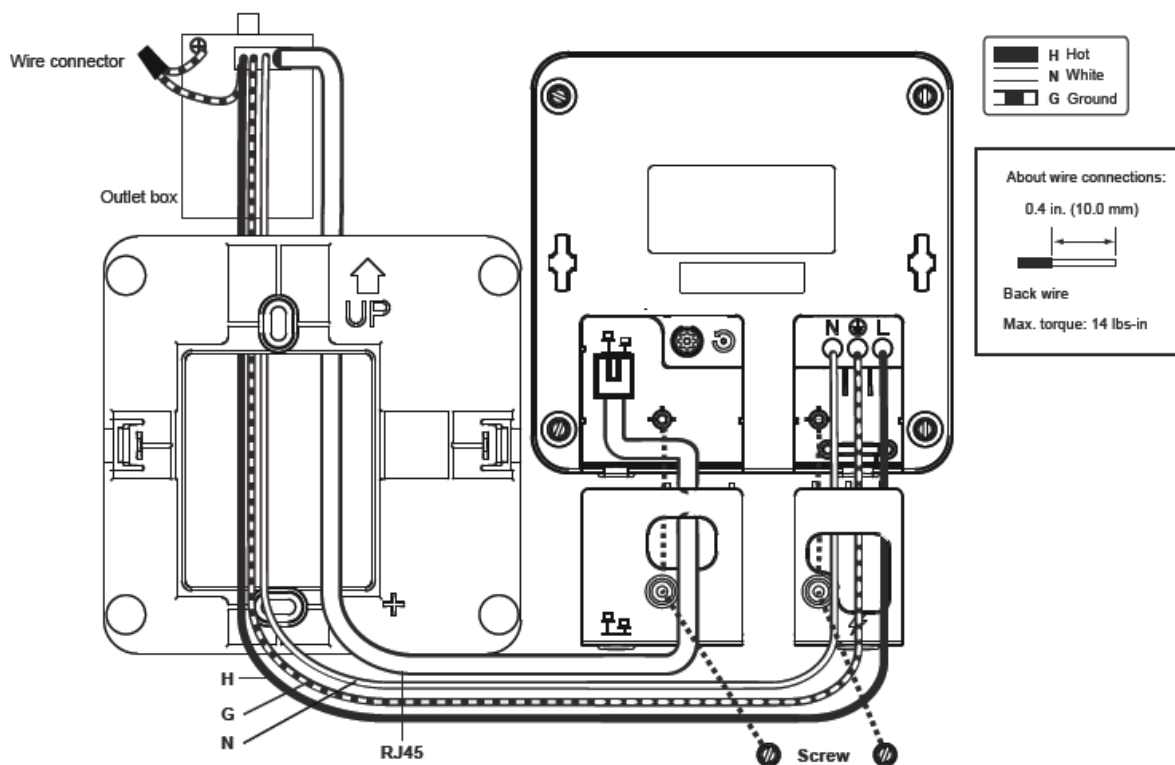

4. Fixing the Installation Bracket to the Junction Box on the wall by screws. And then fixing the device by snap-fit. Make sure the wires don't be blocked. /

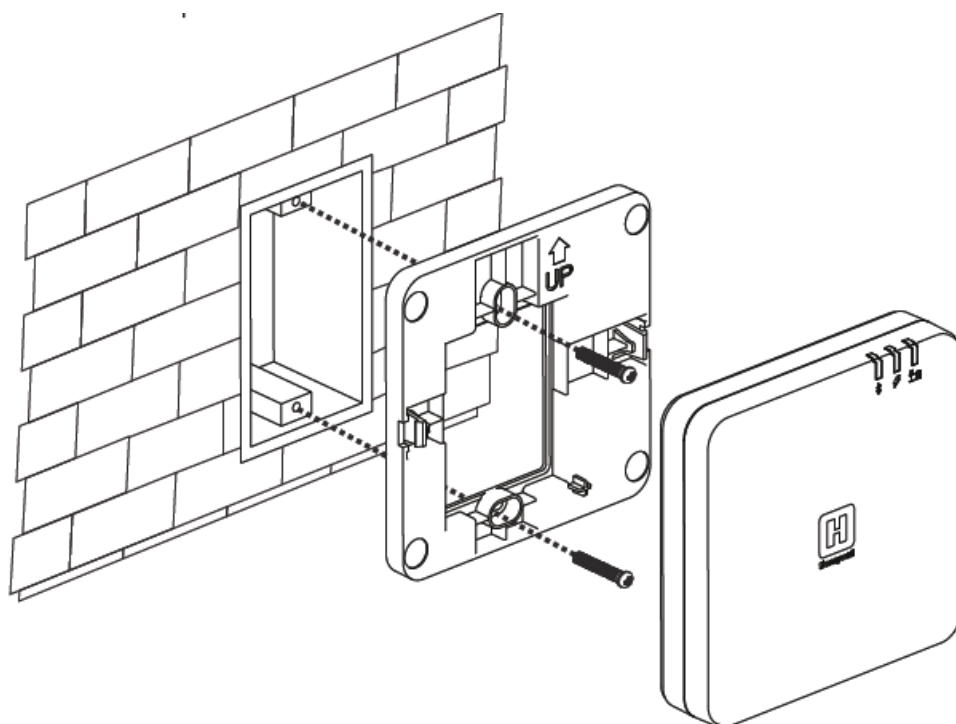

Connect the Outlet to the Hub

- Power up the Hub, it will enter Commissioning mode automatically. The installer can connect the Outlets to the Hub using Commissioning App.

Please note: After power up or long pressing (5s) the Commissioning Button the Hub will remain in commissioning mode for 7 days.

- Long pressing (20s) Reset Button will make the Hub reset.

Cleaning the Device

To protect the quality surface finish of the device, periodic cleaning should only consist of polishing with a dry lint free soft cloth. On no account should abrasive or domestic cleaners be used.

Key parameters

- Frequency Band: 2400 ~ 2483.5 MHz
- RF Max Power Output: <20 dBm

NOTE: This equipment has been tested and found to comply with the limits for a Class B digital device, pursuant to part 15 of the FCC Rules.

These limits are designed to provide reasonable protection against harmful interference in a residential installation. This equipment generates, uses and can radiate radio frequency energy and, if not installed and used in accordance with the instructions, may cause harmful interference to radio communications. However, there is no guarantee that interference will not occur in a particular installation.

If this equipment does cause harmful interference to radio or television reception, which can be determined by turning the equipment off and on, the user is encouraged to try to correct the interference by one or more of the following measures:

- Reorient or relocate the receiving antenna.
- Increase the separation between the equipment and receiver.
- Connect the equipment into an outlet on a circuit different from that to which the receiver is connected.
- Consult the dealer or an experienced radio/TV technician for help.

Warning:

This device complies with part 15 of the FCC Rules. Operation is subject to the following two conditions: (1) This device may not cause harmful interference, and (2) this device must accept any interference received, including interference that may cause undesired operation.

Caution:

Changes or modifications not expressly approved by the party responsible for compliance could void the user's authority to operate the equipment.

Specifications:

- Model: CSHUB3WHI
- Manufacturer: Honeywell International Inc.
- Address: 12 Clintonville Rd, Northford, CT 06472
- Wire Connections: Hot (H), White (N), Ground (G)
- Installation: Wall or ceiling
- Recommended Screw Sizes: P+ UNC 6-32 X 25 (X2)

FCC Radiation Exposure Statement

This equipment complies with FCC radiation exposure limits set forth for uncontrolled environment. This equipment should be installed and operated with minimum distance of 20 cm between the radiator and your body.

This transmitter must not be co-located or operating in conjunction with any other antenna and transmitter.

ISED Radiation Exposure Statement:

This equipment complies with ISED RSS-102 with radiation exposure limits set forth for an uncontrolled environment. This equipment should be installed and operated with minimum distance 20cm between the radiator & your body. This transmitter must not be co-located or operating in conjunction with any other antenna and transmitter.

ISED RSS WARNING

This device contains licence-exempt transmitter(s)/receiver(s) that comply with Innovation, Science and Economic Development Canada's licence-exempt RSS(s). Operation is subject to the following two conditions:

- (1) This device may not cause interference.
- (2) This device must accept any interference, including interference that may cause undesired operation of the device.

For further guidance, capability and instruction please scan the QR Code.



Honeywell International Inc.
12 Clintonville Rd, Northford, CT 06472

buildings.honeywell.com

©2023 Honeywell International Inc.

FAQ

Q: What should I do if the indicator lights are not functioning as described?

A: If the indicator lights are not displaying the correct colors or patterns, please ensure all connections are secure and follow the installation instructions carefully.

Q: Can this device be used in a ceiling installation?

A: Yes, this device is suitable for both wall and ceiling installations. Follow the provided instructions for proper installation.

Documents / Resources

	Honeywell CSHUB3WHI Transform Any Outlet Into Connected Power Control [pdf] User Guide CSHUB3WHI Transform Any Outlet Into Connected Power Control, CSHUB3WHI, Transform Any Outlet Into Connected Power Control, Outlet Into Connected Power Control, Connected Power Control, Power Control
---	--

References

- [H Building Automation](#)
- [User Manual](#)

[Manuals+](#), [Privacy Policy](#)

This website is an independent publication and is neither affiliated with nor endorsed by any of the trademark owners. The "Bluetooth®" word mark and logos are registered trademarks owned by Bluetooth SIG, Inc. The "Wi-Fi®" word mark and logos are registered trademarks owned by the Wi-Fi Alliance. Any use of these marks on this website does not imply any affiliation with or endorsement.