

## Honeywell Home T6590A Fan-Coil Controller Installation Guide

[Home](#) » [Honeywell Home](#) » Honeywell Home T6590A Fan-Coil Controller Installation Guide 

### Honeywell Home T6590A Fan-Coil Controller Installation Guide



## Contents

### 1 Installation

### 2 Wiring

2.1 Application 0: Two Pipes, Heating only

2.2 Application 1: Two Pipes, Cooling only

2.3 Application 2: Two pipes, Heating or Cooling, Manual changeover

2.4 Application 3: Two pipes, Heating or Cooling, Auto changeover

2.5 Application 4, 5 & 7 (T6590B ONLY / SEULEMENT T6590B / T6590B SOLTANTO / SOLO T6590B): Four pipes, Heating & Cooling, Manual or Auto changeover

2.6 Application 6 (T6590B ONLY / SEULEMENT T6590B / T6590B SOLTANTO / SOLO T6590B) : Two pipes, Heating or Cooling with Auxiliary electric heater

### 3 Applications

3.1 T6590A (2 Pipe Model)

3.2 T6590B (4 Pipe Mode)

### 4 Installer Setup Mode

### 5 Installer Parameters Table

### 6 Support

### 7 Documents / Resources

7.1 References

### 8 Related Posts

## Installation

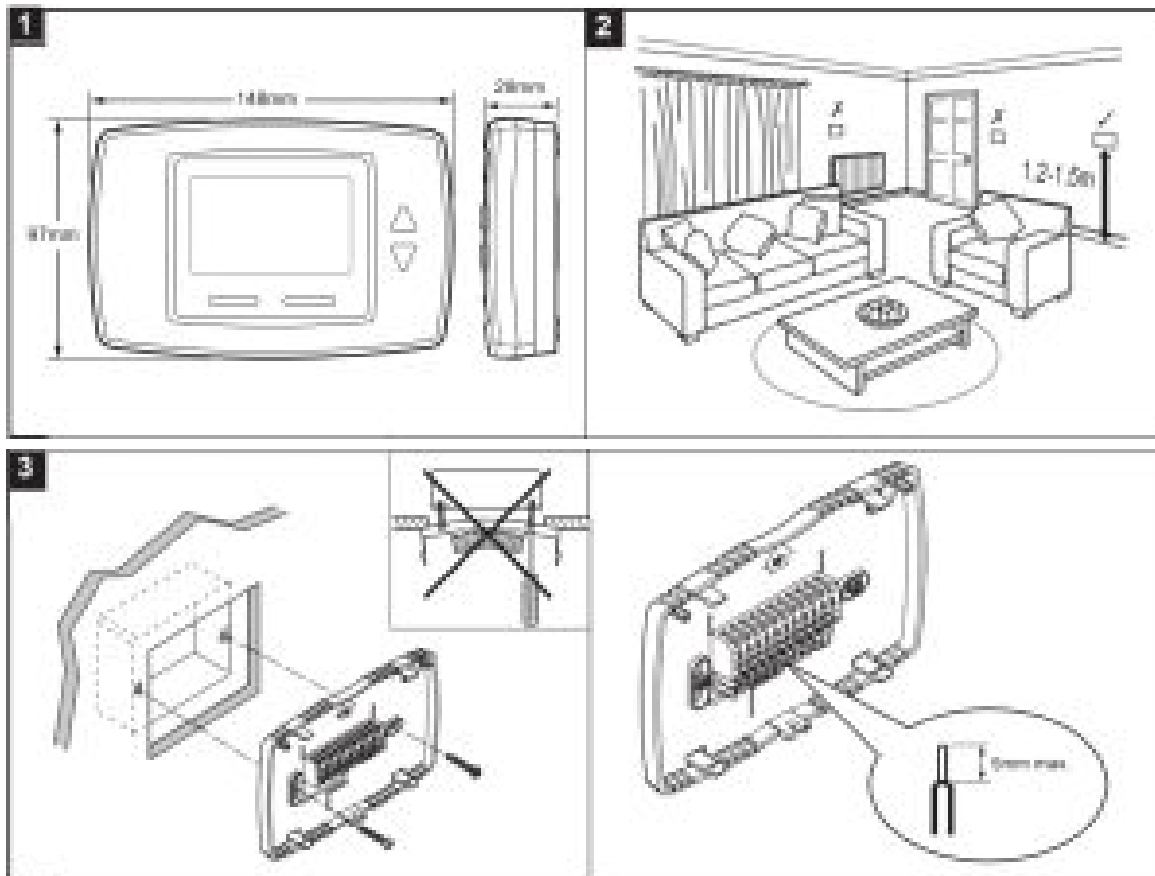

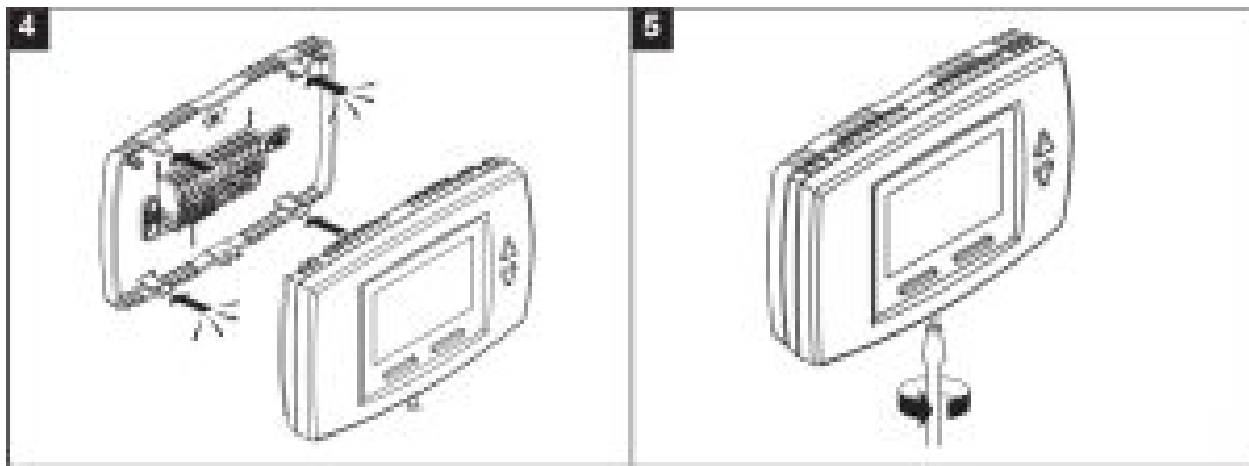

## Wiring

### Application 0: Two Pipes, Heating only

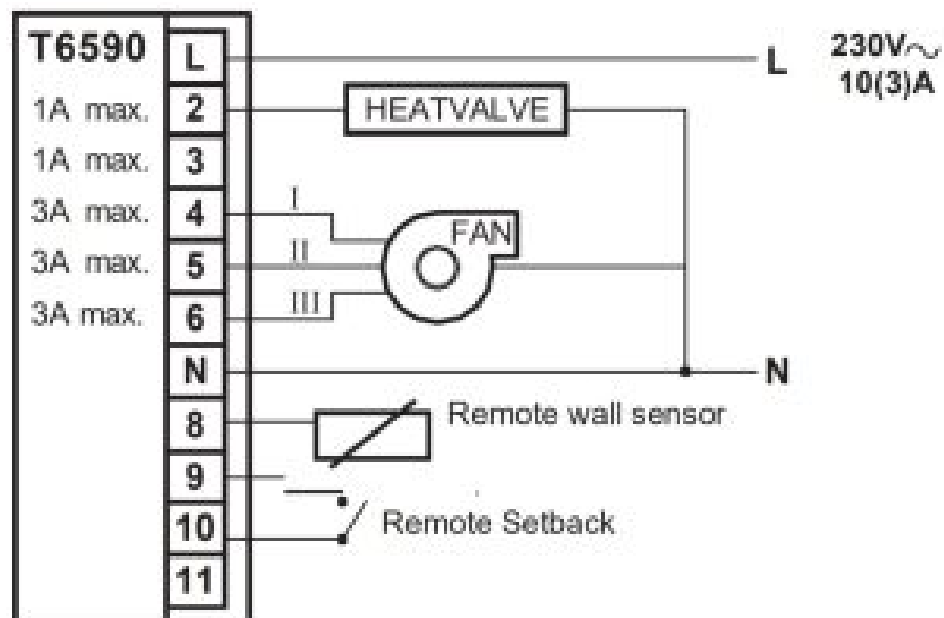

### Application 1: Two Pipes, Cooling only

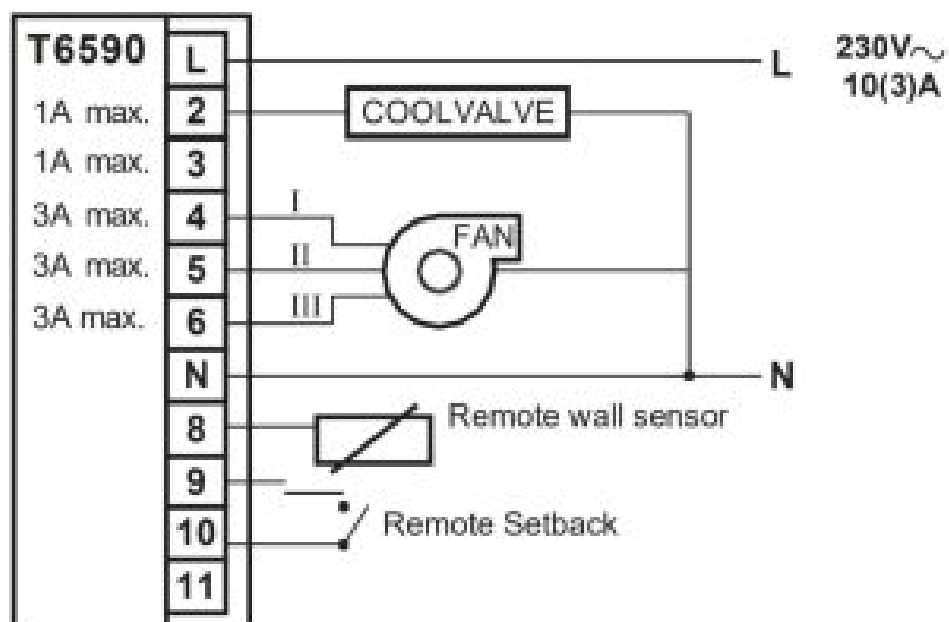

**Application 2: Two pipes, Heating or Cooling, Manual changeover**

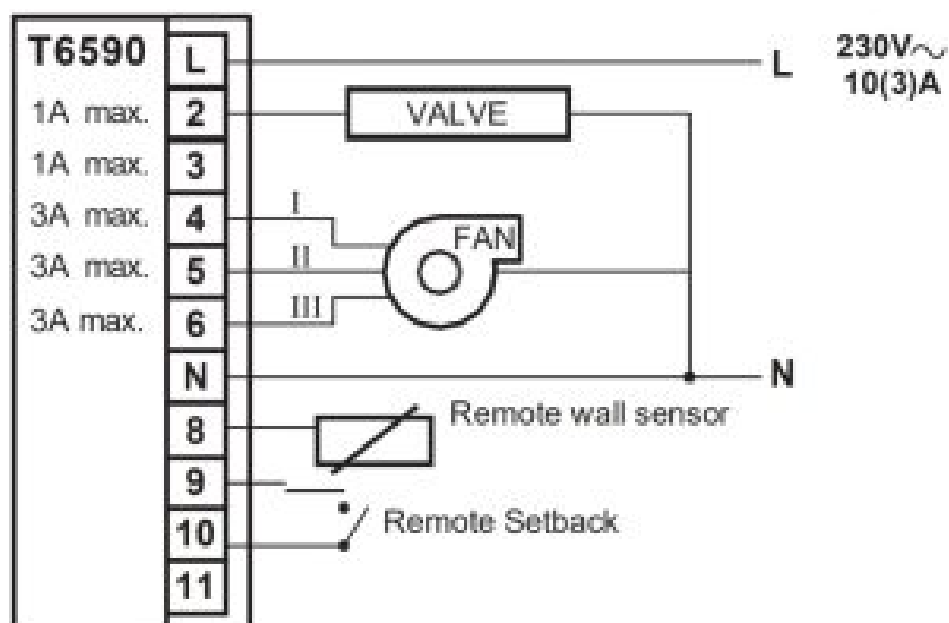

**Application 3: Two pipes, Heating or Cooling, Auto changeover**

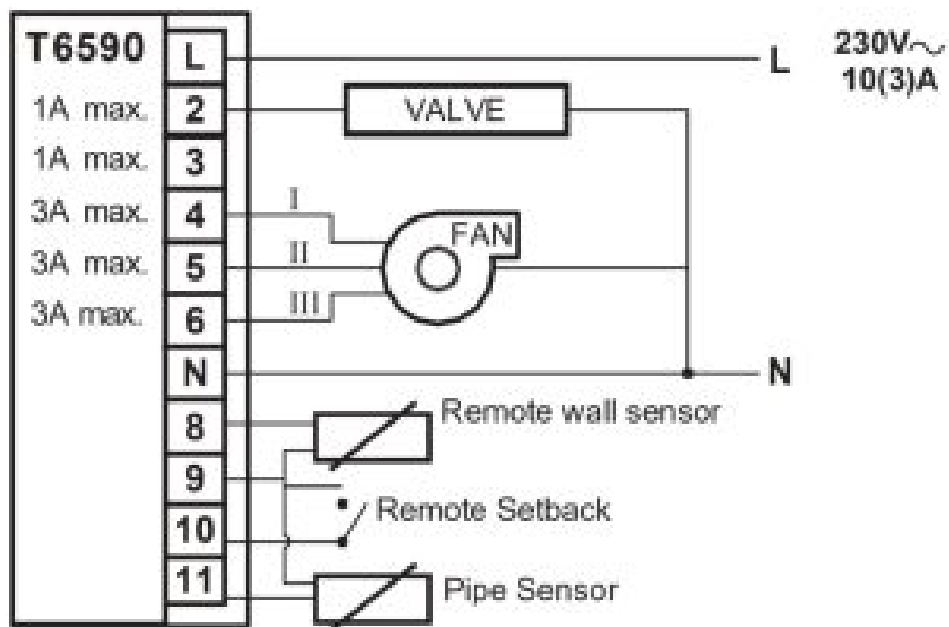

**Application 4, 5 & 7 (T6590B ONLY / SEULEMENT T6590B / T6590B SOLTANTO / SOLO T6590B): Four pipes, Heating & Cooling, Manual or Auto changeover**

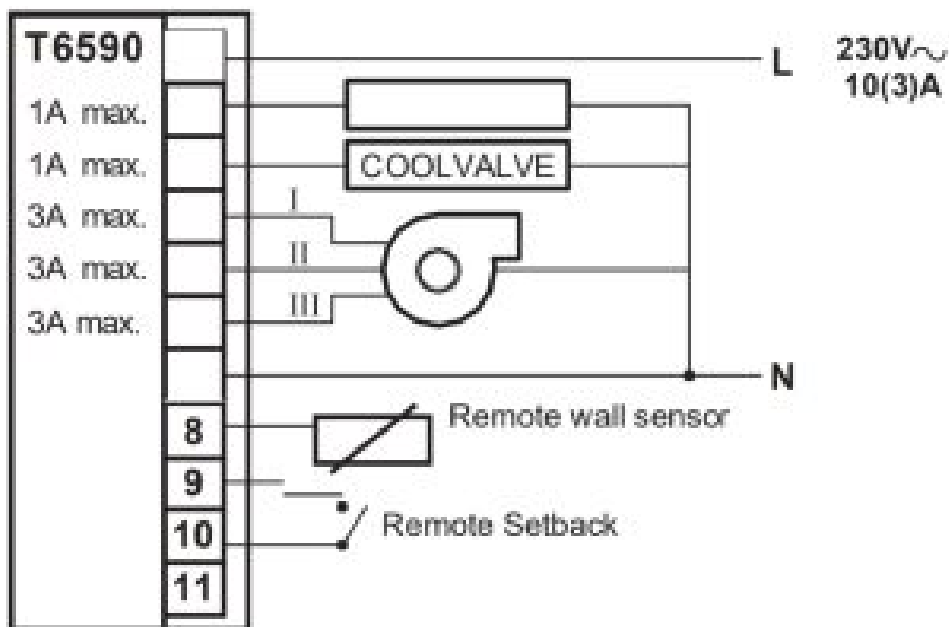

**Application 6 (T6590B ONLY / SEULEMENT T6590B / T6590B SOLTANTO / SOLO T6590B) : Two pipes, Heating or Cooling with Auxiliary electric heater**

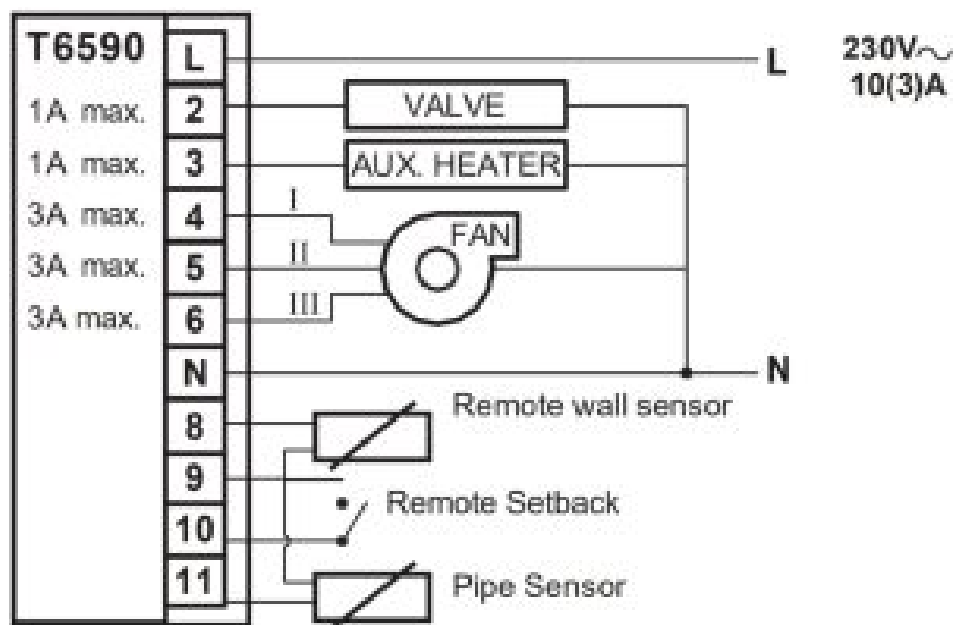

## Applications

### T6590A (2 Pipe Model)

Applica tion	Description	Changeover	Fan sp eed	Rem ote s ensor	Pipe sens or	Remo te set back	Auxili ary H eater	Outp ut typ e
0	2 pipe system, heating only	—	ON/OFF F, 1/2/3, AUTO	•	—	•	—	ON, OFF
1	2 pipe system, cooling only	—	ON/OFF F, 1/2/3, AUTO	•	—	•	—	ON, OFF
2	2 pipe system, 1 stage heat or 1 stage cool	Manual	ON/OFF F, 1/2/3, AUTO	•	—	•	—	ON, OFF
3	2 pipe system, 1 stage heat or 1 stage cool, auto changeover	Seasonal Chan geover	ON/OFF F, 1/2/3, AUTO	•	•	•	—	ON, OFF

### T6590B (4 Pipe Mode)

Applica tion	Description	Changeover	Fan sp eed	Rem ote s ensor	Pipe sens or	Remo te set back	Auxili ary H eater	Outp ut typ e
0	2 pipe system, heating only	–	ON/OFF, 1/2/3, AUTO	•	–	•	–	ON, OFF
1	2 pipe system, cooling only	–	ON/OFF, 1/2/3, AUTO	•	–	•	–	ON, OFF
2	2 pipe system, 1 stage heat or 1 stage cool	Manual	ON/OFF, 1/2/3, AUTO	•	–	•	–	ON, OFF
3	2 pipe system, 1 stage heat or 1 stage cool, auto changeover	Seasonal Chan geover	ON/OFF, 1/2/3, AUTO	•	•	•	–	ON, OFF
4	4 pipe system 1 stage heat and 1 stage cool	Manual	ON/OFF, 1/2/3, AUTO	•	–	•	–	ON, OFF
5	4 pipe system 1 stage heat and 1 stage cool auto changeover	Auto changeover	ON/OFF, 1/2/3, AUTO	•	–	•	–	ON, OFF



6	2 pipe system, 1 stage heat or 1 stage cool with auxiliary electric heater	Manual with seasonal changeover	ON/OFF, 1/2/3, AUTO	•	•	•	•	ON, OFF
7	4 pipe system, mixed manual and auto	Manual / Auto changeover	ON/OFF, 1/2/3, AUTO	•	–	•	–	ON, OFF

## Installer Setup Mode

The T6590 is delivered with a set of pre-configured operational values that will allow the device to function immediately. However, in order to make the device compatible with a specific system, some of the internal settings may need to be changed. For information on the default values and the configurable options, please refer to the “**Installer Parameter Table**”.

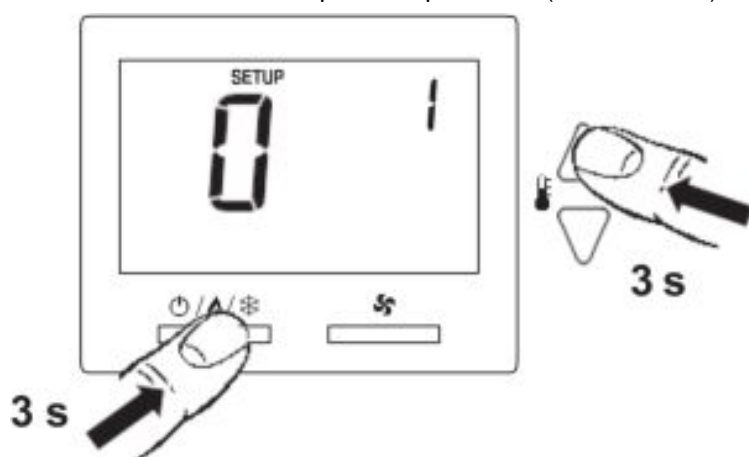

1. To enter the Installer Setup Mode, press the (  /  /  ) and  buttons together for 3 seconds.





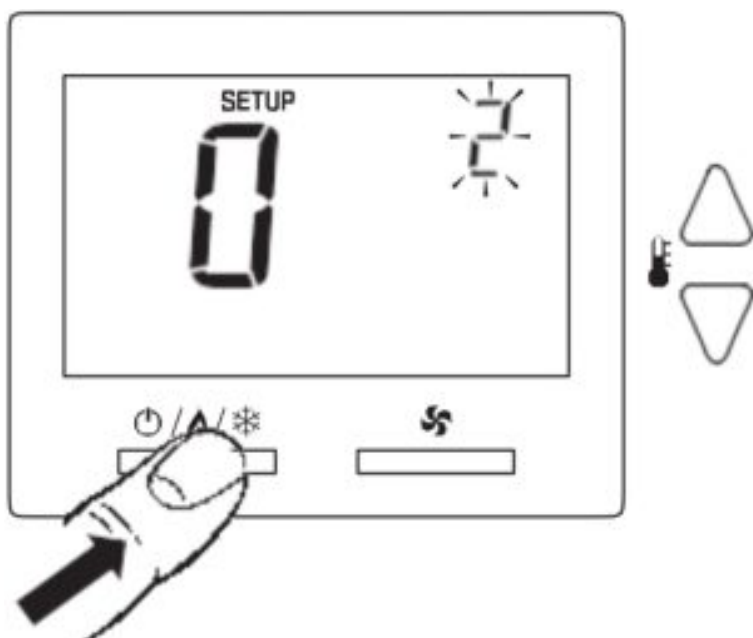

2. To index between the individual Parameters, use the (  /  /  ) button. It is only possible to move upwards through the parameters.



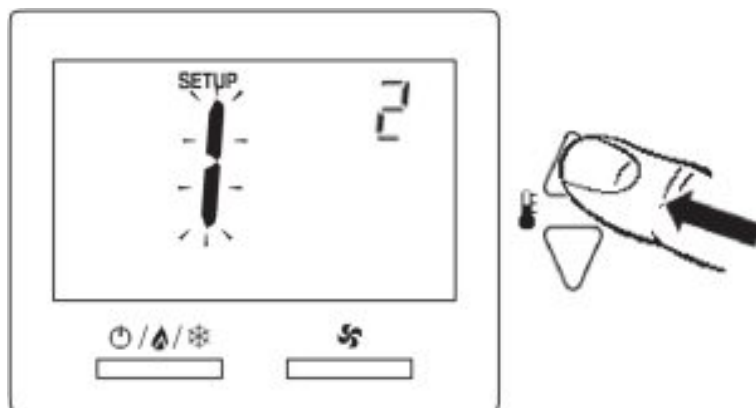

3. To change a selected parameter, use the  or  button.

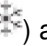

4. To save the altered settings, exit the Installer Setup Mode by Pressing the (  /  /  ) and  buttons together for 3 seconds. **NB:** If the Installer Setup Mode is exited by time-out (approximately 120 seconds), then the newly changed values will not be saved.

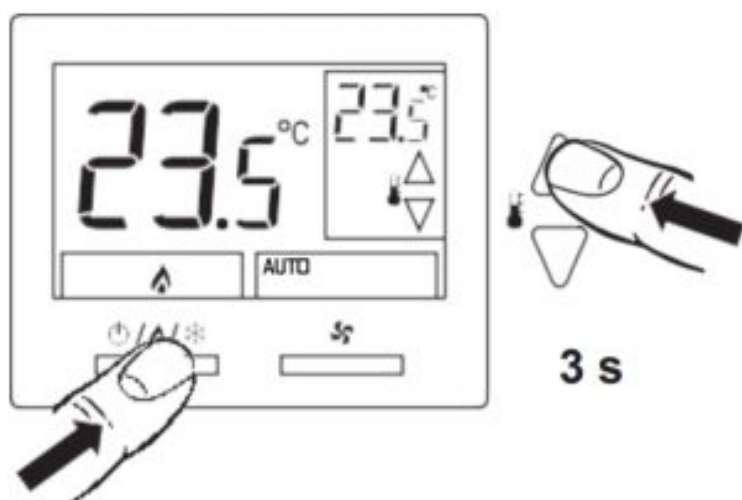

## Installer Parameters Table

Parameter No	Parameter	Setting
		0 = 2 Pipe system Heat Only

1	System Type	1 = 2 Pipe system Cool Only
		2 = 2 Pipe system 1H1C manual changeover
		3 = 2 Pipe system 1H1C auto changeover (default on T6590A)
		4 = 4 pipe system with manual changeover (not available on T6590A)
		5 = 4 Pipe system auto changeover (default on T6590B)
		6 = 2 pipe system 1H1C with Auxiliary Heater. Manual changeover
		7 = 4 pipe system, mixed manual and automatic changeover (not available on T6590A)
2	Valve output type	0 = NO* ON/OFF (Default)
		1 = NC** ON/OFF
3	Sensor Type	0 = Onboard Sensor (Default)
		1 = Remote Sensor
4	Pipe sensor (Note: This item will be automatically populated based on Parameter No.2)	0 = NO* input (Default = Heat)
		1 = NO* input (Default = Cool)
		2 = NC** input (Default = Heat)
		3 = NC** input (Default = Cool)
		4 = Analogue input (Default) (NTC20K, T7414C1012)
5	Threshold for pipe sensor cooling	10 – 18°C (Default)
6	Threshold for pipe sensor heating	24 – 32°C (Default)
7	Fan control type Fan stops in deadband	0 = Cycle or Constant (Default) (3 speed: Low->Med->High->Auto-> Low)
		1 = Constant only (3 speed: Low->Med->High-> Low)
8	Dead band for four pipes	1 – 5°C (Default = 2°C) (not available on T6590A)
9	Cycles Per Hour (CPH) value for heating	1 – 12 CPH (Default)
10	Cycles Per Hour (CPH) value for cooling	1 – 6 CPH (Default)
11	Cycles Per Hour(CPH) value for Auxiliary Heater	1 – 12 CPH (Default)
12	Display Temperature adjustment	-2 to +2°C (Default)

13	Temperature Display mode	0 = Room Temperature only
		1 = Setpoint only
		2 = Room Temperature and Setpoint (Default)
14	Heating setpoint Range Stops	10 – 32°C (Default)
15	Cooling setpoint Range Stops	10 – 32°C (Default)
16	Keypad Lockout	0 = All keys available (Default)
		1 = System button Locked out
		2 = Fan and System button Locked out
		3 = All buttons locked out
17	Remote setback	1 = Hotel card NO*, with 1 second software delay going from Unoccupied to Occupied; 2 minute delay going from Occupied to Unoccupied
		2 = Hotel card NC**, with 1 second software delay going from Unoccupied to Occupied; 2 minute delay going from Occupied to Unoccupied
		3 = Hotel Card enabled, NO*, with 1 second software delay going from Unoccupied to Occupied; 30 minute delay going from Occupied to Unoccupied
		4 = Hotel Card enabled, NC**, with 1 second software delay going from Unoccupied to Occupied; 30 minute delay going from Occupied to Unoccupied
18	Remote setback heating setpoint	10 – 21°C (Default)
19	Remote setback cooling setpoint	22 – 32°C (Default)
20	Activity Sensing (If no key is pressed after a certain period which is configured in this item, the system will enter Unoccupied mode)	0 = Disabled (Default)
		1 = 4 Hour Sensing
		2 = 12 Hour Sensing
		3 = 24 Hour Sensing. NB: Anytime the thermostat is not touched (no single key pressed), the thermostat will automatically fall back into Unoccupied setpoints. When any key is pressed, thermostat controls to occupied mode
21	Freeze Protection	0 = Disabled (Default)
21		1 = Enabled – Thermostat Cycles On Heat when room temperature reaches 4°C and disables Heat when room temperature reaches below 8°C. This feature cannot activate if the application is cool only

22	Auto Fan Reset	1 = Reset back to Auto after 2 hours (Not allowed when constant fan is selected in Parameter No.7). The start time is calculated after the initial call for heat
		2 = Reset back to Auto after 4 hours (Not allowed when constant fan is selected in Parameter No.7). The start time is calculated after the initial call for heat/cool
23	Fan run-on time after auxiliary heater is switched off	0 – 600 Sec. (Default)

## Support



[www.resideo.com](http://www.resideo.com)

### Ademco 1 GmbH

Hardhofweg 40

74821 Mosbach

**Phone:** +49 1801 466 388

[info.de@resideo.com](mailto:info.de@resideo.com)

[homecomfort.resideo.com](http://homecomfort.resideo.com)

@2020 Resideo Technologies, Inc. All rights reserved. The Honeywell Home trademark is used under license from Honeywell International Inc. This product is manufactured by Resideo Technologies, Inc and its affiliates.

# Honeywell Home

## Documents / Resources

	<a href="#">Honeywell Home T6590A Fan-Coil Controller</a> [pdf] Installation Guide T6590A, T6590B, Fan-Coil Controller
--	---

## References

-  [HoneywellHome comfort Europe from Resideo](#)
-  [Smart Home Products and Systems | Resideo](#)