



## Honeywell Home Smart Home Security Motion Sensor User Guide

[Home](#) » [Honeywell Home](#) » Honeywell Home Smart Home Security Motion Sensor User Guide 

# Honeywell Home

SMART HOME SECURITY MOTION SENSOR



This is a legacy product document supported by Resideo. It is no longer manufactured.



33-00335EF-03



#### Contents

[1 FCC Regulations](#)

[2 IC Regulations](#)

[3 Documents /  
Resources](#)

[4 Related Posts](#)

## FCC Regulations

### § 15.19 (a)(3)

This device complies with part 15 of the FCC Rules. Operation is subject to the following two conditions: (1) This device may not cause harmful interference, and (2) this device must accept any interference received, including interference that may cause undesired operation.

### § 15.21

Changes or modifications not expressly approved by the party responsible for compliance could void the user's authority to operate the equipment.

### 47 CFR § 15.105 (b)

FCC statement available at: <https://customer.resideo.com/en-US/support/residential/codes-andstandards/FCC15105/Pages/default.aspx>

#### **FCC Radiation Exposure Statement:**

This equipment complies with FCC radiation exposure limits set forth for an uncontrolled environment. This equipment should be installed and operated with a minimum distance 20cm between the radiator & your body.

## IC Regulations

This device complies with Industry Canada license-exempt RSS standard(s).

Operation is subject to the following two conditions:

1. this device may not cause interference, and
2. this device must accept any interference, including interference that may cause undesired operation of the device.

#### **IC Radiation Exposure Statement:**

This equipment complies with IC RSS-102 radiation exposure limits set forth for an uncontrolled environment. This equipment should be installed and operated with a minimum distance 20cm between the radiator & your body.

**Before you install your motion sensor...**



Your **Honeywell Home** app must be used to install and configure this sensor. You need to install the app first. **If your system is already installed**, open your Honeywell Home app to install the sensor.

**Please wait** to pull the tab on the sensor until you are **instructed by the app**.

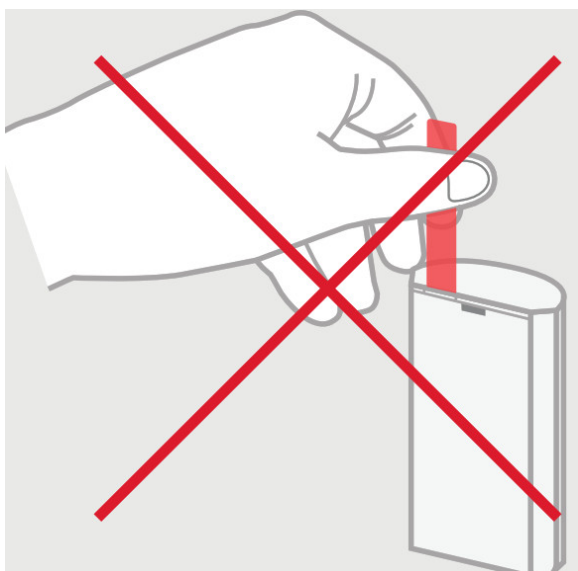

[www.resideo.com](http://www.resideo.com)

© 2021 Resideo Technologies, Inc. All rights reserved. 1985 Douglas Drive North, Golden Valley, MN 55422 1-800-468-1502 This product is manufactured by Resideo Technologies, Inc. and its affiliates.

**Documents / Resources**

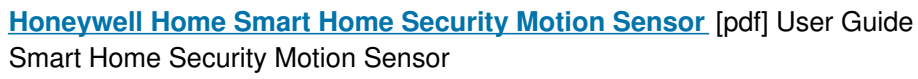

Manuals+,