

Honeywell Home Reverse Osmosis Filtration System User Guide

[Home](#) » [Honeywell Home](#) » Honeywell Home Reverse Osmosis Filtration System User Guide 

Honeywell Home Reverse Osmosis Filtration System

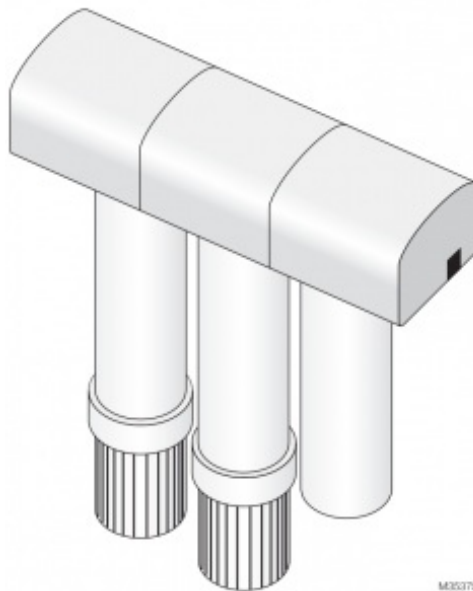

Contents

- 1 SPECIFICATIONS
- 2 DIMENSIONS
- 3 REVERSE OSMOSIS FILTRATION SYSTEM
- 4 PARTS INCLUDED
- 5 TOOLS NEEDED
- 6 OTHER REQUIREMENTS
- 7 SAFETY GUIDELINES
- 8 RO SYSTEM ASSEMBLY INSTALLATION
- 9 PLUMBING
 - 9.1 RO System
- 10 OPERATION
- 11 MAINTENANCE
- 12 TROUBLESHOOTING
- 13 MAINTENANCE PARTS
- 14 Documents / Resources
 - 14.1 References
- 15 Related Posts

SPECIFICATIONS

Specifications listed are based on average filter life of one year (one operating season for the steam humidifier).

Water Hardness	0-25 grains per gallon (gpg)
Water Pressure	30-120 pounds per square inch (psi)
Water Temperature	40°F – 100°F (only use on cold water supply)
Weight (RO System with water)	7 lbs.

DIMENSIONS

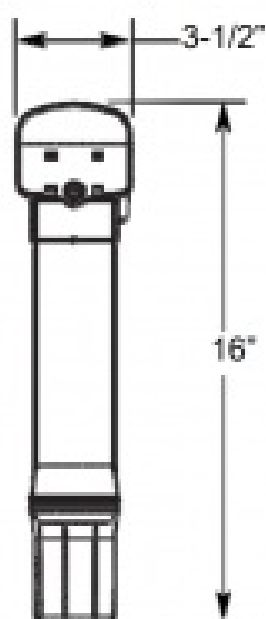
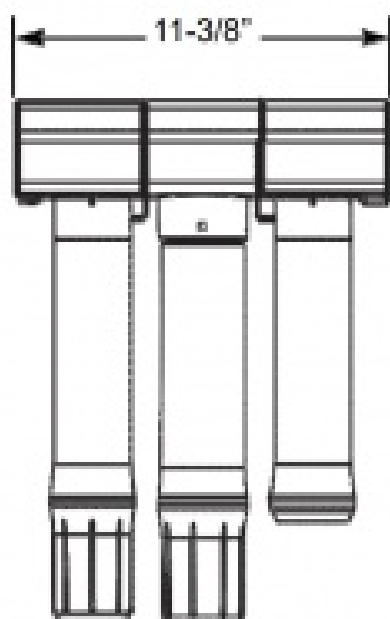

REVERSE OSMOSIS FILTRATION SYSTEM

This Reverse Osmosis (RO) filtration system removes dissolved solids and organic matter from water by passing it through a membrane which separates and flushes minerals and impurities from the water.

Install this system upstream of the steam humidifier's water inlet. It is recommended that the RO system's filters be replaced at least once per year to ensure optimal humidifier performance.

PARTS INCLUDED

RO System Assembly

(Model HM600XROF1/U)

- RO manifold assembly
- Supply tubing (one 20 ft. long, 1/4" dia. white tube)
- Adapter elbow (3/8" x 1/4")
- Drain line (one 6 ft. long, 1/4" dia. red tube)
- Mounting screws and washers
- Plug Fitting

Water Filters

- #1 – Sediment filter
- #2 – Reverse osmosis filter
- #3 – Staging tank

TOOLS NEEDED

- Crescent wrench
- Philips screwdriver

OTHER REQUIREMENTS

- If the RO filtration system or the humidifier is installed in finished space or above ceilings, it is required to install a water drip pan with a shutoff sensor under all water connections. See steam humidifier manual, Appendix C.

SAFETY GUIDELINES

- Read, understand and follow all steps, guides and requirements before installing the Reverse Osmosis (RO) filtration system.
- All water connections must comply with local and state plumbing and sanitation codes.
Reference, understand and comply with all governing codes before installing the RO filtration system.
- Do not install on hot water supply. Only use cold water supply.
- Do not install outside or in unconditioned space where there is potential for the water system to freeze.

RO SYSTEM ASSEMBLY INSTALLATION

1. Choose a location for the RO system assembly capable of holding up to 7 lbs.
2. Mark screw/washer location 9 inches apart.

3. Fasten screws and hanger washers.
 - Sheet metal install – use sheet metal screws (not provided).
 - Wood stud install – use provided wood screws and hanger washers.
4. Hang the RO system assembly on the hanger washers.
5. Connect Filter Assembly top cover.
6. Connect three filter cartridges in the order below by turning cartridge to the right, ensuring thread is properly engaged and seal is tight.
 - Align #3 staging tank with RO system assembly connection #3.
 - Align #2 RO filter with RO system assembly connection #2.
 - Align #1 sediment filter with RO system assembly connection #1.

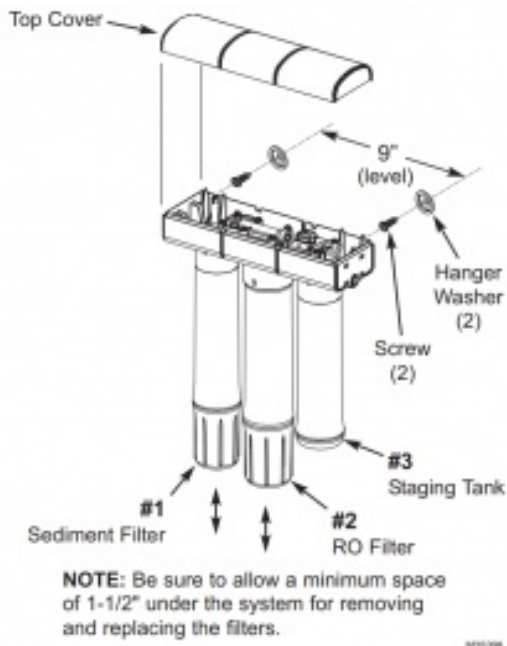

FIG. 2

PLUMBING

RO System

(HM600XROF1/U)

Drain Points for Reject Water

- Follow local codes for proper installation
- Refer to additional drain requirements in steam humidifier manual when coupling RO drain and humidifier drain

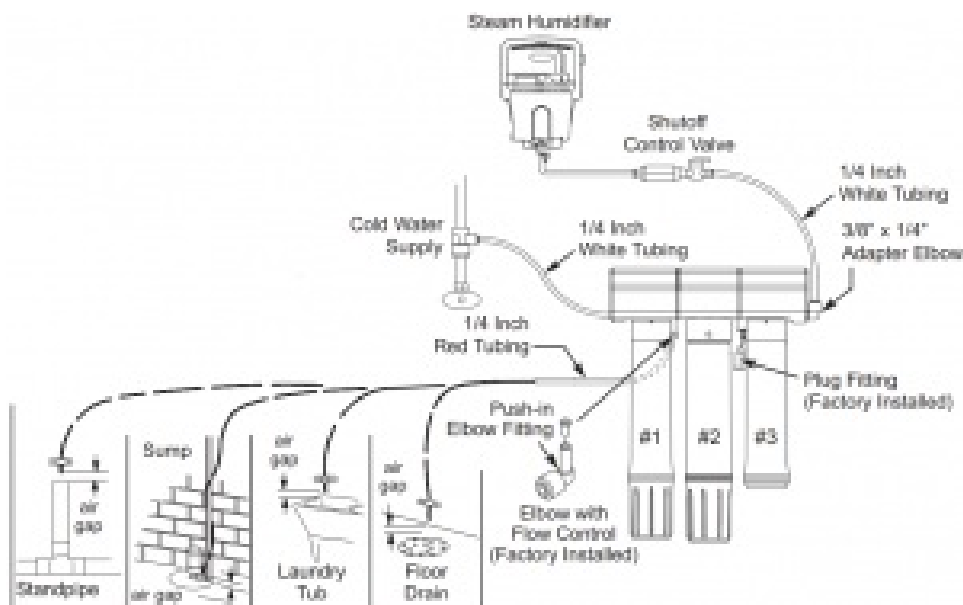

- Cut 1/4" dia. tubing lines to fit your installation.
Ensure all cuts are evenly made with no nicks, scratches or rough spots on the tube end.
- Longer tubing lengths – nylon or copper – may also be used (not provided). Ends of tubing must be round and free of burrs and scratches to seal properly.
- Install 3/8" x 1/4" adapter elbow into blue outlet port.
- Verify that the plug is in place in the yellow port on the base of the RO System.
- Locate the drain line (1/4" dia. red tube). Install one end of the line into the elbow that is preinstalled in the red port on the RO system.
Connect the other end of the line to a drain.
- Push tubing completely into applicable fitting by pushing past initial resistance and then applying light pulling force to ensure a tight fit.

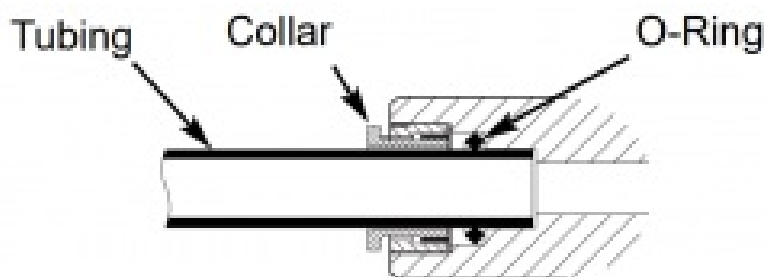

Tube Fully Engaged with Fitting

FIG. 4

– To remove tube from connection, depress collar and pull tubing.

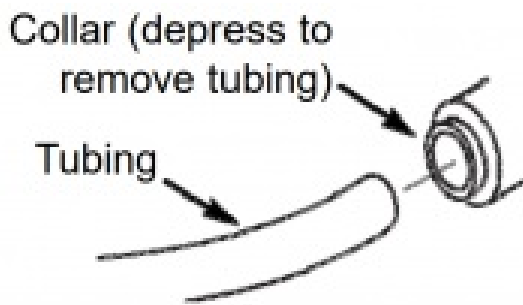

FIG. 5

- Water tube connections to the water supply, filter and steam humidifier must be checked for leaks after installation and a short period of operation.

OPERATION

RO System Assembly

The RO System Assembly directs the flow of water into the filters in numeric order, and out to the steam humidifier. A built-in backflow prevention valve prevents the backward flow of water from the storage tank. The shutoff/check valve provided with the steam humidifier must still be installed between the RO system and the steam humidifier.

#1 Sediment Filter

Cold water enters the sediment filter, reducing chlorine, sand, silt, dirt and other sediment. This filters the feed water before entering the RO filter.

#2 Reverse Osmosis (RO) Cartridge

Filtered water enters the RO filter where dissolved minerals are removed, effectively 'softening' the hardness of the water. This reduces the amount of solid mineral (scale/sediment) fallout inside the steam humidifier's tank. Reducing the amount of scale and sediment increases the time between manual cleanings of the steam humidifier.

#3 Staging Tank Canister

After leaving the storage tank, but before going to the steam humidifier, water enters the #3 staging tank canister. This canister holds the initial water that enters steam humidifier when the solenoid fill valve opens.

NOTE: It is normal to hear the RO System operating the first few days after the initial installation. This will dissipate as air is purged from the system.

MAINTENANCE

Replacement Steps – Water Filters

- It is recommended that the #1 sediment filter and #2 RO filter be replaced at least once per season or as needed.
- Do not replace the #3 staging tank. At the end of the humidification season, unscrew the #3 filter and empty any remaining water.
- When installing new filters, install #2 RO filter first, followed by the #1 sediment filter.

NOTE: Periodically check the flow control to be sure the small hole through it is clean and unrestricted. If the flow control requires service, remove and replace the cylindrical plastic flow control that is inserted into the elbow connector. If the flow control remains in the manifold when the elbow connector is removed, you will need to remove the drain ports collar and O-ring to retrieve it.

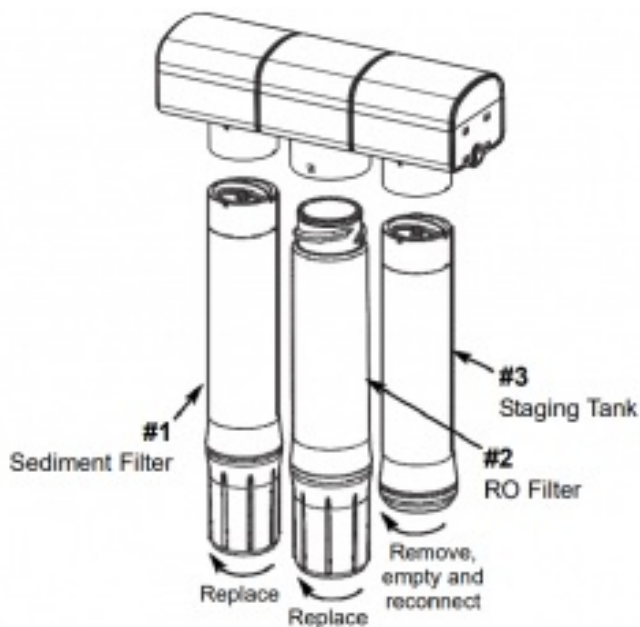

Turn cartridges in the direction of the arrow to remove. Turn them in the opposite direction to install.

FIG. 6

NOTE: Refer to the steam humidifier's manual for more detailed maintenance steps.

TROUBLESHOOTING

The following table refers to the steam humidifier's fault detection feature.

Number of “Service” red light blinks	Description	Possible Cause	Corrective Action
2	Water level sensors failed to detect tank water	Scaling on the sensor	Replace #1 sediment filter and #2 RO filter. See steam humidifier manual troubleshooting section for specific humidifier steps
3	Failed to fill steam humidifier tank	Expired #1 and #2 water filters	
		Missing flow control in drain line	Replace flow control
4	Heating element overheated	Scaling on element	See steam humidifier manual for cleaning steps
6	Water overflow sensed in humidifier tank	Heavy sediment in humidifier tank	
13	Tank failed to drain		
	Blinking “Cleaning required” light on steam humidifier		
	Continual water flow to drain	Check valve or automatic shut off assembly plugged or parts worn	Replace RO system

MAINTENANCE PARTS

Key No.	Part Number	Description
1	50046083-001	One #1 sediment filter
2	50046084-001	One #2 reverse osmosis (RO) filter
3	50046089-001	One #3 staging tank
4	50046086-001	Filter kit, including one #1 sediment filter, one #2 RO filter, and one f low control

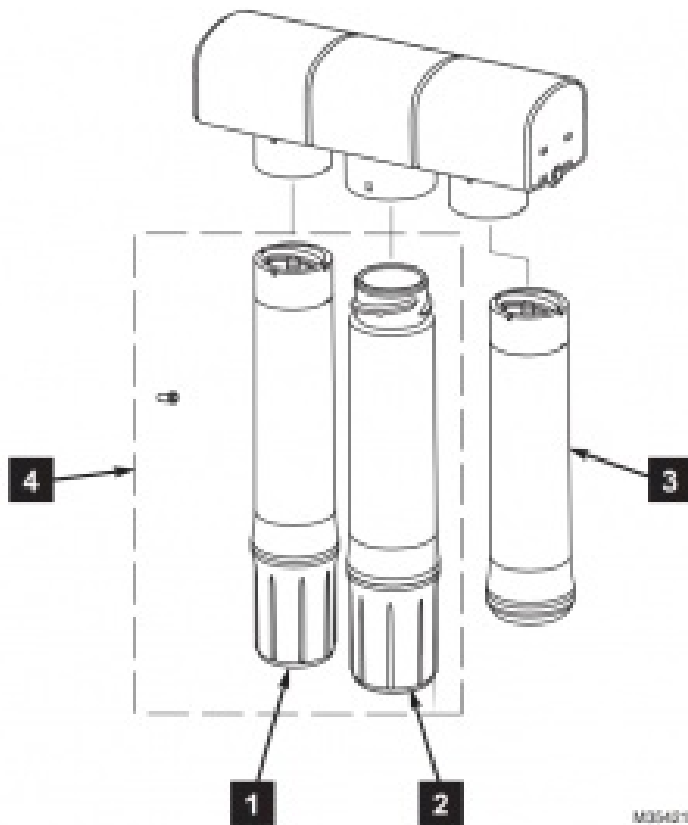
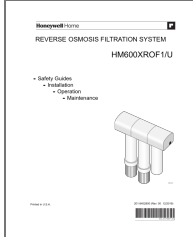

FIG. 7

Resideo Inc., 1985 Douglas Drive North,
Golden Valley, MN 55422

This product is manufactured by Resideo Technologies, Inc., Golden Valley, MN, 1-800-468-1502
©2019 Resideo Technologies, Inc. The Honeywell Home trademark is used under license from Honeywell International Inc. All rights reserved.

Documents / Resources

	Honeywell Home Reverse Osmosis Filtration System [pdf] User Guide HM600XROF1, HM600XROFU, Reverse Osmosis Filtration System
---	--

References

-  [Smart Home Products and Systems | Resideo](#)

Manuals+.