



HONDA PACKTALK EDGE Powerful Communication System User Guide

[Home](#) » [Honda](#) » HONDA PACKTALK EDGE Powerful Communication System User Guide 

HONDA PACKTALK EDGE Powerful Communication System User Guide



Contents

- 1 [Getting Started](#)
- 2 [Cardo Connect App](#)
- 3 [General](#)
- 4 [Radio](#)
- 5 [Music](#)
- 6 [Switch Source](#)
- 7 [Phone Call](#)
- 8 [DMC Intercom](#)
- 9 [Music Sharing](#)
- 10 [DMC Intercom](#)
- 11 [Phone Call](#)
- 12 [GPS Pairing](#)
- 13 [Universal Bluetooth Intercom](#)
- 14 [Reboot](#)
- 15 [Factory Reset](#)
- 16 [Voice Commands – Always On!](#)
- 17 [Documents / Resources](#)
 - 17.1 [References](#)
- 18 [Related Posts](#)

Getting Started

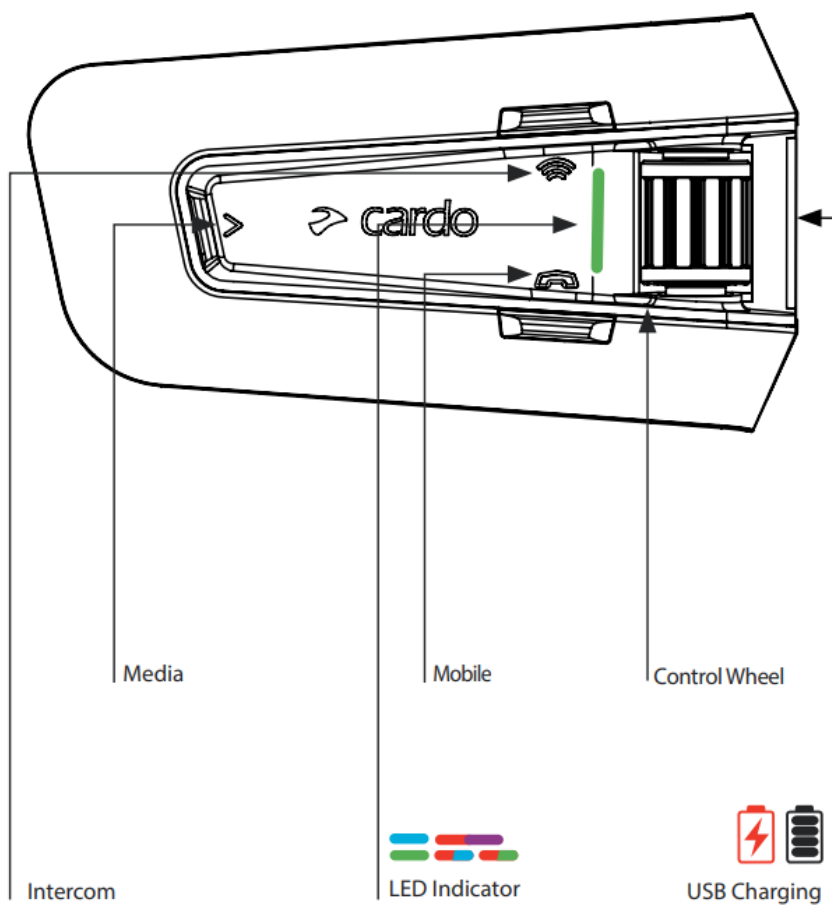

Press & Hold



Number of Taps



On / Off

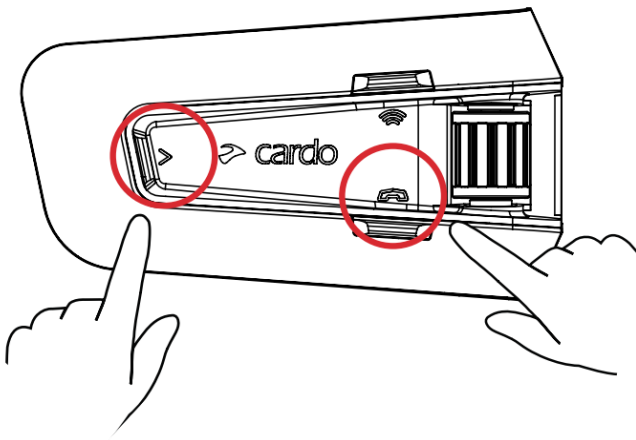

Phone Pairing

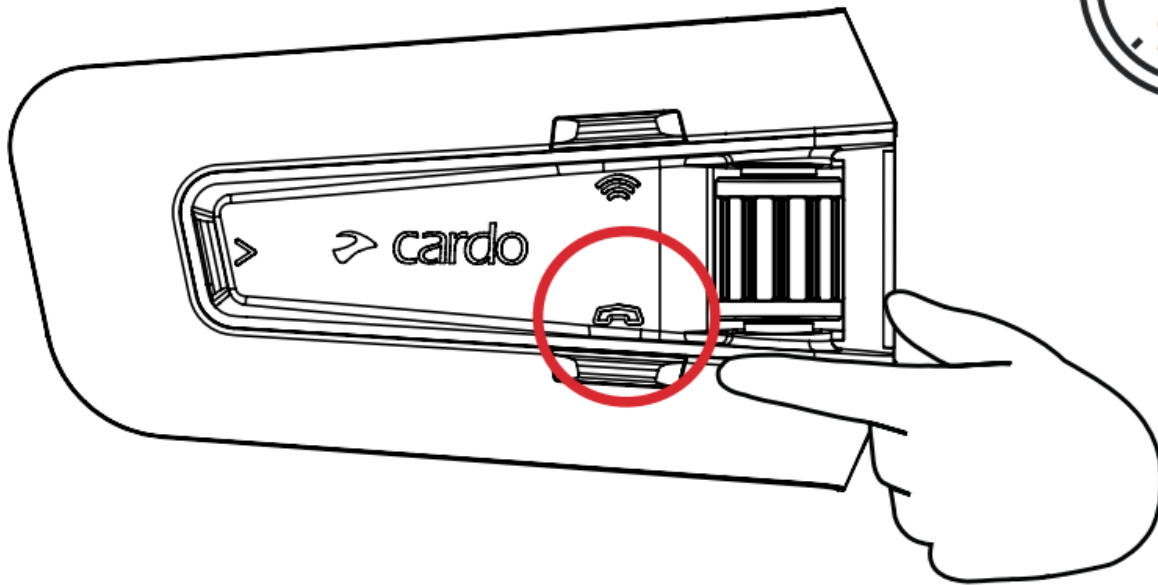

LED Red & Blue 
✓



Cardo Connect App



Download



Register

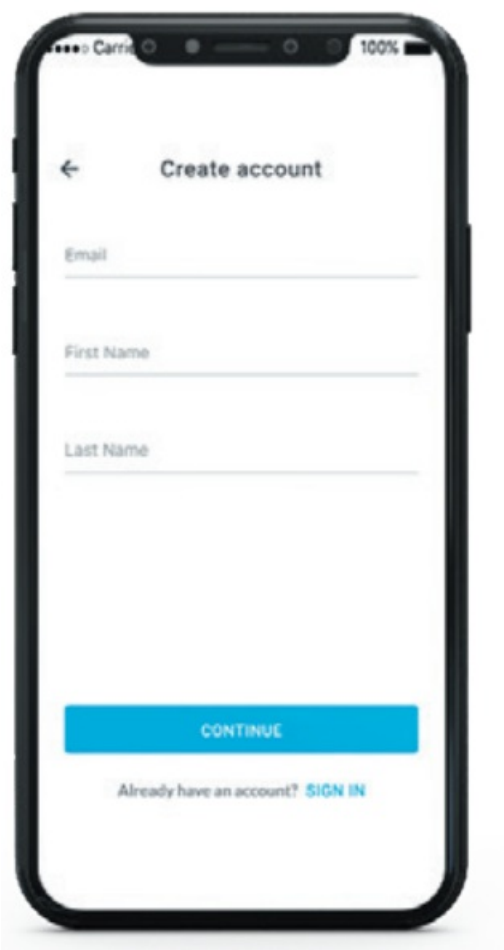

Choose Language



Update Software

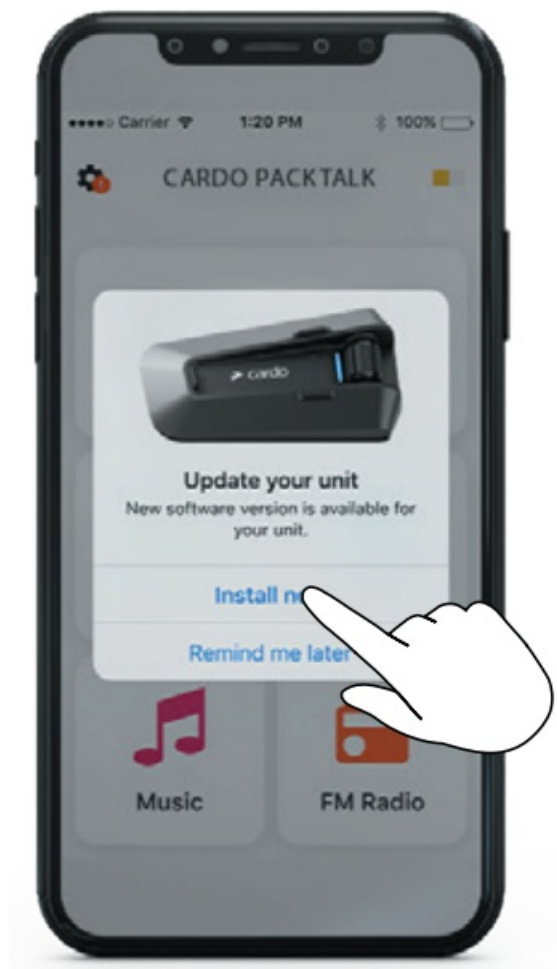

General



Volume Up

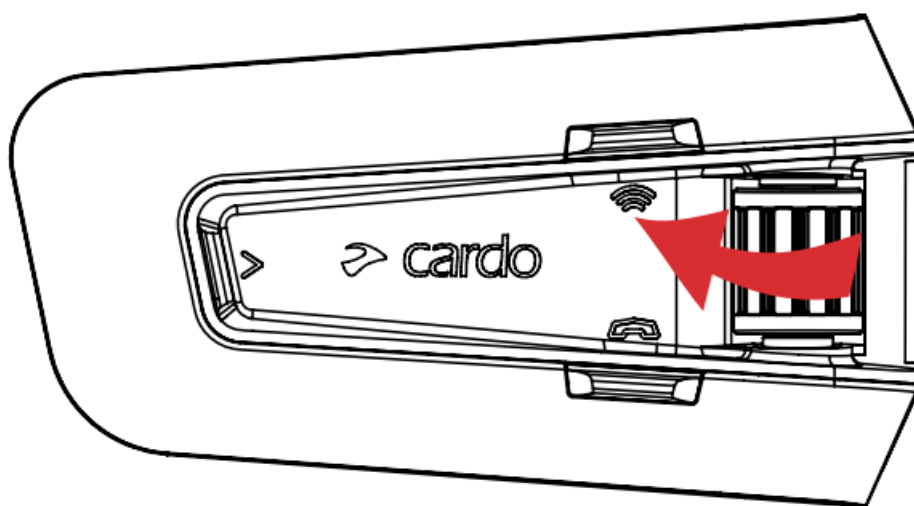

Volume Down

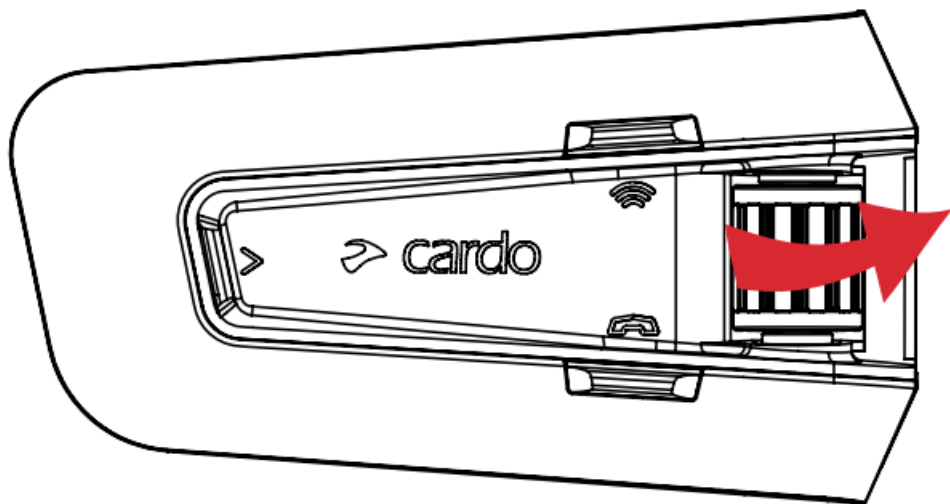

Mute / Unmute Microphone

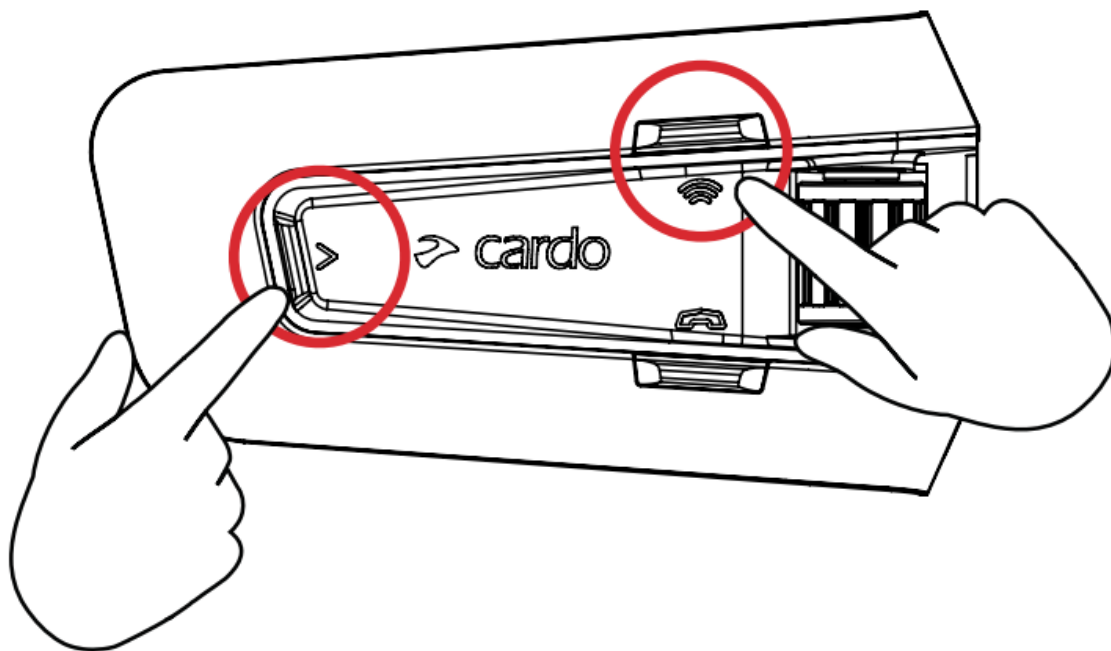

Voice Assistant

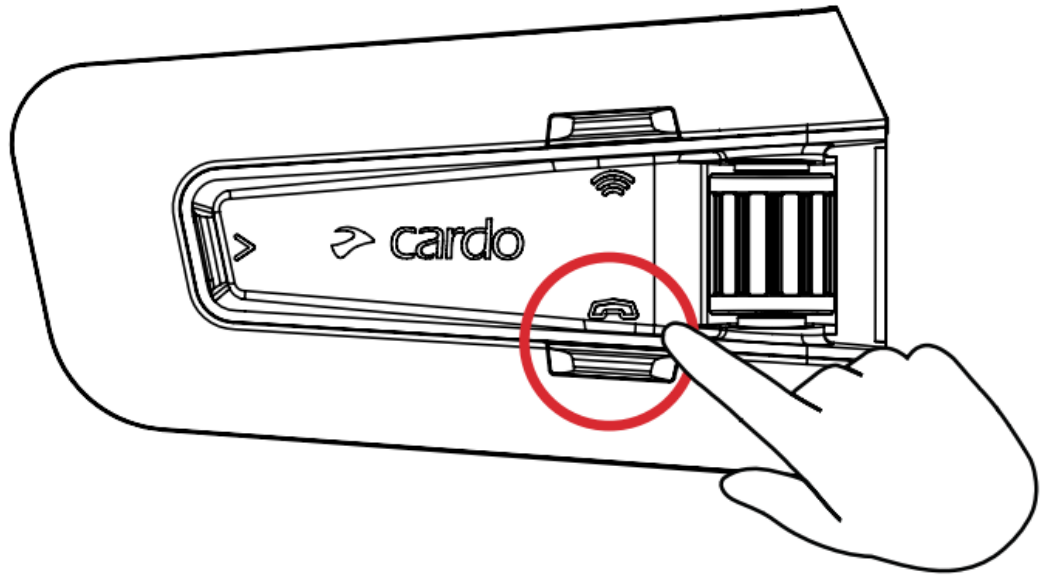

Siri



Google Assistant

Radio



Set Presets

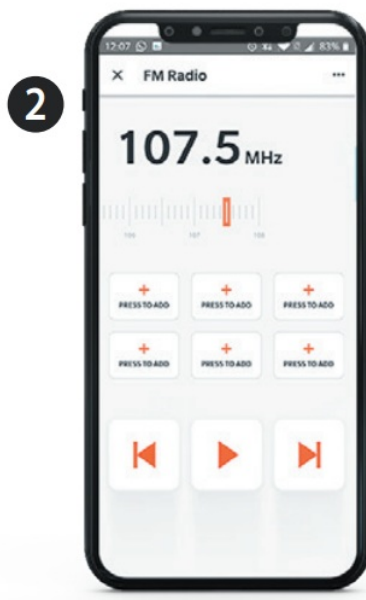
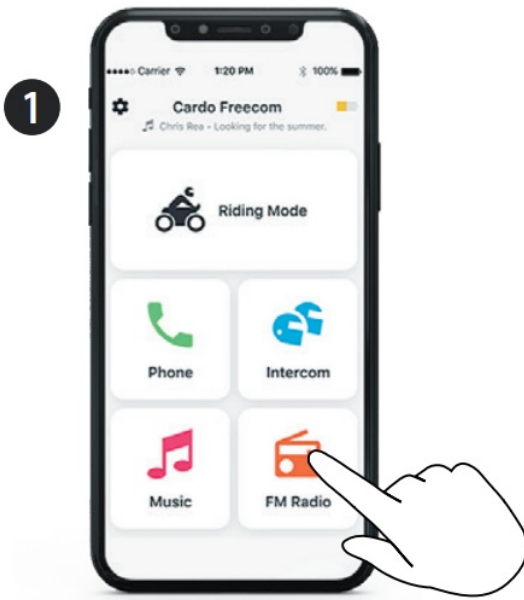

On

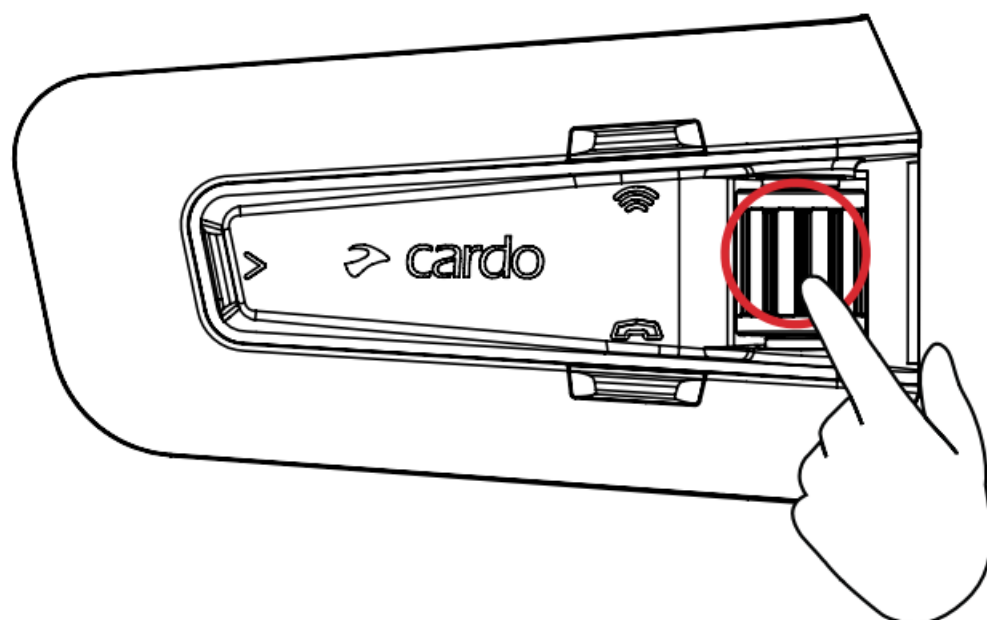
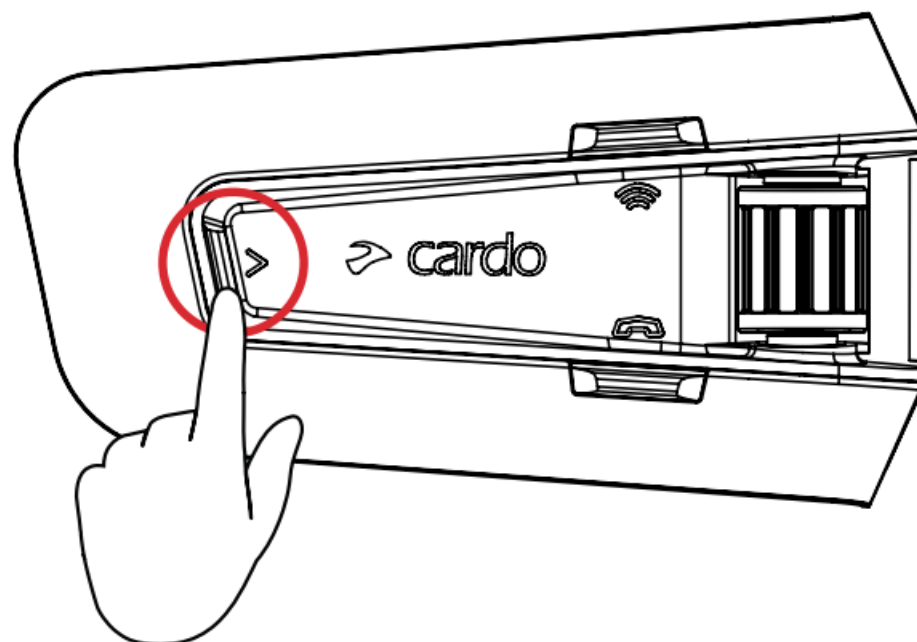

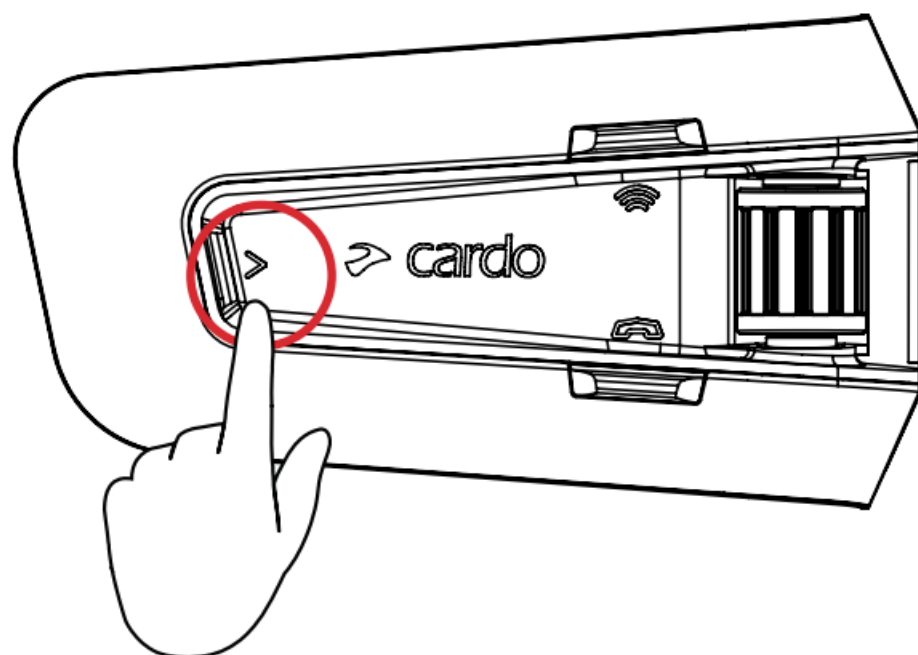

Previous Preset

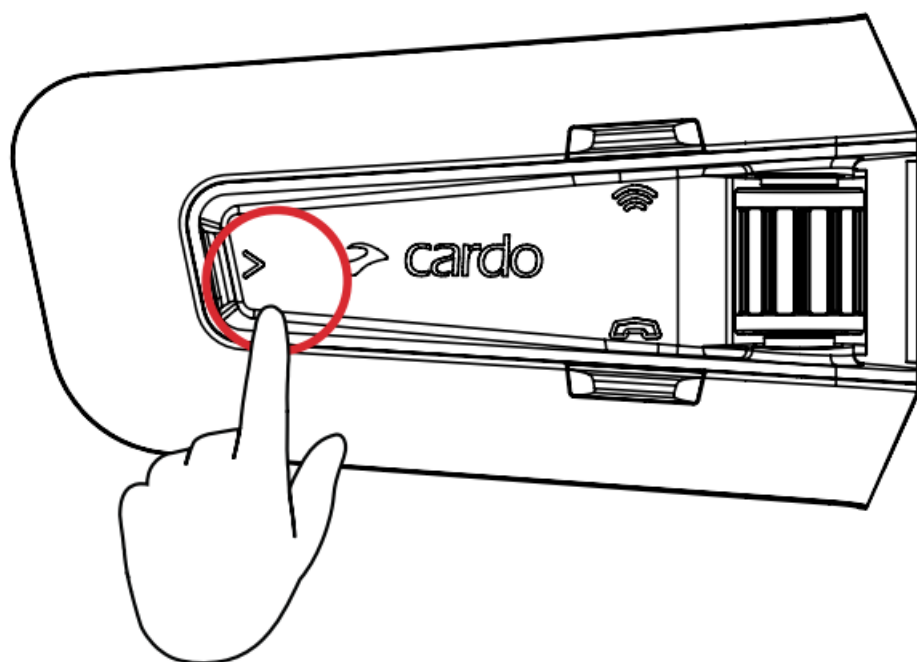

Start Scan

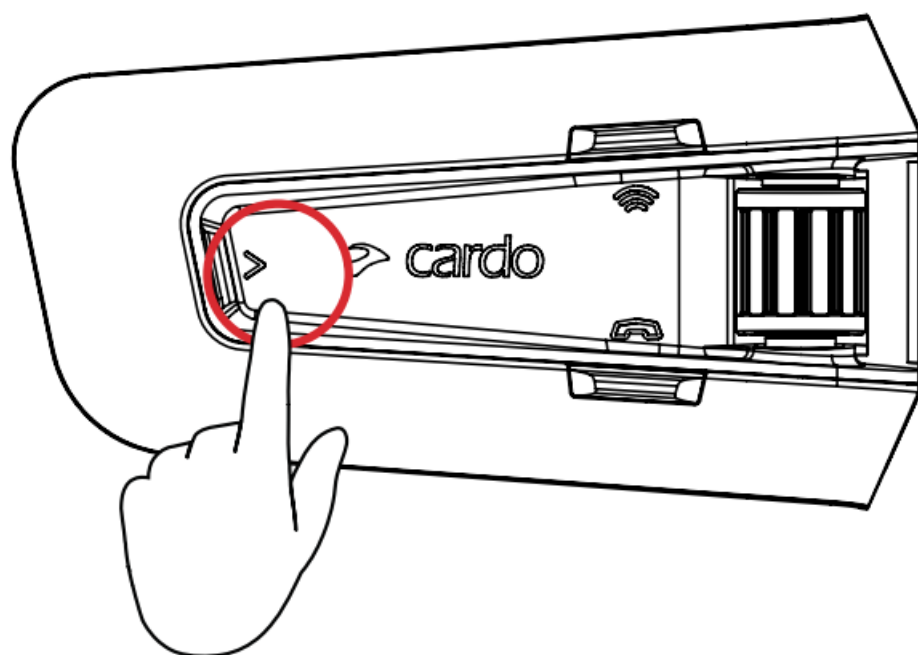

Stop Scan

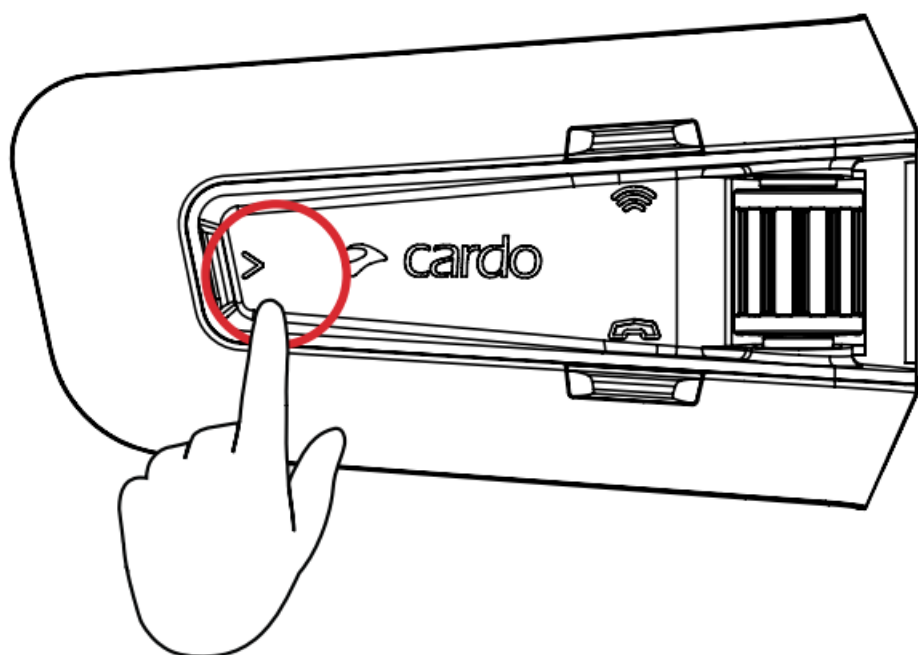

Music

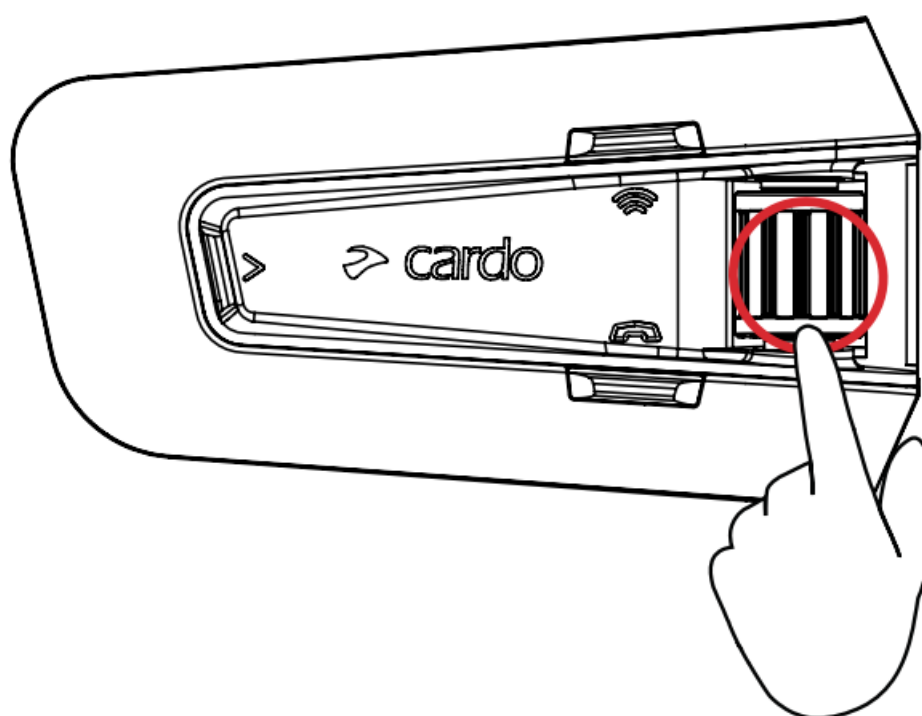
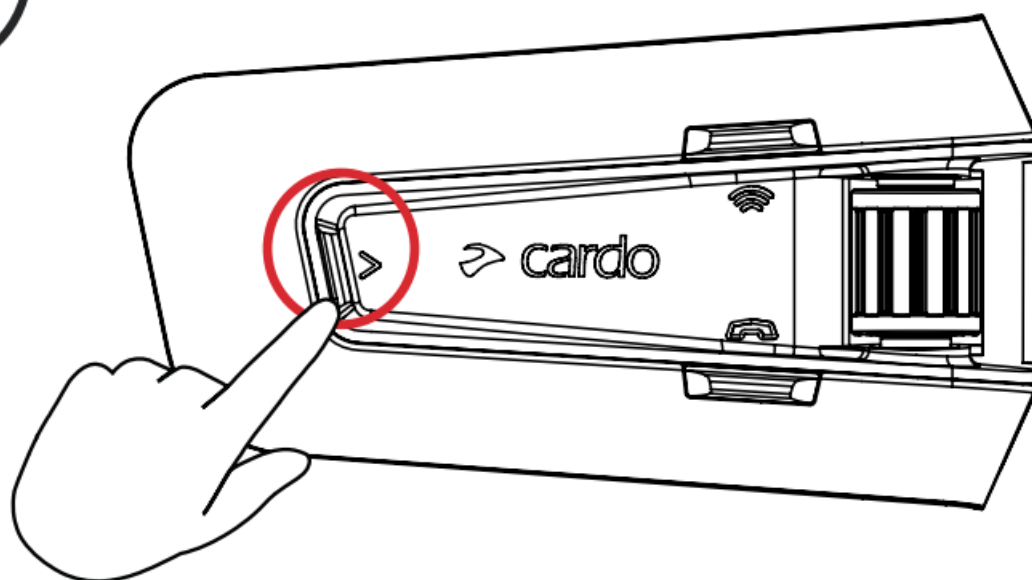



Next

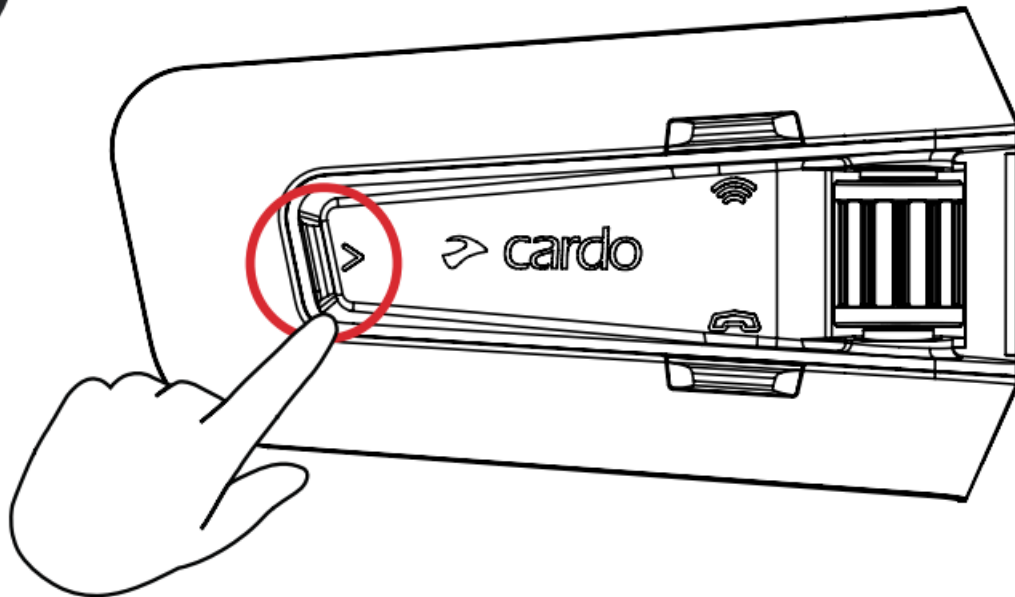

Previous

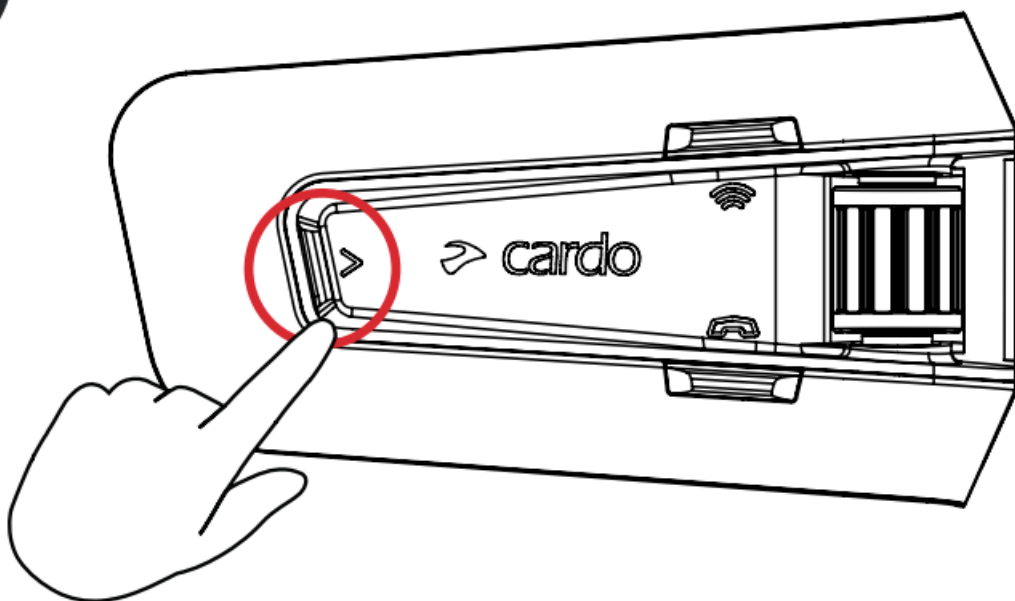

Switch Source



Music to Radio

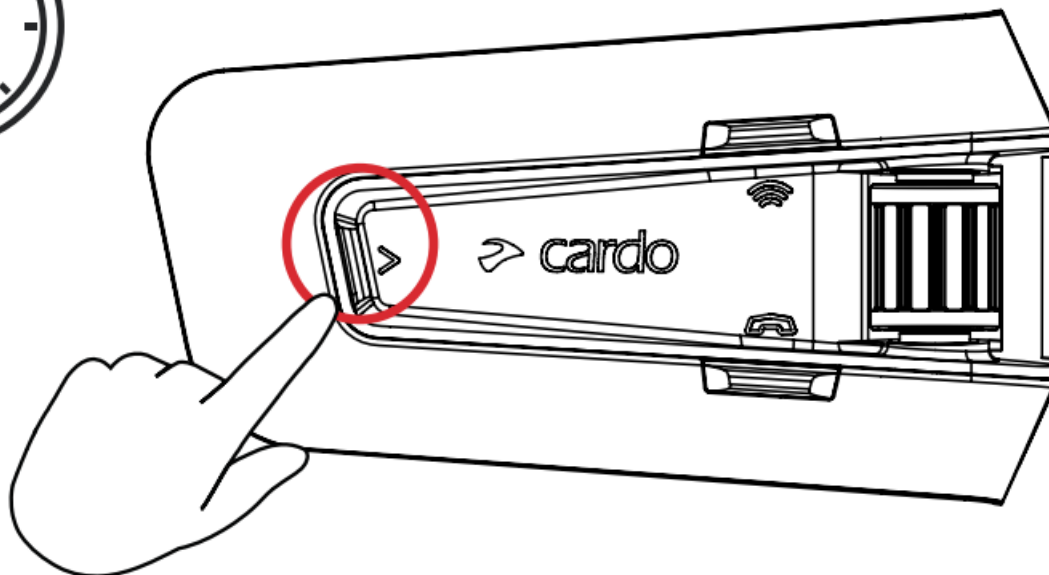

Radio to Music

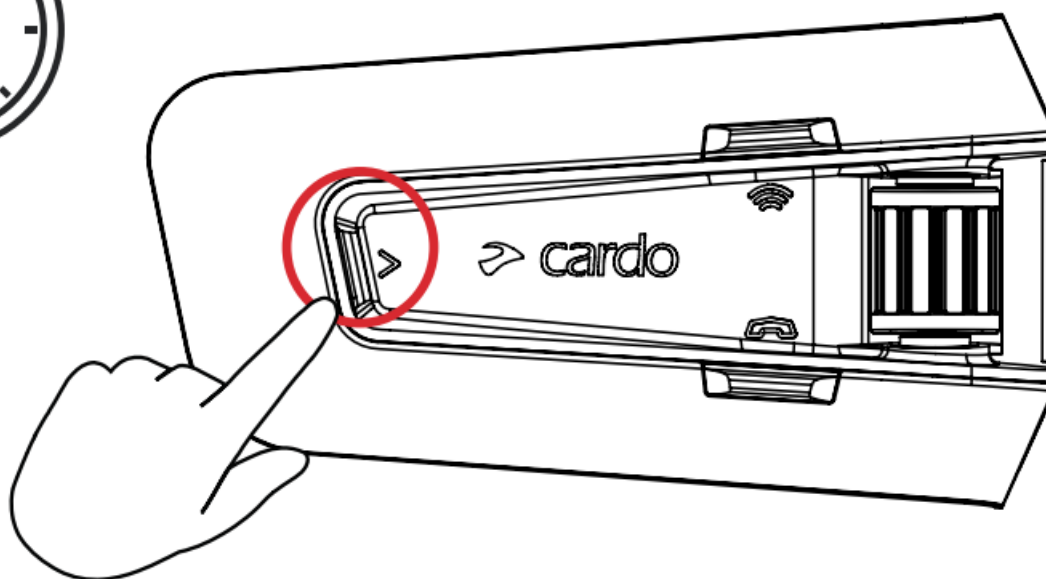

Phone Call



Answer

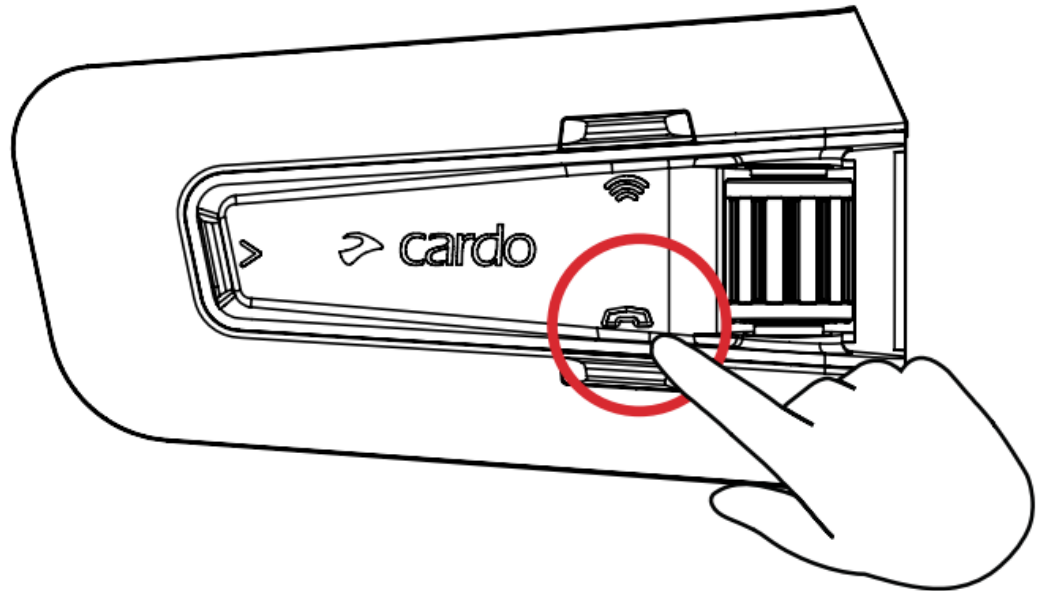

Ignore

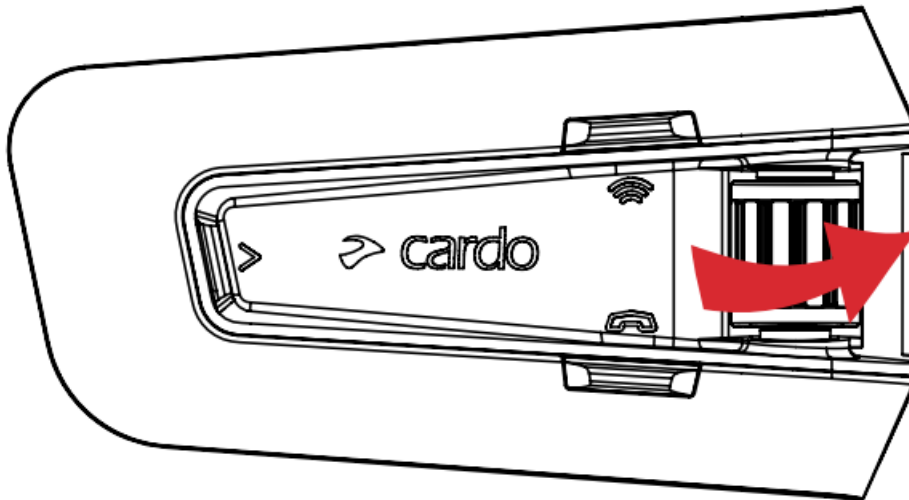

End Call

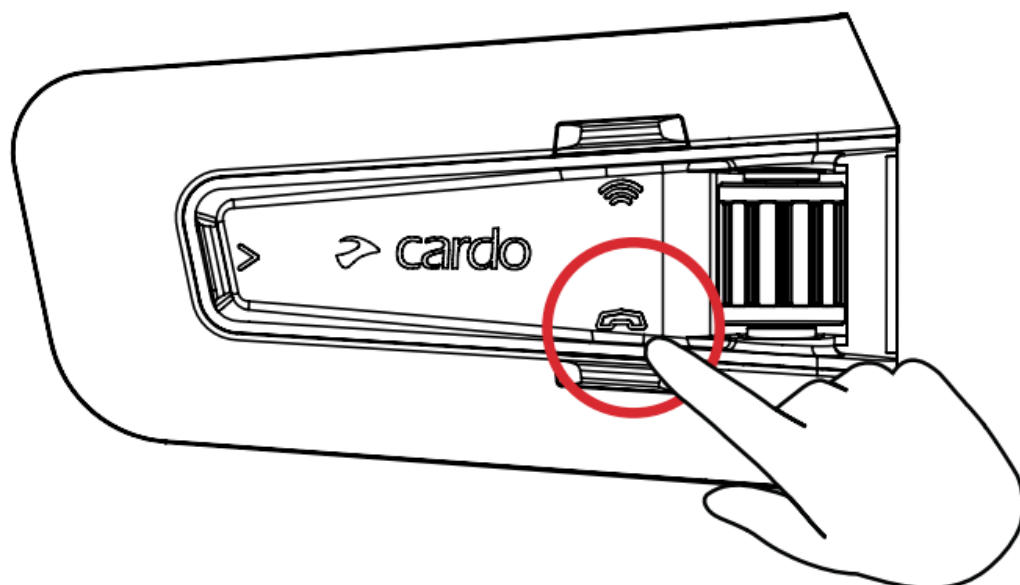

Redial

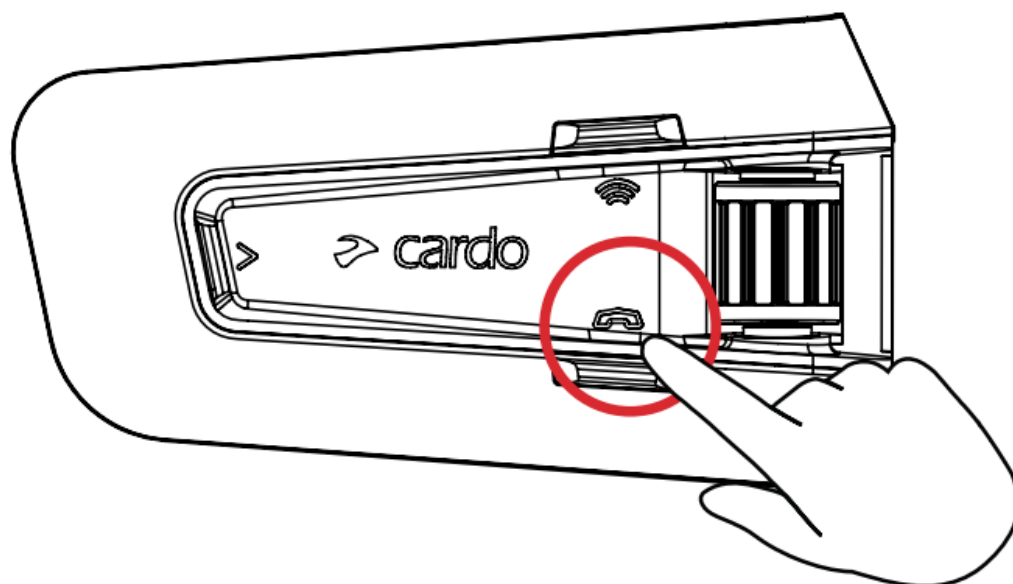

DMC Intercom



Grouping

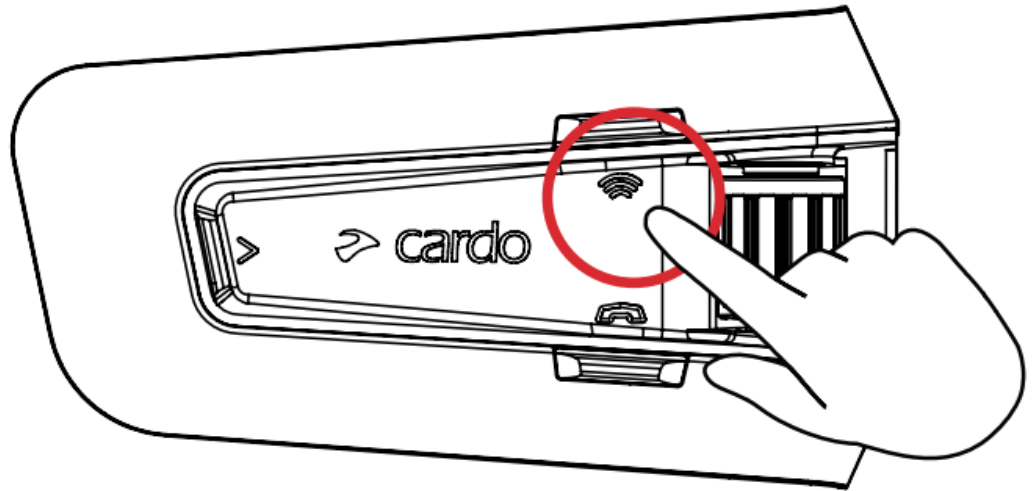

LED Red & Green 

Grouping Success

LED Purple 



Mute / Unmute Group

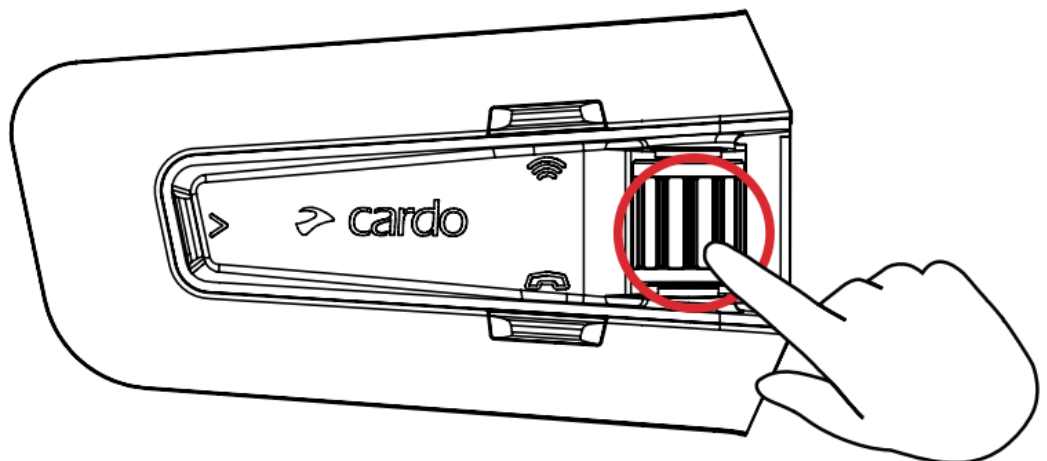

Share Call

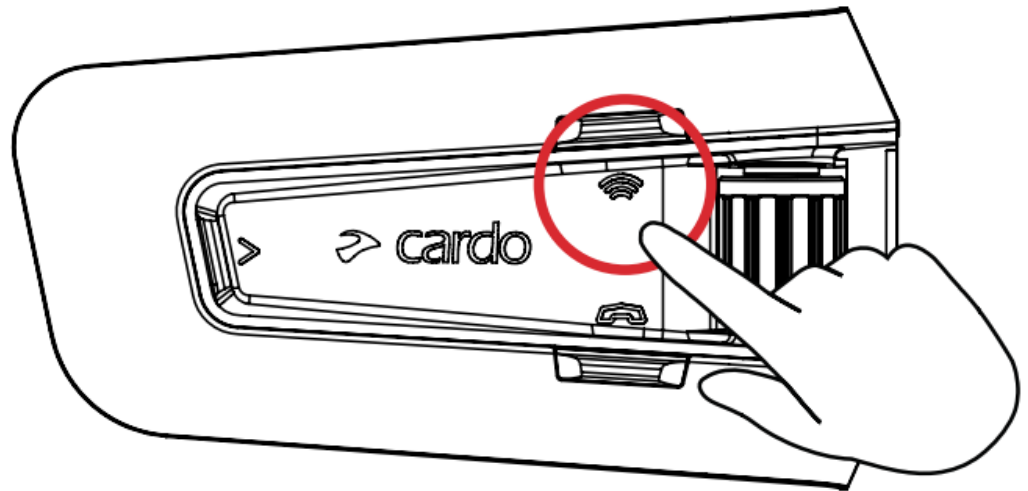

Music Sharing



Set Sharing Partner

1

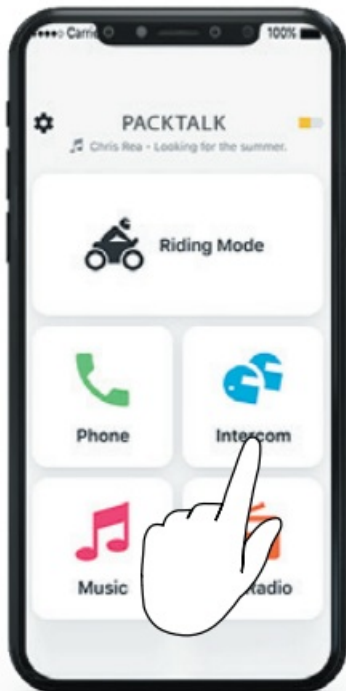

2

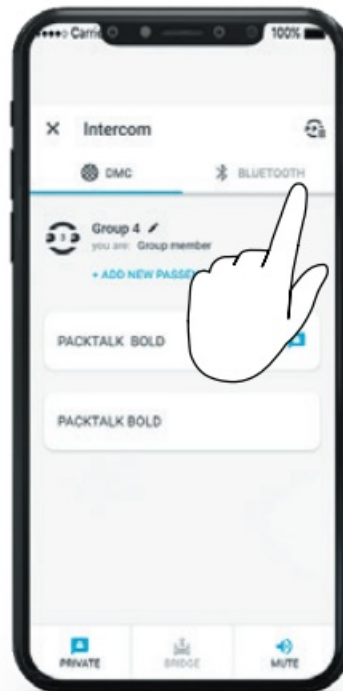

3

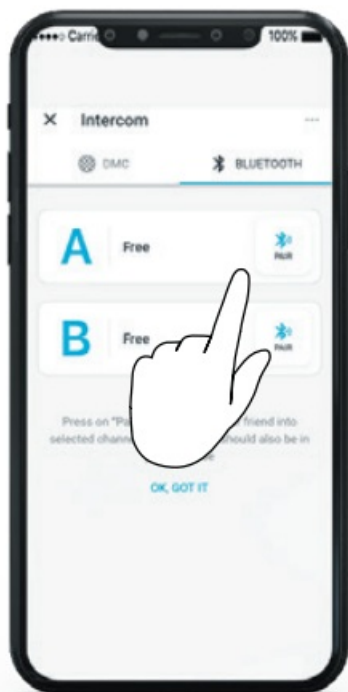

4

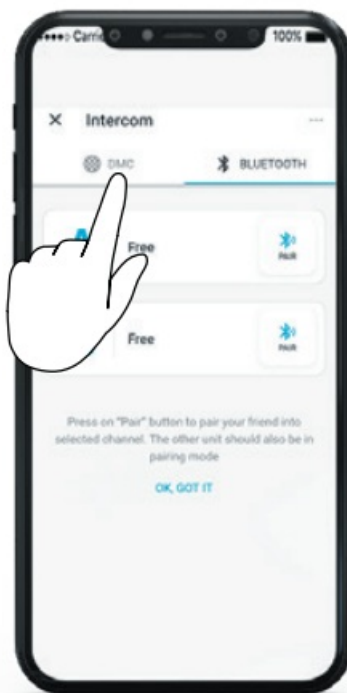

Start / Stop Sharing

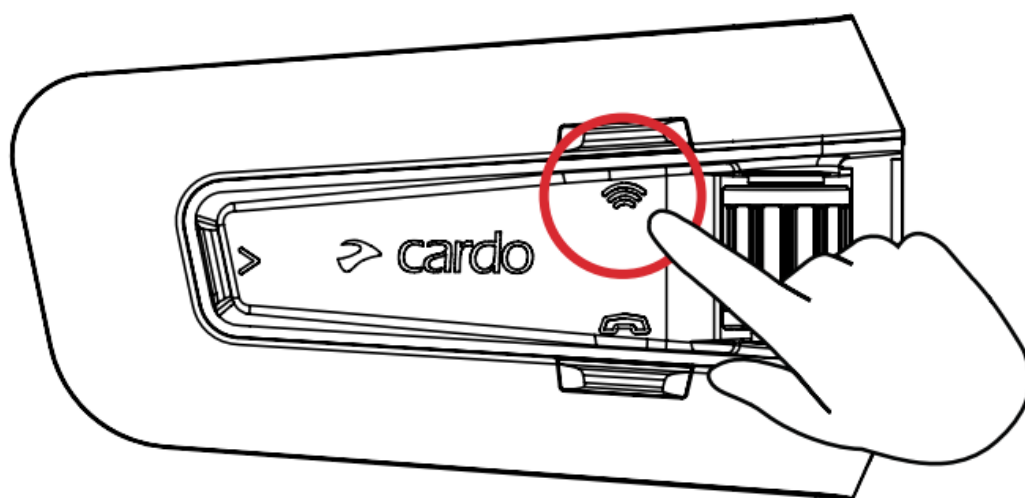

DMC Intercom



Set Private Chat Partner

1

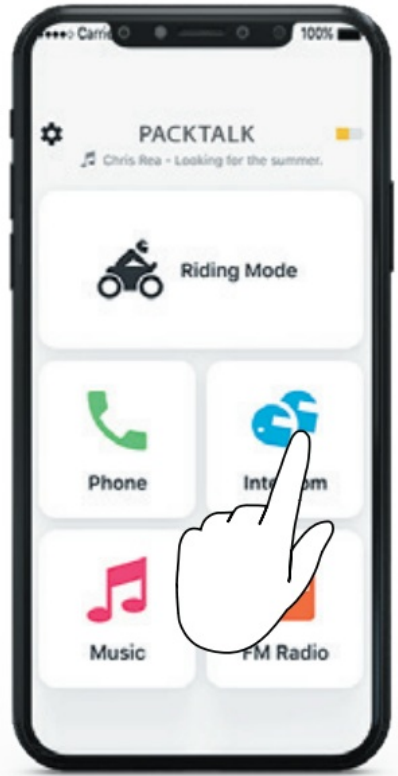

2

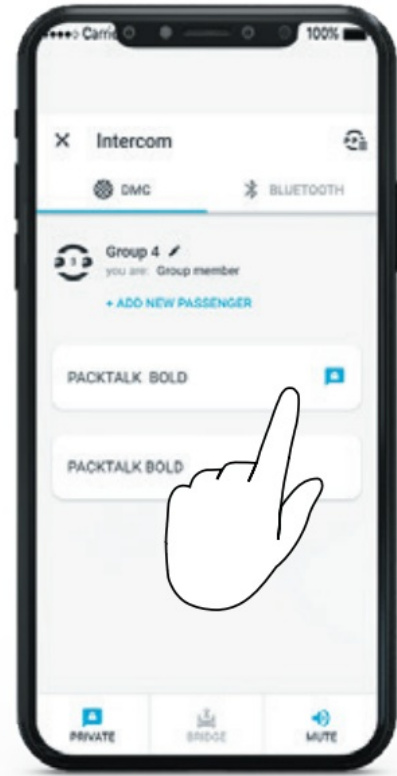

Start / Stop Private Chat

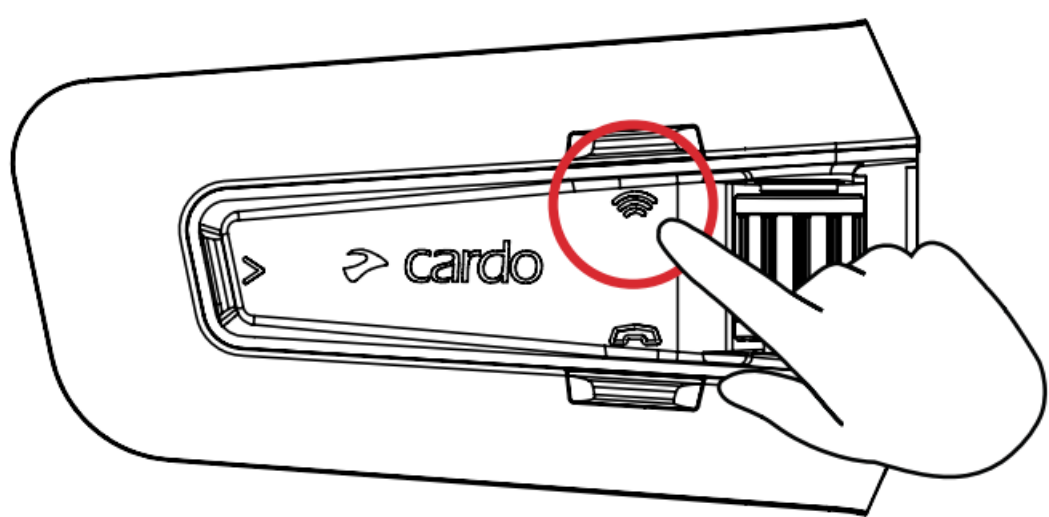

Add Bluetooth Passenger

1

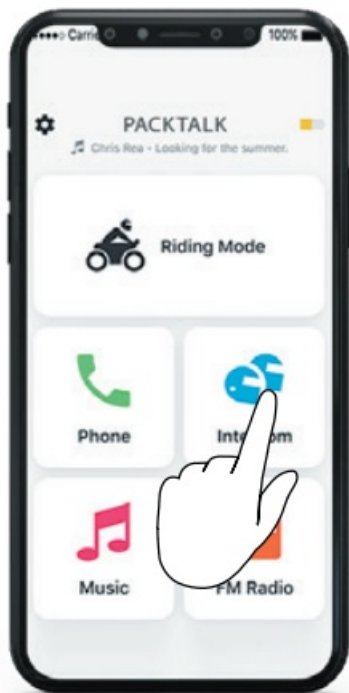

2

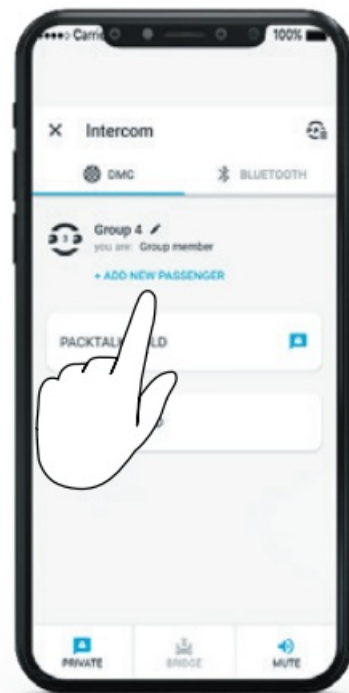

Start/Stop Passenger Intercom

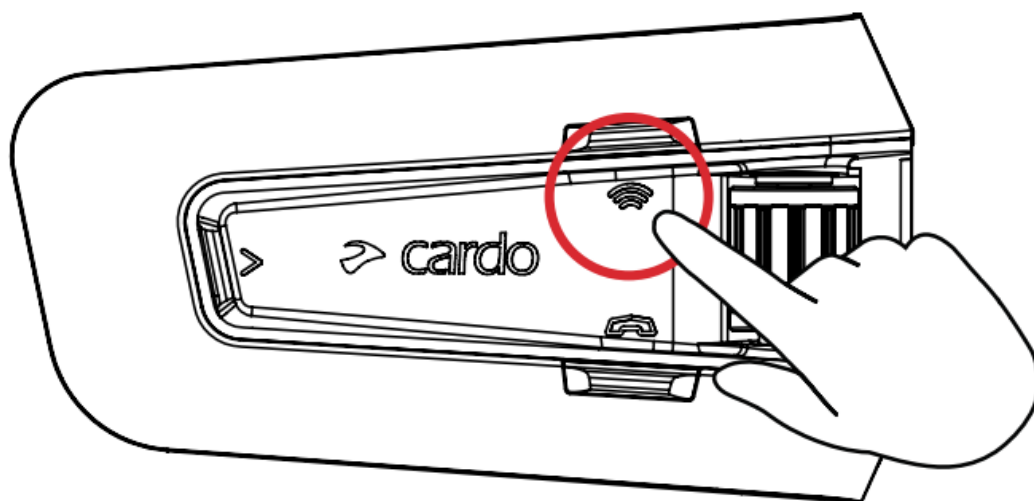

Phone Call



Set Speed Dial

1

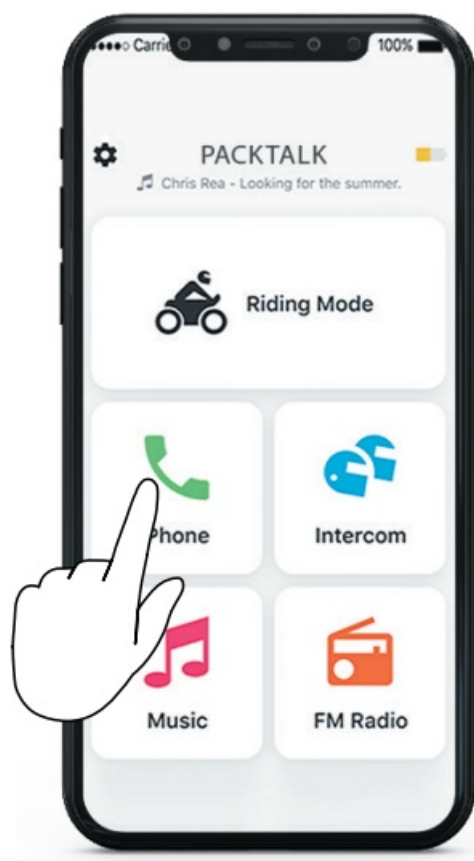

2

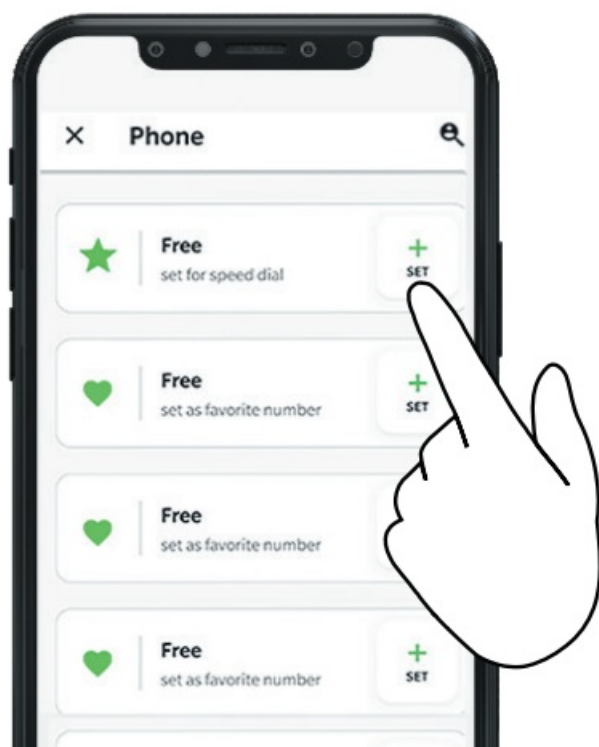

3

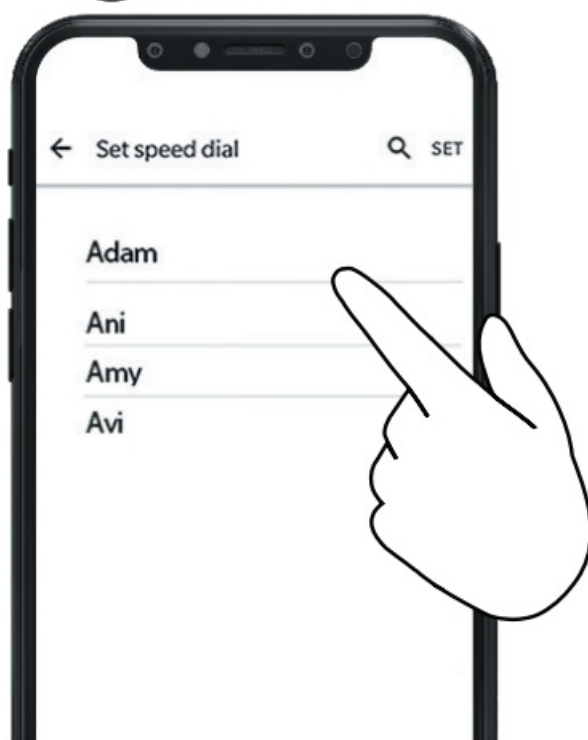



Call Speed Dial

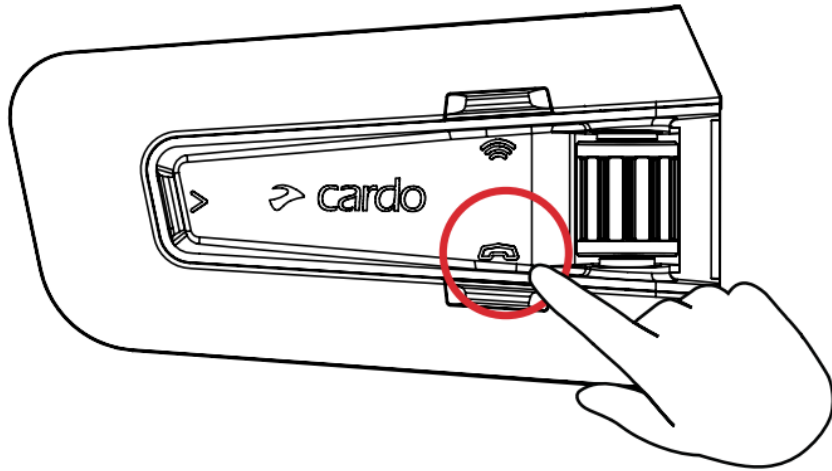

GPS Pairing

Step 1

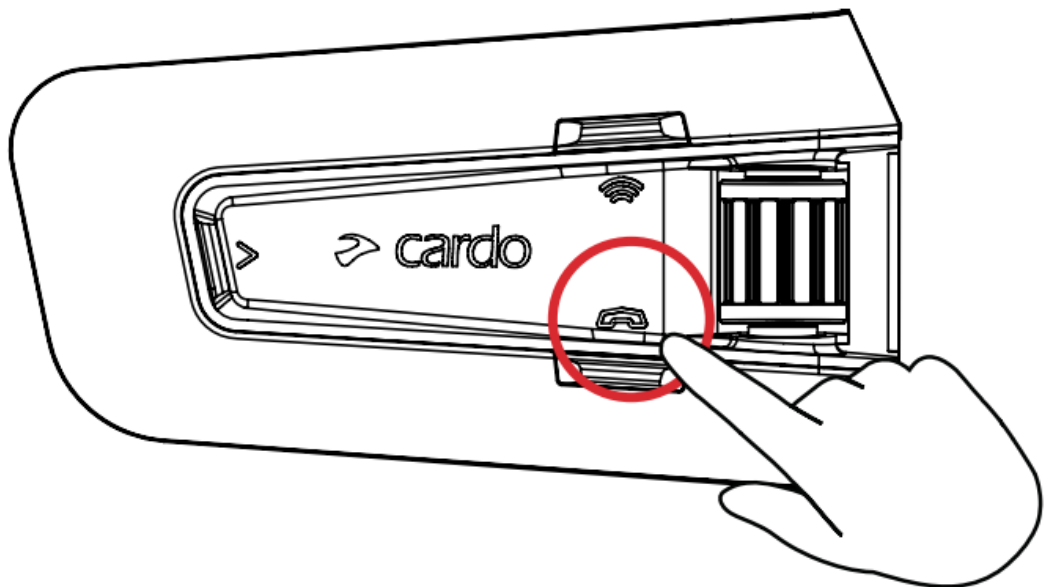

LED Red & Blue

Step 2

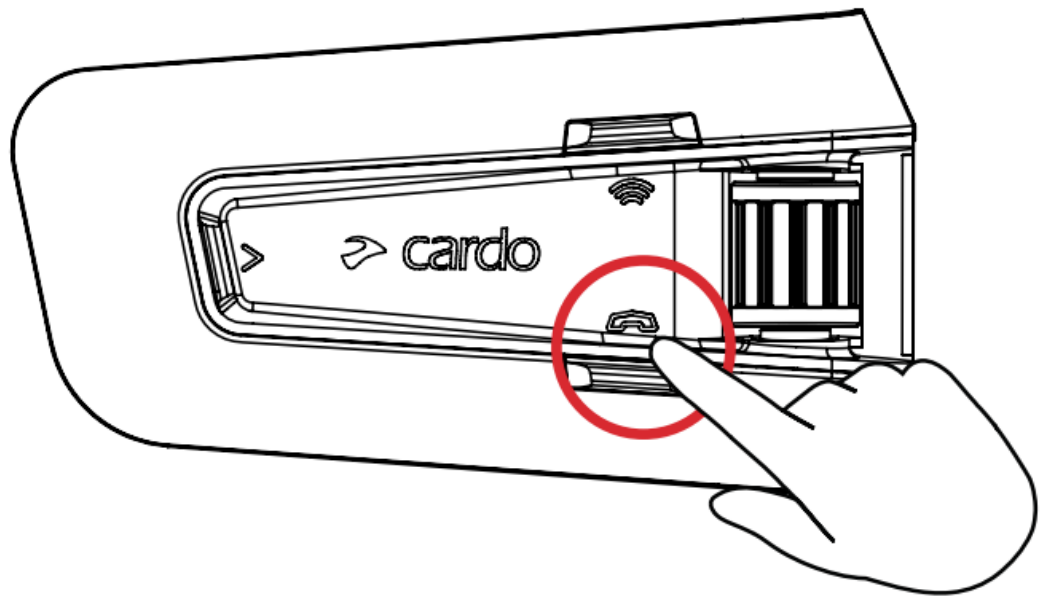

LED Red & Green 

Step 3

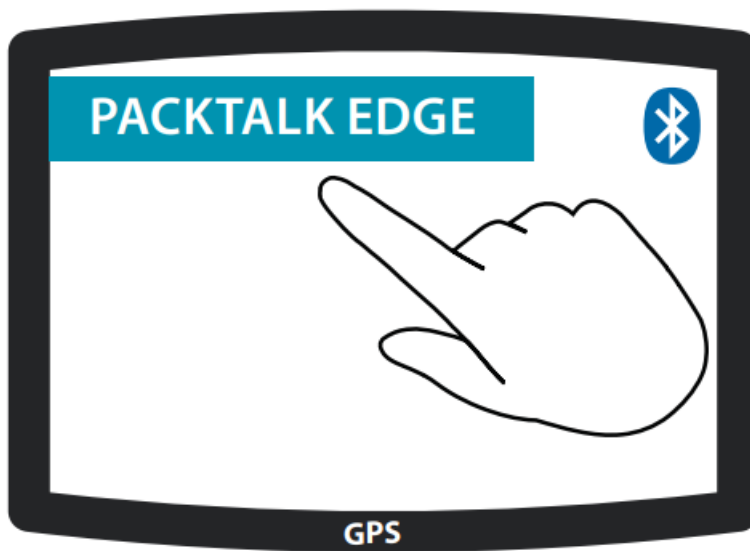

Universal Bluetooth Intercom



Bluetooth Intercom Pairing

1

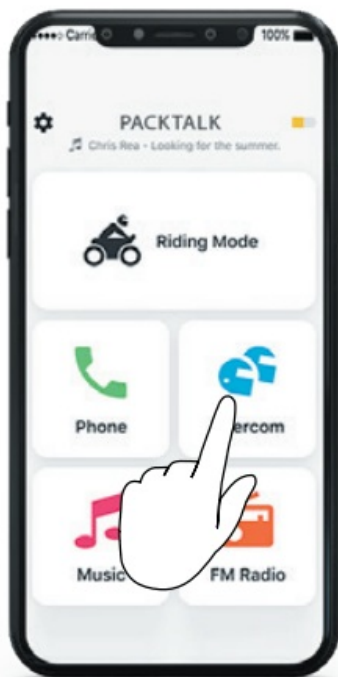

2

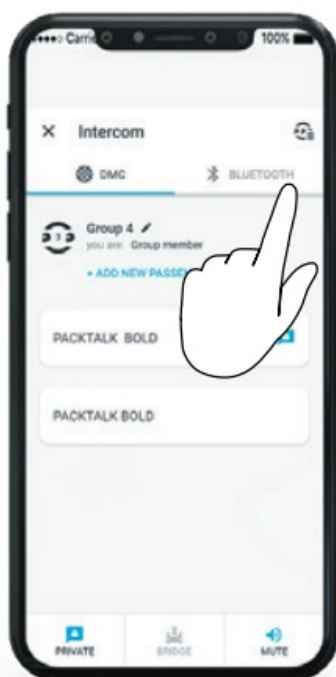

3

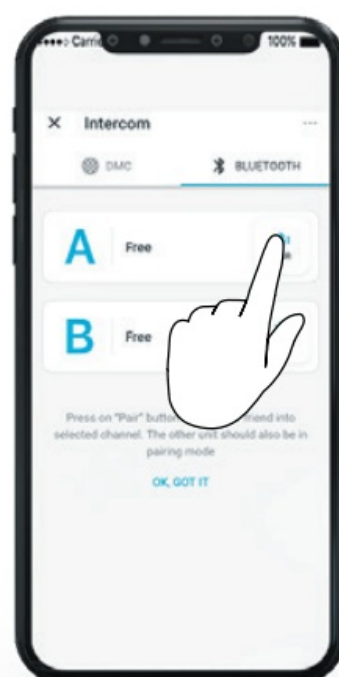

Start / Stop Intercom

Rider A

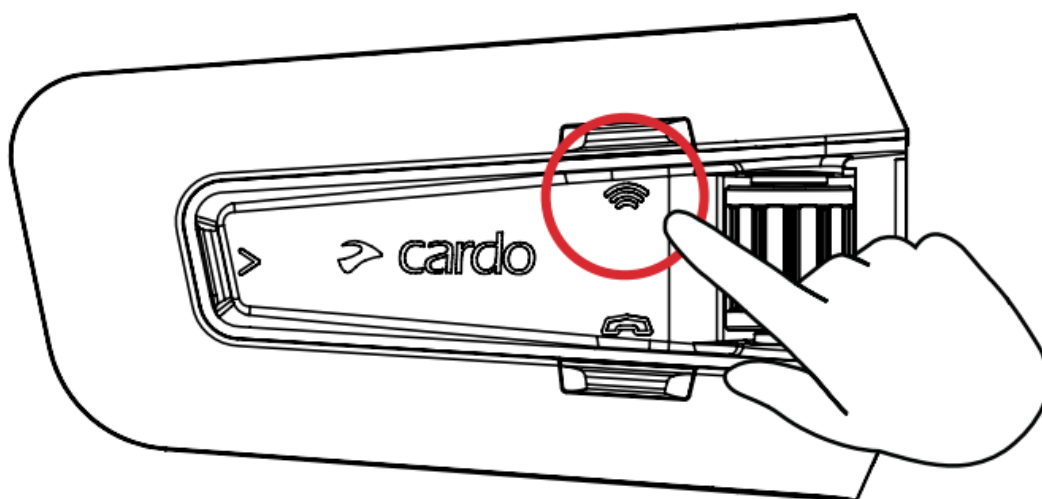

Start / Stop Intercom

Rider B

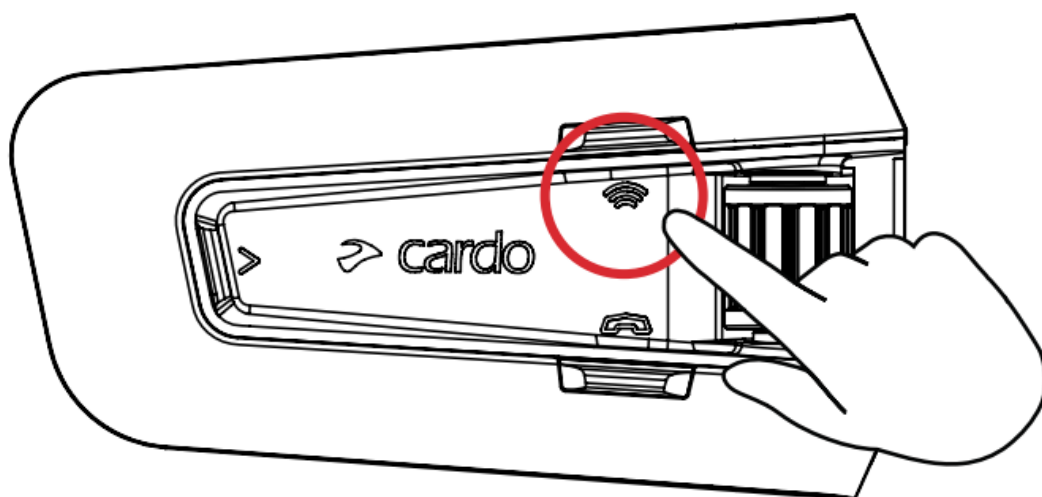

Reboot

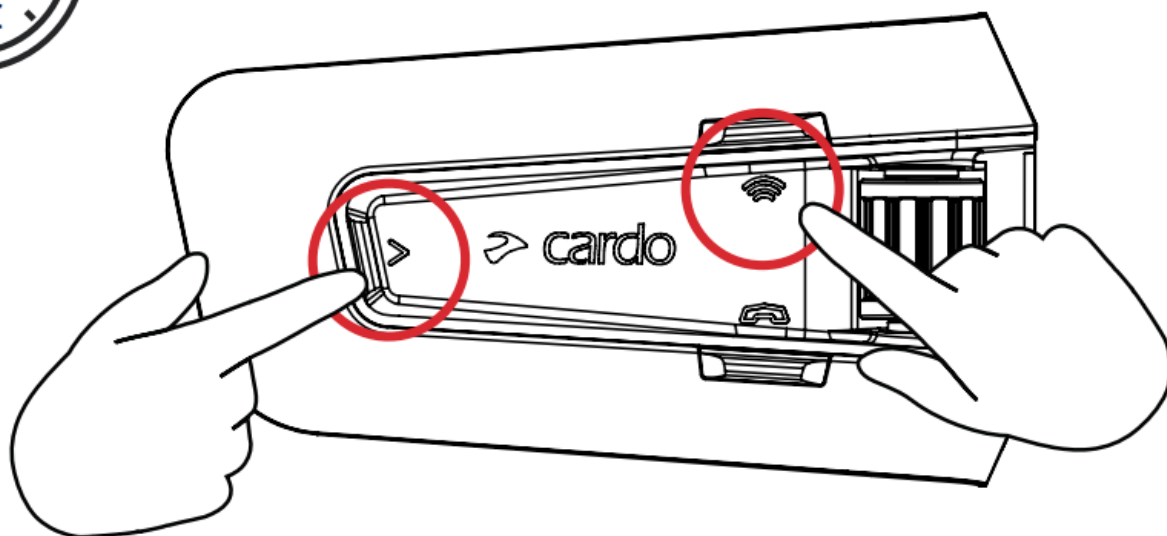

Factory Reset

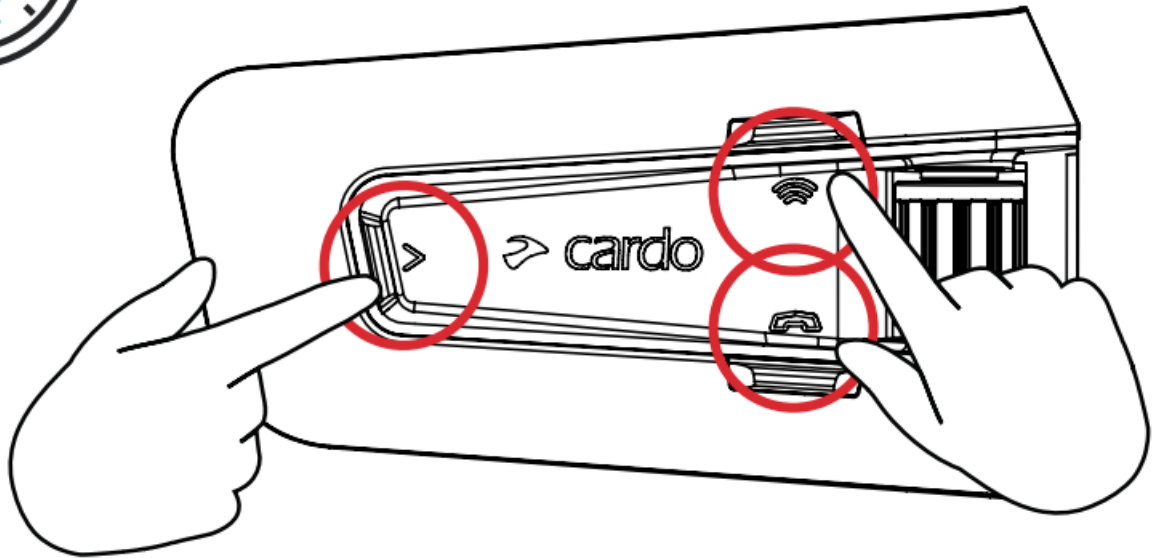

Voice Commands – Always On!



- Answer
- Ignore

- “Hey Cardo, end call”
- “Hey Cardo, speed dial”
- “Hey Cardo, redial number”



- “Hey Cardo, music on”
- “Hey Cardo, music off ”
- “Hey Cardo, next track”

- “Hey Cardo, previous track”
- “Hey Cardo, share music”



- “Hey Cardo,radio on”
- “Hey Cardo, radio off ”
- “Hey Cardo, next station”

- “Hey Cardo, previous station”



For Bluetooth intercom only

- “Hey Cardo, call intercom”
- “Hey Cardo, end intercom”



- “Hey Siri”
- “OK Google”



- “Hey Cardo, volume up”
- “Hey Cardo, volume down”
- “Hey Cardo, mute audio”
- “Hey Cardo, unmute audio”
- “Hey Cardo, mute microphone”
- “Hey Cardo, unmute microphone”



- “Hey Cardo, battery status”



cardosystems.com



Cardosystems.com/update

Cardosystems.com/support



Documents / Resources



[HONDA PACKTALK EDGE Powerful Communication System](#) [pdf] User Guide
PACKTALK EDGE Powerful Communication System, PACKTALK EDGE, Powerful
Communication System, Communication System

References

- ➔ [Cardo Systems - The World's Best Powersports Communication System](#)
- ➔ [Cardo Connect app, updater, software upgrades, manual & accessories for devices](#)
- ➔ [Download cardo updater - Cardo Systems](#)

Manuals+.